

Russell Hobbs

INSTRUCTIONS & WARRANTY



RHM18
MIST FAN

INTRODUCTION

Congratulations on purchasing our Russell Hobbs Mist Fan. Each unit is manufactured to ensure safety and reliability. Before using this appliance for the first time, please read the instruction manual carefully and keep it for future reference.

IMPORTANT SAFEGUARDS

When using any electrical appliance, basic safety precautions should always be followed including the following:

1. Please read the instructions carefully before using any appliance.
2. Always ensure that the voltage on the rating label corresponds to the main voltage in your home.
3. Incorrect operation and improper use can damage the fan and cause injury to the user.
4. The fan is intended for household use only. Commercial use invalids the warranty and the supplier cannot be held responsible for injury or damage caused when using the appliance for any other purpose than that intended.
5. This fan is not intended for use by persons (including children) with reduced physical, sensory or mental capabilities, or lack of experience and knowledge, unless they have been given supervision or instruction concerning use of the appliance by a person responsible for their safety.
6. Check the power cord and plug regularly for any damage. If the cord or the plug is damaged, the manufacturer or a qualified person must replace it in order to avoid an electrical hazard.
7. Do not use the fan if it has been dropped or damaged in any way. In case of damage, take the unit in for examination and/or repair by an authorised service agent.
8. To reduce the risk of electric shock, do not immerse or expose assembly, plug or the power cord to water or any other liquid.
9. Never immerse the unit in water or any other liquid for cleaning purposes.
10. Remove the plug from the socket by gripping the plug. Do not pull on the cord to disconnect the fan from the mains. Always unplug the unit when not in use, before cleaning or when adding or removing parts.
11. The use of accessory attachments that are not recommended or supplied by the manufacturer may result in injuries, fire or electric shock.
12. A short cord is provided to reduce the hazards resulting from becoming entangled in or tripping over a longer cord.
13. Ensure that the cord is not in a position where it can be pulled on inadvertently.
14. Do not allow the cord to touch hot surfaces and do not place on or near a hot gas or electric burner or in a heated oven.
15. Use of an extension cord with the fan is not recommended.
16. This fan is not suitable for outdoor use. Do not use this appliance for anything other than its intended use.
17. DO NOT carry the appliance by the power cord.
18. DO NOT COVER the fan under any circumstances.
19. Do not leave the appliance unattended during use. Always unplug the unit when not in use or before cleaning.
20. Always operate the appliance on a smooth, even, stable surface. Do not place the unit on a hot surface.
21. Ensure that the switch is in the "Off" position after each use.
22. The manufacturer does not accept responsibility for any damage or injury caused by improper or incorrect use, or for repairs carried out by unauthorised personnel.
23. In case of technical problems, switch off the unit and do not attempt to repair it yourself. Return the appliance to an authorised service facility for examination, adjustment or repair. Always insist on the use of original spare parts. Failure to comply with the above mentioned pre-cautions and instructions, could affect the safe operation of this machine.

Introduction

This product has both fan and humidifier functions, which can be used together or separately. The humidifier is especially useful on very hot days, when the extra mist in the air helps not only to cool you down, but also to increase the humidity in the dry heat.

How does it work?

This Mist Fan uses ultrasonic vibration to atomise water into 1-5 micron particles, which can then be blown through the room with the fan.

Why is it useful?

Not only does this fan help to cool you down with air containing micro water droplets, it also helps to avoid dry skin and eyes which are common in dry heat. A relative humidity of 45% - 65% is recommended for comfortable living, and this fan can help maintain that balance in the hot summer months.

Parts

1. Front mist plate
2. Front Guard
3. Blade cap
4. Blade
5. Guard Mounting Nut
6. Rear Guard
7. Motor
8. Fan Body
9. Base
10. Castor wheels
11. Base Nut
12. Fixer
13. Plastic Tube
14. Tube Button

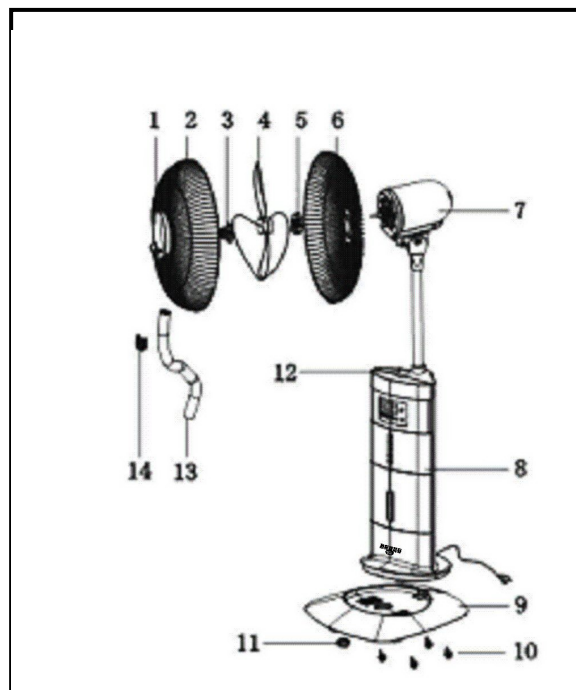

Technical Data

Rated Voltage: 220-240V~
Rated Frequency: 50Hz
General Power: 120W
Max Mist Capacity: 200ml/h
Fan Head Size: 450mm
Water Tank Capacity: 1500ml

Installation

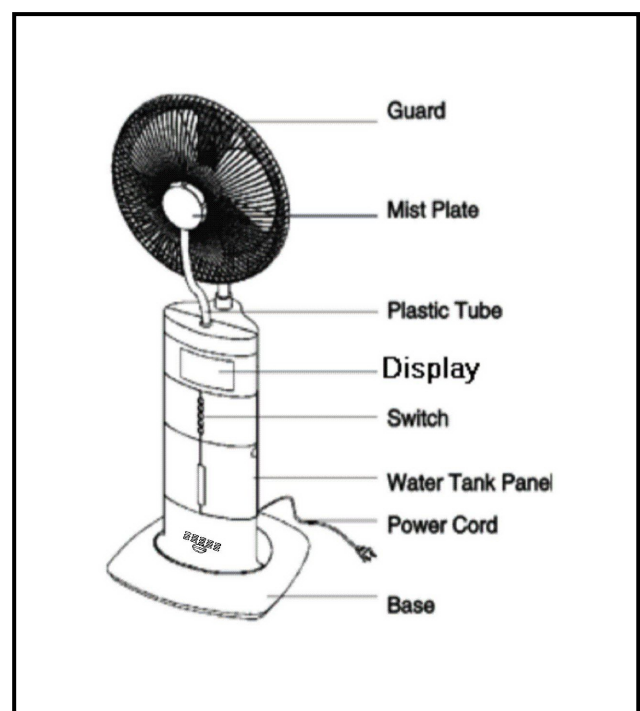

- 1: First base is installed in place of the main stable
- 2: The head fixed in the main part of the bearing hole
- 3: Installed guard and blade, and net fixed firmly lock the lookout Network

Filling the water tank

Place the fan on a flat, stable floor, then add water for the humidifying function as follows:

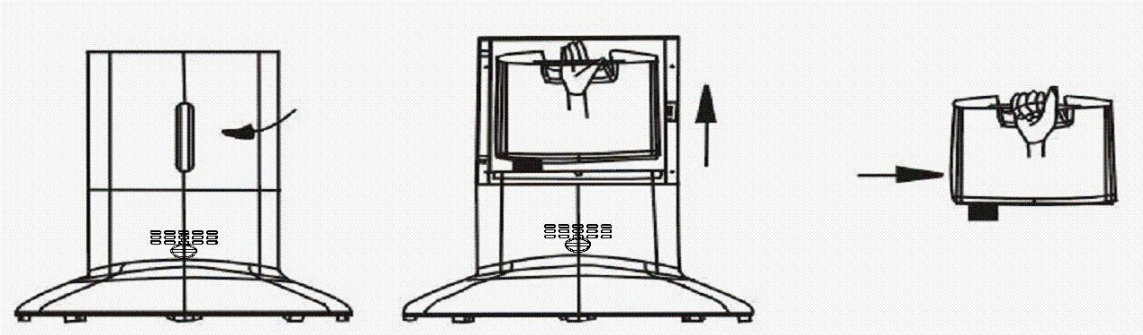

1. Open the water tank cover.
2. Lift out the water tank
3. Take out the water tank.

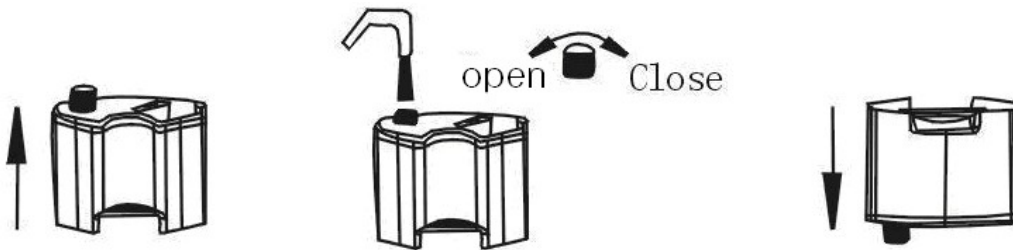

4. Over a sink, turn the water tank so the outlet cap is facing upwards.
5. Screw off the tank cap, and add water.
6. Screw tank cover tightly, and put it into the fan, then close panel.

Operation

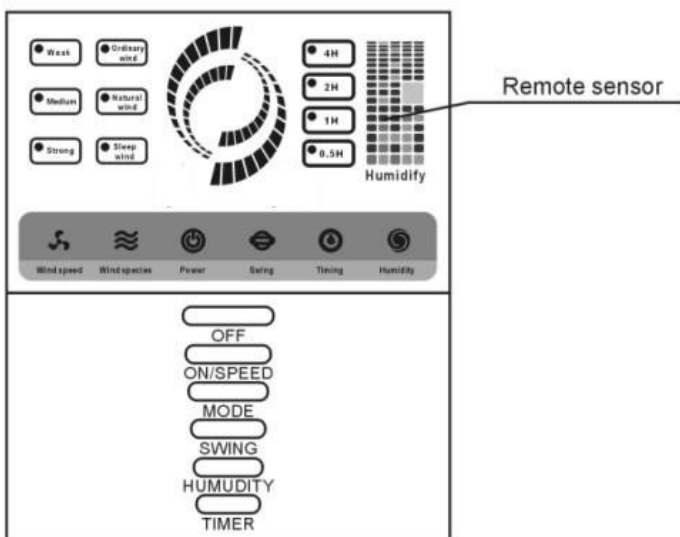

*Insert plug to the electrical outlet, and the indicator light turns on.

*Press “**ON/SPEED**” button to choose the wind for low, Med, High speed that matches the light on the control panel.

*Press “**MODE**” to choose the wind type from one of the following:

“Normal”: Wind flow based on Low/Med/High speed.

“Breeze”: Imitates the flow of natural wind based on strong and soft wind.

“Sleep”: The fan runs for half an hour on strong then soft natural wind mode, then changes to soft natural wind for the next half hour, and then the fan turns off automatically.

(1).Setting H:

Operation pattern: H→Stop→H→Stop→H

(2).Setting M:

Operation pattern: M→stop →M→Stop→M

(3)Setting L:

Operation pattern: L→Stop→L→off→L

*Press “**SWING**” to start oscillation; press again to fix the airflow direction.

*Press “**HUMIDITY**” to start the humidifying function; mist comes out of the front plate if there is water in the tank.

The MIST function can be used on its own or along with the fan function to blow the mist into the room.

*Press “**TIMER**” button to make the fan run for the length of the timer. There are 4 indicator lights for automatic timing. To set a time of **7.5 hours** you need to press 15 times and all the 4 indicator lights light up.

* The Remote Control must be pointed towards the Remote Sensor on the main unit for best results. If the remote control doesn't operate as expected, replace the batteries (**2 pcs, AAA battery**).

Caution

- * Do not touch / pull out / put back the water tank when the unit is plugged into a power source. Make sure it is physically disconnected from the mains before doing anything with the water tank.
- * When the water level is too low, the safety switch will cut out operation of the mist function. Unplug the unit and refill the water tank for further operation.
- * Do not let dust or other particles collect on the mist plate - if the mist outlets are blocked, the mist function could malfunction.
- * Before cleaning the unit, make sure it is completely disconnected from the power source. Make sure your hands are not wet when unplugging the unit.
- * Do not use very hot water in the water tank - use water less than 40 degrees Celsius.
- * Use only water in the water tank. Do not add chemicals or oils or any other additive.
- * Infants, the disabled and the elderly should not be in the direct airflow from the fan for long periods of time.
 - This appliance is not intended for use by young children or infirm persons unless they have been adequately supervised by a responsible person to ensure that they can use the appliance safely.
 - Young children should be supervised to ensure that they do not play with the appliance.
 - If the supply cord is damaged, it must be replaced by the manufacturer, its service agent or similarly qualified person in order to avoid a hazard.

Cleaning and Maintenance

* Make sure power is disconnected before any cleaning or maintenance is performed.

* It is recommended that you clean the water tank every 2-3 weeks of use, and clean the flume every week.

* Pull out the water tank before cleaning it - pull the plastic tube out of the mist cask properly, then take out the mist cask and water tank.

* Use a dry cloth to clean the mist cask. If there are stubborn stains on the mist cask, use a cloth lightly dampened with mild detergent.

* If the mist feature will not be used for a long time, empty the water tank and leave it to dry before recapping it.

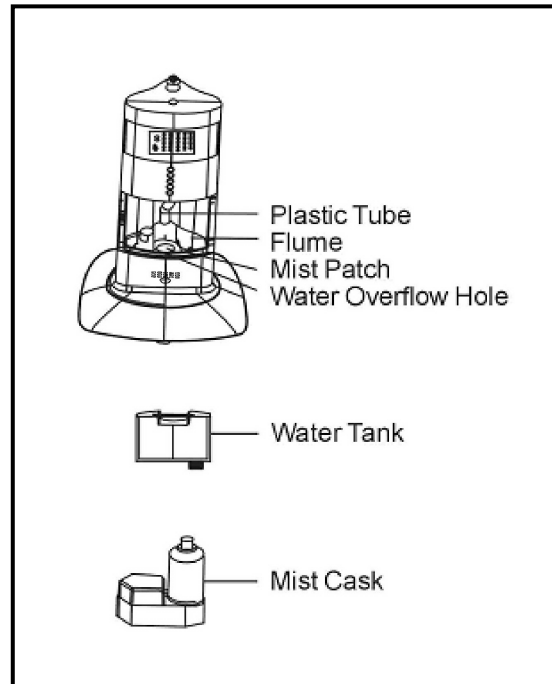

Troubleshooting

Fault Phenomenon	Reason	Solution
1. Mist projector works normally, but without mist spray	a. Water could be contaminated with other substances or chemicals b. Water tank could be cracked c. Water tank could be empty	a. Clean out the water tank and replace with clean water b. Pour out the water and check for cracks c. Refill the water tank. A full tank of water will last approximately 8 hours
2. Mist projector doesn't work	a. Bobber doesn't float b. Water tank could be empty	a. Free the bobber and allow it to float freely. b. Refill the water tank. A full tank of water will last approximately 8 hours
3. No indicator light, no wind, no mist.	a. Power cord is unplugged, and electric power is power off	a. Plug the power cord, and turn on the electric power
4. Peculiar smell from the mist	a. When new, there might be residue in the water tank/mist plate. b. The water in the water tank may be contaminated.	a. The smell should disappear after further use. b. Clean out the water tank and refill with fresh water
5. The fan doesn't work as normal	a. The plug and supply cord are damaged b. The blades are bent c. Don't safety device	a. Find service agent or a suitable qualified person to change or service b. Don't play the blades. Use soft damp cloth then wipe with dry cloth c. Installed correctly in accordance with the manual. Can not be installed until there is no electricity

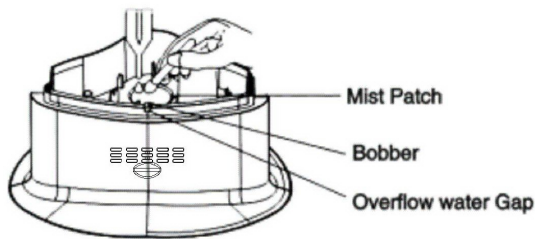

Figure of cleaning mist patch

WARNING:

Unplug from electrical supply source before cleaning. After servicing, any safety device (including grilles and blades) must be reinstalled or remounted as previously installed. Use soft damp cloth then wipe with dry cloth. Do not use harmful cleaners. Do not bend the blades.

If the plug and supply cord are damaged, it must be replaced by the manufacturer, its service agent or a suitable qualified person in order to avoid a hazard.

This appliance is not intended for use by persons (including children) with reduced physical, sensory or mental capabilities, or lack of experience and knowledge, unless they have been given supervision or instruction concerning use of the appliance by a person responsible for their safety. Children should be supervised to ensure that they do not play with the appliance.

Changing the Plug

Should the need arise to change the fitted plug, follow the instructions below.

This unit is designed to operate on the stated current only. Connecting to other power sources may damage the appliance. Connect a three-pin plug as follows:

The wires in this mains lead are coloured in accordance with the following code:

- Green/Yellow = Earth
- Blue = Neutral
- Brown = Live

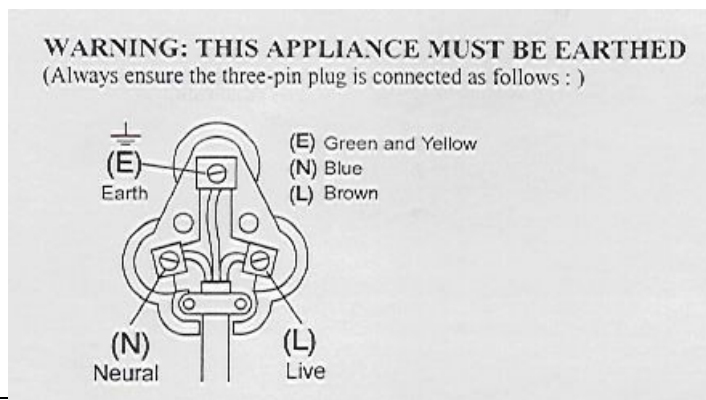

PLEASE AFFIX YOUR PROOF OF
PURCHASE/RECEIPT HERE
IN THE EVENT OF A CLAIM UNDER WARRANTY THIS RECEIPT MUST BE PRODUCED.

WARRANTY

1. Home of Living Brands (Pty) Limited warrants to the original purchaser of this product ("the customer") that this product will be free of defects in quality and workmanship which under normal personal, family or household use and purpose may manifest within a period of 1 (one) year from the date of purchase ("warranty period").
2. Where the customer has purchased a product and it breaks, is defective or does not work properly for the intended purpose, the customer must notify the supplier from whom the customer bought the product ("the supplier") thereof within the warranty period. Any claim in terms of this warranty must be supported by a proof of purchase. If proof of purchase is not available, then repair, and/or service charges may be payable by the customer to the supplier.
3. The faulty product must be taken to the supplier's service centre to exercise the warranty.
4. The supplier will refund, repair or exchange the product in terms of this warranty subject to legislative requirements. This warranty shall be valid only where the customer has not broken the product himself, or used the product for something that it is not supposed to be used for. The warranty does not include and will not be construed to cover products damaged as a result of disaster, misuse, tamper, abuse or any unauthorised modification or repair of the product.
5. This warranty will extend only to the product provided at the date of the purchase and not to any expendables attached or installed by the customer.
6. If the customer requests that the supplier repairs the product and the product breaks or fails to work properly within 3 (three) months of the repair and not as a result of misuse, tampering or modification by or on behalf of the customer, then the supplier may replace the product or pay a refund to the customer.
7. The customer may be responsible for certain costs where products returned are not in the original packaging, or if the packaging is damaged. This will be deducted from any refund paid to the customer.

HOME OF LIVING BRANDS (PTY) LTD (JOHANNESBURG)

JOHANNESBURG TEL NO. (011) 490-9000

CAPE TOWN TEL NO. (021) 552-5161

DURBAN TEL NO. (031) 792-6000

www.homeoflivingbrands.co.za

www.russellhobbs.co.za