

You have decided to buy a watch, which was assembled by a watchmaker using a Ronda movement. Please note that no watches are produced or distributed under the Ronda brand.

In case of repairs, guarantee claims and questions concerning the functioning of a watch, purchasers and consumers should contact their retailer or the watch manufacturer, for which the relevant information can be found in the sales or guarantee documentation provided with the watch.

Chronograph: Basic function

(Start / Stop / Reset)

Example:

- Start:** Press push-button A.
- Stop:** To stop the timing, press push-button A once more and read the chronograph counters: **20 min / 38 sec**
- Zero positioning:** Press push-button B. (The chronograph hands will be reset to their zero positions.)

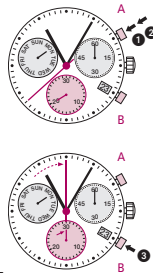

05

Description of the display and control buttons

Display elements Z60

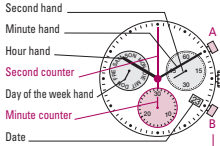

Control buttons

Push-button A & B
Crown

Display elements Z50

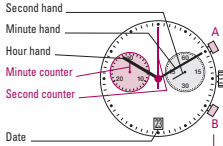

Control buttons

Push-button A & B
Crown

01

Chronograph: Accumulated timing

Example:

- Start:** (start timing)
- Stop:** (e.g. 15 min 5 sec following 1)
- Restart:** (timing is resumed)
- Stop:** (e.g. 5 min 12 sec following 3) = **20 min 17 sec** (The accumulated measured time is shown)
- Reset:** The chronograph hands are returned to their zero positions.

Please note:

* Following 4, the accumulation of the timing can be continued by pressing push-button A (Restart / Stop, Restart / Stop, ...).

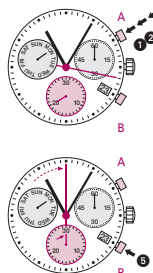

06

Setting the time

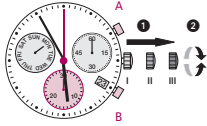

- * Pull out the crown to position III (the watch stops).
- Turn the crown until you reach the correct time 8:45.

- * Push the crown back into position I.

Please note:

* In order to set the time to the exact second, 1 must be pulled out when the second hand is in position «60». Once the hour and minute hands have been set, 2 must be pushed back into position I at the exact second.

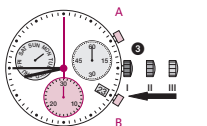

02

Chronograph: Intermediate or interval timing

Example:

- Start:** (start timing)
- Display interval:** e.g. 20 minutes 17 seconds (timing continues in the background)
- Making up the measured time:** (the chronograph hands are quickly advanced to the ongoing measured time).
- Stop:** (Final time is displayed.)
- Reset:** The chronograph hands are returned to their zero position

Please note:

* Following 2, further intervals or intermediates can be displayed by pressing push-button B (display interval / make up measured time, ...).

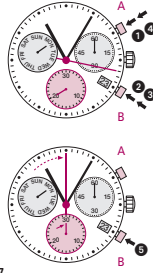

07

Setting the date (quick mode)

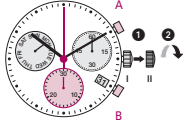

- Pull out the crown to position II (the watch continues to run).
- Turn the crown anticlockwise until the correct date [] appears.

- Push the crown back into position I.

Please note:

During the date changing phase between approx. 09:45 PM and 12 PM, the date must be set to the date of the following day.

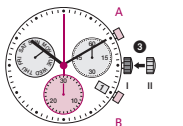

03

Setting the date, day of the week (Z60) and time

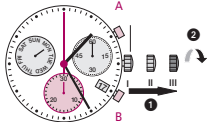

Example:
- Date / time on the watch: [17] / 01:25 / MON
- Present date / time: [23] / 20:35 / THU

- Pull out the crown to position III (the watch stops).

- Turn the crown anticlockwise until yesterday's day of the week WED appears.
- Push the crown to position II.

- Turn the crown until yesterday's date appears [22].

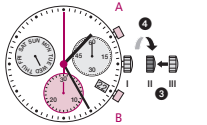

- * Pull out the crown to position III (the watch stops).

- Turn the crown anticlockwise until the correct date [23] and day of the week THU appears.

- * Continue to turn the crown anticlockwise until the correct time 8:35 PM appears.

- Push the crown back into position I.

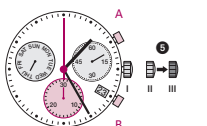

Please note:

* To set your watch to the exact second, please refer to the chapter entitled «setting the time».
** Please observe the AM/PM clock rhythm.

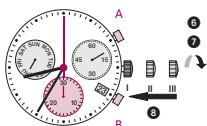

04

Adjusting the chronograph hands to zero position

Example:

One or several chronograph hands are not in their correct zero positions and have to be adjusted (e.g. following a battery change).

- Pull out the crown to position III (all chronograph hands are in their correct or incorrect zero position.)
- Keep push-buttons A and B depressed simultaneously for at least 2 seconds (the second counter hand rotates by 360° → corrective mode is activated.)

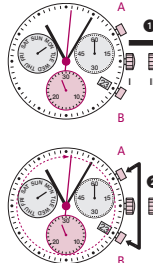

08

Adjusting the second counter hand

Single step: A 1 x short
Continuous: A long

Adjusting the next hand B

Single step: A 1 x short
Continuous: A long

Adjusting the minute counter hand (position 6h)

Single step: A 1 x short
Continuous: A long

- Returning the crown to position I
Termination of the chronograph hands adjustment (can be carried out at any time).

