

Note.1

Input "0000" and press "ENTER" for 12 times in order to next process.

Pass word:0000

Note.2

The number of physical drives in a specific RAID set determines the RAID levels that can be implemented with the RAID set.

- RAID 0 requires 1 or more physical drives per RAID set.
- RAID 1 requires at least 2 physical drives per RAID set.
- RAID 1 + Spare requires at least 3 physical drives per RAID set.
- RAID 3 requires at least 3 physical drives per RAID set.
- RAID 5 requires at least 3 physical drives per RAID set.
- RAID 3 + Spare requires at least 4 physical drives per RAID set.
- RAID 5 + Spare requires at least 4 physical drives per RAID set.

Note.3

Stripe size default is 64k, it could adjust to 4k or 128k mode under stripe size, actually 128K size will get much better performance.

Note.4

Please refer to the CD enclosed for detail user's manual.

Product Family/ Produkt Familie/ Famile de produit/ Familia de productos/ Famiglia di prodotti/ 製品ファミリー / 相關系列產品



MS1U



MS2C1



MS2UT



MR5S1

2.5" Hard disk Enclosure with 10-in-1 Card Reader/ Writer

- Blue backlight LCD Panel with Status and Battery Indicator
- Three memory card slots supports, CF I/II, MD, SM, MS, MS-PRO, SD, Mini-SD, MMC Card, XD, etc.
- USB 2.0 host interface, backward compatible with USB 1.1.
- Built-in Rechargeable Lithium-Ion Battery
- Single button backup from memory card to hard drive
- Durable and light weight Aluminum Case with Carry bag

Triple Interface RAID Subsystem

- Hardware RAID Engine, supports RAID 0 and JBOD
- Triple Host Interface: USB 2.0 + FireWire 400 + Firewire 800
- Drive Interface: 2x 3.5" SATA Harddrive
- Fan and Temperature failure detectors with purple warning LED

USB 2.0 & SATA Combo RAID Subsystem

- Hardware RAID Design, supports RAID 0, 1
- Host Interface: eSATA port & USB 2.0
- Drive Interface: 2 x 3.5" SATA Hard Disk
- Hot-Swappable Removable Tray
- Data Auto-Rebuilding
- Hard Disk, Fan and Temperature failure detectors
- No Driver Required

SCSI to SATA RAID 5 Subsystem

- Hardware RAID Design, supports RAID 0, 1, 3, 5, 0+1, JBOD & Hot Spare Disk
- Host Interface: SCSI Ultra 320
- Drive Interface: 5 x 3.5" SATA
- Hot-Swappable Removable Tray Hard Disk
- Data Auto-Rebuilding
- Hard Disk, Fan and Temperature failure detectors to ensure system stability

Version 1.0

INSTA RAID

IR35S1



QUICK INSTALLATION GUIDE

SANS DIGITAL

Your ONE-STOP Storage Solution Provider
www.sansdigital.com

IR35S1 system includes the following:

Please contact our distributors in case of any missing or damaged items.

Item	Quantity
IR35S1	1
Removable Tray Module	5
User's Guide & CD Title	1
RS232 cable	1
PCI Bracket RS232 Cable	1

PCI Bracket
RS232 cable



Installing HDD in the Removable Tray Module

1. Demount the transport holder.
2. Mount the HDD into the tray.

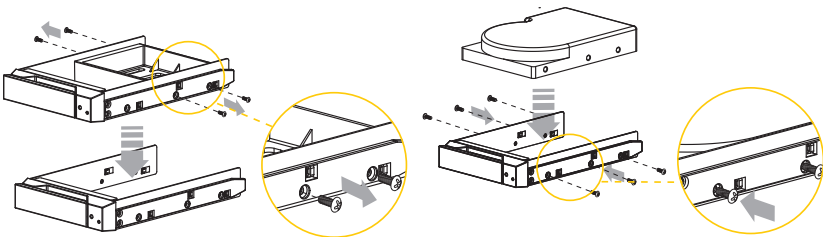

Note : It will cause hard disk push towards the backplane and the tray handle is unable to rotate once the screws do not properly fixed.

Hardware Installation

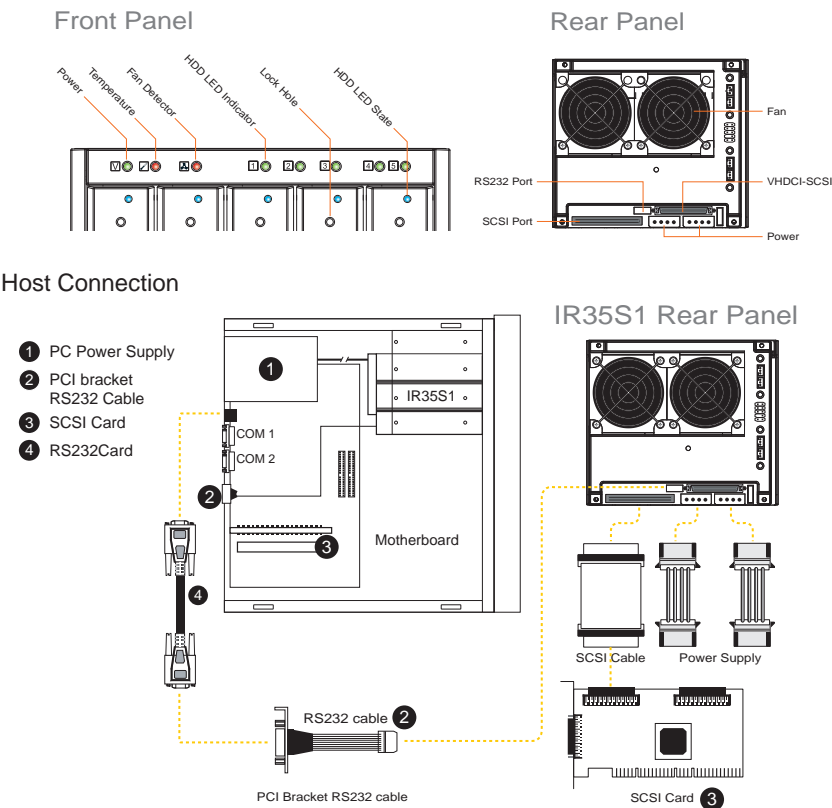

Quick Volume / RAID Setup

The serial port on the controller's back plane can be used in VT-100 mode. The RAID subsystem comes with 10-pin RS-232 serial port, which, using a null modem cable, can be connected to any COM port on a host computer for VT-100 terminal management purposes. It can also transfer to external for a VT-100 compatible terminal (or a PC running appropriate terminal emulation software). The firmware-based terminal array management interface can access the array through this RS-232 port.
Note : You may allow connecting a terminal while the RAID subsystem is at power on state.

To ensure proper communications between the RAID subsystem and the VT-100 Terminal Emulation. Please configure the VT-100 terminal emulation settings to the values shown below :

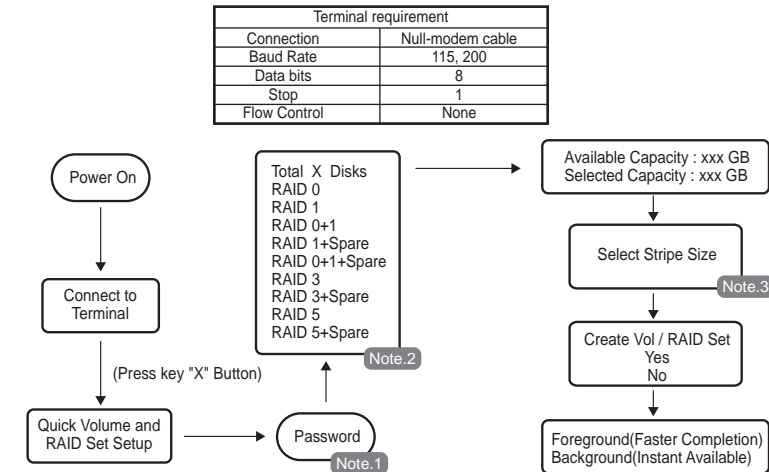

! IR35S1 did not set any default RAID level, hence, please set your desire RAID level after booth the device. Please be noted when you set the RAID level please make sure all hard disk inside the device is "Green" light.