

Gigaset

SL910-SL910A

Congratulations

By purchasing a Gigaset, you have chosen a brand that is fully committed to sustainability. This product's packaging is eco-friendly! To learn more, visit www.gigaset.com.



GIGASET. INSPIRING CONVERSATION.
MADE IN GERMANY

Pack contents



- 1 one Gigaset Base station
- 2 one power adapter for the base
- 3 one phone cord
- 4 one Gigaset handset
- 5 one batterie
- 6 one battery cover
- 7 one charger
- 8 one power adapter for the charger
- 9 one user guide plus one Quick start guide

Connecting the base station

- ▶ Insert the phone cable (cable slightly flattened) into the lower connection socket **1** at the rear of the base.
- ▶ Insert the power cable for the power adapter into the upper connection socket **2** at the rear of the base.
- ▶ Insert both cables into the appropriate cable channels **3**.

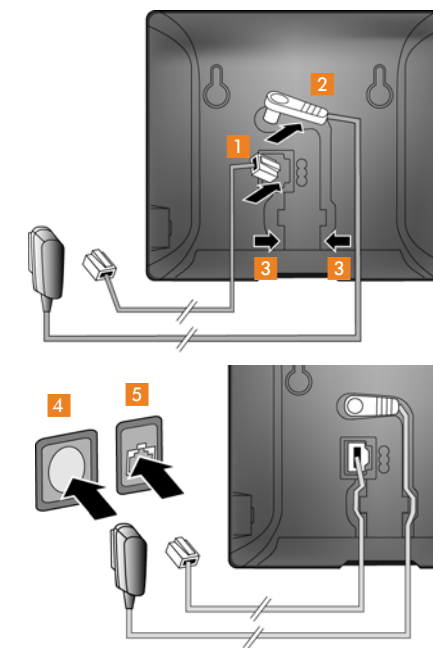

- ▶ **First**, connect the power adapter **4**.
- ▶ Then connect the phone jack **5**.

Please note:

- ▶ The power adapter must **always be connected**, as the phone will not operate without a power supply.
- ▶ Use only the power adapter and phone cord **supplied**. Pin connections on telephone cables can vary.

Connecting the handset charger

- ▶ Connect the flat plug on the power adapter **1**.
- ▶ Plug the power adapter into the plug socket **2**.

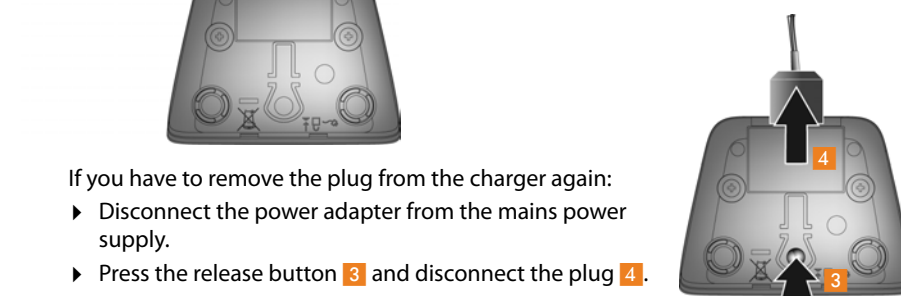

If you have to remove the plug from the charger again:

- ▶ Disconnect the power adapter from the mains power supply.
- ▶ Press the release button **3** and disconnect the plug **4**.

Preparing the handset

- ▶ First insert battery with the contact surface facing down **1**.
- ▶ Then press the battery downwards **2** until it clicks into place.

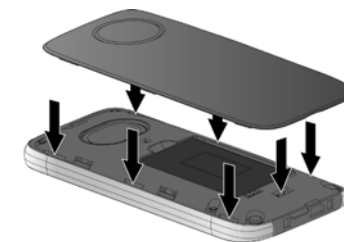

- ▶ First, align the protrusions on the side of the battery cover with the notches on the inside of the casing.
- ▶ Then press the cover until it clicks into place.

To **reopen the battery cover** to replace the battery:

- ▶ Insert your fingernail into the cavity on the bottom of the battery cover and pull the battery cover upwards.

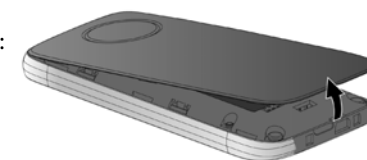

Charging the battery



The battery is supplied with a partial charge. Please charge it completely before use.

- ▶ Charge the handset in the charger for **5 hours**.

Please note

The handset must only be placed in the designated charger.

- ▶ Place your handset back in the charger after every call.

Version: 01-12-2011



A31008-M2300-L101-1-7643

Issued by
Gigaset Communications GmbH
Frankenstr. 2a
D-46395 Bocholt

© Gigaset Communications GmbH 2011
All rights reserved. Subject to availability.
Rights of modification reserved.
www.gigaset.com
This user guide is made from 100% recycled paper.

Setting up the base and handset

Once the battery has been inserted, the time and date symbols flash. The installation wizard starts automatically as soon as you touch one of the flashing symbols. You can configure the settings at a later stage by touching the [**Skip Settings**] option at the bottom of the display. The handset then switches to idle status.



- ▶ To configure the settings:
- ▶ Touch the **Skip Settings** icon next to the time to set the time.

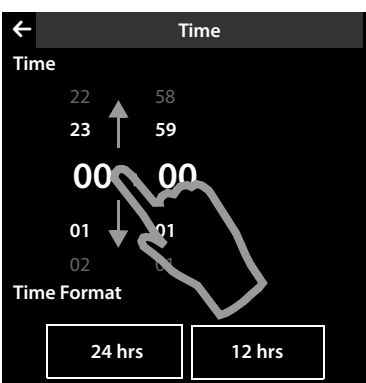

- ▶ Use the left-hand number wheel to select the current hour by touching the number wheel with a finger and moving it upwards or downwards.
- ▶ Operate the right-hand number wheel in the same way to select the minutes.
- ▶ Specify whether you wish the time to be displayed in **12 hrs** or **24 hrs** mode. To do this, touch the corresponding area under **Time Format**.
- ▶ The current setting is highlighted.
- ▶ Touch the **Skip Settings** icon (at the top left of the display) to return to the **Welcome** page.



- ▶ Touch the **Skip Settings** icon next to **Date** to set the date.



- ▶ Use the three number wheels to set the current date. The procedure is the same as for setting the time.
- ▶ The current mode for displaying the date is displayed under **Date Order** (here: **Day Month Year**). If you want to change the mode:
- ▶ Touch the **Skip Settings** icon.

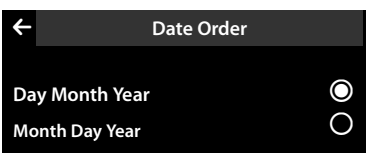

- ▶ Touch the required mode **Day Month Year / Month Day Year**.
- ▶ The selected mode is marked with **Skip Settings**.
- ▶ Touch the **Skip Settings** icon to return to the **Date** page.
- ▶ Touch the **Skip Settings** icon to return to the **Welcome** page.

Setting up the base and handset



The current language is displayed under **Display Language**.
If you want to change the setting:
▶ Touch the **Skip Settings** icon next to the language displayed.



This brings up a list containing all the available languages. The current language is marked with **Skip Settings**.
▶ Touch the required language.
If your language is not displayed, you must then scroll through the list.
▶ To do this, put a finger on the display and move it slowly upwards.



Enter the country under **Country** in which you will operate the phone and for which it is authorised. If the setting is not compatible:
▶ Touch the corresponding **Skip Settings** icon.
▶ Select the desired language as described before.
▶ Touch the **Skip Settings** icon to return to the **Welcome** page.

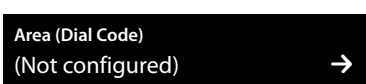

Finally, you have to enter your area code:
▶ Touch the corresponding **Skip Settings** icon.

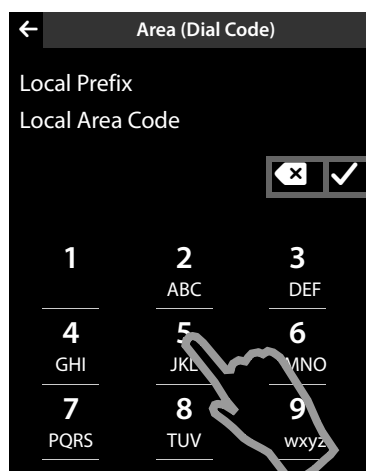

The **Local Prefix** refers to the country-specific prefix that is put in front of the area code when you do not dial the country code. In England this is "0". The **Local Area Code** is then 20 for London, for example.

The **Local Prefix** is only displayed if it is not already stored in the phone for the selected country.
▶ Use the keypad to enter the **Local Prefix** if required (maximum 4 characters) and the **Local Area Code** (maximum 8 characters). Before entering the numbers, briefly touch the field where the numbers should be entered. You can correct incorrect entries using **Skip Settings**.
▶ Touch **Skip Settings** after entering the numbers.

Setting up the base and handset

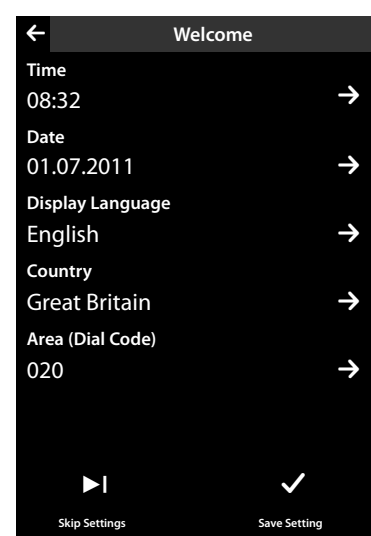

The **Welcome** page is displayed again.

- ▶ Touch the [**Save Setting**] option to save your settings.

The handset switches to idle status.

Handset in idle status (configurable page)

Once you have configured all the necessary settings, your handset switches to idle status. There are three idle display pages. When you first set up the phone, the **configurable page** that you can customise is displayed. Here, you can compile important functions and phone numbers for quick access. Some are set by default.

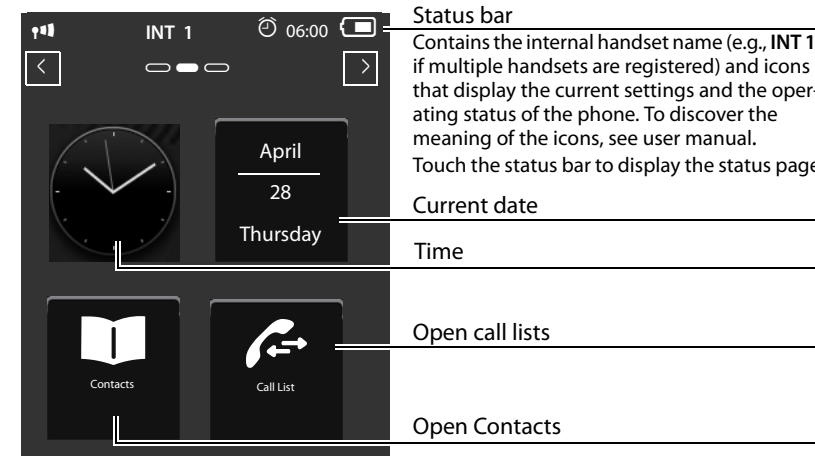

Your phone is now ready for use.

Frequently asked questions

Q: There is no dial tone.

A: Press call button for 2 seconds (long press) to obtain dial tone. A short press opens the redial list.

Q: The line is crackling / not clear.

A: Have you used the new line cable provided? Please do not use an old cable.

Q: The display is not clear / seems to be broken.

A: The display is protected by a plastic film, please make sure you have removed the protective film.

Q: The handset is not registered.

A: If your handset is not registered, please follow the Registration handset procedure. (see user manual)

Q: The caller ID is not working.

A: Have you subscribed to this service (CLIP) from your provider?

Q: Message indicator flashing and I cannot retrieve my message.

A: Message indicator will flash to indicate missed calls as well as new messages of text messages. (see user manual)

Please check:

- Have you used the phone cord supplied ☐
- Have you fully inserted the power cable into the base station ☐
- Have you inserted the batteries correctly ☐
- Have you charged the battery for 5 hours ☐
- Have you set up the Date/Time ☐

To download the latest manuals, visit our web-site: <http://www.gigaset.com>

You have questions? As a Gigaset customer, you can take advantage of our comprehensive service offerings. You can find help quickly in this User Manual and in the service pages of our Gigaset online portal: <http://www.gigaset.com>

If you have problems setting up or operation this product please call
GIGASET UK HELPLINE 0845 3670812
GIGASET IRL HELPLINE 1850 777277

Product may not be fully compatible with the national telephone network. It is clearly specified on the box near the CE mark as well as on the bottom of the base station for which country/countries the equipment has been developed. If the equipment is used in a manner inconsistent with this advice or with the instructions of the manual and on the product itself, this may have implications on the conditions for warranty or guarantee claims (repair or exchange of product). In order to make use of the warranty, the product purchaser is asked to submit a receipt which proves the date of purchase (date from which the warranty period starts) and the type of goods that have been purchased.

The handset at a glance (dial page)

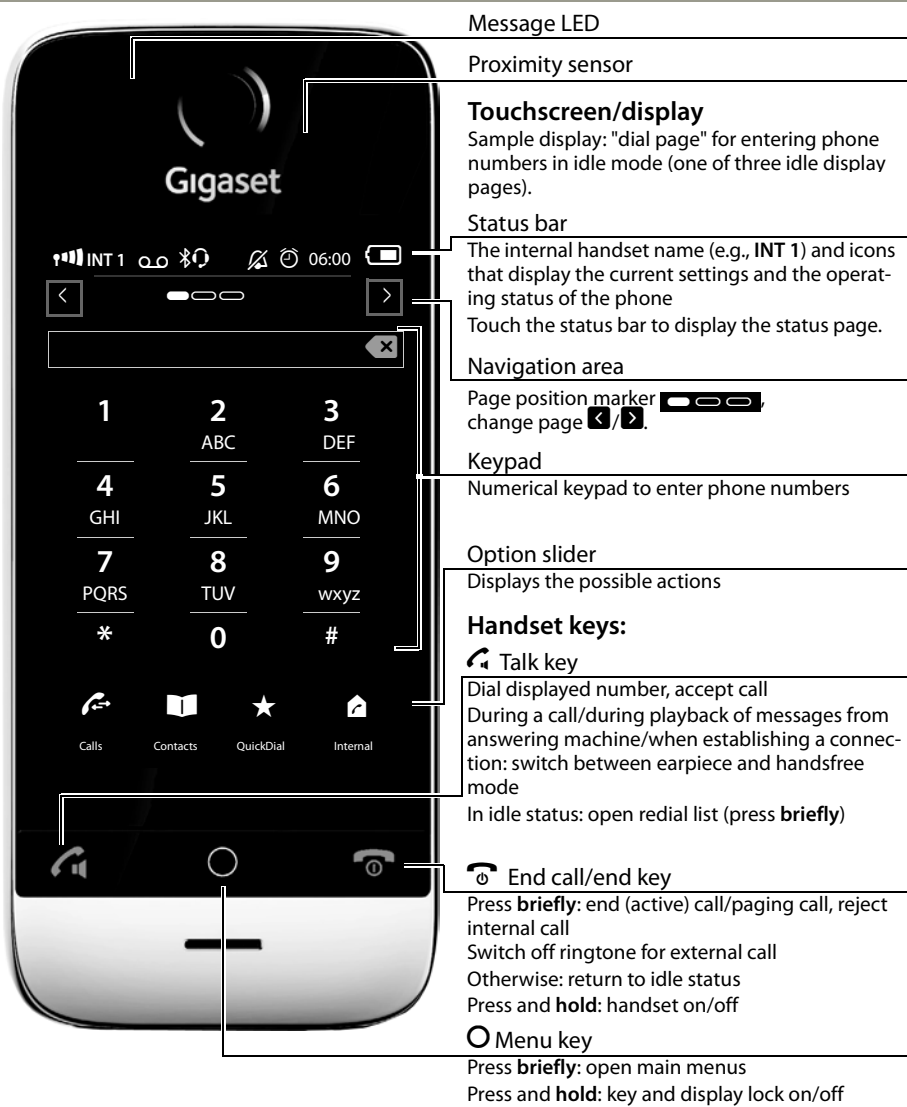

Underside of the handset:

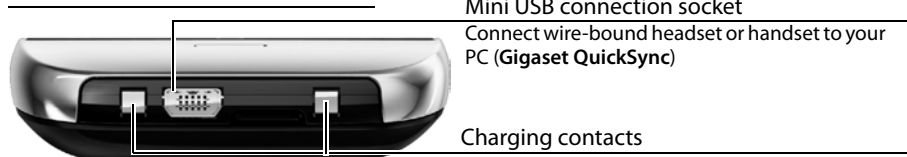

Using lists

Redial list

The redial list contains the twenty numbers last dialled with the handset (max. 32 digits). To dial using the redial list when the handset is in idle status:

- ▶ Press **briefly**. ▶ Touch an entry in the list.

Managing entries in the redial list

- ▶ Open redial list. ▶ Touch **next** to an entry. The detail view for this entry opens. You can:
 - Call: Press **briefly**.
 - Delete entry.
 - Save the number in Contacts.

Call lists

Your telephone stores various types of calls:

- ◆ Outgoing calls (📞) in the **Outgoing Calls** list
- ◆ Missed calls (📞) in the **Missed Calls** list
- ◆ Accepted calls (📞) and calls recorded by the answering machine (📞, Gigaset SL910 A only) in the **Accepted Calls** list

You can view each type of call separately or get an overview of all calls (**Call List**). Each call record contains the last 20 numbers in its category.

Opening lists from the menu

- ▶ In the **Applications** menu, touch [📞 **Call List**].
- The last call list displayed is opened. **All**, **Missed**, **Accepted** and **Outgoing** appear in the lower part of the display.
- ▶ Touch one of the areas to open the corresponding list.

List entry

New messages are displayed at the top. The following information is displayed in the list entries:

- ◆ List type (in header)
 - ◆ Icon for the type of entry
 - ◆ Caller's number. The name will appear on the display instead if you have saved the number in Contacts
 - ◆ Date/time of call (if set)
 - ◆ For missed calls, the number of missed calls from this number is shown in square brackets
- If the number is saved in Contacts, the number type and, if set, the number of the caller is also displayed. You have the following options:

- ▶ **Call back a caller**: Briefly touch the corresponding entry.
- ▶ **Open detail view**: Touch **next** to the entry. In the detail view, you can delete the entry or add the number of the entry to Contacts.

Missed appointments list

Missed (unacknowledged) appointments from the calendar and birthdays are saved in the **Reminders / Events** list under the following circumstances:

- ◆ You do not acknowledge the appointment/birthday reminder.
- ◆ The appointment/birthday was signalled during a phone call.
- ◆ The handset is deactivated at the time of the appointment/birthday.

You open the list via the message page in the idle display. If 20 entries are saved in the list, the oldest entry is deleted at the time of the next unacknowledged appointment reminder.

Deleting entries

When the handset is in idle status:

- ▶ Open the message page and touch **next** and [🗑 **Delete**] in sequence.
 - ▶ Touch all the entries to be deleted in sequence and then touch [🗑 **Delete**].
- To delete the entire contents of the list, see "Deleting lists"

Using the phone

Activating/deactivating the handset

- ▶ Press and **hold** the end call key **briefly** in idle status to deactivate the handset. You will hear a melody.
- ▶ Press and **hold** the end call key **briefly** again to reactivate the handset.

Operating the touchscreen

The Gigaset SL910H handset is primarily operated using the display and only to a small extent using the three buttons on the handset.

Icons, list entries, buttons and sliders shown on the display are sensitive areas. You can set up and activate functions, enter or dial phone numbers and navigate between the various display screens (pages) by touching these areas and dragging them across the display.

Selecting functions/list entries

To activate a function or select a list item (Contacts, submenu, call list), simply tap your finger on the corresponding icon or on the required list entry on the display.

Activating/deactivating functions

Functions, e.g., room monitor, are activated and deactivated via buttons.

If the button slider is to the right, the function is activated. The area to the left of the slider is highlighted (**on**).

If the button slider is to the left, the function is deactivated (**off**). The area to the right of the slider is black.

There are two ways to operate a button:

- ▶ Slowly drag the slider to the right or left to activate or deactivate the function.
- ▶ Touch the area to the right or left of the slider **briefly** and the slider moves to the right or left to the area that has been touched.

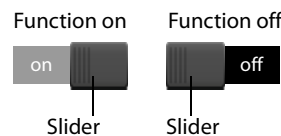

Making calls

Making an external call

- ▶ Open the dial page, enter the number, **briefly** press **briefly**.

Or:

- ▶ Press and hold the **briefly** key in idle mode, then enter the number.

You can cancel dialling by pressing **briefly**.

Accepting a call

You have the following options:

- ▶ Press **briefly**.
- ▶ Take the handset out of the charger, if **Auto Answer** is activated.
- ▶ Gigaset SL910A: Touch [📞 **Divert**] to divert the call to the answering machine.

For calling line identification

The number is shown on the display. If the number of the caller is stored in Contacts, additionally the name and number type of the Contacts entry is displayed.

No calling line identification

Instead of name and number, the following is displayed:

- ◆ **External**: No number is transferred.
- ◆ **Withheld**: Caller has withheld calling line identification.
- ◆ **Unavailable**: Caller has not requested calling line identification.

Using lists

Opening lists via the message page in the idle display

- ◆ Answering machine list (Gigaset SL910A only)
- ◆ Network mailbox (if your network provider supports this function and the number of the network mailbox has been stored.)
- ◆ Text Messages Inbox
- ◆ Missed calls list
- ◆ Missed appointments list

The list of missed calls is always displayed. The list of missed calls and the answering machine list (Gigaset SL910A) are always displayed. The icon for the network mailbox is always displayed, provided the number is stored in the telephone. The other lists are only displayed if they contain messages.

The icons have the following meanings:

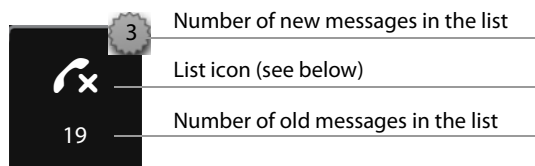

Deleting lists

You can delete the entire contents of the individual lists:

- ▶ In the **Settings** menu, touch [⚙ **System**]. ▶ (If necessary, scroll). ▶ Touch **next** to **Clean-up List**. ▶ Touch the symbol next to the list to be emptied. ▶ Press **Yes** to confirm.

Configuring the display of new messages

Specify whether receipt of new messages should be displayed on the handset.

- ▶ In the **Settings** menu, touch [📞 **Display and Keypad**]. ▶ (If necessary, scroll). ▶ Touch **next** to **Indication of New Messages**.
- ▶ Activate or deactivate the message display using the switch.

When message display is activated:

An advisory tone sounds as soon as a new entry arrives in a list. The message LED on the left next to the earpiece also flashes.

In idle status, the following message appears:

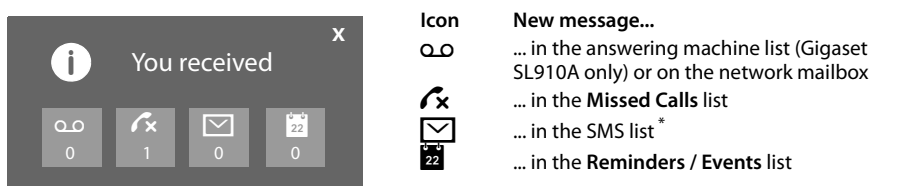

The number of new messages is displayed under the icons.

- ▶ **Open the list**: Touch the list icon.
- ▶ **Close the message**: Touch x (top right).

If you close the message without opening the list containing the new messages, the LED continues to flash.

For messages from the network answering machine, please refer to the user guide.

*Some of the functions are only available after you have carried out a firmware update for the base and for the handset.

Making calls

Handsfree mode

You can configure various profiles for handsfree operation.

- ▶ If you are going to let someone listen in, you should tell the other party that this is happening.

Activating while dialling

- ▶ Enter the number, press **briefly** twice.

Switching between earpiece and handsfree mode

During a call, when establishing the connection and when listening to the answering machine (Gigaset SL910A only):

- ▶ Press **briefly** or touch [📞 **Speaker**].

Switching to mute

Deactivate the handset's microphone during an external call. The other parties cannot hear you, but you can still hear the other party.

Switch to mute, cancel muting (activate/deactivate microphone):

- ▶ Touch [🔇 **Mute**].

Phone settings/applications

All the functions for the base and the handset are provided in a menu (main menu).

- ▶ Briefly press the middle key **briefly** when the handset is in idle status. The main menu is divided into two "pages". The **Applications** page comprises all the applications offered by your base or handset. The **Settings** page offers all the setting options for the base, handset and telephony.

The functions/applications contained in the menus depend on the firmware version.

- ▶ Touch the icon to open the menu of the appropriate setting/application.

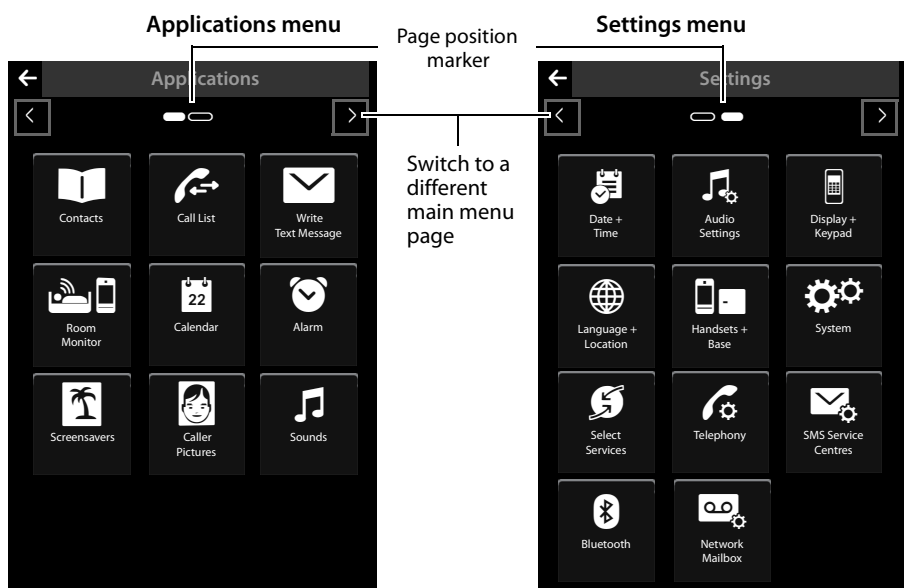

Answer machine (Gigaset SL910 A only)

Set the answering machine using the status page or the **Answer Machine** submenu:

- ▶ Open the **Settings** menu. ▶ [📞 **Answer Machine**] ▶ If necessary, scroll to the desired function.

Activating/deactivating the answering machine and setting the mode

- ▶ **Activation**: You activate/deactivate the answering machine with the button.

- ▶ **Mode**: The options are:

- **Announcement**: Caller hears announcement, can leave a message;
- **Advisory Message**: Caller hears announcement, cannot leave a message;
- **Time Control**: Activate **Announcement** mode for a fixed time of day, outside this time, **Advisory Message** is activated.

Touch the corresponding area (activated mode is highlighted).

In the case of **Time Control**, the following fields are displayed (time **must** be set):

- ▶ **Announcement from** / **Advisory Message from**: Touch corresponding **next** ▶ Specify the time when the appropriate mode should be activated.
- ▶ Go back with **back**.

If no personal announcements are available, the default announcements are used.

Recording, playing back, deleting announcements/advisory messages

Recording a new announcement deletes the announcement previously saved.

- ▶ Open the [📞 **Answer Machine**] submenu. ▶ If necessary, scroll to **Announcement** / **Advisory Message**. ▶ Touch the **next** to **Announcement** / **Advisory Message**.

Recording

- ▶ Touch [📞 **Record own**] / [📞 **Re-Record**]. ▶ Record the announcement after the ready tone (at least 3 seconds, up to a maximum of 180 seconds). ▶ Complete with [📞 **End**].

To cancel the recording: Press **briefly** or touch **back**.

Listening

- ▶ Touch [▶ **Play**]. You will hear the default announcement if you have not recorded one of your own.
- ▶ During playback, touch [📞 **New**] to re-record the announcement.

Deleting

- ▶ Touch [🗑 **Delete**]. ▶ Press **Yes** to confirm.

Playing back messages

You can open the answering machine list using the following icon on the message page:

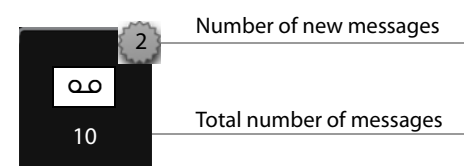

- ▶ Touch the icon to open the answering machine list.

Using Contacts

Opening Contacts (list of Contacts entries)

- ▶ In the **Applications** menu, touch [📞 **Contacts**] or touch [📞 **Contacts**] on the dial page or during a call.

Creating a new entry in Contacts

- ▶ Open Contacts. ▶ Touch [📞 **New Entry**].
- ▶ Touch the individual fields to enter the corresponding component of the entry. You can assign up to eight numbers to this entry.

You can save the components shown in the adjacent picture. If available, confirm with **next** or [✓ **Select**].

Defining default numbers

If you have entered several numbers, one of the options **next** (green) is displayed next to each number.

- ▶ Choose the default number for the entry by touching the corresponding option (**next** = default number)

The default number is the number automatically dialled when you touch the corresponding Contacts entry.

Saving a Contacts entry

- ▶ Touch [✓ **Save**].

Selecting a Contacts entry, navigating in Contacts

If your Contacts has too many entries to display all at once, an alphabetical index is shown on the right side. You have the following options:

- ◆ Scroll vertically to the name you are searching for.
- ◆ Touch the first letter in the index. The display jumps to the first name that begins with this letter. If necessary, scroll on to the desired entry.

Dialling with Contacts

- ▶ Open Contacts.

You have the following options:

- ▶ Press **briefly**. The default number of the entry marked with the green dot is dialled.

Or:

- ▶ Touch the name in the entry. The default number of the entry is dialled. Exception: If you have opened Contacts via the dial page, the phone number is transferred into the number field and can be expanded if required.

Or:

- ▶ Touch the **next** corresponding to the entry and touch the desired number in the detail view.

Managing Contacts entries

Viewing an entry (detail view)

- ▶ Open Contacts. ▶ Touch **next** to an entry.

Editing an entry

- ▶ Touch [✎ **Edit**].
- ▶ Touch the corresponding **next**. ▶ If necessary, touch the corresponding field. ▶ Delete name/number with **next**. ▶ If necessary, enter new name/new number. ▶ Confirm with **next**.
- ▶ Deleting the assignment of a caller picture, a VIP ringtone or a birthday: Touch **next** to the appropriate entry. ▶ Touch [🗑 **No Picture**], [🗑 **No Ringtone**] or [🗑 **No Birthday**].

Deleting an entry

- ▶ In the detail view, touch [🗑 **Delete**]. ▶ Press **Yes** to confirm.

Answer machine (Gigaset SL910 A only)

An entry in the list is displayed as follows (example):

1. Number or name and number type (if number is in Contacts).
 - Unavailable, if no number is available.
2. Message status:
 - 📞 (red): New message, date and time of receipt.
 - 📞 (white): Old message, date and time of receipt.

Playing new messages

- ▶ Touch [▶ **Play all new**].

Playing individual messages

- ▶ Touch an entry in the answering machine list. While listening, the **Call Info** is displayed. You have the following options:

- ◆ [🔊 **Volume**] ▶ Adjust the playback volume.
- ◆ [⏮ **5 sec.**] ▶ After playback of more than 5 seconds, the playback jumps back 5 seconds. After playback of less than 5 seconds, the playback jumps back to the start of the current message.
- ◆ [🗑 **Delete**] ▶ Delete message during playback.
- ◆ [📞 **Copy Number**] ▶ Copy number to Contacts.

Deleting all old messages

See "Deleting lists".

