

arcus[®]

USER'S MANUAL

incantare MediaServer



Version 10.2009

You can download the latest version of this manual from the arcus website at
www.arcus-HighEnd.de

*D*ear arcus customer,

The "arcus" brand is synonymous with technically well-devised and highly innovative products. arcus opens up new perspectives which need to be experienced at close hand. Thank you for purchasing our incantare Media Server. We are delighted by your trust in our products.

Your arcus team

CONTENTS

Section	Page	Section	Page
1. Safety Information	01	7. Remote Control	06
2. Legal Notice on Copyright	02	8. Get Started	09
3. Scope of Delivery	03	9. Trouble Shooting	10
4. Environmental Protection Information	03	10. Terms and Conditions of Guarantee	11
5. Operating Elements on the Front	04	11. Technical Data	12
6. Installation	04	12. Important Note	13
		13. Imprint	13

1. SAFETY INFORMATION



Electrical devices are not toys

Never let your children use electrical devices without supervision.

Cells/rechargeable batteries can endanger life when swallowed.

Therefore keep the device and batteries out of the reach of small children.

If a battery has been swallowed, medical assistance must be sought immediately.



Moisture and cleaning

The device must be set up and operated in dry rooms only. Attention – this product is not waterproof. Do not immerse the device in water and do not allow it to make contact with water. Water seeping into the device can cause serious damage. Do not use any cleaning products that contain alcohol, ammonia, benzene or abrasive products, as these products may damage the device. The mains plug must be pulled out before the device is cleaned. To clean, only use a soft, dry cloth to wipe the surfaces of the device.



Heat

Do not expose the device to direct sunlight. Take care to ensure that the device is not exposed to any direct sources of heat, such as heating or an open fire. Ensure that the ventilation slits on the device are not obstructed.

Additional safety instructions

- Do not allow any objects to fall onto, or any liquids to seep into the device.
- If this occurs, pull the mains plug out of the socket and have the device examined by a professional.
- Place the device horizontally on a stable, even surface.
- Take care to ensure that the device's cooling system is not impaired.
- Position the device so that the connections cannot be touched.
- When the device is exposed to low temperatures (during transportation, for example), it must only be switched on once it has reached room temperature and any condensation that may have formed has evaporated.

- The plug should be pulled out of the socket if the device is not in use for a while. Before operating the device again, ensure that there are no short-circuits at the connection points and that all connections are properly attached.
- The user should carry out no works on this device other than the measures described in this user's manual.
- Apart from the manual interventions described in the user's manual, no works of any kind must be performed on the device by the user. The device may only be opened by a qualified professional. Repairs and fuse changes must be carried out by a specialist repair shop.
- In the event of damage or if an irregular function is suspected, it is mandatory to pull out the plug immediately and have the device examined by a specialist repair shop.
- If you have sensitive furniture on which you wish to place the device, we recommend a neutral underlay in order to prevent potential colour staining by the device's feet.
- Always switch off the device using the standby switch on the front before cutting it off from the electrical supply by activating the mains switch (on the rear of the housing) or pulling out the plug.

2. LEGAL NOTICE ON COPYRIGHT

Intellectual property, including music, is subject to worldwide copyright protection.

It is legal in most countries to create copies of legally acquired recording media (e.g. CDs) or music files (e.g. from the Internet) for personal use.

It is prohibited to offer these copies commercially or to give them to a third party.

Caution when downloading MP3 files from the Internet: Please make sure that the files are properly licensed, i.e. that the provider also has rights to the respective titles.

If you are not the originator yourself or you have not been granted the appropriate rights of use by the originator or rights holder, you should note that if you infringe on this right, there is a risk that beneficial owners may take action against this possible criminal act and assert their rights.

3. SCOPE OF DELIVERY

When unpacking, check the system's completeness in terms of:

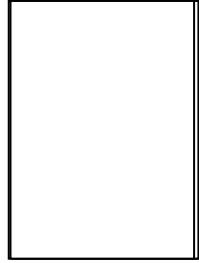

User's manual



Remote control (illustrated for demonstration purposes) and batteries



Mains cable

4. ENVIRONMENTAL PROTECTION INFORMATION

Professional recycling

Batteries and packaging materials have no place in domestic refuse. Batteries must be handed in at a collection point for used batteries. Conserve the environment by disposing of packaging material separately.



This product must not be disposed of via the normal household waste at the end of its useful life, but must be handed in at a collection point for the recycling of electrical and electronic devices. The symbol on the product, in the user's manual or on the packaging recalls this fact. The materials can be used again according to their description. By reusing, recycling materials or using spent devices in any other form you make an important contribution to protecting our environment. Please ask your local municipality for information on the relevant disposal point.



5. OPERATING ELEMENTS ON THE FRONT

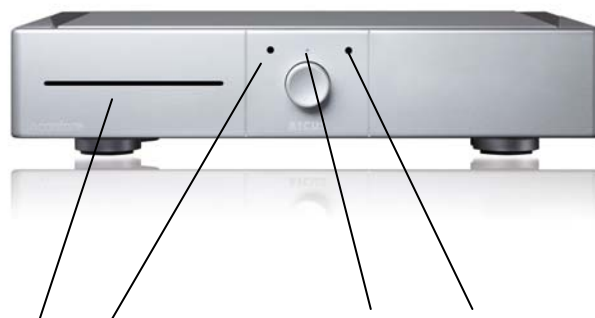

1 2 3 4

- | | |
|--------------|---|
| 1. CD Slot | Insert CD gently until it is pulled inside. Use Eject Key to eject. |
| 2. On/Off | Starts the unit, or switch offs the Unit (Standby) |
| 3. Blue LED | Indicates the unit is switched on |
| 4. Eject Key | Eject CD |

6. INSTALLATION

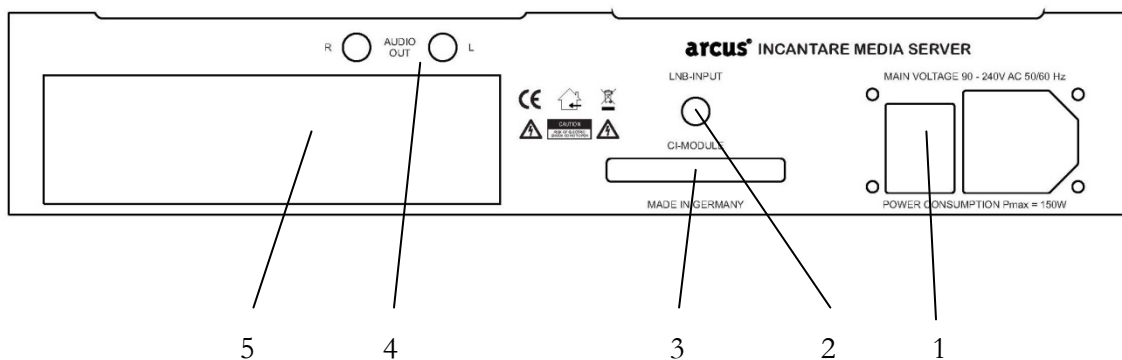

When connecting the MediaServer it is mandatory that you observe the following indications:



- Never open the housing of the power supply unit. Your **life is at risk** from electrocution when the housing is open. There are no components to be cleaned or repaired inside the device.
- Operate the device using only an earthed socket with **100-240V~/ 50-60 Hz** alternating current. Information about your power supply ratings can be obtained from your local electricity provider.

- Only use the **supplied** mains cable, or a derivative of identical construction.
- The **mains socket** should be located in the vicinity of the device and within reach of the mains cable.

AVOID a situation where you have to stretch the mains cable in order to reach the socket.

- Arrange the cable of the MediaServer so that it cannot be tripped over or trodden on.
- **Place no objects or furniture on the cable**, in order to avoid damage.

It is essential that you switch off the MediaServer along with the rest of your system at all times when working on the cabling!

1. **Power Supply Input Cord**

The mains cable is inserted here

2. **LNB-INPUT**

Connection for DVB-S

3. **CI-MODULE**

Possibility for a CI module to watch Pay TV

4. **Audio Out**

Assymetric pre-amplifier output. Connect this to an amplifier.

5. **Panel Connectors**

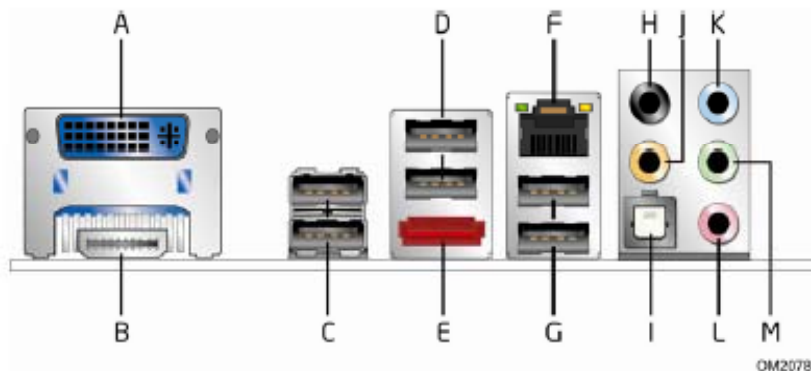

Item	Description
A	DVI-I output
B	HDMI port
C	USB ports [2]
D	USB ports [2]
E	eSATA port
F	LAN
G	USB ports [2]
H	Rear surround left/right channel audio out
I	S/PDIF Digital audio out (optical)
J	Center channel and LFE (subwoofer) audio out
K	Audio line in/side surround
L	Mic in
M	Audio line out

7. REMOTE CONTROL

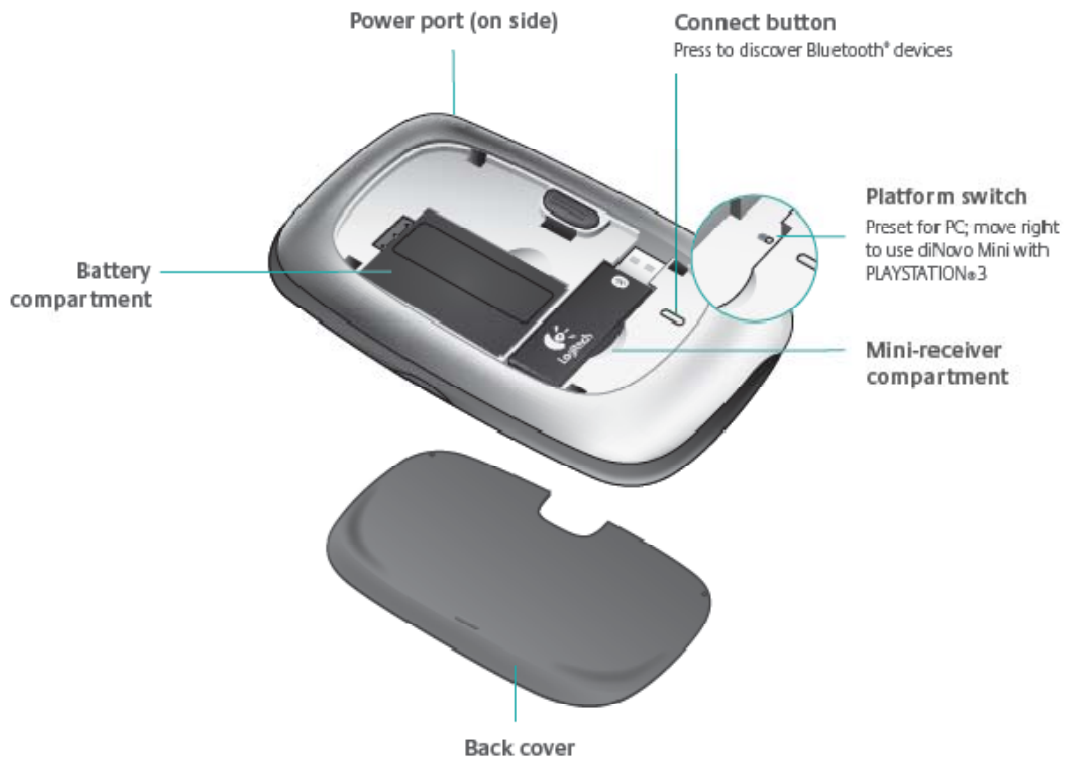
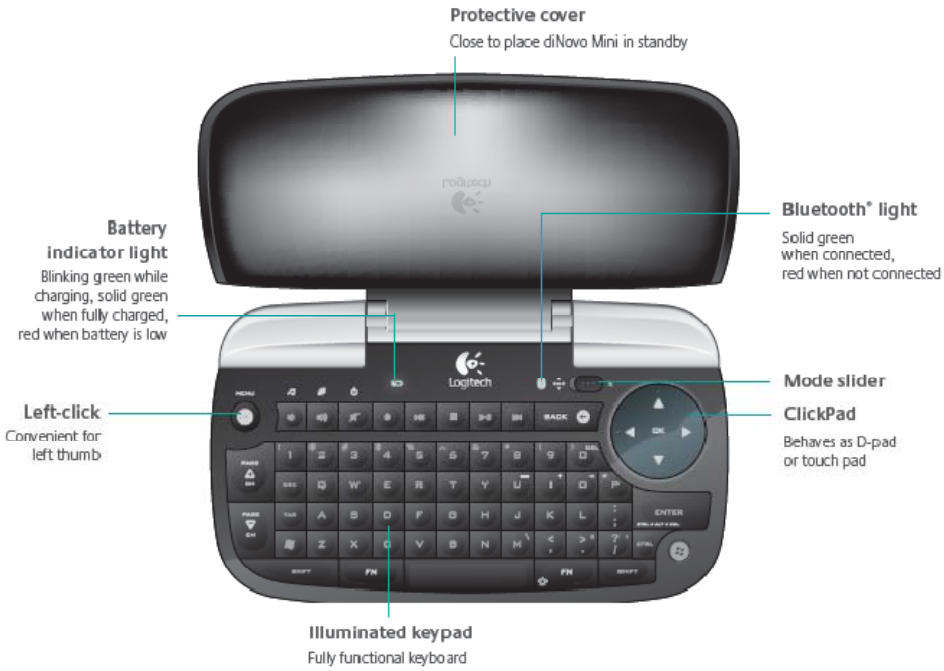

Insert battery

Open the back cover of the remote by sliding the tab up. Insert the lithium-ion battery as shown in the illustration. Replace the back cover



Connect the Power

Plug the AC cable into the power port on the side of the remote control. Plug the AC adapter into a wall socket to start charging the lithium-ion battery.

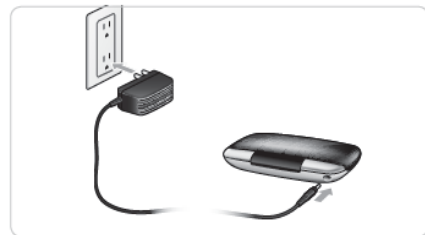

Connect mini-receiver

Plug the mini-receiver into a USB port on the rear side of the MediaServer

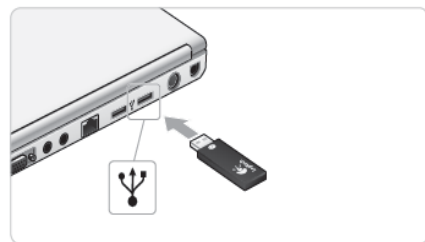

Changing modes

The remote control offers two operating modes, a media remote for navigating the Windows media center and a cursor mode for familiar keyboard and touch pad functions.

Switch between modes by moving the mode slider at the top of the keypad. Move the slider to the left place the remote control in media remote mode. Move the slider to the right for cursor mode.



Controls in media remote mode

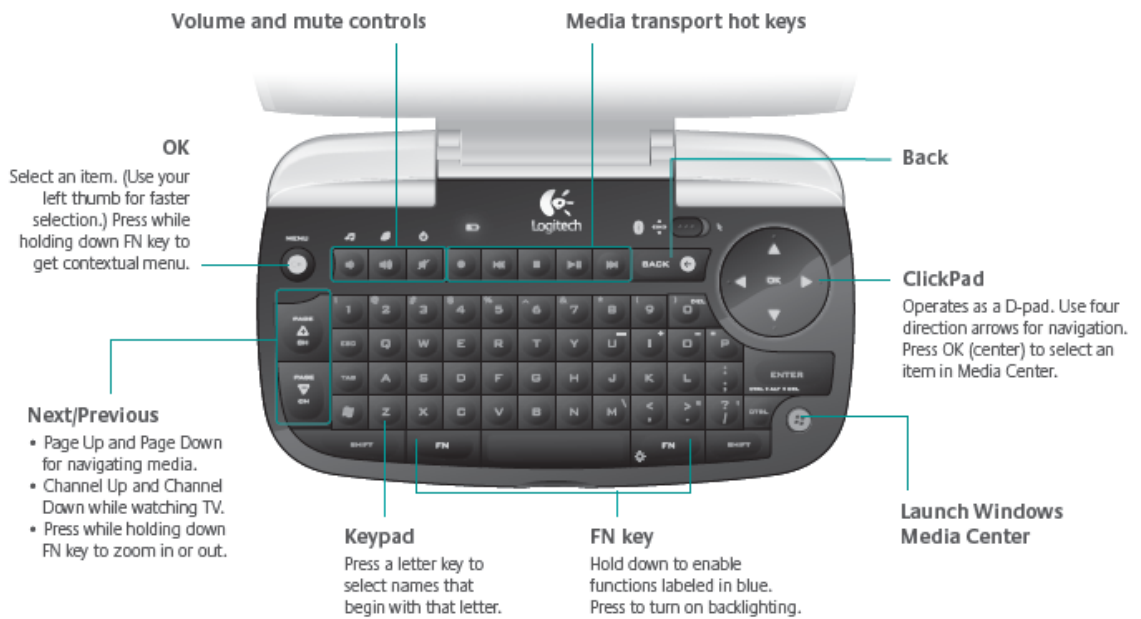

Controls in cursor mode

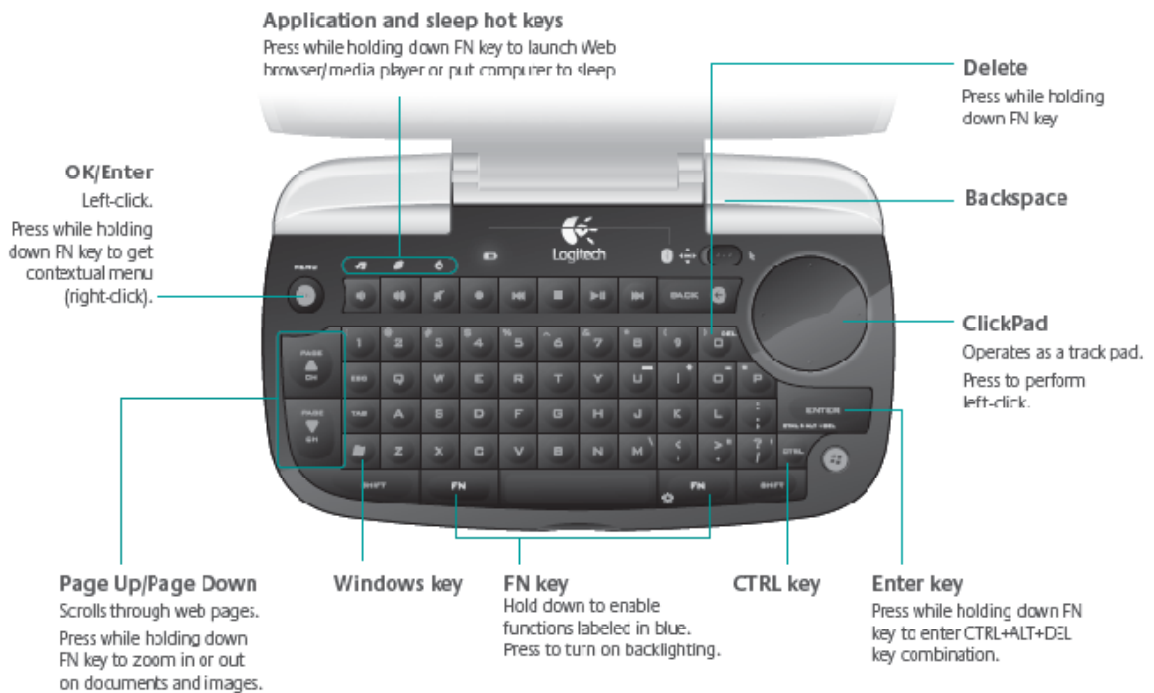

8. GET STARTED

First steps:

Once all devices have been properly connected to the MediaServer, plug in the mains cable on the rear of the device and press the “On/Off” button on the front of the device.

The first time the unit will need about one minute to start all operating systems.

After you see the arcus logo on your screen you can start the setup.



Press the “Launch Windows Media Center” button on the remote control



CUSTOMIZE WINDOWS MEDIA CENTER

When you first start Windows Media Center, you can choose:

- * Express setup to get started right away.
- * Custom setup to learn more about all the possibilities with Windows Media Center.

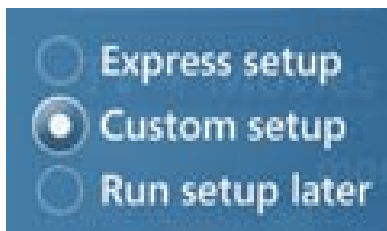

CUSTOM SETUP

Select Custom setup.

When you reach “Get the Most from Windows Media Center”, select Yes to be able to download album cover art, DVD cover art, current TV guide listings, information from online media services, and more.

Follow the OSD Menue step by step and finish the installation.

Now your system is ready to use.

9. TROUBLESHOOTING

Reset system

In rare cases, the unit may not function as normal.

Press the On/Off button for 5 seconds and the system will reset, or pull out the mains plug, wait at least three minutes and then re-insert it in the socket.

Problem:

The device is not working, even though the mains plug is plugged in.

Cause:

No mains supply.

Solution:

Make sure that the mains plug is correctly inserted in the socket.

Check whether the socket is conducting electricity.

Problem:

Device does not react to commands from the remote control

Cause:

Batteries are too weak. Infrared sensor on the amplifier is obstructed

Solution:

Change batteries in the remote control.

Remove object that is blocking the sensor.

10. TERMS AND CONDITIONS OF GUARANTEE

arcus GmbH guarantees to the purchaser of this product that, under normal operating conditions, the product is free from material and processing defects. When claiming under the guarantee it is mandatory that the customer present the following documents and provide the following information.

- 1. The original purchase receipt showing date of purchase, name, address, serial number and model number of the product.**
- 2. A detailed description of the defect.**

Note:

A malfunction in the device does not automatically mean a defect.

Before sending in the device contact our service hotline on + 49 (0)700 60 77 77 77 or send us a brief fault description via e-mail: info@arcus-HighEnd.de .

In order to be able to claim our optimal guarantee and service performance, you have the option of registering. You will then also receive automatic updates on developments in your product and other products.

All arcus products are subject to a full quality inspection before leaving the factory. However, should manufacturing and/or material defects emerge during normal use, we provide a 2-year guarantee on our products.

You can extend your guarantee for electronic components to 3 years, and for loudspeakers to 5 years, by sending in the guarantee card and/or registering on our website www.arcus-HighEnd.de.

The guarantee period commences from date of purchase. The guarantee extension applies only for registered first-time buyers, and purchase must have taken place at an authorized arcus dealer.

The guarantee will become invalid if a repair is carried out by a person or repair shop that is not authorized by arcus, or if the serial number is changed, removed or made illegible. Cases which do not fall under the guarantee: transport damage, and damage arising as a result of improper use or installation. There will be no extension of the guarantee period as a result of a performance under guarantee, and also not in the event of repaired or replaced parts. The provisions of the German product liability law and of comparable foreign regulations remain, insofar as they are indispensable, unaffected. We reserve the right to perform technical modifications for the purpose of advancement.

arcus incantare: MediaServer – technical data sheet

MediaServer	
Frequency response	2 Hz - 20 kHz
Distortion factor	< 0.002 %
Channel separation	> 110 dB
Signal-to-noise	> 110 dB
Audio inputs analogue	1 x stereo cinch
Analoge Audio-Ausgänge	High definition 7.1 multichannel, 1 x stereo cinch
Audio outputs analogue	SPDIF toslink, 24 Bit, 196 kHz
Video outputs	HDMI 1.3, DVI-I
Weight	20 kg
Dimensions incl. feets	44 x 10 x 37 cm
Power supply	110 / 230 Volt; 50 - 60 Hz
Optional extras	Extern memory up to 4 TB
Disc drive	Selectet high end slot in drive
Used memory	audio/video formatted memory with damped suspension
Memory size	1 TB, 4 GB RAM
Backup function	Yes
Cooling	Heatpipe System without fan
Networking wired	Ethernet 10/100/1000 m/bits
Networking wireless	By USB-stick
Encryption	Folowing Rules
Other ports	6 x USB 2.0
Finishes	Titan silver, black, white
Mechanical construction	Resonance optimized full metal housing, shielded board, vibration decoupled, stream optimized
Technology platform	Microsoft Windows Vista Ultimate Certified for Dolby Home Theater, Microsoft Windows Vista Premium WHQL
Processor	Intel Core 2 Duo E8500, 3,16 GHz
Audio resolution	24 Bit - 196 kHz
Video resolution	1080p Full HD, 2048 x 1536 mit 75 Hz frequence (QXGA) for digital and analog screens, HDCP Version 1.1 support
Supported media	BD-RE/R (SL), BD-RE/-R (DL), BD-ROM (SL/DL), DVD Multi Read/Write support, CD-R/-RW-ROM
Audio support	MP3 (32 kBit/s - 320 kBit/s), WAV, WMA, Audio CDs
Video support	MPEG-2, VOB, ASK, M1V, M2V, WMV, DAT, VOR, DVR-MS, H.264, MP2, MOV, DV AVI, VC1, TS, TRP, TP, M2TS, RM, DivX AVI
Supportet formats	TCP/IP, UPnP AV, DHCP, AutoIP
Supported data systems	FAT, FAT32, NTFS
Country of production/manufacture	Developed and engineered in Germany

Errors excepted. arcus has the right to change technical details without any advance notice.

12. IMPORTANT NOTE

We receive many enquiries concerning loudspeakers or playback devices recommended by us for our products. We therefore think you will be interested in reading our views on this.

arcus products are NOT developed in order to function / resonate only with specific loudspeakers or playback devices. arcus products are developed in order to play the music signal naturally. As long as your loudspeakers / playback devices follow the same principle, you will enjoy an outstanding sound experience at all times.

13. IMPRINT

Published by

arcus GmbH

Phone: +49 (0) 700 / 60 77 77 77 • Fax: +49 (0) 700 / 61 77 77 77

E-mail: info@arcus-HighEnd.de • [http:// www.arcus-HighEnd.de](http://www.arcus-HighEnd.de)

Errors and omissions reserved.

arcus reserves the right to modify technical details without prior notice.

arcus and the arcus logos are registered trademarks of arcus GmbH

Reproduction, in whole or in part, only with the permission of arcus GmbH