

Door Camera - VDT591 User Manual

Parts and functions

The 591 is a special design for the 2-wire system:

- Full metal cover with backlight nameplate
- 4 Door cameras connection
- Directly connect 2 separate electronic locks, unlock time controlled by Monitor

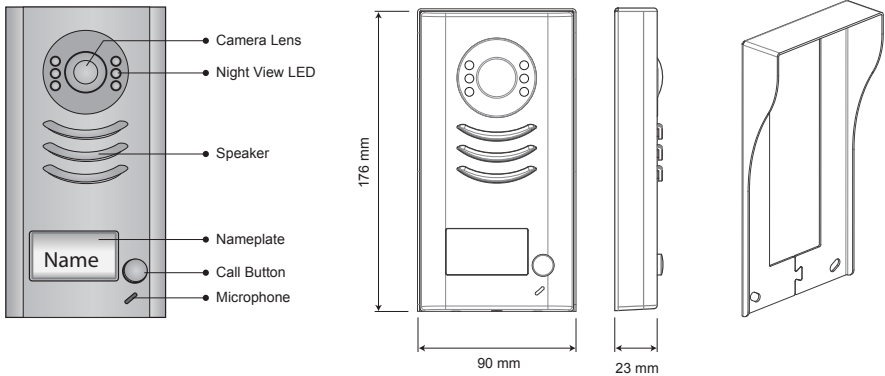

Terminal Descriptions

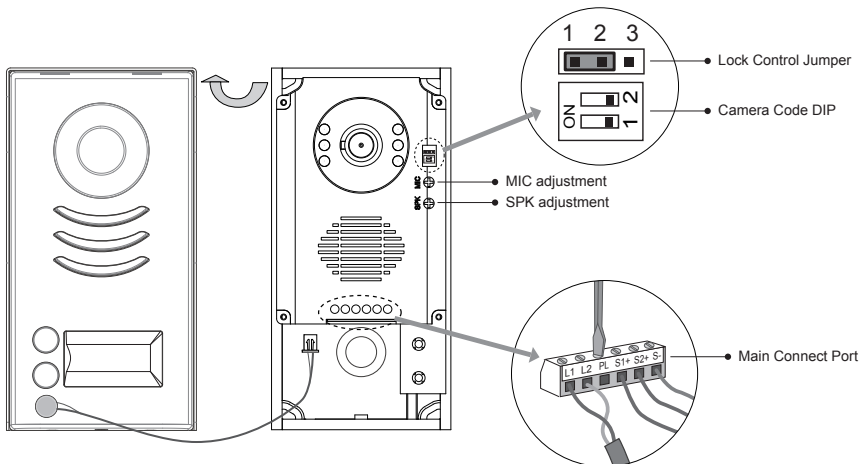

- **Lock Control Jumper:** To configure the electronic lock safety type; set the jumper in 1-2 position for Power-to-Unlock type(pulse activated electronic lock), set the jumper in 2-3 position for the Power-Off-to-Unlock type(electromagnetic lock). Remove the jumper if using external power supply for the lock.(the power+ will be connected to the PL on the Main Connect Port)
- **Camera Code DIP:** To set the code for the door camera, total 4 cameras can be connected in the system; set to 00 for the master camera, set to 10 for the slave 2nd camera, set to 01 for the slave 3rd camera, set to 11 for the slave 4th camera. Set to 00 if there is only one door camera used in the system.
- **Main Connect Port:** To connect the bus line and the electronic locks.
- L1, L2: Connect to the bus line, no polarity.
- PL: External lock power input, connect to the power positive(power +).
- S1+, S2+: Lock power(+) output, to connect 2 electronic locks.
- S-: Lock power(-) output, connect to the power(-) input of electronic locks(only when using the camera to power the locks, if using the external power supply for the locks, the S- will not be connected)

Inner Power 1 Lock Connection

The standard inner power lock connection, use the Camera power to supply the lock, no need for external power supply. In this way, the Lock Control Jumper and Unlock Mode in the monitor need to be set: for Power-to-Unlock type electronic lock, set to position 1-2 and Unlock Mode 0(in Monitor, goto Main--> Setup--> Advanced Set--> Information page, then press and hold the Unlock Button for 2 seconds to open the Unlock Mode setting page); for Power-Off-to-Unlock type electromagnetic lock, set to position 2-3 and Unlock Mode 1.

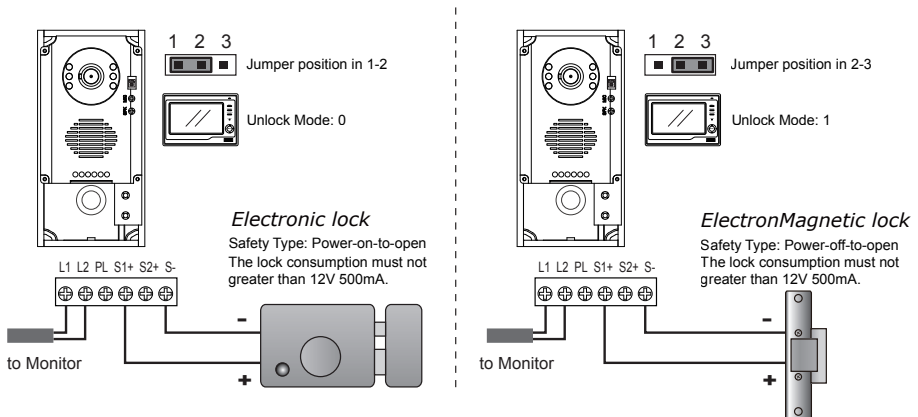

Inner Power 2 Locks Connection

Directly connect 2 electronic locks to the door station and use the Camera power to supply the locks. There are 2 separate unlock icons on Monitor for opening each lock. Note that the 2 locks should be the same safety type.

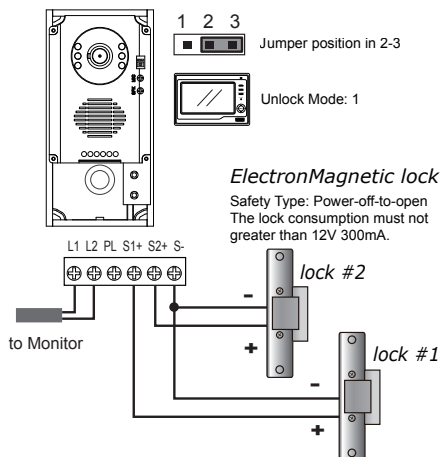
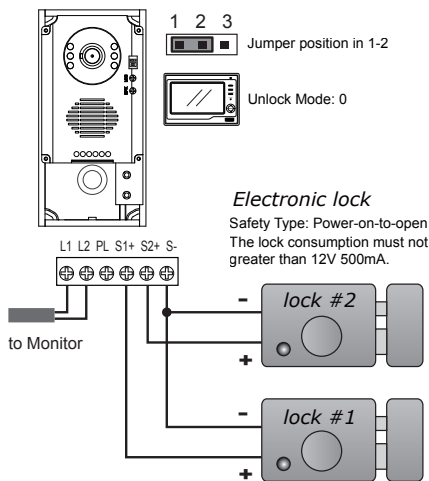

External Power Connection

Use external power supply to power the electrical locks, in this way, wide range lock from 5V to 48 V electronic locks can be used in the system. Note that in this case, the Lock Control Jumper is removed in both lock type.

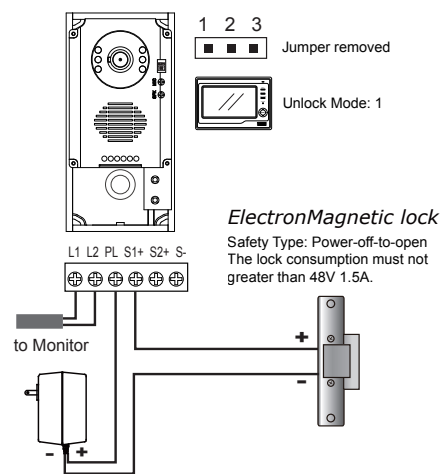
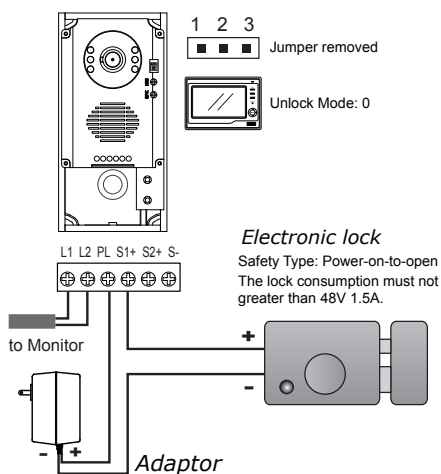

Mounting Without Rain Cover

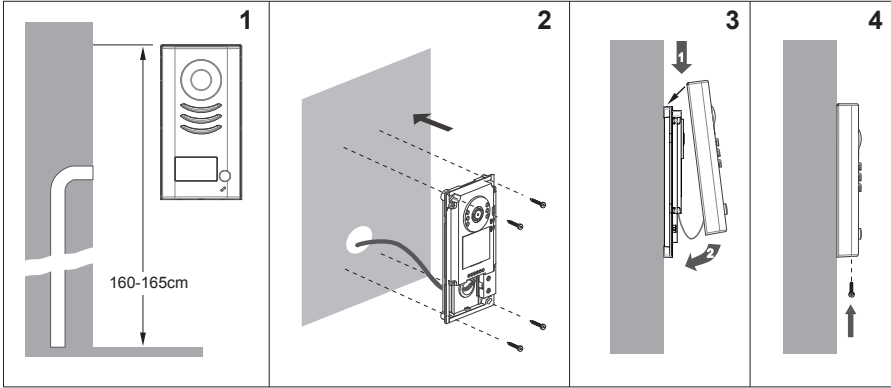

Mounting With Rain Cover

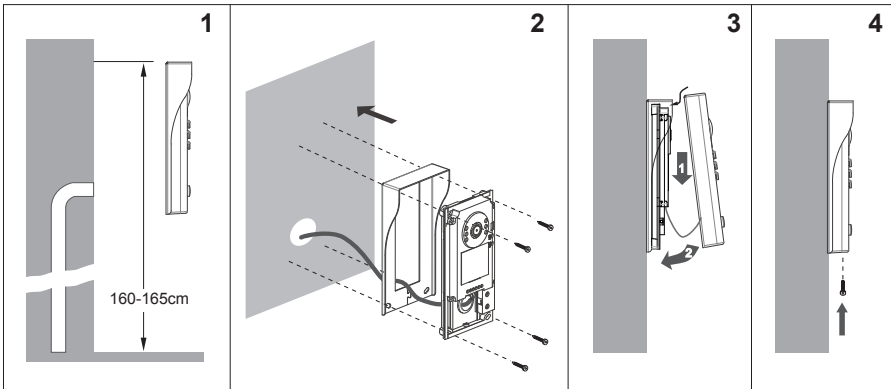

Electronic Specifications

Lock Power supply:	12Vdc, 500mA(supplied by system)
Power Consumption:	1W in standby, 12W in working
Video signal:	1V _{p-p} 75ohm CCIR
NO, COM exchange contact:	Max. 48V dc 1.5A
Unlocking time:	1 to 9 seconds, set by Monitor
Working temperature:	-5°C +45°C