

FLEXLITE

OPERATOR'S MANUAL LED WORKLIGHT FLX3M FLX3C FLX3SA



Your worklight has been engineered and manufactured to our high standard for dependability, ease of operation, and operator safety. When properly cared for, it will give you years of rugged, trouble-free performance.



WARNING:

To reduce the risk of injury, the user must read and understand the operator's manual before using this product.

Thank you for buying a FLEXLITE product.

SAVE THIS MANUAL FOR FUTURE REFERENCE

Patent pending



Printed and made in Canada

GENERAL SAFETY RULES



WARNING!

READ AND UNDERSTAND ALL INSTRUCTIONS.

Failure to follow all instructions listed below may result in electric shock, fire and/or serious personal injury.

SAVE THESE INSTRUCTIONS

WORK AREA

- **Keep your work area clean and well lit.** Cluttered benches and dark areas invite accidents.
- **Working temperature.** If used over 40°C (104°F) an automatic cut-off will turn the light off until the temperature of the light head comes down. Depending on if the work area is closed, with or without a fresh air draft, the cut-off temperature can be affected.
- FLEXLITE is designed to be used in an industrial environment in rain, snow and dust, but FLEXLITE products can not be immersed in water. If the working area is moist and dusty, some particles will stick on heatsink and reduce the performance. See maintenance section to remove any dirt.
- Don't operate FLEXLITE in sunshine or near to other heat sources.
- The power supply should be protected with an optional sealed case. It can't be used outside or in rain, moisture, snow, ...



DANGER!

Never connect / disconnect or use an external power supply or charger in a hazardous area.



DANGER!

Never connect or disconnect the connector on the lighthouse or any extension cord when the power is on.

SERVICE

- **Worklight service must be performed only by qualified repair personnel.** Service or maintenance performed by unqualified personnel may result in a risk of injury.
- **When servicing a worklight, use only identical replacement parts. Follow instructions in the Maintenance section of this manual.** Use of unauthorized parts or failure to follow Maintenance Instructions may create a risk of shock or injury.

STORAGE TEMPERATURE

- Store worklight at room temperature between -35°C and 35°C (-31°F and 95°F) for best results.
 - When transporting or temporarily storing in a vehicle, temperature range should be between -35°C(-31°F) and 66°C(151°F).
- **Storing worklight at temperatures greater than 76°C (169°F) for extended periods of time (more than 2 hours) may cause damage to worklight and possible fire.**



DANGER!

Don't use the power supply outside without protection cabinet IP66.

SPECIFIC SAFETY RULES

- **Know your worklight. Read operator's manual carefully. Learn its applications and limitations, as well as the specific potential hazards related to this worklight.** Following this rule will reduce the risk of electric shock, fire, or serious injury.
- **Lens and housing become hot during use:**
 - During or immediately after use, don't lay worklight flat on lens surface or place lens area in contact with a plastic or fabric covered surface.
 - Handle worklight with care around any flammable surface.
 - Do not use or permit use of worklight in bed or sleeping bags. This worklight lens can melt fabric and a burn injury could result.
- **Do not disassemble your worklight.**
- **Do not permit children to use worklight unsupervised.** It is not a toy. The temperature of the light head will become hot after being on for only a short period of time. This hot temperature can cause burn injury if touched and can create sufficient heat to melt some fabrics.
- **Stay alert.** Watch what you are doing and use common sense. Do not rush.
- **If wrapped or in contact with fabrics, the worklight lens can produce sufficient heat to melt some fabrics.** To avoid serious personal injury, never allow the worklight lens to come in contact with anything.
- **Check damaged parts.** Before further use of this worklight, a part that is damaged should be carefully checked to determine that it will operate properly and perform its intended function. Do not use worklight if it does not function properly.
- **Do not abuse the cord.** Never use the cord to carry the FLEXLITE. Do not pull the cord rather than the plug when disconnecting from receptacle. Damage to the cord could occur and create an electric shock hazard. Replace damaged cords immediately.
- **Make sure the cord is located so that it will not be stepped on, tripped over, come in contact with sharp edges or moving parts or otherwise subjected to damage or stress.** This will reduce the risk of accidental falls, which could cause injury, and damage to the cord, which could result in electric shock.
- **Keep the cord from heat to prevent damage to housing or internal parts.**
- **Do not let gasoline, oils, petroleum-based products, etc. come in contact with plastic parts.** They contain chemicals that can damage, weaken, or destroy plastic.
- **An extension cord should not be used unless absolutely necessary.** Use of an improper extension cord could result in a risk of fire and electric shock. If extension cord must be used, make sure:
 - That extension cord is properly wired and in good electrical condition; and
 - That wire size is large enough for AC ampere rating of FLEXLITE as specified below:

Cord Length (Feet)	25'	50'	100'
Cord Size (AWG)	16	16	16

NOTE: AWG = American Wire Gauge



WARNING!

LED LIGHT

Do not stare into the beam or view directly with or without optical instruments.







WARNING!

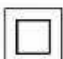

Do not project the light toward a road, another person or any vehicle to prevent blindness. Doing so, may result in serious injuries or death.

SYMBOLS

Some of the following symbols may be used on this worklight. Please study them and learn their meaning. Proper interpretation of these symbols will allow you to operate the worklight better and more safely.

SYMBOL	NAME	DESIGNATION/EXPLANATION
V	Volts	Voltage
A	Amperes	Current
Hz	Hertz	Frequency (cycles per second)
W	Watt	Power
min	Minutes	Time
	Alternating Current	Type of current
	Direct Current	Type or a characteristic of current
	Class II Construction	Double-insulated construction
	Safety Alert	Precautions that involve your safety.

The following signal words and meanings are intended to explain the levels of risk associated with this product.

SYMBOL	SIGNAL	MEANING
	DANGER :	Indicates an imminently hazardous situation, which, if not avoided, will result in death or serious injury.
	WARNING :	Indicates a potentially hazardous situation, which, if not avoided, could result in death or serious injury.
	CAUTION :	Indicates a potentially hazardous situation, which, if not avoided, may result in minor or moderate injury.
	CAUTION :	(Without Safety Alert Symbol) Indicates a situation that may result in property damage.

SERVICE

Servicing requires extreme care and knowledge and should be performed only by a qualified service technician. For service we suggest you return the product to your nearest **AUTHORIZED SERVICE CENTER** for repair. When servicing, use only identical replacement parts.



WARNING:

To avoid serious personal injury, do not attempt to use this product until you have thoroughly read and completely understood the operator's manual. Save this operator's manual and review frequently for continuing safe operation and instructing others who may use this product.

SAVE THESE INSTRUCTIONS

FEATURES FLX3M / FLX3C / FLX3SA

PRODUCT SPECIFICATIONS

Electric :

- Input voltage : 100 – 240 VAC 50-60Hz desktop transformer
- Consumption : 1.52 mA @ 14.7V
- Lumen : 1755 lumen
- Cable length : 6 feet - optional 20 feet cord
- Efficacy : 93% @ 12 VDCin
- Color temperature : 5000°K

Mecanic :

	FLX3M	FLX3C	FLX3SA
LENGTH :	27.5 inches	30 inches	Closed : 41 inches Upright : 96 inches
WEIGHT :	2.9 lbs	2.4 lbs	8.3 lbs

IMPORTANT: The FLEXLITE is designed to be connected to specific voltage. Any other voltage can permanently damage the unit.

ASSEMBLY

UNPACKING

This product has been shipped completely assembled.

- Carefully remove the worklight and any accessories from the box. Make sure that all items listed in the packing list are included.
- Inspect the worklight carefully to make sure no breakage or damage occurred during shipping.
- Do not discard the packing material until you have carefully inspected and satisfactorily operated the worklight.
- If any parts are damaged or missing, please call 1-866-854-1411 for assistance.

PACKING LIST

Worklight
Operator's Manual



WARNING:

If any parts are missing do not operate this worklight until the missing parts are replaced. Failure to do so could result in possible serious personal injury.



WARNING:

Do not attempt to modify this worklight or create accessories not recommended for use with this worklight. Any such alteration or modification is misuse and could result in a hazardous condition leading to possible serious personal injury.

OPERATION

Use « Touch Pad » switch in front of the lighthouse :

TO TURN WORKLIGHT ON: *Push and hold 2 seconds.*

DIM FROM 100% TO 50%: *Push quickly once.*

DIM FROM 50% TO 25%: *Push quickly another time.*

FLASHING MODE: *Push quickly another time.*

TURN OFF: *Push and hold 2 seconds at anytime.*

Installation suggestion:

FLX3M and **FLX3C** come with a sticky pad to increase the performance of the magnet or c-clamp. Remove protection before finally installing your FLEXLITE.

SAFETY ADVICE

- If the light head becomes too hot, an integrated electronic device will turn down the light power to 25% of efficiency on blinking mode. If the temperature still increases, the device will cut off the light automatically. Verify if the heatsink is clean. If the problem persists, return the worklight to an authorized service center.
- When the battery becomes discharged, the light head will automatically turn down the light power to 25% of efficiency to allow to the user several minutes to leave the dark area.

MAINTENANCE



WARNING:

When servicing use only identical **FLEXLITE** replacement parts. Use of any other parts may create a hazard or cause product damage.



WARNING:

Always wear safety goggles or safety glasses with side shields when using compressed air to clean worklights. If operation is dusty, also wear a dust mask.

GENERAL MAINTENANCE

Avoid using solvents when cleaning plastic parts. Most plastics are susceptible to damage from various types of commercial solvents and may be damaged by their use. Use clean cloths to remove dirt, dust, oil, grease, etc.



WARNING:

Do not at any time let brake fluids, gasoline, petroleum-based products, penetrating oils, etc., come in contact with plastic parts. Chemicals can damage, weaken or destroy plastic which may result in serious personal injury.

FAN AND /OR HEATSINK MAINTENANCE

- The FLX3M / FLX3C / FLX3SA model is made with an integrated cooling fan. Designed to resist rain and dust. This fan and air flow heatsink must be cleaned frequently to perform well. Use only a **low air pressure** gun to clean and remove any dust. Don't use solvent, soap or cleaner. The unit is clean when you can see across the heatsink.



WARNING:

Do not immerse in water.

KNOW YOUR WORKLIGHT

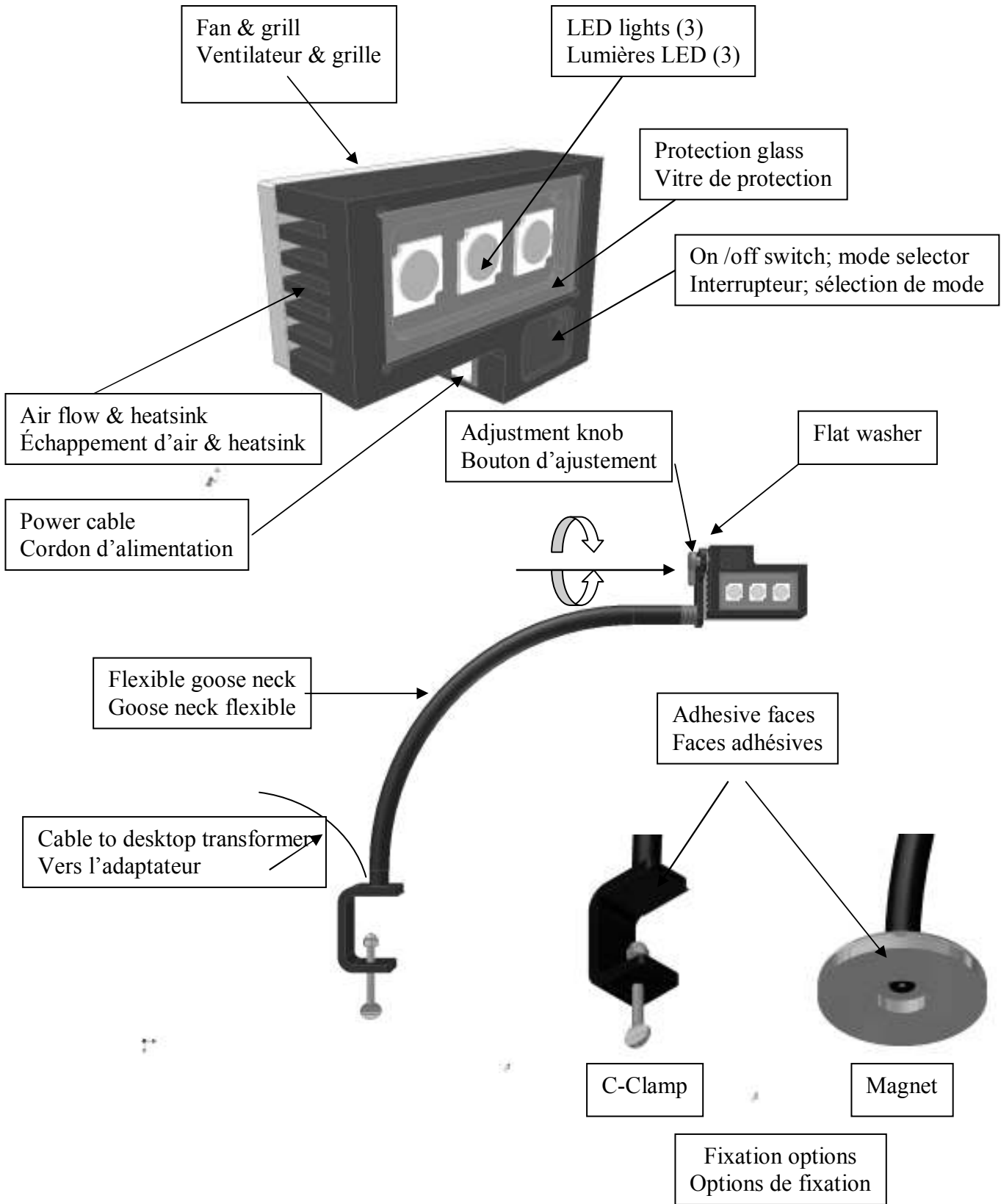

WARRANTY

FLEXLITE 1 YEAR LIMITED SERVICE WARRANTY

Proof of purchase must be presented when requesting warranty service.

Limited to FLEXLITEs purchased 1st December 2010 and after. This product is manufactured by FP Technologies. The FLEXLITE trademark is licensed by FP Technologies. All warranty communications should be directed to FP Technologies Technical Service at (toll free) 1-866-854-1411.

GUARANTEE POLICY

To receive a replacement you must present proof of purchase and return all original equipment packaged with the original product. The replacement will be covered by the limited warranty for the balance of the 1 YEAR service warranty period.

WHAT IS COVERED UNDER THE 1 YEAR LIMITED SERVICE WARRANTY

This warranty on FLEXLITE covers all defects in workmanship or materials including the brushes, switches, LED and cables, for one year after the purchase date. Malfunction is covered by warranty only if the product has been used normally and not if it results from misuse.

Warranties for other FLEXLITE products may vary.

HOW TO OBTAIN SERVICE

To obtain service for this FLEXLITE you must return it; freight prepaid, or take it in to an authorized service center for FLEXLITE. You may obtain the location of the authorized service center nearest you by calling (toll free) : 1-866-854-1411 or by logging on to the FLEXLITE website at www.flexlite.ca. When requesting warranty service, ask for a RMA number before returning any products and you must present the original dated sales receipt. The authorized service center will repair any faulty workmanship, and at our discretion either repair or replace any part covered under the warranty, at no charge to you.

WHAT IS NOT COVERED

This warranty applies only to the original purchaser and may not be transferred. This warranty only covers defects arising under normal usage and does not cover any malfunction, failure or defect resulting from misuse, abuse, neglect, alteration, modification or repair by other than an authorized service center for FLEXLITE brands.

FLEXLITE MAKES NO WARRANTIES, REPRESENTATIONS OR PROMISES AS TO THE QUALITY OR PERFORMANCE OF ITS WORKLIGHT OTHER THAN THOSE SPECIFICALLY STATED IN THIS WARRANTY.

ADDITIONAL LIMITATIONS

To the extent permitted by applicable law, all implied warranties, including warranties of MERCHANTABILITY or FITNESS FOR A PARTICULAR PURPOSE, are disclaimed. Any implied warranties, including warranties of merchantability or fitness for a particular purpose, that cannot be disclaimed under state law are limited to one year from the date of purchase. FLEXLITE are not responsible for direct, indirect, incidental or consequential damages. Some states do not allow limitations on how long an implied warranty lasts and/or do not allow the exclusion or limitation of incidental or consequential damages, so the above limitations may not apply to you. This warranty gives you specific legal rights, and you may also have other rights which vary from state to state.