



OWNER'S MANUAL

INSTALLATION - OPERATION - MAINTENANCE



STANDARD PUMP SYSTEM

Powered By: Bennett Hydraulics

CAUTION: Read this instruction manual carefully. Become familiar with the controls and know how to operate the *Power-Pole™* system safely.

US PAT No. 6,041,730



FIVE (5) YEAR LIMITED WARRANTY

(KEEP YOUR RECEIPT) ORIGINAL PURCHASE

Any *Power-Pole™* manufactured by JL Marine systems Inc. is warranted against defects in material and workmanship in the stern bracket, U-channel, Knuckle joint, hydraulic system, and electrical system, according to the following stipulations:

1. The *Power-Pole™* is warranted to the original owner for a period of five years, from the date of purchase.
 - A. A *Power-Pole™* component which proves defective within ninety (90) days from date of purchase will be repaired or replaced, at JL Marine Systems, Inc. option, free of charge to the owner. JL Marine Systems, Inc. will pay for the replacement product shipping and handling fees to and from the JL Marine Systems, Inc. manufacturing plant or some other place which JL Marine Systems, Inc. might designate.
 - B. A *Power-Pole™* component which proves defective after twelve (12) months, but before sixty (60) months, will also be repaired or replaced free of charge, but there may be a shipping and handling charge to and from the JL Marine systems, Inc. manufacturing plant or some other place which JL Marine Systems, Inc. might designate. In the case of replacement, parts of same (or equivalent) model will be used.
2. This warranty covers the finish for a period of six (6) months from the date of purchase not to crack, chip or fade.
3. This warranty covers the hydraulic pump and cylinder for a period of (36) months. Pump damage due to submersion or excessive exposure to water may void this warranty.
4. *Power-Pole™* warranties are activated upon receipt by JL Marine Systems, Inc. of the completed warranty card, postdated within 10 days of purchase. Please retain your sales receipt as proof of purchase.
5. This warranty is void if the *Power-Pole™* is used commercially, structurally altered or subject to stress beyond the physical limits of the anchor material.
6. This warranty does not cover abrasion or abnormal abuse, nor does it cover an anchor while being used for anything other than what it was intended for.
7. JL Marine Systems, Inc. reserves the right to change products and designs without incurring any obligations to incorporate such changes in already completed products, or those in the hands of dealers or consumers. Anchors repaired or replaced under this warranty may or may not have these changes.

THE WARRANTY CONTAINED HEREIN IS THE EXCLUSIVE WARRANTY MADE BY JL Marine Systems, Inc. AND THERE ARE NO OTHER WARRANTIES, EXPRESSED OR IMPLIED, INCLUDING A WARRANTY OF FITNESS FOR A PARTICULAR PURPOSE OR OF MERCHANTABILITY MADE WITH RESPECT TO SUCH ANCHORS.

JL Marine Systems, Inc. IS NOT LIABLE FOR ANY INJURY OR MISHAPS SUSTAINED IN THE USE OF THIS PRODUCT. THE USER OF THIS PRODUCT ACKNOWLEDGES ASSUMED RISKS AND WAIVES ANY AND ALL CLAIMS AGAINST JL Marine Systems, Inc. AND ANY OF IT'S AGENTS.

This warranty applies under conditions of normal use. The warranty does not cover: 1) defects caused by improper assembly or disassembly; 2) defects occurring after purchase due to product modification, intentional damage, accident, misuse, abuse, negligence or exposure to corrosive elements; 3) cosmetic damage and 4) labor or assembly costs.

Except as provided herein, JL Marine Systems, Inc. makes no express warranties, and any implied warranty, including without limitation any implied warranty of merchantability or fitness for a particular purpose, is limited in its duration to the duration of the written limited warranty set forth herein.

Except as provided herein, JL Marine Systems, Inc. shall have no liability or responsibility to the purchaser or any other person or entity with respect to any liability, loss or damage caused or alleged to be caused directly or indirectly by use of the product, including, but not limited to, any incidental or consequential damages. Some states do not allow limitation on how long an implied warranty lasts or the exclusion of limitation of incidental or consequential damages, so the above limitation and exclusion may not apply to you.

This warranty gives you specific legal rights. You may also have other rights which vary from state to state.

Warranty Procedure



To obtain warranty service, take or ship your **Power-Pole™** to JL Marine Systems, Inc or to a JL Marine Systems Inc. authorized service station, together with a note describing your complaint and your copy of the dated purchase receipt. If you choose to ship your **Power-Pole™** to JL Marine or an authorized service station, all shipping arrangements must be made by you and all shipping charges and insurance must be fully pre-paid. All to and from shipping charges for JL Marine systems, Inc. products which have been serviced under this Warranty within ninety (90) days of the purchase date may be reimbursed by JL Marine.

Keep this information for your records

Model _____

Serial No _____

Customer's Name _____

Place of purchase _____

Date of Purchase _____



JL MARINE SYSTEMS, INC.
9208 PALM RIVER ROAD SUITE 303
TAMPA, FL 33619

(813) 689-9932

CONGRATULATIONS on your purchase of a **Power-Pole™ Shallow Water Anchor** system. It has been designed, engineered, and manufactured to give you the best possible dependability and performance for years of enjoyment.

Please read and retain this manual. The information contained in the manual describes the proper procedures for safely installing, operating and maintaining your **Power-Pole™**.

CAUTION: Do not use the Power-Pole™ as your primary anchorage. Never leave your boat unattended while anchored with the Power-Pole™.

TRAINING:

- Read this operator's manual carefully. Become familiar with the controls and know how to operate your Power-Pole™ properly.
- Do not allow children to operate the Power-Pole™ without adult supervision.
- Do not modify the unit in any way or add accessories not intended for this unit.
- Always disconnect power from Power-Pole™ before servicing.

PREPARATION:

- Always make sure the Power-Pole™ is in the full up position with a travel strap in place when on the trailer.
- If any debris gets caught around the Power-Pole™, **DISCONNECT** power from motor and remove any debris.

OPERATION

- In the event of pump failure the Power-Pole™ may be manually raised by applying enough pressure to bypass the Pole-Protector valve thus allowing the unit to come all the way up to the stowed position. If the Power-Pole™ is beyond reach it can be forced up by driving the boat to shallower water. Depressing the up button on the Power-Pole™ control may offer assistance.
- Be sure to have the Power-Pole™ in the full up position when using outboard motor at high speeds.
- Keep your hands and clothing completely clear of the Power-Pole™ at all times.
- Do not use the Power-Pole™ as a step or handle to enter or exit the boat.
- Never allow children to play with or around the Power-Pole™.
- The Power-Pole™ is fully powered, never give any assistance to raise or lower.
- In high wind or rough seas the Power-Pole™ may relieve holding pressure to protect your boat's transom.
- Never leave your boat unattended while your Power-Pole is providing anchorage.

MAINTENANCE AND STORAGE:

- **CAUTION**—Hydraulic lines always have pressure, disconnecting the lines will cause sudden high pressure leakage and Power-Pole™ failure which may cause bodily harm.
- Check all hydraulic lines at frequent intervals for proper tightness to be sure there are no leaks.
- Make sure all power connections are secure and free of corrosion.
- Check all nuts, bolts, and screws at frequent intervals for proper tightness to be sure Power-Pole™ is in safe working condition.
- Check all hydraulic lines at frequent intervals for possible chaffing or damage from kinking or abrasion.
- Keep the hydraulic reservoir filled within the indicator marks at all times.
- Thoroughly rinse and lubricate all moving parts after each use.

INSTALLATION

Tools and Materials Needed

1. 7/16", 1/2" & 9/16" Wrench
2. 7/16", 1/2" & 9/16" Socket and Ratchet
3. Electric Drill
4. Four Foot Straight Edge
5. Marine Grade Sealant
6. Tape Measure
7. Wire Cutters
8. Razor Tube Cutter
9. Small Funnel
10. Wire Crimpers
11. 5/16" & 5/32" Drill Bits
12. 1 Quart Automatic Transmission Fluid
13. #1 & #2 Phillips Head Screw Drivers
14. Jig Saw or Rotary Saw

Hardware Included

- a. Qty(4) 5/16 x 3.5" all-thread transom mount bolts
- b. Qty(1) 5/16 x 3.5" cylinder ram bolt
- c. Qty(2) cylinder ram spacers
- d. Qty(2) thru hull bushings
- e. Qty(1) Cylinder end cap bushing
- f. Qty(3) marine wire ties
- g. Qty(4) 5/16 fender washers
- h. Qty(4) 5/16 lock nuts
- i. Qty(4) neo-bond washers
- j. Qty(2) cylinder ram bolt washers
- k. Qty(2) Brown cylinder ram bolt bushings
- l. Qty(1) 5/16 low profile locknut
- m. Pole-Protector valve

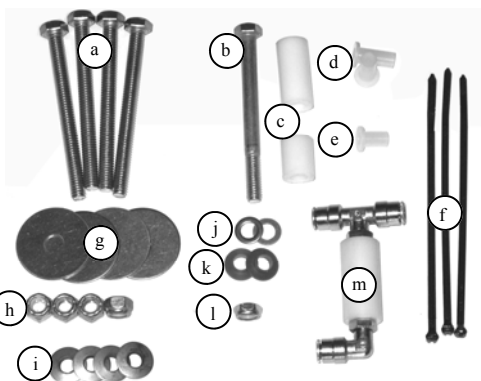

INSTALLATION

Hydraulic Power Unit Included

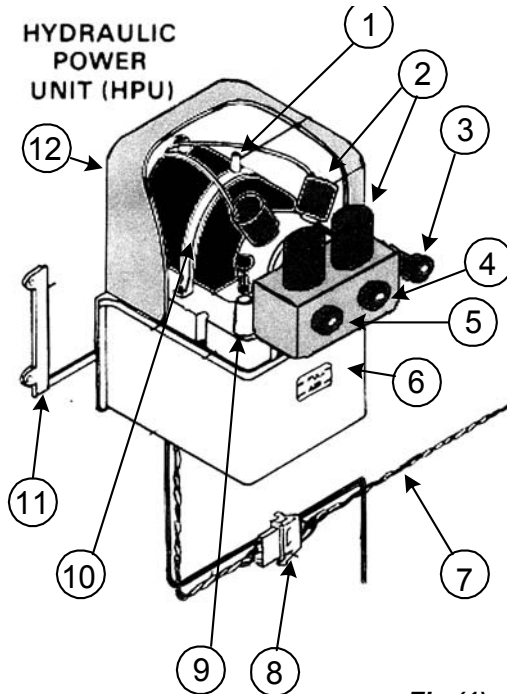

Fig (1)

DIAGRAM #	Description	Part Number
1	Type 25 thread cutting screw	VP1154
2	Solenoid valve	VP1135-R (Red) VP1135-G (Green)
3	Pole Protector Connector	VP1955
4	1/8" NPT to 1/4" tube connector (To cylinder base)	VP1146
5	1/8" NPT to 1/4" tube connector (To cylinder end)	VP1146
6	Fill indicator	
7	Wire Harness (22')	WH1000
8	Quick-disconnect plug	VP1143
9	Filler Stack and Plug	H1180
10	Motor Strap	VP1142
11	Mounting bracket for HPU	H1179
12	Lexan Cover	VP1138

INSTALLATION

Parts Included

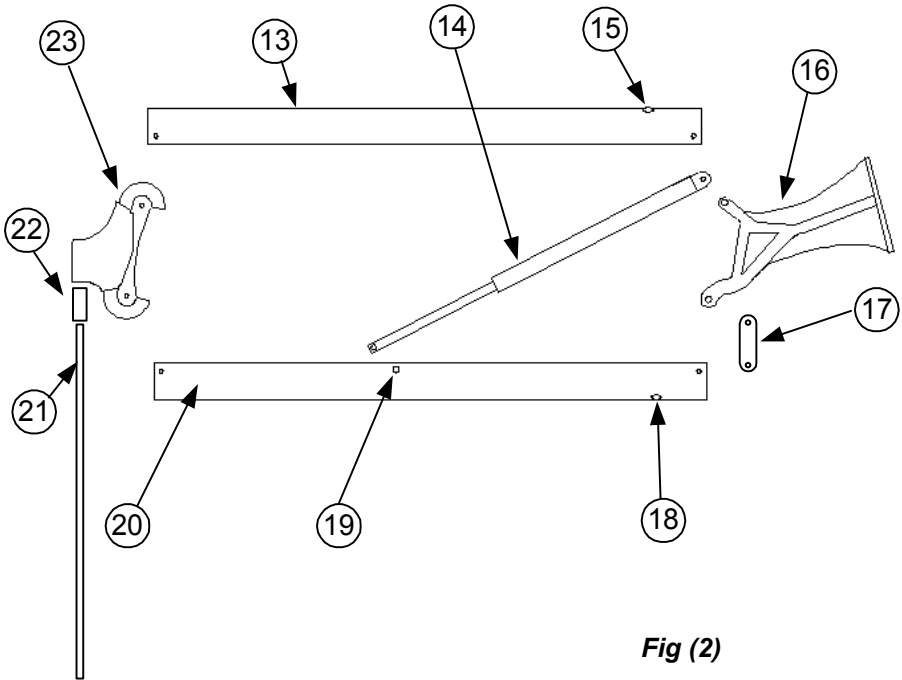

Fig (2)

DIAGRAM #	Description	Part Number
13	Top Arm (Inside)	PP1015
14	12" Hydraulic Cylinder	HL12CDA
15	1/4" Hole, (Marks bottom of Arm)	
16	Stern Bracket	PP1017
17	Serial Number keeper plate	PP1018
18	1/4" Hole, (Marks bottom of Arm)	
19	5/16 Hole for Hydraulic Mount	
20	Bottom Arm (Outside)	PP1016
21	5/8" Everflex™ spike	PP1019
22	Spike Bushing	PP1020
23	Top Knuckle	PP1021

Mechanical Schematic HPU# JLDL12DA

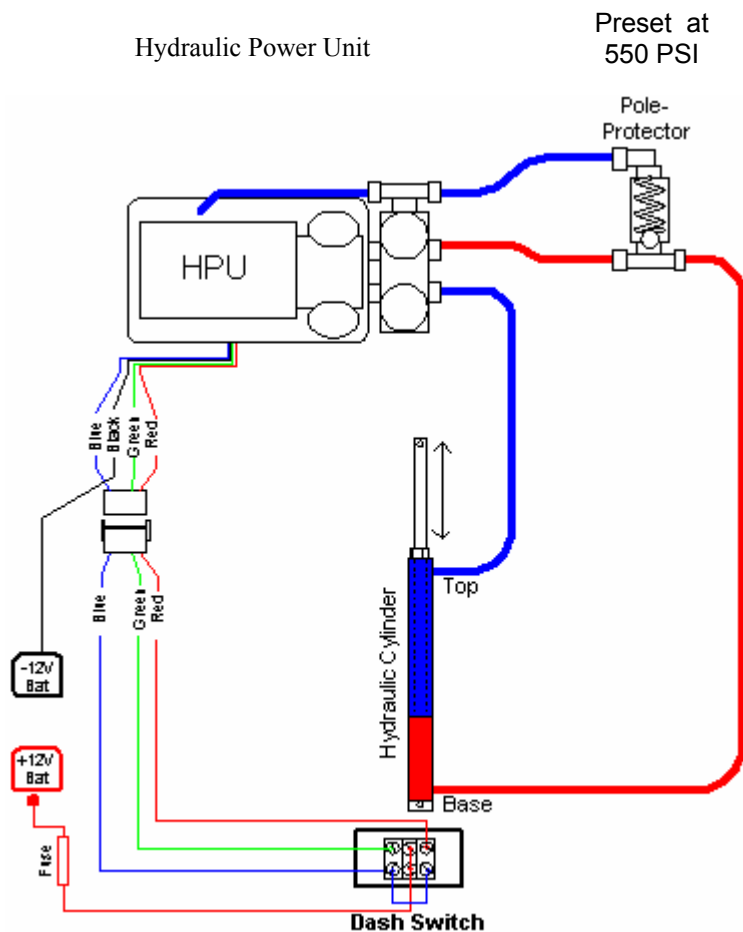

Fig (3)

INSTALLATION

Section 1 Choosing the Location

******IMPORTANT****** *Carefully consider and physically check all 5 steps in section one before mounting the stern bracket.*

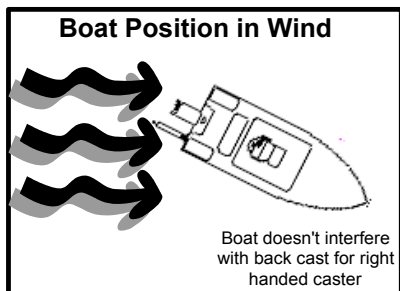

Fig (4)

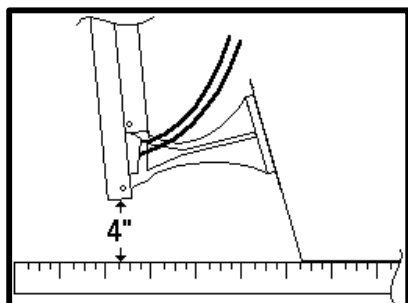

Fig (5)

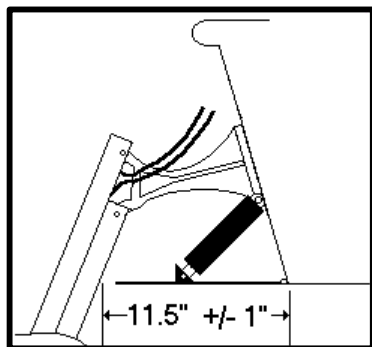

Fig (6)

1) “Left or Right” side of the boat?

Right-handed caster should put the *Power-Pole™* on the right side and left-handers should be on the left side. This is especially important when fly-fishing. The boat will pivot in the wind to the proper angle for easy downwind casts without the back-cast being over the center of the boat.

2) Vertical Positioning—no trim tabs

Use a straight edge on the bottom plane of the boat directly below and centered from the Stern Bracket. Mount the *Power-Pole™* so that the Bottom Arm mounting point of the stern bracket is 4” above the straight edge.

3) Trim Tab Clearance

If your boat has trim tabs it is very important to check their clearance requirements before mounting the bracket. For example, when the bracket is mounted at the suggested 4” above the bottom plane of the boat it will have about 11.5” of clearance for trim tabs. If your Trim Tabs are 12” and you are mounting the bracket over them, then you must mount it at least 5” above the boat’s bottom plane rather than the suggested 4”. Standard 9” Trim Tabs do not interfere with the *Power-Pole™*.

INSTALLATION

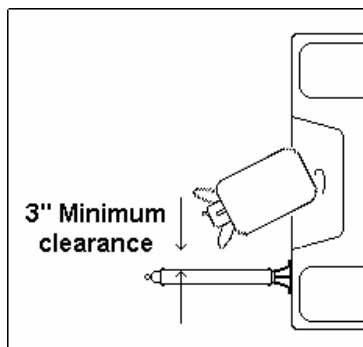

Fig (7)

4) Obstructions

Look inside the boat along the transom to make sure that the bolts will not have any obstructions.

5) Motor Clearance

Turn the motor all the way in the direction of the *Power-Pole™* then lower to make sure the motor does not interfere. Spin the propeller to make sure it has clearance also. Allow a minimum of 3" between the motor and the Power-Pole at all times in any position. See fig (7)

Section 2-Mounting The Stern Bracket

Hardware list for this step

- A Qty(4) 5/16 x 3.5 all-thread bolts
- B Qty(4) 5/16 Neo-bond rubber backed washers
- C Qty(4) 5/16 fender washers
- D Qty(4) 5/16 locknuts

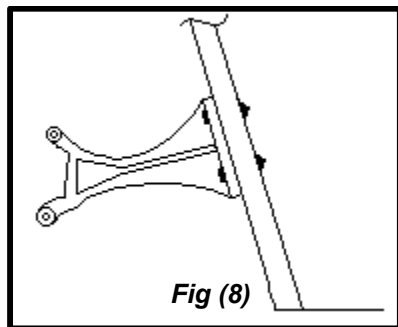

Fig (8)

Once a location has been chosen, mark all four holes. Before drilling any holes double check the inside to be sure that the bolts are not going to interfere with anything and that you have plenty of room to tighten the nut on the other side.

Once all four holes are marked and drilled, fasten the Stern Bracket using the listed hardware. The rubber backed washers are to protect the powder coated surface of the stern bracket. Use a marine quality sealant on and around the bolt and holes then tighten

adequately, **DO NOT OVER TIGHTEN.**

INSTALLATION

Section 3-Hydraulic Power Unit (HPU)

Install the (HPU) In a convenient location and in a dry environment.

Important: The HPU must be mounted in a dry enough location to avoid submersion and drenching. Allow space above the HPU so that it may be slid into its mounting bracket (about 3"). Layout upper holes on HPU mounting bracket 4-5/8" apart and start #10 x 1" screws using 5/32" pilot holes. Then drill 5/32" pilot holes for lower screws and mount bracket. Slide HPU into bracket.

Section 4-Installing the Lines and Cylinder

Unpack the hydraulic cylinder from the box with the two 90° nickel plated push-fit hydraulic line connectors pre-installed.

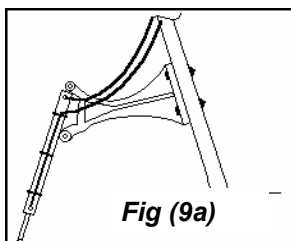

Fig (9a)

Insert the 1/2" long bushing into the 5/16 hole in the RED end cap (*found in the Power-Pole™ hardware bag*). Install on the same side as the hydraulic fittings. **See fig (9b)**

Partially remove the 1/4" x 3 1/2" bolt on the top of the stern bracket and install the cylinder. The hydraulic fittings should be on the same side of the Power-Pole™ as the serial# plate.

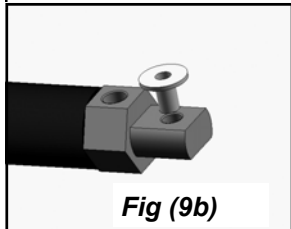

Fig (9b)

Attach the hydraulic lines to the push-fit connectors by simply pushing the line into the fitting. "*no tools required*". Route the top line down the cylinder and secure with the enclosed marine wire straps. Route the bottom line directly down and thru the serial# plate. Continue to route each line behind the Serial plate and into the boat. **See fig (9a)** The lines can either go

through or over the transom whichever you prefer. Two through hull sleeves are included to make a clean transom penetration.

Cover the ends of the tubing with tape during the installation to prevent any debris from getting in the lines and contaminating the oil. The slightest piece for dirt could cause severe problems.

*****Note:** *With the Power-Pole™ in the full up position pull any slack from inside the u-channel, this will prevent the hydraulic lines from jamming when lowering the Power-Pole™.*

INSTALLATION

******IMPORTANT****** Once the lines are routed behind the serial# plate and connected to the push fit connectors move the cylinder through the entire range of motion to make sure the lines are not going to kink, chafe or otherwise be damaged during normal use.

Install the Pole-Protector valve as indicated in fig. (10) then route the lines from the Power-Pole™ to the HPU through the most convenient and direct way. Attach with clips and hose benders wherever necessary. COVER THE ENDS OF THE TUBING TO PREVENT CONTAMINATION FROM ENTERING THE SYSTEM WHILE ROUTING THE LINES THROUGH THE BOAT.

Make sure the line that has the Pole-Protector in it is attached to the base side of the hydraulic cylinder.

See fig (10)

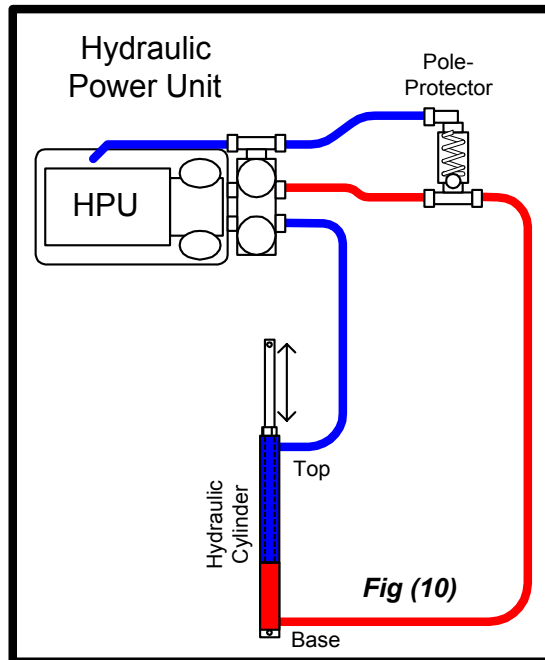

INSTALLATION

Section 5-Choose Location for Switch

The control switch should be mounted where it is easily accessible from anywhere on the boat. Remember the switch requires a +12v DC supply with a minimum of 12 AWG wire. If the switch is mounted in the bow of the boat you should use 10 AWG wire. Multiple switches can also be installed.

Section 6- Mounting Switch

Mark the cutout area and allow room for the faceplate screws. Check to make sure you are not going to interfere with anything on the other side. Use a jig saw to cut out the marked area then screw in place.

Section 7-Connect Wires

*****IMPORTANT***** The +12v source should be directly from the battery with a minimum size of 12 AWG wire. If an inadequate wire is used the *Power-Pole*™ may not function properly.

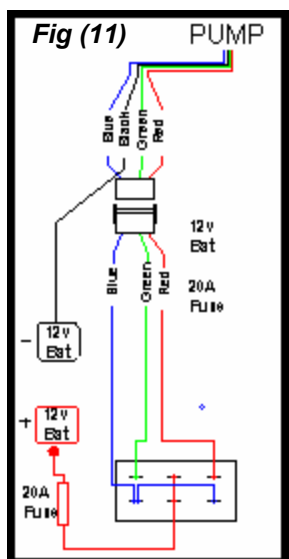

Remove this cutout from your manual and tape to your console at the desired switch location. Using a fiberglass cutting blade cut the solid line. Try to remove all the line without going outside the dashed line.

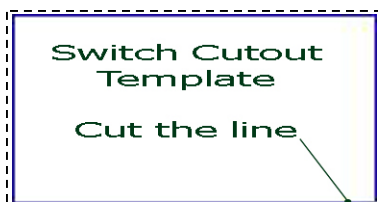

INSTALLATION

Section 9-Prime Pump

After all lines are completely installed, remove the plug from filler stack located at the front left corner of the reservoir. Fill reservoir to “Full Line” using any type automatic transmission fluid (ATF).

Using the control, cycle the cylinder from all the way out to all the way in several times to clear all the air from the system. No bleeding is necessary. To prevent the cylinder from scaring the inside of the u-channel, wrap the end of the ram with a soft cloth during this step.

Section 10-Final Assembly

- 1) Using the 5/16 x 3.5” bolt attach the cylinder ram to the U-channel as shown.

Hardware list for this step

- A. Qty (1) 5/16 x 18 x 3.5 bolt
- B. Qty (2) 5/16 thin wall washer
- C. Qty (2) 5/16 brown bushing
- D. Qty (1) 5/16 low-profile lock nut
- E. Qty (1) small ram spacer
- F. Qty (1) large ram spacer

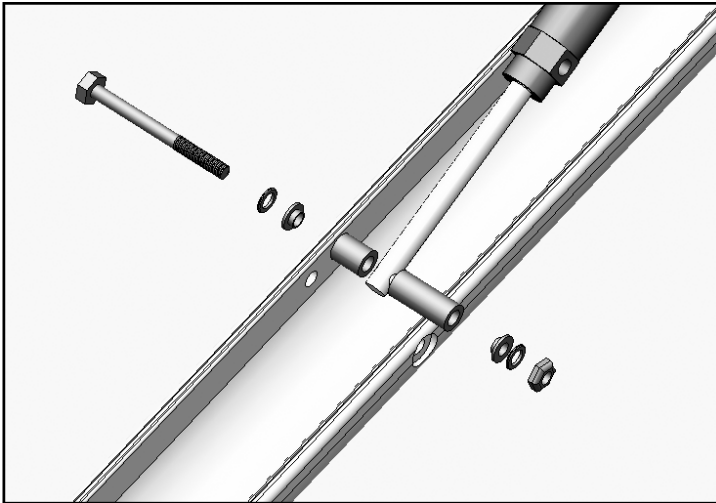

NOTE The large spacer goes on the same side of the ram as the hydraulic fittings to offset the cylinder enough so that the lines do not interfere with the u-channel.

IMPORTANT!!

REGISTER YOUR **POWER-POLE™** *Shallow Water Anchor*

This warranty registration card must be completed and mailed to JL Marine Systems, Inc. to validate your warranty.

CUSTOMER INFORMATION

Purchaser's Name _____ Age _____

Purchaser's Address _____

City _____ State _____ Zip _____

Boat type _____ Length _____

E-mail _____

POWER-POLE™ INFORMATION

Date of Purchase: Month _____ Day _____ Year _____

Serial No. _____ (Found on Stern Bracket)

Place of purchase _____

CUSTOMER SATISFACTION

Where did you hear about **Power-Pole™**?

- ☐ Television (show) _____
- ☐ Word of Mouth
- ☐ Internet
- ☐ Advertisement (type) _____
- ☐ Other _____

What type of fishing do you prefer?

- ☐ Redfish, Snook and Trout
- ☐ Bone Fish
- ☐ Tarpon
- ☐ Bass
- ☐ Other _____

What is your favorite feature?

- ☐ Quiet
- ☐ Convenience
- ☐ Boat Control
- ☐ Holding Power
- ☐ Other _____

What is your favorite bait?

- ☐ Live Bait
- ☐ Cut Bait
- ☐ Artificial
- ☐ Fly

Place
First-Class
Stamp
Here

Post Office will
not deliver
without proper
postage



JL MARINE SYSTEMS, INC.
9208 PALM RIVER RD, SUITE 303
TAMPA, FL 33619