



Tsunami Single User Breathable Air System and Tsunami Single User Breathable Air Unit User Manual Installation Instructions

!! Please Retain This Manual for Your Records !!



Tsunami Compressed Air Solutions is a division of



Protect your employees
and yourself with the
newly designed Tsunami
breathing air system.

YOUR SAFETY IS IMPORTANT

Read ALL instructions before you install and use your
Tsunami Single User Breathable Air System

Observe and follow all warning and caution instructions

!! Warning: Read Before Use !!

- Failure to understand and follow the warnings and instructions contained in this manual may cause **Injury or Death**.
- Failure to read and understand all warning and instructions on the products you are using (paints, solvents, epoxy resins, pesticides, etc.) may cause **Injury, Disease, or Death**.
- Not for use with gasoline powered air compressors.
- All maintenance and operational instructions contained within this manual must be followed. Failure to follow these instructions may result in injury or loss of life.
- All instructions for the carbon monoxide (CO) monitor must be followed exactly.
- Do not attempt to use the respirator without reading and understanding the instructions of the product.
- Never wear supplied air respirators in any atmosphere that may contain levels of contamination which are unknown or may be Immediately Dangerous to Life or Health (IDLH).
- You must use a supplied air respirator that adheres to the guidelines set by the American National Standard Practices for Respiratory Protection Z88.2.
- You must use a supplied air respirator that adheres to the statutes set forth by your federal, state, and local Occupational Safety and Health organizations.
- Always make sure your compressed air system has been depressurized prior to servicing of this product.
- Always wear eye protection when working on compressed air systems.
- Use only proper tools and follow all precautions that pertain to the use of those tools.
- Use appropriate thread sealant on all fittings unless otherwise specified.
- ◆ This breathing air system reduces but does not eliminate your exposure to inhaled chemicals or contaminants. It **Does Not** provide total protection.
- ◆ If you have ever experienced breathing complications while around or after exposure to paint, isocyanates, solvents, etc. **DO NOT USE** this breathing air system.
- ◆ If you are sensitized to paint, isocyanates, solvents, etc., **DO NOT USE** this breathing air system, it **WILL NOT** protect you.
- ◆ **DO NOT USE** this product if you cannot understand the warnings or instructions contained within this manual.
- ◆ If these warnings and instructions lead you to believe that you should not use this breathing air system or that it will not protect you, **DO NOT USE IT**, regardless of any instructions or statements from another source such as an employer, a parts supplier, product manufacturer, etc, that indicate you will be protected.
- ◆ **YOU ARE SOLELY RESPONSIBLE** for any injury, disease, damage, or death caused by failure to follow these warnings and instructions.



DIRECTORY

Maintenance Guide and Instructions Oil Coalescing and Activated Carbon Replacement Elements	Page	4
Maintenance Guide and Instructions Float Drains and Carbon Monoxide (CO) Monitor Calibration	Page	5
Product Overview	Page	6
Tsunami Filtration Package Mounting Instructions	Page	7
Assembly of Tsunami Single User Breathable Air Unit	Page	8-10
How to Use the Tsunami Single User Breathable Air Unit with a Tsunami Regenerative Dryer	Page	11
Warranty	Page	12

For technical support or application assistance please call 1-800-782-5752

www.tsunami.us.com

www.gosuburban.com

Tsunami Compressed Air Solutions is a division of



Maintenance Instructions for Single User Breathable Air System

**** SYSTEM PRESSURE MUST BE RELEASED PRIOR TO
PERFORMING MAINTENANCE PROCEDURES ****

Tsunami Oil Coalescing Filter - **Mandatory every 6 months** (Replacement P/N 21999-0202)

- ① Unscrew the outer tube from the Tsunami head of the 2nd stage oil coalescing filter.
- ② Remove the bottom nylon lock nut and remove the element. Do not lose the top element adaptor or the bottom baffle plate.
- ③ Slide element adaptor, replacement element, and bottom baffle plate up the threaded rod into the Tsunami filter head.
- ④ Tighten the nylon lock nut until the element is firmly secured (Do Not Crush Element) and screw the outer tube back on.

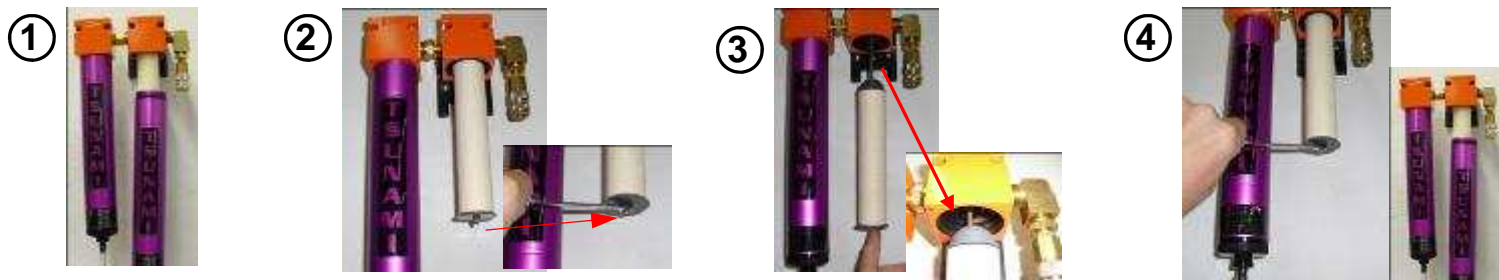

Tsunami Activated Carbon Filter on Belt Unit - **Mandatory every 3 months** (Replacement P/N 21999-0395)

Some compressed air systems may require replacement of the activated carbon element more often than specified
ALWAYS REPLACE THE ELEMENT IF THE USER CAN "SMELL" OR "TASTE" THE AIR THEY ARE BREATHING

- ① Disconnect the CO sampling tube from the carbon monoxide monitor and unbuckle the filter unit from the belt.
- ② Remove the breathing air regulator from the filter assembly and remove the activated carbon element, baffle, and spring.
Note: There are two element gaskets which must stay in place for the replacement element seal.
- ③ Hold the new element, baffle, and spring; slide the tube down over the spring and element.
- ④ Screw the breathing air regulator back onto the filter tube.
- ⑤ Attach the breathing air unit back onto the belt and re-connect the sampling tube to the CO monitor

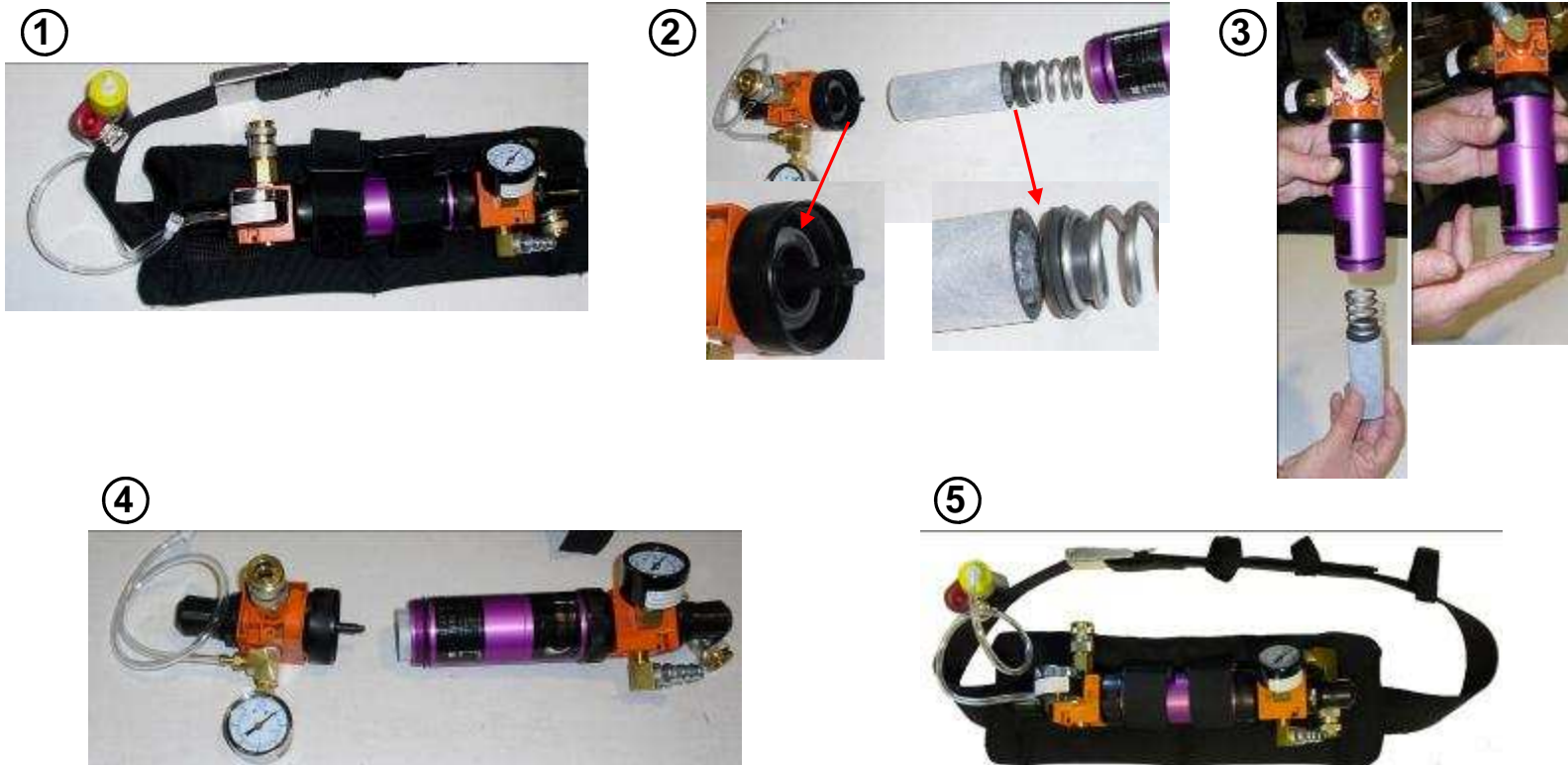

Maintenance Instructions for Single User Breathable Air System

**** SYSTEM PRESSURE MUST BE RELEASED PRIOR TO
PERFORMING MAINTENANCE PROCEDURES ****

Float Drain Replacement on Wall Mounted Tsunami Filtration Package (Float Drain - P/N 9000801)

- ① Unscrew the bottom cap from the Tsunami tube.
- ② Remove the float drain; this is easily achieved by grasping the lower portion of the float stem
Note: You can also reach the float stem from the underside of the Tsunami bottom cap.
- ③ Discard the old float and replace with a new one and screw the bottom cap back onto the Tsunami filter tube.
Note: Float drains only need to be hand tight or just slightly past hand tight.



Carbon Monoxide (CO) Monitor Calibration - **Every 1 to 3 months** (Calibration Kit - P/N 21999-0264)

- ① Purchase a calibration kit and follow all procedures outlined in the GFG operators manual for the CO monitor.
- ② Send your CO monitor to Suburban Manufacturing, Inc and we will calibrate the unit for you.
Note: The cost of calibration is \$50.00 + return freight.



②

To arrange the calibration of your CO monitor;
Contact us at 1-800-782-5752 and request your
Returned Goods Authorization (RGA) number.

Once given an RGA#, please send your CO
monitor to:

CO Monitor Calibration - QC Dept.
Suburban Manufacturing, Inc.
301 Chelsea Road
Monticello, MN 55362

YOUR SAFETY SHOULD NEVER BE COMPROMISED

P/N 21999-0791

Tsunami Single User Breathable Air System

System Includes:

- Tsunami 2-Stage Filtration Package
- Tsunami Single User Breathable Air Unit
- 50' Tsunami Ultra-flo Hose
- SAS Flip Up Mask



P/N 21999-0790

Tsunami Single User Breathable Air Unit

Unit Includes:

- Tsunami belt mounted activated carbon filter with dual regulators for your work line and your breathing air line
- 5' Tsunami Ultra-flo Hose - "whip" hose
- Carbon Monoxide monitor for breathing air



Your Unit at a Glance

It is important to understand the location of each of these regulators and the gauges that are used on them as well as the ports used on each.

- ① The breathing air regulator on this filter has a 0-30psi regulator with a 0-30psi gauge attached.
- ② The inlet air / whip hose regulator on this filter has a 0-180psi regulator and a 0-200psi gauge attached.
- ③ The carbon monoxide sampling port; this is where you connect the sampling tube from your belt mounted CO monitor.
- ④ This is the breathing air coupler for the breathing air hood. This is the only coupler supplied with this unit.

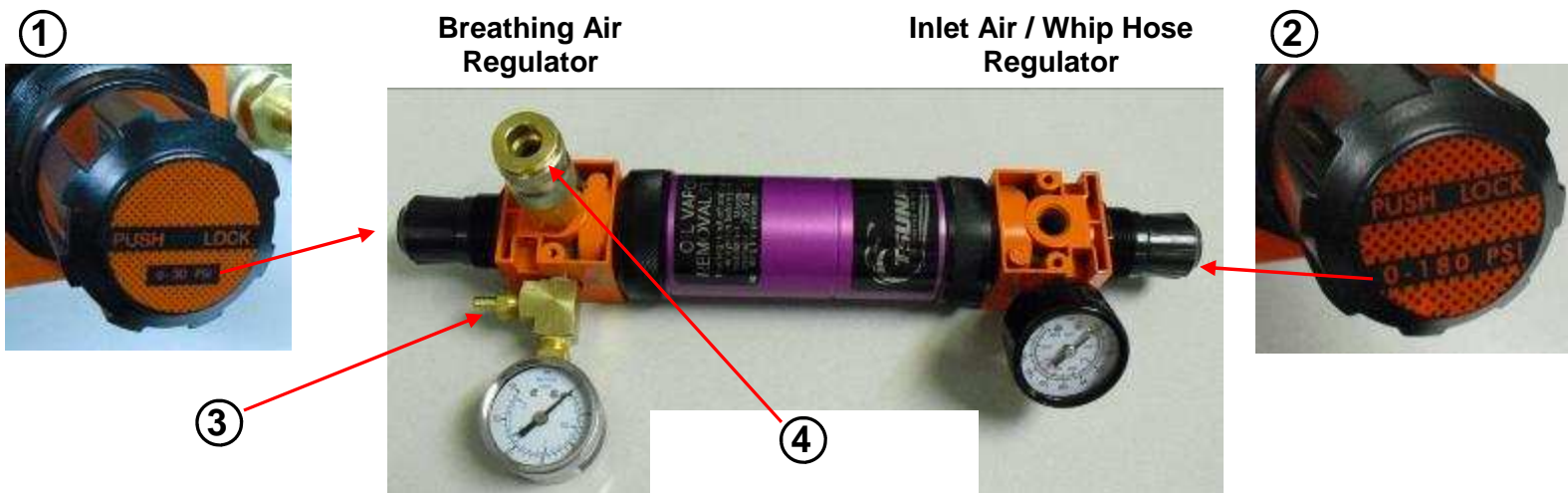

Mounting the Tsunami Filtration Package

7

This step is only used for the Tsunami Single User Breathable Air System

Proceed to page 8 for Belt Unit instructions only.

- ① Securely attach the universal mounting bracket to your wall or booth using appropriate hardware.
- ② Attach the Tsunami Filtration Package to the mounting bracket using the proper size bolts supplied with the filter.
- ③ Install the plastic drain fittings onto the bottom caps of the Tsunami filters.
- ④ Push the clear drain tubing onto the barbed fittings and then route the drain tubing discharge to a suitable location.
- ⑤ Connect the **CUSTOMER SUPPLIED** air hose quick coupler fitting and then attach main air hose to run to belt filter.
- ⑥ A preferred installation requires a **CUSTOMER SUPPLIED** brass elbow and quick coupler fitting.

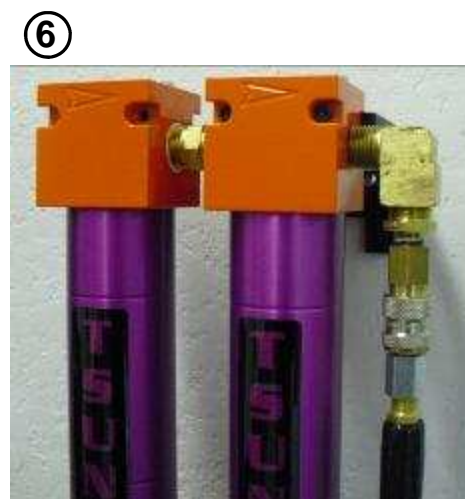

8

Assembling the Fittings to the Breathing Air Unit

Use appropriate thread sealant - thread tape is easy and preferred for this application

- ① Install the two elbows on the inlet and outlet ports of the Inlet Air / Whip Hose regulator.
Note: The inlet air supply fitting and the whip hose fitting are at an approximate 45° angle.
- ② Pre-assemble the brass nipple and the female tee and then attach to the outlet elbow for the work line (whip hose)
- ③ Install CUSTOMER SUPPLIED inlet air fitting and outlet air quick coupler for 5' work hose (Preferred Installation).
Note: You can attach the hose directly to the outlet of the filter unit but is not recommended.

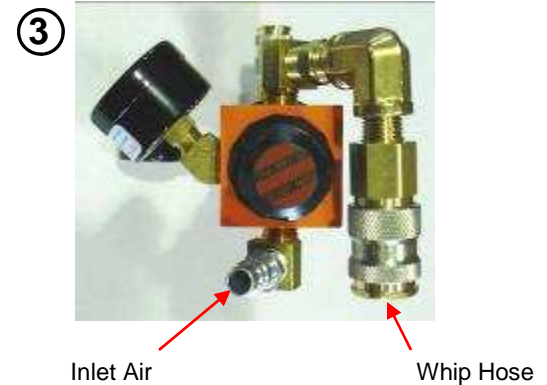
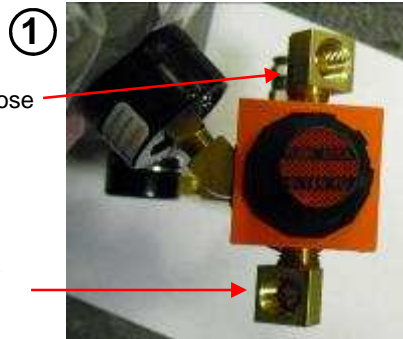

How to Convert the Breathing Air Unit for Left Hand Painters

Important: This belt filter has two different regulators; one for breathing air and one for the work line see page 6

- ① Remove the regulator gauge assemblies from the gauge ports. (see page 6)
- ② Turn the filter so you can access the gauge ports on the reverse side of the regulators
- ③ Remove port plugs with 3mm hex wrench and install the gauge assemblies as shown.
- ④ Plug the open gauge ports on the reverse side of the regulators.
- ⑤ Switch the fixed buckle from the right side of the belt to the left side of the belt.



Attaching the Breathing Air Unit to the Belt

9

- ① Loosen the mounting straps.
- ② Set the breathing air unit on the mounting pad with the gauges facing the top of the belt.
- ③ Slide the mounting straps through the strap buckle.
- ④ Securely strap the breathing air filter unit into place.

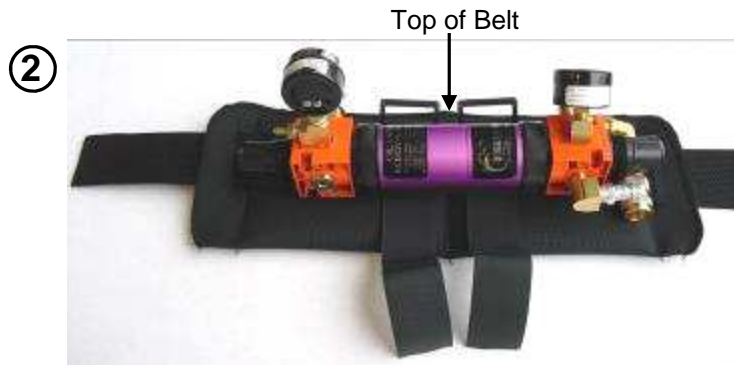
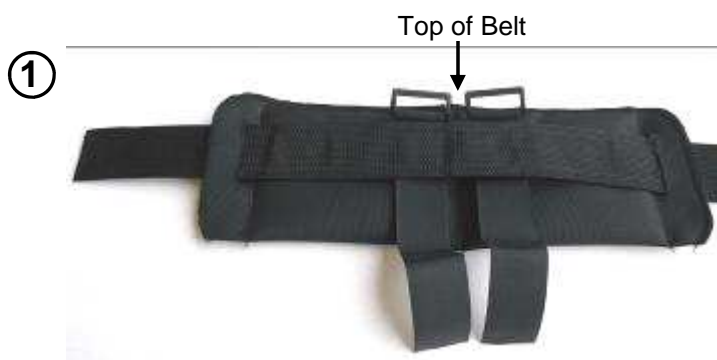

About Your Carbon Monoxide Monitor

- ① **Important: Read your Operations Manual for your CO monitor and be sure to send in your warranty registration.**
- ② Push the carbon monoxide sampling tube adaptor into the top of the CO monitor.
- ③ Twist the tube adaptor until you hear it "click" into place.

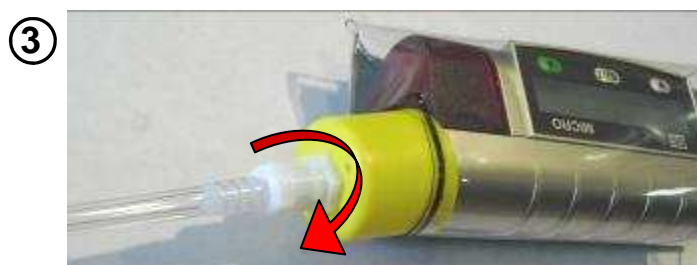

Wearing the Breathing Air Unit

- ① Buckle the breathing air unit around your waist and adjust the placement of the filter pad along the belt until the unit fits comfortably in the center of your back.
- ② Adjust the belt to your desired snugness and cut any excess material from the belt tongue.
- ③ Connect the whip hose to the filter unit.

①



②



③



- ④ Clip the CO monitor onto the belt and connect the sampling tube to the barbed fitting on the breathing air regulator end of the filter.

Note: The CO monitor should be attached to the opposite side of the belt from where the work line is being used.
- ⑤ Put your breathing air hood or mask on and connect to the coupler installed on the belt mounted breathing air unit.

Note: Some brands of hoods by different manufacturers may require that you replace the supplied breathing air coupler for the hood with one that is specific to their hood inlet connection.

④



⑤



How to Use the Tsunami Single User Breathable Air Unit ¹¹ with a Tsunami Regenerative Dryer

Using this system allows you to provide pre-filtered air for the breathable air drops without having to purchase additional filtration to meet the specifications required by OSHA and NIOSH all while drying the downstream air for your spray drops.



①

②

- ① Remove the plug from the auxiliary port which normally blocks off the flow through of compressed air from the dryer inlet air supply.
- ② You can plumb regular air lines or install a hose coupler and run hose to your booth or to the location you wish to use breathable air with the Tsunami Single User Breathable Air Unit.

①



②





a division of:
 Suburban Manufacturing, Inc.
 Monticello, MN 55362
 1-800-782-5752

Suburban Manufacturing, Inc. warrants this unit to be free from manufacturing defects for a period of one year from the date the unit is shipped from factory according to the following terms:

This unit must be installed and maintained in accordance with the manufacturers' written recommendations and requirements as they exist from time to time,
 This unit must be used for appropriate applications;
 This unit must not have been altered from its original state.

Any portion of this unit found defective in material or workmanship will be repaired or replaced, at the manufacturers option, without charge for parts or labor, providing the unaltered product is returned to the manufacturer, shipped prepaid, within the one year time period set forth in this warranty and provided further that the customer establishes that the product is defective in its material or workmanship.

This warranty specifically does not apply to:

Any unit which has been altered from its original state by the customer or anyone acting on behalf of the customer other than the manufacturer;
 Repairs necessitated by accident, abuse, or failure to use the product in a manner for which it was designed;
 Failure by the customer to follow the normal installation, application and maintenance requirements of the manufacturer;
 Loss of use of any system of which this unit is a part, loss of time, inconvenience or any other incidental or consequential damages sustained by the customer.

THIS WARRANTY IS IN LIEU OF ALL OTHER WARRANTIES OR CONDITIONS, INCLUDING ANY WARRANTIES OF MERCHANTABILITY OR FITNESS FOR A PARTICULAR PURPOSE OR USE. THIS REMEDY OF REPAIR OR REPLACEMENT UNDER THIS WARRANTY IS EXCLUSIVE AND NEITHER THE MANUFACTURER NOR ITS AGENTS AUTHORIZE ANYONE TO ASSUME FOR THEM ANY OTHER OBLIGATION OF ANY FORM OTHER THAN THE OBLIGATION TO REPAIR OR REPLACE WHICH IS SET FORTH IN THIS WRITTEN WARRANTY. THIS WRITTEN WARRANTY COMPLETELY EXCLUDES THE MANUFACTURERS' RESPONSIBILITY FOR BUSINESS INTERRUPTIONS, LOSS OF PROFITS, PERSONAL INJURY, COSTS OR DELAY, OR ANY OTHER DIRECT OR INDIRECT INCIDENTAL OR CONSEQUENTIAL LOSSES, COSTS, OR DAMAGES. THE CUSTOMER ACCEPTS THIS WARRANTY AS AN EXPRESS CONDITION OF PURCHASE OF THIS UNIT.