

Always here to help you

Register your product and get support at
www.philips.com/welcome



PT927
PT927CC
PT925
PT923
PT923CC
PT920
PT877
PT876
PT875
PT870

User manual

PHILIPS

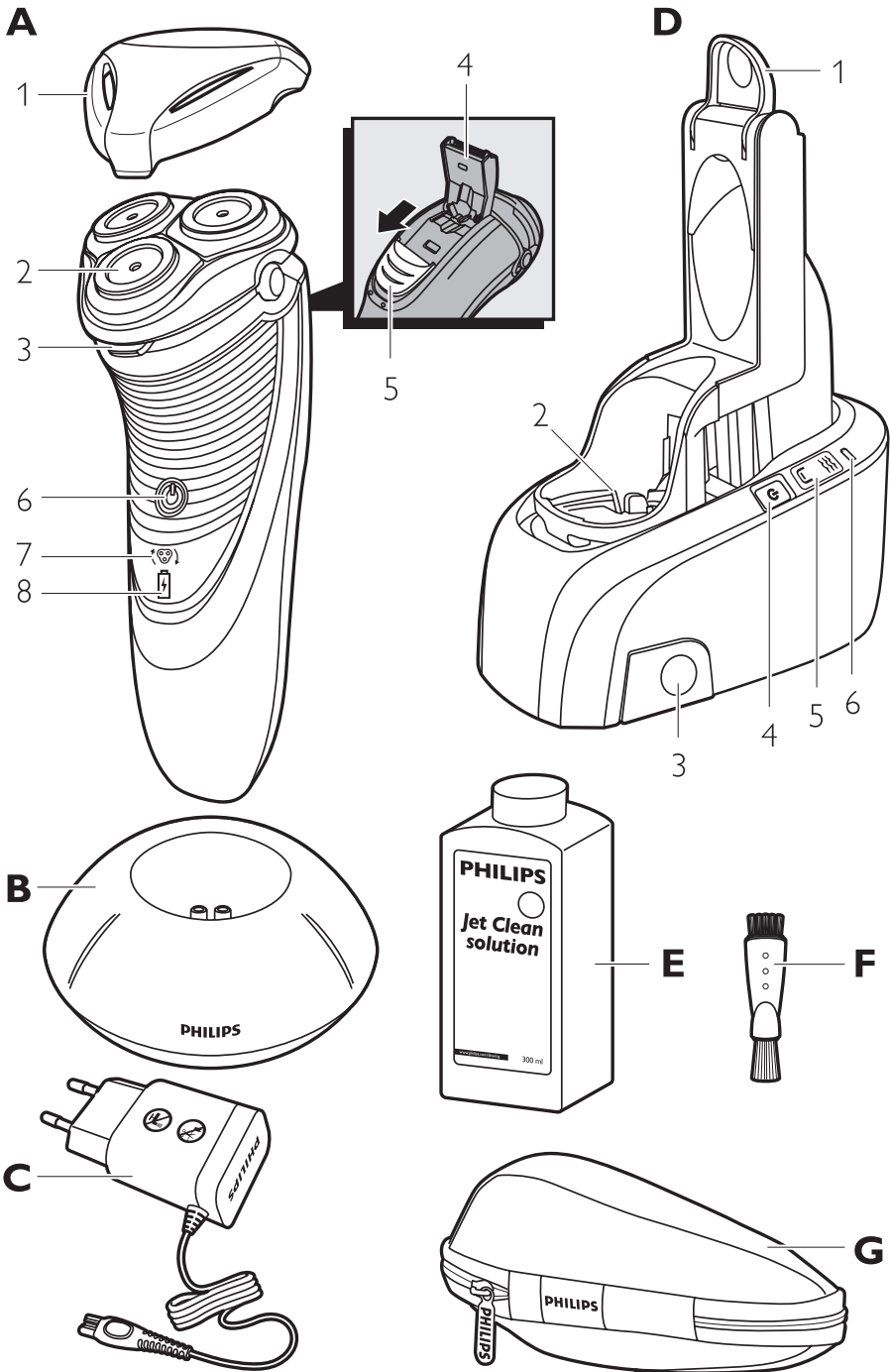

Introduction

Congratulations on your purchase and welcome to Philips! To fully benefit from the support that Philips offers, register your product at www.philips.com/welcome.

Please read this user manual, as it contains information about the wonderful features of this shaver as well as some tips to make shaving easier and more enjoyable.

General description (Fig. 1)

- A Shaver
 - 1 Protection cap
 - 2 Shaving unit
 - 3 Shaving unit release button
 - 4 Trimmer
 - 5 Trimmer release slide
 - 6 Shaver on/off button
 - 7 Shaving head symbol
 - 8 Battery symbol
- B Charging stand (PT927/PT925/PT923/PT920/PT876/PT875 only)
- C Adapter
- D Jet Clean System (PT927CC/PT923CC only)
 - 1 Locking lever
 - 2 Shaver holder
 - 3 Cleaning chamber release button
 - 4 Jet Clean System on/off button
 - 5 Cleaning symbol and 'fluid low' symbol
 - 6 Battery symbol
- E Jet Clean solution (HQ200)
- F Cleaning brush
- G Storage pouch (PT927CC/PT927/PT925/PT923CC/PT920/PT876 only)

Note: You can find the type number on the back of the shaver.

Important

Read this user manual carefully before you use the shaver; the Jet Clean System (PT927CC/PT923CC only) and the charging stand (PT927/PT925/PT923/PT920/PT876/PT875 only). Save the user manual for future reference.

Danger

- Keep the adapter dry.

Warning

- The adapter contains a transformer. Do not cut off the adapter to replace it with another plug, as this causes a hazardous situation.
- The shaver and the Jet Clean System are not intended for use by persons (including children) with reduced physical, sensory or mental capabilities, or lack of experience and knowledge, unless they have been given supervision or instruction concerning use of these appliances by a person responsible for their safety.



- Children should be supervised to ensure that they do not play with the shaver and the Jet Clean System.
- Always unplug the shaver before you clean it under the tap.

Caution

- Never immerse the shaver in water:



- Never immerse the Jet Clean System or the charging stand in water nor rinse it under the tap.
- Do not use the shaver in the bath or in the shower.
- Never use water hotter than 80°C to rinse the shaver.
- Be careful with hot water. Always check if the water is not too hot, to prevent your hands from getting burnt.
- The shaver, the Jet Clean System, the charging stand and the other accessories are not dishwasher-proof.
- Water may leak from the socket at the bottom of the shaver when you rinse it. This is normal and not dangerous because all electronics are enclosed in a sealed power unit inside the shaver.
- Do not use the shaver, Jet Clean System, adapter, charging stand or any other part if it is damaged, as this may cause injury. Always replace a damaged adapter, charging stand or part with one of the original type.
- Use, charge and store the shaver and the Jet Clean System at a temperature between 10°C and 35°C.
- Always place and use the shaver and the Jet Clean System on a surface that is fluid-resistant.
- Only use the adapter, charging stand and accessories supplied.
- Always put the protection cap on the shaver to prevent damage and to avoid dirt accumulation in the shaving heads.
- Only use the Jet Clean System with the original Jet Clean solution (HQ200).
- Always place the Jet Clean System on a stable, level and horizontal surface to prevent leakage.
- When the Jet Clean System is ready for use, do not move it to prevent leakage.
- The Jet Clean System thoroughly cleans but does not disinfect your shaver; therefore do not share the shaver with others.
- Empty the cleaning chamber of the Jet Clean System and clean the cleaning chamber thoroughly by rinsing it with hot tap water every 15 days.
- If the shaver and the Jet Clean System are subjected to a major change in temperature, pressure or humidity, let them acclimatise for 30 minutes before you use them.



Compliance with standards

- This Philips appliance complies with all applicable standards and regulations regarding exposure to electromagnetic fields (EMF) can be safely cleaned under the tap.

General

- The appliance is equipped with an automatic voltage selector and is suitable for mains voltages ranging from 100 to 240 volts.
- The adapter transforms 100-240 volts to a safe low voltage of less than 24 volts.

Charging

It takes approx. 1 hour to fully charge the shaver.

When you charge the shaver for the first time or after a long period of disuse, let it charge until the white battery lights up continuously.

A fully charged shaver provides up to 60 (PT927CC/PT927/ PT925/PT923/ PT923CC/PT920) or 50 shaving minutes (PT877/PT876/PT875/PT870).

The shaving time may be less than 60(PT927CC/PT927/PT925/PT923/ PT923CC/PT920) or 50 shaving minutes (PT877/PT876/PT875/PT870) as a result of your shaving behaviour, your cleaning habits or your beard type.

Charge indications

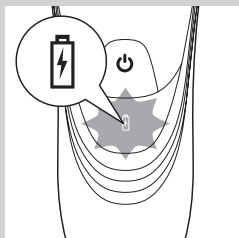

Battery low

- When the battery is almost empty (when there are only 5 or fewer shaving minutes left), the battery light starts to flash orange.
- When you switch off the shaver, the battery light continues to flash orange for a few seconds.

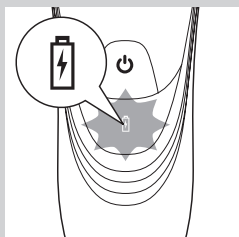

Quick charging

- When you start charging the empty battery, the battery light flashes white and orange.

Note: When the battery light flashes white and orange towards only white, you can have a quick shave of three minutes.

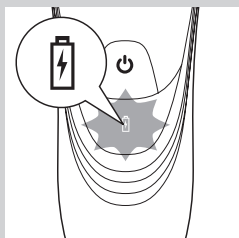

Charging

- When the shaver is charging, the battery light flashes white.

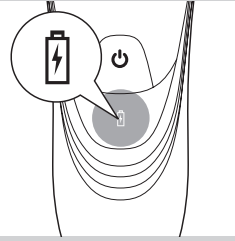

Battery fully charged

- When the battery is fully charged, the battery light lights up white continuously.

Note: After approx. 30 minutes, the battery light goes out to save energy.

Charging with the adapter

Do not charge the shaver in a closed pouch (PT927CC/PT927/PT925/PT923CC/PT923/PT920/PT877 only).

- 1 Put the small plug in the shaver.
- 2 Put the adapter in the wall socket.
 - ▶ The battery symbol show the charging status of the shaver (see section 'Charge indications' in this chapter).

Charging in the charging stand (PT927/PT925/PT923/PT920/PT876/PT875 only)

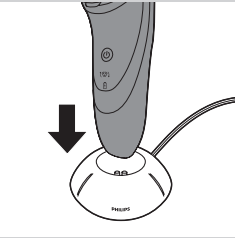

- 1 Put the small plug in the charging stand.
- 2 Put the adapter in the wall socket.
- 3 Place the shaver in the charging stand.
 - ▶ The battery symbol show the charging status of the shaver (see section 'Charge indications' in this chapter).

Charging in the Jet Clean System (PT927CC/PT923CC only)

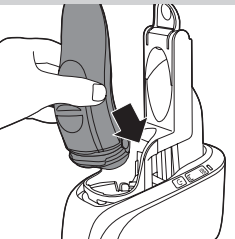

- 1 Put the small plug in the Jet Clean System.
- 2 Put the adapter in the wall socket.
- 3 Place the shaver without protection cap upside down in the shaver holder.

Note: The shaver cannot be placed in the Jet Clean System when the protection cap is on the shaving unit.

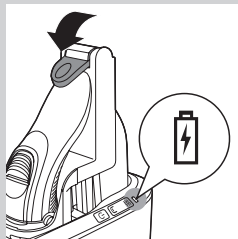

- 4** Push down the locking lever completely to lock the shaver into place.
 - ▶ The battery symbol on the Jet Clean System flashes to indicate that the shaver is being charged.

Note: When the Jet Clean System is performing the cleaning program, the battery symbol is out.

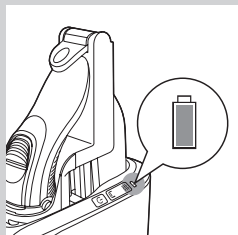

- ▶ When the battery is fully charged, the battery symbol on the Jet Clean System lights up continuously.

Note: After approx. 30 minutes, the battery symbol goes out to save energy.

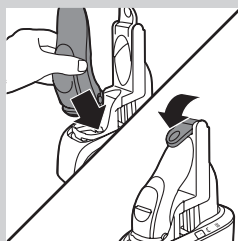

- 5** To remove the shaver from the Jet Clean System, move the locking lever upwards until it does not go any further and remove the shaver.

Using the shaver

Note: You can also use the appliance directly from the mains. Simply connect the shaver to the mains.

Shaving

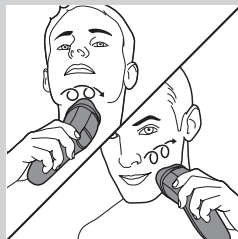

- 1** Press the on/off button once to switch on the shaver.
- 2** Move the shaving heads over your skin. Make circular movements.
 - Your skin may need 2 or 3 weeks to get accustomed to the Philips shaving system.
- 3** Press the on/off button once to switch off the shaver.
- 4** Clean the shaver (see chapter 'Cleaning and maintenance').

Trimming

You can use the trimmer to groom your sideburns and moustache.

- 1** Press the on/off button once to switch on the shaver.
- 2** Push the trimmer slide downwards to open the trimmer.
 - ▶ You can now start trimming.

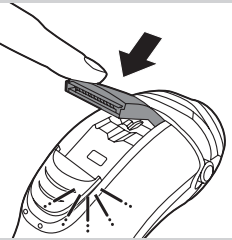
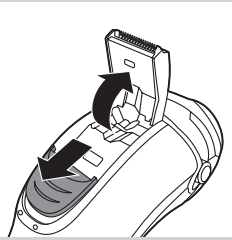

- 3** After trimming, close the trimmer and switch off the shaver.

Cleaning and maintenance

Never use compressed air, scouring pads, abrasive cleaning agents or aggressive liquids such as petrol or acetone to clean the shaver; the charging stand (PT927/PT925/PT923/PT920/PT876/PT875 only) and the Jet Clean System (PT927CC/PT923CC only).

- The best and most hygienic way to clean the shaver is in the Jet Clean System (PT927CC/PT923CC only). You can also rinse the shaver under the tap or clean it with the cleaning brush supplied.
- Clean the shaver after every shave for optimal shaving performance.
- Regular cleaning guarantees better shaving performance.
- For the best cleaning results, we advise you to use the Philips Cleaning spray (HQ110) and (PT927CC/PT923CC only) the Jet Clean solution (HQ200).
- Be careful with hot water: Always check if the water is not too hot, to prevent your hands from getting burnt.

Note: Water may leak from the socket at the bottom of the shaver when you rinse it. This is normal and not dangerous because all electronics are enclosed in a sealed power unit inside the shaver.

Cleaning the shaving unit under the tap



- 1** Switch off the shaver and disconnect it from the mains.
- 2** Press the release button to open the shaving unit.
- 3** Rinse the shaving unit and hair chamber under a hot tap for 30 seconds.

Be careful with hot water. Always check if the water is not too hot, to prevent your hands from getting burnt.

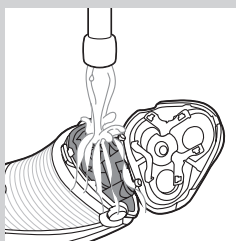

- Rinse the hair chamber and the inside of the shaving unit.



- Rinse the outside of the shaving unit.

- 4** Close the shaving unit and shake off excess water.

Be careful not to hit the shaving unit against anything while shaking off excess water.

Never dry the shaving unit and the hair chamber with a towel or tissue, as this may damage the shaving heads and the coupling spindles.

- 5** Open the shaving unit again and leave it open to let the shaver dry completely.

Cleaning the shaving unit with the cleaning brush



- 1** Switch off the shaver and disconnect it from the mains.
- 2** Press the release button to open the shaving unit.

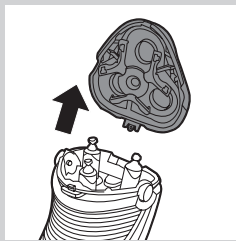

- 3** Pull the shaving unit off the shaver.

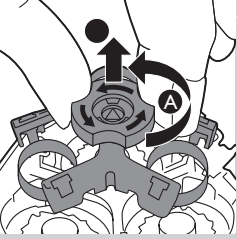

- 4** Turn the lock anticlockwise (A) and remove the retaining frame (B).

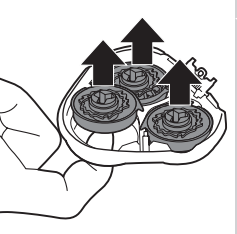

- 5** Remove and clean one shaving head at a time. Each shaving head consists of a cutter and a guard.

Note: Do not clean more than one cutter and guard at a time, since they are all matching sets. If you accidentally mix up the cutters and guards, it may take several weeks before optimal shaving performance is restored.

- Remove the cutter from the shaving guard and clean it with the brush.

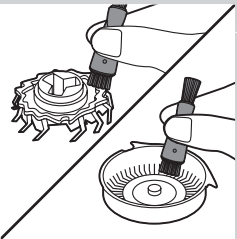

- Clean the inside and outside of the shaving guard with the brush.

- 6** Put the shaving heads back into the shaving unit.

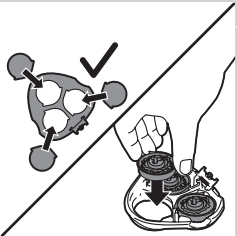

Note: Make sure that the projections of the shaving heads fit exactly into the recesses.

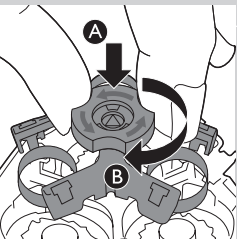

- 7** Put the retaining frame back into the shaving unit (A) and turn the lock clockwise (B).

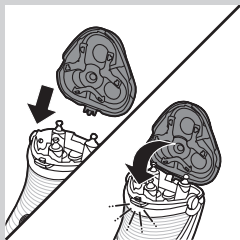

- 8** Insert the lug of the shaving unit into the slot in the top of the shaver. Then close the shaving unit.

Note: If the shaving unit does not close smoothly, check if you have inserted the shaving heads properly and if the retaining frame is locked.

Cleaning the shaving unit in the Jet Clean System (PT927CC/PT923CC only)

The Jet Clean System cleans the shaving unit.

Preparing the Jet Clean System for use

Note: Fill the cleaning chamber before first use and when the 'fluid low' symbol flashes to indicate that the fluid level is too low. When the fluid level drops below the minimum level, the cleaning symbol and the 'fluid low' symbol start to flash and the shaver holder returns to its starting position

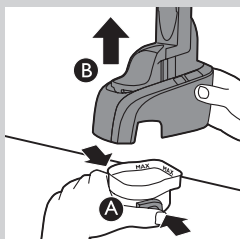
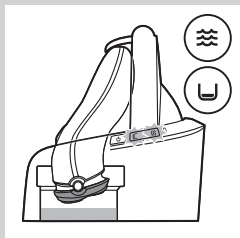

- 1** Simultaneously press the release buttons on both sides of the cleaning chamber (A). Then lift the Jet Clean System off the cleaning chamber (B).

► The cleaning chamber remains behind.

- 2** Unscrew the cap from the bottle with Jet Clean solution (HQ200) and remove the airtight seal.



- 3** Fill the cleaning chamber with Jet Clean solution (HQ200) up to the MAX indication.

Note: Make sure the cleaning chamber is always filled above the MIN indication.

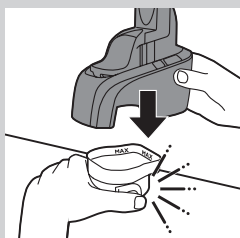

- 4** Place the Jet Clean System back onto the cleaning chamber ('click'). Make sure that the release buttons snap back into place.

When the cleaning chamber is filled with Jet Clean solution, do not move it to prevent leakage.

5 Put the small plug in the Jet Clean System and put the adapter in the wall socket.

► The shaver holder automatically moves to its highest position. The Jet Clean System is now ready for use.

Using the Jet Clean System

1 Place the shaver without protection cap upside down in the shaver holder. Push down the locking lever completely to lock the shaver into place.

► The battery symbol on the Jet Clean System goes on to indicate that the shaver is being charged.

Note: The shaver cannot be placed in the Jet Clean System when the protection cap is on the shaving unit.

2 Press the on/off button on the Jet Clean System to start the cleaning program.

► The battery symbol on the Jet Clean System goes out.

► During the cleaning program, the cleaning symbol starts to flash and the shaver is automatically lowered into the cleaning fluid.

► The shaver automatically switches on and off several times and moves up and down.

► The cleaning symbol flashes throughout the cleaning program, which takes approx. 8 minutes.

► After the cleaning program, the battery symbol on the Jet Clean System goes on to indicate that the shaver is being charged.

Note: If you press the on/off button of the Jet Clean System during the cleaning program, the program aborts and resets. In this case, the cleaning stops flashing and the shaver holder returns to its starting position. The shaver may still be wet and dirty, because the cleaning program has not been finished.

Note: If you remove the adapter from the wall socket during the cleaning program, the program aborts. The shaver holder remains in its current position. When you put the adapter back into the wall socket, the shaver holder moves to its highest position.

Note: When the fluid level drops below the minimum level, the cleaning symbol and the 'fluid low' symbol start to flash with intervals and the shaver holder returns to its starting position

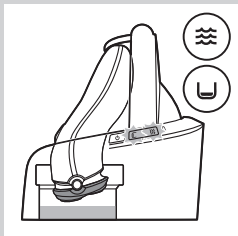
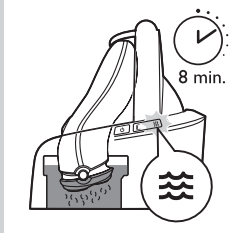
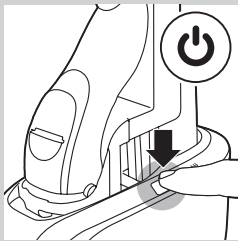
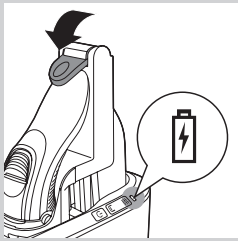

Cleaning the Jet Clean System

Empty the cleaning chamber and clean it thoroughly by rinsing it with hot tap water every 15 days if you use the Jet Clean System daily. Otherwise empty and clean the cleaning chamber at least once a month.

- 1 Clean the outside of the Jet Clean System with a moist cloth.

Never immerse the Jet Clean System in water, nor rinse it under the tap.

- 2 Simultaneously press the release buttons on both sides of the Jet Clean System (A). Then lift the Jet Clean System off the cleaning chamber (B).

► The cleaning chamber remains behind.

- 3 Pour any remaining cleaning fluid out of the cleaning chamber.

You can simply pour the cleaning fluid down the sink, this is not harmful to the environment.

- 4 Rinse the cleaning chamber under a hot tap.

Be careful with hot water. Always check if the water is not too hot, to prevent your hands from getting burnt.

The cleaning chamber is not dishwasher-proof.

- 5 Fill the cleaning chamber with Jet Clean solution (HQ200) up to the MAX indication.

Note: Make sure the cleaning chamber is always filled above the MIN indication.

- 6 Place the Jet Clean System back onto the cleaning chamber ('click').

Make sure that the release buttons snap back into place.

Cleaning the trimmer with the cleaning brush

Clean the trimmer every time you have used it.

- 1 Switch off the shaver and disconnect it from the mains.
- 2 Push the trimmer slide downwards to open the trimmer.

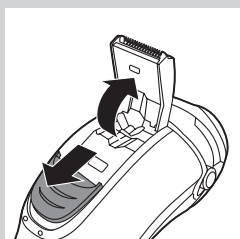
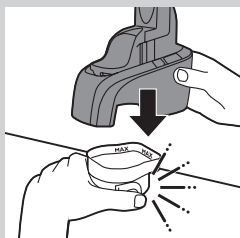
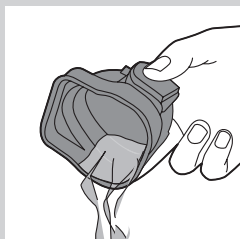
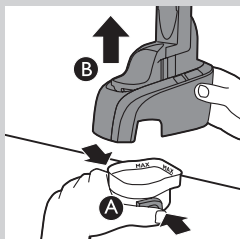

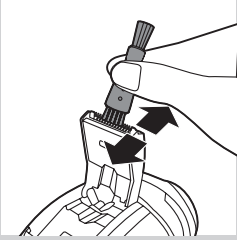

- 3** Clean the trimmer with the short-bristled side of the cleaning brush. Brush up and down along the trimmer teeth.
- 4** Close the trimmer ('click').

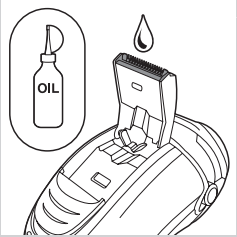

Tip: For optimal trimming performance, lubricate the trimmer teeth with a drop of sewing machine oil every six months.

Storage

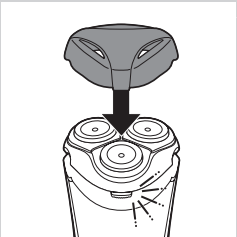

There are several ways to store the shaver or to take it with you when you travel:

- Put the protection cap on the shaver after use to prevent damage and to avoid dirt accumulation in the shaving heads.
- Store the shaver in the pouch supplied (PT927CC/PT927/PT925/PT923CC/PT923/PT920/PT876 only).
- Store the shaver in the charging stand (PT927/PT923/PT920/PT876/PT875 only).
- Put the shaver in the Jet Clean System (PT927CC/PT923CC only). Make sure the protection cap is not on the shaving unit.

Note: If you do not want the shaver to charge while it is stored it in the Jet Clean System, just leave the locking lever in upright position.

Replacement

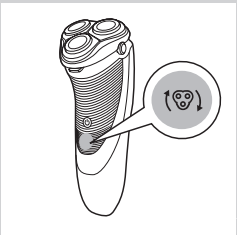

For maximum shaving performance, we advise you to replace the shaving heads every two years.

Replacement reminder

The shaving head symbol will light up to indicate that the shaving heads need to be replaced. Replace damaged shaving heads right away. Only replace the shaving heads with original HQ9 Philips Shaving Heads (PT927CC/PT927/PT925/PT923CC/PT923/PT920) or HQ8 Philips Shaving Heads (PT877/PT876/PT875/PT870).

- 1** The shaving head symbol lights up orange continuously.



2 Switch off the shaver. Disconnect the shaver from the mains and remove it from the Jet Clean System (PT927CC/PT923CC).

3 Press the release button to open the shaving unit.

4 Pull the shaving unit off the shaver.

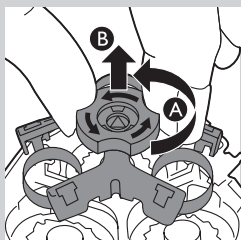

5 Turn the lock anticlockwise (A) and remove the retaining frame (B).

6 Remove the shaving heads and place new ones in the shaving unit.

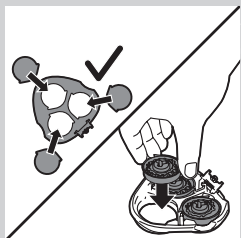

Note: Make sure that the projections of the shaving heads fit exactly into the recesses.

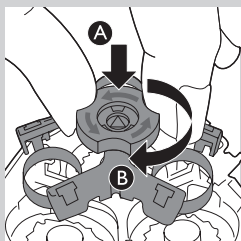

7 Put the retaining frame back into the shaving unit (A) and turn the lock clockwise (B).

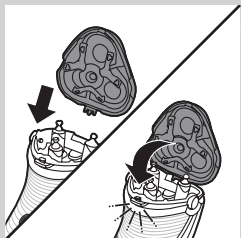

8 Insert the lug of the new shaving unit into the slot in the top of the shaver. Then close the shaving unit.

Note: If the shaving unit does not close smoothly, check if you have inserted the shaving heads properly and if the retaining frame is locked.

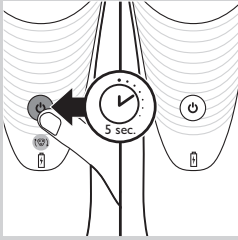

- 9** Press and hold the on/off button for 5 seconds to reset the replacement reminder on the shaver. The orange light goes out.

Ordering accessories

To retain the top performance of your shaver, make sure you clean it regularly and replace its shaving heads at the recommended time.

Shaving heads

- We advise you to replace your shaving heads every two years. Always replace with HQ9 Philips Shaving Heads (PT927CC/PT927/PT925/PT923CC/PT923/PT920) or HQ8 Philips Shaving Heads (PT877/PT876/PT875/PT870).

Cleaning

- PT927CC/PT923CC only: use Jet Clean solution (HQ200) for regular cleaning of the shaving heads.
- Use Cleaning spray (HQ110) to clean the shaving heads thoroughly.

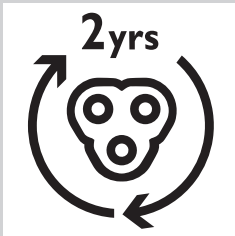

Environment



- Do not throw away the shaver and the Jet Clean System (PT927CC/PT923CC only) with the normal household waste at the end of their life, but hand them in at an official collection point for recycling. By doing this, you help to preserve the environment.



- The built-in rechargeable shaver battery contains substances that may pollute the environment. Always remove the battery before you discard or hand in the shaver at an official collection point. Dispose of the battery at an official collection point for batteries. If you have trouble removing the battery, you can also take the appliance to a Philips service centre. The staff of this centre will remove the battery for you and will dispose of it in an environmentally safe way.

Removing the rechargeable shaver battery

Only remove the rechargeable battery when you discard the shaver. Make sure the rechargeable battery is completely empty when you remove it.

- 1** Disconnect the shaver from the mains, remove it from the Jet Clean System (specific types only) or remove it from the charging stand (specific types only).
- 2** Let the shaver operate until it stops.
- 3** Undo the screws in the back of the shaver and in the hair chamber.
- 4** Remove the front panel and the back panel.
- 5** Bend the 6 hooks aside and take out the power unit.

Be careful, the hooks are sharp.

- 6** Remove the battery.

Be careful, the battery strips are sharp.

Do not put the shaver back into the plugged-in Jet Clean System (specific types only) or charging stand (specific types only) after you have removed the rechargeable battery.

Do not connect the shaver to the mains again after you have removed the rechargeable battery.

Guarantee and support

If you need information or support, please visit www.philips.com/support or read the worldwide guarantee leaflet.

Guarantee restrictions

The shaving heads (cutters and guards) are not covered by the terms of the international guarantee because they are subject to wear.

Troubleshooting

This chapter summarises the most common problems you could encounter with the appliance. If you are unable to solve the problem with the information below, visit www.philips.com/support for a list of frequently asked questions or contact the Consumer Care Centre in your country.

Problem	Possible cause	Solution
The shaver does not shave as well as it used to.	The Jet Clean System (PT927CC/PT923CC only) has not cleaned the shaver properly because the cleaning fluid in the cleaning chamber is soiled or the cleaning fluid level is too low.	Clean the shaver thoroughly before you continue shaving. If necessary, clean and refill the cleaning chamber (see chapter 'Cleaning and maintenance').
	The shaving heads are damaged or worn.	Replace the shaving heads (see chapter 'Replacement').
	Long hairs obstruct the shaving heads.	Clean the shaving heads one by one (see section 'Cleaning the shaving unit with the cleaning brush' in chapter 'Cleaning and maintenance').

Problem	Possible cause	Solution
	You have not inserted the shaving heads properly.	Make sure that the projections of the shaving heads fit exactly into the recesses (see section 'Cleaning and maintenance').
The shaver does not work when I press the on/off button.	The rechargeable battery is empty.	Recharge the battery (see chapter 'Charging') or connect the shaver to the mains.
	The temperature of the shaver is too high. In this case, the shaver does not work.	As soon as the temperature of the shaver has dropped sufficiently, you can switch on the shaver again.
The shaver is not entirely clean after I clean it in the Jet Clean System (PT927CC/PT923CC only).	The cleaning fluid in the cleaning chamber is soiled.	Empty and rinse the cleaning chamber (see chapter 'Cleaning and maintenance').
	The cleaning fluid level is too low. If the fluid volume in the cleaning chamber drops below the minimum level during the cleaning program, the program aborts. The cleaning symbol and the 'fluid low' symbol flash at intervals and the holder returns to its starting position.	Refill the cleaning chamber with cleaning fluid up to the MAX level (see chapter 'Cleaning and maintenance').
	You have used another cleaning fluid than the original Philips cleaning fluid.	Only use Jet Clean solution HQ200.
	You have not closed the locking lever of the Jet Clean System properly, or you have not placed the shaver in the Jet Clean Shaver properly. In these cases the Jet Clean System starts to operate, but the cleaning program is not performed properly.	Place the shaver without protection cap in the Jet Clean System properly. Close the locking lever properly.
The Jet Clean System (PT927CC/PT923CC only) does not work when I press the on/off button.	The Jet Clean System is not connected to the mains.	Put the small plug in the Jet Clean System and put the adapter in the wall socket.
Water leaks from the shaver after cleaning.	This is normal and not dangerous.	During rinsing some water may collect between the power unit and the housing. After rinsing this water flows out through the socket. The power unit is completely watertight so water cannot reach the electronic parts of the shaver. Your shaver continues to be absolutely safe.