

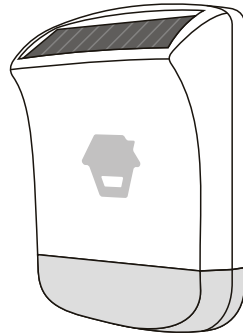

Solar-Powered Siren

User Manual

SPS-260



Jumper Setup

Volume Setting

High (default)

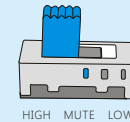

Mute

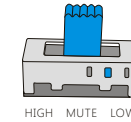

Low

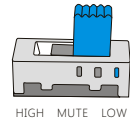

Siren Duration Setting

5minutes

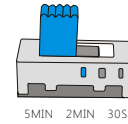

2minutes

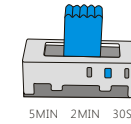

30seconds (default)

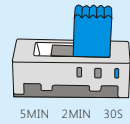

Usage

Getting Started

1. Load the 9V battery.
2. Set the volume and duration of the siren.
3. Start to use by pressing the power button on.

Work as a Wireless Siren

Connect to Alarm Panel

Press the learning button (0.5 seconds), the wireless siren goes into connecting status after one beep is heard. Press **SOS** or **Arm** button on the panel. The wireless siren is connected successfully with the control panel after another beep.

To give up the connection, press the learning button again to exit.

Note: Please don't trigger any accessory during connecting with alarm panel.

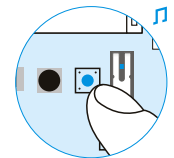

After connected to the alarm panel, the siren will hoot and the strobe light will flash when the alarm panel alarms.

Product Overview

The solar-powered siren is a totally wireless siren, designed to help protect yards, driveways, gardens and all types of other external locations. The strobe siren is battery powered and kept re-charging by the built-in solar panel. The signal transmission is all by wireless radio frequency which achieves significantly wirefree transmission and enhances the flexibility to install. Users can install some outdoor strobe sirens to deter the intruders in Omni-directional guard.

The strobe outdoor siren can be used as a wireless siren by connecting to the control panel as well as a standalone alarm system to work with wireless accessories in same frequency by learning.

PCB Layout

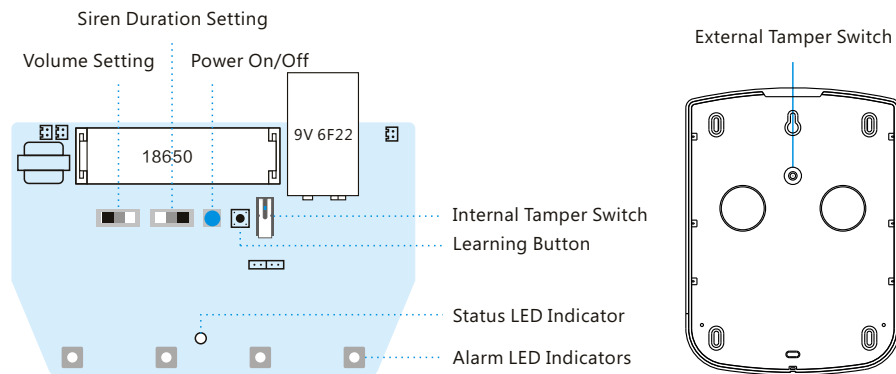

Note: The status LED will flash once every 5 seconds in arm status. It will not flash when in disarm status. The siren will sound immediately if the tamper switch is triggered.

Work as an Alarm Panel

Connect with Wireless Accessories



Press the learning button (0.5 seconds), the system goes into connecting status after one beep is heard. Press test button on accessories or trigger the accessory once. The wireless accessory is connected successfully after another beep. To give up the connection, press the learning button again to exit connecting status after one beep.

After connected with wireless accessories, the siren will hoot and the strobe light will flash to deter the burglar on site when the accessories detect intrusion.

Note: No matter the siren works as a wireless siren or an alarm panel, if disarm is not operated after the siren duration time, the status indicator of siren will flash once every 2 seconds to inform user or patrol police that the alarm system has been triggered. This LED indication lasts for 1 hour.

Enter/Exit Connecting Status by Connected Remote Control

When the siren is working as a standalone alarm system and installed on the wall, newly purchased accessories may not easy to connect with the siren. With this function, user can easily connect the accessories to the siren without dismantling the siren from the wall.

1. Press  on the remote control 3 times (within 5 seconds) to enter service mode.
2. Then press  3 times (within 5 seconds) to enter connecting status.

A longer beep is heard from the siren means it enters connecting status, press test button on the newly purchased accessory or trigger the accessory once. Another beep is heard from the siren, the accessory has been successfully connected with the siren.

Press  on remote control to exit connecting status after a short beep.

Installation

Service Mode

The service mode is to prevent triggering the alarm when you mount the siren on the wall.

When the remote control is connected with the siren, press  on remote control 3 times (within 5 seconds), the siren goes into service mode when a long beep is heard. During this period, the siren will not alarm but beep even if the tamper switch or the sensors connected are triggered. This brings you convenience on installation.

Press  on remote control to exit service mode after a short beep.

Remove the fixing screw from the bottom edge of the siren housing and carefully remove front cover.

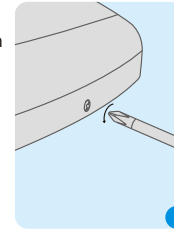

Hold the mounting plate in position and mark the positions of the four mounting holes. A spirit level placed on the water-proof casing will ensure a perfect level.

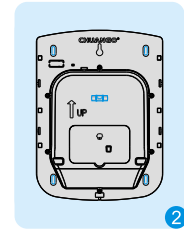

Drill four holes and fit the wall plugs, and then fit supplied fixing screws in the holes.

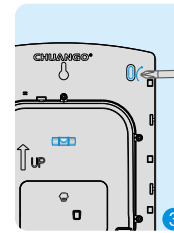

Hinge the front cover locating tabs over the top edge of the back plate and carefully push the base of the siren cover into place. Secure the siren cover in place by refitting the fixing screw in the bottom edge of the cover.

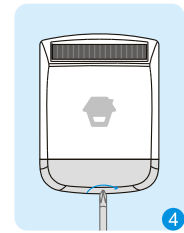

Specifications

Backup Power	18650 3.7V 1200mAh rechargeable lithium battery x 1 9V 6F22 battery x 1
Solar Panel Output Current	2000LUX illumination \geq 4mA (in sunlight)
Maximum Alarm Current	\leq 500mA
Wireless Receiving Distance	\leq 80m (in open area)
Operation Condition:	Temperature $-10^{\circ}\text{C} \sim +55^{\circ}\text{C}$ Relative Humidity \leq 80% (non-condensing)
Maximum Siren Volume	110dB
Static Current	\leq 1mA
Standby Time	\leq 30 days (in case of no sunlight)
Wireless Receiving Frequency	315MHz or 433.92MHz (\pm 75KHz)
Housing Material	PC + ABS + ANTI-UV
Size (L x W x H)	309 x 230 x 79.7mm

CHUANGO®

产品型号	SPS-260	部件名称	说明书
设计	林寿	材料	80克书写纸
印刷尺寸	210X285mm	成品尺寸	210X142.5mm
工艺	折页	版本	Ver: SPS-260-EN-1407-V2.0-1
注: 双色、双面印刷			