



## ★ OPERATING AND MAINTENANCE MANUAL ★

Language: English



### **INSTRUMENTS WASHER MINI-WASH**

**M9016/2**

**6 WASHING PROGRAMS**

**A+ ENERGY EFFICIENCY**

**3 WASHING TEMPERATURE**





<THE MACHINE IS FOR PROFESSIONAL USE ONLY >

<THE USE IS PERMITTED ONLY QUALIFIED PERSONNEL TO DO>

<CONTACT THE QUALIFIED INSTALLER FOR THE IMPLEMENTATION OF THEEQUIPMENT>

<THE MACHINE CANNOT BE PUT IN WORK IN A ENVIRONMENT AT RISK OF EXPLOSION>

- ⇒ Read carefully the instructions when buying the machine and before storing / installing / using it.
- ⇒ This Manual, that provides useful information regarding the safety during the IMPLEMENTATION OF THE EQUIPMENT, INSTALLATION, USE, etc., is part of the product itself and it must be delivered to the user, who has to store and carefully read it before starting each step of the service provided by the machine.
- ⇒ Do not remove, tear or rewrite neither partly this Manual.
- ⇒ Keep the Manual in areas protected from moisture and heat for future reference.
- ⇒ This Manual contains the “CE” Declaration of conformity.

	<p><b>THE MACHINE MUST BE INSTALLED AND USED ONLY ACCORDING TO THE RULES LAID DOWN BY THE MANUAL U.M.M.</b></p>	
---	---	---

**NOTE:**

Images, designs, and texts included in this manual are producer's property.

All rights reserved. It is forbidden even partial reproduction of drawings, images and texts.

The manufacturer reserves the right to alter without notice the info in this manual.

<b>1</b>	<b><u>INTRODUCTION.....</u></b>	<b>5</b>
1.0	PURPOSE OF THE USER MANUAL AND MAINTENANCE	5
1.1	USER'S PROFILE	5
1.2	EXPECTED USAGE	5
<b>2</b>	<b><u>GENERAL WARNINGS .....</u></b>	<b>6</b>
2.0	CAUTIONS, WARNINGS, PROHIBITIONS	6
2.1	WARRANTIES AND LIABILITY	8
2.2	ENVIRONMENTAL CONDITIONS ALLOWED	9
2.3	ELECTROMAGNETIC COMPATIBILITY	9
2.4	REQUIREMENTS OF THE LOCAL WHERE THE EQUIPMENT IS INSTALLED.	10
2.5	USE NOT PERMITTED	10
<b>3</b>	<b><u>RECOMMENDATIONS AND GENERAL SAFETY .....</u></b>	<b>10</b>
<b>4</b>	<b><u>PREVENTIVE EDUCATION (TITLE) USER (OPERATOR).....</u></b>	<b>11</b>
4.0	DEVICES FOR PERSONAL PROTECTION	11
	TO BE USED TO PREVENT THE ONSET OF RESIDUAL RISKS	11
4.1	CONDUCT OF MACHINE BY USER	12
<b>5</b>	<b><u>FAILURES, MALFUNCTIONS OR OTHER INCONVENIENCES .....</u></b>	<b>12</b>
<b>6</b>	<b><u>MACHINE DESCRIPTION.....</u></b>	<b>13</b>
6.0	PUSH BUTTON CONTROLS	13
<b>7</b>	<b><u>INSTALLATION INSTRUCTIONS .....</u></b>	<b>14</b>
7.0	METHOD OF CONNECTING FITTINGS GUIDELINES FOR WATER SUPPLY	14
7.1	DISCONNECT THE FITTING OF SAFETY	14
7.2	DISCONNECT THE WASHING MACHINE	15
7.3	COLD WATER CONNECTION	15
7.4	HOT WATER CONNECTION	15
7.5	POSITIONING OF THE WASHER	15
7.6	CONNECTING THE DRAIN PIPES	15
7.7	ELECTRICAL CONNECTION	15
7.8	SALT	16
7.9	RINSE AID	16
7.10	DETERGENT	17

<b>8</b>	<b><u>PREPARATION OF INSTRUMENTS TO WASH .....</u></b>	<b><u>19</u></b>
<b>9</b>	<b><u>INSTRUCTIONS FOR USE .....</u></b>	<b><u>19</u></b>
<b>9.0</b>	<b>POWER EQUIPMENT</b>	<b>19</b>
<b>10</b>	<b><u>TABLE OF PROGRAMS OF WASHING.....</u></b>	<b><u>21</u></b>
<b>11</b>	<b><u>CLEANING AND MAINTENANCE.....</u></b>	<b><u>22</u></b>
<b>12</b>	<b><u>TECHNICAL FEATURES.....</u></b>	<b><u>23</u></b>
<b>13</b>	<b><u>ANOMALIES AND SOLUTIONS .....</u></b>	<b><u>25</u></b>
<b>14</b>	<b><u>PRODUCT IN ACCORDANCE WITH THE COMMISSION DELEGATED REGULATION (EU) NO 1059/2010.....</u></b>	<b><u>27</u></b>
<b>15</b>	<b><u>WARRANTY CERTIFICATION .....</u></b>	<b><u>28</u></b>
<b>16</b>	<b><u>DECLARATION OF INSTALLATION .....</u></b>	<b><u>29</u></b>

# 1 INTRODUCTION

**We thank you for choosing a REVERBERI machine.**

The User and Maintenance Manual (U.M.M.) has been realized in order to provide general knowledge of the machine and to give the transport, use and maintenance instructions and all the necessary details for the installation, for the correct use and for the proper functioning.

We ask you kindly to CAREFULLY read the manual BEFORE CARRYING OUT ANY OPERATION ON THE MACHINE.

In case you need another copy of the Use and Maintenance Manual (U.M.M.) you are invited to forward your motivated request to the CONSTRUCTOR, quoting the serial number on the title of this post or on the name plate on the back of the machine.

## 1.0 PURPOSE OF THE USER MANUAL AND MAINTENANCE

The following Manual aims to provide user all the information about Washing machine in order to warrant:

- ✓ the correct installation
- ✓ the optimal use.
- ✓ a safe and reliable functioning.
- ✓ the requirements for proper and regular maintenance and for the periodic replacement operations of the components.

## 1.1 USER'S PROFILE

Two kinds of profiles can use the washing machine and have to read carefully this Manual:

### **The Administrator**

The administrator is the responsible for the clinic or doctor's office, or rather the person responsible for the protocol of hygiene and washing process. The administrator is also responsible for the OPERATORS' training and for the proper operation and maintenance of the equipment. Must have adequate training for all operations to be performed and for safe use.

### **The Operators**

The operators are those who use the washing machine according to the instructions received from the ADMINISTRATOR.



## 1.2 EXPECTED USAGE

The Reverberi washing machine are used for **cleaning** tools in general medicine studios, dental studios, veterinary studios and facilities for personal hygiene and beauty treatment.

These washer can be also used by beauticians, tattoo artists, body piercers, hair stylist and podiatrist.

**Do not use the machine for purposes other than those for which it was created. It is important to ensure that the value of ground resistance is efficient and well coordinated with the electrical protections of the implant, in order to avoid electrical interferences to the washer.**



	CAUTION, IT IDENTIFIES A SOURCE OF HEAT, THERE MAY BE AN UNSAFE TEMPERATURE
	CAUTION, IT IDENTIFIES A GENERIC DANGER, THERE MAY BE A DANGEROUS SITUATION
	IT IDENTIFIES THE PROTECTIVE EARTH TERMINAL

	<ul style="list-style-type: none"> <li>• This symbol indicates that the product is covered by 2002/96/CE European Directive.</li> <li>• Please inform yourself about the local separate collection system for electrical and electronic products.</li> <li>• Comply with local rules and do not dispose of your old products with your normal household waste. Proper disposal of the product will help prevent potential negative consequences for the man's health and for the environment.</li> </ul>
---	--

## 2 GENERAL WARNINGS

THE MANUFACTURER DO NOT PROVIDE WARRANTIES ABOUT THE SUITABILITY OF THE TECHNICAL / LEGAL ROOM WHERE THE EQUIPMENT IS INSTALLED AND ALL THE SUPPORT SERVICES AT THE SAME, ALTHOUGH THE U.M.M. OFFERS IMPORTANT INFORMATION FOR A PROPER INSTALLATION. REGARDING THIS ASPECT THE USER IS RECOMMENDED TO USE THE ADVICE OF QUALIFIED PERSONNEL EXPERT IN THE FIELD, FOR THE RESPECT OF EVENTUAL LAWS AND/OR REGULATIONS TOO.

DO NOT ALLOW ANYONE TO USE THE MACHINE WITHOUT FIRST:

- READ AND UNDERSTAND ALL THE INDICATIONS INCLUDED IN THE U.M.M.
- RECEIVE SUITABLE INSTRUCTION FOR THE SAME CONDUCTION BY A PERSON AUTHORIZED.

THE MACHINE IS BUILT IN COMPLIANCE WITH CURRENT STANDARDS. PLEASE BEFORE PROCEEDING WITH THE INSTALLATION, USE, MAINTENANCE AND REPARATION (AND RELATED), READ CAREFULLY THIS USER AND MAINTENANCE MANUAL BECAUSE IT CONTAINS ALL THE NECESSARY INFORMATION FOR A PROPER USE AND OPERATION, DESIGNED TO PREVENT ACCIDENTS.

THIS U.M.M. MUST BE CONSIDERED PART OF THE PRODUCT ITSELF AND IT MUST REMAIN PART OF IT FOR ALL THE PRODUCT LIFE.

The frequencies of monitoring and maintenance, prescribed by the U.M.M., refer to the minimum necessary to ensure efficiency, safety, and duration of the equipment in normal working conditions. Surveillance will still be constant and will act promptly in cases of anomalies.

All our equipment are subject to continuous technological development. We must therefore, from time to time, subject to the possibility of making changes regarding the construction and endowment, which can modify the operating features.

The electrical system, as well as the continuity of the protective circuit, has been tested by REVERBERI at the factory so it is general and guaranteed perfect and functioning.

Any damage caused by the buyer for incorrect links, automatically excludes any warranty on the unit.

The position of the CE plaque is visible EC.

### 2.0 CAUTIONS, WARNINGS, PROHIBITIONS

1° LIQUIDS OR DUST SHOULD NOT FALL/ENTER INTO THE APPARATUS. SEEK TO MAKE INSTALLATION THAT AVOID THESE PROBLEMS.

2° FLAMMABLE LIQUIDS OR POWDERS SHOULD NOT BE USED NEAR THE MACHINERY.

3° IT IS FORBIDDEN TO EVERYONE AND / OR TO OPERATORS WITH HEART DISORDERS AND PACEMAKERS, TO APPROACH THE MACHINERY WITHOUT FIRST CONSULTING THE DOCTOR.

4° BEFORE USING THE DEVICE, IT IS NECESSARY TO KNOW ALL THE OPERATIONS AND CONTROL DEVICES. LEARNING CONCEPTS OF THIS SHOULD BE MANDATORY BEFORE BEGINNING. PEOPLE NOT ATTACHED AND WITHOUT THE APPROPRIATE CONCEPTS ARE NOT ALLOW USING THE MACHINE.

5° READ ALL SAFETY INFORMATION CONTAINED HEREIN AND UNDERSTAND ALL THE PLATES (REPORTS SECURITY) ON THE UNITS. THE SIGNS ON THE UNIT MUST ALWAYS BE READ WELL, REPLACE THEM IN CASE THEY GET WORN OR DAMAGED.

6° NO WARRANTIES PROVIDED ON GOOD FUNCTIONAL OR ON SAFETY OF THE USER AND / OR ENABLED PERSON AND / OR ANY OTHER PERSON AND / OR THE ENVIRONMENT, IN THE EVENT THAT:

- THE PROVISION OF ELECTRICITY NOT COMPLY WITH THE REQUIREMENTS OF THIS LAW AND U.M.M.;
- THE EQUIPMENT ONCE INSTALLED AND PUT IN SERVICE NOT COMPLY WITH THE REQUIREMENTS STATED IN THIS U.M.M.;
- THE DEADLINES SET MAINTENANCE ARE NOT RESPECTED

7° THE OPERATING SAFETY EQUIPMENT ALLOWS IT TO BE INSTALLED AND PUT INTO SERVICE BY QUALIFIED PERSONNEL RESPONSIBLE TO FOLLOW THE INSTRUCTIONS GIVEN IN THIS U.M.M. AND RULES.

8° THOSE WHO ARE NOT ABLE TO INSTALL, START UP OR USE SAFETY ALONE OUR PRODUCT, BECAUSE OF PHYSICAL, SENSORY OR MENTAL INABILITY, OR THROUGH INEXPERIENCE OR NO KNOWLEDGE, THEY MAY CARRY OUT THE BUSINESS SPECIAL SUPERVISION ONLY IF INSTRUCTED BY COMPETENT PEOPLE, WHO TAKE FULL RESPONSIBILITY.

9° YOU MAY NOT USE WATER TO WASH THE MACHINE PARTS (EXCEPT FOR SOME ACCESSORIES, NOT EXPRESSLY REPORTED)

10° IT IS FORBIDDEN TO REMOVE AND / OR TAMPER WITH THE LABELLING AND SYMBOLS FROM ORIGINALLY AFFIXED REVERBERI.

11° DO NOT PUT ANY OBJECT OVER EQUIPMENT,

12° DO NOT TOUCH THE DEVICE WITH BODY PARTS WET AND / OR BARE FEET.

13° DO NOT PULL THE ELECTRICAL CABLES OR THE SHEATHS OF THE ELECTRICAL INSTALLATION

14° DO NOT START BEFORE CHECKING DIRECTLY AND VISUALLY THAT IN OR ON THE MACHINERY THERE IS NO FOREIGN BODY.



15° IN ANY SPECIFIC CIRCUMSTANCES ALWAYS USE APPROPRIATE PROTECTIVE CLOTHING OR TOOLS.

16° NEVER INSERT THE HANDS OR OTHER PARTS OF THE BODY IN COMPONENTS NOT PERFECTLY FIXED OR IN PARTS NOT COMPLETELY VISIBLE FROM THE PERSON WHO IS OPERATING.

17° KEEP THIS U.M.M. ALWAYS AT HAND AND AT DISPOSAL OF THE ENABLED USER AND DURING INSTALLATION AND / OR MORE VISITS AND USE.

18° THE U.M.M. DUPLICATION IS RECOMMENDED (AUTHORIZED BY THE MANUFACTURER FOR THE INTERNAL USE ONLY) AND IT IS AVAILABLE FOR THE PERSONAL AND ENABLED USER, KEEP THEN THE ORIGINAL COPY IN A SAFE AND EASY AVAILABILITY.

	<b>DURING THE OPERATION OF THE MACHINE, THE SURVEILLANCE OPERATOR MUST BE CONTINUED</b>	
---	---	---

	<b>ANY TOOLS FOR THE OPENING OF ELECTRICAL PANEL OR PROTECTIONS MUST BE STORED AND / OR ACCESS ONLY TO AUTHORIZED PERSONS AND EDUCATED. IT IS OUT OF LAW LEAVE THESE TOOLS AND ACCESSIBLE TO ALL PACKING.</b>	
---	---	---

## 2.1 WARRANTIES AND LIABILITY

The MANUFACTURER ASSUMES NO LIABILITY FOR DAMAGES CAUSED ON THE MACHINE, ON THINGS, ANIMALS AND / OR PERSONS, MAKING ANY KIND OF WARRANTY INVALID IMMEDIATELY IF:

- THE INSTALLATION OF THE APPLIANCE IS NOT DONE BY QUALIFIED PERSONNEL IN ACCORDANCE WITH THE RULES AND MAY BE REPORTED AS IN THE DECLARATION OF CONFORMITY
- THE START UP OF THE EQUIPMENT IS NOT PERFORMED BY A QUALIFIED PERSONNEL AND / OR USER NOT COMPLY WITH THE INSTRUCTIONS GIVEN IN THIS USER AND MAINTENANCE MANUAL OR AS RESULT OF ANY OPERATION NOT SPECIFICALLY DESCRIBED.
- VERIFY CAREFULLY DURING THE READING OF U.M.M. THE CORRESPONDENCE WITH THE PARTS OF THE EQUIPMENT, CHECKING:
  - THE PARTS HAVE NOT BEEN DAMAGED DURING THE TRANSPORTATION AND HAVE BEEN DELIVERED INTEGRAL,
  - THERE ARE ALL THE SAFETY SYMBOLS.

DO NOT PROCEED TO USE THE WASHING MACHINE IF ALL ITEMS DESCRIBED ABOVE DO NOT EXIST:

- THE MANUFACTURER ASSUMES NO RESPONSIBILITY FOR DAMAGES CAUSED TO THE SAME DEVICE ON PEOPLE, ANIMALS AND / OR PROPERTY, IF ANY ANOMALIES IS NOT REPORTED WITHIN 30 DAYS OF RECEIPT OF GOOD TO MANUFACTURER. IN THESE CASES ANY TYPE OF WARRANTY BECOME INVALID AUTOMATICALLY.
- TO COMPLY WITH THE TRACEABILITY OF THE WASHING MACHINE ANY CHANGE OF ADDRESS OF THE SAME MACHINE MUST BE COMMUNICATED TO THE MANUFACTURER / DEALER.  
ANY CHANGES MADE ON ITS DEVICE or safety devices, WHICH MAY AFFECT THE FUNCTIONS PROVIDED BY THE MANUFACTURER and the risks of the risk analysis, included in the "Technical Construction File", WILL BE FULL RESPONSIBILITY OF THE USER. AS CHANGE IS MEANT ALSO THE FAILURE OF THE INSTRUCTIONS, REPRESENTATIONS AND EFFORT NONCONFORMING AND THE USE OF PARTS NOT ORIGINAL.

Any change, even if not substantial, must be communicated by registered post and also approved by the MANUFACTURER, THAT will approve THE CHANGES only if, such amendment, shall not constitute implementations of risk analysis AND THE risks of the machine.

Any change made without notice to the MANUFACTURER, will constitute CANCELLATION OF the "CE" Declaration of Conformity, making void any warranty and guarantee by the same.

The manufacturer is not responsible for:

- the placement of a protection mechanisms against overcurrent for power conductors of the electrical equipment, which must be placed upstream of the apparatus and duly reported.
- the installation of a power plug to be placed between the electrical panel and the electrical appliance in place of the existing installation.

## WARRANTIES CONDITIONS

This appliance is guaranteed for one year (12 months) from the date of purchase, on the whole territory of the European Union; the date of the delivery note / invoice will be the authentication.  
The device is used for professional use.

During this period, the manufacturer will repair or replace for free those pieces that, at its own sole discretion, were to be originally defective, with only the reimbursement of travel expenses incurred by the technicians of the "Service Centre", at doorstep or totally free if the equipment is delivered to BARCO di Bibbiano (RE).

Defective parts replaced become the property of the manufacturer.

If the defect is not repaired, the manufacturer may avoid the termination of the contract by the customer by offering free replacement of the property.

Are not covered by the warranty the damaged parts for transport / shock for bad or improper installation / use, through neglect or misuse, tampering by unauthorized persons, damages weather or other natural events or other causes not dependent on REVERBERI, supplies and / or subjected to wear / low.

Further or other claims for damages, in addition to those provided by law, are excluded.



The manufacturer will charge the cost of repair if the returned product is not covered under warranty.

Interventions for alleged defects or casual checking shall be borne by the customer.

Any repair of transport to and from the "Technical Assistance Centre" of BARCO di Bibbiano (RE) is done at the expense and responsibility of the customer.

The technical staff, when called to repair, will be sent in time only compatible with the business needs of the manufacturer.

Any use bans imposed by the Health Authority or by other competent bodies, do not entitle the buyer to demand the surrender or to ask for damages.

Any difference on the exterior color or color effects of the various parts making up the unit are not considered defects: the differences may be e.g. due to the manual workers.

The inability to ensure substitutability of parts that make up the set with pieces from standard / freshmen / supplies purchased specifically different and not as a replacement is not considered a defect.

In case of repair / replacement of defective parts or replacement of the equipment during the warranty period, the warranty remains unchanged: it always starts from the original date of purchase of the unit.

As nothere reported The Terms and Conditions listed on the commercial documentation / sales catalogue in force at the time of purchase remain valid.

## **2.2 ENVIRONMENTAL CONDITIONS ALLOWED**

TEMPERATURE, HUMIDITY AND ALTITUDE

See Paragraph in particular.

## **2.3 ELECTROMAGNETIC COMPATIBILITY**

Install the unit where electromagnetic interference comply with the limits permitted by the rules and with the presence of electric and electronic equipment.

RADIATION EXPOSURE

The appliance is not intended to be used to direct exposure to:

- Non-ionizing radiation of the sun, being the same to be placed indoor and / or repaired
- X-ray radiation, microwave radiation, laser radiation, etc...

In the event that, in the environment where the unit is placed, there is a risk of radiation directly on it, specific measures to protect exposed areas must be taken by the purchaser.

USE IN EXPLOSIVE ENVIRONMENT

The device cannot be used in any way in the environment where there is a risk of explosion or in a potentially explosive environment.



**IT IS FORBIDDEN TO USE THE EQUIPMENT IN EXPLOSIVE ENVIRONMENTS SUCH OR CONSIDERED.**

## **ILLUMINATION IN THE WORKPLACE**

The environment in which the washing machine is installed must meet the requirements listed on the Directive 89/654/EEC concerning the workplace and the requirements of the RULES FORCE THE INSTALLATION SITE.



**Proper lighting can, in some cases, avoid or limit an injury to the operator.**

## **2.4 REQUIREMENTS OF THE LOCAL WHERE THE EQUIPMENT IS INSTALLED.**

The local should:

- be free of debris and / or residues of various kinds of flammable or potentially dangerous operation;
- provide a specific room for washing, away from the patient.
- have doors (accesses) appropriate to the size of the machine, ensure a suitable floor for the mass flow of the machine, ensure a perfectly level floor, be free, at the area of installation, strong drafts or substantial temperature changes;
- ensure good ventilation and air exchange with the provision of specific natural ventilation openings.

## **2.5 USE NOT PERMITTED**

It is not allowed:

- THE USE of the machine if you have not INSTALLED in accordance with APPLICABLE RULES and BY AUTHORIZED PERSONNEL,
- the use of the appliance by USERS not authorized by the superior role (or employer),
- the use of the appliance by USERS not trained to manage it,
- the use the equipment for purposes other than those expected and stated in the Declaration of Conformity,
- the use the equipment in environments with explosive atmosphere or where there are similar risks,
- elaborate or otherwise alter the unit cycles and performance
- use or use accessories other than the original operation,
- use replacement parts other than original
- alter the electrical system and safety devices connected to them,
- NOT TO COMPLY WITH THE INSTRUCTIONS, THE OBLIGATIONS AND PROHIBITIONS CONTAINED IN THIS MANUAL AND ON THE UNIT ITSELF.

## **3 RECOMMENDATIONS AND GENERAL SAFETY**

- The user is responsible for installation, proper use and maintenance of the washing machine in accordance with the instructions in this manual. If necessary, contact your local Technical Support.
- The washing machine should not be used with flammable gases or vapors.
- For the wash of materials, carefully follow the instructions provided by the manufacturer of the materials.
- Do not exceed load limits specified in this manual
- Do not remove the identification number or any other labels from the serial number or other washing machine.
- To prevent electrical short circuits, do not spill water or other liquids on the machine.
- Turn off the machine and unplug the power cord before inspecting, make operations, maintenance or repairs of the washing machine.
- Never turn off the machine with the door closed.
- Keep the original packaging carefully for any transport.
- The repairs should be made by individuals authorized by the manufacturer and using only original parts.

*In case of transport:*

- The machine should be empty
- Use the original packaging or other suitable packaging.
- Use a reliable transporter



**Any intervention on, determined by a malfunction, must mandatory be performed by qualified personnel to do so.**



**In case of replacements of equipment parts, use original spare parts, to avoid causing variations in performance and / or reduce the level of safety.**



**Each cleaning, checking and / or maintenance must be performed by authorized personnel and authorized to do so in accordance with the requirements described in this U.M.M.**



**Failure to follow the instructions in this manual may cause danger to the user.**

## **4 PREVENTIVE EDUCATION (TITLE) USER (OPERATOR)**

The user, who has the responsibility for operation of the unit, must be educated and trained person in advance by the Employer (or his guardian), that person must **MANDATORY** read / **UNDERSTAND** all instructions in this MUM. The manufacturer is not liable for any direct or indirect damages caused by people who have used the device without having received proper education and qualifications relevant to the conduct thereof and in which they did accordingly misuse.

### **4.0 DEVICES FOR PERSONAL PROTECTION**

TO BE USED TO PREVENT THE ONSET OF RESIDUAL RISKS

According to legal requirements dictated by the regulations on this subject it is the duty of Head of Hygiene and Safety to analyse the potential risks people are exposed to and to wear appropriate Personal Protective Equipment (P.P.E.) in the Studio where the equipment is installed. Regardless of the risk analysis of Hygiene and Safety Manager, in all cases mentioned in this Section are shown the **MANDATORY** P.P.E. that the exposed personnel must use while approaching the machine. The use of additional D.P.I. is at the discretion of the Head of the Hygiene and Safety in the Studio where the equipment is installed.

Use:

1. safety shoes to ensure a sufficient level of electrical / mechanical isolation /
2. flame retardant protective clothing.
3. appropriate gloves



**IN NORMAL CONDITION OPERATIONS NEVER STOP THE DEVICE REMOVING THE POWER SUPPLY DIRECTLY FROM THE GENERAL SWITCH BUT STOP THE CONTROL PANEL FIRST.**

### **EMERGENCY STOP WASHING MACHINE**

In case of emergency there is a need to stop THE equipment the operator must take prompt action on the connection socket / plug off, grabbing the plug **WITHOUT** pulling the cable. In this regard it should be noted that the plug must always be free of any material or furniture and always visible.

## 4.1 CONDUCT OF MACHINE BY USER

The user's tasks are:

- monitor the operation of the appliance, acting promptly in case of malfunctions;
- check the constancy of performance and integrity of the devices used and promptly shut down the device in case of malfunctions.



It is **FORBIDDEN** to leave the unit without first having switched it off at the end of the work



*The intervention of the user will always be subject to compliance with the symbols placed on the machine and the requirements dictated by this U.M.M.*

### RESIDUAL DANGERS AND SIGNALS

To highlight to the user, to those exposed and to the authorized personnel all the residual risks to which attention must be paid, it was decided to affix to the machine standardized symbols highlighted in the following pages.

The dangers to which it could not apply a total protection, because it would make the machine difficult to use, inhibiting their intended use, are as follows:



- 1 Electrical dangers inside the control panel or any derivations of the unit.



- 2 Thermal dangers resulting from the contact of the user's arms when the respective electrical resistance is operating.

## 5 FAILURES, MALFUNCTIONS OR OTHER INCONVENIENCES

In case of failures, malfunctions or other problems not covered in this U.M.M., call the manufacturer directly. The address is as follows.

### REVERBERI ARNALDO S.R.L.

Via Don L. Sturzo, 6 – 42021 BARCO di Bibbiano (RE) – ITALIA

Tel. +39 (0) 522 875159

Fax.+39 (0) 522 875579

e-mail: reverberi\_a@libero.it



**Any work on the machine, determined by a malfunction, must necessarily be performed by qualified personnel.**



**In case of replacements of equipment parts, use original spare parts, to avoid causing variations in performance and / or reduce the level of safety**



**Each cleaning, checking and / or maintenance must be performed by authorized personnel and authorized to do so in compliance with the requirements given in this U.M.M.**

## 6 MACHINE DESCRIPTION

Instruments washer dimensions

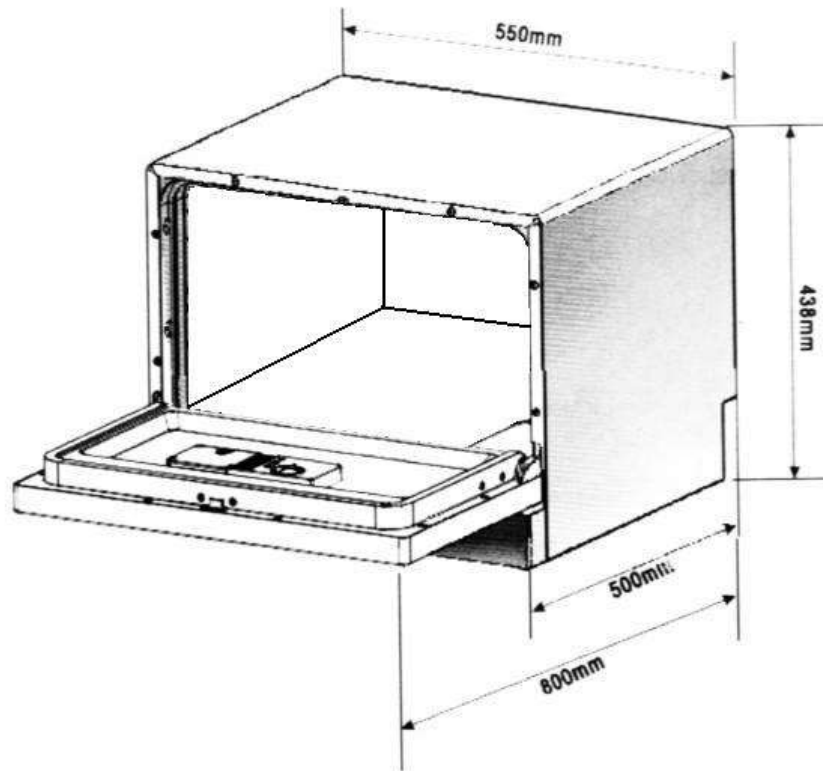

### 6.0 PUSH BUTTON CONTROLS

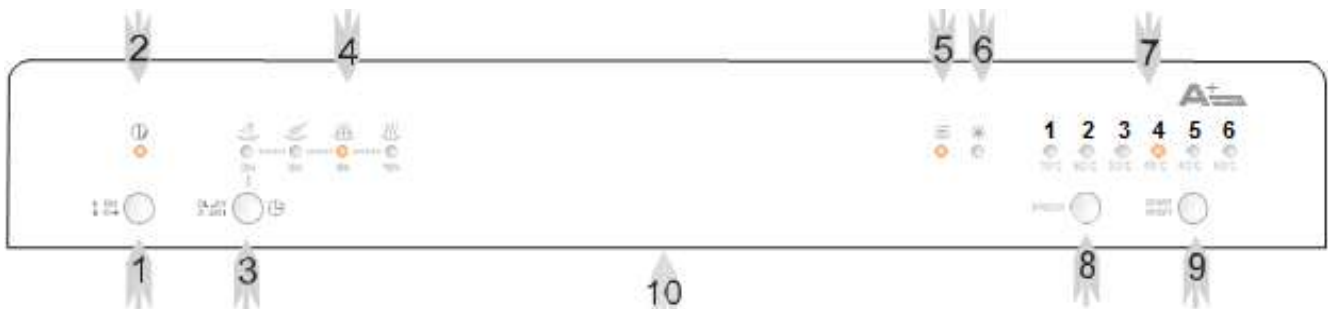

1 – on/off

2 – light power

3 – start/delayed start

4 – light Delay Start / Washing phase

5 – salt refill indicator

6 – liquid rinse aid refill indicator

7 – indicator light program

8 – program selection button

9 – start/reset button

## 7 INSTALLATION INSTRUCTIONS

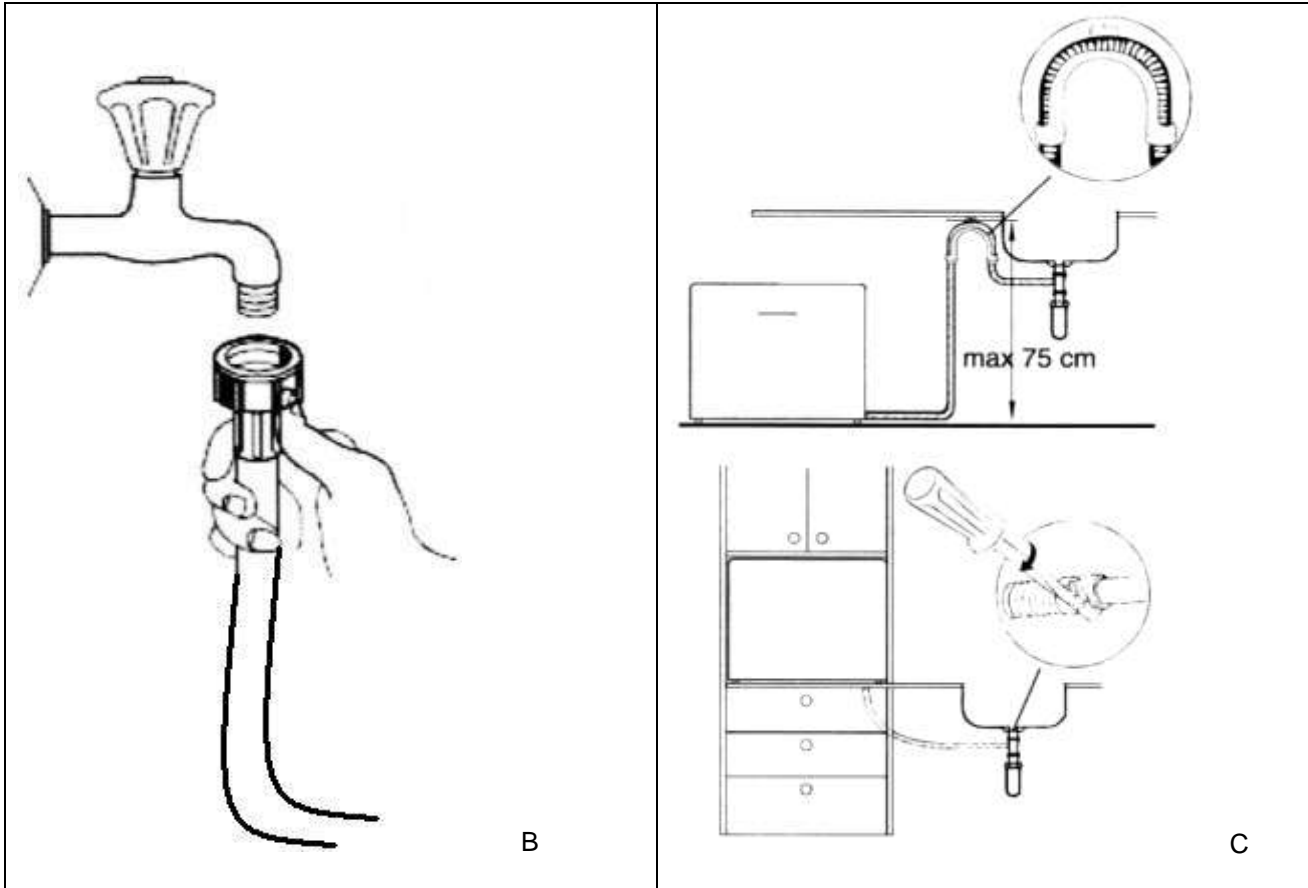

- A. Carefully remove and store the packaging.
- B. Carefully screw the hose water with the cold water tap.
- C. Connect the drain hose.

### 7.0 **METHOD OF CONNECTING FITTINGS GUIDELINES FOR WATER SUPPLY**

The washing machine must be connected to the main water supply pipes, using new fittings. The water pressure must be between 0.04 MPa and 1 MPa.

- Remove the fittings for the water supply of the compartment on the back of lava tools.
- Tighten the screws of the safety fitting for the connection to the tap with  $\frac{3}{4}$ .
- Fully open the water tap before starting the washing machine.

#### **Instructions**

A fitting connected to a faucet sprayer may burst if it is installed on the same pipe that is connected to the washing machine. If there is this kind of connection, disconnect the connector and plug the drain hole.

### 7.1 **DISCONNECT THE FITTING OF SAFETY**

- Close the water tap
- Release the water pressure by pressing the pressure release. This helps decrease the water pressure and to protect people and the room from violent splashing water.
- Unscrew the safety of the tap

## **7.2 DISCONNECT THE WASHING MACHINE**

- Remove the power cord from the wall outlet
- Disconnect the connector Unicouple from the tap adapter.

Note: When the motor stops after the final rinse, the connector Unicouple can be disconnected and stored.

## **7.3 COLD WATER CONNECTION**

Connect the connection for cold water supply to a  $\frac{3}{4}$  connector. Make sure it is secure. If the water pipes are new or have not been used for a long time, let the water run to make sure it is clean and free of debris. Otherwise you run the risk of blocking the ingress of water and damage to the appliance.

## **7.4 HOT WATER CONNECTION**

The machine can also be connected to the hot water pipes (centralized system, heating) provided it does not exceed a temperature of 60 °. In this case, the washing cycle will be shortened by about 15 minutes and the washing efficiency slightly reduced.

## **7.5 POSITIONING OF THE WASHER**

The rear part of the machine should be resting on the wall.

The machine is equipped with pipes for the water supply and drain fittings that can be positioned to the left or right side for easier installation.

## **7.6 CONNECTING THE DRAIN PIPES**

Insert the drain hose into a drain pipe with a minimum diameter of 4 cm or let it flow into the sink and avoid bending or kinking. Use the special plastic support that comes with the machine. The free end portion of the exhaust pipe can be at a maximum height of 75 cm and must not be immersed in water.

## **7.7 ELECTRICAL CONNECTION**

Power supply with electrical fuses. Only copper cables. We recommend the use of delayed-action fuse, circuit breaker and separate circuit dedicated exclusively to the machine. The socket-outlet shall be installed in a recessed compartment adjacent. Make sure that the plug is accessible after installation.

After checking that the values of voltage and frequency to the household power supply correspond to those given in the rating plate and that the electrical system is sized for the maximum voltage on the rating plate, insert the plug into the outlet with earthing adequate. If the electrical socket to which the appliance must be connected is not adequate for the appliance, have the socket replaced by a qualified electrician and the use of adapters (danger of overheating and burns).



Before use, make sure that this grounding. Do not use extension cords or adapters for this washing machine. Do not remove for any reason, the ground connection of the power cord.

## 7.8 SALT

- D. Load the salt into the water softener. Unscrew the cap of the container in a counterclockwise direction (f.1), placed on the left side, inside the machine.
- E. Pour salt in the container (250 gr) (f. 2)
- F. Add water into salt container until a small amount of water comes out (is very important when using the washer for the first time).
- G. Carefully screw the cap.

Important note: Add the salt before starting the wash cycle to prevent corrosion. Only use salt for machine.

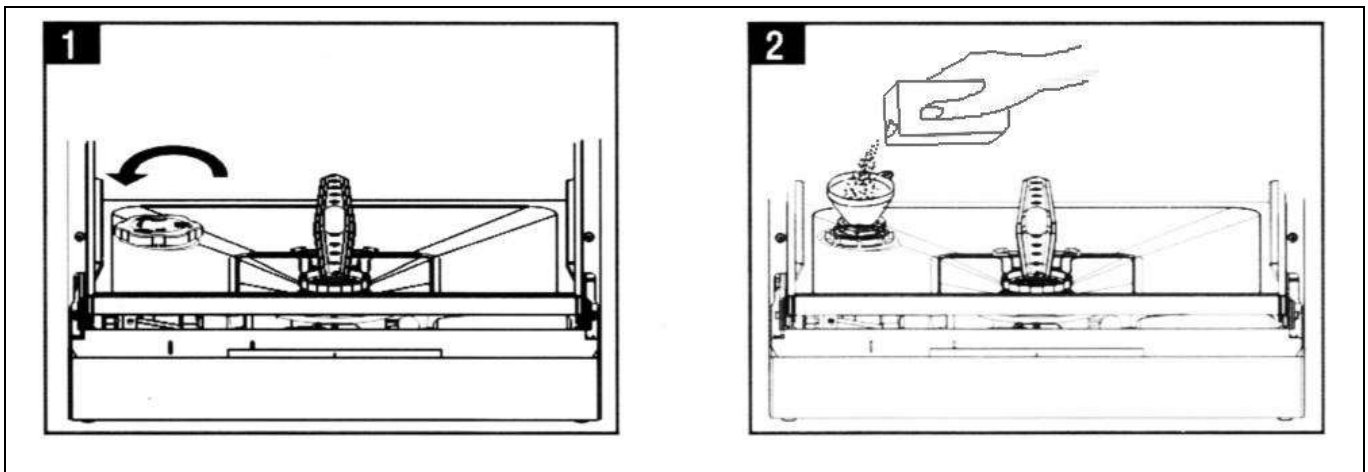

## 7.9 RINSE AID

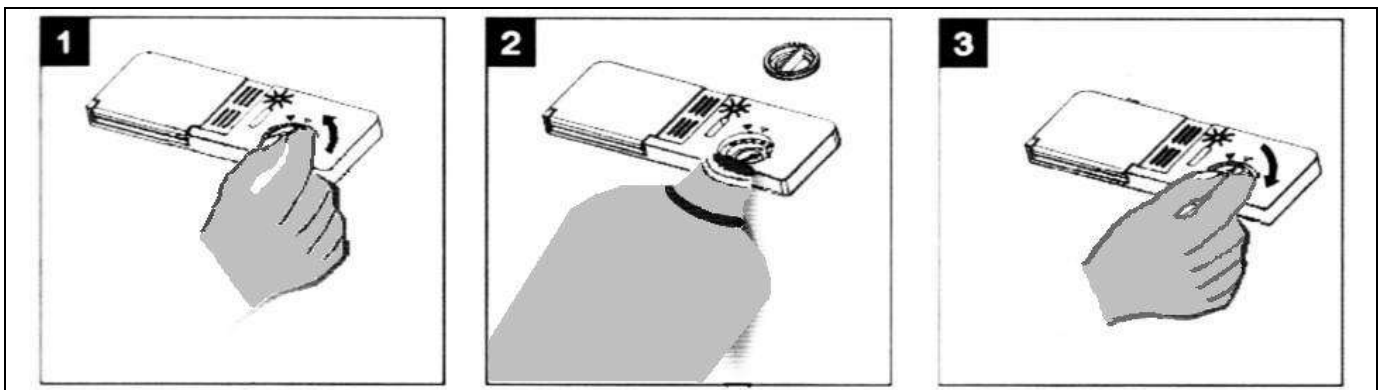

Add the rinse aid unscrewing the cap in a counterclockwise direction (f.1) Fill the rinse aid dispenser to fill it up (f.2). Screw the cap clockwise. (f.3)

To prevent stains on the instruments and reduce the drying time, always use the rinse aid.



## 7.10 DETERGENT

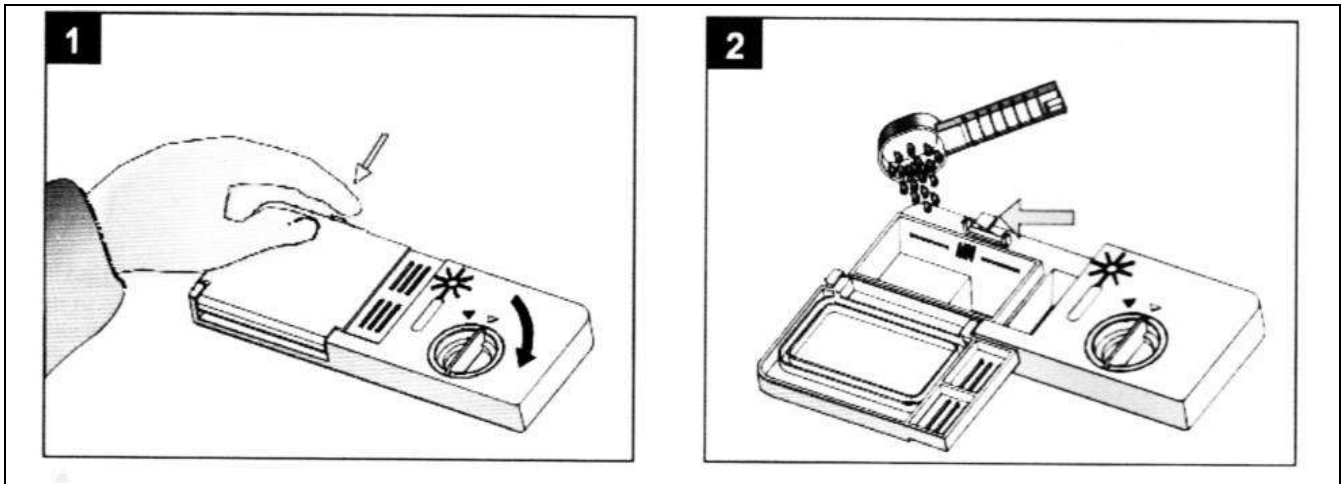

1. Open the door by pressing the key (f.1).
2. Put the detergent up to the filling line (f.2).
3. Use the detergent compartment A to fill the normal washing detergent.
4. Use the detergent compartment B to fill the pre-wash detergent.
5. At the end of each wash check that the compartment of detergent is empty.

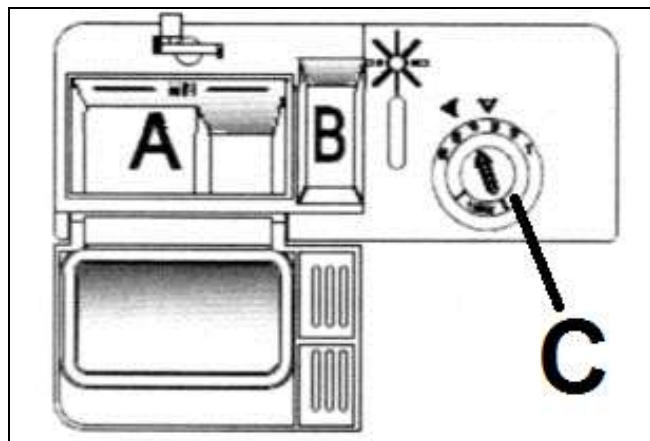

DETERGENT



**CLEANEK 1 ART. 5660:** enzyme powder for the instruments to be sterilized. Degreasing, suspending, descaling and sequestrant. Multipurpose and non-foaming.

Dosage: 7-10 grams in door B

CLEANEK1 is a medical device meets the requirements on the DM Directive 93/42/EEC and subsequent amendments (Directive EC 47/2007).

**CLEANEK 2 ART. 5661:** detergent powder for the instruments sterilized. Degreasing, suspending, descaling and sequestrant. Multipurpose and non-foaming.

Dosage: 7-10 grams in door A

CLEANEK2 is a medical device meets the requirements on the DM Directive 93/42/EEC and subsequent amendments (Directive EC 47/2007).

**RINSEOFF AB ART. 5662:** liquid for rinsing which helps to reduce drying time, it meets the need for lubrication of joints and mechanical joints, making it shiny and stain-preventing oxidative effects.

Dosage: fill the rinse aid cover

RINSEOFF AB is a medical device meets the requirements on the DM Directive 93/42/EEC and subsequent amendments (Directive EC 47/2007).



Warning! Keep the soap out of reach of children! Avoid contact with skin! Use only detergents specially formulated for washing machine! Do not overuse detergent! We suggest using readily soluble detergent.



## 8 PREPARATION OF INSTRUMENTS TO WASH

- Tools with sharp points must be positioned so as not to damage the parts of the machine (door...)
- Do not put plastic or wooden tools if they are not covered by the mark of "temperature" or equivalent
- Place any containers with the large down
- Do not overload the machine
- Remove any residue from the instruments before insert them into the machine (preferably use a tank of disinfection)
- Check that the arm rotates freely sprinkles water

## 9 INSTRUCTIONS FOR USE

1. Make sure that the hydraulic and electrical connections have been properly made by qualified personnel and that the water tap is open
2. Open the door and place the instruments
3. Check that the arm moves freely and sprays water and if necessary remove any obstructions
4. Fill the detergent compartment
5. Close the door
6. Select the desired program using the rotary 3
7. Press the power button 1. Will turn on the light 2
8. Press the start button 4. Will turn on the light of operating 5
9. The machine will stop automatically at the end of washing cycle and 5 and 2 green lights will stay on. A short beep will signal the end of the wash cycle.
10. Open the door and wait a few minutes before removing tools
11. After downloading the machine, remove the filters, clean them and put them back in their original position.



Do not open the door until it has finished the cleaning!



To facilitate drying of the instruments, at the end of the wash cycle, open the machine and wait a few minutes before removing the tools!

### 9.0 POWER EQUIPMENT

#### Starting a wash cycle

- ❖ Ensure that the plug is inserted into the wall outlet
- ❖ Check that the water supply is done with the right pressure
- ❖ Load the instruments (see paragraph)
- ❖ Add detergent
- ❖ Close the door, press the ON / OFF button and the light will turn on
- ❖ At this point the cycle starts
- ❖ Press the START / RESET button and the program will start in a few seconds
- ❖ Press the DELAY / START button to set the delayed start. This washing machine can be programmed in advance by choosing from 3, 6, 9 and 12 hours. If you wish to cancel the delayed start, just press the button until it no longer appears selected time.

#### Cancellation or change the setting of a wash cycle

Press and hold the START / RESET button for at least 3 seconds (the current program will be erased.) At this point, a new program can be selected.

### **The end of the wash cycle**

At the end of the wash cycle, the buzzer of the washing machine will beep for eight seconds, then stops. Switch off the appliance using the ON / OFF, open the door and wait a few minutes before removing tools (30 minutes is ideal).

### **If you have forgotten to add tools**

You can add instruments at any time.

- Open the door slightly to stop the washing
- After the spray arm has stopped, fully open the door.
- Add the tools forgotten
- Close the door and the washing will start after ten seconds from closing completely.

### **Warning**

It is dangerous to open the door with the washing machine on as it may come out boiling water.

**10 TABLE OF PROGRAMS OF WASHING****WASHING MACHINE MOD. MINI-WASH**

PROGRAMS	INFORMATION ON THE LOAD	DESCRIPTION OF WASHING	DETERGENT PRE-WASHING GR.	DURATION MIN.	ENERGY CONSUMPTION kWh	WATER CONSUMPTION IN LT.
<b>1 INTENSIVE</b>	Metal tools very dirty	Pre-wash 50° Wash 70° Rinsing Rinsing Rinsing 70° Drying	3/15	140	0.9	11
<b>2 NORMAL (EN50242)</b>	Metal tools very dirty	Pre-wash Wash 60° Rinsing Rinsing 70° Drying	3/15	120	0.65	9
<b>3 ECO</b>	Delicate tools not very dirty	Pre-wash Wash 50° Rinsing Rinsing 70° Drying	3/15	170	0.61	7
<b>4 GLASS</b>	Rubber and plastic Delicate tools Glass	Wash 45° Rinsing Rinsing 60° Drying	15	75	0.5	7
<b>5 RAPID</b>	Tools not very dirty	Wash 40° Rinsing Rinsing Drying	15	30	0.30	6
<b>6 3 in 1</b>	Standard washing	Pre-wash Wash 60° Rinsing Rinsing 70° Drying	3 in 1 (1pcs)	140	0.7	9

**Starting a wash cycle**

- a-We recommend charging the lower basket first and then the upper.
- b-Make sure you have properly closed the door with limited strength.
- c-Insert the plug into the socket. The power supply is 230V 50 HZ, the specification of the socket is 250V 10 °.
- d-Select the desired program and press the select button of the program.
- e-Press-and ON-OFF button to start the automatic car wash.
- f-Press ON-OFF at the end of the wash.

**Open the door of the washing tools after waiting for 30 minutes.**

**Changes to the program**

Press and hold the START / RESET button for more than 3 seconds to stop washing.

Press the button to select the program you choose.

Press the START / RESET button to start the wash.

**At the end of the wash cycle**

After washing, the time display will flash for 8 seconds while the buzzer sounds.  
After washing delayed you will not hear any beep but you can only see the time display flashes.

## 11 CLEANING AND MAINTENANCE

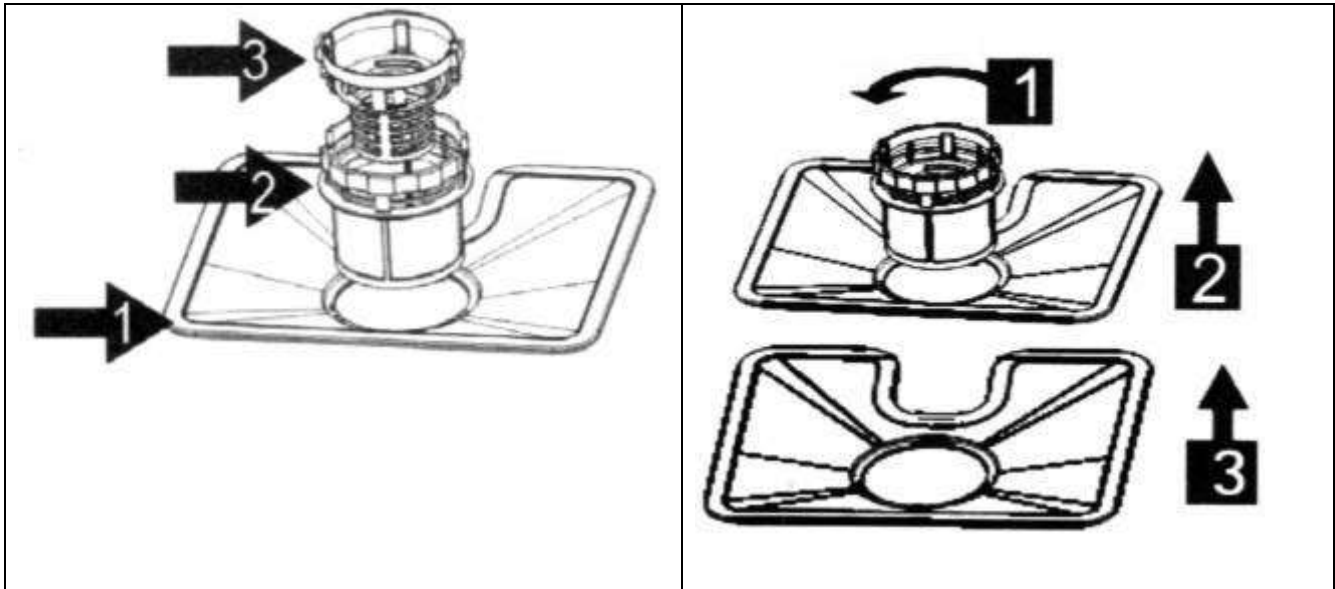

Provide regular cleaning of filters to remove providing the three parts that are on the bottom of the wash tools.  
Wash with water, dry and reassemble them as before.

To clean the outer cabinet use a soft non-abrasive detergent.

## 12 TECHNICAL FEATURES

### MAIN FEATURES

Color	White
ENERGY EFFICIENCY CLASS – NEW (2010/30/EC)	A+
WIDTH mm	550

### GENERAL FEATURES

CODE EAN	8016361843554
BUILT IN / FREE INSTALLATION	FREE INSTALLATION
PRODUCT CODE	M9016/2

### TECHNICAL FEATURES

FUNCTION OF DELAYED START	A CLICK
END OF CYCLE INDICATOR	YES WITH BUZZER
NUMBER OF PROGRAMS	6
DRYING SYSTEM	CONDENSER
RINSE AID WARNING LIGHT	YES
SALT WARNING LIGHT	YES
MAX TIME DELAY START (h)	3,6,9,12

### ENERGY LABEL

DRYING EFFICIENCY CLASS	A
WATER CONSUMPTION (l)	7
ENERGY CONSUMPTION (kWh)	0.62
TOTAL ENERGY CONSUMPTION PER YEAR (kWh)	174
CONNECTION RATING (W)	1280
TOTAL DURATION OF A CYCLE TIME OF REFERENCE PROGRAM (min)	140
SOUND LEVEL dB(A) re 1 pW – SOUND	55

### DIMENSIONS

HEIGHT WITH WORK PLAN (mm)	438
WIDTH (mm)	550
GROSS WEIGHT (kg)	27.7
NET WEIGHT (kg)	23.5

---

DEPTH (mm)	500
<b>SPECIAL FEATURES AND BUTTONS</b>	
<b>BUTTONS</b>	
PROGRAM SELECTION	YES
DELAYED START 3-6-9 h	YES
START	YES
<b>LEDS</b>	
PROGRAMS SELECTION	YES
LED OF WASHING STEP	YES
LOW RINSE	YES
LOW SALT	YES
OPERATION	YES
DELAYED START	YES
<b>PROGRAMS LIST</b>	
INTENSIVE	YES
NORMAL	YES
ECO	YES
GLASS	YES
RAPID	YES
3 IN 1	YES

---



## 13 ANOMALIES AND SOLUTIONS

ANOMALIES	POSSIBLE CAUSES	SOLUTIONS
<b>THE MACHINE DOES NOT START</b>	<ol style="list-style-type: none"> <li>1. POWER IS NOT BEING</li> <li>2. THE DOOR IS NOT CLOSED GOOD</li> <li>3. THE MACHINE is NOT ON A FLAT SURFACE</li> <li>4. BLOWN FUSE OR CIRCUIT BREAKERS IN ACTION</li> <li>5. THE WATER PRESSURE IS TOO LOW</li> </ol>	<ol style="list-style-type: none"> <li>1. CHECK THE POWER AND THAT THE SWITCH IS ON</li> <li>2. WELL SHUT THE DOOR</li> <li>3. PUT UP IN THE MACHINE</li> <li>4. REPLACE THE FUSE OR RESET THE CIRCUIT BRAKERS. REMOVE ANY OTHER APPLIANCE THAT AGREE TO THE SAME CIRCUIT WITH WASHER</li> <li>5. MAKE SURE THE WATER SUPPLY IS CONNECTED PROPERLY AND THE TAP IS OPEN.</li> </ol>
<b>THE DRAIN PUMP DOES NOT STOP</b>	<ol style="list-style-type: none"> <li>1. RELEASE OF WATER</li> </ol>	<ol style="list-style-type: none"> <li>1. THE SYSTEM WAS DESIGNED TO DETECT LEAKS WATER. IN THIS CASE THE PUMP STOPS AND IS ACTIVATED THE DRAIN PUMP.</li> </ol>
<b>TOOLS NOT CLEAN</b>	<ol style="list-style-type: none"> <li>1. LOAD WRONG</li> <li>2. THE BOOM SPRAYING WATER DOES NOT ROTATE FREELY</li> <li>3. INADEQUATE OR NOT SUITABLE DETERGENT</li> <li>4. DIRTY INSTRUMENTS INCORPORATED</li> <li>5. BENT PIPE WATER LOAD</li> <li>6. IMPROPER INSTALLATION</li> </ol>	<ol style="list-style-type: none"> <li>1. ARRANGE THE LOAD IN A WAY THAT ALL SPLATTER INTO ALL SURFACES. DO NOT OVERLOAD THE MACHINE.</li> <li>2. CHECK THE BOOM SPRAYING WATER ORDER 'NOTHING OBSTACLES HIS DIRECTION.</li> <li>3. USE MORE 'DETERGENT. DO NOT USE DETERGENT OR HARD GRAINY. ONLY USE DETERGENT WASHING MACHINE.</li> <li>4. CLEAN WITH CARE INSTRUMENTS BEFORE YOU LOAD THE MACHINE</li> <li>5. SPREAD THE GOOD WATER INLET HOSE</li> <li>6. REVIEW THE INSTALLATION</li> </ol>
<b>TOOLS NOT DRY</b>	<ol style="list-style-type: none"> <li>1. THE RINSE AGENT DISPENSER is EMPTY</li> </ol>	<ol style="list-style-type: none"> <li>1. FILL</li> </ol>

<b>STAIN ON TOOLS</b>	<ol style="list-style-type: none"> <li>1. WATER TOO HARD</li> <li>2. LOW TEMPERATURE INPUT</li> <li>3. OVERLOAD THE WASHER</li> <li>4. DETERGENT NON CONFORMING</li> <li>5. LACK OF AID</li> <li>6. EXCESS OF DETERGENT</li> </ol>	<ol style="list-style-type: none"> <li>1. FOLLOW THE MANUFACTURER'S INSTRUCTIONS</li> <li>2. DO A WASH CYCLE ALONG WITHOUT ADDING DETERGENT BUT THREE GLASSES OF WHITE VINEGAR ON THE BOTTOM OF THE WASHER.</li> </ol>
<b>WATER HAS BEEN ON THE BOTTOM OF THE MACHINE</b>	<ol style="list-style-type: none"> <li>1. IT IS NORMAL FOR THE BOTTOM THERE IS A LITTLE BIT OF WATER</li> </ol>	<ol style="list-style-type: none"> <li>1. THIS QUANTITY IS NECESSARY TO KEEP THE PIPE READY TO USE. THE WATER IS DRAINED AUTOMATICALLY AT THE BEGINNING OF EACH CYCLE.</li> </ol>
<b>THE MACHINE DOES NOT STOP</b>	<ol style="list-style-type: none"> <li>1. DIRTY FILTER</li> </ol>	<ol style="list-style-type: none"> <li>1. DOWNLOAD THE WATER AND CLEAN THE FILTER</li> </ol>
<b>NOISE</b>	<ol style="list-style-type: none"> <li>1. THE TOOLS TO WASH DO NOT HAVE BEEN PROPERLY PLACED IN TRAY OR HAVE FALLEN</li> <li>2. HUM OF THE ENGINE</li> </ol>	<ol style="list-style-type: none"> <li>1. MAKE SURE THAT ALL THE TOOLS ARE WELL POSITIONED</li> <li>2. IN THE EVENT OF LITTLE USE, KEEP OILED THE SEAL.</li> </ol>
<b>FOAM IN THE BATH</b>	<ol style="list-style-type: none"> <li>1. NOT SUITABLE DETERGENT</li> <li>2. RELEASE OF AID</li> </ol>	<ol style="list-style-type: none"> <li>1. USE ONLY DETERGENT RECOMMENDED BY THE MANUFACTURER</li> <li>2. DRY IMMEDIATELY THE RELEASE OF THE RINSE</li> </ol>
<b>THE DETERGENT DRAWER WILL NOT CLOSE</b>	<ol style="list-style-type: none"> <li>1. THE KNOB IS NOT SET ON THE POSITION OF POWER OFF (OFF)</li> </ol>	<ol style="list-style-type: none"> <li>1. TURN THE KNOB ON THE POSITION OF POWER OFF (OFF) AND SLIDE THE CLOSING THE DOOR TO THE LEFT.</li> </ol>
<b>STEAM</b>	<ol style="list-style-type: none"> <li>1. NORMAL PHENOMENON</li> </ol>	<ol style="list-style-type: none"> <li>1. DURING THE DRYING AND THE DISCHARGE OF WATER VAPOR PASSING THROUGH THE VENT OF CLOSING THE DOOR.</li> </ol>
<b>THE WASHER LOSE WATER</b>	<ol style="list-style-type: none"> <li>1. OVERFILLING THE DETERGENT DISPENSER OR LEAK OF AID</li> <li>2. THE LAVSTRUMENTI NOT BEEN INSTALLED IN A PERFECTLY FLAT SURFACE.</li> </ol>	<ol style="list-style-type: none"> <li>1. BE CAREFUL NOT TO OVER-FILL THE FEEDER. THE RELEASE OF DETERGENT OR MAY RESULT IN EXCESS OF FOAM RINSE AND OUT OF WATER.</li> <li>2. MAKE SURE THAT THE WASHER IS LEVEL.</li> </ol>

## 14 PRODUCT DETAILS IN ACCORDANCE WITH THE COMMISSION DELEGATED REGULATION (EU) NO 1059/2010

Free-standing	Free-standing
Energy efficiency class - <b>new (2010/30/EC)</b>	A+
Annual energy consumption (kWh) – <b>New (2010/30/EC) (1)</b>	174
Energy consumption (kWh)	0.62
Water consumption in liters / year – <b>New (2010/30/EC) (2)</b>	1960
Reference program <b>(3)</b>	Eco
Efficiency class Drying	A
Total duration of a cycle time of reference program (min)	140
<b>Noise level dB (A) re 1 pW – sound power</b>	55
Consume energetic in 'left-on' ' <b>left-on</b> '	0.3 W
Consume energetic in 'left-on' ' <b>off-mode</b> '	0.2 W

1) Power consumption in kW / h per year based on 280 standard cleaning cycles with cold water and consumption of energy-efficient ways. Actual energy consumption will depend on how the appliance is used.

2) Consumption of water "W" liters / year based on 280 standard cleaning cycles. Actual energy consumption will depend on how the appliance is used

3) Program is the standard wash program to which the information relates to the label , this program is suitable for washing delicate instruments and that is the most efficient program in terms of combined energy and water.

## 15 WARRANTY CERTIFICATION



### WARRANTY CERTIFICATION

Hereby certify the correct construction of the equipment.

The device that within the warranty period manifests irregularities in the running for manufacturing defects will be repaired at the sole discretion of the house.

Return the attached coupon, duly stamped and signed by the technician who took part to the installation course. In case of dispute will be valid the delivery note / sale invoice or delivery invoice.

The electric and electronic parts, screws, are guaranteed for a period of 12 months.

The warranty is limited to the replacement or refurbishment of spare parts or parts that prove defective manufacturing, excluding expenses, or call.

Any particular replaced must be returned prepaid. Any piece that is not returned will be billed to the payer.

- **THE WARRANTY IS NO MORE VALID:**

- 1. If the equipment is repaired, modified or tampered with by the purchaser or unauthorized third parties**
- 2. If the customer does not perform the proper and constant maintenance on this manual**
3. If the buyer does not talk to the dealer or authorized service centre
4. After 12 months from date of purchase proven by the sales document
5. If the customer delays or suspends payments
6. If the equipment shows damages caused by exposure to fire, spilled liquids, natural disasters, falls, however, causes not attributable to manufacturing defects
7. If the guarantee has been not duly completed, signed and returned in a timely manner
- 8. If the customer makes improper use of the equipment, does not administer the ordinary maintenance or neglects elements principles of good maintenance**

# 16 DECLARATION OF INSTALLATION WARRANTY CERTIFICATE AND STATEMENT OF SERVICE INSTALLATION

INSTALLATION DATE .....

Technical course of installation, repair and maintenance

The technician who has carried out the installation of the washing machine has previously attended the technical course and has been authorized by the manufacturer's for the installation and repair of such equipment

Installation according to the manual of use and maintenance

The technician who has carried out the installation of the washing machine claims to have complied with all conditions that allow the correct installation of the device according to the use and installation manual.

Instruction to the user, functioning and maintenance

The technician further declares to have properly instructed the user on the functioning of the machine with the support of the instruction manual.

Instructions to the user on the warranty conditions

The technician has also shown the warranty conditions as described in the use and maintenance manual.

Warranty form

The technician declares to have attached to this form the warranty model, which has been carefully filled in.

## WARRANTY CERTIFICATION



EQUIPMENT:	
------------	--

The undersigned dealer certifies that the warranty conditions have been read and that the machine has been delivered and operated in accordance with the provisions of the manufacturer.

Installation date:..... To the Doct: .....

Address: .....Post Code .....

City: .....Country.....

STAMP AND SIGNATURE OF THE DEALER	STAMP AND SIGNATURE OF THE DOCTOR/MANAGER
-----------------------------------	---

To be completed by the technician who has made the installation of the machine. Copy for the medical.



Art.-No.: 770 500  
EAN: 4 004 470 770 506