

USER MANUAL

EN

# SEDEO PRO+

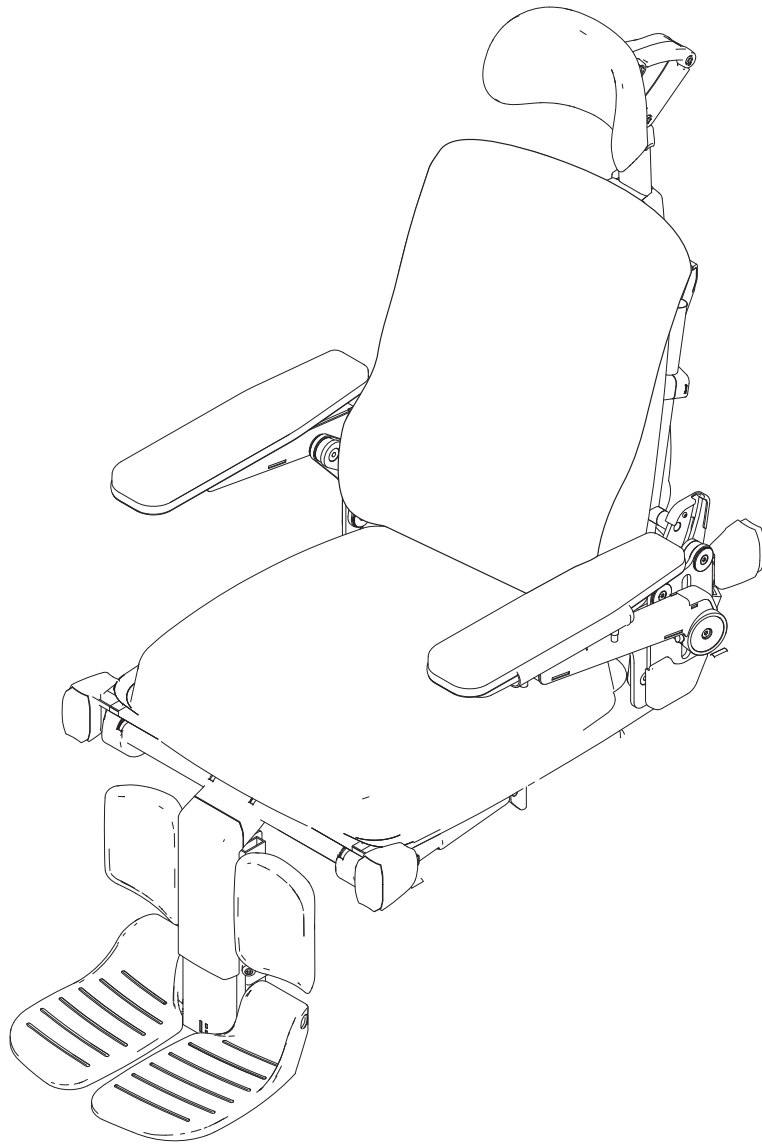

handicare

9010304A

© 2014 Handicare

All rights reserved.

The information provided herein may not be reproduced and/or published in any form, by print, photoprint, microfilm or any other means whatsoever (electronically or mechanically) without the prior written authorization of Handicare.

The information provided is based on general data concerning the construction known at the time of the publication of this manual. Handicare executes a policy of continuous improvement and reserves the right to changes and modifications.

The information provided is valid for the product in its standard version. Handicare can therefore not be held liable for any damage resulting from specifications of the product deviating from the standard configuration. Illustrations contained in the manual may deviate from the configuration of your product.

The information made available has been prepared with all possible diligence, but Handicare cannot be held liable for any errors contained in the information or the consequences thereof.

Handicare accepts no liability for loss resulting from work executed by third parties.

Names, trade names, trademarks etc. used by Handicare may not, as per the legislation concerning the protection of trade names, be considered as being available.

2014-01

## Table of content

1	Introduction.....	4
1.1	This user manual	4
1.2	Symbols used in this manual	4
2	Safety.....	5
2.1	Temperature	5
2.2	Indications on the seating system	5
2.3	Moving parts	5
3	General description.....	6
3.1	Sedeo Pro+ product description	6
4	Use.....	7
4.1	Adjustments (by the user/attendant)	7
4.2	Getting in and out of the wheelchair (transfer)	8
4.3	Options / accessories	9
4.4	Reducing the seating system in size for transportation purposes	10
4.5	Setting up the seating system following transportation	12
5	Adjustments (to be carried out by a professional).....	14
5.1	Seat width	14
5.2	Seat depth	14
5.3	Backrest height	15
5.4	Standard and manually elevating legrest	15
5.5	Central legrest	17
5.6	Electrical central legrest	18
5.7	Armrest assembly	20
5.8	Adjusting the centre of gravity	23
5.9	Headrest	24
5.10	Fixed / swing-away controller bracket	25
5.11	Backrest with adjustable straps - flexible	26
5.12	Velcro back curvature adjustment	26
5.13	Abduction support	27
5.14	Thoracic support	27
5.15	Attaching the lap strap	28
6	Maintenance.....	30
6.1	Cleaning the upholstery	30
7	Troubleshooting.....	31
8	Technical specifications.....	32
8.1	CE declaration and requirements	32
8.2	Technical information	32
9.	Warranty.....	34

# 1 Introduction

## 1.1 This user manual

This user manual will help you to use and maintain your seating system safely. This user manual is a supplement to Handicare's general wheelchair user manual.

Where necessary, this user manual refers to other manuals as shown below:

 Wheelchair: Refers to the general wheelchair user manual.

 Controller: Refers to the user manual for the controller (only applicable for power wheelchairs).

**Read this user manual and the other user manuals referred to carefully before using the product.** If one of the user manuals was not included with your wheelchair, please contact your dealer immediately. In addition to this user manual, there is also a service manual for qualified specialists.

Contact Handicare if you have a visual impairment.

## 1.2 Symbols used in this manual

### Note!

Pointing out possible problems to the user.

### ⚠ Caution!

Advice for the user to prevent damage to the product.

### ⚠ Warning!

Warnings for the user to prevent personal injury.

Not following these instructions may result in physical injury, damage to the product or damage to the environment!

## 2 Safety

### ⚠ Warning!

Always follow the instructions given next to the warning symbols! Failure to follow these instructions may result in physical injury, damage to the wheelchair or damage to the environment. Where possible the warning symbols have been placed in the applicable paragraphs.

Be careful when swing away/flip up parts. Contact with moving parts should be avoided.

Take care when smoking.

Do not use wheelchair near open flame.

### ⚠ Caution!

Parts of the wheelchair that are intended, for service or repair, to be removed without the use of tools (e.g. armrest, legrest) can have an adverse effect on the support of the user if they are missing or not placed back in the right position.

### 2.1 Temperature

#### ⚠ Warning!

Avoid exposing the wheelchair to direct sunlight for extended periods of time. Some parts of the wheelchair, such as the seat, the backrest and the armrests assembly, complete, can become hot if exposed to the sun for too long. This may cause burns or skin irritation.

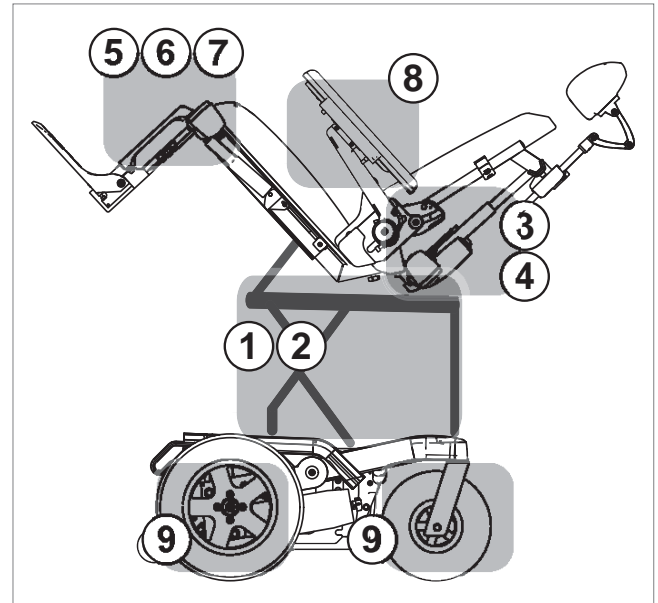

### 2.2 Indications on the seating system



The wheelchair must not be lifted up by the armrests assembly, complete and/or legrests.



The stability of the wheelchair is influenced by the adjustment of the seating system's centre of gravity. Such adjustments should be made by professionals only.

### 2.3 Moving parts

#### ⚠ Warning!

Contact with the moving parts of the wheelchair should be avoided. A wheelchair has moving and rotating parts. Contact with moving parts may result in serious physical injury or damage to the wheelchair.

Moving/rotating parts:

1. Electrically tilt adjustment
2. Electrically high/low adjustment
3. Electrically reclining backrest
4. Electrically reclining antishear backrest
5. Electrically elevating legrests
6. Electrically elevating central legrest
7. Electrically elevating central legrest and electric height adjustment
8. Flip-up armrests
9. Wheels (turning and pivoting)

## 3 General description

### 3.1 Sedeo Pro+ product description

The wheelchair is fitted with a Sedeo Pro+ seating system. The Sedeo Pro+ seating system provides excellent support for the head, torso, arms and legs. Optimal body support ensures maximum independence for the wheelchair user.

The wheelchair must be adjusted by a qualified specialist. Incorrect settings may have negative consequences for seating posture.

#### **Caution!**

Please study this manual carefully before using the seating system.

#### Key to symbols



Loosen by one turn with wing-nut



Tighten by one turn with wing-nut



Loosen by one turn with torx



Tighten by one turn with torx



Step 1, 2 etc.

An arrow, as part of an illustration, indicates that the component in question moves or needs to be moved in the direction indicated.

#### Notes on "Key to symbols"

Each illustration includes icons and numbering to indicate what needs to be done and in which order.

## 4 Use

### 4.1 Adjustments (by the user/ attendant)

#### Manually elevating legrest knee angle

The angle of the manually elevating legrests can be adjusted independently of each other.

1. Push handle (A) forwards.
2. Lift your leg.
3. Release the handle when in the desired position.

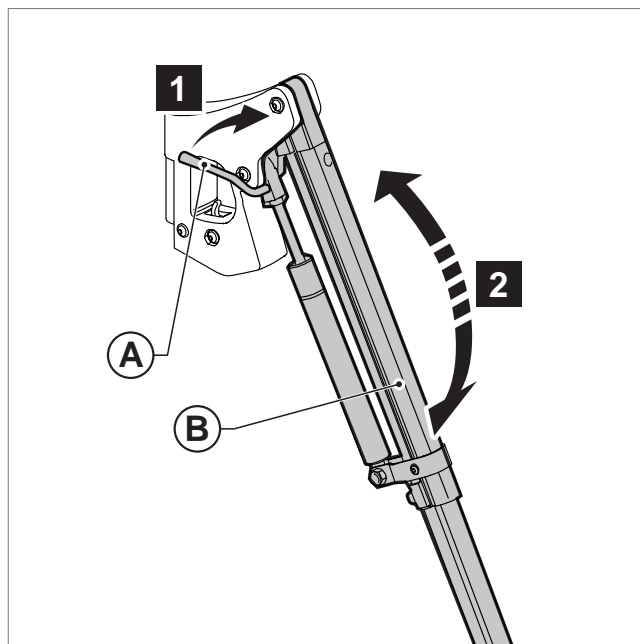

#### Moving the controller bracket inwards

1. Push (A) inwards until hearing a click.

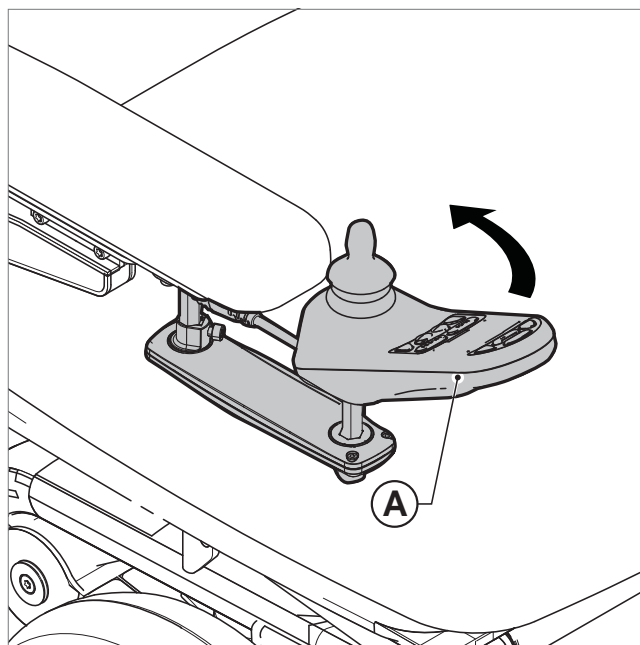

#### Swing away the controller bracket

1. Push (A) outwards until hearing a click.

#### Note!

Swinging back the controller bracket will allow you to pull up close to a table. Full operation of the controller remains possible.

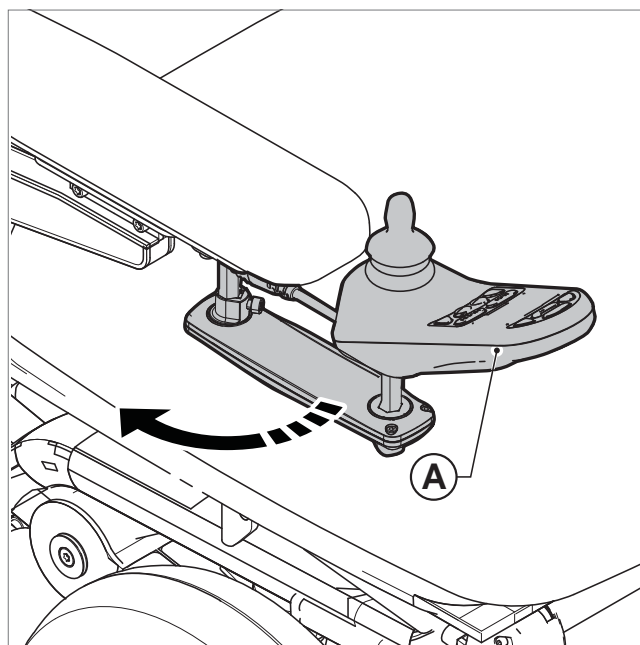

### Hemiplegia armrest

1. Pull (A) out of the locked position and twist (B) into the desired position.

#### Note!

Ensure that (B) is properly secured!

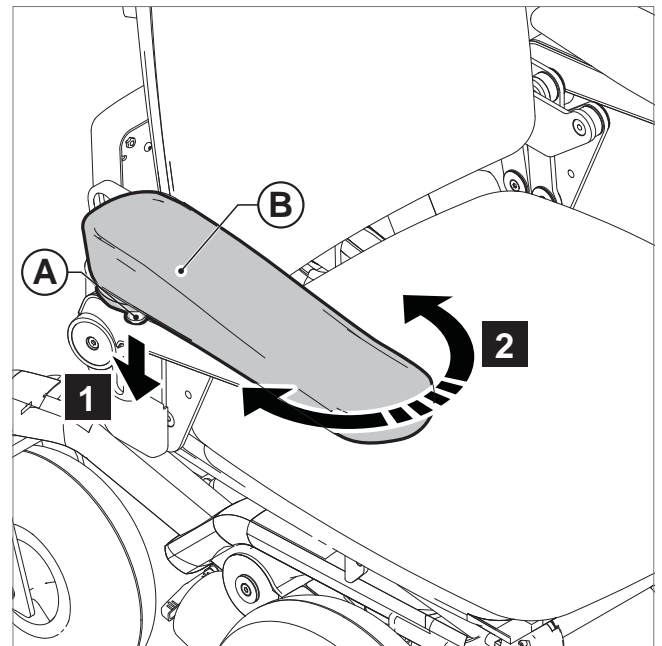

## 4.2 Getting in and out of the wheelchair (transfer)

### Forwards transfer

#### ⚠ Warning!

Do not stand on the footplates. Putting your full weight on the footplates may lead to wheelchair damage and to hazardous situations, including the wheelchair tipping up.

Swinging back and/or removing the standard legrest

1. Push (A) to the rear.
2. Swing (B) to the side.
3. Remove (B).

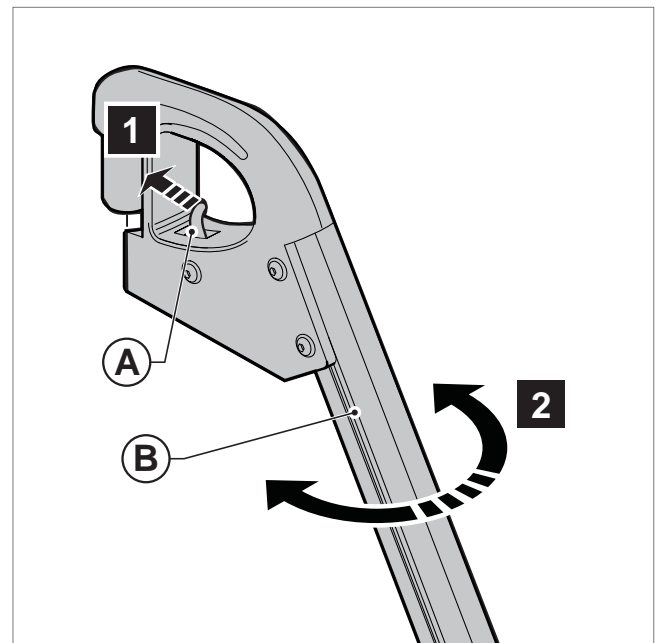

Flipping up the (electrical) central legrest footplate

1. Flip up (A).

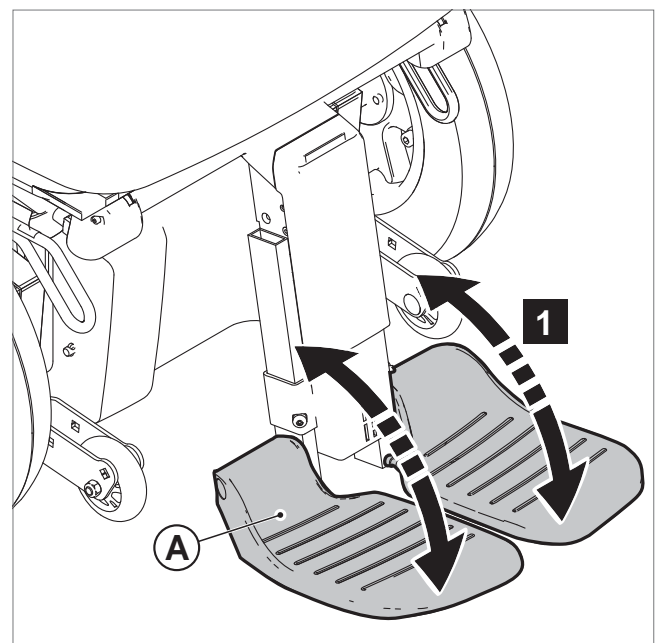



### Sideways transfer

Folding back the armrest assembly

1. Fold (A) to the rear.

#### ⚠ Caution!

Remove the tray before folding back the armrest assembly.

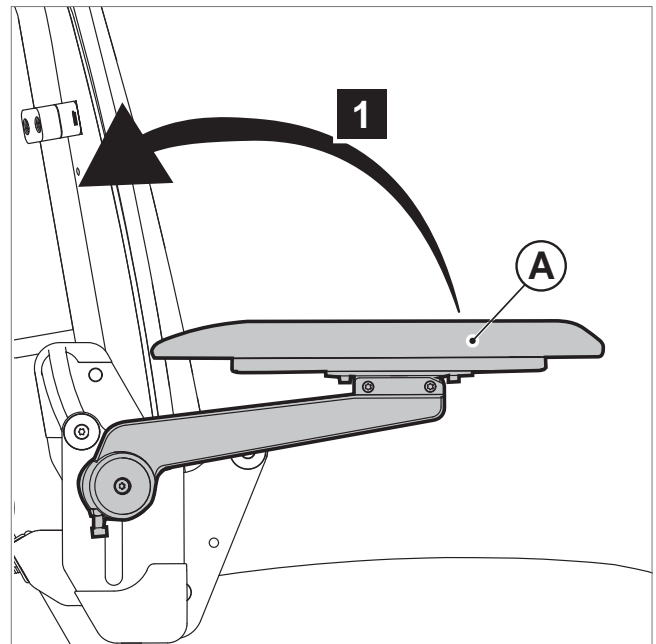

## 4.3 Options / accessories

### Removing/positioning the headrest

1. Loosen (A) by one turn.
2. Slide (B) out of or into the receiver.
3. Tighten (A).

#### Note!

Always slide the headrest until it comes to a stop in the bracket.

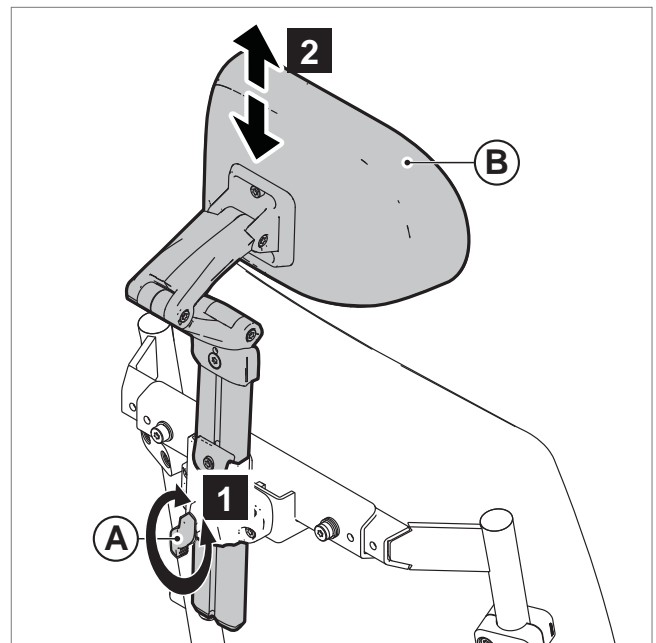

### Removing the side cushion

1. Loosen (A) by two turns
2. Slide (B) up
3. When replacing the side cushion, tighten (A) by two turns

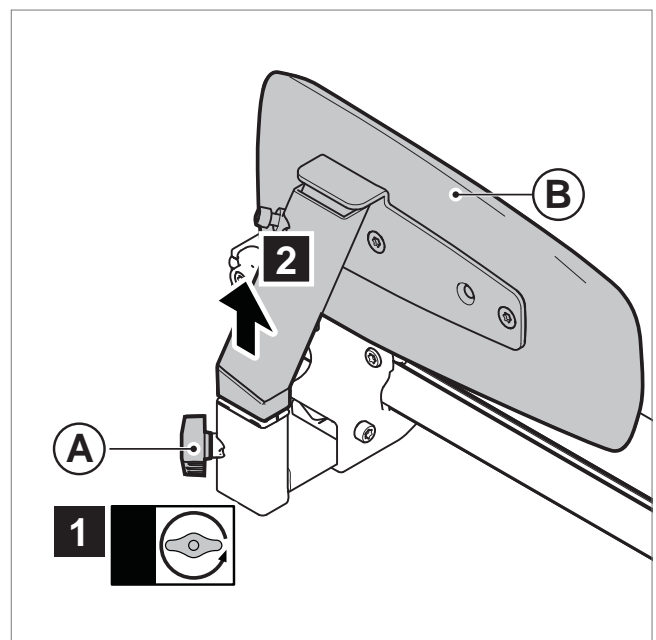

**Flip down the abduction support**

1. Pull (A) out of the locked position and flip down (B)
2. Release (A).

**Flip up the abduction support**

3. Pull (A) out of the locked position and flip up (B).
4. Release (A) in the locked position.

**Note!**

Ensure that (B) is properly secured!

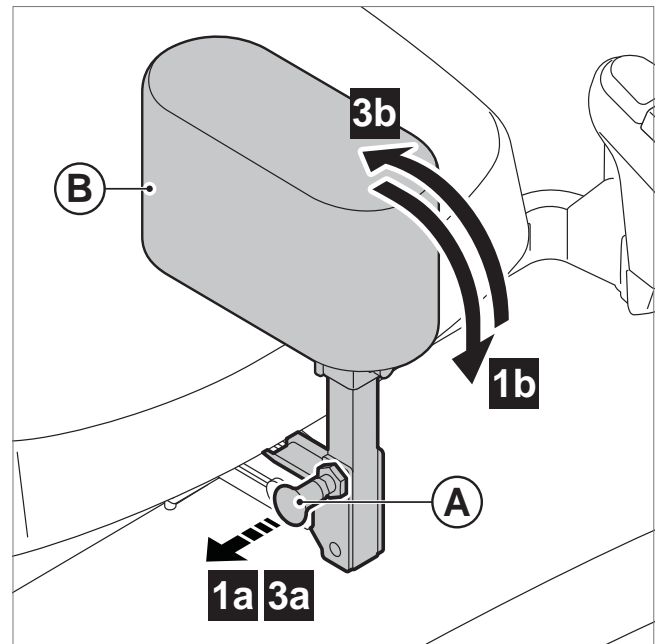
**Folding back the thoracic support**

1. Press (A) to fold back (B).

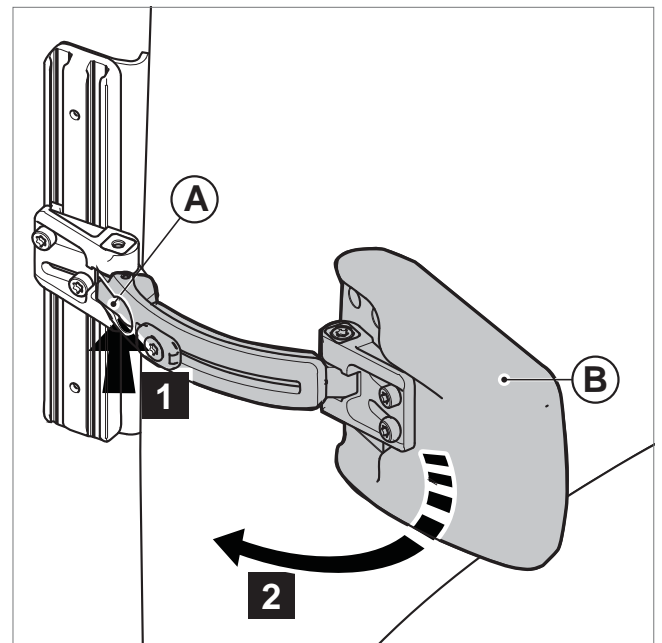

#### 4.4 Reducing the seating system in size for transportation purposes

- A. Removing the headrest, see 4.3 'Options/ accessories (1,3 kg)
- B. Removing the seat cushion (2,5 kg)
- C. Flip up the armrest
- D. Folding the backrest fully forward
- E. Removing the legrest or fold up footplates

**⚠ Warning!**

The wheelchair can be reduced in size for transportation without a passenger. Any components of the seating system that can be detached easily should be removed. Store away such components safely so that they can not cause injury or damage, or become damaged themselves.

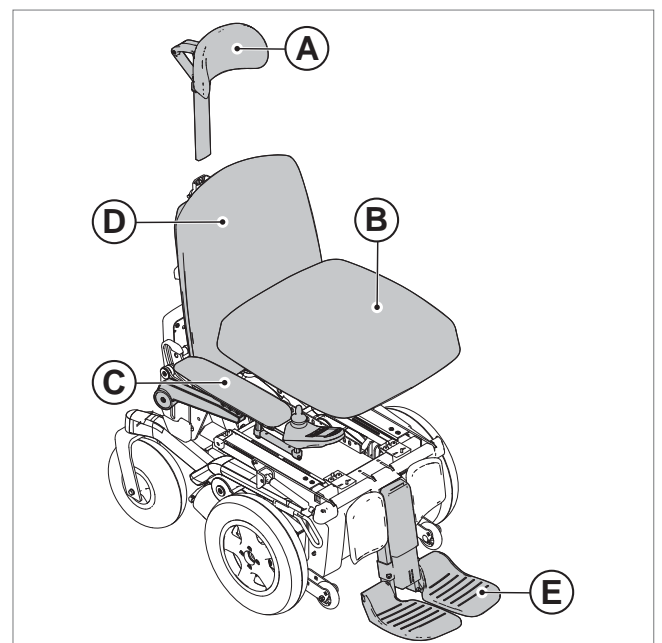

### Removing the seat cushion

1. Pull (A) upwards and forwards.

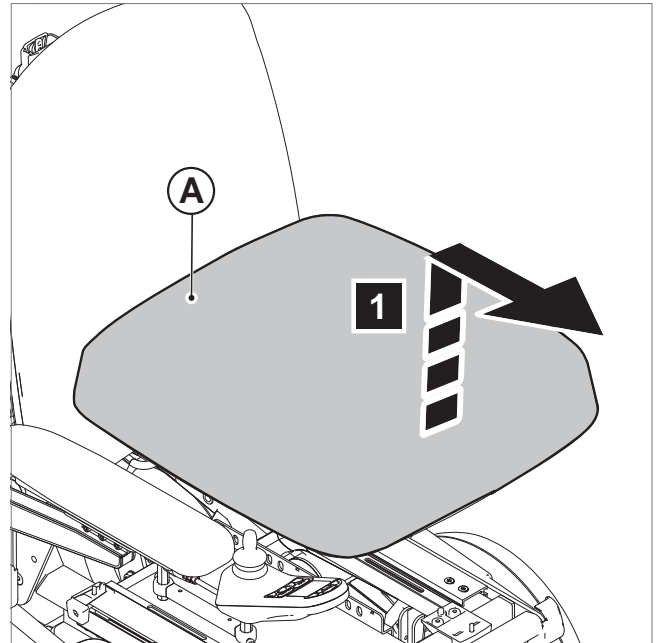

### Flip up the armrest

1. Flip up the armrest (A)
2. Lock the armrest (B)

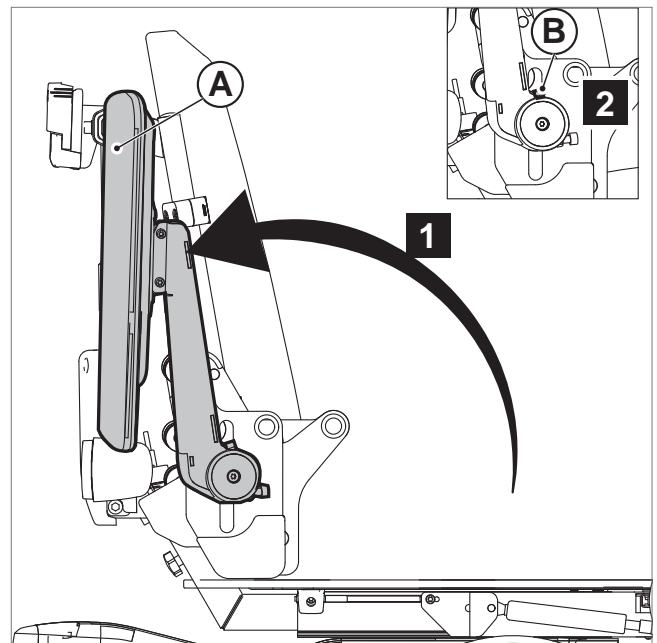

### Folding the backrest fully forward

1. Loosen the knobs (A) at the lower back.
2. Lift the backrest 60° up (B)

#### Note!

The backrest is heavy.

#### ⚠ Warning!

Watch squeezing your fingers while lifting the backrest

3. Fold (B) fully forward.

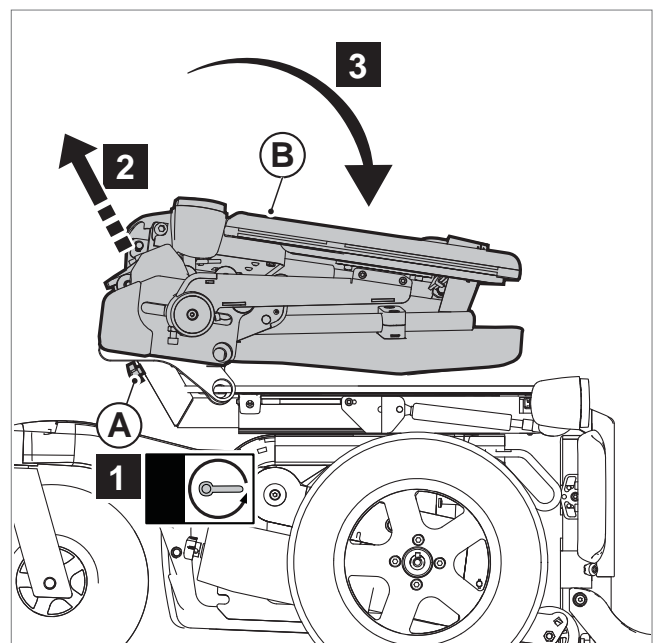

### Removing the standard legrest

1. Push (A) to the rear.
2. Swing (B) to the side.
3. Remove (B).

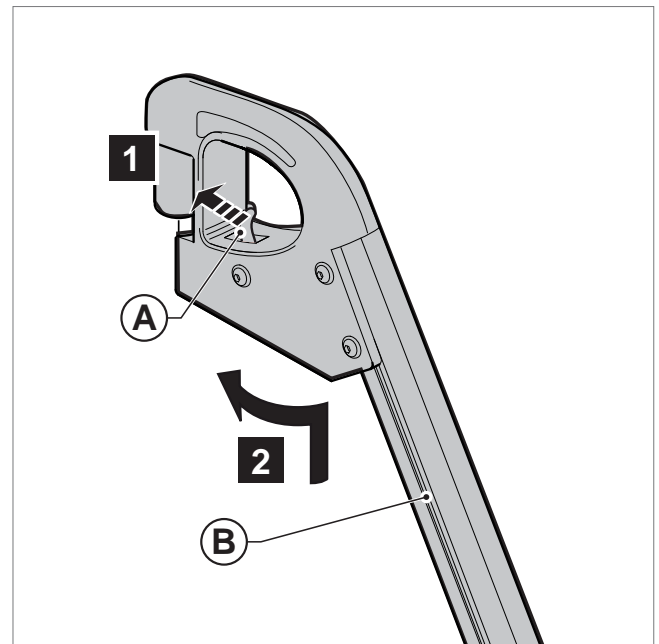

## 4.5 Setting up the seating system following transportation

### Positioning the standard legrest

1. Place the legrest (A) in the bracket.
2. Swing the legrest inwards.

#### **⚠ Caution!**

You should hear a click when replacing the legrest. This indicates that the legrest has locked into place.

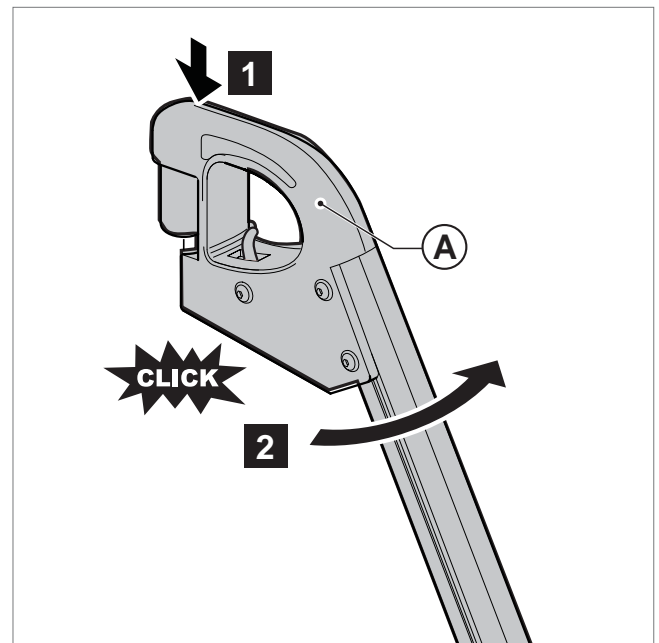

### Positioning the backrest for use

1. Lift (A) upwards and backwards. Due to its weight the backrest will fall into place.
2. Tighten the star knobs (B).

#### **⚠ Warning!**

Watch squeezing your fingers while lifting the back.

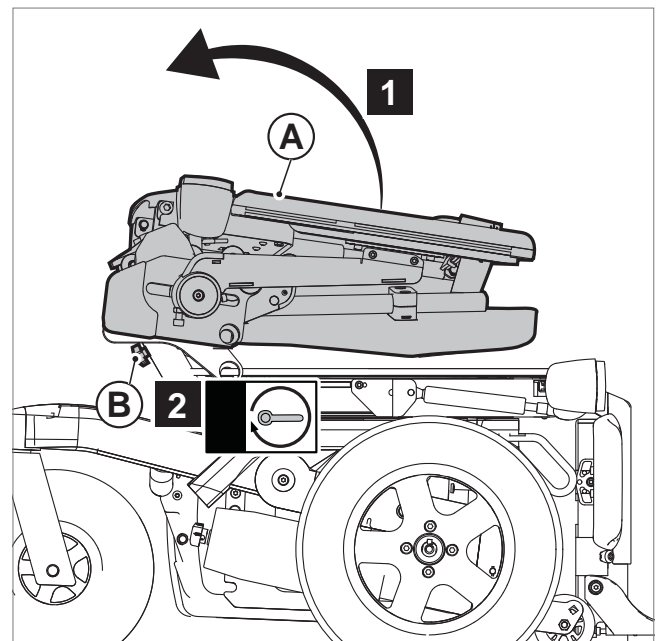

**Positioning the armrest**

1. Unlock the armrest (A)
2. Flip down the armrest (B)

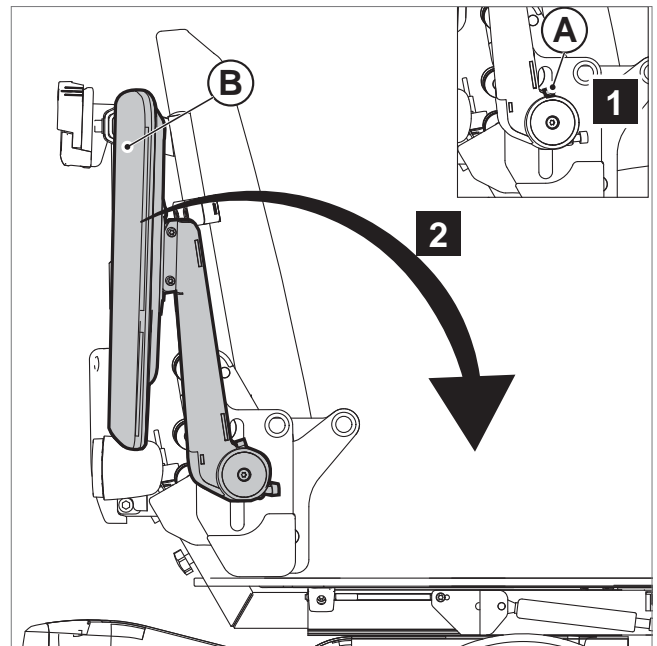
**Positioning the seat cushion**

1. Slide (A) and (B) over (C) and (D)
2. Push (E) downwards.

**⚠ Caution!**

Ensure that (C) and (D) at the back of the seat hook under the bolt heads.

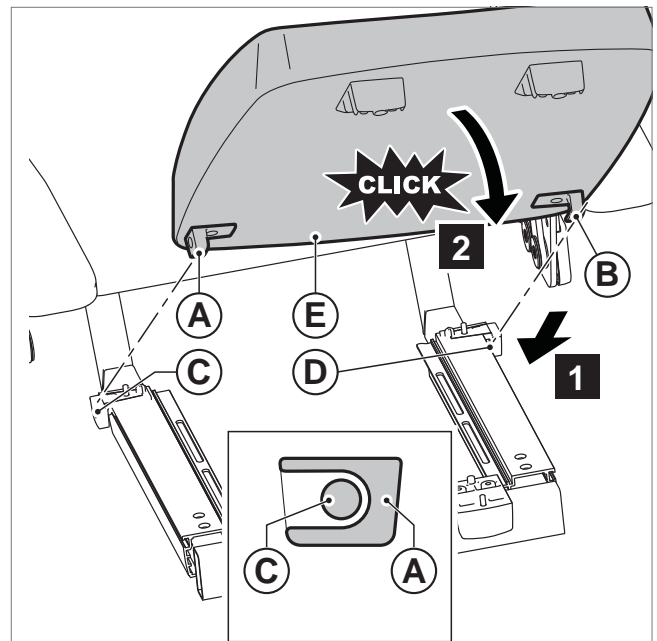

## 5 Adjustments (to be carried out by a professional)

### Note!

There are calibration marks on various parts of the seating system. The ex-factory settings are indicated.

### 5.1 Seat width

1. Unscrew (A) (with use of a ring spanner) and (B).
2. Adjust to desired seat width.
3. Place (A) (with use of a ring spanner) and (B) in new holes and tighten.

### Note!

First adjust one side, then the other side.

### 5.2 Seat depth

#### Backrest adjustment

1. Loosen (A) by one turn.
2. Adjust (B) to the desired position.
3. Tighten (A).

### ⚠ Warning!

The stability of the wheelchair is influenced by the adjustment of the seating system's centre of gravity.

Such adjustments should be made by professionals only.

#### Seating system adjustment

1. Remove the seat (see "Use - Reducing the seating system in size for transportation purposes").
2. Remove the screws (B).
3. Move (C) and (D).
4. Tighten the screws (B).
5. Replace the seat (see "Use - Setting up the seating system following transportation").

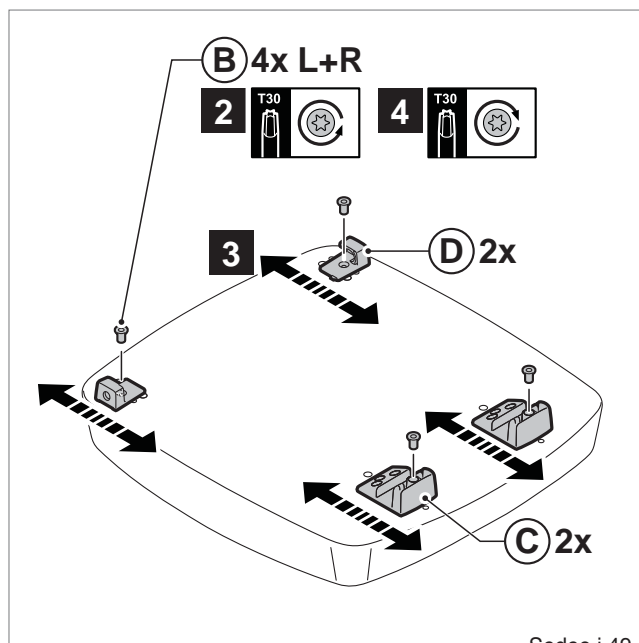
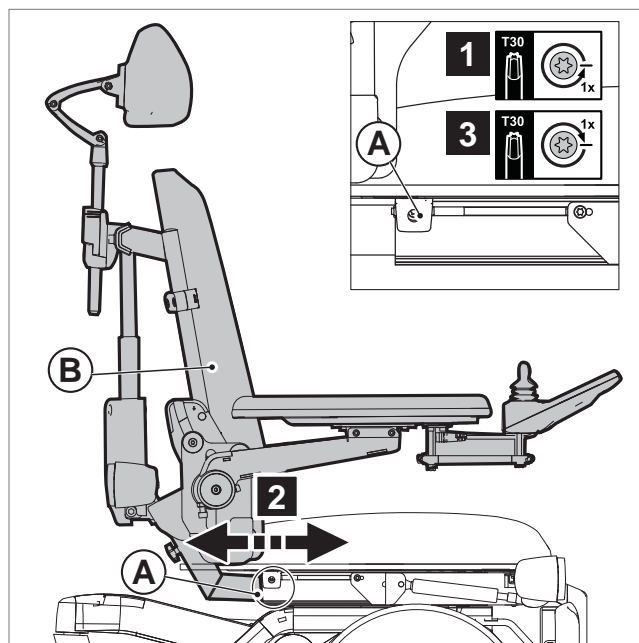
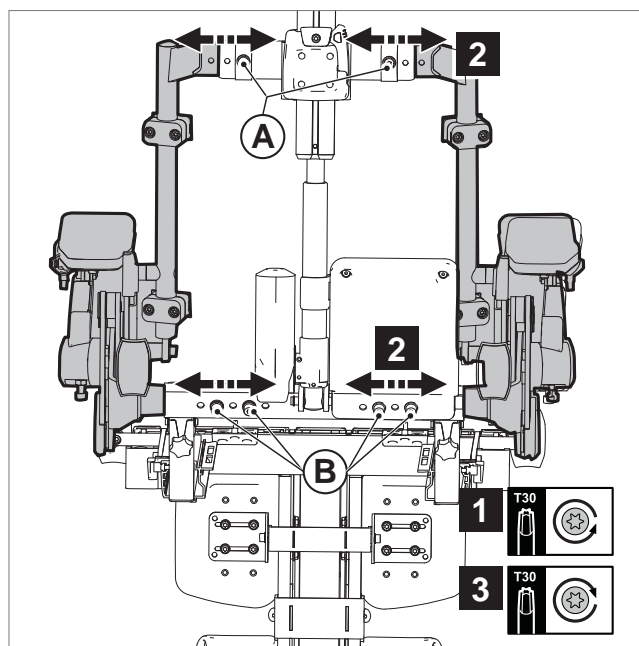

## 5.3 Backrest height

### Note!

First loosen the velcro backrest flap from the seat frame.

### Height (1)

1. Loosen the 8 screws (A) by one turn.
2. Adjust the backrest to the desired position.
3. Tighten the 8 screws (A).

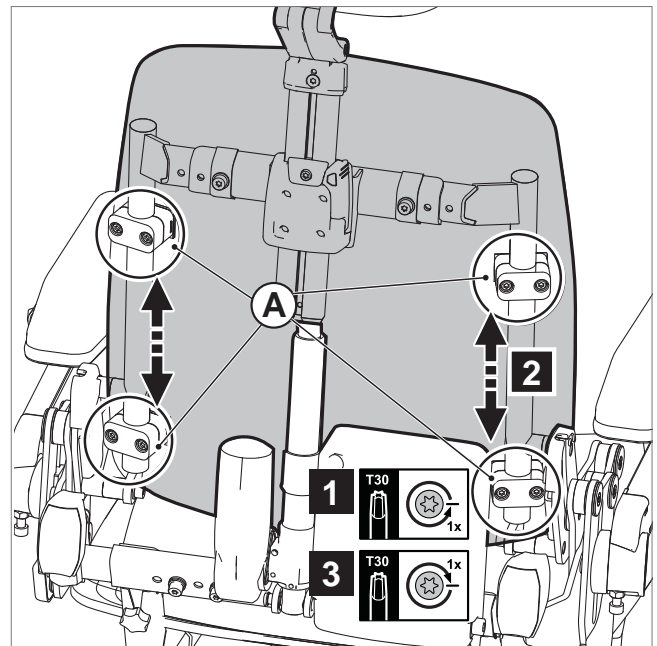

### Height (2)

1. Remove the 8 screws (A, left and right).
2. Remove the 4 clamps of the backrest cushion
3. There are extra mounting holes in the wood of the backrest (B). Make holes in the fabric at the desired position.
4. Mount the clamps on the backrest
5. Mount the backrest on the frame by tighten the 8 screws (A).

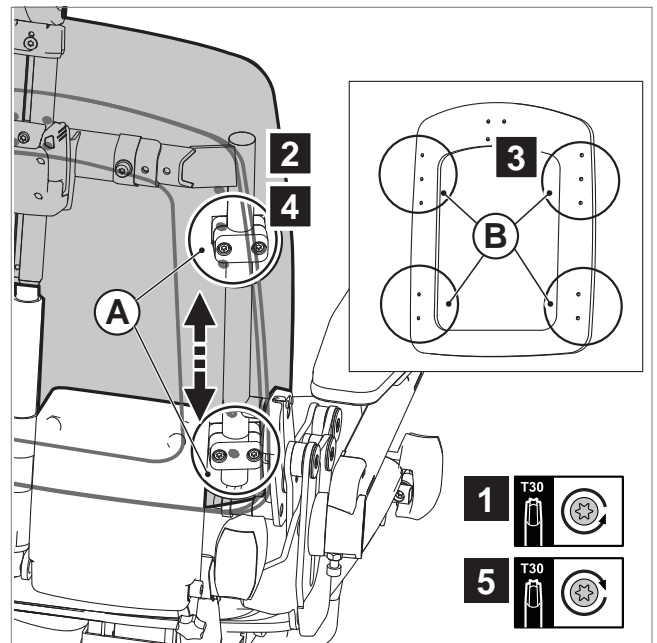

## 5.4 Standard and manually elevating legrest

### Legrest width

1. Loosen (A) by one turn.
2. Slide (B) into the desired position.
3. Tighten (A).

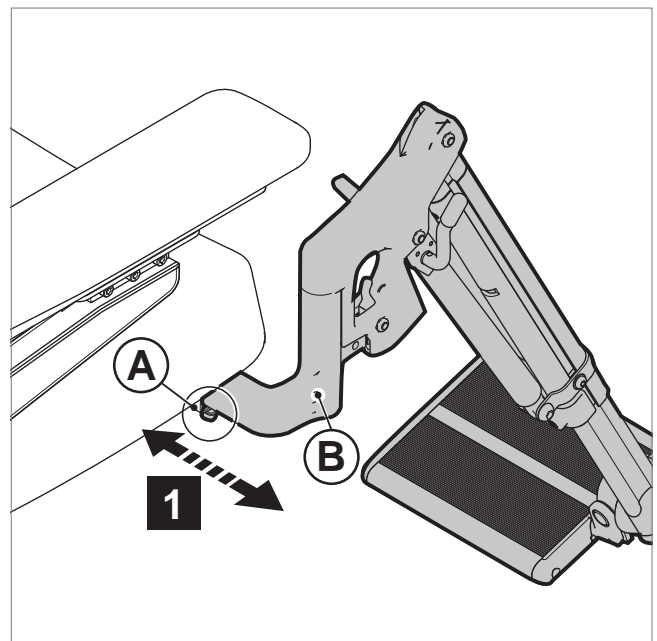



**Lower leg length**

1. Loosen the setscrew (A) a few turns with a 4 mm Allen key.
2. Slide the footplate (B) in the desired position.
3. Tighten the setscrew (A) securely.

**⚠ Caution!**

Ensure that there is sufficient free space under (B) for the wheelchair to drive over obstacles.

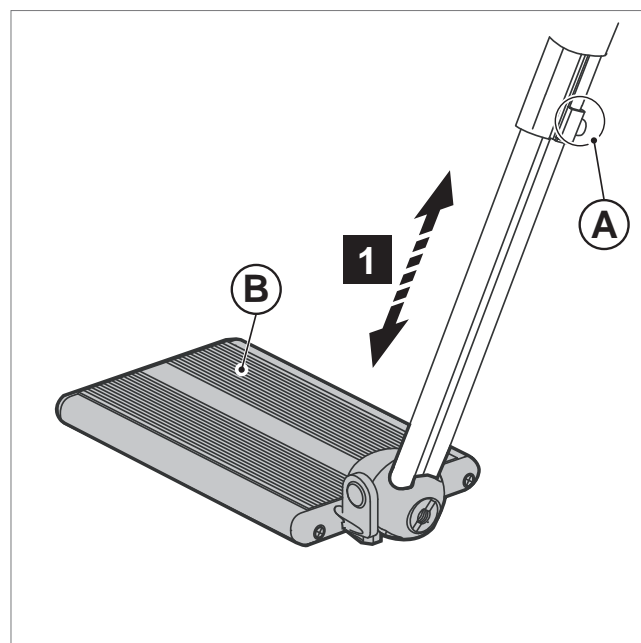
**Footplate depth**

The footplate is secured asymmetrically. The left and right footplate can be exchanged.

1. Loosen the setscrew (A) with a 4 mm Allen key.
2. Remove the footplate together with the profile.
3. Slide the footplate in the top tube of the other legrest.
4. Tighten the setscrew (A) securely.

**⚠ Caution!**

Make sure that the castor wheels do not touch the footplates when manoeuvring. If this is the case, the legrests must be brought forward. There must be at least 1 cm between the castor wheels and the footplates.

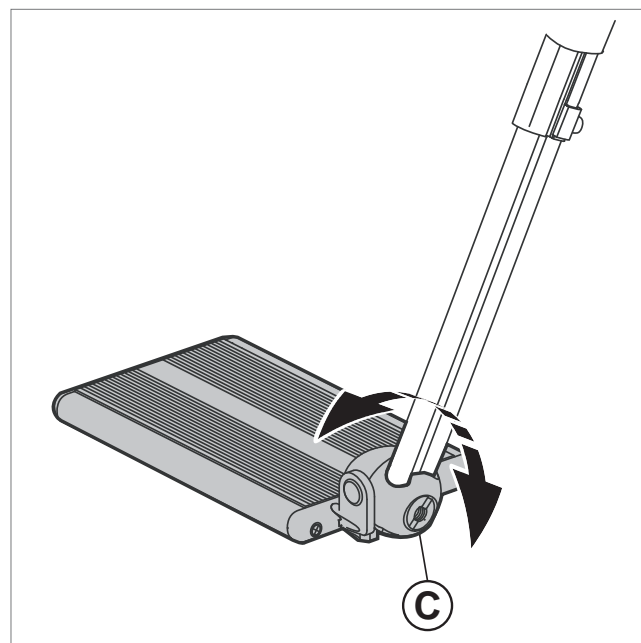
**Footplate angle**

1. Loosen the Allen bolt (C) a few turns with a 6 mm Allen key, so that the teeth of the hinge come completely free.
2. Adjust the desired footplate angle (D) and push the hinge manually together again.
3. Tighten the Allen bolt (C) securely.

**Calf pad height**

1. Loosen the Allen bolt (A) a few turns with a 4 mm Allen key.
2. Slide the calf pad (B) in the desired position.
3. Tighten the Allen bolt (A) securely.

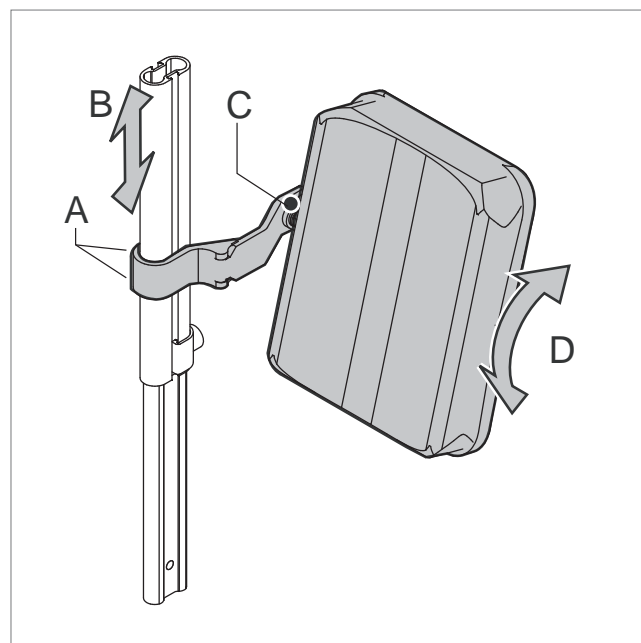



## 5.5 Central legrest

### Lower leg length

1. Loosen (A) by one turn.
2. Slide (B) into the desired position.
3. Tighten (A).

#### ⚠ Caution!

Ensure that there is sufficient free space under (B) for the wheelchair to drive over obstacles.

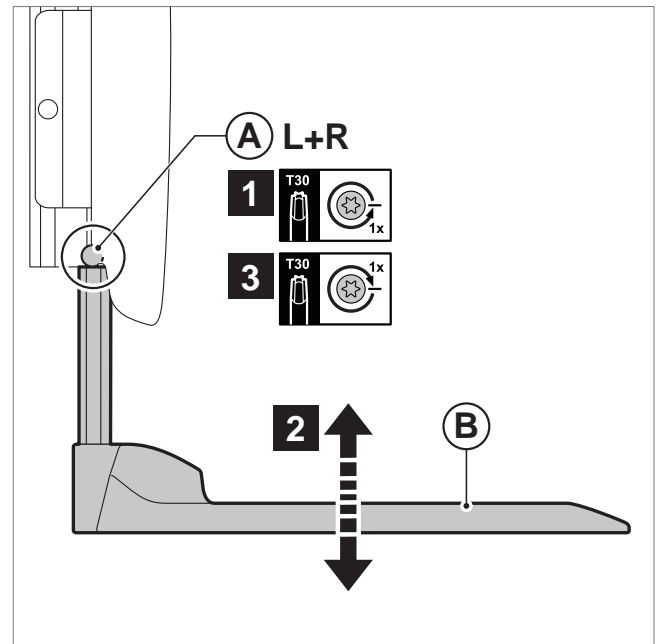

### Knee angle

1. Loosen (A) by two turns.
2. Adjust (B) to the desired angle.
3. Tighten (A) by two turns.

#### ⚠ Caution!

Change the height or knee angle if the footplate touches the castor wheels.

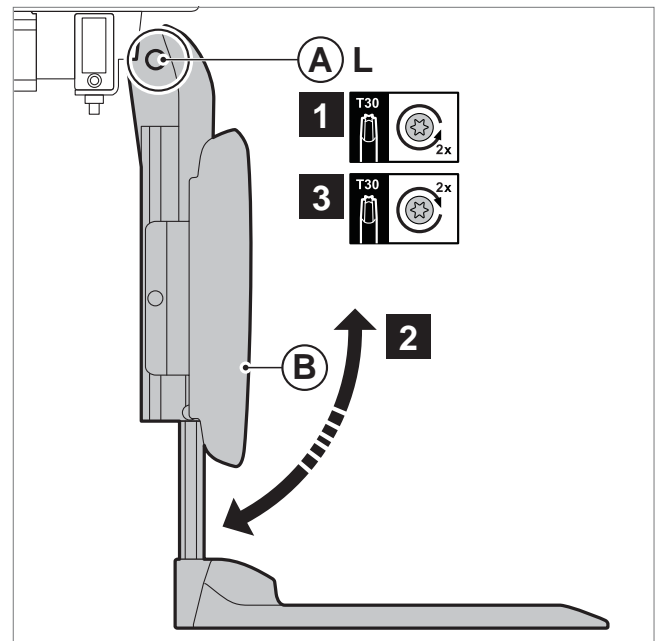

### Ankle angle

1. Flip up (A).
2. Turn (B) in order to adjust the ankle angle as desired.
3. Fold (A) down.

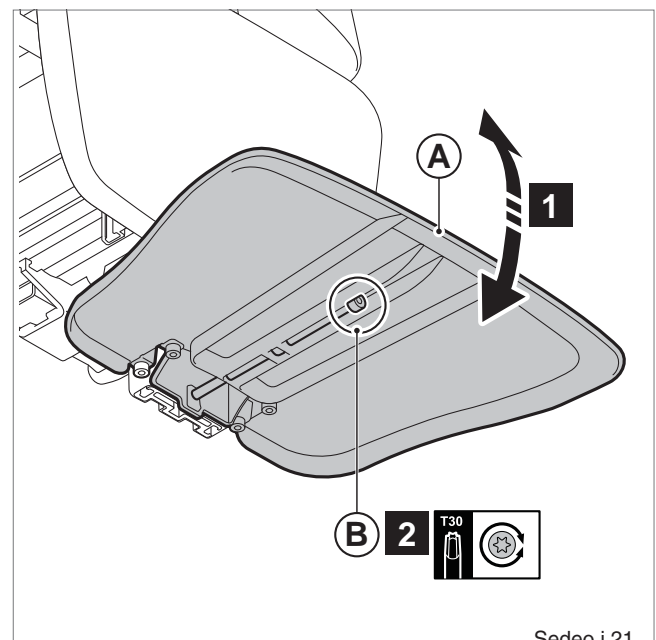

**Calf pad height**

1. Loosen (A) by one turn.
2. Slide (B) into the desired position.
3. Tighten (A).

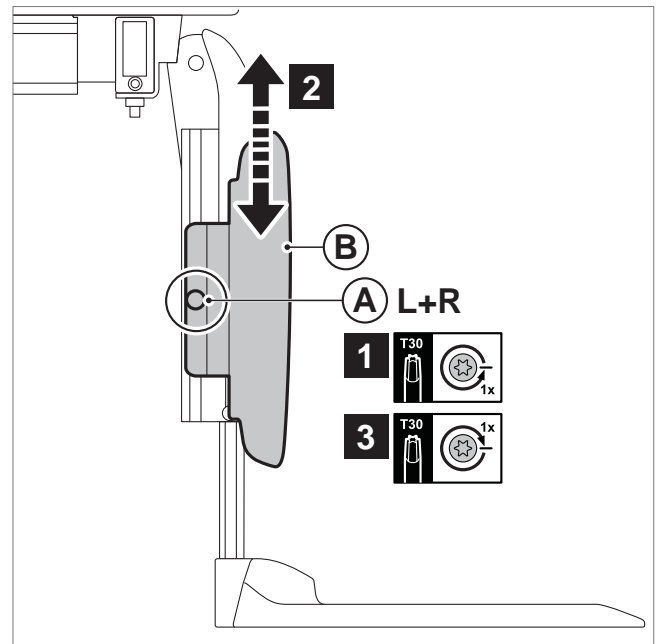
**5.6 Electrical central legrest****Lower leg length**

1. Loosen (A) by one turn.
2. Slide (B) into the desired position.
3. Tighten (A).

**⚠ Caution!**

Ensure that there is sufficient free space under (B) for the wheelchair to drive over obstacles.

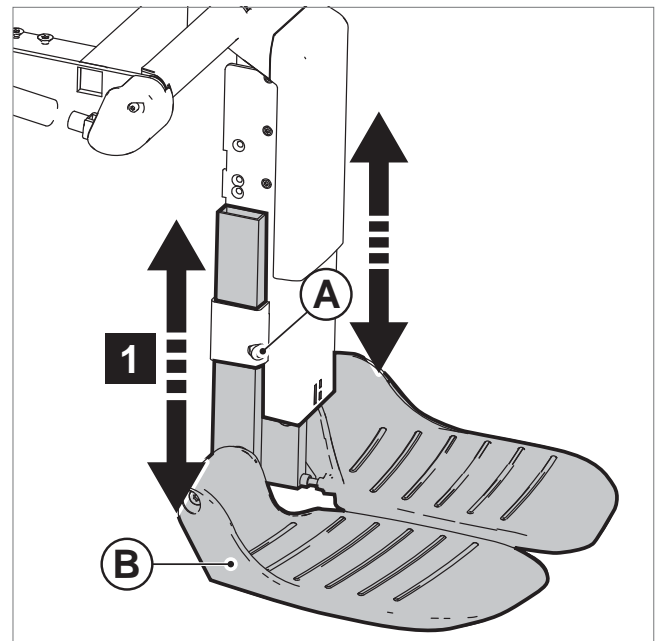
**Ankle angle**

1. Flip up (A).
2. Turn (B) in order to adjust the ankle angle as desired.
3. Fold (A) down.

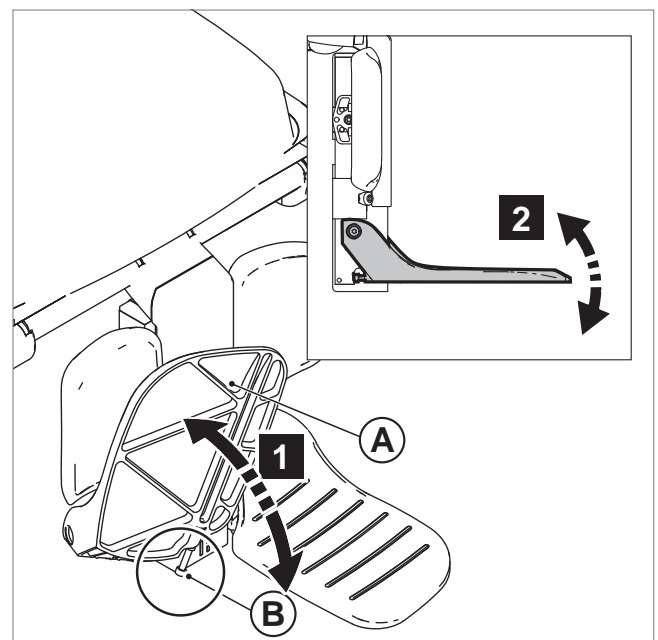

**Calf pad height(1)**

1. Lower the leg length
2. Unscrew (A) (2x)
3. Adjust (B) to desired height and move (A) to higher/lower holes (C)
4. Tighten (A) (2x)

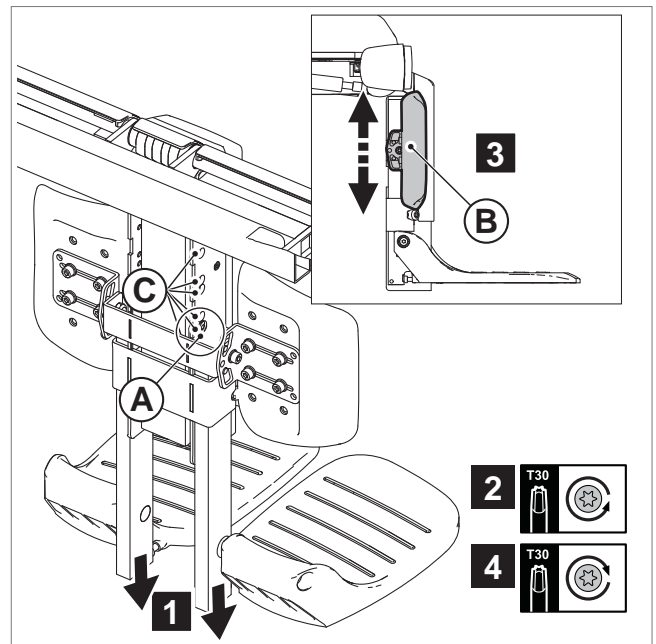
**Calf pad height(2)**

1. Unscrew (A)
2. Adjust (B) to desired height and move (A) to higher/lower hole.
3. Tighten (A)

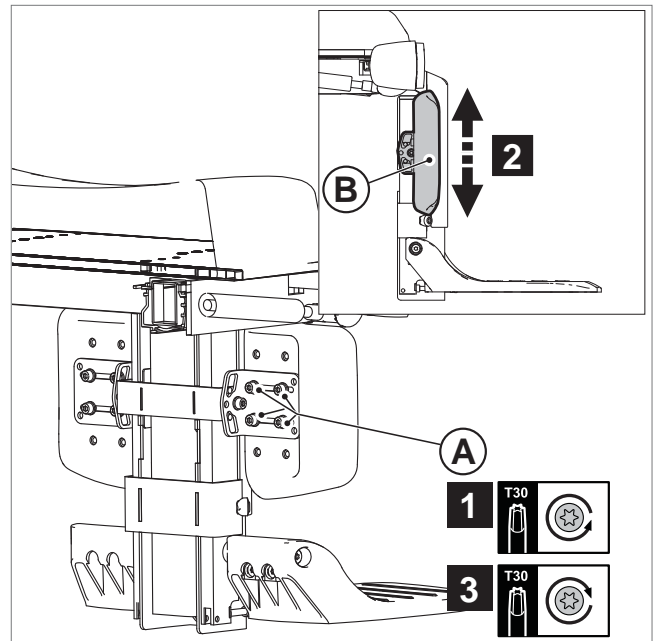
**Calf pad width**

1. Loosen (A) by one turn.
2. Slide (B) into the desired position.
3. Tighten (A).

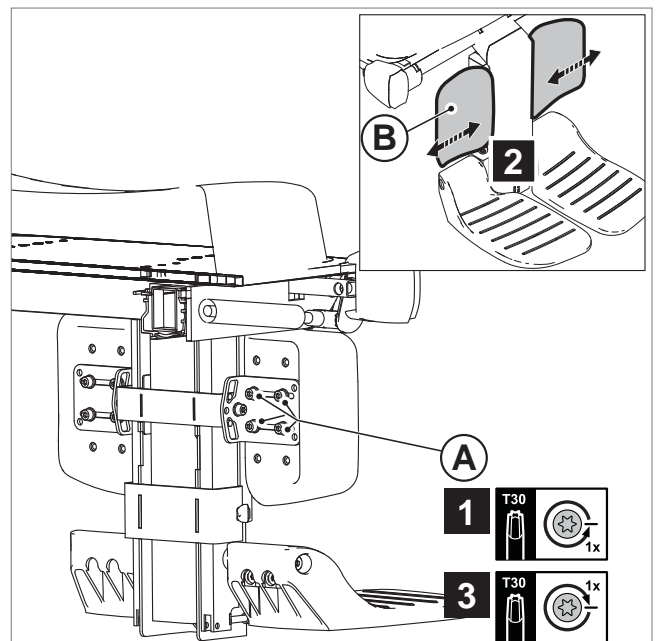

**Calf pad depth**

1. Unscrew (A)
2. Adjust (B) to desired depth and move (A) to new hole.
3. Tighten (A)

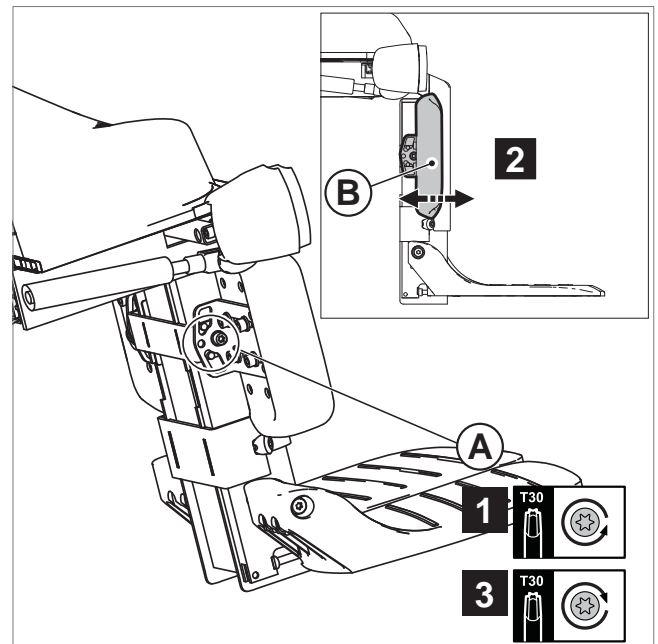
**5.7 Armrest assembly****Note!**

Ensure that the arms are supported well, without the shoulders being pushed upwards.

**Armrest height (1)**

1. Loosen (A) by one turn.
2. Adjust the armrest to the desired position.
3. Tighten (A).

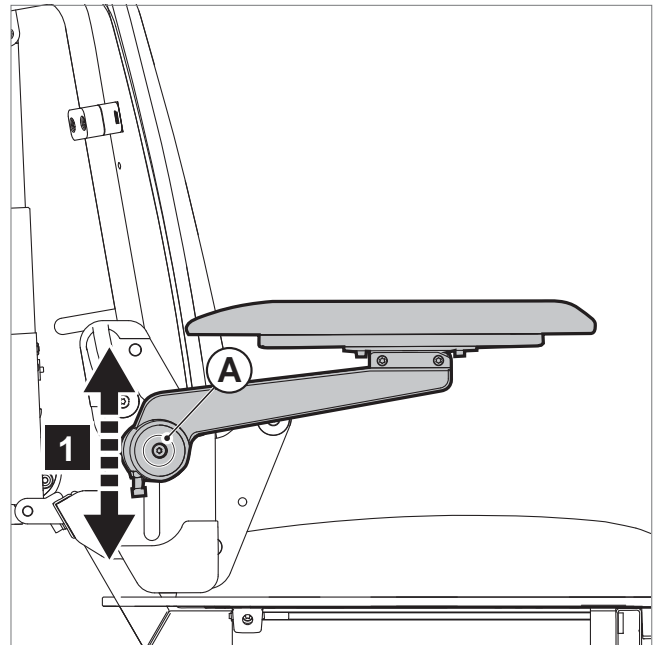
**Armrest height (2)**

1. Turn screw A to position the armrest height
2. Loosen B by one turn
3. Adjust the armrest angle
4. Tighten (B)

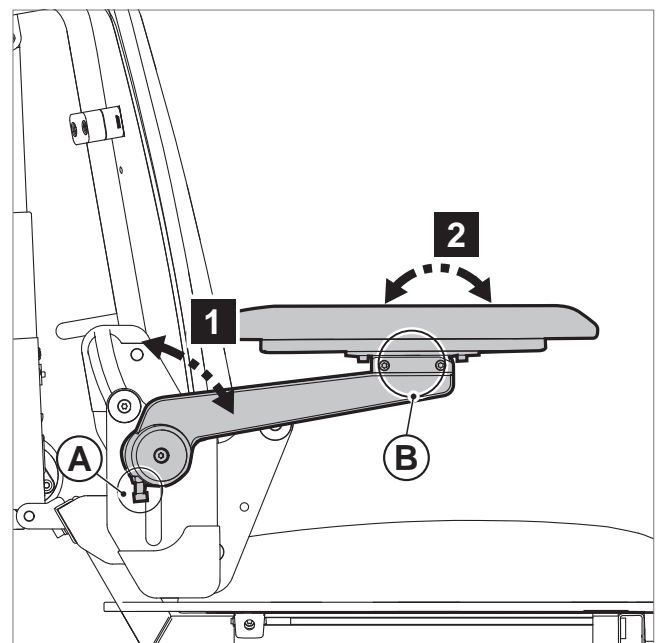

### Armrest depth (1)

**Note!**

In case you cannot access the bolts (A) first adjust the armrest angle.

1. Loosen (A) by one turn.
2. Slide (B) into the desired position.
3. Tighten (A).

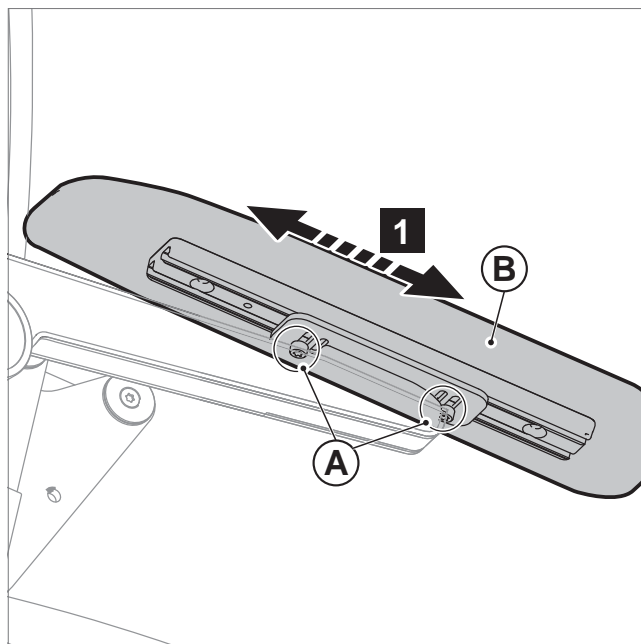

### Armrest depth (2) (only armrest pad 40 cm)

1. Loosen (A).
2. Position (B) into the desired position
  - a Enlarge armrest depth
  - b Reduce armrest depth
3. Tighten (A).

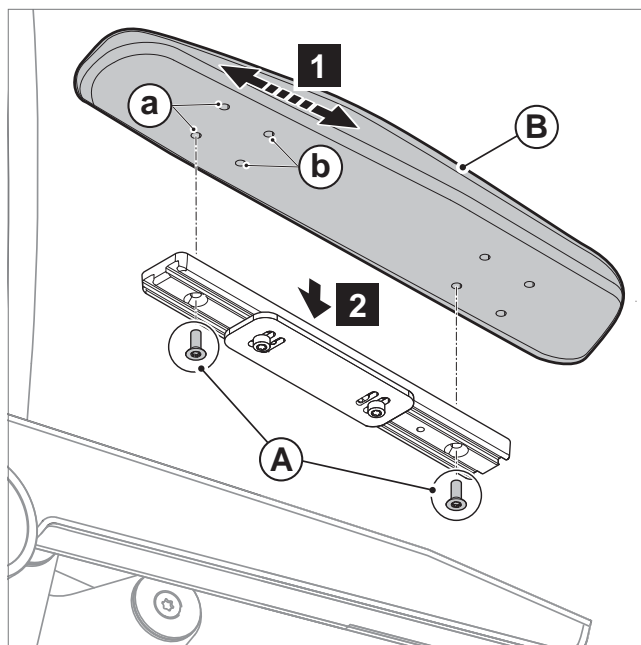

### Armrest width (1)

**Note!**

In case you cannot access the bolts (A) first adjust the armrest angle.

1. Loosen (A) by one turn.
2. Slide (B) into the desired width.
3. Tighten (A).

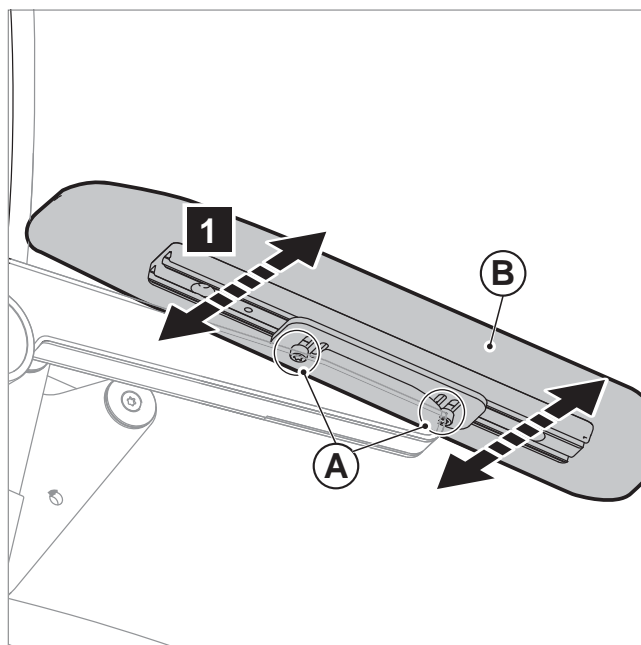

**Armrest width (2)**

To remove:

1. Remove (A) and (B).
2. Remove (C) and (D).

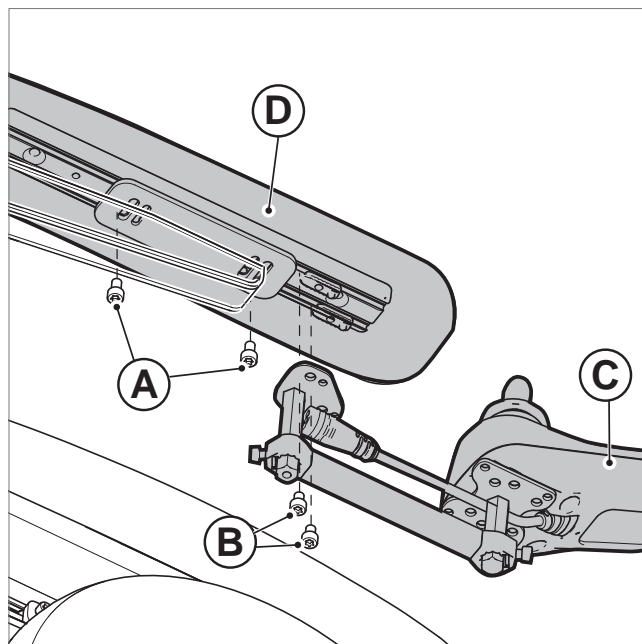

To position:

3. Slide (D) onto (E).

**Note!**

Ensure that the ridge on the terminal block falls into the opening

4. Adjust the depth of (D) and tighten (A).
5. Position the controller bracket and tighten (B).

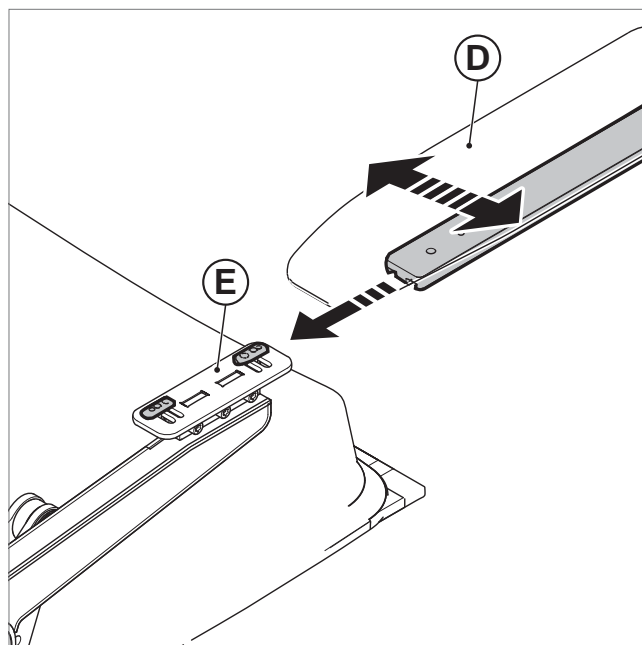
**Armrest width (3)**

1. Loosen (A).
2. Position (B) into the desired position
  - a Left: Reduce armrest width
  - Right: Enlarge armrest width
  - b Left: Enlarge armrest width
  - Right: Reduce armrest width
3. Tighten (A).

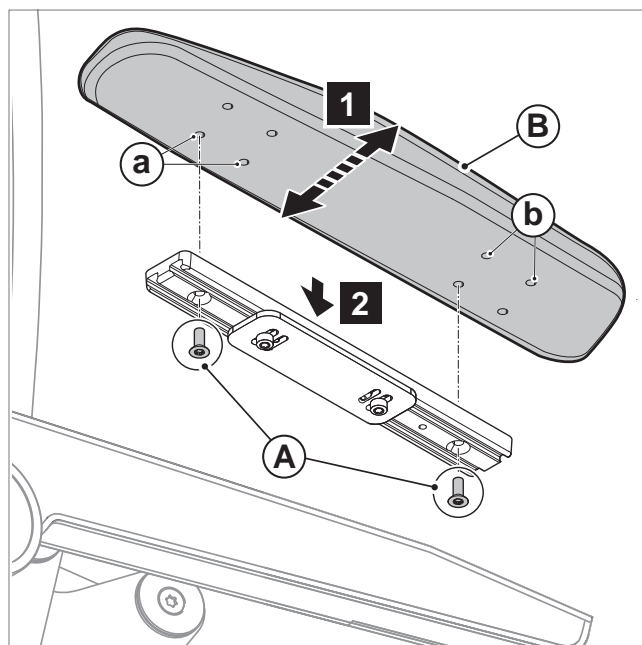

### Armrest horizontal angle

1. Loosen (A).
2. Adjust (B) to desired position  
By positioning (A) into different sliders of (C) an additional horizontal angle can be achieved

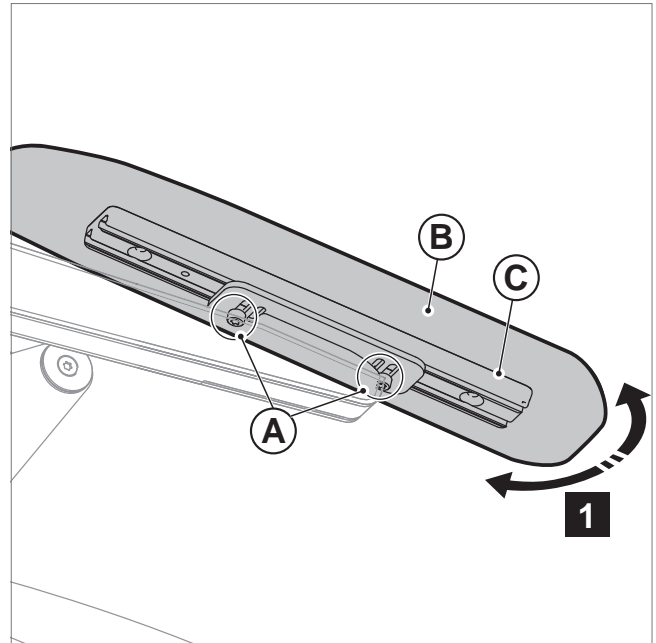

### Side cushion

Adjust the side cushion as follows:

1. Loosen the Torx screw.
2. Adjust the part to the desired position.
3. Tighten the Torx screw

A/a. Height adjustment

B/b. Width adjustment

C/c. Depth adjustment

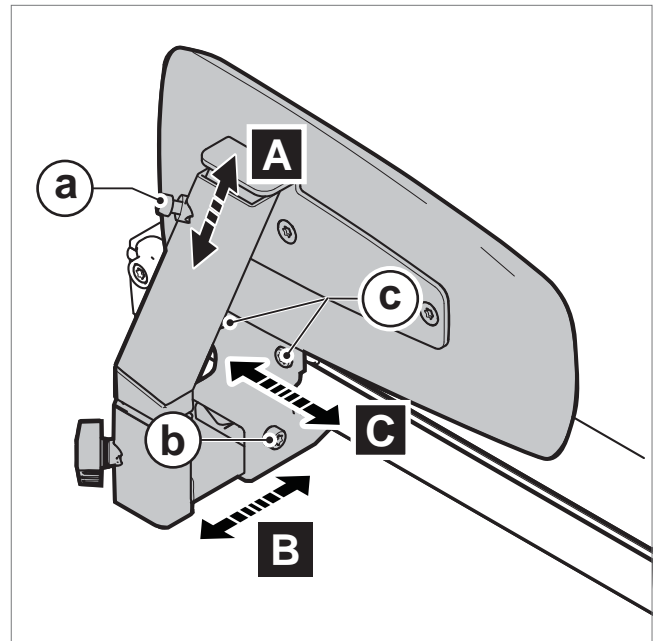

## 5.8 Adjusting the centre of gravity

### ⚠ Warning!

Changing the wheelchair's centre of gravity may negatively influence the wheelchair's driving characteristics and/or its dynamic stability. Such adjustments should be made by professionals only.

1. Loosen (A) by one turn.
2. Slide (B) forwards or backwards.
3. Tighten (A).

### Note!

If the user's weight distribution is average, then the centre of gravity should be adjusted to the same setting as the seat depth.

For better sliding release the seat depth adjustment

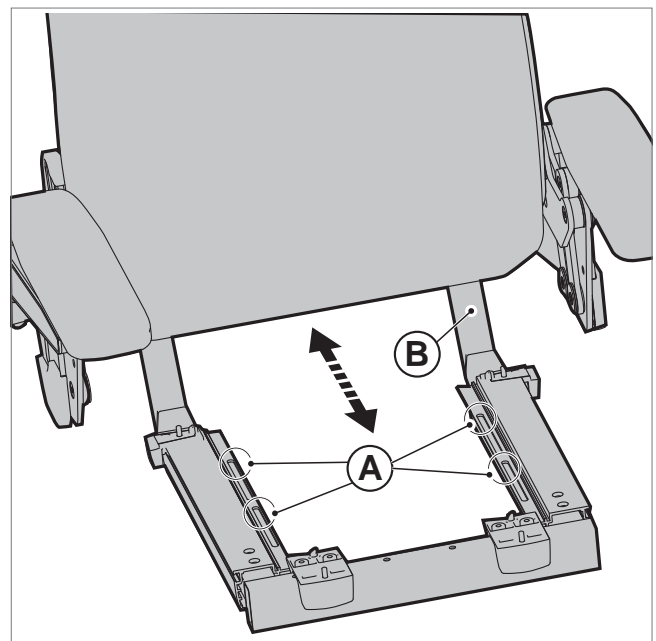

## 5.9 Headrest

### Adjusting the memory setting / headrest height

1. Loosen (A).
2. Loosen (C) by one turn.
3. Slide (B) into the desired position.
4. Slide (D) as far down as possible.
5. Tighten (A).
6. Tighten (C).

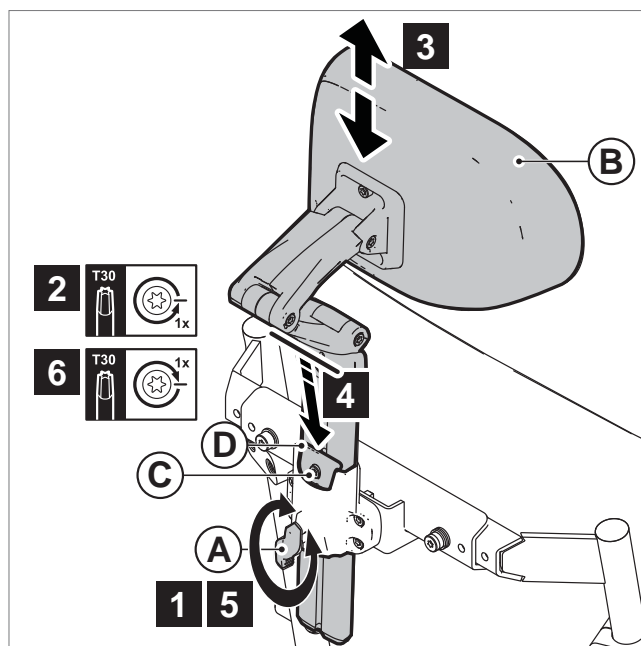

### Headrest position

1. Loosen (A) by one turn.
2. Adjust (B) to the desired position.
3. Tighten (A).

#### Note!

Correct the headrest height and tilt the headrest cushion as required.

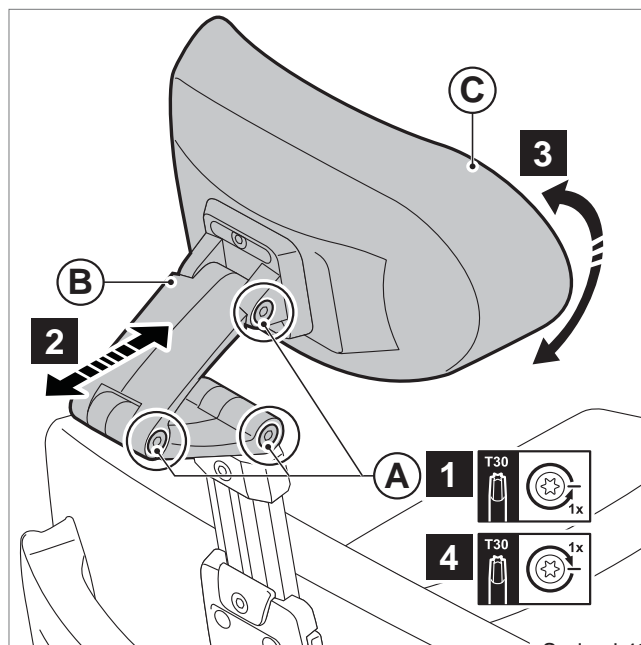

### Headrest cushion width

1. Loosen (A) by one turn.
2. Slide (B) into the desired position.
3. Tighten (A).

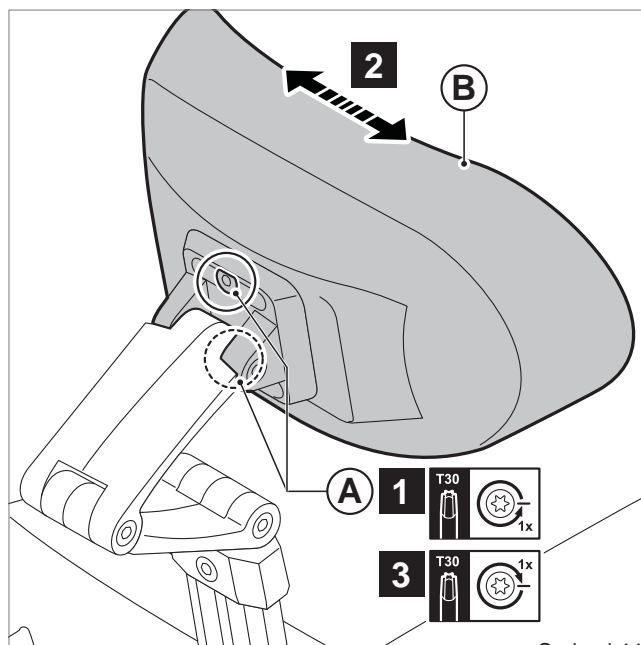



## 5.10 Fixed / swing-away controller bracket

### Depth

1. Loosen (A) by one turn.
2. Slide (B) into the desired position.
3. Tighten (A).

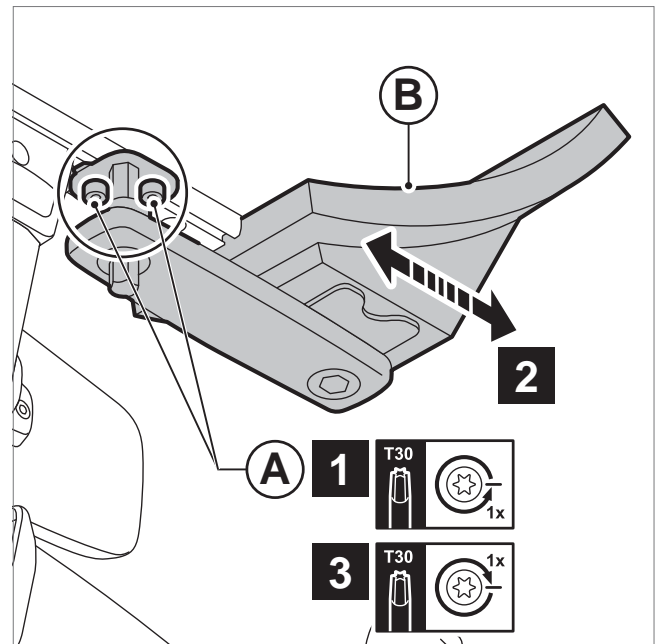

### Height (1)

1. Loosen (A) by one turn.
2. Slide (B) into the desired position.
3. Tighten (A).

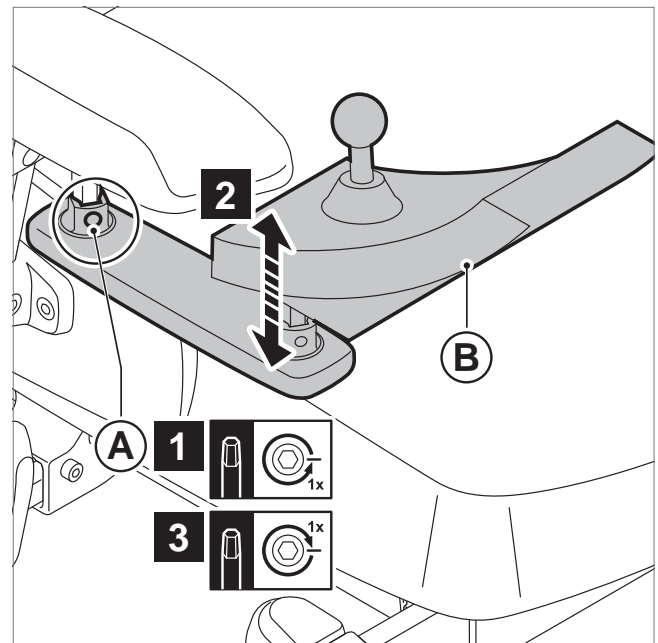

### Height (2)

1. Loosen (C) by one turn.
2. Slide (D) into the desired position.
3. Tighten (C).

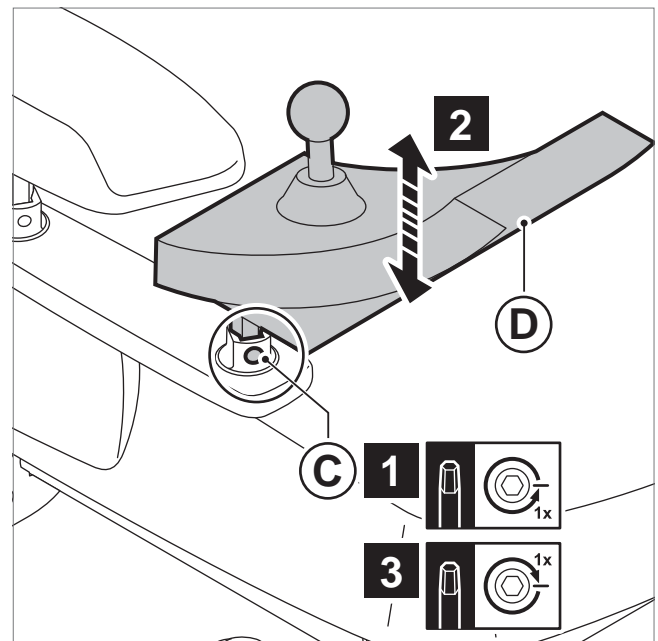

### 5.11 Backrest with adjustable straps - flexible

The sides of the backrest with adjustable straps can be adjusted as follows:

1. Loosen the 8 Torx screws.
2. Adjust the sides to the desired position.
3. Tighten the 8 Torx screws.

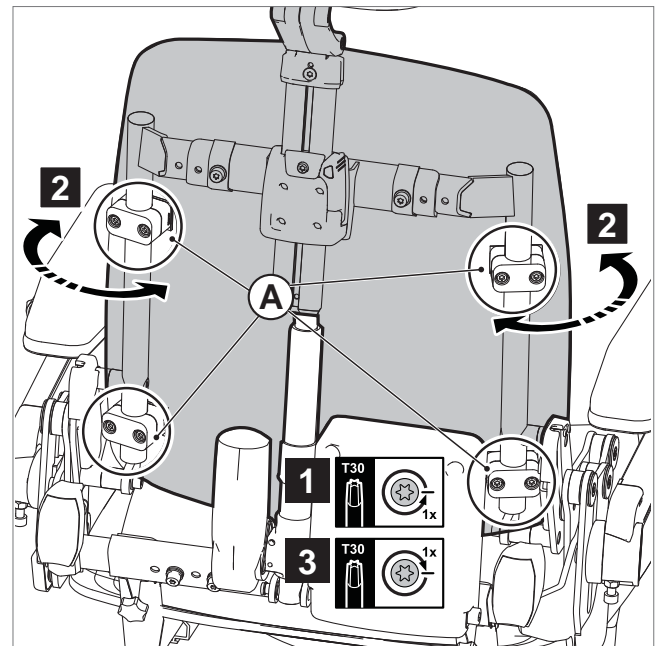

### 5.12 Velcro back curvature adjustment

1. Slacken all the straps a little before you begin to adjust the backrest. Start the adjustments with the lowest straps and work upwards.

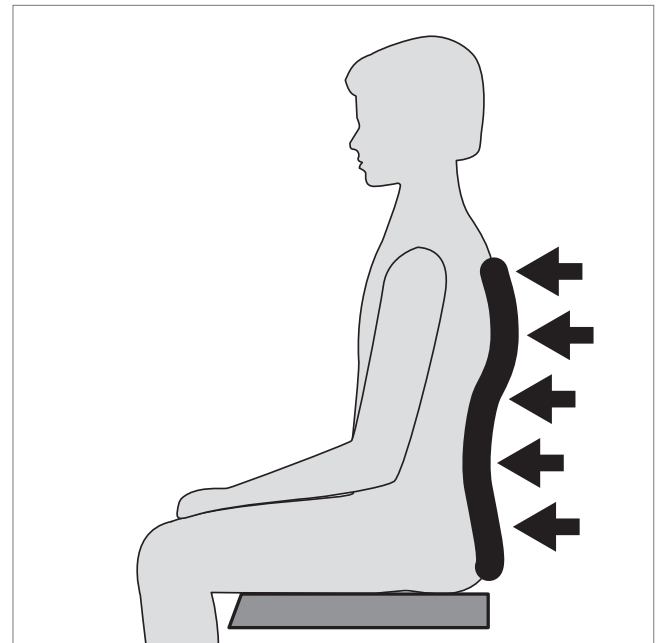

2. Tighten or loosen the straps (A) so that the user gets the maximum comfort and support.

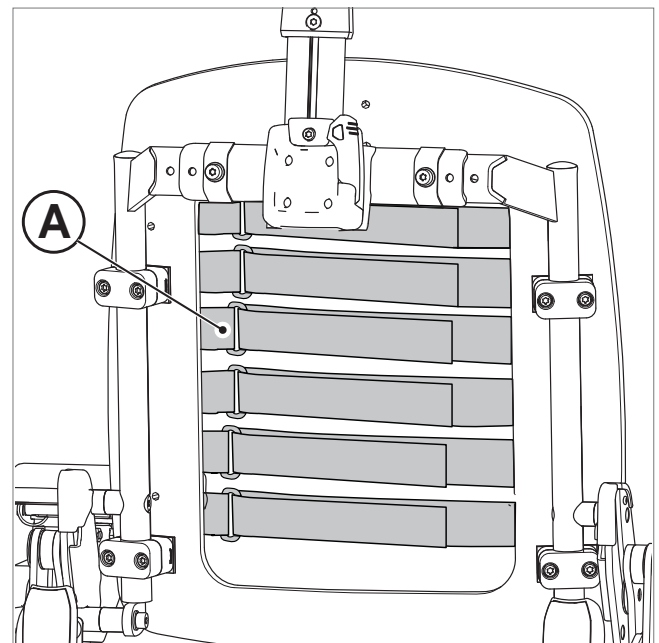

### 5.13 Abduction support

**Adjust the abduction support as follows:**

1. Loosen the Torx screw.
2. Adjust the part to the desired position.
3. Tighten the Torx screw.

A/a. Height adjustment.

B/b. Depth adjustment.

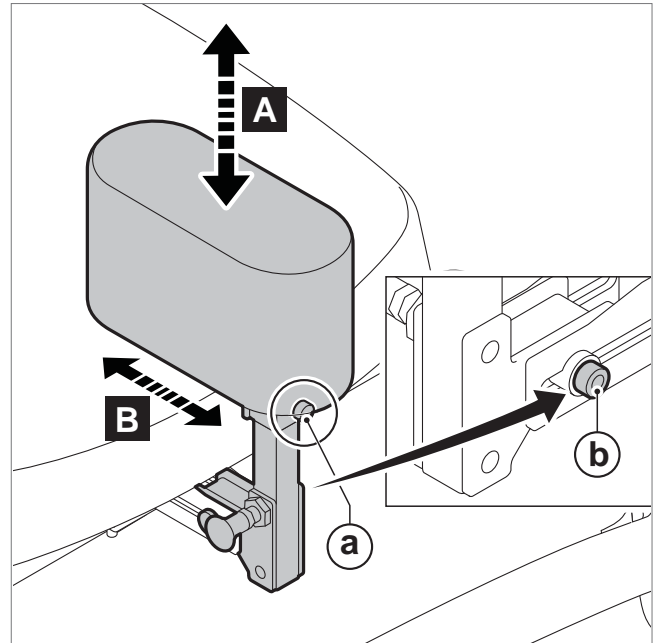

### 5.14 Thoracic support

**Adjust the thoracic support as follows:**

1. Loosen the Torx screw.
2. Adjust the part to the desired position.
3. Tighten the Torx screw.

A/a. Rough adjustment of width

B/b. Height adjustment

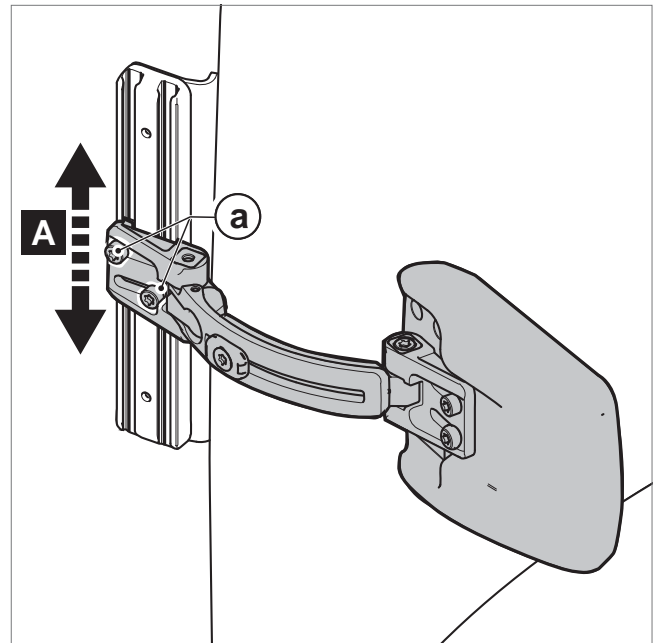

A/a. Adjustment of bracket depth

B/b. Adjustment of cushion depth

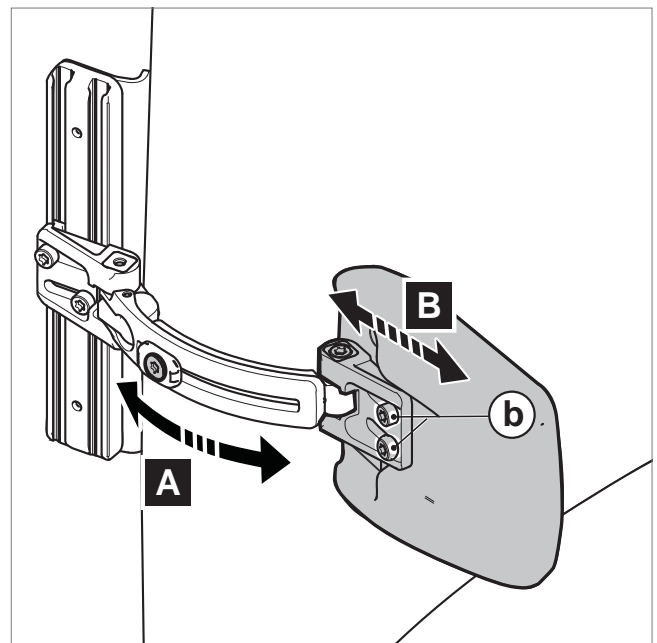

A/a. Adjustment of cushion angle  
B/b. Fine adjustment of width

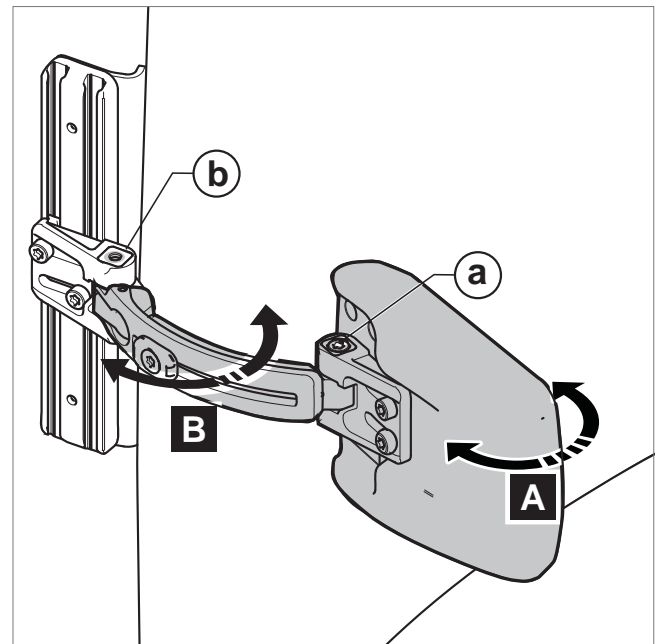

## 5.15 Attaching the lap strap

### Attaching to the seating frame

1. Tighten (A) through (B) into (C).

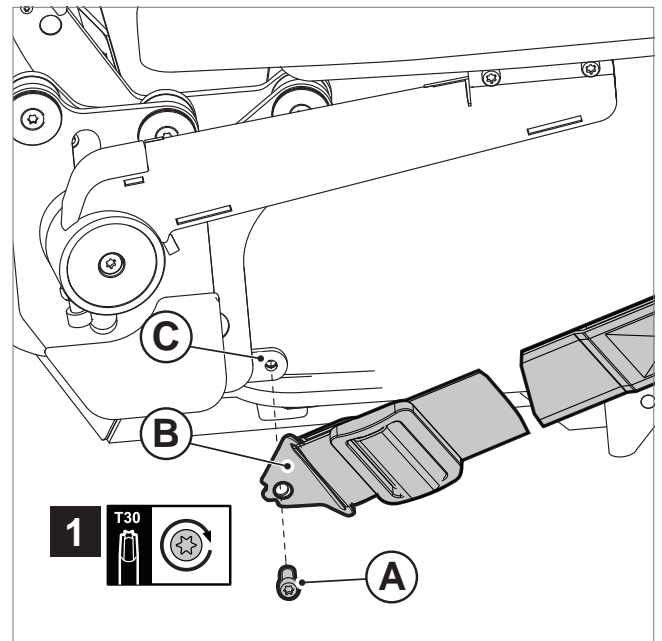

**⚠ Warning!**

Ensure that the lap strap is adjusted to the wheelchair user. The strap must fit snugly across the hips at an angle of approximately 45°.

Ensure that the strap is clean at all times and that the locking mechanism is working properly. The strap and the locking mechanism can be cleaned using a damp cloth.

If the strap is positioned above the hips and across the soft part of the user's belly, then this can result in seating posture being incorrect and the user slumping in the seat.

Never use the lap strap as a seatbelt when using transport.

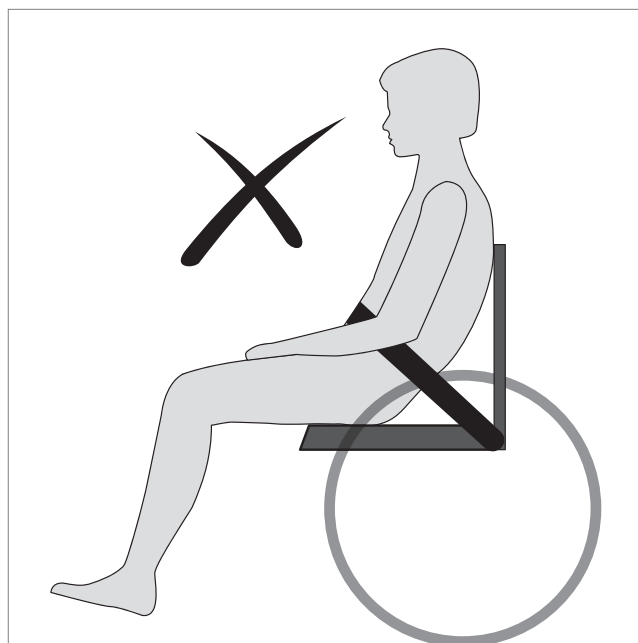
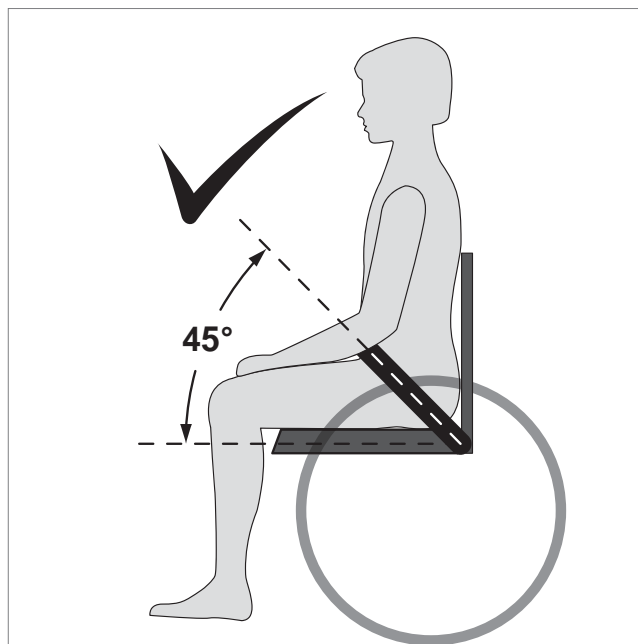

## 6 Maintenance

It is recommended that you have your wheelchair serviced by your dealer once a year or, in the case of intensive use, once every six months.

### 6.1 Cleaning the upholstery

Clean the upholstery using a damp cloth and household soap. Then rub dry using a soft, dry cloth.

#### PU parts

Clean the armrests, side cushions etc. using a damp cloth and household soap. Then dry the parts using a soft cloth.

#### Armrest cushion upholstery

Covers are removable and washable.

#### Seat and backrest cushion upholstery

Covers are removable and washable. Follow the washing instructions on the covers:  
For the incontinence cover see figure 1.  
For the comfort cover see figure 2.

#### **⚠ Warning!**

Do not use organic solvents such as thinner, benzine or white spirit.

Do not chemically clean the upholstery. Do not iron or spin-dry the upholstery.

1

### Stretch Rubber

58% Knitted Polyester  
42 % FR Polyurethane

#### Fabric

Backing 100% Polyester  
Coating 100% PVC

#### Care instructions

Do not use cleaning materials that contain solvents



9005849



2

### Stretch Fabric

35% Polyester  
65% Dioleen Safe

#### Fabric

Backing 100% Polyester  
Coating 100% PVC

#### Care instructions

Do not use cleaning materials that contain solvents



9005850



## 7 Troubleshooting

If there is a problem with your seating system, contact your dealer.

## 8 Technical specifications

### 8.1 CE declaration and requirements



The product is in conformity with the provisions of the Medical Devices Directive and carries the CE mark.

The product also meets the following requirements and standards. This has been verified by independent test organizations.

1. EN 12183 (2009) Manual wheelchairs or EN 12184 (2009) Electrically powered wheelchairs.
2. ISO 7176-8 Requirements for impact, static and fatigue strength.
3. ISO 7176-9 Climatic tests for electric wheelchairs and scooters.
4. ISO 7176-16 Requirements for resistance to ignition of upholstered parts.
5. ISO 7176-19 Crash test.
6. EN-ISO 10993-5 (1999-11) Biological evaluation of medical devices.
7. EN 1021 1,2 Assessment of the ignitability of upholstered furniture. Ignition source: smouldering cigarette/match flame equivalent.

### 8.2 Technical information

<b>Seating system</b>		
User weight	kg (st.)	160 (25.2)
Seat width	mm (inch)	380 - 600 (15 - 23.6)
Seat depth	mm (inch)	440 - 600 (15.7 - 23.6)
Point of gravity	mm (inch)	95 (3.7)
<b>Backrest</b>		
Backrest height	mm (inch)	480 - 670 (18.9 - 26.4)
Backrest recline	°	90 - 135
<b>Armrest</b>		
Armrest pad width	mm (inch)	-40 till +20 (-1.6 till +0.8)
Armrest pad height from seat frame	mm (inch)	240 - 360 (9.4 - 14.2)
Armrest pad depth controller bracket side	mm (inch)	95 (3.7)
Armrest pad depth non controller bracket side	mm (inch)	140 (5.5)
<b>Side support</b>		
Side cushion height	mm (inch)	100 (3.9)
<b>Central legrest</b>		
Lower leg length (with compressed seat cushion)	mm (inch)	330 - 495 (13 - 19.5)
Knee angle	°	30 - 110
Ankle angle	°	+20 till -40
Central calf support height (option)	mm (inch)	120 (4.7)



<b>Electrically elevating central legrest</b>		
Lower leg length (with compressed seat cushion)	mm (inch)	365 - 530 (14.4 - 20.9)
Knee angle	°	94 - 170
Maximum length compensation	mm (inch)	180 (7.1)
Ankle angle	°	+20 till -20
Calf support height	mm (inch)	90 (3.5)
Width calf supports	mm (inch)	350 - 430 (13.8 - 16.9)
<b>Standard legrest (set)</b>		
Lower leg length (with compressed seat cushion)	mm (inch)	340 - 510 (13.4 - 20.1)
Knee angle	°	70
Ankle angle	°	0 - 180
<b>Elevating and electrical elevating legrest (set)</b>		
Lower leg length (with compressed seat cushion)	mm (inch)	340 - 530 (13.4 - 20.9)
Knee angle	°	70 - 0
Ankle angle	°	0 - 180
Calf support height	mm (inch)	120 (4.7)
<b>Headrest</b>		
Headrest height (memory)	mm (inch)	170 (6.7)
Headrest depth	mm (inch)	180 (7.1)
Headrest vertical angle	°	-45 - 45
Headrest width standard headrest (option)	mm (inch)	-20 - 20 (-0.8 - 0.8)
Headrest width width adjustable headrest (option)	mm (inch)	-110 - 110 (-4.3 - 4.3)
<b>Controller bracket</b>		
Controller bracket height	mm (inch)	60 (2.4)
Controller bracket depth	mm (inch)	35 (1.4)
<b>Controller bracket swing away</b>		
Controller bracket height	mm (inch)	50 (2)
Controller bracket depth	mm (inch)	35 (1.4)
Controller position angle	°	0 - 45
<b>Hemiplegia</b>		
Hemiplegia armrest angle (option)	°	0 - 45
<b>Abduction support</b>		
Abduction support height	mm (inch)	60 - 120 (2.4 - 4.7)
Abduction support depth	mm (inch)	60 - 110 (2.4 - 4.3)
<b>Thoracic support</b>		
Thoracic support width	mm (inch)	-60 - 0 (-2.4 - 0)
Thoracic support height	mm (inch)	200 - 400 (7.9 - 15.7)
Thoracic support depth	mm (inch)	20 - 70 (0.8 - 2.8)

## 9. Warranty

The provisions of warranty and liability applicable to the seating system are identical to those incorporated in the wheelchair manual.

( Wheelchair)



Dealer:

Serial number:



**handicare**

[www.handicare.com](http://www.handicare.com)