

Xeo

DYNAUDIO





x^eo

the next revolution.

the next revolution will change everything. again.

Multi-room. Multi-source. Totally lossless. With advanced digital technology. For awesome sound. When the original Xeo was launched in 2012, it set the sound quality standard for all wireless loudspeakers. That's why Xeo was voted one of the 10 best new products at the CES and subsequently earned rave reviews and awards all across the globe. It was 24 months later that our first competitors finally arrived. They didn't achieve much, frankly. And we haven't been sitting idle either. So here it comes. The next revolution in high-end wireless. The next-generation Xeo, with better DSP performance, upgraded amplifiers and advanced sound tuning.

Raising the benchmark, once again. And it will raise those little hairs on your arms and in your ears. Because Xeo was, is and will remain the best-sounding wireless loudspeaker on the planet! So burn your cables. Sell your amp. Ditch everything that currently clogs up your system. And dig the new Xeo. What Xeo does is connect you to the music. To your movies. Completely lossless. Directly from any source. Because, who invented the loudspeaker? The Danes. Who builds the finest studio monitors professionals rely on? Dynaudio in Denmark. And whose true high-end wireless speaker system do you crave? Exactly.

Dynaudio. Xeo. The next revolution.



Xeo 4

the next revolution will
sound awesome.

Xeo 4 minimizes your system to the essentials: The audio source and the speakers. A high-end digital amplifier is integrated into Xeo, so speaker cables and external amplifiers become obsolete. With Auto Play, connection is automatic.

Xeo can be used with anything that plays music: computer, mobile phone, personal player, video system, docking station, network player, streaming client, TV, hifi audio system, anything. The music from your computer finally sounds great. Videos from the internet finally sound great. Even your smartphone finally sounds great.

Because Xeo contains the worldwide reference for music reproduction in its DNA: the renowned Dynaudio drive units with matching integrated digital amplifiers and advanced digital sound processing. Music enthusiasts, musicians and audio critics everywhere are in awe of Dynaudio loudspeakers. Now imagine that within a complete system. You may end up with the best two-way single-source musical instrument in the universe.

Xeo 4. The next revolution.



"The Xeo 4s serve up great-quality, convenient, versatile wireless sound."
WHAT HI-FI?, November 2014

*"Distinctively expressive and vital sounding compact speaker
with good, strong bass and finest timbre. Precise sound-staging.
Despite sounding open it never becomes obtrusive."*
AUDIO, October 2014



Xeo 6

the next revolution will
bring a bigger bang.

Hallelujah, a bass. Eureka, voices. Surprise, butterflies in your brain. Oops, the kick. The new Xeo 6 is the absolute reference for wireless high-end. It kills cable effects. It eliminates timing problems. It bans voodoo stuff. It resurrects dead records. Because it has everything the famed Dynaudio reference speakers possess. Plus a new Speaker Position EQ allowing you to optimize the sound quality according to the speakers' placement in the room. Along with the added convenience of the very informative visual Xeo Interface which makes Xeo more user-friendly than ever.

The new Xeo is also very intelligent, as Auto Play automatically finds your music source, making Xeo even more convenient for the less-technically-minded user. True aficionados will also dig the new upgraded remote control, as remote control interaction has gotten really smooth and quick. And signal stability and reliability is further improved via the new multi-band technology. But the most important feature is: nothing stands between you and the music.

Xeo 6. The next revolution.



"...an ideal proposition for music lovers who want serious hi-fi sounds from minimal components."

Hi-Fi Choice, September 2014

"Very neutral and widerange-sounding floorstand speaker, distinguished character without any artificiality. Superior in the bass, surprisingly power-stable despite its compact size, with precise sound-staging."

AUDIO, October 2014

www.dynaudio.com/xeoreviews



Xeo Hub

the next revolution will be totally connected.

The Xeo Hub connects to your music sources and sends a wireless digital signal to the Xeo 4 or Xeo 6 loudspeakers.

The Hub has three digital inputs: optical, coaxial, USB. All three inputs also accept music with a high data rate and resolution up to 24 bit/96 kHz. This means that even high-res audio files can be played with Xeo.

Two analogue inputs are also provided: A stereo mini jack for connecting a smartphone, tablet or any other personal media devices, as well as a set of RCA stereo inputs allowing connection to an existing hifi system or other analogue sources. Depending on room shapes and wall construction, the Xeo Hub can send the wireless signal up to 20 meters, or even more in spaces without any boundaries. The Multi-room function also allows multiple Xeo speakers to receive the signal from a Xeo Hub.

And the best thing: The Xeo Hub requires no software and no installation as it instantly sets up its own wireless connection to the Xeo speakers via the 2.4 GHz or 5 GHz frequency.

Xeo Hub. The next revolution.



Xeo is the ideal sound upgrade for your smartphone, mobile player, tablet, network player, streaming device, flat screen, hard disc player. Or simply as a substitute for the hifi system.

Xeo is incredibly versatile: The Xeo Hub can be connected to any analogue and digital music source. Analogue Minijack 3.5 mm. Analogue RCA. Optical Digital. Coaxial Digital. USB.

Thanks to the Multi-source function all music sources can play simultaneously. You choose the inputs right at the speaker or by using the Xeo Remote Control. And with Auto Play, Xeo even finds your music before you find the remote.

Xeo Multi-source. The next revolution.

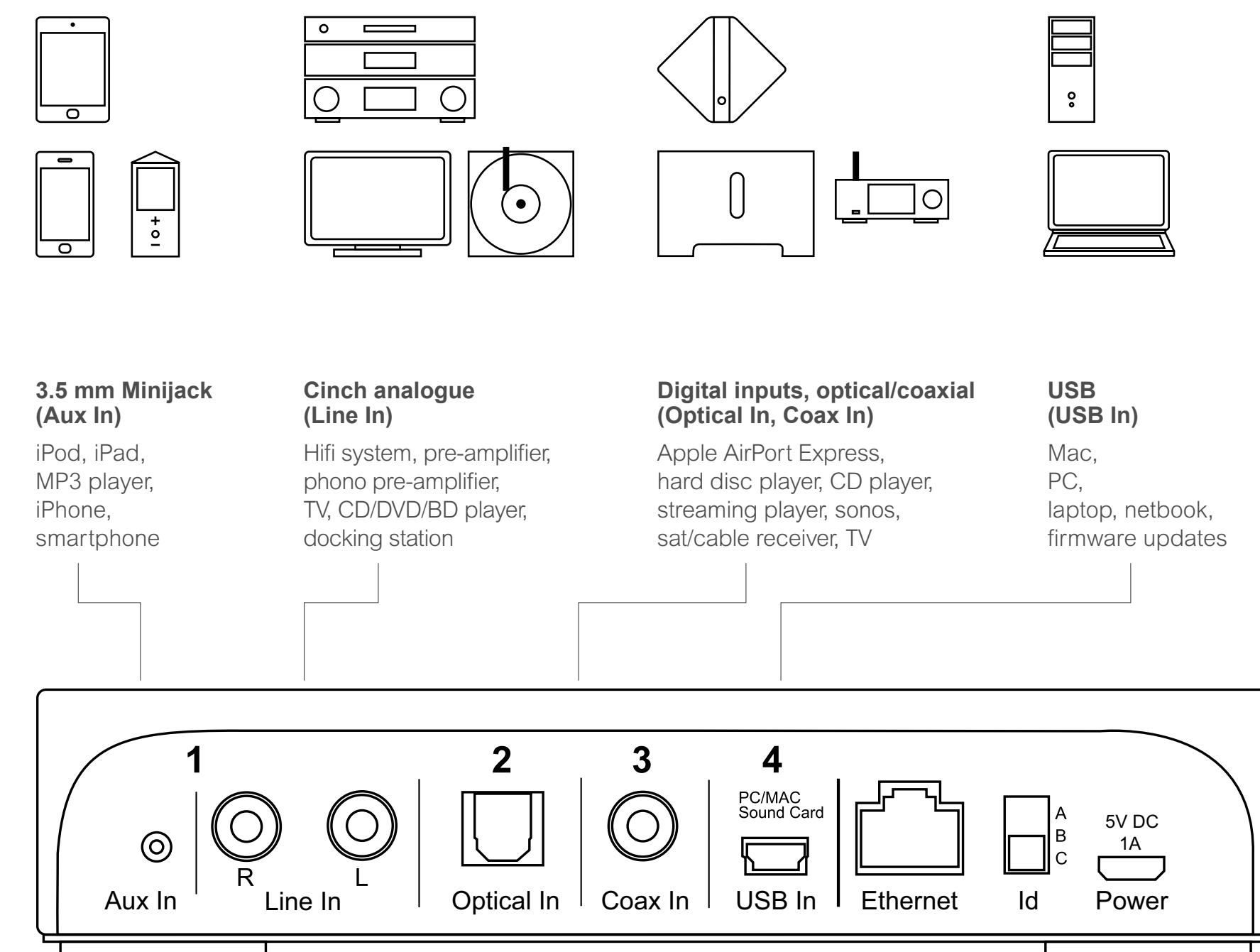

Xeo Extender, Xeo Link the next revolution will be more flexible than ever.

Xeo Extender and Xeo Link expand the Xeo system to provide many more possibilities.

Xeo Extender extends the range of the Xeo Hub. This means that Xeo speakers can be positioned further away, long corridors or partition walls can be bridged or the Xeo signal can be sent to another floor – e.g. for another pair of Xeo speakers.

Xeo Link is a receiver. It makes the wireless signal of a Xeo hub usable for other analogue or digital devices. For example: an active subwoofer, a headphone amplifier or a hifi system can be connected to the analogue stereo output of Xeo Link. Xeo Link either runs in parallel with the Xeo speakers and takes over their volume control and input selection, or it is set to a separate zone and runs independent of the Xeo speakers. In addition, Xeo Link even has its own infrared receiver. The Xeo combination options are almost limitless.

Xeo Extender and Xeo Link. The next revolution.

Xeo Multi-room the next revolution will be everywhere.

Several Xeo speakers can play in the same room. Or in a number of rooms. All connected to the same Hub. Thanks to the Multi-source function, it is even possible for the Xeo speakers to play various sources from the Hub. Or all the same source.

With a simple press of a button, your music will be everywhere, in any room. You've never before been so close to the action. All without running a single speaker cable.

For a smart Multi-room solution simply set your Xeo loudspeakers to belong to either Zone Red, Green or Blue, and you are ready to switch each zone's Xeo on or off, to set individual volume levels, or select the desired music source. You can also group all Xeo speakers in the house to one zone and have Xeo playing your tunes everywhere. The new Speaker Position EQ allows you to optimize the bass performance in the room with a simple switch on the loudspeaker: Set Xeo to be free standing, near a corner, near a wall and enjoy even further sonic refinement.

Xeo Multi-room. The next revolution.

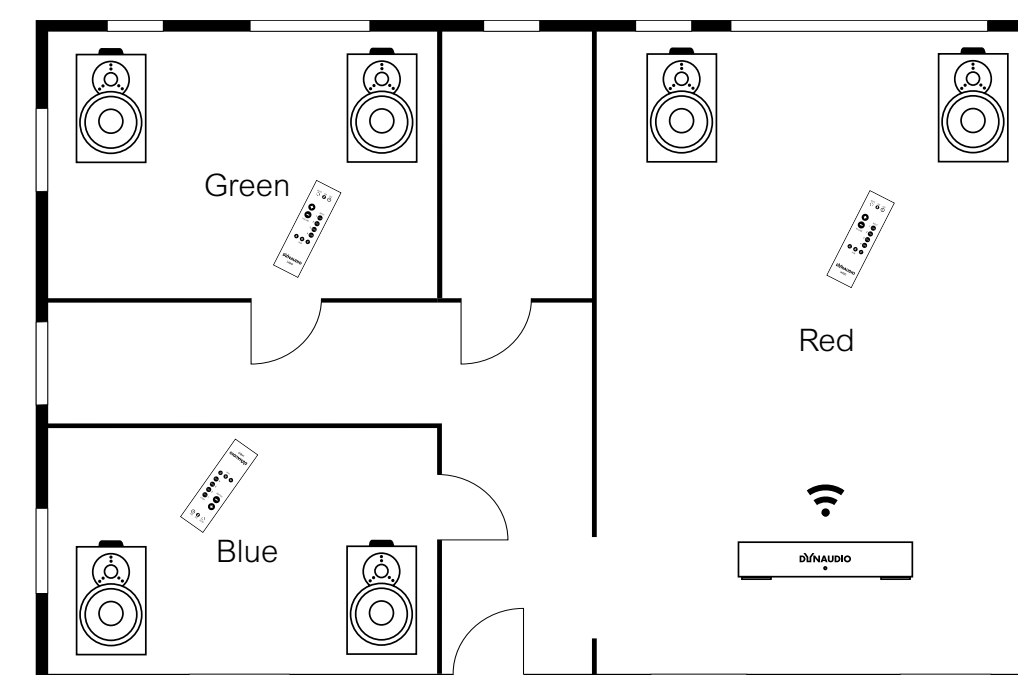

Example for Xeo Multi-room

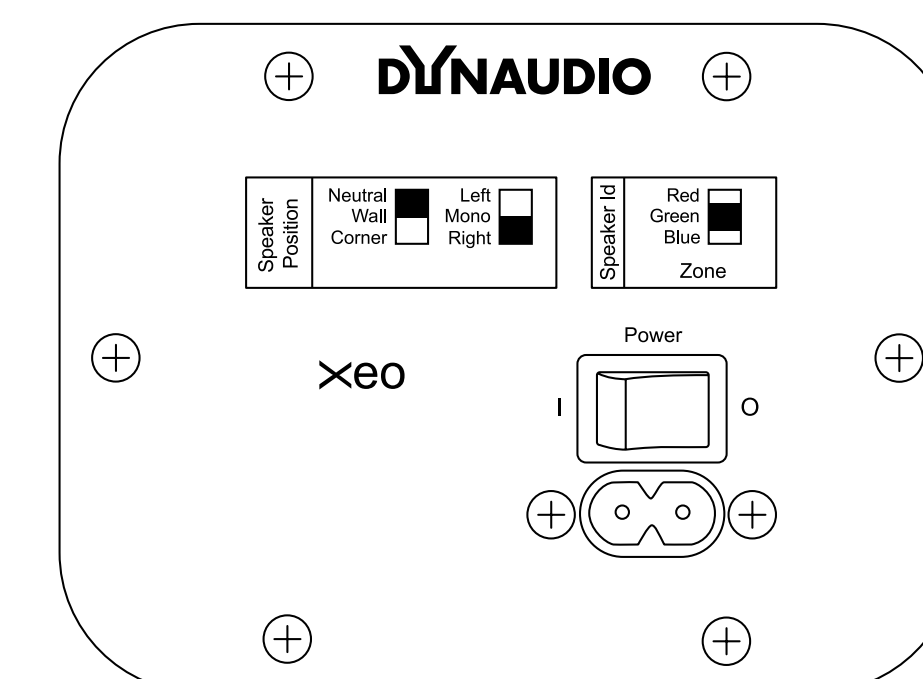

Setting options on the speaker backplate

sound quality

the next revolution comes from the north.

Since Dynaudio was founded in 1977, our mission has always been to communicate the truth. And nothing but the truth. With the next generation Xeo, we've come a step closer to that ideal once again. Dynaudio is and remains the true north for high-end music reproduction everywhere on the planet. We're happy you're there with us.

Please stay and enjoy...

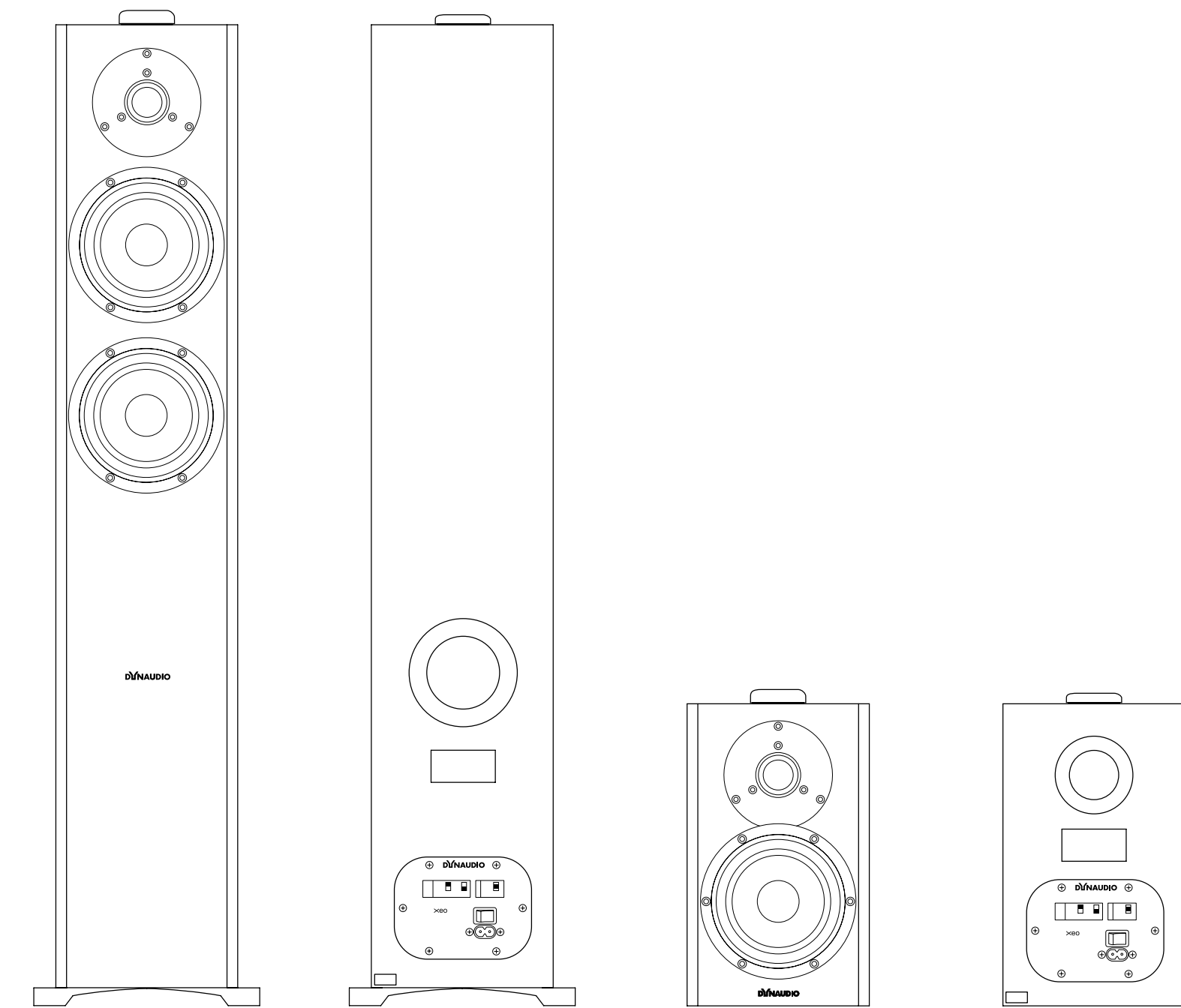

Technical Specifications	Xeo 4	Xeo 6
Frequency response (+/- 3dB)	45 Hz – 23 kHz	31 Hz – 23 kHz
Power consumption	5 – 38 W	7.4 – 77 W
Power consumption standby	0.34 W (network active)	0.35 W (network active)
Power rating	Woofer: 50 W, Tweeter: 50 W	Woofer: 2 x 50 W, Tweeter: 50 W
Dimensions (W x H x D)	170 x 282 x 246 mm (6.7 x 11.1 x 9.7 inch)	170 x 854 x 246 mm (6.7 x 33.6 x 9.7 inch)
Weight	6.4 kg	14.7 kg
Power supply	100 – 240 V, 50/60 Hz	100 – 240 V, 50/60 Hz
Finishes	Satin White Lacquer Satin Black Lacquer	

Technical Specifications	Hub
Transmission signal frequencies	2.4 GHz, 5.2 GHz, 5.8 GHz (subject to availability)
Wireless signal resolution / sample rate	accepts up to 24 bit/96 kHz
Dimensions (W x H x D)	140 x 32 x 105 mm (5.5 x 1.3 x 4.1 inch)
Weight	0.2 kg
Power Supply	Adaptor: 100 – 240 V or Micro USB: 5 V / min. 500 mA
Colour	Black

Further information and technical data: www.dynaudio.com/xeo

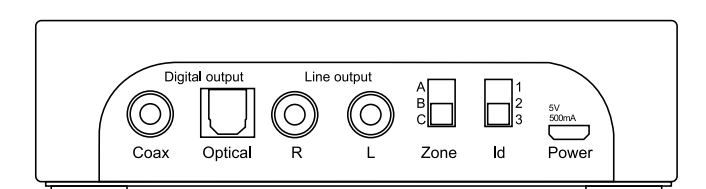
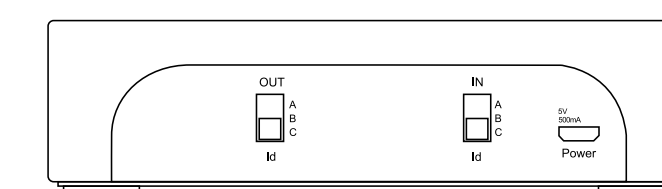
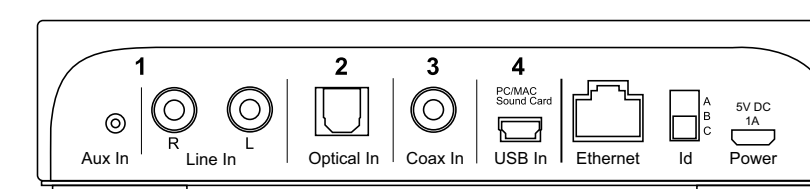

Hub

Extender

Link



All there is.

DYNAUDIO

Dynaudio A/S, 8660 Skanderborg, Denmark

Sales & Marketing: Dynaudio International GmbH, Ohepark 2, 21224 Rosengarten, Germany, Phone: +49 4108 - 41 80 - 0
www.dynaudio.com

© Dynaudio International GmbH, Xeo Brochure 1014, Item No. 466331. All text and image copyrights reserved. Subject to change without notice.