

USER MANUAL

MODEL: WST-916

LEARNING CODE WALL SWITCH TRANSMITTER WITH DELAY TIME

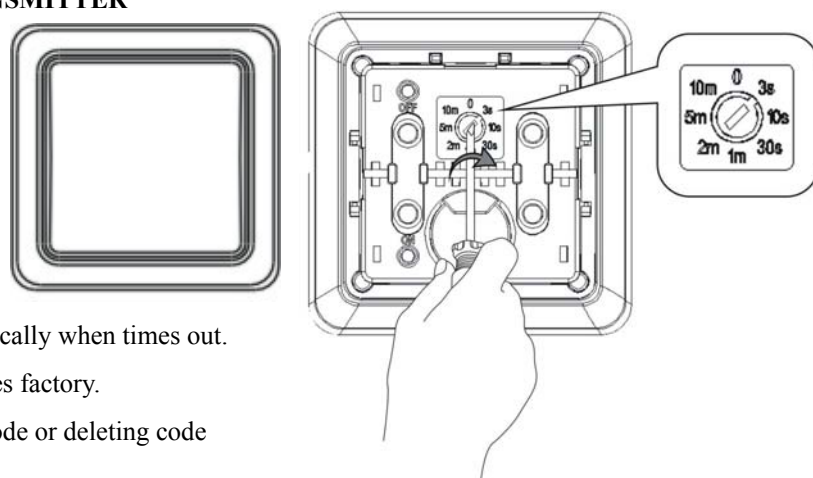

FEATURES:

- ON/OFF/DIMMER wall switch transmitter.
- Delay time switch design for switching light off automatically when times out.
- One of 67 million codes is fixed when each product leaves factory.
- Using ON or OFF sending code to receiver as learning code or deleting code function.
- Compatible to KAPPA learning code type receivers (eg. LYCR-3500/300,LCMR-1000/300, LWMR-210,)

INSTALLATION:

1. Screw Base to wall.
2. Fix Frame to Base.
3. Fix Rocker to Frame.

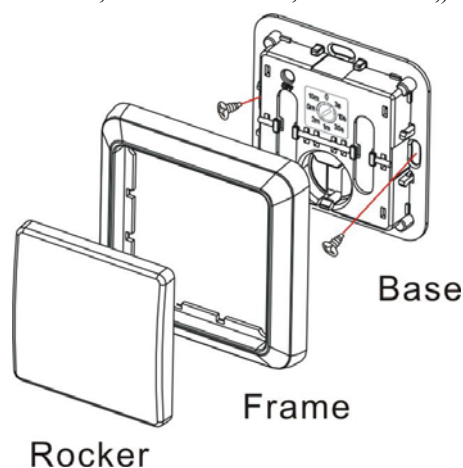

HOW TO SET CODE: learning function:

- * To start, program your transmitter with receiver.
- * Connect power to receiver.
- * Push the learning button on receiver once.
- * Receiver LED will blink slowly, press WST-916 “ON” button from Rocker.
- * Receiver connected lamp will blink twice, code is confirmed and LED stops blinking.
- * Repeat step for new setting of receiver.

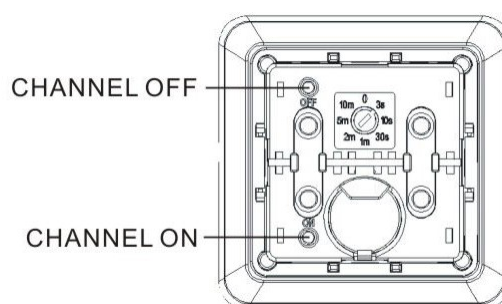

□ **Attention:** when coding WST-916 with CFR-2027 (also refer to CFR series manual for coding instruction), must adjust WST-916 in delay time switch “0” position. Only after coding is done, adjust WST-916 to required delay time for normal operation.

HOW TO CHANGE OR DELETE CODE :

DELETE INDIVIDUALLY-

- * Push the receiver learning button once, LED will blink slowly.
- * Press WST-916 “OFF” button from Rocker.
- * Receiver connected lamp will blink twice for confirmation.
- * Repeat step for new deletion of receiver.

ALL MEMORY DELETE -

- * Push the receiver learning button for 6 sec. till LED blinks continuously.
- * Release and push again once.
- * Receiver connected lamp will blink twice for confirmation.
- * All (max. 6) programmed memory will be deleted from receiver.

RECEIVER HAS 6 MEMORY (SCENE) SETTINGS:

- * Learning function RECEIVER has 6 memory scene settings.
- * It can be programmed as to your requirement with special effect. It can be programmed to switch ON at one time individually or programmed with different combinations switching.
- * This means one receiver can be programmed into max. 6 different combinations.

Example : if there are 3 receivers, [receiver 1 = stand light, receiver 2 = night light , receiver 3 = ceiling light]

Receiver 1, 2 can be controlled by WST-916, (stand light and night light ON/OFF at same time)

Receiver 1,2,3 can also be programmed and controlled by LYCT-505 (other transmitter) (stand light, night light and ceiling light ON/OFF at same time)

(Above settings Receiver 1, 2 each takes up 2 programmed memories out of 6 memories. Different combinations and settings can be teamed up and controlled from transmitter.)

APPLICATION:

Example 1:

- * Install WST-916 beside the bed.
- * When on the bed, it is easy to switch ON/OFF or DIM the night light or stand light.

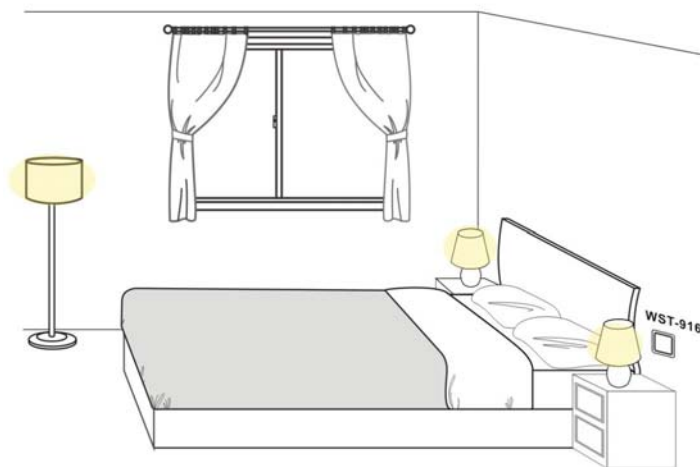

Example 2:

- * Install WST-916 beside the door.
- * When walking out or getting in the door, it is easy to switch ON/OFF or DIM the ceiling light or stand light.

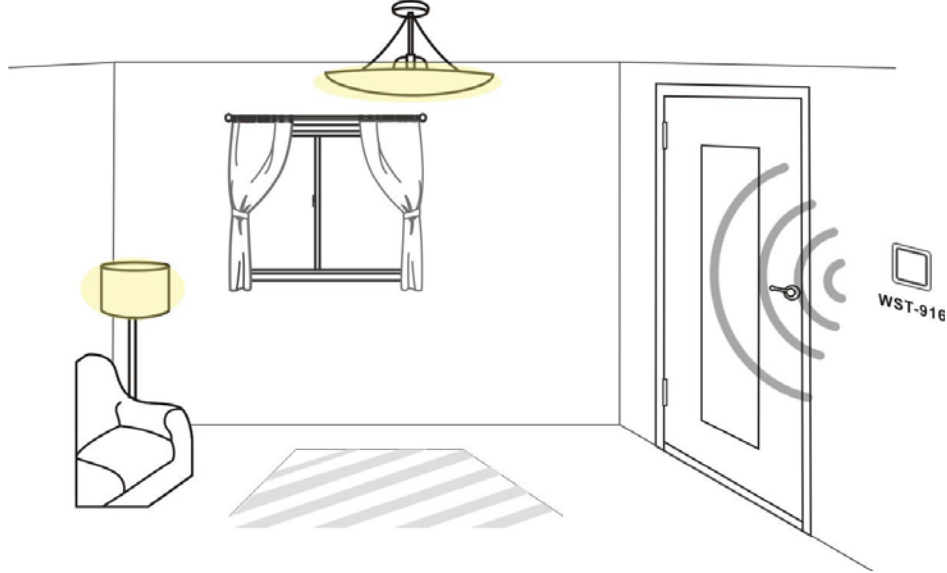

OPERATION:

When delay time switch in “0” (manual control)

ON/OFF function :

- * Press ON button (from rocker) for switching light ON.
- * Press OFF button (from rocker) for switching light OFF.

DIMMER function :

- * For dimmer control, press “ON” button (from rocker) twice (receiver light will start to run), press same “ON” button (from rocker) again and light will stop at the wanted brightness.
- * For immediate OFF, press “OFF” button (from rocker).

When delay time switch in time interval (3s/10s/30s/1m/2m/5m/10m)

- * select wanted delay time by using “□” type screwdriver to adjust code switch.
- * Press ON button (from rocker) to switch light ON and time is counted down from selected time to 0.
- * When times up, WST-916 automatically sends OFF signal to switch light OFF.
- * In the period of delay time counted down, pressing ON button will cause delay time counted from start selected time and lengthen again.
- * Press OFF button (from rocker) for immediate switch OFF light.
- * Dimmer is disabled when delay time is set.

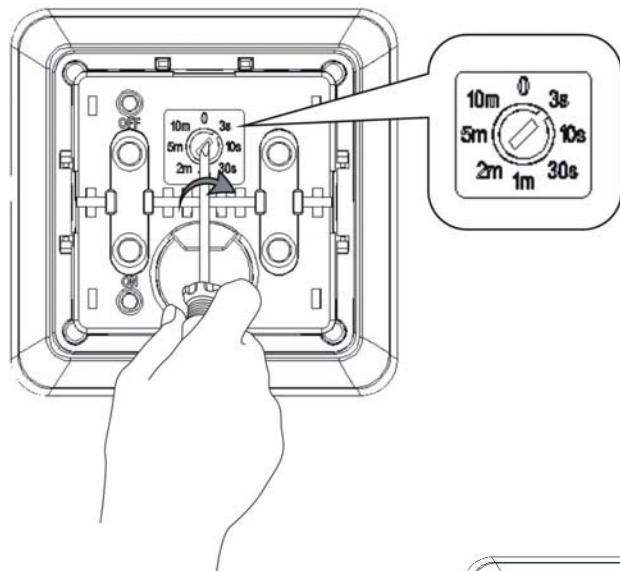

of

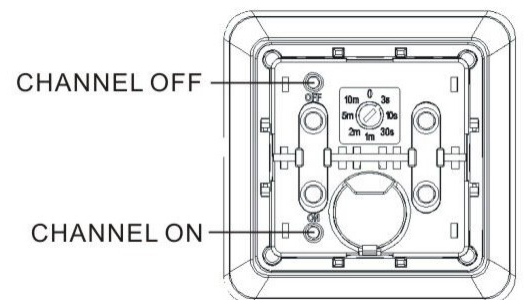

BATTERY CHANGING:

TAKE OUT BATTERY

1. Press the battery holder.
2. Battery drops out of the holder.

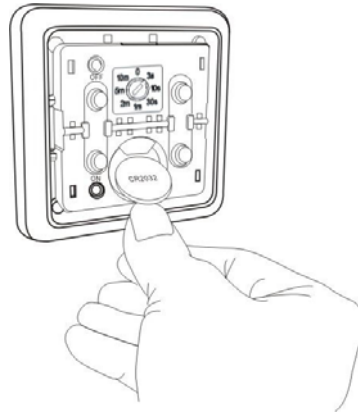
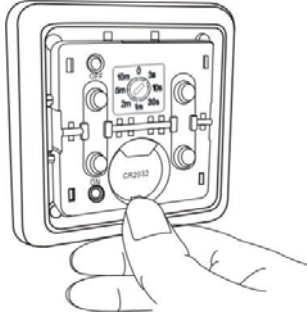

PUT IN NEW BATTERY

1. Replace new battery to battery holder.
2. Push battery stable in the battery holder.

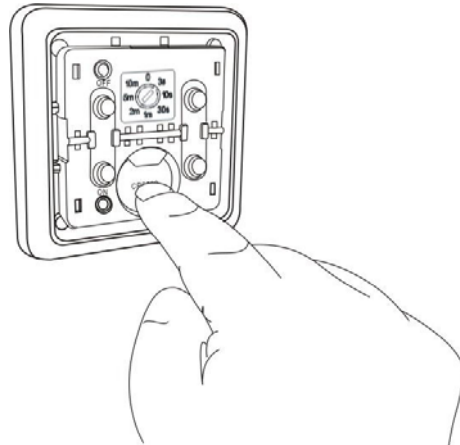
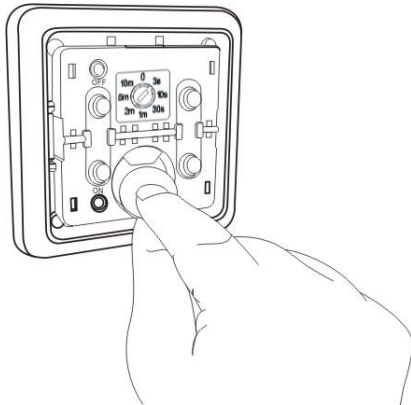

SPECIFICATION:

Frequency: 433.92 MHz

Battery: 3V CR2032 lithium cell battery operated (included)

Operating distance: 25 meters (in open field)