



CN2HK LIMITED

GSM Fixed Wireless Terminal (CK-8801)

User Manual



Please read this manual before operating this product.

After you finish reading this manual, store it in a safe place for future reference.

ENG



FCC STATEMENT



This equipment has been tested and found to comply with the limits for a Class B digital device, pursuant to part 15 of the FCC Rules. These limits are designed to provide reasonable protection against harmful interference in a residential installation. This equipment generates, uses and can radiate radio frequency energy and, if not installed and used in accordance with the instructions, may cause harmful interference to radio communications. However, there is no guarantee that interference will not occur in a particular installation. If this equipment does cause harmful interference to radio or television reception, which can be determined by turning the equipment off and on, the user is encouraged to try to correct the interference by one or more of the following measures:

- Reorient or relocate the receiving antenna.
- Increase the separation between the equipment and receiver.
- Connect the equipment into an outlet on a circuit different from that to which the receiver is connected.
- Consult the dealer or an experienced radio/ TV technician for help.

This device complies with part 15 of the FCC Rules. Operation is subject to the following two conditions:

- 1) This device may not cause harmful interference.
- 2) This device must accept any interference received, including interference that may cause undesired operation.

Any changes or modifications not expressly approved by the party responsible for compliance could void the user's authority to operate the equipment.

CE Mark Warning



This is a class B product. In a domestic environment, this product may cause radio interference, in which case the user may be required to take adequate measures.

Product Introduction

Congratulations on purchasing of our Fixed Wireless Terminal. Before using this terminal, please kindly read this user guide carefully.

This is our new design, which uses GSM networks to operate. You can dial the local calls, domestic and international calls with this Terminal connecting with a common wired desktop phone and a standard SIM card. It is widely used in these areas:

Remote country

Mountains

Dwelling house with weak signals

Public telephone shops

Offices

Removable places such as Ships, Trains, and Long distance buses

Our wireless Terminal also has these characteristics as below:

Easy to install

Easy to operation

Powerful capacity of signals receiving

Clear talking setting

Long using life

Steady performance

Key Technical Specifications

Following are the key technical specifications of this Terminal:

1. Networks support: **GSM900/1800MHz**

2. Frequency range:

GSM 900MHz(Transmits: **890-915MHz**, Receives: **935-960MHz**)

GSM 1800MHz (Transmits: **1710-1785MHz**, Receives: **1805-1880MHz**)

3. Voltage: DC 9V /DC12V

4. Stand by hours: 48 Hours

5. Talk time: 2-6 Hours

6. Charging time: 6 hours

7. Power consumption:

Static \leq 25MA emission \leq 500MA

8. Peak power consumption: 0.25W/0.5W

9. Receive sensitivity: -104db

10. Antenna increment: All directions: 5.0db Certain/Selection: 12db

Key functions

The key functions of the Terminal are list as below:

1. Multicolor backlight display (e.g.: blue, green)
2. Can dial the local calls, mobile calls, international calls and special free calls
3. Supports modem mode
4. No need to dial area code when calling local numbers
5. Automatically connects to IP network when dialing long distance(optional)
6. Automatic card-locking and network -locking enable
7. Caller ID display, time and date display, the power supply of battery can display at the same time on the LCD.
8. Cost rate setting enable

Cautions and Storage

Cautions

1. This terminal should not be used at garage, oil storage, and chemical plant or near to any inflammable or explosive substance.
2. This terminal should be avoided in the hospital. It will interfere with medical electronic equipments such as pacemaker and audiphones.
3. If it is found that the terminal is not successful in login onto network, please check whether the SIM card or antenna is well installed.
4. It is blocked to touch the antenna when the Terminal is being used. (Being making calls or receiving calls), otherwise the terminal will be damaged. This kind of damage is beyond the range of warranty.
5. When the terminal is being used, it should be placed where signal is strong enough. In order to ensure good voice quality, the terminal should be far from other electronic equipment.
6. Don't use chemic substance to clean the terminal, but use dry soft cloth to clean it.
7. Don't disassemble the terminal by yourself. If there is any problem, please contract the authorized personnel.

Storage:

1. The terminal that is packed or not could piled up no more than 10 layers.
2. The terminal should be saved in ventilate and dry place.
3. Don't knock the terminal to avoid breaking the case.

Connect the terminal

Connecting Your Service Provider

To use the networks services available in you terminal, you will need to sign up with wireless provider and purchase a SIM (Subscriber Identity Module) Card or purchase a prepaid SIM card. In many cases, the wireless provider will make available descriptions of its services and instructions for using its features. Wireless provider may differ in their support of features. Before you sign up, make sure a wireless provider support the features that you need.

Installing the Antenna

To choose a proper place for the antenna is the first and very important step for antenna installing. You can use your mobile phone to search for the place where the strongest signal is. Then put the antenna here.

Please do not make the antenna too close to the terminal. It will disturb the signal of the terminal.

Please do not make the antenna and the terminal too close to the TV set, computer, and radiogram. It will disturb the signal of the terminal.

Inserting a SIM Card

Make sure the terminal is switched off and the AC adapter is unplugged: insert the SIM card only when the terminal is switched off and the AC adapter is unplugged. Follow the instructions below to insert a SIM Card into the terminal.

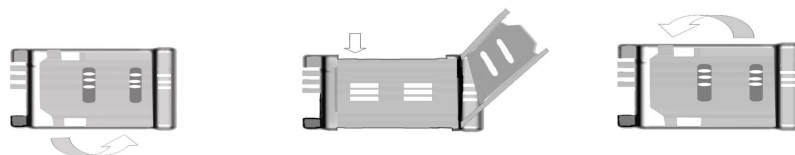

- 1). Screw off the screw of SIM card case, and open the cover.
- 2). Slide back the SIM card door and lift it up.
- 3). Slide the SIM card into the SIM door making sure that the clipped corner of the SIM card lines up with the clipped corner of the SIM holder.
- 4). Close the SIM card door and slide it to lock the SIM card in place.
- 5). Replace the cover of SIM card case and fixes it with a screw.

Connecting your terminal with desktop phone

If you want to use the terminal to make calls, you should connect the terminal with a common wired desktop phone.



A



B



C

There is one or two communication portals at the back of the terminal (**Picture A**). You can connect one desktop phone and billing machine (optional) with our terminal. It's very easy to connect the phone and terminal, just need a common communication cable (**Picture B and picture C**).

Operation and Setting

----PIN Lock

- *00#000# Restore to factory setting
- *00#010# Auto lock Sim Card (This function will be cancelled if restore to factory setting)
- *00#011# Lock Sim Card manually <initial pin code should be 1234>
- *00#012# Unlock Sim card manually <pin code restore to 1234, but Sim card pin keep open>

----Phone Lock (optional)

- *00#013# Lock phone function open and Lock phone
- *00#014# Unlock Phone function

After activate lock phone function, and re power on, the LCD will display " adusun-5110--01 L"
There will be a "L" added.

After activate lock phone function, if you put another sim card into the device, it will not permit to call out and "ERR--08" will be displayed on LCD.

----Call billing function setting

(Example for China mainland, other countries customer may adjust according to their real application).

- *00#016# Charge for first 3 minutes
- *00#017# No charge for first 3 minutes
- *00#018#ABCD# First 3 minutes fee rate: Outgoing call:0.ABRMB. Incoming call: 0.CD (RMB)
- *00#019# AB CD EFG HIJ KLM NOP# Fee rate setting

Local call	0.AB RMB /minute
DDD	0.CD RMB /minute
HK,MACAO,TAIWAN Call	E.FG RMB/ minute
US,Canada, Hawaii	H.IJ RMB/ minute

UK,France,Italy,Germany, Japan, Korea, NZ, AU	K.LM RMB/ minute
Singapore, Malaysia, Thailand, Indonesia, Philliphnes	

Other countries IDD	N.OP RMB /minute
---------------------	------------------

=====

*00#050#	Permit incoming call(default)
*00#051#	Prohibit incoming call
*00#052#	Number segment close (default)
*00#053#	Number segment open
*00#054#	LCD display Prefix IP number close (default).
*00#055#	LCD display Prefix IP number open

----Change Charge time.

*00#056#	change charge time
*00#056#00# 60s	this represents 60s as 1 charging minute
*00#056#01# 58s	this represents 58s as 1 charging minute
*00#056#02# 55s	this represents 55s as 1 charging minute
*00#056#03# 50s	this represents 50s as 1 charging minute

=====

*00#057#	Change Display Time format : *00#057#HHMMSS#
	HH-Hour, MM-Minute, SS-Second

*00#059#00000# "0" permit Outgoing call, "1" prohibit outgoing call, eg *00#059#11111#
 Sequence: 1st "0" or "1" -Local mobile number, 2nd-Local pstn number, 3rd-Long distance mobile number, 4th- Long distance pstn number, 5th- International number

*00#061# AAAAAA#	Set 1 st IP number eg. *00#061#17951#	IP number from 3 -13 digit.
*00#062# AAAAAA#	Set 2 nd IP number , eg.:*00#062#17911#	
*00#063# AAAAAA#	Set 3 rd IP number	eg.:*00#063#193899#
*00#064# AAAAAA#	Set 4 th , IP number	eg:*00#064#19314#
*00#065# AAAAAA#	Set 5 th IP number	eg:*00#065#19314#

*00#070# ABCDE# "ABCDE": "0"-don't add IP number, "1~5"-adding related IP number as above setting.

- A- local mobile phone number
- B- Local pstn number
- C- Long distance mobile phone number
- D- Long distance pstn number
- E- International phone number

eg: all don't add prefix IP number *00#070#00000#

eg: all add 1'st setting prefix IP number *00#070#11111#

eg: A and B don't add IP number, C,D,E add 2'nd Prefix IP number *00#070#00222#

- *00#080# Clear Ban dial prefix, direct dialing and free number 10 groups respectively.
- *00#081# Ban dial prefix 10 groups Close (default)
- *00#082# Ban dial prefix 10 groups Open
- *00#083# Call Long distance mobile phone number prefix IP plus 0, eg. 17951+0+13880088008
- *00#084# Call Long distance mobile phone number prefix IP w/o 0 , eg.17951 +13880088008
- *00#085# Communication over and return to standby status (default).
- *00#086# Communication over, Must press Re-dial key to return to standby status
- *00#089# Cancel Auto lock SIM card ,change to Lock sim card Manually(default)

```
=====
display"err---3" // No SIM Card or can not find Sim card.
display"err---4" // Pin Code is wrong.
display"ERR--08" // The device is locked, can not work. Need to un
```

Packing List

With the Fixed Wireless Terminal, there are some accessories. When you get the terminal please check them and to see whether you have all of them. Please contact us or call the distributor in your area to hand back the absent parts if you find that you lack one of them as below:

Name	Quantity	Remark
AC- adapter	1pcs	DC12V/1A
Special antenna	1pcs	
User Manual	1pcs	English

Attentions

In order to protect your Terminal and make sure the terminal have a long using life, you should pay attentions as below:

1. You'd better place the terminal in a safe place where the kids cannot be fetch, or the terminal will hit the kids.
2. Please keep the terminal and the accessories dry and do not place the terminal in a dirty place, or it will affect the use of the terminal.
3. Please use the terminal in a normal temperature. It will damage the using lift of the terminal if the temperature is too high or too low.
4. Make sure that there is no water immerge the terminal, or it will short-circuit and leads the perpetual damage of the terminal
5. Do not swab the terminal with the corrosive materials.
6. Do not open the terminal optionally. Please ask professional repairer for help if your terminal was damaged.
7. Please use the special battery and adapter. Do not use the common battery and adapter instead of the special battery and adapter.
8. Please charge the terminal if the terminal turns off automatically when you use the battery to work..