

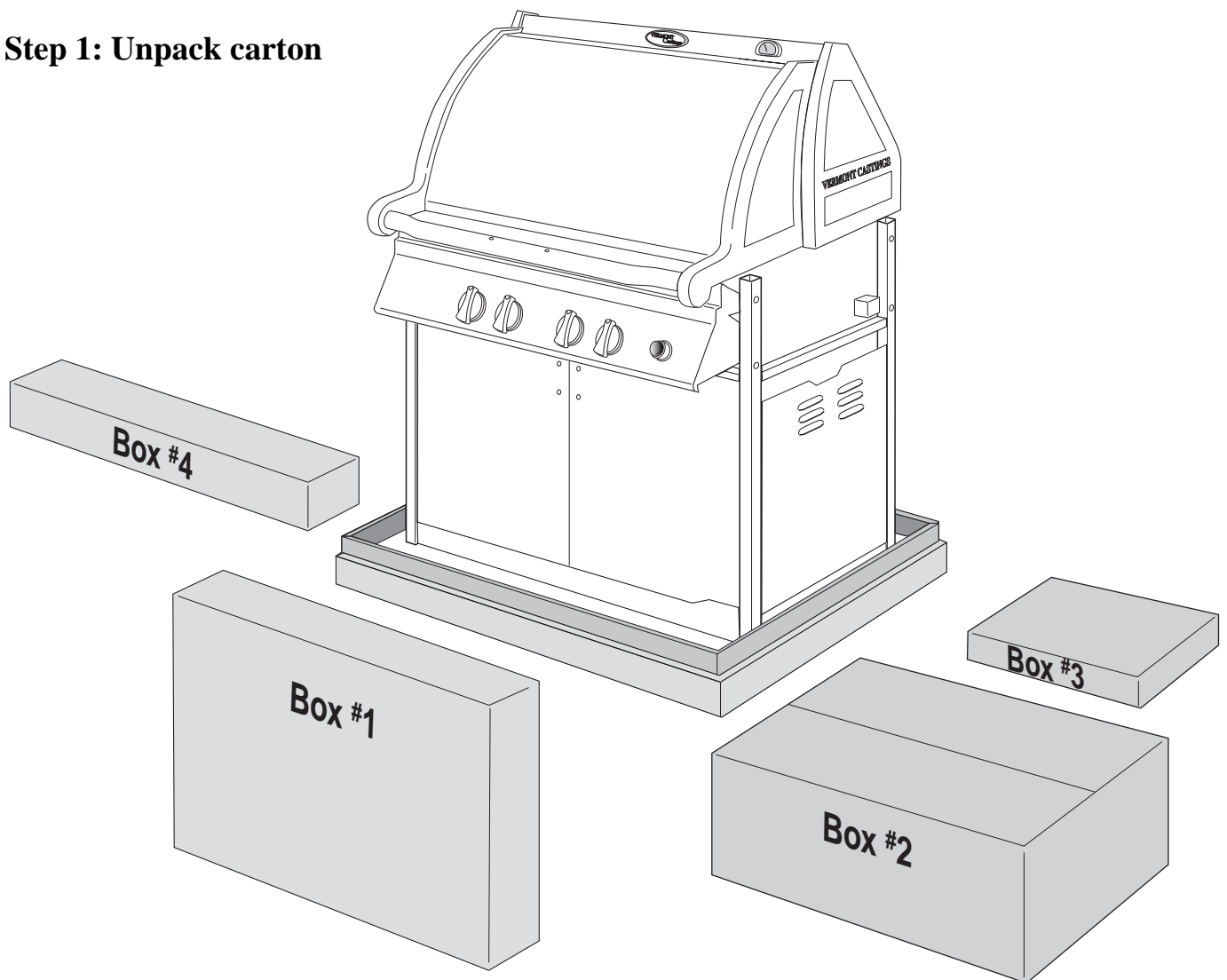

VC200C ASSEMBLY PROCEDURES

Tools Required: Knife or Scissors, Hammer, 7/16" (11 mm) wrench/ratchet or an adjustable wrench, Philips or Robertson screwdriver.

Step 1: Unpack carton



Use the knife or scissors to cut the strapping on the package then lift off the cardboard cap. Remove the cardboard sleeve lifting it straight over top of the barbecue. Check the 4 enclosed parts kits, against the parts list (Appendix A) to ensure that no parts are missing.

Step 2: Prop up left hand side of the barbecue

In order to attach casters and wheels to the barbecue, each side of the unit must alternately be propped up to provide access to the bottom of the legs. A block of wood or other solid item about 4-6 inches high will suffice for this purpose.

The same process can be used with the right legs for attachment of the unit's wheels.

NOTE: BEFORE BEGINNING ANY ASSEMBLY, REMOVE THE BARBECUE'S BASE PANELS (See Fig. 1) TO PERVENT THEM FROM BEING DAMAGED.

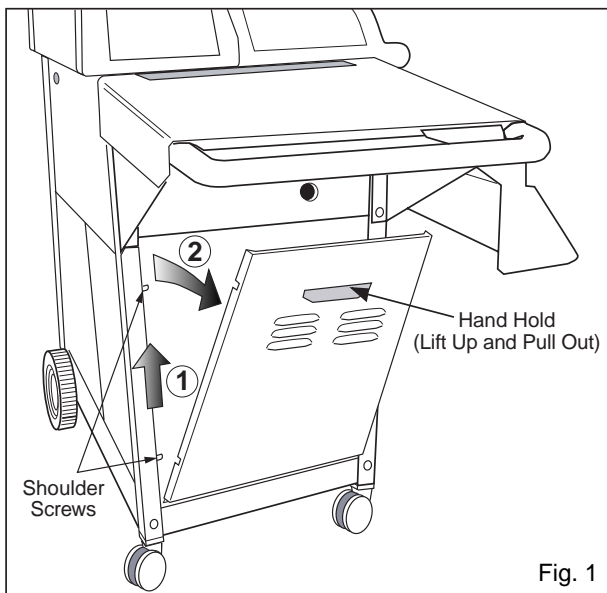
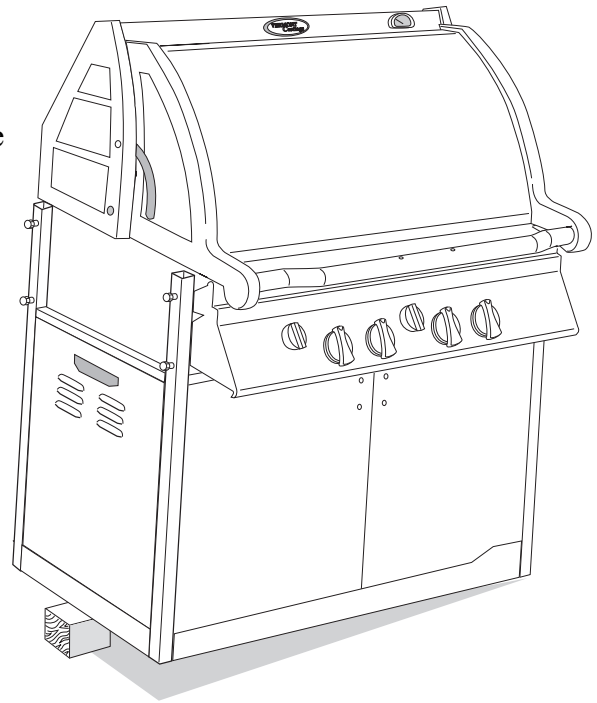

Step 3: Install Casters

Materials Required:

Two casters and two caster inserts.

Place a caster insert in the bottom of the rear left leg and tap it into place with a hammer. Tap the other caster insert into the front left leg. Snap the casters into the inserts.

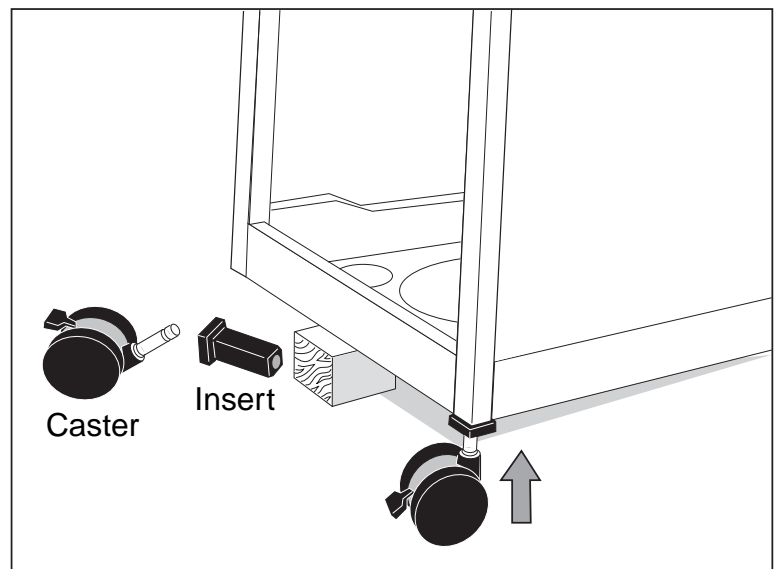

Step 4: Attach Wheels Materials Required: axle; two axle caps and two wheels.

Prop up the right hand side of the barbecue using the method described in Step 2.

Tap a cap onto one end of the axle. Push a wheel onto the axle flush against the cap, the cone shaped side of the wheel facing inward. Insert the axle through the holes at the bottom of the right hand legs. Finally slide the other wheel into place on the axle, again with the cone shaped side facing inward, and tap the other axle cap onto the axle.

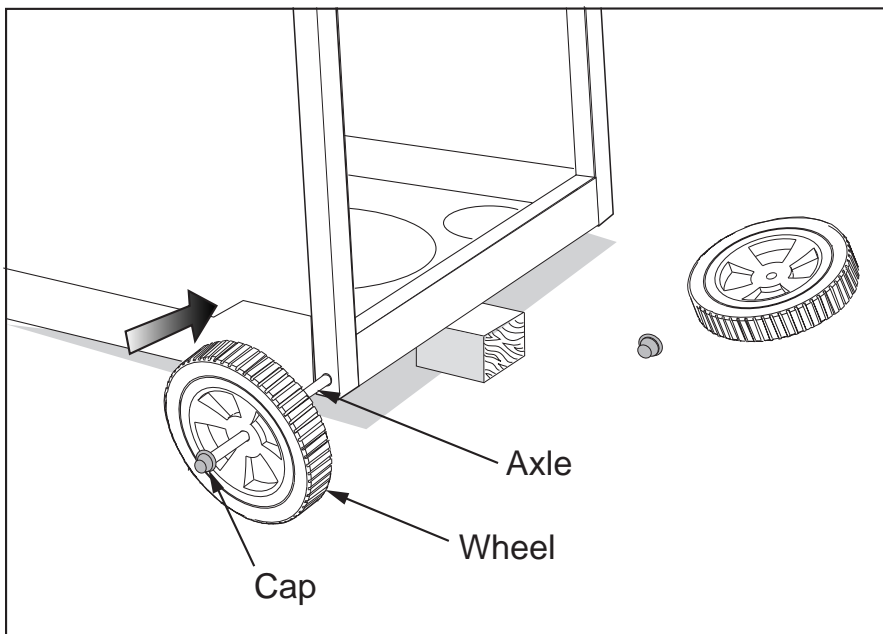
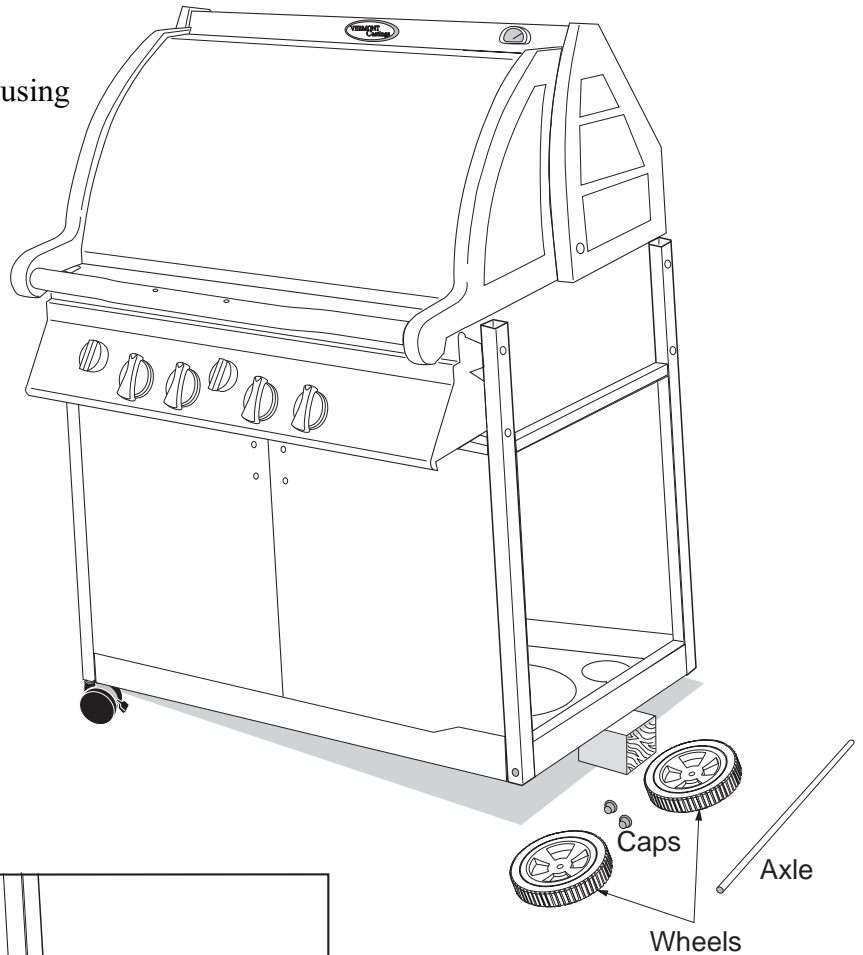

NOTE: PLACE THE UNIT ON LEVEL GROUND. LOCK THE CASTERS BEFORE PROCEEDING TO STEP 5 AND BEGINNING FURTHER ASSEMBLY.

Step 5: Attach Shelf Supports Materials Required: Left and Right shelf supports and eight shim washers.

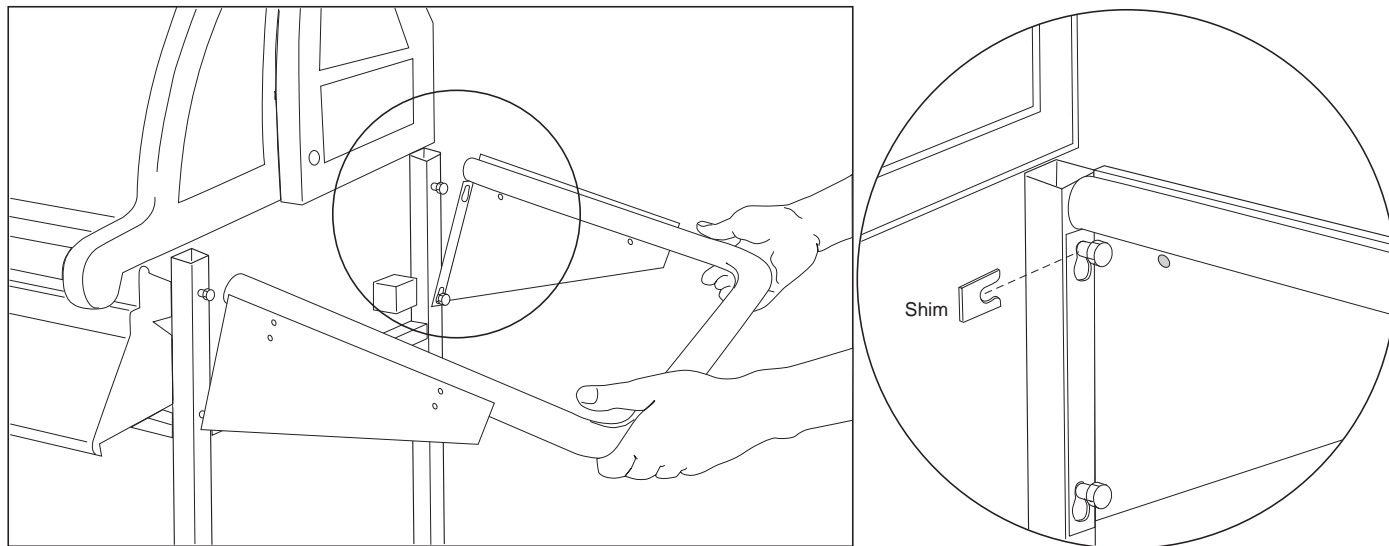

Attach the right shelf support to the barbecue by loosening the 4 existing leg bolts, approximately 3 turns only, so that the shelf support can slide over the bolt heads. Insert a shim washer sideways behind the head of one of the bolts and in front of the shelf support. Tighten the bolt using the 7/16" (11 mm) wrench/ratchet or adjustable wrench. Repeat inserting shim washers behind the heads of the remaining 3 bolts.

Attach the left shelf support in the same manner.

Step 6: Install Handle Grips

Materials Required: Three handle grip sets (six pieces total) and six #4 x 3/4" Philips screws.

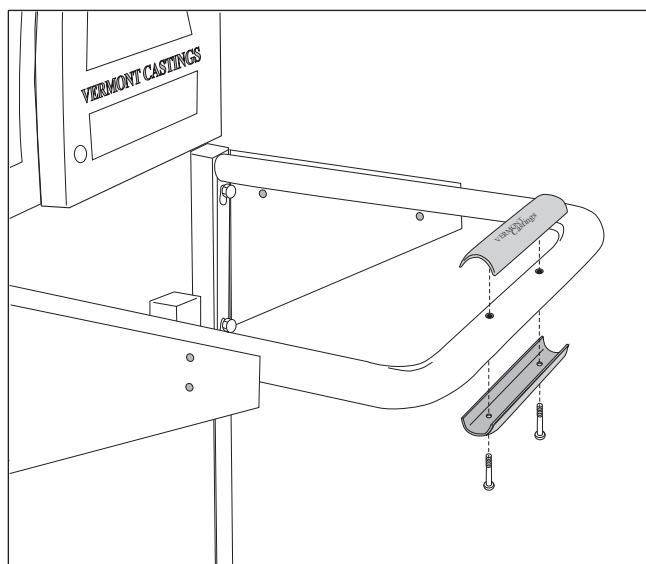

Place the top half of one handle grip, the half bearing the Vermont Castings logo, onto the right shelf support handle. Use the holes provided as a guide. Snap the two halves of the handle grip together and secure them using two Philips screws and a Philips screwdriver.

Repeat this procedure for the left shelf support handle grip.

Finally, attach the last handle grip to the front lid handle.

Step 7: Attach Front Condiment Shelves

Materials Required: Four #10-24 x 1/2" bolts; four #10-24 x 1/4" nylon bolts; four # 10-24 nylon nuts; four #10-24 lock nuts; 2 front shelves; the right shelf end; the left shelf end.

7a - Loosely attach the side of the right front shelf End Cap to a Front Shelf with (2) 1/2" bolts & nuts. Attach the bottom flange of the End Cap to the Front Shelf with a nylon nut & 1/4" bolt. Note: Flange should be below Front Shelf.

Tighten all fasteners.

7b - position the right front shelf (condiment bin) to the shelf support by tilting the bin upwards while passing the extended arm of the bin side under the support. Hook the back edge over the arm support, then swing the bin down into position. Next secure the condiment bin to the front control panel by aligning the center hole on the inside bottom side of the shelf with the provided on the right side flange of the control panel. Screw the pieces together using a nylon nut & 1/4" bolt.

Repeat to attach the left condiment bin.

Do not tighten the fasteners yet.

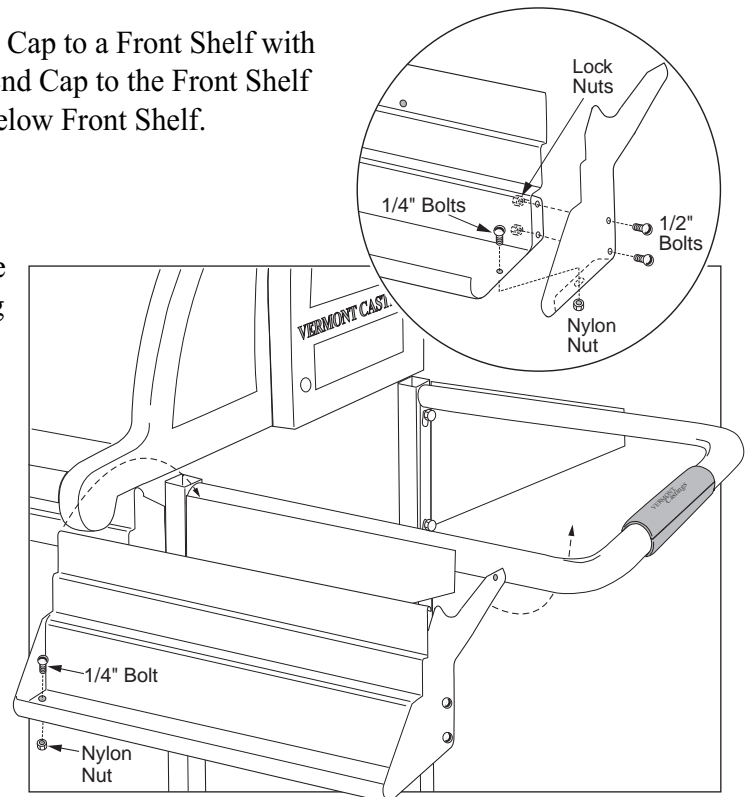

Step 8: Attach Side Shelves

Materials Required: Nine #10-24 x 1/2" round head bolts; eight plastic washers, nine #10-24 lock nuts; and the left and right side shelves, and the Tool Holder.

NOTE: See separate rotisserie instructions to assemble rotisserie bracket to left side shelf.

- ① Secure the left side shelf to the side of the base using a bolt and nut. Assembly loosely.
- ② Secure the left side shelf to the left front shelf with one bolt, washer and nut. NOTE: The Tool Holder may be assembled at this time to the left or right end. The top of the Tool Holder fits under the edge of the shelf.
- ③ Finally, fit the left side shelf onto the left shelf support and secure it to the unit at the rear using two bolts, two washers and two lock nuts.

Tighten all connections on the condiment bin, side shelf, and Tool Holder.

Repeat for the right side shelf, place side shelf plate into center of shelf.

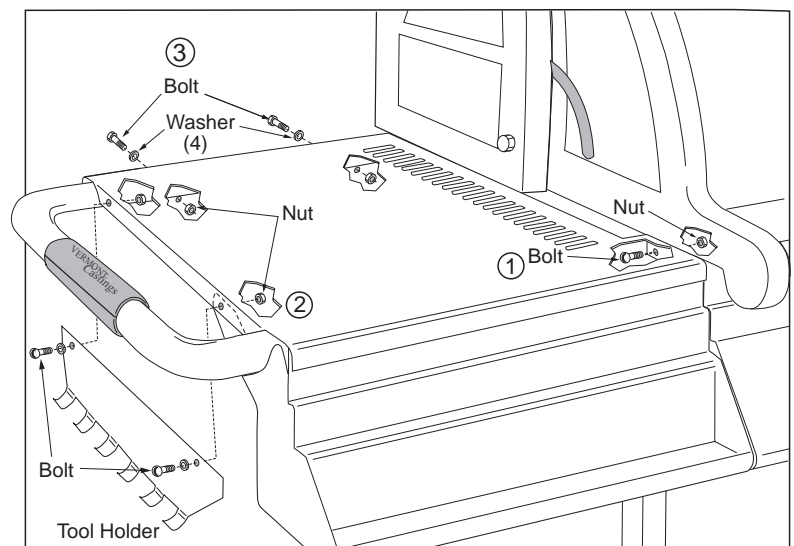

Step 9: Attach the Handles to the Cabinet Doors

Materials Required:

Two door handles with four screws.

Attach a door handle to the left cabinet door by aligning the ends of the handle with the two holes provided on the top right side of the door. Secure the handle using the screws provided and a Philips screwdriver.

Repeat for the right hand door handle.

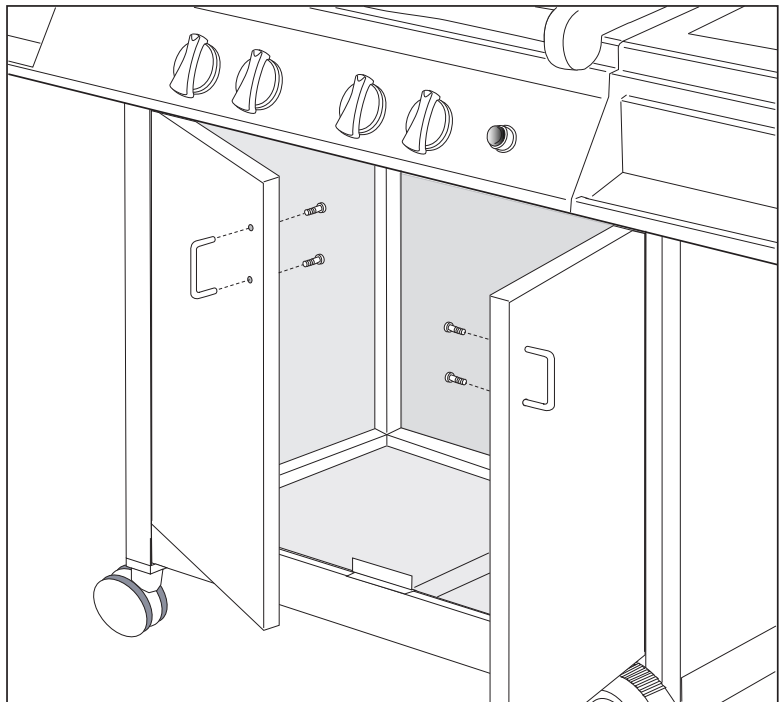

Step 10: Insert the Bottom Panels

Materials Required: Two bottom panels. Four #8-18 self-tapping screws for Propane Model Only.

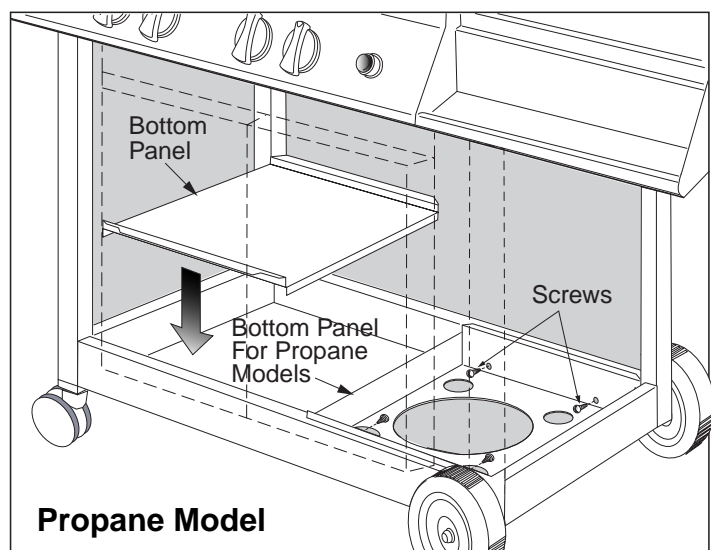
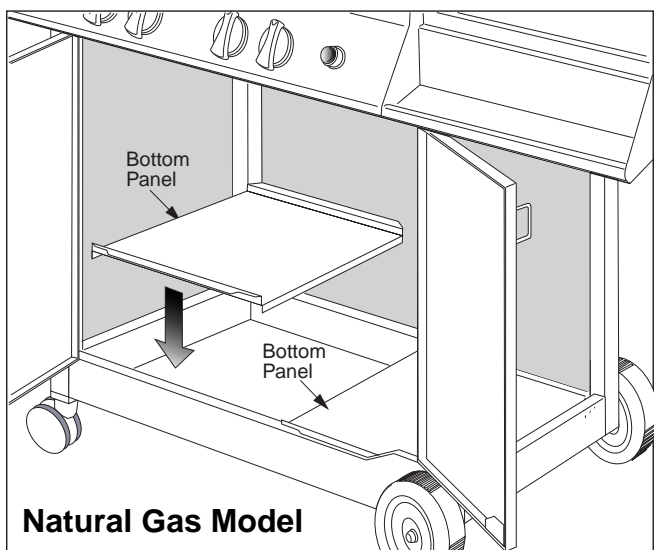

Insert the bottom panels of the cabinet by placing the lips of the panels on the front and rear leg brace. For Propane Models, the panel with the holes is to be placed on the right and secured with four self-tapping screws.

Step 11: Set up the Grease Pan and Grease Cup Holder

Materials Required: Grease pan; grease cup, grease cup holder assembly.

Beneath the cooking unit a guide track has been provided so that the grease pan can easily slide in and out. This guide track can be accessed from the left side of the barbecue. Slide the grease pan halfway out to install the grease cup assembly. Insert a disposable aluminum pan into the grease cup holder then hook it onto the slots provided on the end of the grease pan. Push the grease pan back into place.

(Note: the grease cup should be hanging below the square hole provided in the grease pan).

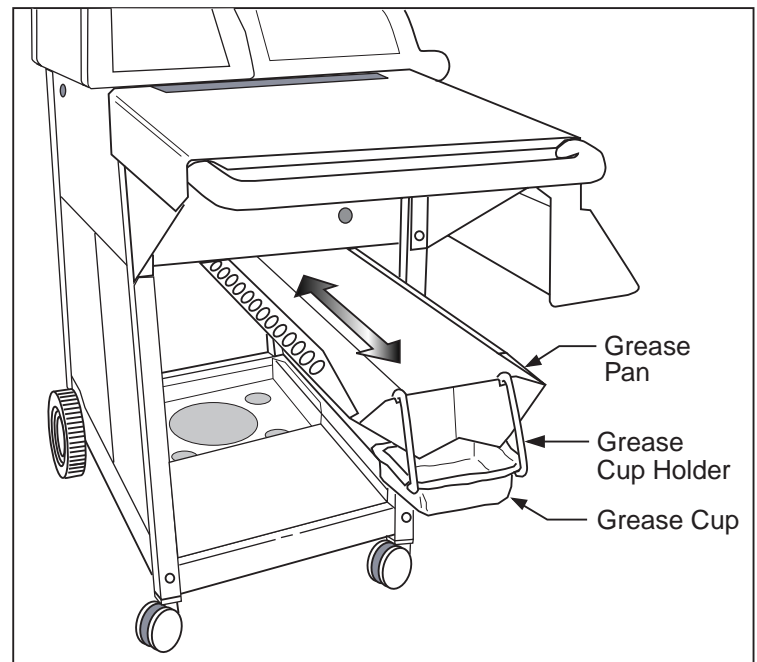

Step 12: Attach the Back Panels of the Cabinet

Materials Required: #8-18 self-tapping screws (4 total); 2 back panels.

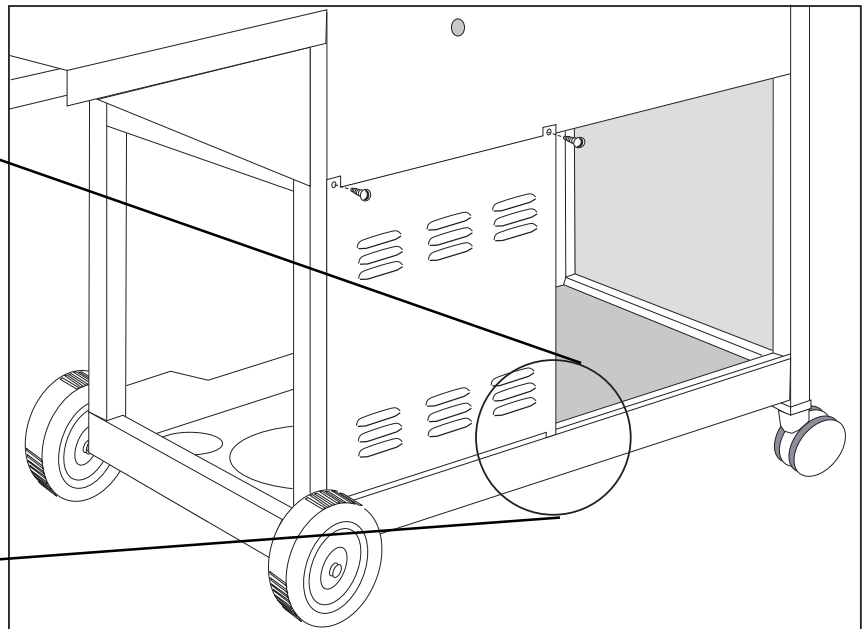
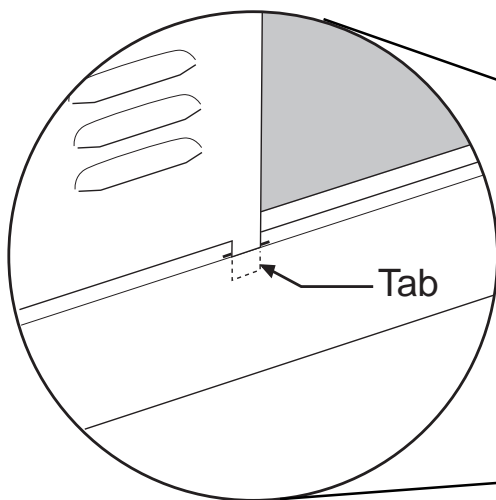

Place a back panel with the louvers facing down and to the rear on top of the rear leg brace. Ensure that the tab, the small flange on the bottom of the back panel, is inserted into the slits provided on the top edge of the rear leg brace. Secure the top of the panel using two self-tapping screws in the holes provided at the top right and left hand corner of the panel.

Repeat for the remaining back panel.

Step 13: Install Sear Plates, Cooking Grates, Warming Rack, and Smoker Boxes

Materials Required: Two sear plates; smoker box with lid; three cooking grates, and the warming rack.

Place the sear plates into the barbecue ensuring that their edges are facing downward. The sear plate with the large square cutout will house the smoker box. The plate with the smoker box hole should be placed so that it is closer to the rear of the unit on the left side of the Grill. If the plates have arrows stamped on them, position the plates so the arrows point to each other. Place the lid on the smoker box.

Position the 3 cooking grates in the base unit with the finger holes to the front. These may be turned over to provide an angled flat surface for delicate foods.

Slip the rear lip of the warming rack into the two supports extruding above the rotisserie burning housing. Let it rest in a level position.

To use the rotisserie smoker box. Remove the warming rack, and sit the box and lid on top of the rotisserie housing.

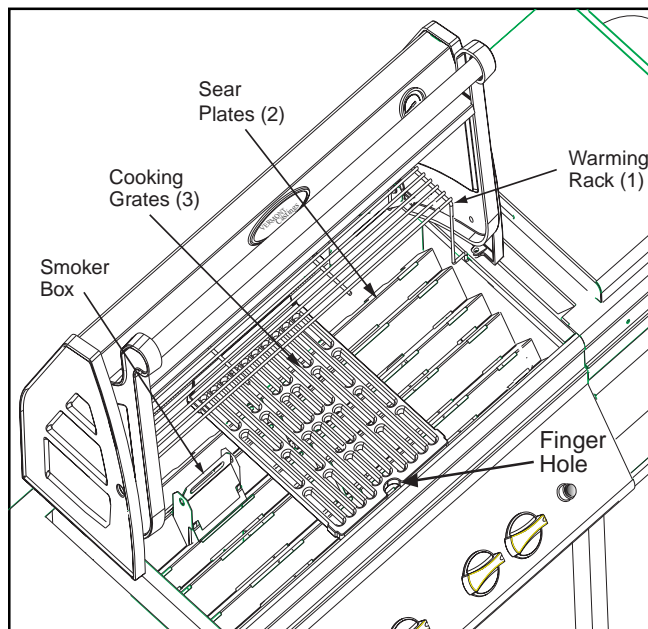

Step 14: Insert the Gas Tank

Materials Required: Cylinder. (Not supplied with barbecue)

NOTE: Refer to the Users Manual for the propane cylinder specifications and for cylinderfilling requirements, before lighting the Grill.

Insert the propane cylinder into the hole provided in the bottom right bottom panel. **Ensure the valve is facing forward.** Connect the cylinder to the main regulator.

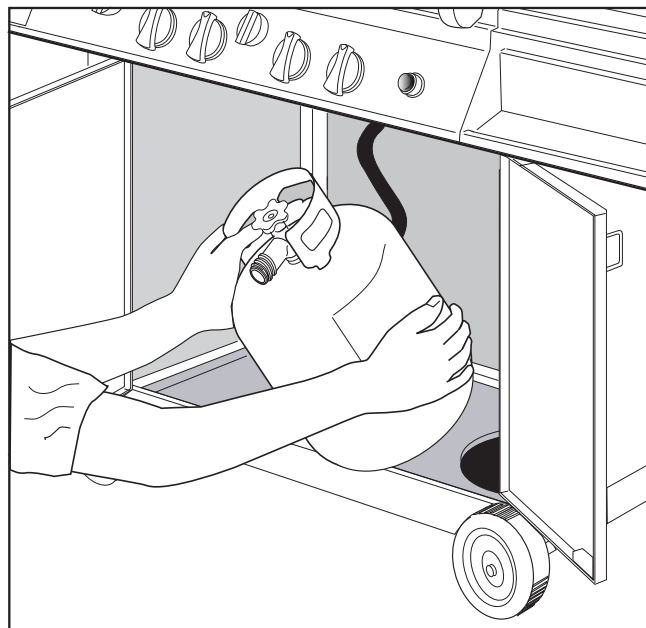

Step 15: Reinstall the Base Panels of the Cabinet

Materials Required: 2 base panels

Take the smaller base panel with the louvers facing down and out and attach it to the right side of the cabinet by sliding the holes on the side of the panel onto the shoulder screws protruding from the legs. Push the panel down to secure it in position.

Repeat for the left base panel.

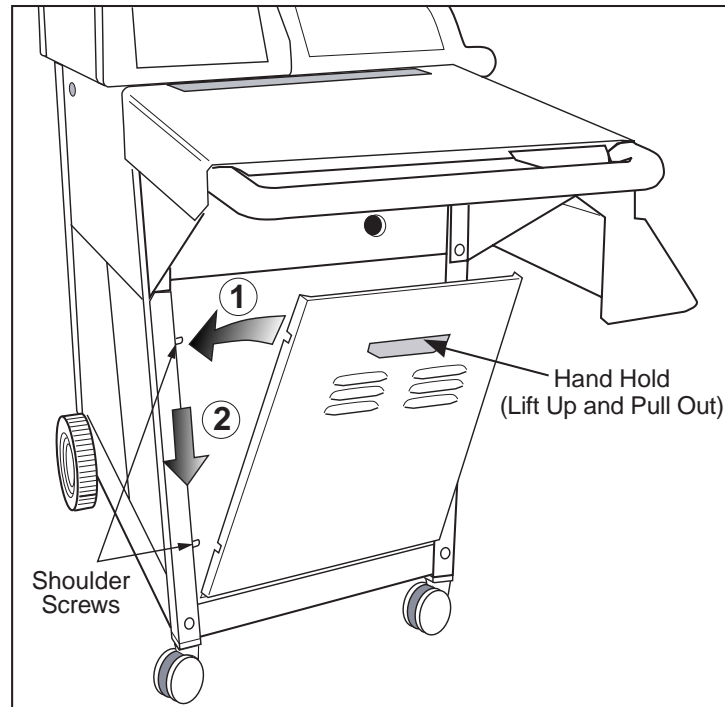

Step 16: Install Ignitor Battery

Materials Required: 'AA' Battery

Unscrew the ignitor button knob, remove the spring, and place the AA battery **positive end down** into the holder. Replace the spring over the battery and tighten the cap. The ignitor should make an audible snap every second when the button is pushed.

Follow the leak test procedure and operation guide in the user's manual.

VC200C ASSEMBLY DRAWING

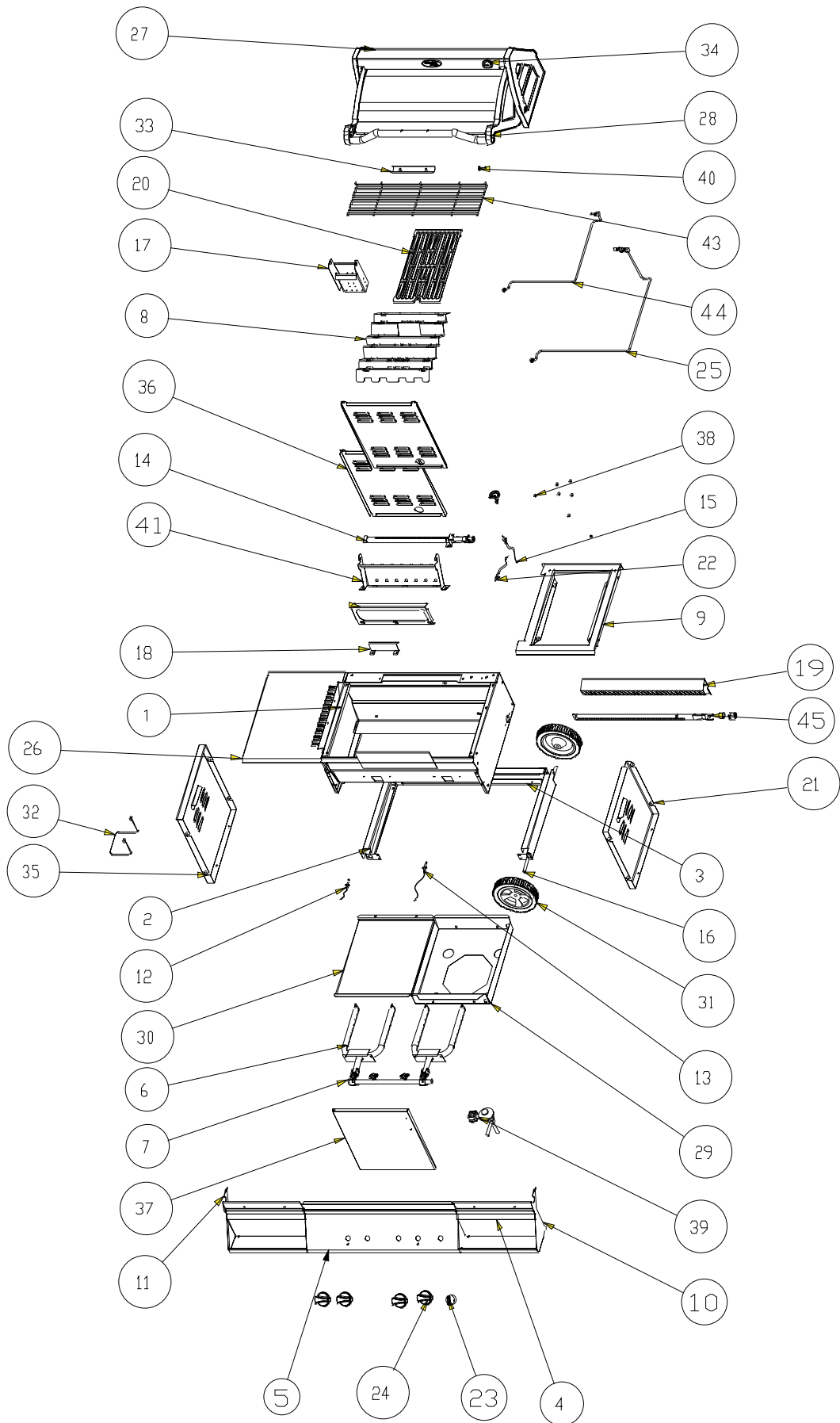

VC200C PARTS LIST

Item	Qty	Part #	Description
1	1	50000899	Base Assembly
2	2	50000236	Brace Leg End
3	1	50000237	Brace Leg Rear
4	2	50000738	Shelf Front
5	1	50000429	Console 200 B
6	2	50000038	Burner Main
7a	1	50000919	Valve/Manifold Assy - NG
7b	1	50000470	Valve Manifold Assy - LP
8	1	50000356	Plate Heat Set
9	1	50000099	Shelf Side Right
10	1	50000441	End Cap Shelf R
11	1	50000442	End Cap Shelf L
12	1	50000431	Electrode Main Short
13	1	50000523	Electrode Main Long
14	1	50000047	Burner Rotiss Assy
15	1	50000466	Electrode Rotiss
16	1	50000093	Axle
17	1	50000357	Box Assy - Smoke
18	1	50000043	Flash Tube
19	1	50000430	Deflector Oven
20	1	VCCG1A	Cook Grates
21a	1	50000130	Panel Base R Charcoal
21b	1	50000283	Panel Base R Green
22	1	50000439	Electrode Oven
23	1	50000438	Igniter Kit
24	4	50000076	Knob Control
25a	1	50000456	Tube & Orifice Assy Rotiss - NG
25b	1	50000455	Tube & Orifice Assy Rotiss LP
26	1	50000097	Shelf Side Left
27a	1	50000414	Lid Assy Rear Black
27b	1	50000446	Lid Assy Rear Green
28a	1	50000419	Lid Assy Front Black
28b	1	50000449	Lid Assy Front Green
29	1(0)*	50000096	Panel Bottom LP
30	1(2)*	50000095	Panel Bottom Plain
31	1	50000360	Wheel (2)
32	1	50000361	Grease Cup Holder / cups(2)
33	1	50000642	Grip Handle Set (3)
34	1	50000967	Gauge Temp
35a	1	50000129	Panel Base L Charcoal
35b	1	50000282	Panel Base L Green
36	2	50000369	Panel Rear Lower – Black – set
37a	1	50000363	Door Front Charcoal Set
37b	1	50000366	Door Front Green Set
38	6	50000365	Lid Bumpers Set
39	1	50000248	Regulator/O.D. Assy
40	1	50000355	Pivot Pin & Bolt Set (2)
41	1	50000746	Rotisserie Housing / Screen Assy
43	1	50000261	Warming Rack
44a	1	50000454	Tube and Orifice Assy Oven - NG
44b	1	50000453	Tube & Orifice Assy Oven - LP
45	1	50000433	Burner Oven Assy
-	1	50000747	Rotisserie Housing / Screen Assy
-	1	50000399	Support - Rotisserie Spit Rod
-	1	50000286	Rotisserie Spit Rod
-	1	50000287	Rotisserie Work Kit
-	1	50000541	Rotisserie Motor Bracket
-	1	50000151	Rotisserie Bracket Guide
-	1	50000504	Tool Holder

* Natural Models

APPENDIX A

The contents of the VC200C parts kits included in the appliance pack should be as follows:
(For reference only, see parts list for replacement parts)

Box 1:

Left Side Shelf (1)
Right Side Shelf (1)
Side Shelf Plate (1)

Box 2:

Warming Rack
Shelf Support Assembly (2)
Front Shelf (2)
Front Shelf End-R (1)
Bottom Panel – Tank (1) *
Bottom Panel – Plain (1) * or (2)**
Sear Plate – Right Hand (1)
Sear Plate – Left Hand (1)
Axle
Front Shelf End-L (1)
Tool Holder
Smoker Box-Rotisserie Body
Smoker Box-Rotisserie Lid
Rear Panel Lower - Set (2)
* Propane Models Only
** Natural Gas Models Only

Parts Bag: (Box 2)

Smoker Box (1)
Smoker Box Lid (1)
Wheels (2)
Casters (2)
Caster Inserts (2)
Aluminum Grease Cups (2)
Grease Cup Holder (1)
Handle Grip Top (3)
Handle Grip Bottom (3)
Hardware kit
Door Handle and mounting screws (2)

Box 3:

Cooking Grates (3)

Box 4:

Rotisserie Motor
Rotisserie Spit Rod
Rotisserie Fork Kit
Rotisserie Support-Right
Rotisserie Motor Bracket
Rotisserie Bracket Guide

Hardware Bag: (Part # 50000452)

(Parts not available separately)

(2) Axle Caps

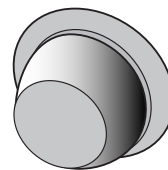

(14) #10-24 x 1/2" Bolt

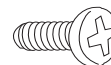

(8) #8-18
Self Tapping Screw



(14) #10-24 Lock Nut



(4) #10-24 Nylon Nut



(4) #10-24 x 1/4"
Nylon Bolt



(6) #4 x 3/4 Screws



(8) #10 Nylon Washer



(8) Shim Washer

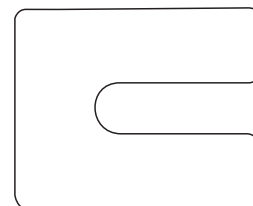

The Vermont Castings
Majestic Products Company

410 Admiral Blvd. • Mississauga, Ontario, Canada L5T 2N6 • 905-670-7777
www.vermontcastings.com