

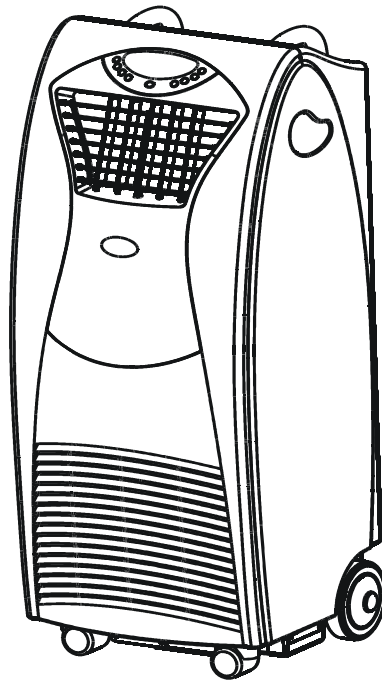

**15000BTU MOBILE AIR CONDITIONER
INSTRUCTION MANUAL
Model KY-44B**



IMPORTANT

Please read these instructions carefully before use.

Contents

Description	Page
Important Safety Instruction	3-4
BS Plug Wiring	5
Technical Specification	6
Energy Saving Advice	7
Product Description	8
Control Panel	9
Remote Control Functions	10
Use of Control Panel	11 -13
Remote Control Operation	14
Air Exhaust Duct Installation	15 -17
Maintenance	18 – 19
Trouble Shooting	20
Packing List	21
Electrical Circuit Diagram	22
Services Warranty	23

THE MANUFACTURER DISCLAIMS ANY RESPONSIBILITY, IF THE ABOVE INSTRUCTIONS ARE NOT FOLLOWED.

Please note:

For those who are not aware of the danger that might occur from the usage of an electrical appliance, they should use the product under guidance and supervision.

Important Safety Instructions

Read and save these important safety instructions before using this unit. When using electrical appliances, basic safety precautions should always be followed including the following:

1. Transport & store the unit in an upright position only. Leave it in an upright position for at least 3 hours before first use.
2. Always place the unit on an even, level surface.
3. An opening in a window or wall is required to accommodate the exhaust hose to expel the hot air.
4. Make sure the unit is connected to an earthed power supply of the correct rating. (Refer to the rating label located at the back of the unit).
5. The unit will cool when the room temperature is between 18°C~32°C depending on the thermostat setting.
6. Operate this unit in an ambient temperature of 32°C or lower.
7. DO NOT use this unit for functions other than those described in this instruction manual.
8. DO NOT tilt the unit.
9. DO NOT cover or obstruct the appliance's inlet and outlet grilles.
10. Your air conditioner has been designed to be used only in the home, office and similar conditions and should not be used for any other purpose.
11. Never unplug the air conditioner while it is working, this could damage the electronic circuits.
12. DO NOT use the appliance in a wet room, such as a bathroom or laundry room to avoid the risk of electrical shocks.
13. Do not bend or crush the warm air exhaust hose.
14. DO NOT sit or place articles on the appliance.
15. DO NOT use the appliance with wet or damp hands.
16. DO NOT let chemical substances come into contact with the appliance.
17. DO NOT use the appliance in the presence of flammable substances or vapours such as alcohol, insecticides, petrol, etc.
18. DO NOT use the plug to start and stop the appliance. ALWAYS use the control panel to start and stop the unit.
19. ALWAYS keep an air path of at least 50cm from walls, furniture or curtains.
20. ALWAYS turn off the appliance when it is not in use and remove the mains plug from the socket outlet.

21. ALWAYS turn the unit off and remove the mains plug before cleaning, carrying out maintenance or moving location.
22. Avoid the use of adapter plugs, multiple sockets and /or extension leads. If their use is necessary, ensure they conform to current safety standards.
23. Do not pull the electrical cable or place it near a source of heat: always unroll it completely to avoid dangerous overheating. If the supply cord becomes damaged, the service agent or a similarly qualified person must replace it, in order to avoid a hazard.
24. The filter must be used with the product at all times, when removing it for clearing always turn the unit off and unplug the mains plug from the socket.
25. Do not operate the fan with a damaged power cord or plug, after it malfunctions, has been dropped or damaged. If the power cord is damaged it must be replaced by the manufacturer or a qualified service engineer to avoid a hazard.

For those who are not aware of the danger that might occur from the usage of an electrical appliance, they should use the product under guidance and supervision.

**THE MANUFACTURER DISCLAIMS ANY RESPONSIBILITY, IF
THE ABOVE INSTRUCTIONS ARE NOT FOLLOWED.**

BS Plug Wiring

Wiring Instructions: Should it be necessary to change the plug please note the wires in the mains lead are coloured in accordance with the following code:

BLUE - NEUTRAL
BROWN - LIVE
GREEN AND YELLOW - EARTH

As the colours of the wires in the mains lead of this appliance may not correspond with the coloured markings identifying the terminals in your plug, proceed as follows:

1. The **BLUE** wire is the **NEUTRAL** and must be connected to the terminal which is marked with the letter **N** or coloured **BLACK**.
2. The **BROWN** wire is the **LIVE** and must be connected to the terminal which is marked with the letter **L** or coloured **RED**.
3. The **GREEN/YELLOW** is the **EARTH** and must be connected to the terminal which is marked with the letter **E** or \oplus or coloured **GREEN OR GREEN/YELLOW**.
4. Always ensure that the cord grip is positioned and fastened correctly.

If a **13A (BS 1363)** fused plug is used it must be fitted with a **13A** fuse. If in doubt consult a qualified electrician.

Wiring for a 13 Amp Plug (BS1363)

Please note. The Earth Terminal is marked with the letter **E** or Earth Symbol \oplus .

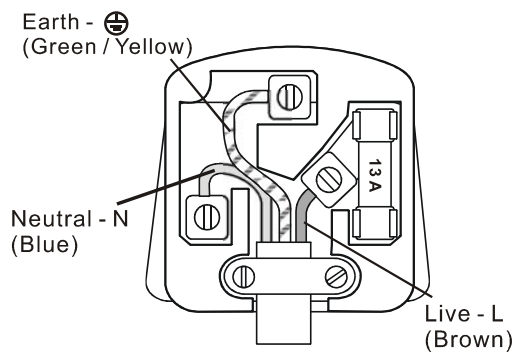

Technical Specification

Model		KY-44B
Cooling capacity		15000Btu/hour
Dehumidifying capacity		3.5 litres / hour
Nominal power		1600 watts
Input power (Max)		1800 watts
Air flow		550 m ³ /h
Power source		220-240V ~ 50Hz
Sound pressure level		≤54 dB (A)
Net weight		50 kg
Dimensions	Unit	100 x 43 x 40 (cm)
	Packaged	117.5 x 50 x 46 (cm)
Refrigerant		R407c / 0.87 kg

NOTE:

1. The above cooling capacity is measured at ambient temperature 30°C, Relative Humidity 70%.
2. Noise level is measured at a point one-meter away from the front of the machine in cooling mode.
3. Fan power consumption is measured when the fan runs at high speed.
4. Specifications listed above are for reference only. Please see actual data printed on the nameplate located on the appliance.

Please note: Due to continuous research and development the specifications are subject to change without notice.



Energy Saving Advice

- 1. Do not locate the air conditioner where furniture or other objects can obstruct the airflow.**
- 2. Keep blinds/curtains closed during the warmest part of the day.**
- 3. Close the fireplace damper, floor and/or wall grilles, so cool air does not escape through the chimney or ductwork.**
- 4. Keep the filters clean.**
- 5. Avoid opening doors frequently.**
- 6. Each person present in a room provides between 100 & 150Watts of heat, consequently, the more people there are in the room, the less effective the unit will be in cooling.**
- 7. Set the unit to maximum cooling and high-speed ventilation for the initial start up and then adjust the unit to a comfortable setting.**

Product Description

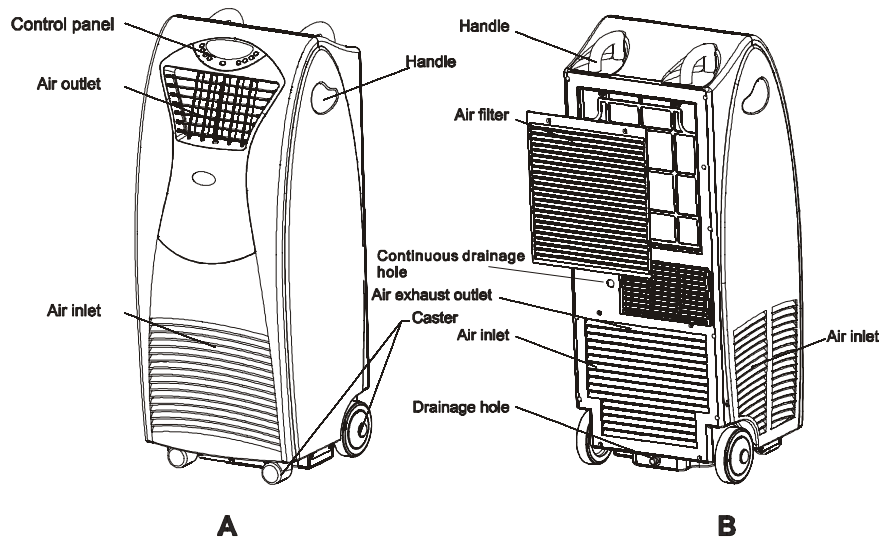

1. Exhaust air duct
2. Exhaust air duct inlet connector
3. Mid-connector
4. Exhaust air duct outlet connector
5. Remote controller
6. Fish tail exhaust outlet connector

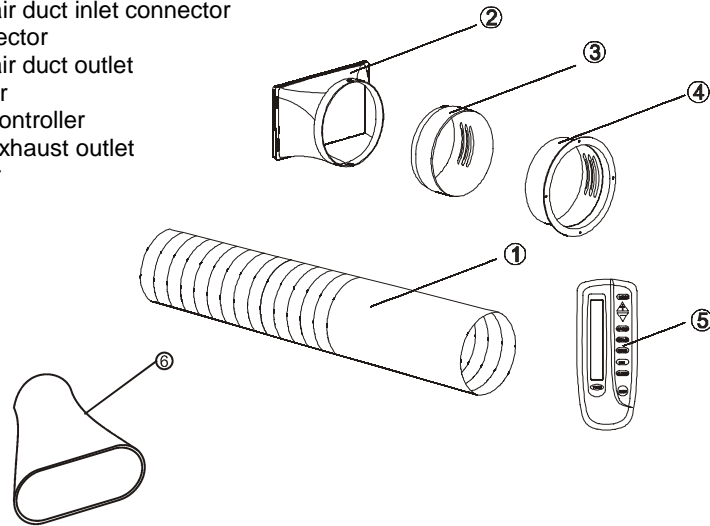

Control Panel

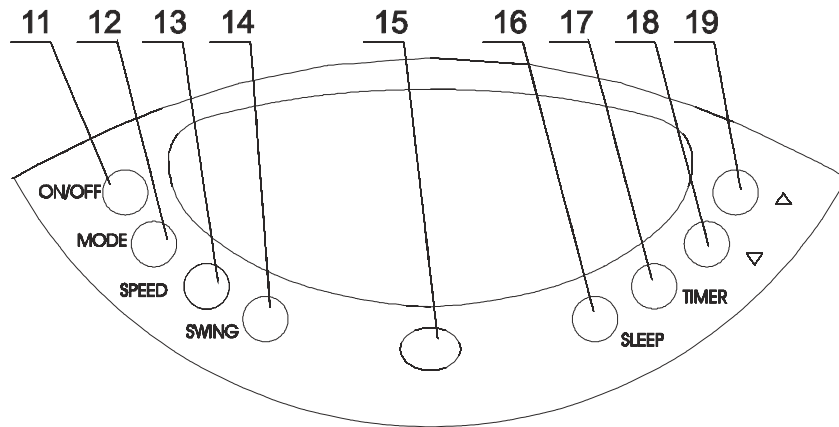
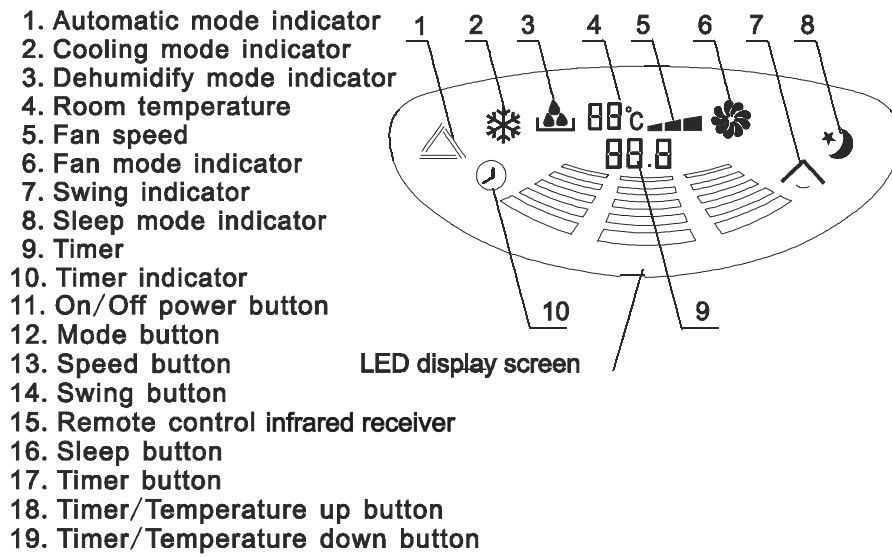

Remote Control Functions

1. Automatic mode indicator
2. Cooling mode
3. Dehumidify mode indicator
4. Fan mode indicator
5. Room temperature
6. High speed indicator
7. Medium speed indicator
8. Low speed indicator
9. Swing running indicator
10. Swing stop indicator
11. Clock display
12. Sleep mode indicator
13. Automatic on indicator
14. Automatic off indicator
15. Timer
16. Mode button
17. Timer/Temperature up
18. Timer/Temperature down
19. Speed button
20. Swing button
21. Clock hour button
22. Clock minute button
23. Sleep button
24. Timer button
25. On/Off power button

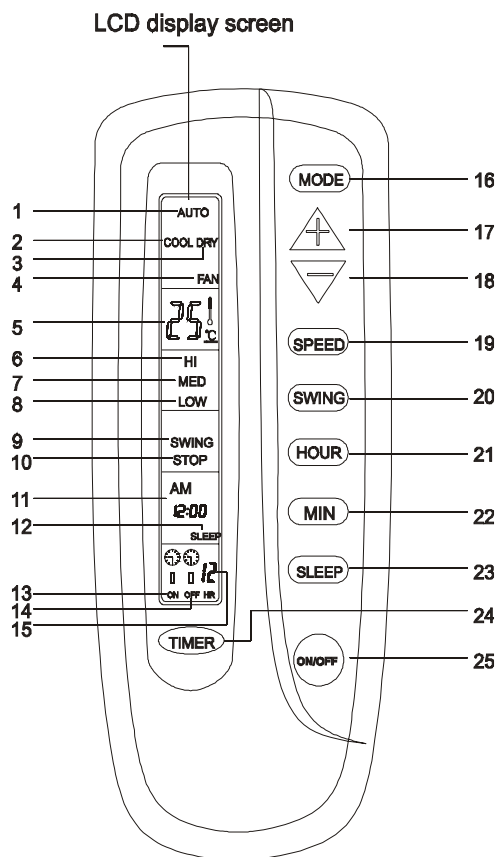

Use of Control Panel

Do not operate in cooling or dehumidifying mode when room temperature exceeds DB35°C, RH70%

- **Automatic, Dehumidify, Cooling, Fan mode operation**

1. **Turning the unit on**

- a) Plug in the power cord. The unit beeps twice.
- b) Press the “**On/Off**” button to turn on the unit. The LED displays the room temperature and operates in **Automatic** mode.

2. **Selecting operating mode**

Press the “**Mode**” button to select the desired mode as show below:

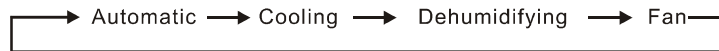

3. **Adjusting temperature**

The adjustable temperature range is 15-31°C. Press Δ (up) or ∇ (down) button to increase or decrease by 1°C. The unit LED shows the target temperature for 5 seconds and then display the room temperature.

4. **Adjusting the fan speed**

Press the “**Speed**” button to select the desired fan speed as shown below

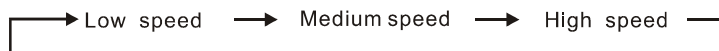

5. **Turn the unit off**

Press “**On/Off**” button, the unit will emit “di” sound and stop working.

Use of Control Panel (continued)

6. Modes operation

◆ Automatic Mode

1. Once the Automatic mode is selected, the indoor temperature sensor operates to select the desired mode.
2. When the room temperature $\geq 24^{\circ}\text{C}$, the unit automatically selects cooling mode and the upper fan turns to low speed automatically.
3. When the room temperature $\leq 23^{\circ}\text{C}$, the unit automatically selects fan mode and the upper fan turns to low speed automatically.

◆ Dehumidifying Mode

1. The upper fan will run at low speed, the speed is not adjustable.
2. The compressor and lower fan runs 8 minutes **ON** than 6 minutes **OFF** automatically.
3. The unit has constant temperature dehumidifying mode, adjustment of temperature is not possible.

◆ Cooling Mode

1. When the room temperature is higher than set temperature. The compressor starts to run.
2. When the room temperature is lower than set temperature, the compressor stops and upper fan operates at original set speed.

◆ Fan Mode

1. The upper fan runs at set speed, the compressor and lower fan motor stop.
2. The temperature is not adjustable.

Use of Control Panel (continued)

7. Timer operation

1. Press "**Timer**" button to set **Automatic Off** time while the unit is running.
2. Press "**Timer**" button to set **Automatic On** time while the unit is standby.
3. The adjustable time range is 1-12 hours by hour.

8. Swing operation

1. Press "**Swing**" button to change airflow direction. The unit default setting is straight airflow.
2. Press "**Swing**" button once, the airflow direction will change to swing at 120° right-left.

9. Sleep operation

1. Sleep operation works in **Cooling** mode.
2. Press "**Sleep**" button, the unit runs in Sleep mode, the upper fan turns to low speed automatically. The set temperature increases by 1°C per hour for up to 8 hours.
3. The unit turns off after 8 hours running in Sleep mode.

Remote Control Operation

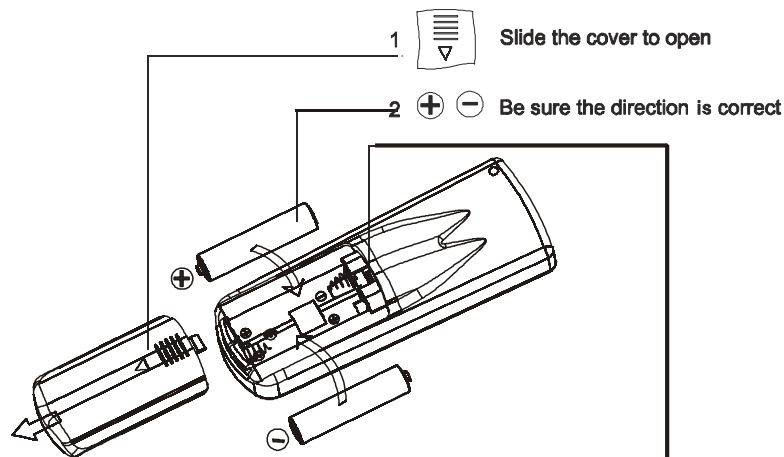

●Setting the clock

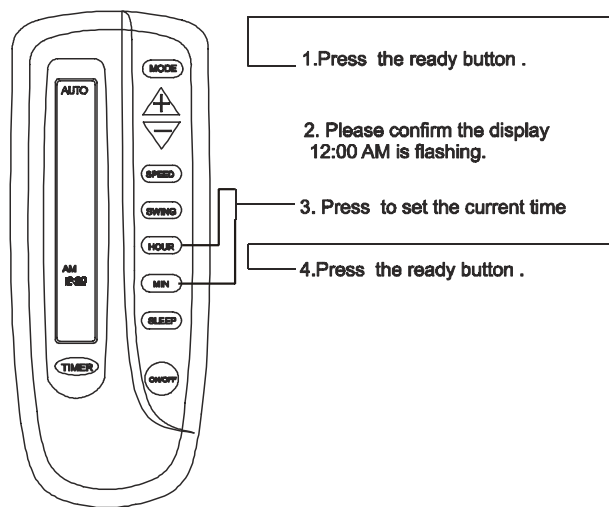

How to install or change batteries (batteries not include)

1. The polarity of batteries must match the indicator in the remote control.
2. Don't mix new and old batteries.
3. If the remote control will not be used for a long period, take batteries out to avoid corrosion.
4. The batteries must be removed from the remote control before it is scrapped and dispose of them responsibly.

Air Exhaust Dust Installation

How to connect the connectors to the exhaust air duct:

1. Extend the exhaust air duct by drawing out the two ends of the duct.

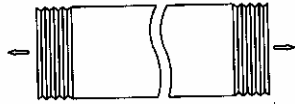

2. Screw the exhaust air duct into the mid-connector.

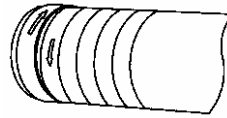

3. Screw the exhaust air duct into the outlet connector.

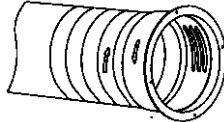

4. Screw the mid connector into the inlet connector.

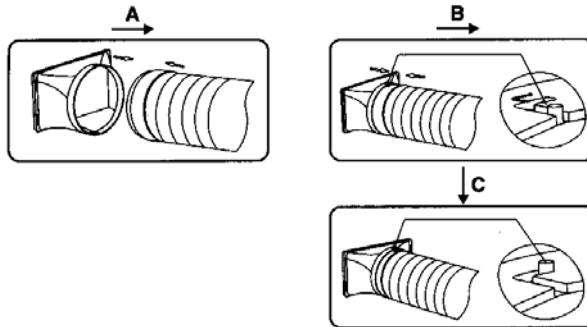

5. Connect the inlet connector onto the unit.

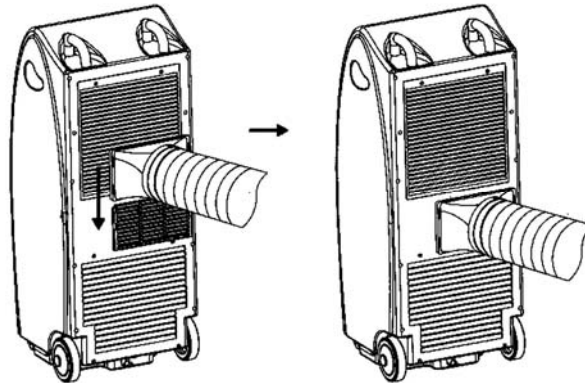

Air Exhaust Dust Installation (continuous)

Suggestion methods to exhaust hot air:

- Exhaust hot air from window

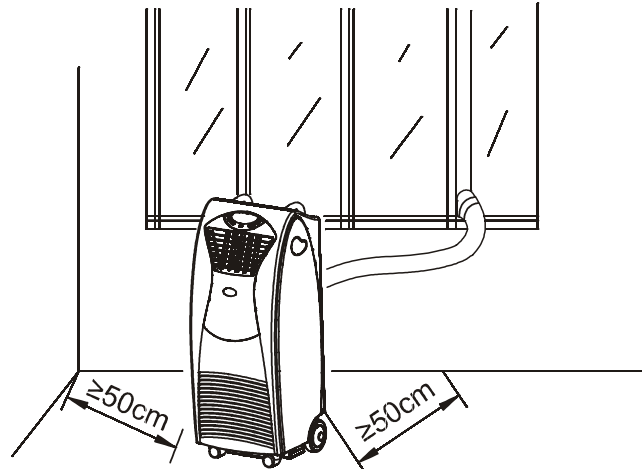

Open window a little and place plastic pipe outside.

- Exhaust hot air from door

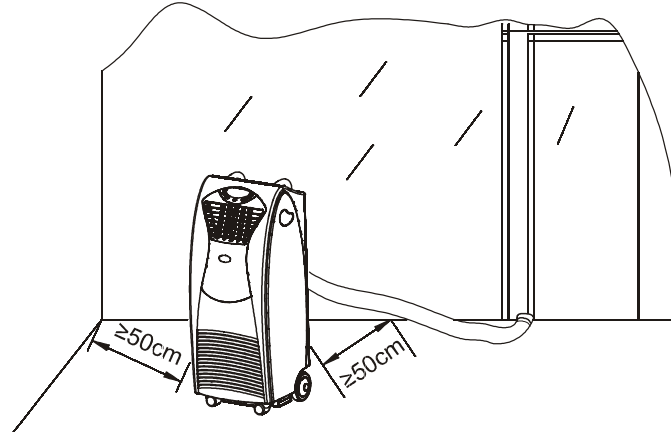

Open door to an appropriate angle to fit plastic pipe to outside.

Air Exhaust Dust Installation

Note

1. Air exhaust duct can be extend from 0.55 to 1.8 meters, the unit works more efficiently if the duct is shorter.

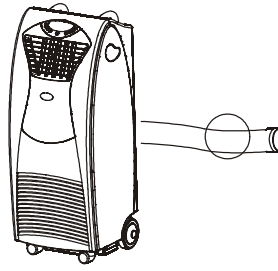

2. Make sure the air exhaust duct is not distorted.

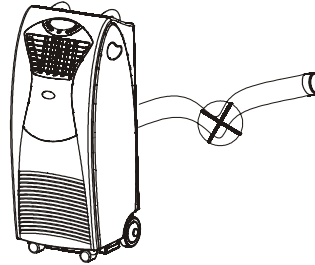
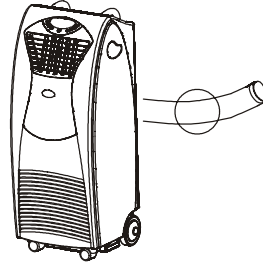

3. Use only the duct supplied

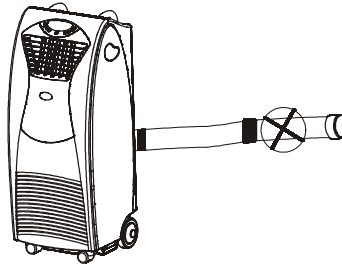

Maintenance

Before carrying out ANY maintenance works ensure the appliance is switched off and the three-pin plug is removed from the power socket.

Filter maintenance

Take out air filter cover from back air inflow vent.

Clean, wash the air filter by immersing it gently into warm water with a neutral detergent, rinse the filter of detergent and dry it thoroughly in a shaded place.

Allow the filter to dry naturally before returning to the air filter cover.

How to draining excess condenser water

When unit running at cooling mode, the unit automatically dehumidifies the air in the room. The water from dehumidification is stored in a collecting water tray and then immediately “evaporated” and evacuated via the warm air outlet duct. However, when it is extremely humid, the collecting tank may fill up. In this case the alarm Buzzer will sound 20 times while water tray gets full, error code “E4” will display in LED panel and cooling system stops automatically, and fan will stop in 3 minutes automatically as well.

To re-set the unit and drain the condensed water, please follow the instructions below.

A. Water Tank Drainage

1. Horizontally place water tray under drainage hole.
2. Disconnect the rubber plug from drainage pipe, condensed water will flow out.
3. When the water tray gets full, push rubber plug back to drainage hole, and empty water tray.
4. Repeat 1,2,3 until all condensed water in the unit is drained.

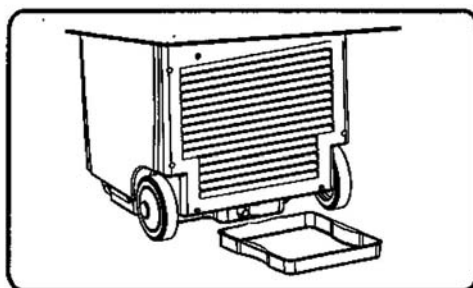

Maintenance (continued)

B. Continuous drainage

This unit can be used with a permanent drain connection. If you use this unit frequently, please connect the pipe to the unit as shown below so that the unit can drain the water continuously.

1. Disconnect the rubber plug from continuous drainage pipe. Store the disconnected rubber plug for later use.
2. Connect supplied drainage pipe to drainage hole, condensed water will flow out.
3. If you want to extend drainage pipe, you can use 18mm (inside diameter) plastic pipe and connect with the supplied drainage pipe.

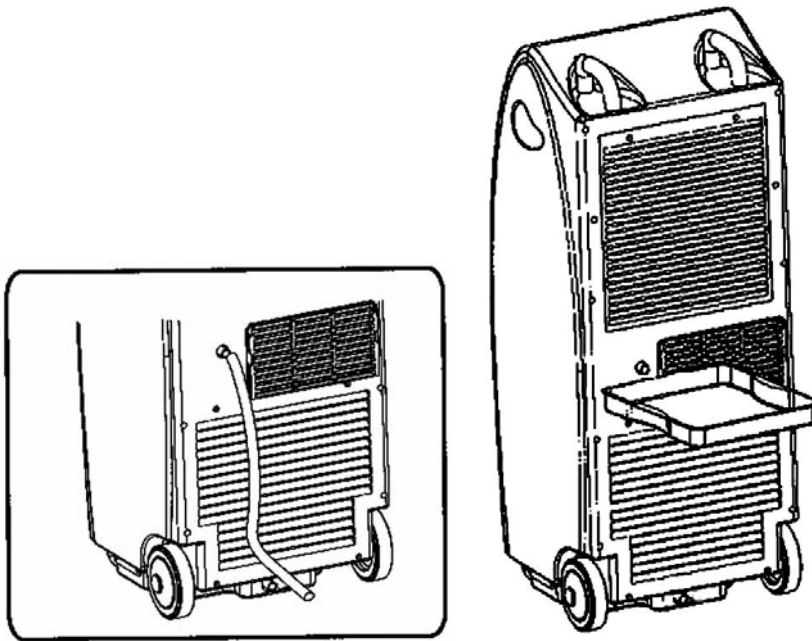

Troubleshooting

Problem	Cause	Suggested solution
The air conditioner does not work	Power supply fault. 1. Unit not plugged in 2. Faulty plug or socket 3. Blown or tripped fuse	Plug into socket outlet. Contact a qualified engineer to replace faulty plug or socket. Replace or reset fuse.
The display shows run mode but does not run	1. The TIMER has been set	Cancel the TIMER or wait for timer to initiate.
Not working In cooling mode	1. The room temperature is lower than the set temperature	It is normal
No cold air is being delivered	1. There is frost on the evaporator	The unit is defrosting & will run after defrost termination.
In dehumidifying mode no cool air is delivered	1. There is frost on the evaporator	The unit is defrosting & will run after Defrost termination. This is normal.
LCD window shows "E2, E3"	1. Room temperature sensor	Refer fault to authorised dealership.
LCD window shows "E4"	1. Water tank is full	Drain condenser water

Packing List

No.	Part Name	Qty
1	Mobile Air Conditioner	1
2	Exhaust Air Duct	1
3	Mid-Connector	1
4	Exhausted Air Duct Inlet Connector	1
5	Exhausted Air Duct Outlet Connector	1
6	Exhausted Air Duct Fish Tail Outlet Connector	1
7	Remote Controller	1
8	Manual Instruction	1
9	Drainage Pipe	1
10	Water Plate	1

Electrical Circuit Diagram

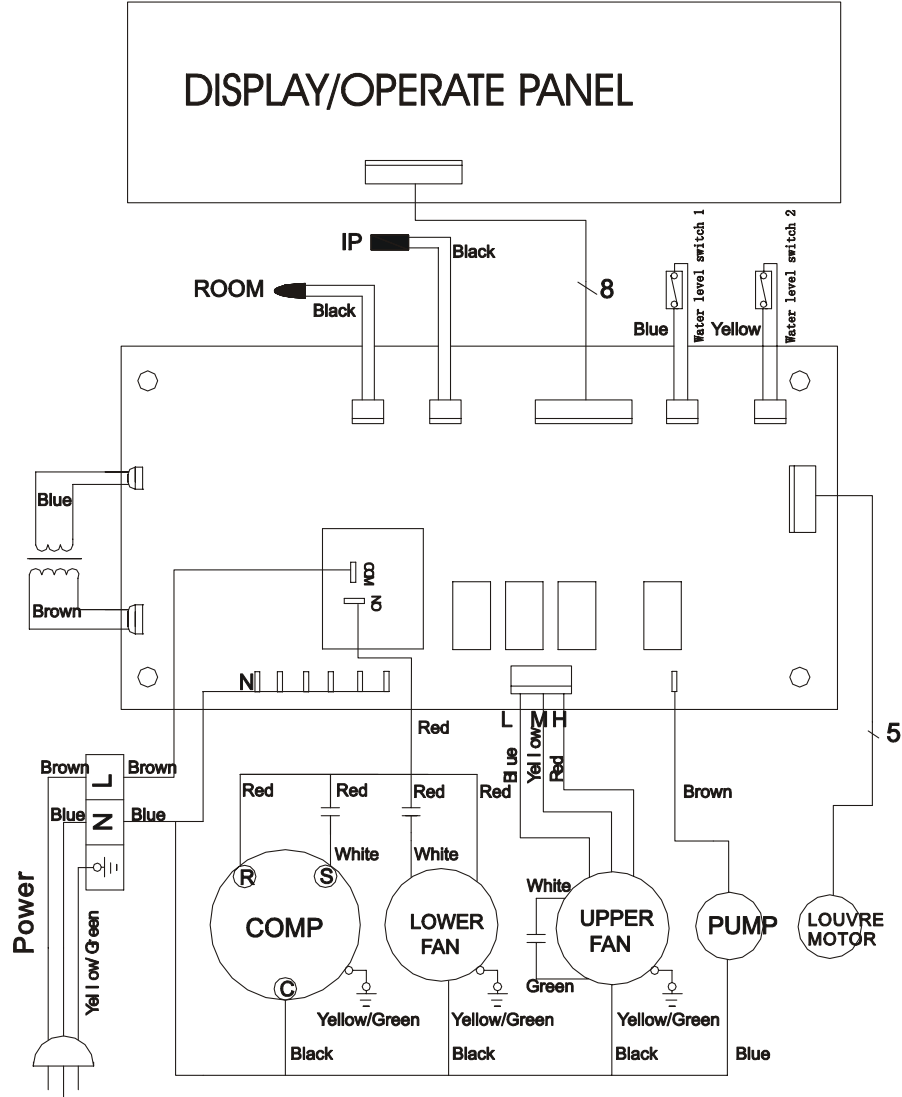

Warranty

Do not operate the unit with a damaged cord or plug, after the unit malfunctions, has been dropped or damaged.

For your convenience, record the complete model number and product name (located on the Product Identification Plate), the date you purchased the product, and attach your purchase receipt as proof of purchase.

To ensure your product is covered by warranty, the complete faulty product together with your purchase receipt should be returned to your retailer.

ONE (1) YEAR LIMITED WARRANTY Save This Warranty Information

EHS (International) Ltd. guarantees this product free from defects in materials and workmanship for a period of one (1) year.

Should this unit be operated under conditions other than those recommended, at voltages other than the voltage indicated on the unit, or any attempts made to service or modify the unit, will render this **WARRANTY VOID**. The product you buy may sometimes differ slightly from illustration. This warranty is in addition to, and does not affect your statutory rights.

Should you have a problem with this product, please call our Help Desk on: (0870) 742 5021.

This product has been manufactured to comply with EEC Directives 73/23/EEC and 89/336/EEC

Waste electrical products should not be disposed of with household waste. Please recycle where facilities exist. Check with your Local Authority or retailer for recycling advice.



EHS, Manchester, M17 1RN

EHS05/06