

Instruction Manual

Hitachi Air Purifier with Humidifying Function

Model

EP-A8000

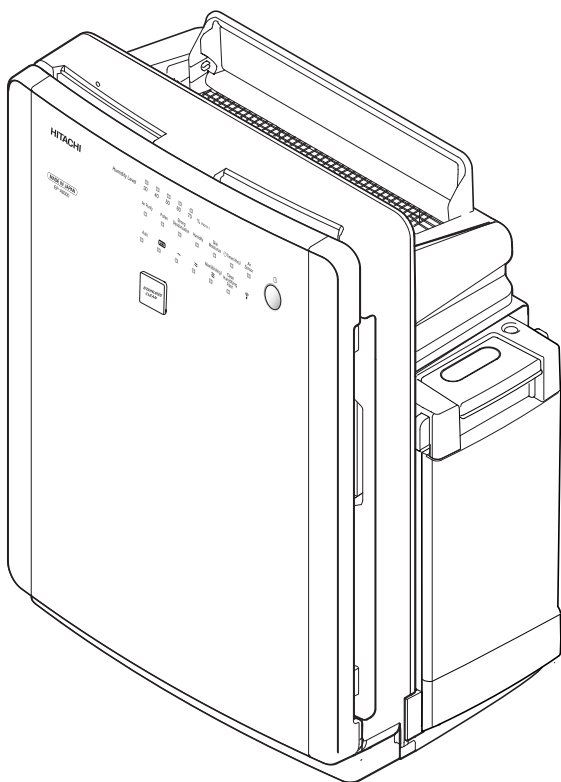

Thank you for purchasing a Hitachi air purifier.

This air purifier is for home use only. Do not use it for any other purposes besides purifying air.

Please read this instruction manual carefully before using this product to ensure the unit is operated correctly.

For future reference, keep this manual in an easily accessible place.

Read the “Safety Precautions” from page E-4 to E-7 to ensure correct use.

HITACHI

Inspire the Next

Contents

Before Use

● Features / Name of Each Component / Operation	
Buttons and Indicators / Accessories	E-2
● Safety Precautions	E-4
● Cautions on Use	E-8
● Preparations for Operation	E-9
• Setting Filter in Unit	E-9
• Inserting Batteries into Remote Controller	E-11
• Filling Water Tank	E-11
● Installation	E-13

Operating Air Purifier

● Using Remote Controller	E-14
• Starting Operation	E-14
• Selecting Operation Mode	E-15
• Switching Airflow Rate	E-16
• Max Operation	E-17
• Using Timer	E-17
● Using the Control on Unit	E-18
● Memory Function / Sensors / Auto Detection	E-18
• Memory Function	E-18
• Air Sensor	E-18
• Odor Sensor	E-18
• Dust sensor · Humidity Sensor	E-19
• Auto Detection	E-19
• Adjusting Sensor Sensitivity Setting	E-20
● Useful Feature	E-21
• Eco Operation	E-21
• Dimmer Control	E-21

Cleaning and Maintenance

● Cleaning	E-22
• When the “Clean Humidifying Filter” Indicator Comes On	E-22
• Water Tank · Humidifying Filter	E-23
• Replacing Humidifying Filter	E-24
• Water Tray / Tray Cover	E-24
• Pre-filter	E-25
• Unit · Dust sensor	E-26
● Filter Replacement	E-27
• Replacement Interval · Precautions regarding Filter Handling	E-27
• Replacing the Filter	E-28
● Alert Display	E-29
● Troubleshooting Guide	E-29
● Replacement Parts	E-32
● Specifications	E-32

Features / Name of Each Component / Accessories

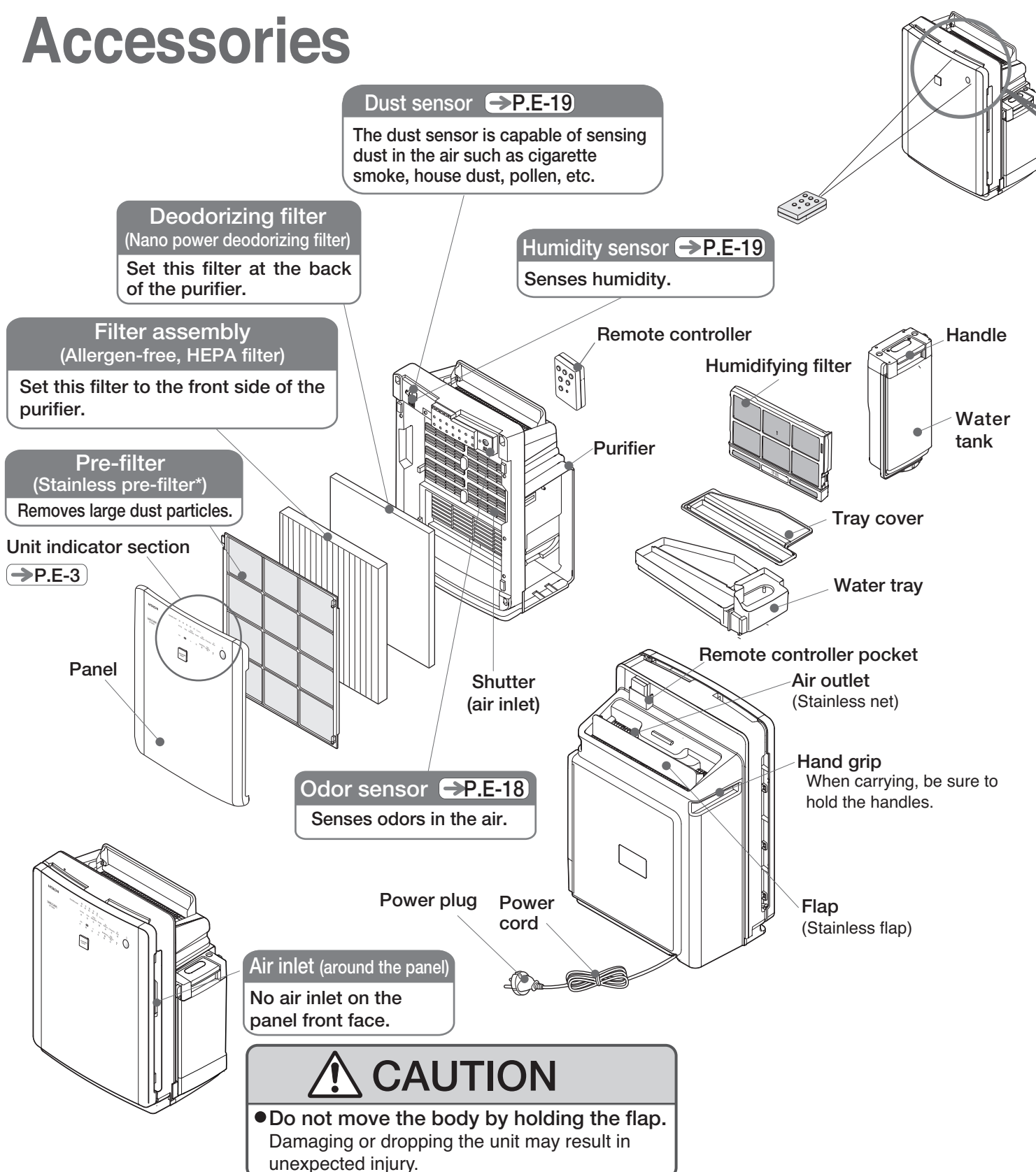

Provided Accessories

Filter	Pre-filter	Remote controller	"AAA" R03 batteries for remote controller	Humidifying filter
Housed inside the purifier. * Be sure to remove this filter from the plastic bag before operating the purifier. (dust filter(x1) deodorizing filter(x1))	(x1)	(x1)	(x2)	(x1)

Operation Buttons and Indicators /

■ P.* shows a page in the instruction manual with additional information.

Unit Operation Buttons and Indicators

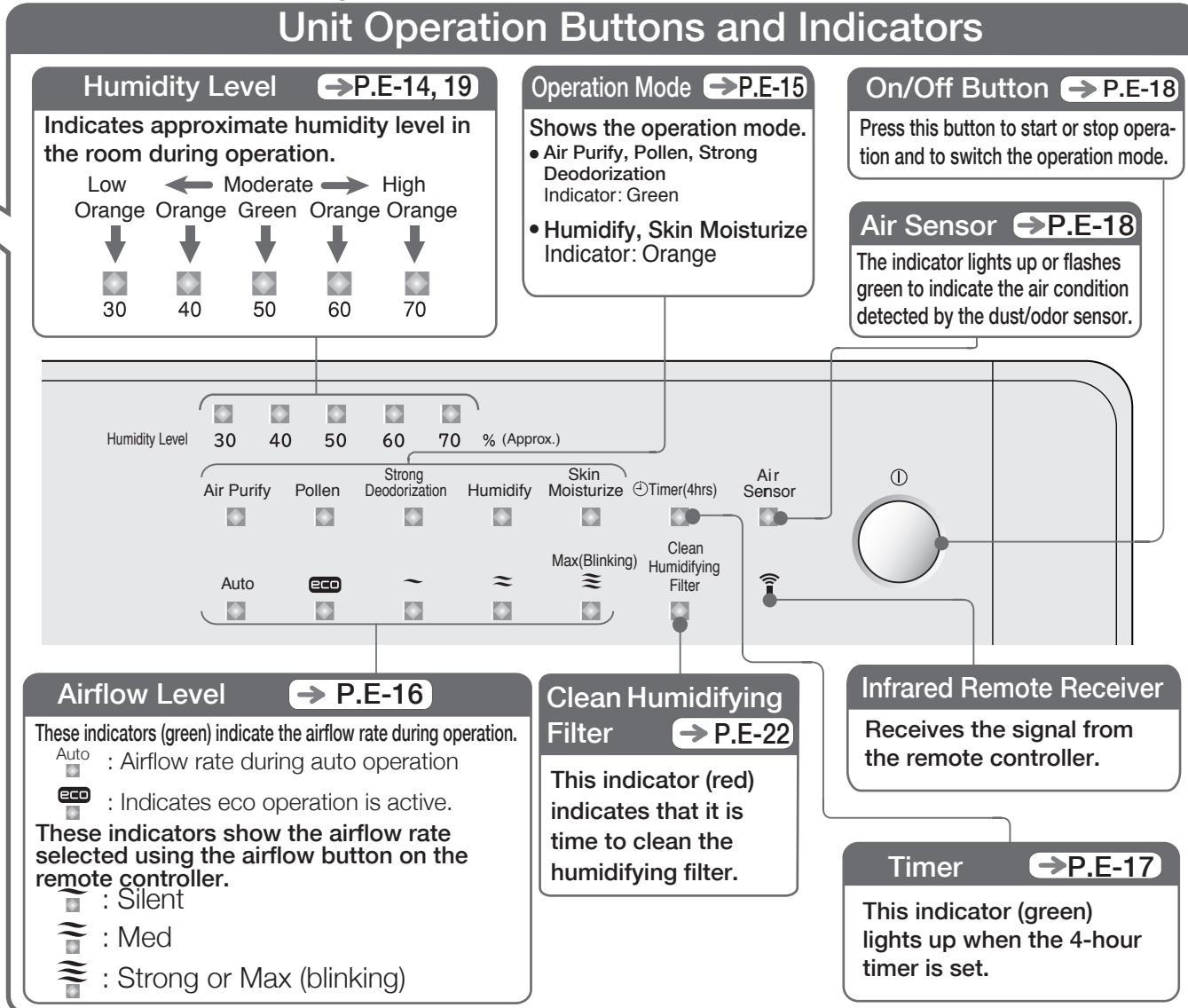

Features / Name of Each Component / Operation Buttons and Indicators / Accessories

Remote Controller

- When using the remote controller, point it at the infrared remote receiver on the unit indicator section.
- When aimed squarely at the infrared remote receiver, the remote controller can be used at distances of up to approximately 6 m.

On/Off Button → P.E-14

Press this button to start or stop operation.

eco Button → P.E-21

Press this button to start or stop eco operation.

Max Button → P.E-17

Press this button to start max operation.

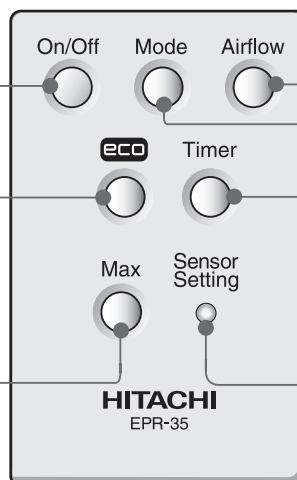

Airflow Button → P.E-16

Press this button to switch airflow rate.

Mode Button → P.E-15

Press this button to switch operation mode.

Timer Button → P.E-17

Press this button to set Off-timer.

Sensor Setting Button → P.E-20

Press this button to switch sensor sensitivity.

Note

- The remote control may not work in a room where inverter lighting apparatus or electronic quick start lighting apparatus is used, or when the infrared receiver is exposed to direct sunlight.
- The remote controller works best when aimed squarely at the remote infrared receiver. Whenever possible, use the controller from a point directly in front of the unit.

Safety Precautions

- **Please read the following safety precautions carefully before using the unit.**
To prevent injury to the user or other people and property damage, the following instructions must be followed. Also read the precautions appearing in the text carefully to ensure correct use.

■ Definition of each indication

Incorrect operation that are carried out as a result of ignoring instructions will cause harm or damage. The seriousness is classified by the following indications.



WARNING

This symbol indicates the possibility of death or serious injury.



CAUTION

This symbol indicates the possibility of injury or damage to property.

Meanings of Symbols



Indicates "warning or caution".



Indicates "prohibition".



Indicates a "must".



WARNING

To Prevent Fire, Electric Shock and Injury

AC Outlet, Power Plug and Power Cord



- **Before cleaning and carrying out other types of maintenance, be sure to unplug the power cord from the AC outlet, and never pull it out or insert it with wet hands.**
Otherwise, it may cause an electric shock or injury.

- **Be sure to hold the plug, not the power cord, when unplugging it from the AC outlet.**
Otherwise, it may cause an electric shock or short-circuit, which may result in a fire.

- **Be sure to unplug the power cord from the AC outlet when not using the air purifier for an extended period of time. Also drain the water tank and water tray.**
Otherwise, it may cause an electric shock, fire or create unpleasant odors.

- **Securely insert the power plug into the AC outlet.**
Otherwise, it may cause an electric shock, fire, smoke emission and ignition.

- **Remove dust from the power plug periodically using a dry cloth.**
Otherwise, it may cause a fire.

- **If you notice any abnormalities (water leakage, burning smell, etc.) stop operation and unplug the power cord.**
It may cause an electric shock or fire due to ground leakage or short-circuiting.

- **If the supply cord is damaged, it must be replaced by the manufacturer, its service agent or similarly qualified persons in order to avoid a hazard.**



- **Do not use with a voltage other than 220-240V AC.**
Otherwise, it may cause a fire or electric shock.

- **Do not damage the power cord.**

(Do not break, modify, forcibly bend, pull or twist it.
Also do not place any heavy objects on it or pinch it.)

- **Do not use a damaged power cord or power plug, or a loose AC outlet.**
Otherwise, it may cause an electric shock, short-circuit or ignition.

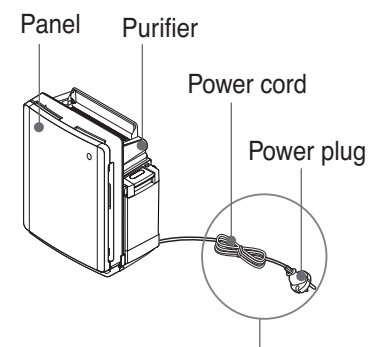
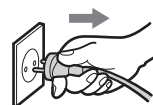

WARNING

Water Tank, Water Tray and Humidifying Filter



- **Do not operate the unit without first setting the water tank, water tray and humidifying filter in place.**
Otherwise, it may cause an injury or unit failure.
- **Do not use any detergent (used for kitchen or laundry) when cleaning the water tank or water tray.**
Ingredients in the detergent may cause damage and subsequent water leakage, or electric shock, injury or unit failure.
- **Do not carry the water tank by its handle.**
Dropping the tank may inadvertently cause an injury or other accident.
- **Do not disassemble the tank cap.**
Otherwise, it may inadvertently cause an accident such as small children swallowing it by mistake.

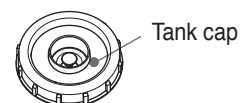
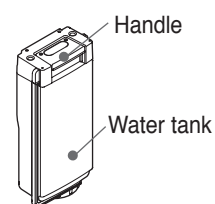

Place of Use



- **Do not use in any place with considerable oily smoke such as a dining room, restaurant, kitchen, etc.**
- **Oil and dust accumulated inside the body may result in fire disaster, failure and odor.**
- **Do not use in a humid place such as in a bathroom.**
It may cause an electric shock or unit failure.
- **Do not place the air purifier near a hot object such as a heater.**
Doing so may cause unit failure or deformation.
- **Do not use in a location where soot from oil, such as machine oil, is floating in the air.**
Doing so may cause a crack or fire.
- **Do not use the air purifier in a kitchen as a substitute for a ventilation**
Doing so may cause a unit failure.
- **Do not use in a location where any organic solvents or chemicals are used.**
Doing so may cause discoloration, deformation or fire.
- **Do not use the air purifier in a location where a machine tool that produces flammable dust or sparks (such as a grinder or welder) is installed.**
Otherwise, it may cause a fire.

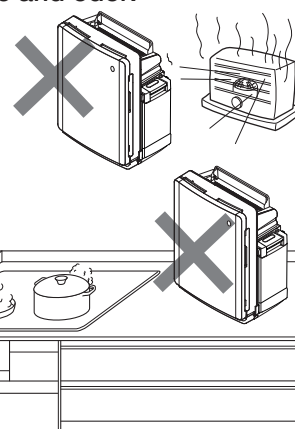

Purifier and Panel



- **Do not use benzene or thinner to clean the purifier or spray flammable gas such as insecticides.**
Doing so may lead to cracking, electric shock, ignition or explosion.
- **Do not let any inflammable materials, lit cigarettes or incense enter the air purifier intake.**
Doing so may cause a fire.
- **Securely hold the grip when carrying the air purifier.**
Dropping it may cause an injury or damage it.

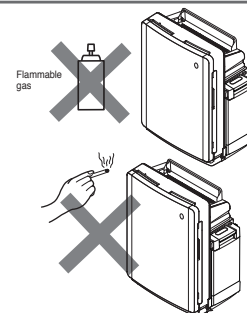

Miscellaneous



- **In case the unit becomes inoperative or anything abnormal such as smoke or unusual odor is noticed, immediately unplug the power cord to prevent an accident and contact your dealer to request checking or repair.**
It may cause an electric shock or fire due to ground leakage or short-circuiting.
- **Ventilate the room on a frequent basis if any heating appliance is simultaneously used with the air purifier.**
Otherwise, it may cause carbon monoxide poisoning.
- **The appliance is not to be used by children or people with reduced physical, sensory or mental capabilities, or lack of experience and knowledge, unless they have been given supervision or instruction.**
- **Children should be supervised to ensure that they do not play with the appliance.**
- **Never attempt to disassemble, modify or carry out repairs by yourself.**
Doing so may cause a fire, electric shock or injury. (Contact your dealer for repairs.)
- **Do not put your finger or any other object into the air outlet or inlet.**
Otherwise, it may cause an injury or unit failure.
- **Do not submerge or splash water on the unit. Also avoid filling water directly into the unit.**
Doing so may cause an electric shock or short-circuit.
- **Do not tilt or tip the unit over. Do not put your weight on the unit or step on it.**
Doing so may cause the unit to tip over, which may cause an injury or water leakage.
- **Do not install it in an unstable place or anywhere near infants.**
Doing so may cause the unit to tip over, which may cause an injury.

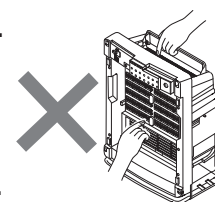
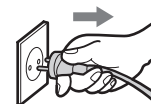

Safety Precautions (Continued)



CAUTION

Miscellaneous



- **Securely hold the grip when carrying the unit.**

Damaging or dropping it may cause injury.

- **When you attach or detach the panel and water tank, do it slowly and carefully.**

Otherwise, water may leak out or fingers may be pinched.

- **Use dry cell batteries after reading the relevant precautions.**



- **Refill water in the water tank on a daily basis using tap water and clean the tank periodically according to the instructions in the "Cleaning" section of this manual.**

Continued use without cleaning may propagate molds or bacteria due to dirt and water scale, which may lead to unpleasant odors. In rare cases, this may cause a health risk to those who are hyperactive. In rare cases, this may cause a health risk to those who are hyperactive. In such a case, please seek medical advice.

- **Only use fresh tap water.**

Otherwise, it may cause deformation or degeneration of parts, unit failure or unpleasant odors due to propagation of molds or bacteria.

Do not use hot water (over 40°C), purified water, alkali ion water, mineral water, well water, or other similar types of water.

Do not put organic solvents, chemicals, perfume or air freshener into the water tank.

- **Do not drink or allow anyone to drink water in the water tank and water tray.**

Doing so may cause a health threat.

- **Do not leave the detached water tank with its cap closed.**

The inner pressure of the tank changes according to ambient temperature changes and may cause water to leak or injury due to deformation or damage.

- **Use a genuine filter for the Hitachi Air Purifier.**

Other filters may cause unit failure.



- **Do not operate the unit when using fumigating (smoking) type insecticide.**

Use of such insecticides will cause chemicals to accumulate in the unit and subsequently be emitted by subsequent operations, which can be harmful to your health.

After using insecticide, ventilate the room well before running the purifier.

- **Do not allow water to freeze.**

Doing so may damage the water tank, causing a risk of electric shock and unit failure.

Whenever it is considered that water may freeze, drain the water tank and water tray.

- **Do not use the purifier if water is leaking from it.**

Doing so may cause an electric shock. If water is leaking out, unplug the power cord from the AC outlet and request repairs.

- **Do not carry the unit when the water tank is full.**

· Doing so may cause water to leak or injury.

· If you carry the purifier when the water tank is full, the level of water in the tray will rise and cause the water to overflow when operated.

· Drain the water tank and water tray first, and set them on the unit before carrying.

- **Do not tip over or drop the water tank when it is filled.**

Doing so may cause an injury or the tank to become deformed or damaged.

Hold the tank securely when you fill it with water.

- **Do not look into the indicator.**

Doing so may cause an eye injury.



CAUTION

Miscellaneous



- **Do not use near cooking utensils.**

Heat, oily smoke, etc. may result in component deterioration, electric shock and ignition.

- **Do not strongly push or pull the flap.**

Doing so may result in injury and failure.

- **Do not move the body by holding the flap.**

Damaging or dropping the unit may result in unexpected injury.

- **When using near a pet, do not let it urinate on the body, or bite the electrical cord.**

Doing so may result in electric shock and ignition. In such a case, disconnect the power plug from AC outlet and request repair.

To Prevent Floor Scratches or Wall Stains

During Cleaning / Place of Use



- **During cleaning, lay a soft cloth on the floor and place the unit and detached components (panel, water tank, water tray, etc.) on it.**

Otherwise, it may cause scratches on the floor.

- **When you pull out the water tray from the unit, be careful not to scratch the floor with the bottom of the tray.**



- **Do not use the air purifier near a wall that cannot be scrubbed, such as a white cloth-covered wall.**

The air purifier will take in the surrounding air and may produce stains on a wall near its air outlet.

Cautions on Use

Do not install in an unstable or angled location, or near any obstacles.

Otherwise the unit may fall or drop, resulting in damage or unit failure.
If the space between the unit and floor remains humid, mold may grow on the floor.
If the unit is used at an angle, water may leak out.

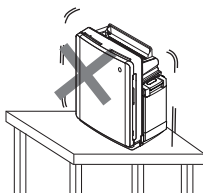

Do not directly fan animals and plants.

Air drafts may adversely affect them.

Do not place anything on the unit, and do not block the air inlet or air outlet.

Doing so may cause a unit failure.

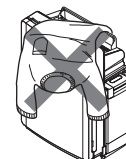

Do not drag the unit on any floor susceptible to scratches or on thick carpet.

Doing so may damage the floor or carpet surface.

Do not run with filter detached.

No cleaning effect can be expected unless the filter is used.
Running without the filter may also cause unit failure.

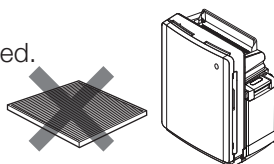

Do not use near cooking utensils.

Heat, oily smoke, etc. may result in deformation and discoloration.
Place at a distance of at least 1 m.

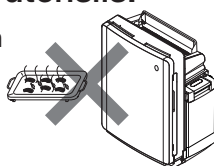

Do not block or touch the infrared receiver, odor sensor, dust sensor or humidity sensor.

- Doing so may result in the infrared receiver becoming stained or damaged, which may reduce its sensitivity.
- The sensitivity of sensors may be reduced.



Do not subject the remote controller to impact.

Do not drop the remote controller or step on it, and do not place any object on it. Doing so may cause a unit failure.

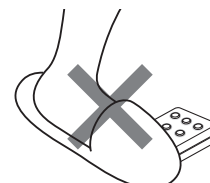

Do not install in a location where the air from the unit will blow directly onto furniture, electric appliances, walls or ceiling.

Humid air may cause stains or deformation of furniture, or may cause unit failure.

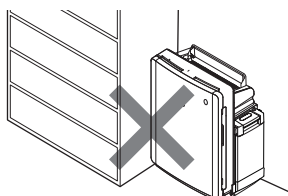

Do not subject the water tank to impact.

Water may leak from the tank and wet the floor. Also water may drip from the tank cap and wet the floor.

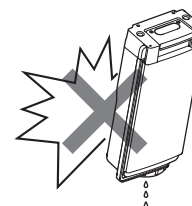

Ventilate closed rooms occasionally.

The purifier does not have a ventilation effect.

- * The purifier cannot remove hazardous substance in cigarettes (carbon monoxide, etc.).

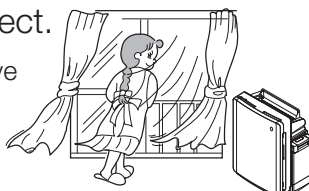

Do not use near a television or radio.

Doing so may interfere with broadcasts. Install the unit 2m or more away from such devices.

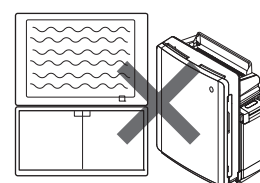

Preparations for Operation



- Lay a soft cloth or similar material beneath the unit to protect the floor against scratches.
- No cleaning effect can be expected if the filter is inserted while still inside the plastic bag. It may also cause a malfunction.
- Do not tip over or tilt the unit.

CAUTION

Due to vibrations during transport, etc., deodorant powder (black, white) may emerge from the filter.

- When removing the filter from the bag and attaching it to the body, please be careful to ensure your hands, clothes and surroundings, etc. are not soiled.
- Wipe off any powder that is spilt or adheres to the filter.
- The deodorization performance will be unaffected.

Setting Filter in Unit

- The procedures for filter replacement are also the same. (Use a genuine filter for the Hitachi Air Purifier.)

1 Remove the panel and pre-filter.

- 1 Place the body in a horizontal and stable place.
- 2 Hook your fingers at the bottom of the panel (in two locations), slowly pull toward you and slightly shift upward to remove.
- 3 Rotate the knobs of the pre-filter (in two locations) to the left to unlock.
- 4 Remove the pre-filter.

CAUTION

- Do not rotate the knobs in reverse or rotate them forcibly. Doing so may result in damage.

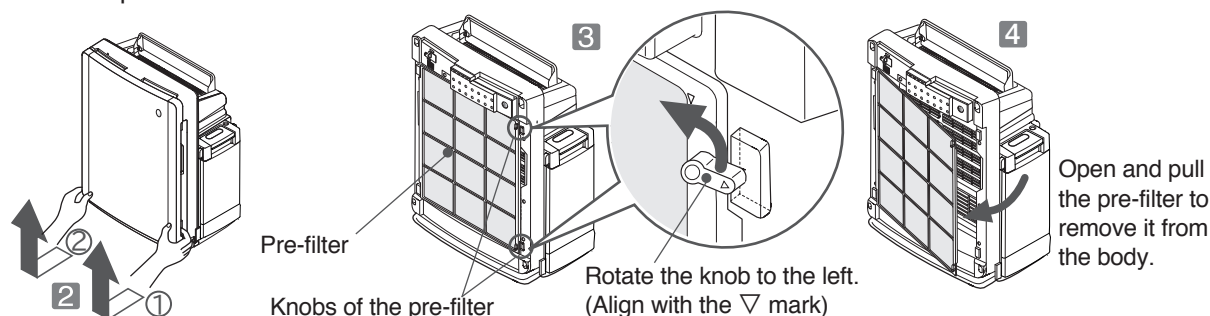

2 Remove the filter. (There is a dust filter and deodorizing filter.)

- 1 Remove the filter packed in a plastic bag from inside the purifier.
- 2 Take the filter out of the plastic bag.
- 3 Remove the packaging.

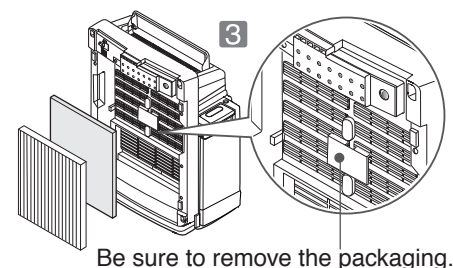

3 Install the deodorizing filter on the purifier.

- 1 Install the deodorizing filter so that its black surface faces the front (white surface in the back).
- 2 Insert the filter all the way until the label (deodorizing filter position indicator) is hidden.

Note

- Be sure to take the filter out of the plastic bag.
- Do not block the front face of the filter with cloth or paper.
- The same precautions should also be followed for the dust filter.

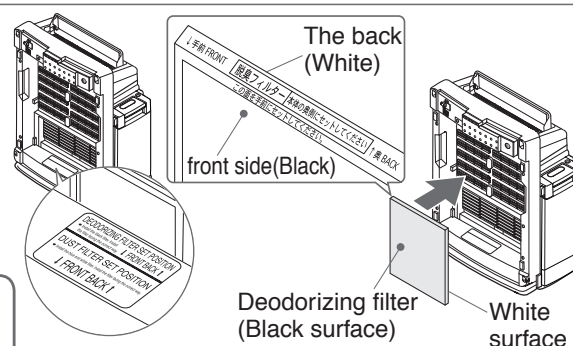

Preparations for Operation (Continued)

4 Install the dust filter on the purifier.

- 1 Insert the filter all the way until the label (dust filter position indicator) is hidden.

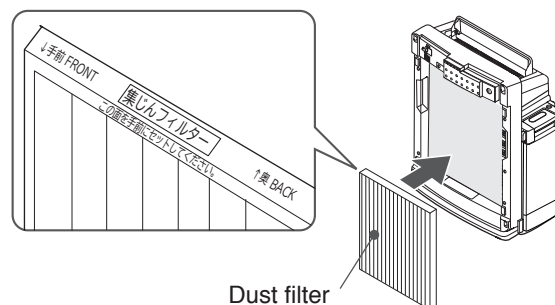
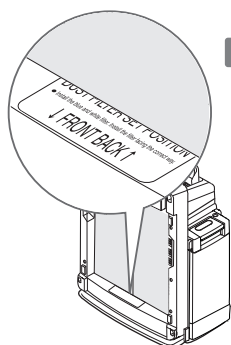

Dust filter

5 Attach the pre-filter to the body.

- 1 Incline the pre-filter and stably insert the latch nub into the insertion holes of the body in order from top to bottom.
- 2 Close the pre-filter on the body filter side.
- 3 Rotate the knobs of the pre-filter (in two locations) to the right to lock into the insertion holes of the body.
- 4 Lightly pull the pre-filter to confirm it does not come off.

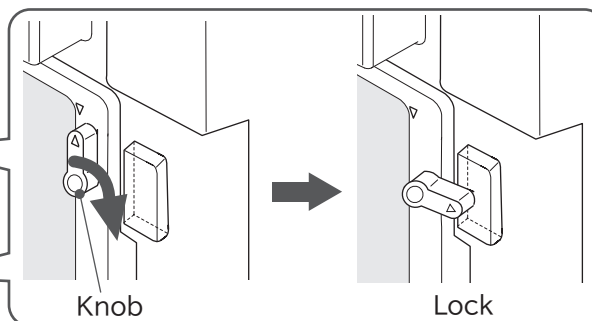
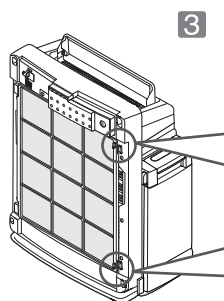
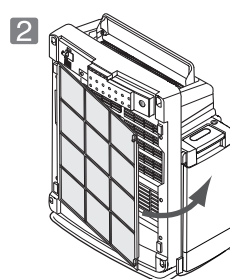
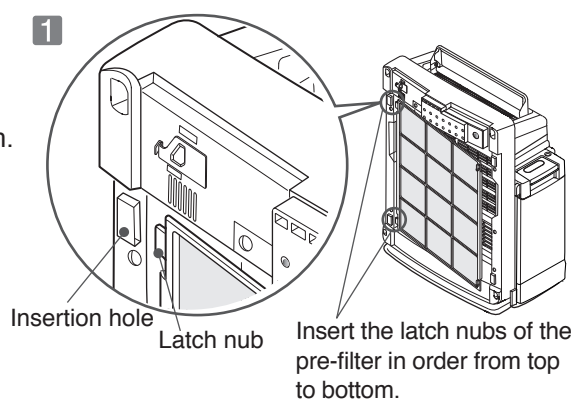

Rotate the knob to the right by 90 degrees to lock it.

6 Reinstall the panel on the purifier.

- 1 Insert the two tabs on top of the panel into the two holes on the purifier.
- 2 Gently push the bottom of the panel until it clicks to close it securely.

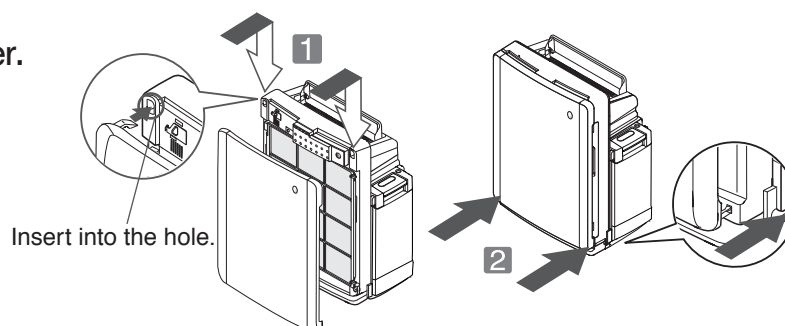

Inserting Batteries into Remote Controller

1 Remove the battery compartment cover.

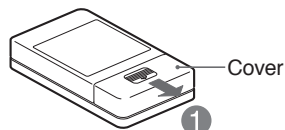

2 Insert batteries and close the cover.

- Insert the two provided AAA R03 batteries with the correct polarities as instructed.
- Since the batteries are provided when shipped from the factory, their lives may be shorter than brand new batteries due to self discharge.
- Batteries are consumable items.
- When replacing batteries, replace two batteries simultaneously.
- Only use two manganese batteries or two alkali batteries. Do not mix different types of batteries.

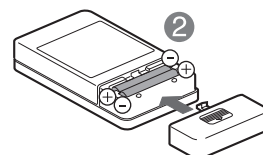

Press in the cover until it clicks.

Filling Water Tank (for Humidify Mode and Skin Moisturize Modes)

1 Quietly remove the water tank.

- 1 As in the following illustration, applying your thumb to the top of the water tank handle, lift up the bottom to unlock.

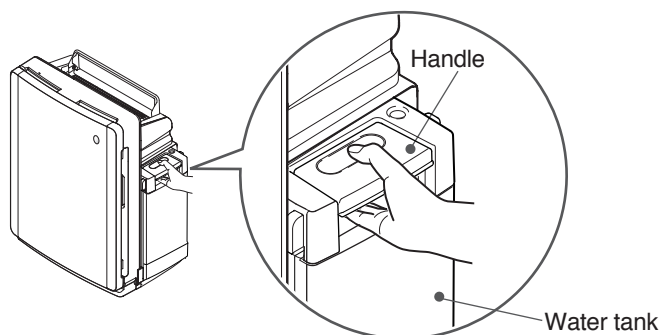

- 2 Pull the water tank toward you and remove it.

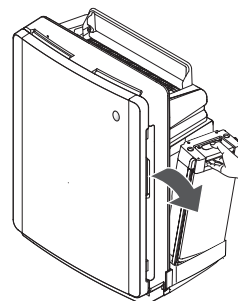

CAUTION

- When removing the water tank, water adhering to the tank cap may spill, so lay a dry cloth beforehand.

2 Remove the tank cap and fill with clean tap water at room temperature.

- When pressing the pin in the center of the tank cap, confirm it returns with a spring.
- Firmly fix the tank cap parallel to the surface of the water tank inlet. Wipe off the spilt water and turn the tank cap upside down to check that there is no water leakage.
- * When carrying the tank, keep the tank cap upward.
- When water collects in the handle of the water tank, wipe it off.
- The tank cap is consumable. (When water leaks due to deterioration, etc. of the rubber packing, purchase the tank cap, a part separately sold to replace → P.E-32)

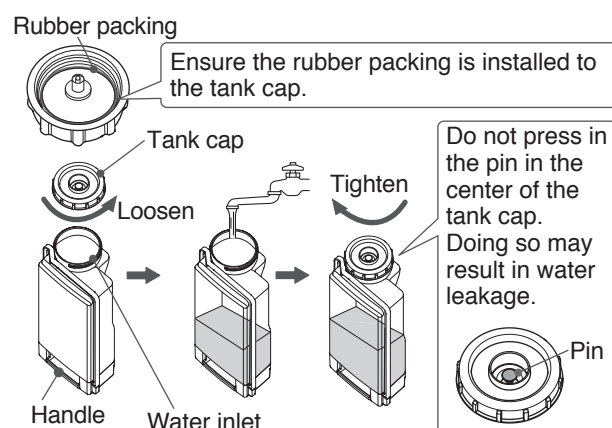

Preparations for Operation (Continued)

- 3** Remove the water tray, confirm the humidifying filter and tray cover are attached, and press it back in place.
- Water supplied from the water tank is sucked upward by the humidifying filter for humidification.

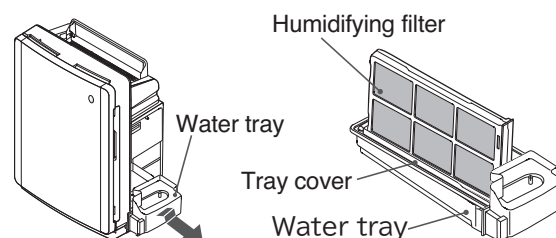

When removing the water tray, slowly pull it out by lifting it upward at a slight angle.

- 4** Set the water tank in the receiving portion of the body.

- Push in the handle of the water tank firmly until it clicks and ensure it will not come off. (When it is difficult to push in the water tank, move the handle up and down.) Insecure attachment may result in the water tank falling or water leakage.

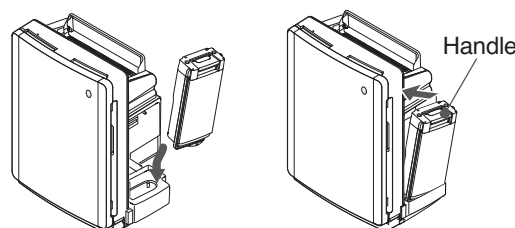

CAUTION

- Please securely tighten the tank cap. After tightening, turn over the tank cap, wipe off any spilt water and check that there is no water leakage.
If water leaks, retighten the tank cap firmly and recheck whether any water leaks.
- If water still leaks, stop using the unit. When carrying the water tank, keep the tank cap side up and hold the top and bottom of the water tank.
If the water tank is wet, wipe off the drops before carrying.
- When water collects in the handle of the water tank, wipe it off.
Do not apply excessive force to the water tank, for example, holding the front and rear with hands, placing something on it, stepping on it or dropping it. Do not freeze the water in the water tank.
- Do not freeze the water in the water tank.
- Do not leave the water tank removed from the body.
When attaching the tank cap, be sure to install it on the body.
Changes in the inner pressure of the tank according to ambient temperature change may cause water leakage, deformation or damage.
- Do not place the body anywhere exposed to high temperature and direct sunlight.
Inner pressure of the tank changes according to ambient temperature change and may cause water leakage or deformation or damage.
- Remove the water tank before pulling out the water tray.
Pulling out the water tray without removing the water tank may result in deformation and damage of the water tank and water tray.
- When removing the water tray from the body, quietly pull it out by lifting it upward at a slight angle.
The bottom part may damage the floor.
- Do not mount the water tank with the water tray removed.
The water tank may fall.

Note

- If water is present in the water tank or water tray, the humidification function operates regardless of the operation mode.
If you do not need humidification, do not fill the water tank and water tray with water.
- When installing the empty water tank on the product, do so by lifting up the handle.

Installation

- Install the unit on a level, stable and sturdy surface.
- Avoid any location close to cooling or heating appliances, and select a well-ventilated area.
- Keep the unit at least 90 cm away from the walls on both sides. Otherwise, discharged air will mix with surrounding air and the walls may become dirty.



WARNING

- Do not place the unit on an unstable floor or pedestal. Otherwise the unit may fall or drop, resulting in damage or unit failure.
- Using the unit positioned on an angle may cause water to leak.

Opening the flap

- Hold the tip of the flap with your hand and adjust it.
- The angle of the flap is adjustable in three stages.
When in operation, use it in a diagonal or upward direction.

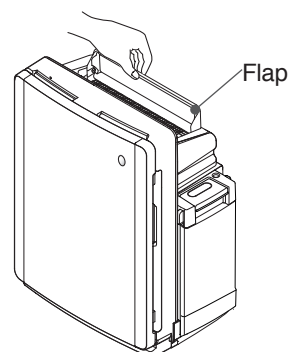

● Position of the flap

- Closed (when not in operation)

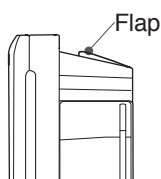

When not in operation, close the flap to avoid dust ingress.
When in operation, set it in a diagonal or upward direction.

● Diagonal direction (in pollen mode)

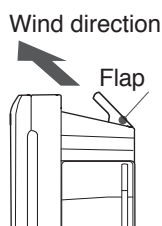

Incline the airflow by the flap to improve the capture efficiency of pollen floating near the floor.
Use in pollen mode.

● Upward direction

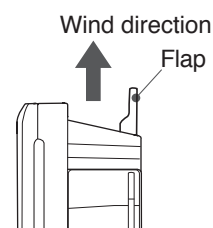

Normally use in the upward direction.

- When changing the angle of the flap, move it until it clicks.

CAUTION

- **Do not operate with the flap closed.**
Doing so may result in louder noise and greater vibration or failure.
- **Do not apply excessive force to the flap.**
Doing so may result in failure and damage.



CAUTION

- **Do not move the body by holding the flap.**
Damaging or dropping the unit may result in unexpected injury.

Using Remote Controller

- Here we describe how to operate the unit using the remote controller. For information about using the control on the unit, please refer to page E-18.

Starting Operation

● Remote Controller

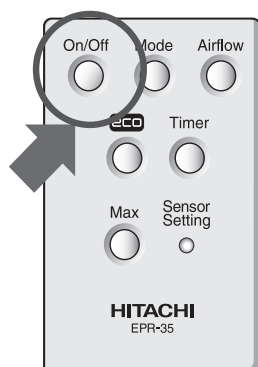

● Unit

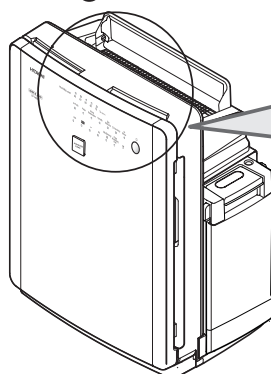

● Unit indicator Section

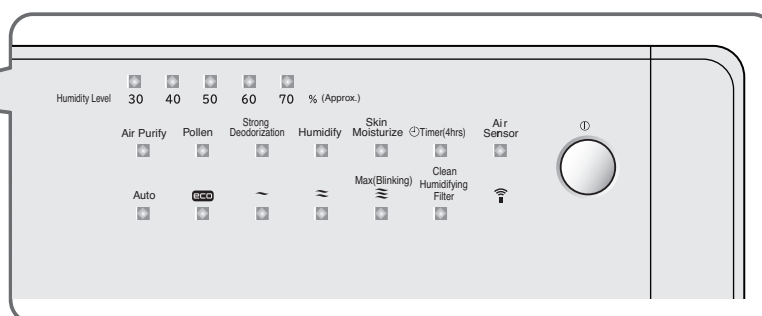

1 Securely insert the power plug into the AC outlet.

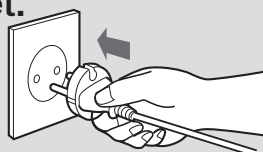

- During the first 3 minutes after the power cord is plugged in, the unit will check the air condition of the room and save it in memory. During that time, the “Air Sensor” and “Humidity Level 50” indicators will blink.

- You may start the operation within 3 minutes after plugging it in. In this case too, the “Air Sensor” and “Humidity Level 50” indicators will continue to blink. After 3 minutes have elapsed, the indicators will stop blinking.

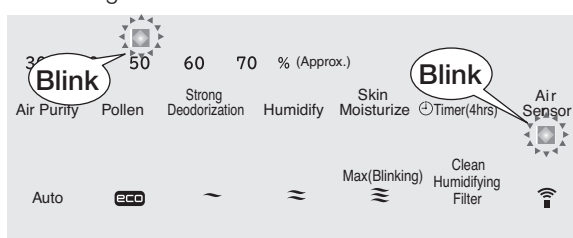

2 Press On/Off button.

Operation starts and the indicators are lit.

Pressing On/Off button during operation will stop operation.

- The “Air Purify” mode indicator lights up in green. *

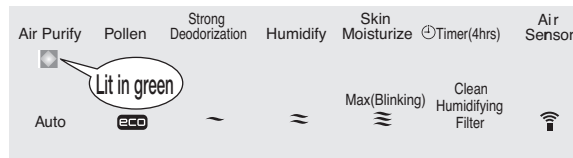

Note

If the On/Off button is not pressed after the power cord is plugged in, all indicators will go off after the “Air Sensor” and “Humidity Level 50” indicators blink for 3 minutes.
(Operation via remote controller is accepted even in this state.)

- * ● The factory setting is “Air Purify”.

- From the second time onward, the memory function enables the operation with memorized conditions. → P.E-18

Stand-by Power Consumption

- As long as the power plug remains inserted in the AC outlet, approximately 4W power will be consumed even if the unit is not used. (Unplug the power cord when the unit will not be used for an extended period of time.)

Selecting Operation Mode (Basics)

- 5 operation modes are available.
- In every operation mode, the fan will not stop during operation.
(In eco operation mode, the fan may stop. → P.E-21)
- In every operation mode, the air purifying function will work.
- When the operation mode is switched, airflow rate is set to “Auto”.

Operation Modes and Tips for Selection

Operation mode	Tips for Selection
Air Purify (Green)	<p>This is a normal operation mode.</p> <ul style="list-style-type: none"> • The odor sensor and dust sensor detect the degree of air contamination, and airflow rate is switched automatically. • During the auto sensor operation, airflow rate ranges from Silent to High.
Pollen (Green)	<p>This mode is recommended for users who are concerned about pollen contamination.</p> <ul style="list-style-type: none"> • The odor sensor and dust sensor detect the air contamination level, and the unit operates automatically. • In the automatic operation mode, airflow rate will be Silent to Med.
Strong Deodorization (Green)	<p>This mode is recommended for users who are concerned about room odor.</p> <ul style="list-style-type: none"> • The odor sensor and dust sensor detect the degree of air contamination and the unit switches to the operation with higher airflow than Air Purify mode. • During auto sensor operation, airflow rate ranges from Low to Max. • In the first minute, Max airflow operation is performed regardless of the level of air contamination.
Humidify (Orange)	<p>Room air humidity is controlled to approximately 50%.</p> <ul style="list-style-type: none"> • During auto sensor operation, airflow rate ranges from Silent to High.
Skin Moisturize (Orange)	<p>Room air humidity is controlled to approximately 60%.</p> <ul style="list-style-type: none"> • During the automatic operation, airflow rate ranges from Silent to High.

Note

- During operation, vibrations from the unit may slightly rock the water in the water tank.

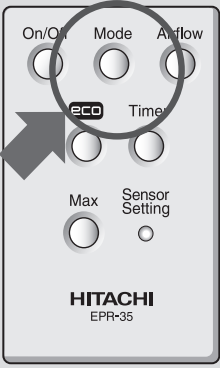

Press Mode button.

Operation mode switches every time you press this button.

- Selected operation mode indicator lights up.

On

Air Purify
Pollen
Strong Deodorization
Humidify
Skin Moisturize
⌚Timer(4hrs)

Auto
eco
~
≈
Max(Blinking)
Clean Humidifying Filter

- Operation mode switches every time you press the Mode button.

Air Purify → Pollen → Strong Deodorization → Humidify → Skin Moisturize

- The airflow rate is set to Auto by switching the operation mode.

Using Remote Controller (Continued)

Airflow rate

- When “Auto” is lit, the following airflow rate is used according to the selected operation mode.
The airflow rate indicators from “Silent” to “Max” do not light up.

Mode	Airflow Range
Air Purify	Silent ↔ Low ↔ Medium ↔ High
Pollen	Silent ↔ Low ↔ Medium
Strong Deodorization	Low ↔ Medium ↔ High ↔ Max
Humidify	When humidity level indicates 60% or higher Silent ↔ Low ↔ Medium ↔ High
Skin Moisturize	When humidity level indicates 70% or higher Silent ↔ Low ↔ Medium ↔ High

- According to the level of air contamination and humidity detected by the odor sensor, dust sensor and humidity sensor, airflow rate is automatically switched to an appropriate level.

Note

- So far as the water tank and water tray are filled with water, humidifying function works in any of “Air Purify”, “Pollen” and “Strong Deodorization” modes. If you do not want the humidifying function, drain the water tank, water tray and humidifying filter.

Switching Airflow Rate

- You can select a desired airflow rate from the four different levels.

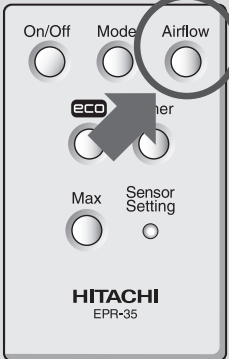

Press **Airflow** button.

Airflow rate switches every time you press this button.

- Airflow rate indicator comes on.



- Airflow rate changes in the following sequence.

Auto → Silent → Medium → High → Blinking (Max)

Max Operation (Air Purify Mode)

- This operation is useful in an environment where many people are smoking or when you want to clean room air quickly.

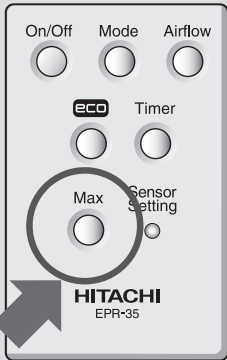

Max

Press  button.

The operation with Max airflow will continue for about 5 minutes.



After the Max operation, the status before the Max operation is resumed.

- The airflow indicator  blinks for 5 minutes.



How to cancel

On/Off Max

Press  button or  button during operation.

- It takes about 10 seconds until the air flow rate reaches Max.

Using Timer



Timer

Press  button.

Off-timer (4 hours) is set.

Operation will stop approximately 4 hours after the timer is set.

- The timer indicator lights up.



How to set/cancel

Every time you press the  button, "Set" and "Cancel" will alternate.

Using the Control on Unit

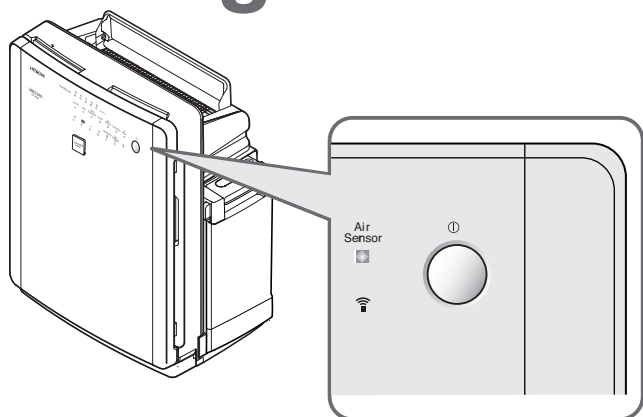

Press  button.

Operation starts.

- Every time you press the  button, the operation mode switches in the following sequence so that you can choose a desired mode or stop.

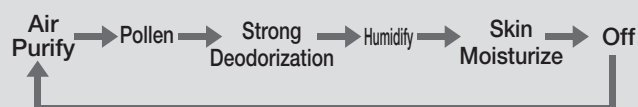

- The airflow rate is set to "Auto" by switching the operation mode.

Memory Function / Sensors / Auto Detection

Memory Function

- When you stop operation and then restart, the purifier will resume the operation that was running before shutdown.
- If you operate the Purifier for approximately 5 seconds or longer, the operation status will be stored in memory. (If you stop operation before 5 seconds have elapsed, the operation status will not be stored in memory.)
- Even if you unplug the power cord, the operation status will be stored in memory. However, the airflow rate is automatically set to "Auto".

Air Sensor

- Level of air contamination detected by the odor sensor and dust sensor is shown by the way the indicator is activated.
- | | | | |
|----------------------------|---------------------|---------|----------------|
| Indicator action | : Light up in green | ←.....→ | Blink in green |
| Contamination level: Clean | | ←.....→ | Contaminated |

Note

- You can adjust the air sensor and dust sensor sensitivity setting as desired. → P.E-20
- In case the purifier is installed in a location where air contamination is difficult to detect or in case the sensor itself is not clean, the indicator action may not change. → P.E-29

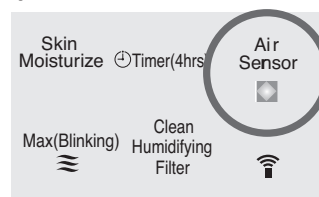

Odor Sensor

- The sensor detects odors in the air such as cigarette smoke or animal odors. Even if you think the air is clean, the unit may continue the operation if the odor sensor detects any gas component that has not been removed by the filter. Any of the following may also be detected by the odor sensor.
- Combustion gases from heating appliances, alcohol, odor of perfumes or cosmetics used in beauty parlors or aesthetic salons, sprays, vapors, abrupt temperature changes, etc.

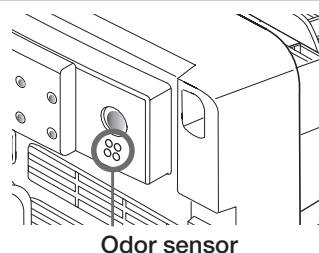

Dust sensor

- The dust sensor is capable of sensing dust in the air such as cigarette smoke, house dust, pollen, etc.
The dust sensor may fail to sense dust stirred up when you lay out or put away bedding, which contains significantly fewer contaminants than cigarette smoke, etc. In such a case, the displayed air contamination level may appear to be lower.
- Carry out periodical cleaning every 3-6 months. Otherwise the performance of the dust sensor will drop. → P.E-26

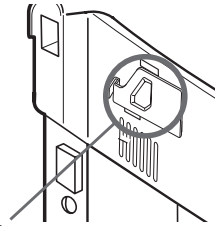

Dust Sensor

Humidity Sensor

- The humidity sensor detects humidity of room air during operation.
- Humidity levels should be taken as a guide only.
 - The indication may differ from hygrometer readings.
 - Humidity will change as temperature changes.
 - Humidity levels may differ between well-ventilated and poorly-ventilated places.

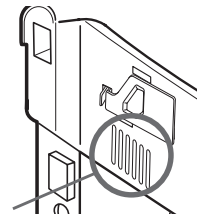

Humidity Sensor

Auto Detection

- The air purifier performs automatic operation by detecting room air contamination using the “Odor Sensor” and “Dust Sensor”, and room air humidity using the “Humidity Sensor”.
During the first 3 minutes after the power cord is plugged in, the unit will check the air condition of the room and save it in memory. During this time, the “Air Sensor” and “Humidity Level 50” indicators will blink. After 3 minutes, both the “Air Sensor” and “Humidity Level 50” indicators will go off and the purifier will now be ready to operate.
- You may start the operation within 3 minutes after the power cord is plugged in.
In this case too, the “Air Sensor” and “Humidity Level 50” indicators will continue to blink, meaning the unit is checking room air condition. After 3 minutes have elapsed, the indicators will stop blinking.
- If you plug in the power cord in an environment containing contaminated air, the sensitivity of the sensor may be reduced. In such a case, perform the High or Max operation. Or open a window and plug the power cord into the AC outlet when ambient air is clean. If the sensitivity of the sensor remains low after doing so, change the sensor sensitivity setting.

Memory Function / Sensors / Auto Detection (Continued)

Adjusting Sensor Sensitivity Setting

●Sensor sensitivity can be adjusted in 3-step fashion.

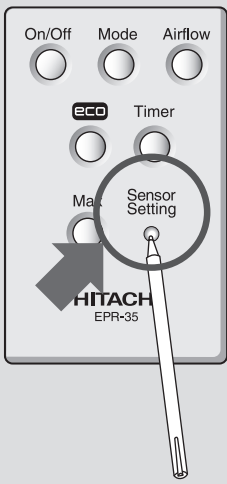

In each operation mode,

Sensor Setting

press  button.
(Use the tip of a ball point pen or similar object.)

The airflow indicator will blink for 5 seconds.

While the airflow indicator is blinking,

Sensor Setting

press  button.

●Present setting is shown by the airflow indicator that blinks for 5 seconds.

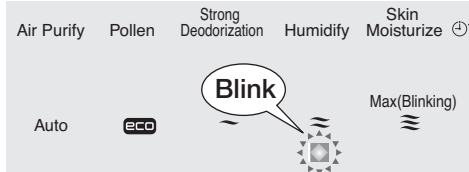

●Every time you press the button, the setting switches.

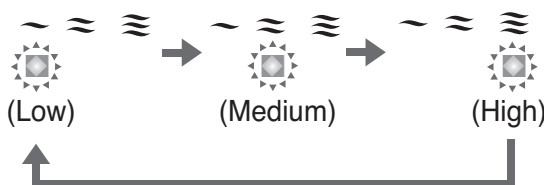

●The factory setting is “Medium”.

Useful Feature

Eco Operation

- In the eco operation mode, the unit automatically pauses when the air in the room is clean in order to save money on electricity. Furthermore, if this state continues for longer than 8 hours, the unit automatically stops operation. (During humidifying operations, the unit will not pause at a certain humidity level.)

- Normal automatic operation ①

When the air is clean, the unit continuously operates using "Silent" airflow. (In the strong deodorization mode, the airflow rate is set to "Low".)

- Eco operation

When the air is clean and the "Silent" operation continues for 10 minutes or longer, the fan stops for about 50 minutes and the unit intermittently operates using "Silent" airflow for about 10 minutes. If this state continues for longer than 8 hours, the unit automatically stops operation.

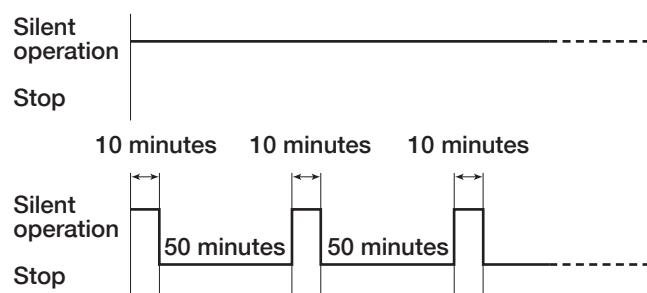

- × The degree of air contamination is detected by the odor sensor and dust sensor during eco operation. If the sensors detect odor or dust, the airflow rate switches according to the degree of air contamination. When the air becomes clearer and the unit runs for 10 consecutive minutes or longer using "Silent" airflow, the unit starts intermittent operation.

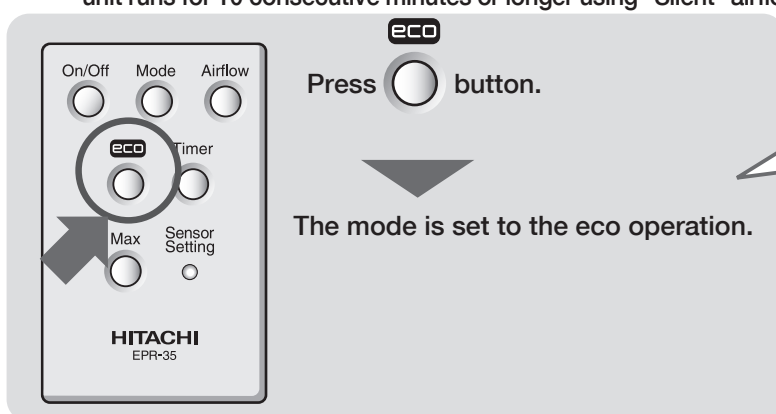

- "eco" indicator lights up.

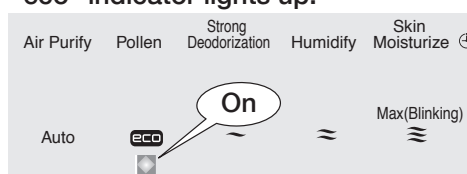

How to set/cancel

- Every time you press the button, "Set" and "Cancel" will alternate.
- The settings are stored.

Note

- When using the unit together with the Hitachi air purifier with ionizing function
 - Pressing the button on the remote controller in front of the Hitachi air purifier with ionizing function (model whose ionization setting / release is switched using the remote controller) sets and releases ionization. Furthermore, pressing the ionizing button on the remote controller of the model with the ionizing function sets and releases eco operation.

Dimmer Control

- If you feel uncomfortable about indicator lightings when you go to sleep, press button on the unit for 3 seconds or longer to dim the indicators.

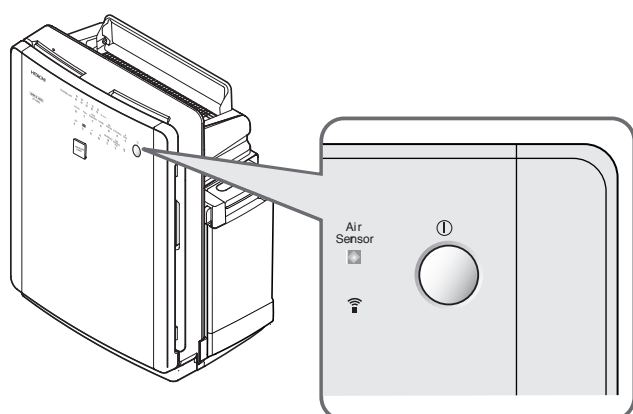

Press button for 3 seconds or longer.
The indicators are dimmed.

How to set/cancel

- Every time you press the button for approximately three seconds, "Set" and "Cancel" will alternate.
- The setting will be saved in memory.

Cleaning

- Before cleaning, be sure to stop operation and unplug the power cord from the AC outlet.



- Do not splash water on the unit. Doing so may cause a unit failure.
- Do not use volatile solvents, such as gasoline, thinner, benzene, wax, kerosene, alcohol, etc. or polishing powder, or detergent (used for kitchen or laundry). Such chemicals could cause deformation, discoloration, damage or removal of prints.
- Do not tip over or tilt the unit.



- When using a chemically treated cloth, follow relevant instructions.
- Never use a dryer or heater to dry the unit case. Heating could cause deformation, discoloration, damage or removal of prints.
- Lay a soft cloth or similar material beneath the unit to protect the floor against scratches.

- When the “Clean Humidifying Filter” indicator lights up, clean the humidifying filter, water tray and tray cover. The “Clean Humidifying Filter” indicator will come on approximately one month (approximately 720 hours) after the start of use or after the reset button was pressed after the previous cleaning operation finished. Depending on the tap water used, water scale may adhere earlier. If there is heavy filter contamination, clean the filter more than once a month before the “Clean Humidifying Filter” indicator lights up.
- After cleaning, press the reset button. The “Clean Humidifying Filter” indicator will go off.

When the “Clean Humidifying Filter” Indicator Comes On

1

Remove the water tank and then pull out the water tray. → P.E-9

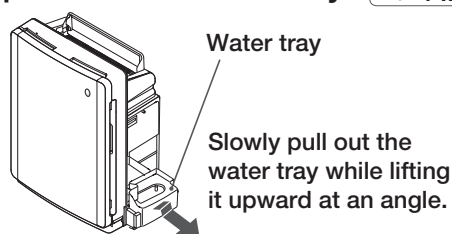

2

Remove the humidifying filter from the water tray.

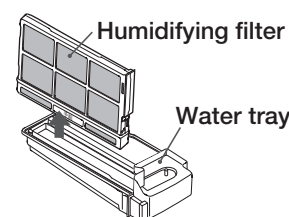

- When you pull out the water tray from the unit, water may spill out or the floor may be scratched by the tray bottom. Lay a soft cloth or similar material beneath the unit to protect the floor.

3

Clean the humidifying filter, water tray and tray cover. → P.E-23, E-24

- When the unit is shaken or rocked, water may gather in a part other than that where the humidifying filter of the water tray is installed. After you pull out the water tray, be sure to remove the tray cover and wipe off any water that exists or clean it.

4

Set the humidifying filter.

- Slowly insert the humidifying filter into the tray cover. Insert the filter fully until it comes into positive contact with the bottom of the tray. Inadequate fitting may cause water to leak during operation.

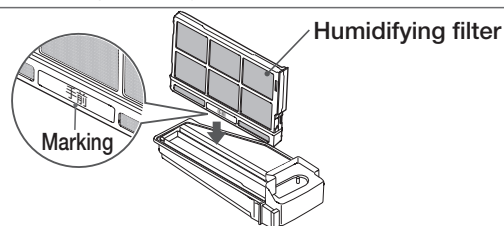

5

Install the water tray, and then mount the water tank.

6

Remove the panel. → P.E-9

7

Plug the power cord into the AC outlet and press the reset button located behind the panel.

- (Use the tip of a ball point pen or similar object.)
- Check that the “Clean” indicator is now OFF.

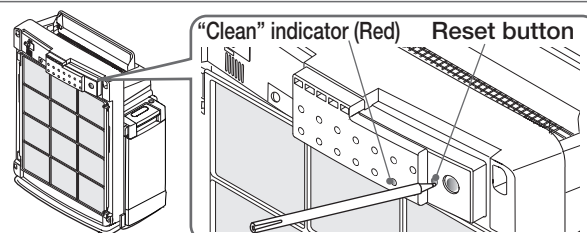

8

Mount the panel on the purifier. → P.E-10

Water Tank (Guide for cleaning: Daily)

- Change water daily with fresh tap water.
- Discard any remaining water in the tank.
- Pour a small quantity of tap water, tighten the cap firmly and shake to wash.
(Change water and repeat the steps twice or three times.)

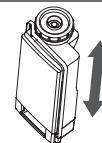

WARNING ● Do not use detergents (for either kitchen or laundry use) for cleaning.



- Do not push in the pin at the center of the cap. Doing so may cause water to leak.
- Be sure to stop operation before removing the water tank from the unit.
- Do not set the water tank without first setting the water tray in place. Otherwise, the water tank may tip over.
- When you remove the water tank, water may drip from the tank cap.

Humidifying Filter (Guide for cleaning: Once a month)

- The humidifying system employed in this product is the evaporating type that produces moisturized air by passing an air stream through the humidifying filter.
- Depending on the application environment, dirt or odor may adhere to the humidifying filter even when the "Humidify" or "Skin Moisturize" mode is not activated.
- When "Humidify" or "Skin Moisturize" mode is used, be sure to pour tap water into the water tank.
- Although the humidifying filter has been treated against bacteria and mold, it may get slimy or moldy, or may become discolored to pink, red, green, brown or gray after a short period of use depending on the quality of tap water used, and the application environment. (Discoloration has no effect on humidifying performance.)
- It is recommended that the filter be cleaned as often as practicable regardless of whether the "Clean Humidifying Filter" indicator lights up or not.
Early replacement of the filter is recommended if it exhibits any of the following conditions despite periodical cleaning.
 - Heavy dirt is present, adhered water scale is difficult to remove, bad odors, serious damage or deformation
- If you do not use the "Humidify" or "Skin Moisturize" mode, drain the water tank and water tray.
Remaining water can be a cause of dirt or discoloration.

Do not disassemble the humidifying filter from its case.

1

Submerge the humidifying filter in either water, lukewarm water or water containing neutral kitchen detergent for 30 minutes or longer.

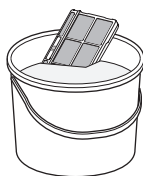

- Do not disassemble the humidifying filter from its case.
- When you use neutral kitchen detergent, follow the instructions provided by the manufacturer.
(Only use neutral kitchen detergent.)

2

Change the water and rinse the humidifying filter by shaking it.
(Repeat the steps 2 or 3 times.)



- When you use neutral kitchen detergent, rinse the filter well to ensure no detergent remains.

3

Shake lightly to drain off water.
(Continue until no more dripping occurs.)



- As you operate the unit, whitish or brownish water scale will adhere to the inside of the water tray or to the surface of the humidifying filter. Water scale is residue minerals from tap water that have not evaporated. If you continue to use the filter without cleaning the water scale, it will solidify and become difficult to remove, resulting in lower humidifying performance.
- Depending on the quality of tap water used, water scale may adhere quickly.
In such a case, clean the filter on a frequent basis.
- When you rinse the humidifying filter, rinse it as assembled with its case. Do not remove the case.
(Removing the case may cause deformation or damage.)
- Do not scrub the humidifying filter with a brush or press forcibly to deform.
(Doing so may cause damage and deterioration in performance.)
- A new humidifying filter may smell at the beginning. This is normal.
- Replace the filter early if it is damaged.



- Washing the humidifying filter with citric acid will deteriorate the anti-bacterial and anti-mold performance.
- Do not install the humidifying filter on the unit if containing too much water. Doing so may cause water to leak.

Cleaning (Continued)

Replacing Humidifying Filter

- The humidifying filter is a consumable part. Replace it using 24 months of use as a guide (cleaning is necessary on a monthly basis).
Early replacement of the filter is recommended if it exhibits any of the following conditions despite periodical cleaning.
 - Heavy dirt, adhered water scale that is too difficult to remove, bad odors, serious damage or deformation
 Depending on the quality of tap water used, the humidifying filter may be consumed extremely early.
- Detach the case and replace the humidifying filter.

Do not dispose of the humidifying filter case.

1 To detach the case, push the tabs (three locations).

Detach the case by opening it in ◀▶ directions.

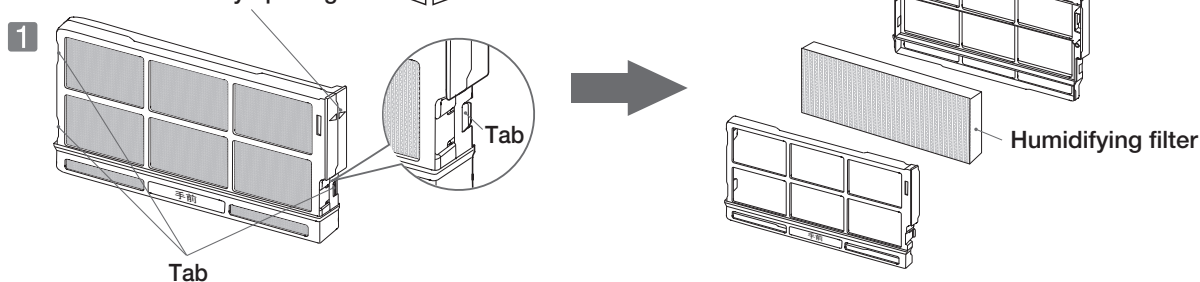

Humidifying filter for replacement
No. EP-DX40E-908

- The humidifying filter is flammable. Dispose of the filter according to local regulations.

Water Tray / Tray Cover (Guide for cleaning: Once a month)

Do not use any detergent.

1 Remove the tray cover.

- Remove the tray cover from the water tray.

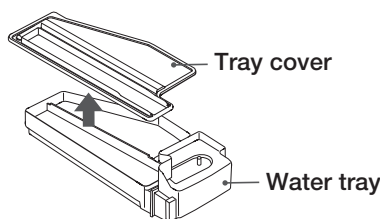

2 Wash with water to remove dirt.

- Drain water remaining on the try.
- Use a cotton swab or toothbrush to remove dirt in narrow parts.

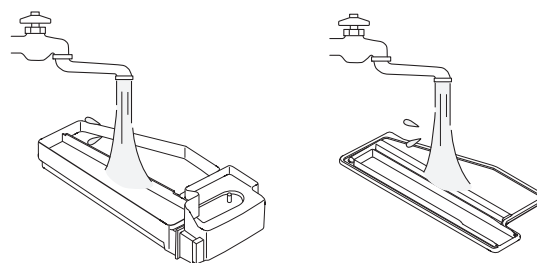

3 Wipe off water and assemble.

- Attach the tray cover to the water tray.

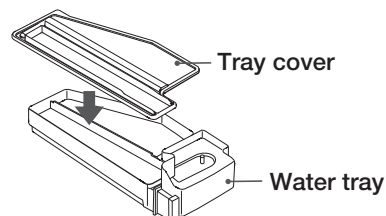

WARNING

- Do not use detergents (for either kitchen or laundry use) for cleaning.



CAUTION

- When you mount the water tray on the unit, the tray should be empty. Otherwise water may spill out.

Pre-filter (Guide for cleaning: Once a month)

● To clean the pre-filter, follow the steps below.

- 1 Remove the water tank, and then pull out the water tray. → P.E-9
(This is to prevent water leakage.)



● When you remove the tank, water may drip from the tank cap. Lay a dry cloth before removing the water tank.

- 2 Remove the panel and pre-filter. → P.E-9

- 3 Clean the filters.

Pre-filter

- Remove dust with a vacuum cleaner etc.
Lightly apply the nozzle brush of the vacuum cleaner and suck up the dust.
- If heavily soiled, do not apply strong force but wash with water using a commercially available soft sponge, drain sufficiently and dry in the shade with a breeze.

CAUTION

- Strongly rubbing with a floor nozzle of a vacuum cleaner or a scourer will cause the stainless coating on the surface to come off.
- Do not use detergent (for kitchen, washing, etc.).

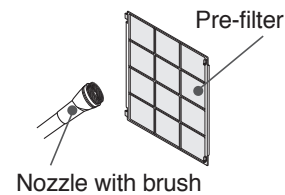

Dust collection/deodorization filter

- If you are concerned about dust on the deodorization and dust collection filters, remove it with a vacuum cleaner and so on.
- Lightly apply the nozzle brush of the vacuum cleaner and suck up the dust.

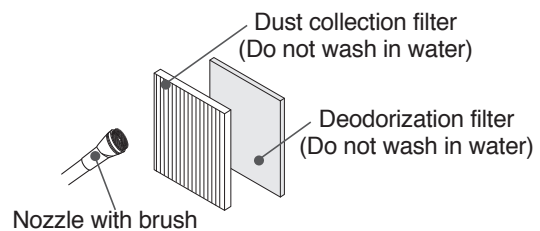

- 4 Attach the deodorization and dust collection filters. → P.E-9, E-10

- 5 Attach the pre-filter and panel to the body. → P.E-10

- 6 Install the water tray, and then mount the water tank. → P.E-12

● The pre-filter is a consumable part.

When pre-filter needs to be replaced due to damage, purchase the replacement part (Part No. EP-JV1000-002).

Cleaning (Continued)

Unit (Guide for cleaning: Once a month)

- For dust, etc. attached to the back of the panel, the odor sensor part, the dust sensor part, the humidity sensor part and the surface of the remote light receiver, suck it up with the nozzle brush of a vacuum cleaner and wipe with a soft cloth.
- When wiping the surface of the panel, use a soft and clean cloth. Since the panel is transparent, wiping with a hard or soiled cloth may result in damage. If the stain remains, soak a soft cloth in dilute neutral kitchen detergent with water and wipe. After removing the stain, wipe off sufficiently so that no detergent remains.
- If it is difficult to remove the stain from the back of the panel, remove the stain using a soft brush.
- For stains on the body, wring a soft cloth soaked with water dry and wipe. If the unit is significantly soiled, soak a soft cloth in dilute neutral kitchen detergent with water and wipe. After removing the stain, wipe off sufficiently so that no detergent remains.
- When oil or chemicals such as insecticide, etc. is attached, clean out on each occasion.
- For dust, etc. attached to the surface of the flap, wipe it off with soft cloth.
- For stains on the remote light receiver, wipe with a narrow cotton swab soaked with a little water and subsequently wipe with a dry cotton swab.

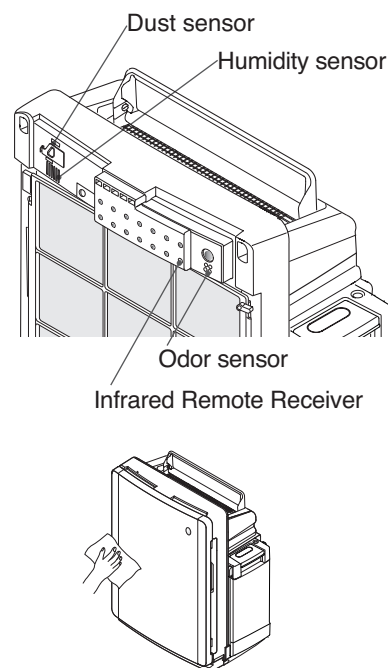

CAUTION

- Do not use anything other than neutral kitchen detergent. Otherwise cracking, discoloration, damage or scratches to the panel surface may be caused.

Dust sensor (Cleaning guide: every 3-6 months)

- Carry out periodical cleaning every 3-6 months. Otherwise the performance of the dust sensor will drop.

1

Remove the dust sensor cover.

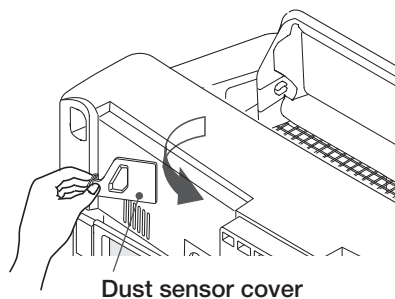

2

Wipe the lens with a cotton swab.

- Soak a cotton swab with a little water and use it to wipe off any heavy dirt.
- After cleaning the dust sensor, reinstall the dust sensor cover.

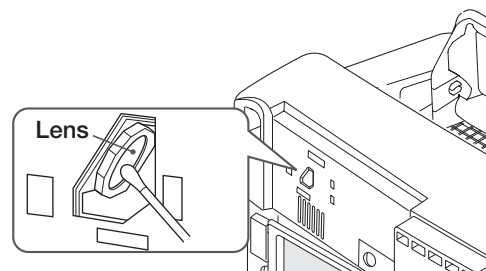

CAUTION

- Do not wipe the lens forcibly. Doing so may cause damage.
- Do not forcibly disengage and engage the tabs of the dust sensor cover. Doing so may cause damage.

Filter Replacement

Replacement Interval

- The filters are consumable items parts. The standard life of the dust filter is approximately 8 years, and that of the deodorizing filter is approximately 10 years. Testing was conducted according to JEM1467 of the Japan Electric Machine Industry Association. If 5 cigarettes are smoked per day:
[Dust filter] Years until the air purifying time is double that of when the filter is new
[Deodorizing filter] Years until the deodorizing rate is reduced by half compared to when the filter is new
- The dust filter should be replaced early if its color resembles any of the colors on the dirtiness label attached to the unit.
 - The colors on the dirtiness label are shown as a guide only. Depending on the installation location, the actual color of the contaminated filter may differ from the color shown on this label.

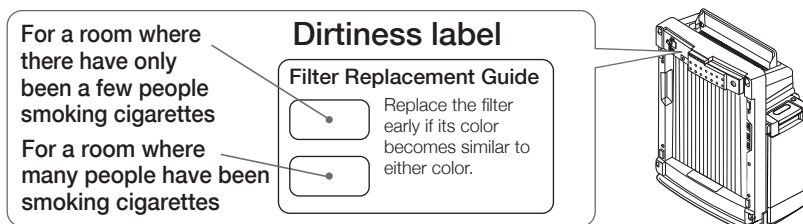

- For the deodorizing filter replacement interval, use approximately 10 years as a guide. Replace the filter earlier when the filter performance is degraded.
- The filter may need to be replaced earlier depending on the installation location and conditions of use. When it becomes difficult to remove dirt or odor, replace the filter earlier than suggested. Otherwise, the filter may generate odors.
- The filter should be replaced earlier in the following cases.
 - When the purifier intakes oily smoke, carbon substances (soot), etc. or when the smell of new building materials remains after a new house has been built or the house has been remodeled.
 - When used in stores, such as in coffee shops, game parlors, barber shops, beauty parlors, or in offices or hotels and inns.
 - When the purifier intakes large amounts of cigarette smoke.
 - When the purifier intakes combustion gases generated by heating appliances.
 - When the purifier intakes solvent content of paint, adhesive, etc.
 - When used in dusty locations near roads subject to heavy traffic.

Precautions regarding Filter Handling

- Be sure to take the filter out of the plastic bag before use.
 - Do not set the filter when it is still in a plastic bag. Otherwise, a malfunction may occur.
- Avoid handling it roughly.
 - Do not crush, knead or roll the filter.
Once the filter is broken, it will not have any cleaning effect.
- Do not wash the filter.
 - The filter is not washable for reuse. Purchase a new filter for replacement.
- The filter contains plastics. Dispose of the filter according to local regulations.

Filter Replacement (Continued)

Replacing the Filter

■For the filters, use the optional EP-A6000-902 (dust filter) and EP-A6000-903 (deodorizing filter).



●Use a genuine filter for the Hitachi Air Purifier.
Other filters may cause unit failure.

■Before replacing the filter, be sure to stop the purifier and unplug the power cord from the AC outlet.

- 1 Remove the water tank and then pull out the water tray. →P.E-11
(This is to prevent water leakage.)



●When you remove the water tank, water may drip from the tank cap.
Lay a dry cloth before removing the water tank.

- 2 Remove the panel and the pre-filter. → P.E-9

- 3 Remove the used filter.

●Remove the dust filter and then the deodorizing filter.

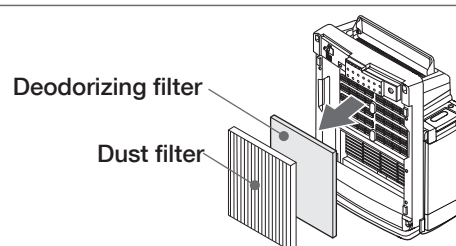

- 4 Take a new deodorizing filter out of its plastic bag and install it on the purifier. → P.E-8

- Install the deodorizing filter so that its black surface faces the front (white surface in the back).
- Insert the filter all the way until the label (deodorizing filter position indicator) is hidden.



- Be sure to take the filter out of the plastic bag.
- Do not block the front face of the filter with cloth or paper.
- The same precautions should also be followed for the dust filter.

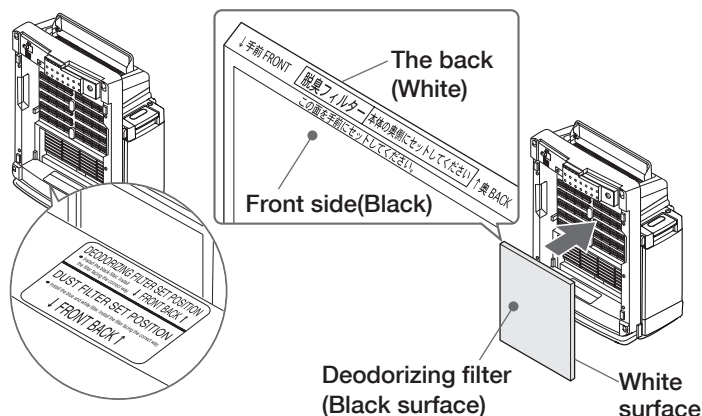

- 5 Take a new dust filter out of its plastic bag and install it on the purifier.

→ P.E-9

- 1 Insert the filter all the way until the label (dust filter position indicator) is hidden.
- 2 Install the pre-filter on the purifier.

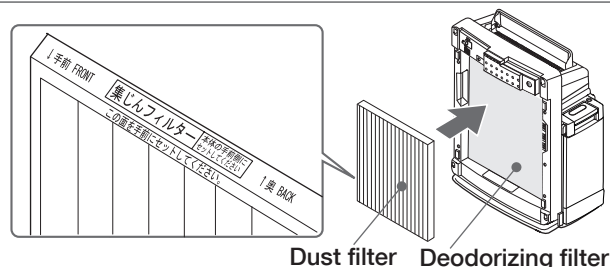

- 6 Reinstall the panel on the purifier. →P.E-10

- 7 Install the water tray, and then mount the water tank. →P.E-12

Note

●No cleaning effect can be expected if the filter is inserted while still inside the plastic bag.
This may also cause a malfunction.

Alert Display

Symptom	Cause
All airflow indicators ~ ≈ ≐ are blinking.	Faulty fan rotation.

Stop the operation, unplug the power cord from the AC outlet and contact your dealer for service.

Troubleshooting Guide

Before asking for repair

Check the following again

Symptom	Check to see	Solution
No air blows out or no power is supplied	<ul style="list-style-type: none"> ● Is power plug securely inserted into the AC outlet? ● Is the breaker switched off? 	<ul style="list-style-type: none"> Securely insert the power plug into the AC outlet. Switch on breaker.
Smoke or smells are not efficiently removed, or there is an odor	<ul style="list-style-type: none"> ● Is the pre-filter very dirty? ● Is the filter dirty? 	<ul style="list-style-type: none"> Clean the pre-filter, referring to the “Pre-filter” in “Cleaning”. → P.E-25 Replace the filter, referring to the “Filter Replacement”. The filter may need to be replaced earlier depending on the installation location and conditions of use. → P.E-27
No remote operation	<ul style="list-style-type: none"> ● Are battery polarities correct? ● Are batteries dead? ● Is the remote infrared receiver dirty? 	<ul style="list-style-type: none"> Insert the batteries with correct polarities. → P.E-11 Replace the batteries. → P.E-11 Clean the remote infrared receiver. → P.E-26
Airflow rate does not decrease even though the air is clean	<ul style="list-style-type: none"> ● Has airflow rate been switched? ● Is the operation in the “Humidify” mode? ● Is sensor sensitivity high? 	<ul style="list-style-type: none"> Press the airflow button and select Auto Sensor or another airflow rate. → P.E-15,E-18 Airflow rate will not decrease when humidity is low. Change the sensor sensitivity setting. → P.E-20
Airflow rate does not increase even though the air is contaminated	<ul style="list-style-type: none"> ● Has airflow rate been switched? ● Is the odor sensor hole blocked by dust or other obstacles ? ● Is sensor sensitivity low? ● Was the ambient air clean when the unit power cord was plugged into the AC outlet? 	<ul style="list-style-type: none"> Press the airflow button and select Auto Sensor or another airflow rate. → P.E-15,E-18 Clean the odor sensor. → P.E-26 Change the sensor sensitivity setting. → P.E-20 Change the airflow rate. Or open a window and plug the power cord into the AC outlet when ambient air is clean. → P.E-19
“Air Sensor” indicator remains constantly lit in green	<ul style="list-style-type: none"> ● Is the unit installed in a location away from odor or dust? ● Is the odor sensor hole blocked by dust or other obstacles ? 	<ul style="list-style-type: none"> Relocate the air unit. Clean the odor sensor. → P.E-26
“Air Sensor” indicator is kept blinking in green.	<ul style="list-style-type: none"> ● Is the dust sensor covered with dust? ● Is the odor sensor hole blocked by dust or other obstacles ? 	<ul style="list-style-type: none"> Clean the dust sensor. Clean the odor sensor. → P.E-26

Troubleshooting Guide (Continued)

Symptom	Check to see	Solution
“Air Sensor” indicator is kept blinking in green.	<ul style="list-style-type: none"> ● Is there anything nearby that the odor sensor might detect? <ul style="list-style-type: none"> • Any appliance generating combustion gas • Alcohol, cosmetics, sprays, etc. 	The Purifier may detect components of invisible gas that cannot be cleaned by the filter and continue operation. Ventilate the room by opening windows, etc. → P.E-19
	<ul style="list-style-type: none"> ● Is the odor sensor hole blocked by dust or other obstacles? 	Clean the odor sensor. → P.E-26
	<ul style="list-style-type: none"> ● Is there water in the water tank? 	Fill the water tank with water. → P.E-12
No humidifying effect	<ul style="list-style-type: none"> ● Is the operation in any of “Air Purify”, “Pollen” or “Strong Deodorization” mode? 	Change the operation mode to “Humidify” or “Skin Moisturize” mode. → P.E-15
	<ul style="list-style-type: none"> ● Is the humidifying filter dirty? 	Clean or replace the humidifying filter, referring to the “Humidifying Filter” in “Cleaning”. → P.E-23
Humidifying performance is inadequate when operated in “Humidify” mode	<ul style="list-style-type: none"> ● Is the airflow rate set to “Auto”? 	Depending on the installation location and conditions of use, water may not be consumed. Set the operation mode to “Skin Moisturize” and the airflow rate to “High” or “Max”. → P.E-15, E-16
	<ul style="list-style-type: none"> ● Is the pre-filter or the filter dirty? 	Clean the pre-filter, referring to the “Pre-filter” in “Cleaning”. → P.E-25
	<ul style="list-style-type: none"> ● Is the humidifying filter set properly, or is it dirty? 	Set the humidifying filter correctly. If it is dirty, clean or replace it. → P.E-22-E-24
When operated in “Air Purify”, “Pollen” or “Strong Deodorization” mode, air is humidified	<ul style="list-style-type: none"> ● Is there water in the water tank and water tray? 	Discharge water and then operate.
	<ul style="list-style-type: none"> ● Is the humidifying filter wet with water? 	Drain the humidifying filter.
Water leaks	<ul style="list-style-type: none"> ● Is the water tank set correctly? 	Set the water tank correctly. → P.E-12
	<ul style="list-style-type: none"> ● Is the tank cap closed firmly, or is the tank cap packing set securely? 	Close the tank cap firmly. → P.E-11
	<ul style="list-style-type: none"> ● Is the water tray cover closed properly? 	Close the water tray cover correctly.
	<ul style="list-style-type: none"> ● Is the humidifying filter set securely? 	Set the humidifying filter securely. → P.E-22
	<ul style="list-style-type: none"> ● Is the unit tilted, or was it carried with water in the tank? 	Place the unit on a level, stable surface. Avoid carrying the unit with water in the tank.
	<ul style="list-style-type: none"> ● Is there any opening in the water tank or water tray? 	Stop using the unit immediately and contact your dealer for repairs.
	<ul style="list-style-type: none"> ● Is there any leakage from the water tank? 	Stop using the unit immediately and contact your dealer for repairs.
Indicator is dim	<ul style="list-style-type: none"> ● Has the dimmer control been activated? 	Cancel the dimmer control setting. → P.E-21
The “Clean Humidifying Filter” indicator does not go off	<ul style="list-style-type: none"> ● Was the reset button pressed after cleaning? 	Press the reset button. → P.E-22

Following Conditions Are Normal

Noise/vibration

Symptom	Cause
Snapping noise sounds when plugging power cord into the AC outlet.	It is because electric components are energized when power is supplied. This is normal.
Unit vibrates during the “Max” operation.	Vibration is caused by fan rotation. This is normal.
Bubbling noise	The noise is produced by air bubbles when water in the water tank is supplied to the water tray. This is normal.
Clicking noise sounds during operation.	This is a switching sound of the shutter. This is normal.

Heat/odor

Symptom	Cause
The wind coming out of the outlet smells.	When first using, the odor of the parts inside the body may be noticeable. Otherwise, the deodorization performance of the filter has declined. → P.E-27 Or, odor may have contaminated the humidifying filter. Clean the humidifying filter. → P.E-22-E-24
The remote control or the remote control receiving part is warm.	The control substrate is built into the body. Therefore, the remote control or remote control receiving area may get warm.

Operation/other



Symptom	Cause
No vapor or mist visible	As the unit employs an evaporation system that produces moisturized air by passing an air stream through the humidifying filter, no vapor or mist is visible. This is normal.
Humidity level indication differs from hygrometer reading.	Humidity level is indicated as a guide only. Also, differences in the environment in different parts of the room may cause different indications.
Shutter is stopped midway.	Performance is not affected even if the shutter is not fully opened. This is normal.
Water surface in the water tank waves.	This is caused by vibration during operation. This is normal.
Unit indicators repeatedly turn on and off one after another, and the fan is stationary.	The unit is in demo mode. Unplug the power cord once, wait for a few seconds, and then insert the power plug into the AC outlet.
Pressing the eco button operates the ionization setting / release of the other Hitachi air purifier with ionizing function. Pressing the ionizing button on the remote controller for the other Hitachi air purifier with ionizing function operates the setting / release of eco operation.	Because the signals from the remote controllers are the same, both functions respond. This is normal.

Troubleshooting Guide (Continued)

Operation/other

Symptom	Cause
The fan is stopped.	When the eco operation is selected, the fan may stop. → P.E-21
The humidifying filter clean lamp lights up although the humidification function was not used.	When the power plug has been inserted into the AC outlet for about 1 month (about 720 hours), the lamp lights up. → P.E-22

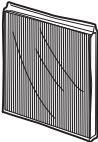
Replacement Parts (Separately Available)

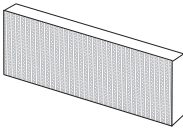
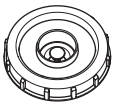
●Dust Filter Designate the replacement part No. EP-A6000-902 when ordering. 	●Deodorizing filter Designate the replacement part No. EP-A6000-903 when ordering. 
●Pre-filter Designate the replacement part No. EP-JV1000-002 when ordering. 	●Humidifying Filter Designate the replacement part No. EP-DX40E-908 when ordering. The case is not included. 
●Tank Cap Designate the replacement part No. EP-JV700-005 when ordering. 	

Specifications

Model	EP-A8000			
Power supply	AC220-240V 50-60Hz			
Airflow switching	Max	High	Medium	Silent
Power consumption (W)	70	22	14	4
Airflow rate (m ³ /min)	7.5	4.5	3.4	1.0
Applicable floor space	55m ²			
Humidifying performance (mL/h)	Approx. 670 (Max operation)			
External dimensions	584(H) x 430(W) x 268(D) mm			
Weight	10kg			
Length of power cord	Approx. 1.8m			