



Package Contents

(Please contact Sans Digital in case of missing or damaged items.)

Included

- MR5S1/ MR5CT1 unit..... 1
- RS232 cable..... 1
- Removable Tray..... 5
- Power cord..... 1
- Tray Key..... 2
- Screws..... 32
- User's Manual..... 1

MR5S1 Only

- SCSI cable..... 1
- Terminator..... 1

MR5CT1 Only

- 1394b cable..... 1
- USB cable..... 1
- eSATA cable..... 1

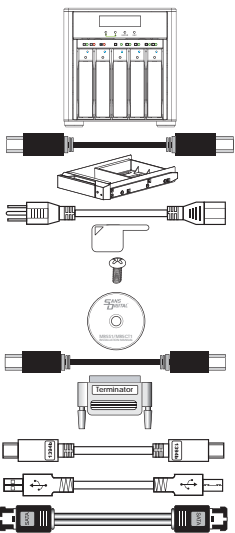

Installing HDD in the Removable Tray

- 1. Demount the plastic tray protector.
- 2. Mount the HDD into the tray.

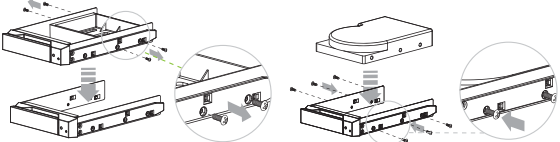

⚠ If the screws are not properly fastened the hard disk may be pushed towards the back of the unit & the tray handle will not open properly.

Hardware Diagrams

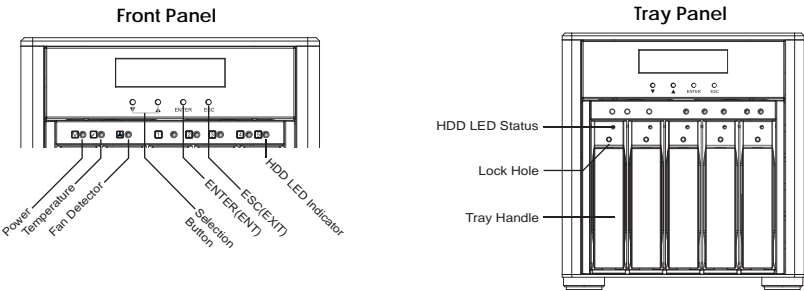

MR5S1 Host Connection

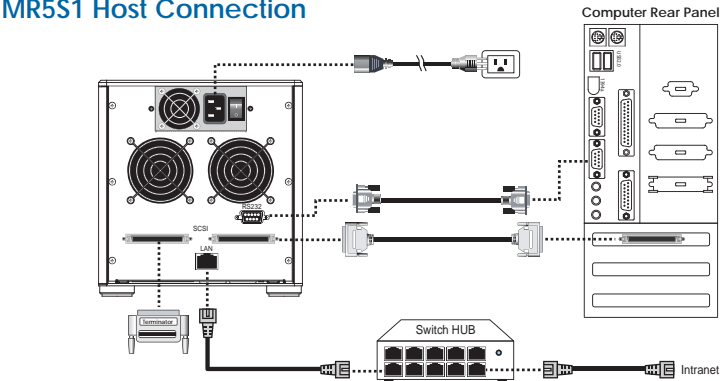

⚠ Please connect the SCSI terminator before setting up the MR5S1 or the device will not be detected.
• For Quick Installation the SCSI ID default is 0, however, if you need to change this please refer to the User's Manual on the CD.

MR5CT1 Host Connection

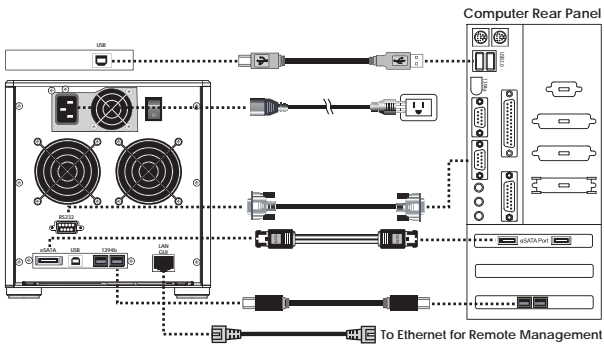

⚠ Please make sure Channel Setting is set to Channel 1 or Channel 0+1 once Volume Set has been created. USB 2.0, 1394b and eSATA connections utilize Channel 1 setting.

Quick Volume / RAID Setup

Quick Volume and RAID Setup are the fastest ways to prepare a RAID set and volume set. You only need a few simple keystrokes to complete. Although disk drives of different capacities may be used in the RAID set, the MR5S1/ MR5CT1 will use the smallest capacity of the disk drive as the capacity of all disk drives in the RAID set.

- The Quick Volume and RAID Setup option creates a RAID set with the following properties :
- 1. All of the physical disk drives are contained in a RAID set.
 - 2. The RAID levels associated with hot spare, capacity, and stripe size are selected during the configuration process.
 - 3. A single volume set is created and consumes all or a portion of the disk capacity available in this RAID set.

(Please See the Diagram on Next Page)

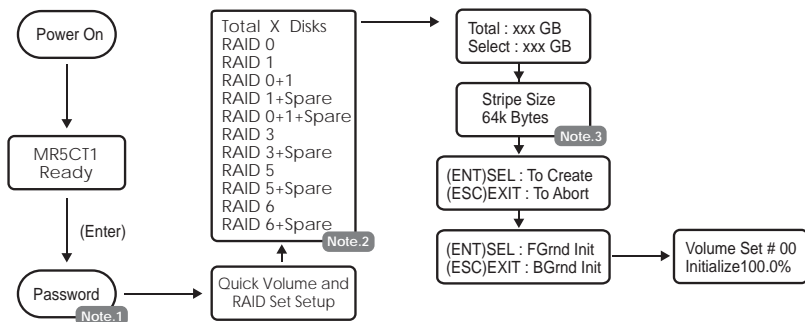

⚠ The MR5S1/MR5CT1 does not set a default RAID level, please set your desired RAID level after the device boots up. When setting the RAID level, please make sure that all hard disks inside the unit display a

Note 1: Password:0000

Note 2: The number of physical drives in a specific RAID set determines the RAID levels that can be implemented with the RAID set.

	RAID 0	RAID 1	RAID 1 +Spare	RAID 3	RAID 3 +Spare	RAID 5	RAID 5 +Spare	RAID 6	RAID 6 +Spare
Minimum # of Physical Drives Required Per RAID Set	1 or more	2 or more	3 or more	3 or more	4 or more	3 or more	4 or more	4 or more	5 or more

Note 3: Stripe size default is 64k, it can adjust to 4k or 128k mode under stripe size.

Note 4: Please refer to the enclosed CD for the detail user's manual.

Note 6: For Remote Management the IP address will be displayed in the LCD Display located on the front of the unit. The default use name & default password is:

Note 6: For Remote Management the IP address will be displayed in the LCD Display located on the front of the unit. The default use name & default password is:

User Name: admin Password: 0000

Other Sans Digital Products



- 3.5" Hard Drive Enclosure with Removable Tray
- Dual host interface: USB 2.0 and eSATA.
- Supports High Performance SATA hard drives.
- Ultra quiet operation.
- Vertical placement stand included.
- Durable aluminum housing.
- Supports both Windows and Mac OS X.



- 2-Bay External RAID Enclosure
- Hardware RAID design, supporting RAID 0, 1, JBOD, BID, SAFE33, and SAFE55, with eSATA and USB 2.0 interfaces.
- Drive Interface: 3.5" x 2 SATA I/ SATA II hard drives.
- Hot-swappable removable tray.
- Data auto-rebuilding.
- Hard drive, fan and temperature failure detectors.



- 4-Bay External RAID Enclosure
- Support JBOD for independent access up to four hard drives.
- 1394b x 2 (MS4B), eSATA x 4 (MS4T), USB 2.0 & Port Multiplier (MS4UM).
- Drive interface: 4 x 3.5" SATA I/ SATA II hard drives.
- RAID supported in MS4B (RAID 0) and MS4UM (software RAID 0, 1, 0+1, 5, 5 + spare in Windows).
- OS independent with plug and play capability.



- 5-Bay External RAID 6 Enclosure
- Hardware RAID design, supports RAID 0, 1, 0+1, 3, 5, 6, JBOD & hot spare disk.
- SCSI Ultra 320 (MR5S1)/ USB 2.0, Firewire 800 and eSATA (MR5CT1).
- Drive interface: 5 x 3.5" SATA I / SATA II hard drives.
- Hot-swappable tray design.
- Hard disk, fan and temperature failure detectors.

T: 1.800.980.1988 F: 1.562.949.3328 E: INFO@SANSDIGITAL.COM W: WWW.SANSDIGITAL.COM