



User Manual

Spend a little Live a lot.

GUIDE

EASY
HOME

HAIR GROOMING KIT WITH RECHARGEABLE BATTERY/ MAINS MODE



Product Info



www.aldi.co.uk

+ VIDEO

QR codes take you where you want to go quickly and easily

Whether you require **product information**, **spare parts** or **accessories**, details on **warranties** or **aftersales services**, or if you want to watch a **product demonstration video**, our QR codes will take you there in no time at all.

What is a QR code?

A QR code (QR = Quick Response) is a type of matrix that can be read with a smartphone camera and that contains a link to a website or contact details, for example.

Advantage: You do not need to manually enter a website address or contact details.

This is how it works

To scan the QR code, all you need is a smartphone with QR code reader software and an internet connection.* This type of software can be downloaded for free from your app store.

Try it out now

Just scan the QR code with your smartphone and find out more about the Aldi product you have purchased.*

Your Aldi Service Portal

All details mentioned above can also be found in the Aldi Service Portal at www.aldi.co.uk.



* Depending on your tariff plan you may be charged for the connection.

Contents

Overview	4
Use.....	5
Scope of delivery/device parts	6
General information	7
Reading and storing the instruction manual	7
Explanation of symbols	7
Safety	10
Proper use	10
Safety notes	10
First use	17
Checking the hair grooming kit and product contents	17
Setting up the charging station	18
Charging the hair grooming kit	18
Operation	20
Using the hair grooming kit in mains operation.....	20
Selecting comb adapters	21
Mounting and changing comb adapters	22
Cutting hair	23
Thinning hair	24
Cutting contours and beards.....	24
Cleaning and care	25
Cleaning the charging station.....	26
Cleaning the comb adapters	26
Cleaning and oiling the hair trimmer adapter	26
Troubleshooting	28
Storage	29
Technical data	30
Declaration of conformity	31
Disposal	31
Disposing of the packaging	31
Disposing of the hair grooming kit.....	31
Warranty Card	33
Warranty conditions	34

A

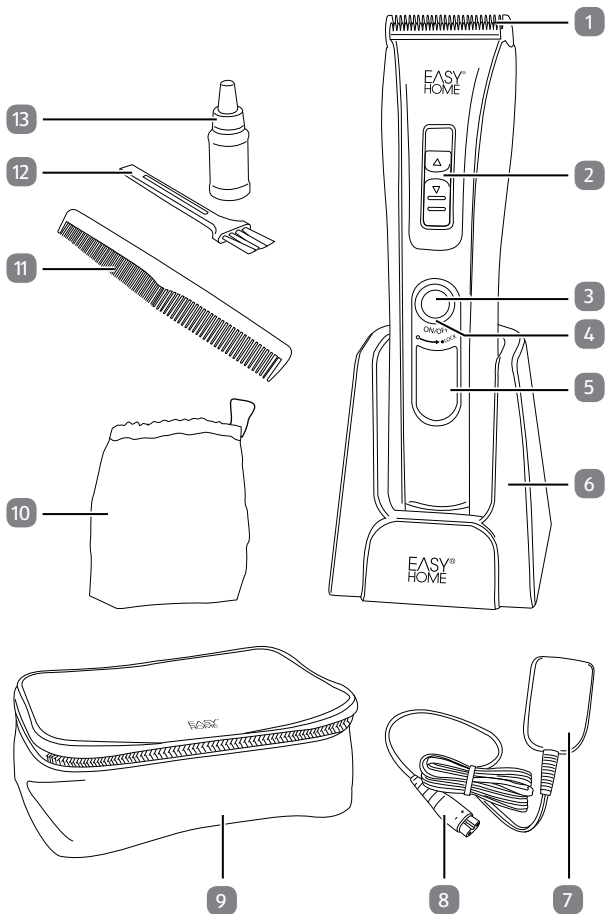

B

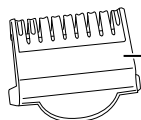

14

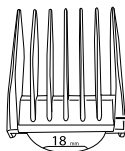

18

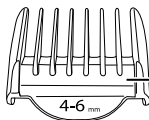

15

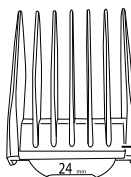

19

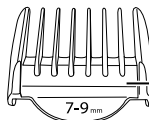

16

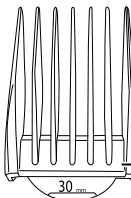

20

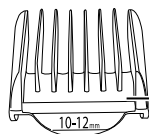

17

C

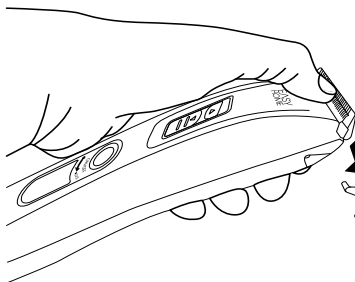

1

Product contents/device parts

- 1 Hair trimmer adapter
- 2 Slide control for the fine adjustment
- 3 "ON/OFF" button
- 4 Switch lock
- 5 Display
- 6 Charging station
- 7 Power supply unit
- 8 Device plug of the power supply unit
- 9 Storage bag
- 10 Storage bag for comb adapters
- 11 Comb
- 12 Brush
- 13 Clipper oil
- 14 Protective cap or thinning adapter
- 15 4 – 6 mm comb adapter
- 16 7 – 9 mm comb adapter
- 17 10 – 12 mm comb adapter
- 18 18 mm comb adapter
- 19 24 mm comb adapter
- 20 30 mm comb adapter

General information

Reading and storing the instruction manual



This instruction manual accompanies this hair grooming kit with rechargeable battery/mains mode. It contains important information on start-up and handling.

For improved readability, the hair grooming kit with rechargeable battery/mains mode will be referred to only as the “hair grooming kit” below.

Before using the hair grooming kit, carefully read through the instruction manual, especially the safety notes. Non-observance of this instruction manual may cause damage to the hair grooming kit.

The instruction manual is based on the standards and rules in force in the European Union. When abroad, you must also observe country-specific guidelines and laws.

Store the instruction manual for future use. If you pass the hair grooming kit on to third parties, please be absolutely sure to include this instruction manual.

Explanation of symbols

The following symbols and signal words are used in this instruction manual, on the hair grooming kit or on the packaging.

⚠ WARNING!

This signal word designates a hazard with moderate degree of risk which may lead to death or severe injury if not avoided.

⚠ CAUTION!

This signal key word indicates a hazard with low risk that, if not avoided, may result in minor or moderate injury.

NOTICE!

This signal word warns against potential damages to property.



This symbol provides you with useful additional information regarding operation or handling.



Declaration of conformity (see chapter “Declaration of conformity”): Products marked with this symbol meet all applicable Community regulations for the European Economic Area.



The Intertek seal confirms that the switching power supply of this hair grooming kit is safe if used as foreseeable.



This symbol identifies electric devices corresponding to protection class II.



This symbol identifies electric devices corresponding to protection class III.



Products marked with this symbol may only be operated in indoor areas.



The hair grooming kit is equipped with a short-circuit proof safety transformer.



The device marked with this symbol features a switching power supply.

IPXX

This information classifies electric and electronic components into IP codes and indicates in which environmental situations the components can be used (see chapter “Technical data”).

Safety

Proper use

The hair grooming kit is exclusively designed for cutting dry, human hair. The hair grooming kit is only intended for private use and is not suitable for commercial purposes. It may only be used in indoor areas. The hair grooming kit is not suitable for artificial or animal hair.

Only use the hair grooming kit as described in this instruction manual. Any other use is considered improper and may result in damage to property.

The manufacturer or vendor accepts no liability for damage caused by improper or incorrect use.

Safety notes



Risk of electric shock!

A faulty electrical installation, improper handling or excessive mains voltage may result in an electric shock.

- Only connect the hair grooming kit to a socket whose mains voltage corresponds to the nameplate specification.
- Only connect the power supply unit to an easily accessible socket so that you can

quickly disconnect the hair grooming kit from the mains in the event of a fault.

- If the power supply unit, cord or hair grooming kit exhibit visible damages or are defective, do not operate the hair grooming kit.
- If the mains cord of the hair grooming kit is damaged, the manufacturer, its customer service team or a person with similar qualifications must replace it to avoid risks.
- Only use the hair grooming kit with the enclosed power supply unit.
- Do not open the housing; instead, have a qualified professional perform the repairs. Contact the service address provided on the warranty card. Liability and warranty claims are waived in the event of repairs performed by the user, improper connection of the device or incorrect operation.
- Only parts that comply with the original device data may be used for repairs by qualified technicians. Electrical and mechanical parts, which are essential for providing protection against sources of danger, are located in this device.
- Do not immerse the hair grooming kit, the power supply unit or mains cord in water or

other liquids.

- Keep the hair grooming kit away from moisture, dripping water and splash water.
- Never touch the power supply unit with damp hands.
- Always take hold of the power supply unit when removing it from the socket. Never pull on the cable to do so.
- Only connect the power supply unit to the socket if the hair grooming kit is connected with the device plug.
- Keep the hair grooming kit, the power supply unit and the cable away from open flames and hot surfaces.
- Lay the cable so that it does not pose a tripping hazard.
- Do not kink the cable and do not lay it over sharp edges.
- Only use the hair grooming kit indoors. Never operate it in wet rooms or in the rain.
- Never store and use the hair grooming kit such that there is a risk of it falling into a tub or a basin.
- If the hair grooming kit or charging station have fallen in water, never attempt to grab it. In such a case, immediately disconnect

the power supply unit from the socket and stop using the hair grooming kit or charging station. Have the hair grooming kit checked by qualified professionals.

- Make sure that children do not insert any objects in the hair grooming kit.
- Turn the hair grooming kit off and pull the power supply unit out of the socket
 - after each use,
 - after the charging process is complete,
 - if a fault occurs,
 - before you connect the charging station with the power supply unit cable,
 - before you clean the hair grooming kit and the charging station and
 - in the event of a storm.

WARNING!

Risk of explosion and fire!

Improper handling of the rechargeable battery poses an increased risk of explosion and fire.

- Protect the rechargeable battery against mechanical damage.
- Never expose the rechargeable batteries to excessive heat such as sunlight, fire or

similar. The ambient temperature should not fall below or exceed 5 – 35 °C.

- Do not use metallic objects to connect the charging contacts on the hair grooming kit.
- Only use the original accessories for the charging process.
- Only use the charging station with the enclosed hair trimmer.

⚠ WARNING!

Danger for children and persons with impaired physical, sensory or mental capacities (e.g. partially disabled persons, older persons with reduced physical and mental capacities) or lack of experience and knowledge (e.g. older children).

- This hair grooming kit may be used by children ages eight and over as well as persons with impaired physical, sensory or mental capacities or those lacking experience and knowledge if they are supervised or have been instructed in how to safely use the hair grooming kit and have understood the risks associated with operating it. Children may not play with the hair grooming kit.

Cleaning and user maintenance must not be performed by unsupervised children.

- Keep children under eight years of age away from the hair grooming kit, power supply unit and cable.
- Do not leave the hair grooming kit unattended while in operation.
- Do not allow children to play with the packaging wrapper. They may get caught in it when playing and suffocate.
- Do not allow children to play with the small parts. They could swallow them and suffocate.

⚠ CAUTION!

Risk of injury!

Handling the hair grooming kit improperly may result in injury.

- Do not use the hair grooming kit in the presence of open wounds, cuts, sun burns or blisters.
- Never use the hair grooming kit if the hair trimmer adapter is not firmly mounted.
- Be careful with the hair trimmer adapter. It has pointy edges.

- Carefully mount the adapters on the hair grooming kit. Pay attention to your fingers. There is a crushing hazard.

CAUTION!

Risk of chemical burns!

Damaged rechargeable batteries, which leak as a result, can inflict chemical burns if they come into contact with your skin.

- Never open the rechargeable battery.
- Be absolutely sure to wear protective gloves if the rechargeable battery has leaked.

NOTICE!

Risk of damage!

Improper handling of the hair grooming kit may result in damage to the hair grooming kit.

- To prevent overheating, do not cover the power supply unit.
- Do not let the hair trimmer fall down.
- If the rechargeable battery is defective, do not attempt to recharge the hair grooming kit and do not continue to use the hair

grooming kit in mains operation. The hair grooming kit may overheat in the process. Have the hair grooming kit available re-paired.

First use

Checking the hair grooming kit and product contents

NOTICE!

Risk of damage!

If you are not cautious when opening the packaging with a sharp knife or other pointy object, you may quickly damage the hair grooming kit.

– Therefore, be very careful when opening.

1. Take the hair grooming kit out of the packaging.
2. Check whether the delivery is complete.
(see **fig. A and B**).
3. Check whether the hair grooming kit or the individual parts exhibit damage. If this is the case, do not use the hair grooming kit. Contact the manufacturer at the service address specified on the warranty card.
4. Remove the packaging material and all protective foils.

Setting up the charging station

NOTICE!

Risk of damage!

If you do not set up the charging station properly, the charging station, along with the hair grooming kit, may fall over and be damaged as a result.

- Place the charging station on a level, dry and non-slip surface.
1. Connect the device plug **8** with the charging station **6**.
 2. Insert the power supply unit in a properly installed socket that is easily accessible.

Charging the hair grooming kit

NOTICE!

Risk of damage!

For technical reasons, prolonged periods of storage and interruptions to the charging and discharging cycles reduce the capacitance of the rechargeable battery.

- Avoid prolonged periods of storage.

- Avoid interrupting the charging and discharging cycles.



- When the capacitance of the rechargeable battery is very low, the display will turn red and the plug icon will blink.
- The charging time for fully charging the rechargeable battery amounts to approx. 1.5 hours.
- The operating time with a fully charged rechargeable battery amounts to approx. 70 minutes.
- This hair grooming kit can also be quick charged. This takes 5 minutes. In this case, the operating time also amounts to 5 minutes.

1. Place the hair grooming kit on the charging station **6** to establish the charging contact.

The display **5** will turn red and indicate the current charge status.



- The display will turn blue once the charge status has reached a capacitance of 10 %.
- The rechargeable battery has been fully charged when the display shows a charge status of 100 %.

2. Once the rechargeable battery is fully charged, disconnect the power supply unit **7** from the socket.

The indicator on the display will disappear after you have pulled the power supply unit out of the socket or taken the hair grooming kit out of the charging station.

Operation

Using the hair grooming kit in mains operation



The oil bottle symbol will appear briefly on the display when you switch on the hair grooming kit. This serves as a reminder to clean the hair grooming kit regularly and also to oil the hair trimmer adapter regularly.

You can use the hair grooming kit at any time in mains operation regardless of the charge status of the rechargeable battery. To do so, proceed as follows:

1. Make sure that the hair grooming kit is switched off.
2. Connect the device plug **8** with the hair grooming kit.
3. Insert the power supply unit **7** in a properly installed socket that is easily accessible.
4. Turn the switch lock **4** to the left so that it points towards **0**.
5. Switch the hair grooming kit on by pushing the On/Off button **3** ("ON").

The mains icon will appear on the display.

6. Cut your hair as described in the section “Cutting hair”.
7. To switch the hair grooming kit off, push the On/Off button again **3** (“OFF”).



If the hair grooming kit is inadvertently locked with the switch lock during use, it can no longer be switched off. In this case, turn the switch lock back to the left so that it points to **O**.

8. To prevent the device from accidentally switching on when not in use, turn the switch lock to the right so that it points to **•LOCK**.

Selecting comb adapters

Select the comb adapters according to your desired cut length.

The cut lengths of the comb adapters **15** **16** and **17** are variable. You can adjust the cut length with the slide control for fine adjustment:

Level of the slide control	Position of the slide control
0	in the lowest position
3	in the topmost position

- To increase the cut length for the comb adapter, push the slide control **2** to the “0” setting.
- To decrease the cut length for the comb adapter, push the slide control to the “3” position.



Fine adjustment has barely any effect for large cut lengths (comb adapters **18** **19** and **20**). Therefore leave the slide control in the “0” position.

Mounting and changing comb adapters

CAUTION!

Risk of injury!

Handling the hair grooming kit improperly may result in cut injuries.

- Switch the hair grooming kit off before you mount or change the comb adapters.
1. To mount a comb adapter **14** – **20**, attach it to the hair trimmer adapter **1** and carefully push the bottom part into the recesses on the side of the hair grooming kit until the comb adapter locks into place.
 2. To remove or change the comb adapter after use, pull the comb adapter off of the hair grooming kit by the side bars.

Cutting hair



- The hair you intend to cut must be dry.
- The length of the cut may vary depending on the trimming angle.
- It is recommended you begin with a comb adapter for a longer cutting length and then use progressively shorter cutting lengths as you progress with the haircut.

1. Thoroughly comb your hair.
2. To prevent hair clippings from falling down the collar, place a cloth or gown around the throat and neck.
3. Begin the haircut on the neck or the sides and cut towards the middle of the head.
4. In the process, hold the hair grooming kit so that the flat side of the comb adapter is on the head and run the hair grooming kit evenly through the hair.



- If possible, cut the hair against the direction of growth.
 - To avoid missing any individual hairs, run the hair grooming kit over the same area of the hair several times.
5. Then cut the front part of the hair towards the middle of the head.
 6. Comb your hair thoroughly again and again.

Thinning hair

- Use the thinning adapter **14** to reduce the volume of hair without changing its length.

Cutting contours and beards



Please note that you can only achieve the cut lengths listed if you hold the hair grooming kit at a right angle to the surface of your skin or run it along your skin.

1. To cut the hair very short or a beard or contours, use the hair grooming kit without the comb adapter. Remove it if necessary.
2. Use the slide control for the fine adjustment **2** to set the desired cut length:

Level of the slide control	Cut length
0	2.8 mm
1	2.2 mm
2	1.5 mm
3	0.8 mm

The selected cut length will appear on the display **5**.

3. Shorten or cut the hair as desired.

Cleaning and care

WARNING!

Risk of electric shock!

Improper handling of the hair grooming kit may result in an electric shock.

- Pull the power supply unit out of the socket before you clean the hair grooming kit or the charging station.

NOTICE!

Risk of short circuit!

Water that has penetrated the housing may cause a short circuit.

- Do not rinse the hair grooming kit or the charging station under running water.
- Only clean the hair grooming kit when it has been switched off.

NOTICE!

Risk of damage!

Improper handling of the hair grooming kit may result in damage.

- Do not use any aggressive cleaners or cleaners with solvents, sharp, scratching or metallic cleaning utensils such as knives, metal sponges and the like. They could damage the surfaces.

Cleaning the charging station

1. Pull the power supply unit **7** out of the socket.
2. Pull the device plug **8** out of the charging station **6**.
3. Use a damp cloth to wipe out the charging station.
4. Then wipe the charging station off with a dry cloth.

Cleaning the comb adapters

1. Pull the comb adapter off of the hair grooming kit by its side bars.
2. Rinse the comb adapter off with water.
3. Then wipe the comb adapter off until it is completely dry.

Cleaning and oiling the hair trimmer adapter



Set the slide control for the fine adjustment to the 0 setting ("2.8 mm") before you clean the hair trimmer adapter.

1. Place your thumb on the front side of the hair grooming kit on the hair trimmer adapter **1**.
2. Use your thumb to push the hair trimmer adapter back and off the hair grooming kit (see **fig. C**).
3. Use the brush to remove leftover hair from the hair trimmer adapter **12**.
4. Apply a few drops of clipper oil **13** to the cutting edge of the hair trimmer adapter.
If applicable, use a soft cloth to wipe excess shaver oil off. Only use oil that does not contain acid, e.g. sewing machine oil.
5. From the back side, carefully push the hair trimmer adapter back onto the hair grooming kit so that the hair trimmer adapter locks in place.

Troubleshooting

Problem	Possible cause	Solution
The hair grooming kit doesn't work.	The rechargeable battery is empty.	Charge the rechargeable battery.
		Use the hair grooming kit in mains mode.
	The power supply unit 7 is not properly inserted in the socket or the device plug 8 is not correctly inserted in the charging station 6 or hair grooming kit.	Check and adjust the connections.
	The switch lock 4 has not been released.	Turn the switch lock to the left so that it points towards O .
The hair trimmer adapter 1 is not running smoothly.	The hair trimmer adapter is dirty and/or has not been oiled for a prolonged period.	Clean and oil the hair trimmer adapter in accordance with the chapter "Cleaning".

Storage

NOTICE!

Risk of damage!

Improper handling of the hair grooming kit may result in damage.

- Before preparing the hair grooming kit for storage, disconnect the hair grooming kit and the charging station from the power source.
- Do not wind the cord of the power supply unit around the hair grooming kit. There is a risk of breaking the cable.
- Place the hair grooming kit on the charging station **6** or place it in the enclosed storage bag **9**.
- Store the hair grooming kit in a dry area with a suitable temperature.
- We recommend to use the original packaging when storing the product for prolonged periods.

Technical data

Model: 15133902

Article number: 92722

Power supply unit

Input voltage: 100 – 240 V ~ 50/60 Hz,
max. 0.2 A

Output voltage: 5 V ===, 1000 mA

Protection class: II

IP code: IP20 – protected against contact with fingers or the ingress of solid objects with a diameter greater than 12 mm. Not protected against the ingress of water.

Hair grooming kit

Input voltage: 5 V ===, 1000 mA

Rechargeable battery: 3.7 V Li-Ion 800 mAh (AA)

Ambient temperature: +5 °C to +35 °C

Protection class: III

Charging station

Input voltage: 5 V ===, 1000 mA

Output voltage: 5 V ===, 1000 mA

Declaration of conformity



The EU declaration of conformity can be requested from the address specified on the warranty card (at the end of this instruction manual).

Disposal

Disposing of the packaging



Dispose of the packaging separated into single type materials. Dispose of cardboard and carton as waste paper and foils via the recyclable material collection service.

Disposing of the hair grooming kit

(Applicable in the European Union and other European states with systems for the separate collection of reusable waste materials)



Old devices must not be disposed of with household waste!

If the hair grooming kit can no longer be used, every user is **required by law to dispose of**

old devices separately from their household waste, e.g. at a collection point in his community/borough. This ensures that old devices are recycled in a professional manner and also rules out negative

consequences for the environment. For this reason, electrical equipment is marked with the symbol shown here.

Batteries and rechargeable batteries may not be disposed of with household waste!



As the end user you are required by law to bring all batteries and rechargeable batteries, regardless whether they contain harmful substances* or not, to a collection point run by the communal authority or borough or to a retailer, so that they can be disposed of in an environmentally friendly manner.

* labelled with: Cd = cadmium, Hg = mercury, Pb = lead

Bring the hair grooming kit in its entirety (including the rechargeable battery) to your collection point and make sure that it is in an uncharged state!

EASY
HOME

WARRANTY CARD

HAIR GROOMING KIT WITH RECHARGEABLE BATTERY/MAINS MODE

Your details:

Name _____

Address _____

_____

E-mail _____

Date of purchase * _____

* We recommend you keep the receipt with this warranty card. _____

Location of purchase _____

Description of malfunction:



If **after contacting the manufacturer** you are requested to return the faulty product please return the completed warranty card together with it.

Docdata Fashion Services
GmbH
Retourenannahme
Aquarius
Amshamerstr. 2
84385 Egglham
GERMANY

AFTER SALES SUPPORT

GB IRE

**00800 36 46 36 00** www.aquarius-service.comMODEL:
15133902PRODUCT CODE:
92722

11/2015

free hotline**3****YEARS
WARRANTY**

Warranty conditions

Dear Customer,

The **ALDI warranty** offers you extensive benefits in addition to your statutory rights:

Warranty period: **3 years** from date of purchase.

6 months for wear parts and consumables under normal and proper conditions of use (e.g. rechargeable batteries).

Costs: Free repair/exchange.
No transport costs.

Hotline: Free hotline.

ADVICE: Please contact our service hotline by phone, e-mail or fax before sending in the device. This allows us to provide support in the event of possible operator errors.

In order to make a claim under the warranty, please send us:

- the faulty item together with the original purchase receipt and the completed warranty card.
- the faulty product with all components included in the packaging.

The warranty does not cover damage caused by:

- **Accident or unanticipated events** (e.g. lightning, water, fire).
- **Improper use or transport.**
- **Disregard of the safety and maintenance instructions.**
- Other **improper treatment or modification.**

After the expiry of the warranty period, you still have the possibility to have your product repaired at your own expense. If the repair or the estimate of costs is not free of charge you will be informed accordingly in advance.

This warranty does not affect your statutory rights. In the event that a product is received for repair, neither the service company nor the seller will assume any liability for data or settings possibly stored on the product by the customer.



Spend a little Live a lot.

Great care has gone into the manufacture of this product and it should therefore provide you with years of good service when used properly. In the event of product failure within its intended use over the course of the first 3 years after date of purchase, we will remedy the problem as quickly as possible once it has been brought to our attention. In the unlikely event of such an occurrence, or if you require any information about the product, please contact us via our helpline support services, details of which are to be found both in this manual and on the product itself.

GB

IRE

PRODUCED IN CHINA FOR:

ALDI STORES LTD. PO BOX 26, ATHERSTONE
WARWICKSHIRE, CV9 2SH

ALDI STORES (IRELAND) LTD.
PO BOX 726, NAAS, CO. KILDARE.
visit us at www.aldi.com

AFTER SALES SUPPORT



GB

IRE

00800 36 46 36 00



www.aquarius-service.com

Model: **15133902**

Product code: **92722**

11/2015

3

**YEARS
WARRANTY**