

- 2 Gebruiksaanwijzing
- 6 User Instructions
- 10 Gebrauchsanweisung
- 14 Mode d'emploi
- 18 Instrucciones para el uso
- 22 Brugsanvisning
- 26 取り扱い説明書



Bobike **maxi City**



Bobike **maxi Tour**



**bobike**<sup>®</sup>  
bicycle safety seats

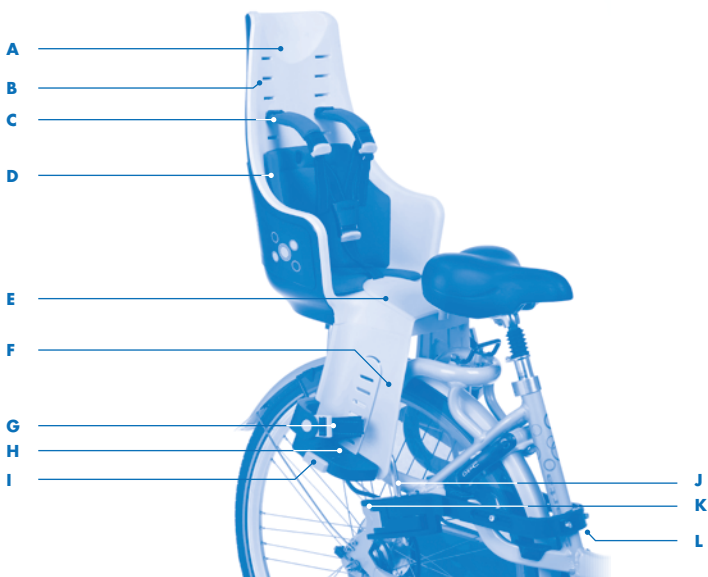

- (NL)** **A** Zitje  
**B** Gordelinsteek  
**C** Gordel  
**D** Bekleding  
**E** Opbergvak  
**F** Spaakafscherming  
**G** Voetengordel  
**H** Voetenbak  
**I** Voetenbak verstelling  
**J** Draagbeugel  
**K** Vergrendeling  
**L** Montagebeugel

- (GB)** **A** Seat  
**B** Slot for inserting safety belt  
**C** Safety belt  
**D** Seat cover  
**E** Storage compartment  
**F** Spoke protector  
**G** Footstrap  
**H** Footrest  
**I** Footrest adjustment  
**J** Bearing bracket  
**K** Locking units  
**L** Mounting bracket

- (DE)** **A** Sitz  
**B** Gurteinstecklöcher  
**C** Gurt  
**D** Kissen  
**E** Schließfach  
**F** Speichenschutz  
**G** Fußriemen  
**H** Fußstützen  
**I** Fußstützenverstellung  
**J** Tragebügel  
**K** Verriegelung  
**L** Montagebügel

- (JP)** **A** シート  
**B** ベルトバックル差し込み口  
**C** シートベルト  
**D** シートカバー  
**E** コンパートメント  
**F** 車輪接触防止プロテクター  
**G** フットステップ  
**H** フットレスト  
**I** フットレストアジャスター  
**J** ペアリングブラケット  
**K** ロッキングユニット  
**L** マウンティングブラケット

- (FR)** **A** Siège  
**B** Fente pour ceinture  
**C** Ceinture de sécurité  
**D** Revêtement  
**E** Casier à rangement  
**F** Protèges-rayons  
**G** Ceinture des pieds  
**H** Repose-pieds  
**I** Réglage repose-pieds  
**J** Barre de support  
**K** Verrouillage  
**L** Fixation

- (ES)** **A** Asiento  
**B** Ranura para cinturón  
**C** Cinturón  
**D** Revestimiento  
**E** Compartimento para guardar  
**F** Protección contra los radios de la bicicleta  
**G** Correa de pie  
**H** Receptáculo para los pies  
**I** Ajuste del receptáculo para los pies  
**J** Brida de soporte  
**K** Bloqueo  
**L** Brida de montaje

- (DK)** **A** Stol  
**B** Indstik til sele  
**C** Sele  
**D** Betræk  
**E** Opbevaringsrum  
**F** Egerbeskytter  
**G** Fodrem  
**H** Fodstøtte  
**I** Justering af fodstøtte  
**J** Bærebøjle  
**K** Lukkemekanisme  
**L** Montagebøjle

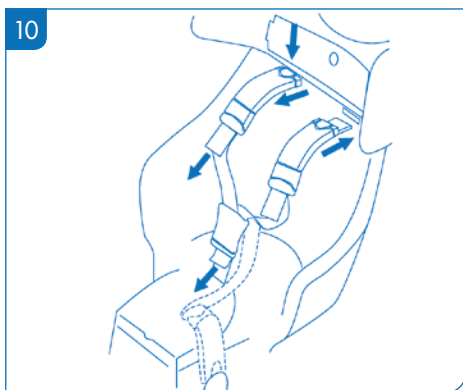
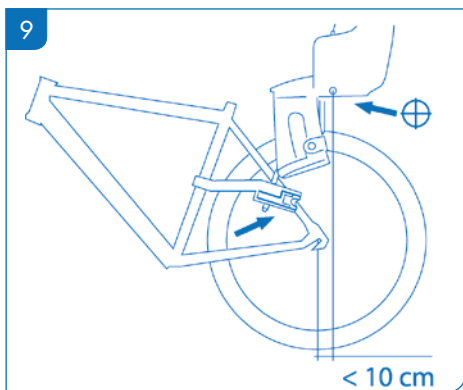
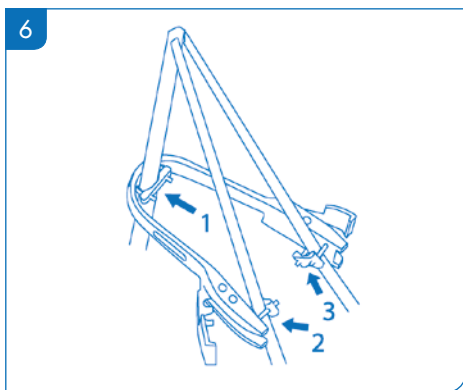
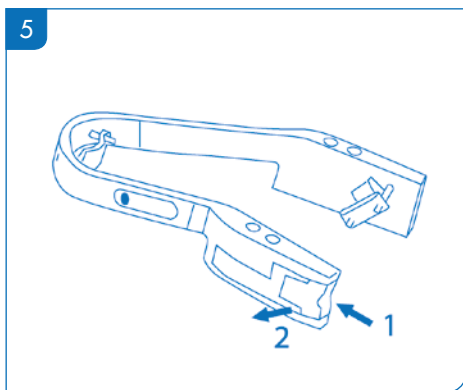
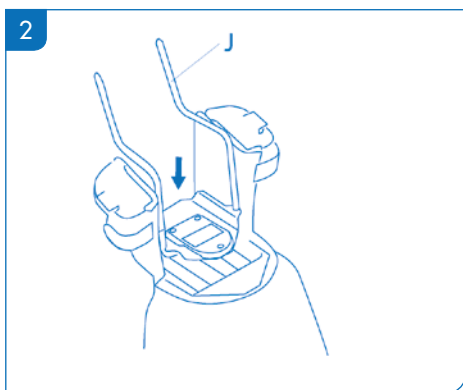
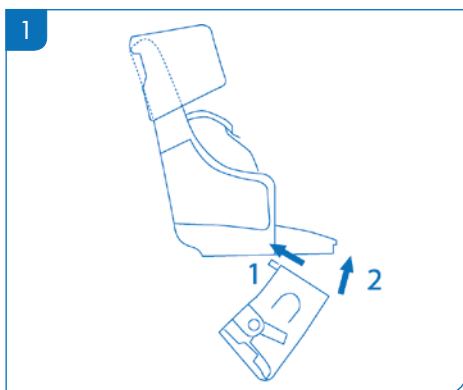

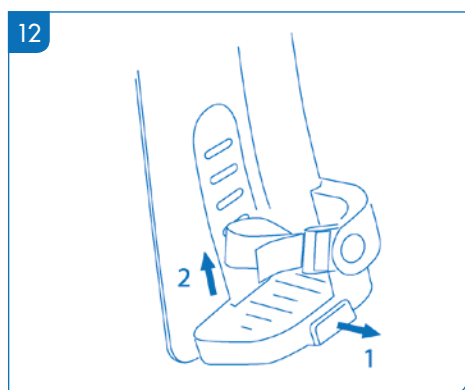
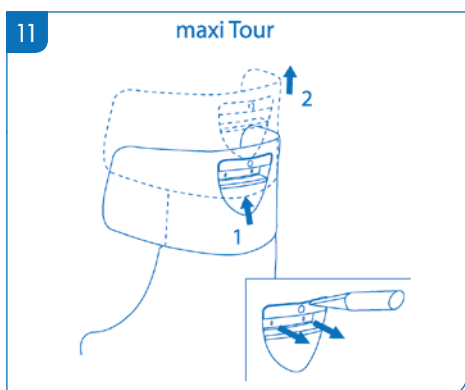
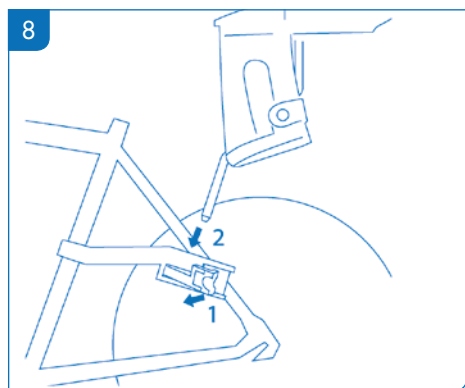
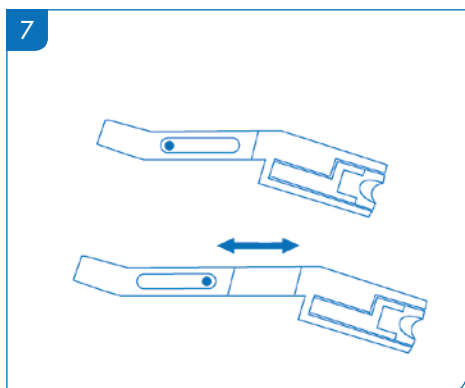
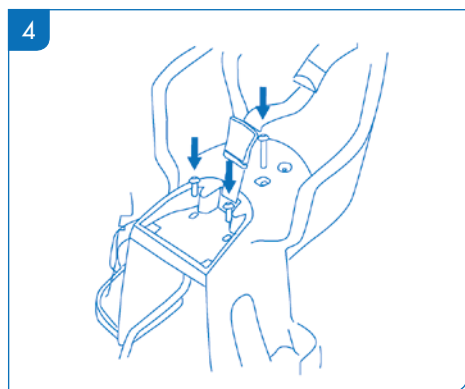
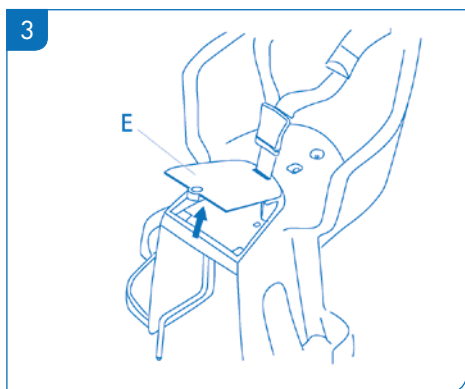

## Bobike maxi City and maxi Tour: a safe choice

You on the bike, your child in a bicycle seat behind you, and off you ride. Sometimes we cycle purely for the fun of it, sometimes because we need to and we have a specific destination. Whatever the reason for a bike ride, your child's safety is paramount. By purchasing the Bobike maxi City or maxi Tour, approved according to European safety standard EN 14344, you have made a good choice. To ensure proper and safe fitting, it is important to read this user manual carefully first, and then follow the instructions carefully. Keep this user manual in a safe place in case you need to refer to it at a later date. Dremefa, the manufacturer of the Bobike maxi City and maxi Tour, wishes you many happy, and above all safe, bicycle rides.

### From 9 months to 6 years

The Bobike maxi City and maxi Tour are suitable for children aged from 9 months to 6 years. We recommend that you use the seat only when your child is able to sit well on its own, at least for the duration of the ride. The maximum weight of a child in the Bobike maxi City or maxi Tour is 22 kilograms. For children older than 6 years or heavier than 22 kilograms, we offer the Bobike junior. If you want to use your Bobike maxi City or maxi Tour on more than one bike, ask your dealer about the extra mounting bracket.

### Maintenance

Bobike child bicycle seats are simple to maintain. The seat cover is held in place and attached by a cap that can be removed by pulling it forward. The seat cover can be washed by hand and the seat cleaned with a mild detergent. Do not use any abrasive cleaning agents.

### Guarantee

Bobike guarantees that the supplied child's cycle seat is manufactured from durable materials and subject to strict quality controls. Bobike therefore guarantees this product for a period of one year. In certain cases, you can present your receipt to your supplier.

### Other Bobike products and accessories

- Bobike mini+

- Bobike maxi+
- Bobike junior
- Windscreen for Bobike mini+
- Separate seat cushions
- Safety belt pads
- Saddle spring protector
- Jacket protectors
- Handlebar with cushion for Bobike mini+
- Footrests
- Tyre levers
- Summer cover
- Safety belt for Bobike junior
- Poncho
- Helmet
- Rear carrier

### Method of mounting

The Bobike maxi City and maxi Tour are not suitable for mounting on a bicycle with a carbon frame or on a moped. You must only mount the seat on bicycles that are suitable for carrying the extra weight of the seat and child. You should therefore consult your bicycle's manual or ask your bicycle manufacturer or supplier for advice. When mounting using the mounting bracket, the diameter of the seat tube may not exceed 52 mm. The width of the luggage carrier may not exceed 160 mm. Should you have any further queries, please refer to your Bobike supplier or visit [www.bobike.com](http://www.bobike.com).

### Twelve steps to a correctly mounted Bobike maxi City or maxi Tour

The Bobike maxi City and maxi Tour comply with European safety standard EN 14344 and are very safe child bicycle seats. Of course, the assembly must be carried out in the correct way. The numbers of the steps match the related drawings. For example, drawing 1 illustrates what is described in step 1.

#### 1. Mounting the spoke protectors

The spoke protectors (F) must be inserted into the underside of the seat. Insert them into the seat (1) and then turn them forward until they click solidly into place (2).

## **2., 3. and 4. Mounting the bearing bracket**

Place the bearing bracket under the seat (2). To mount the bearing bracket (J), open the storage compartment (3). Ensure that the bolt holes align with the nuts in the bracket. Insert the nuts into the holes and hand-tighten them (4).

## **5. and 6. Attaching the mounting bracket to your bicycle**

Attach the mounting bracket (L) to the saddle tube and the upright rear fork of your bicycle. Open the locking units (K) left and right of the bracket (5). Loosen the bolts, and place the bracket on the frame. Hand-tighten the bolts so that you can adjust the bracket. The middle section of the bracket should be positioned horizontally (6).

## **7. Adjusting the height of the mounting bracket**

The height of the mounting bracket is adjustable, so you can adjust the distance (height) properly. The distance between the upper surface of the luggage carrier and the seat should be about 2 cm. If your bicycle has no luggage carrier, maintain a distance of at least 8 cm above the rear wheel. The mounting bracket must be in the same position on both sides. Tighten all bolts firmly (with a torque of 9 Nm).

## **8. Placing the seat onto the bicycle**

Open the locking units (K) of the mounting bracket (1). Insert the seat's bearing bracket into the openings in the front (2) of the mounting bracket. Insert the bearing bracket in the front openings of the mounting bracket. Push the seat so far down that the bearing bracket on the underside of the mounting bracket is visible. Close the locking units. You should hear a definite click.

## **9. The seat's centre of gravity**

Check that the centre of gravity of the Bobike maxi City or maxi Tour does not lie more than 10 cm behind the rear axle. Carry out this check before you go on a first test ride with your child. The symbol for the centre of gravity (⊕) can be found on the sides of the seat (A). You can adjust the location of the centre of gravity by partially loosening the bearing bracket's bolts in the

seat (see Point 4), so that the seat can be moved back and forth over the bearing bracket. Once you have found the proper position, tighten the bolts firmly (with a torque of 5 Nm).

Check that the surface of the seat is horizontal, and that the back of the seat is tilted somewhat to the rear. This is the case when the mounting bracket is in a horizontal position. If this is not the case, you can adjust the position of the Bobike maxi City or maxi Tour by readjusting the mounting bracket (see Points 6 + 7).

## **10. Adjusting the safety belt**

Sit your child in the Bobike maxi City or maxi Tour and check that the chosen setting is correct. If you want to change the setting, always remove your child from the seat first. The unique safety belt system (C) of your Bobike maxi City or maxi Tour ensures that your child will remain seated safely in the seat. First pull out the safety belt system in length as far as it will go. Place your child in the seat. Insert the safety belt clips into the recesses above your child's shoulders. Make sure that your child can still move freely but safely in the seat. The safety belt clips should be inserted, even if you go for a ride without your child. This keeps loose parts from coming into contact with the moving parts of the bicycle. You can insert the safety belt clips into the seat or into the spoke protectors.

## **11. Head support (maxi Tour only)**

For the Bobike maxi Tour, make sure that the head support is adjusted to the height of your child before inserting the belt clips into the head support. You can adjust the head support by squeezing the grey handle (1) on the back whilst simultaneously moving the head support (2) to the right height. Tighten the belt by pulling on the ends. The Bobike maxi Tour is equipped with LED lighting. To operate this, you will have to install 2 AAA batteries yourself. The lighting can be turned on by pressing the grey button.

## **12. Adjusting the height of the footrests**

The Bobike maxi City and maxi Tour are equipped with easily adjustable footrests (H). You can adjust the footrests

to the proper height by pulling on the handle (I) in the footrest. Secure your child's feet with the foot straps (G). These are also easy to adjust in length.

### Extra attention to safety

- Check whether all parts are properly mounted and set. Tighten the screws and check regularly that all attachments are still firmly and safely secured.
- After fitting the Bobike maxi City or maxi Tour, check whether all the components of the bicycle are still working properly.
- After fitting the Bobike maxi City or maxi Tour, go on a short test ride with your child.
- Bobike recommends only using the seat when your child is able to sit independently for at least the duration of the ride.
- An additional mounting bracket is available separately enabling your Bobike maxi City or maxi Tour to be used on more than one bicycle. You can ask your Bobike supplier for advice about this.
- Check whether the bicycle is suitable for mounting the Bobike maxi City or maxi Tour on.
- Check whether the use of the Bobike maxi City or maxi Tour is legally permitted for conveying children in the country where you wish to use it.
- The cyclist must be at least 16 years old in order to carry a child in the Bobike maxi City or maxi Tour. The law in this area can vary according to country.
- The centre of gravity on the seat must never exceed 10 cm behind the rear wheel axle (also see point 9 in the mounting instructions).
- Check from time to time that your child is not too heavy for the Bobike maxi City or maxi Tour. The greatest permissible weight is 22 kilograms. You can carry heavier children in the Bobike junior.
- Before each ride, check that no body parts or articles of clothing interfere with rotating or moving parts of the bicycle. This will prevent, for example, a foot coming between the spokes or a finger in the brake mechanism.
- Ensure that your child cannot touch any sharp parts such as frayed brake cables.
- Ensure that your child is always properly protected against the cold and rain when in the seat. Remember

that your child is sitting still in the seat and will therefore get colder more quickly than the cyclist.

- Ensure that your child always wears a properly fitting safety helmet.
- The seat can become very hot if it is exposed to direct sunlight for any length of time. Remember this before sitting your child in the Bobike maxi City or maxi Tour.
- If the bicycle is transported on top of or on the back of a moving car, the Bobike maxi City or maxi Tour must be removed. The air turbulence can damage the seat and the mounting, resulting in a hazardous situation.
- Check that your child cannot operate any locks or other blocking devices present on the bicycle while seated in the Bobike maxi City or maxi Tour.
- Never convey several children in a single seat.
- The seat must always be replaced following an accident, even if there is no visible damage. Ask your supplier for information about this.
- Cover the saddle springs so that your child cannot poke its fingers between them.
- **Warning:** Do not attach any extra baggage to the Bobike maxi City or maxi Tour. Whenever you carry extra baggage, secure it to the other end of the bicycle, so that the weight is evenly distributed. Use the baggage carrier designed for the front of the bicycle.
- **Warning:** The seat and/or the components must not be modified. To do so will void any claim under guarantee and/or liability.
- **Warning:** A bicycle seat such as the Bobike maxi City or maxi Tour influences the way you ride on your bicycle. Pay extra attention therefore to steering, balancing and braking.
- **Warning:** Never leave your child alone in the seat if you leave the bicycle parked against a wall or on its stand. The child could have a nasty fall.
- **Warning:** If a part of the Bobike maxi City or maxi Tour fails, you should no longer use the seat. Have the part repaired or replaced by your supplier.
- **Warning:** Always use the safety belt and the foot straps when carrying your child in the Bobike maxi City or maxi Tour. Always check whether the safety belt and straps are closed before you set off.

**Bobike**

P.O. Box 18

6980 AA Doesburg

The Netherlands

T +31 (0) 313 47 86 30

F +31 (0) 313 47 40 30

E [info@bobike.com](mailto:info@bobike.com)

I [www.bobike.com](http://www.bobike.com)

Bobike is a registered trademark of Dremefa B.V.

For more information and a list of products:

[www.bobike.com](http://www.bobike.com).





Bobike  
P.O. Box 18  
6980 AA Doesburg  
The Netherlands  
T +31 (0) 313 47 86 30  
F +31 (0) 313 47 40 30  
E [info@bobike.com](mailto:info@bobike.com)  
I [www.bobike.com](http://www.bobike.com)

Bobike **maxi City**

Bobike **maxi Tour**

Bobike is a registered trademark  
of Dremefa B.V.



GBA-maxi City/Tour-01-2011