

Jabra®

JABRA ECLIPSE

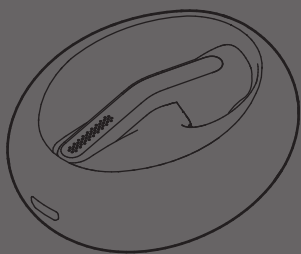

User Manual

jabra.com/eclipse

A BRAND BY

GN Netcom

© 2015 GN Netcom A/S. All rights reserved. Jabra® is a registered trademark of GN Netcom A/S. All other trademarks included herein are the property of their respective owners. The Bluetooth® word mark and logos are owned by the Bluetooth SIG, Inc. and any use of such marks by GN Netcom A/S is under license. (Design and specifications subject to change without notice).

MADE IN CHINA
MODEL: OTE25



Declaration of Conformity can be found on www.jabra.com/CP/US/declarations-of-conformity

1. WELCOME	5
2. PRODUCT OVERVIEW	6
2.1 INCLUDED ACCESSORIES	
3. HOW TO WEAR.....	8
3.1 SELECTING THE CORRECT EARGELS	
3.2 GETTING THE CORRECT FIT	
4. HOW TO CHARGE	10
4.1 ON-THE-GO CHARGING	
4.2 USB CHARGING	
5. HOW TO CONNECT	14
5.1 TURNING THE HEADSET ON/OFF	
5.2 CONNECT USING THE APP	
5.3 CONNECT VIA BLUETOOTH	
5.4 CONNECT WITH AN NFC-ENABLED DEVICE	
6. JABRA ASSIST APP	17
7. HOW TO USE	18
7.1 CALLS	
7.2 VOICE COMMANDS	
7.3 MULTIPLE CALL HANDLING	
7.4 HOW TO RESET	
7.5 HOW TO UPDATE HEADSET FIRMWARE	

8. SUPPORT	22
8.1 FAQ	
8.2 HOW TO CARE FOR YOUR HEADSET	
9. TECHNICAL SPECIFICATIONS	23

1. WELCOME

Thank you for using the Jabra Eclipse. We hope you will enjoy it!

JABRA ECLIPSE FEATURES

- Button-free headset - gently tap/double tap the headset*
- Up to 10 hours talk time (up to 3 hours in the headset and up to 7 hours in the charging case)**
- Power Nap for extended standby time
- Dual microphones for noise cancellation
- Connect with NFC**
- HD voice compatible**
- Voice guidance***
- Voice control/commands***
- Supports Siri/Google Now/Cortana voice commands**
- Wireless freedom - Up to 30 meters/98 feet**
- Portable charging case included
- Comfortable EarGels in various sizes (XS, S, M and L) included

*Tapping the headset too hard may create a sound that could damage your hearing

**Phone/network dependent

*** 10 language options available if using the Jabra Assist app

2. PRODUCT OVERVIEW

HEADSET

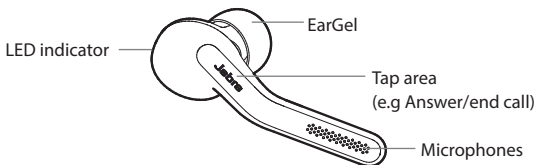

CHARGING CASE (TOP VIEW)

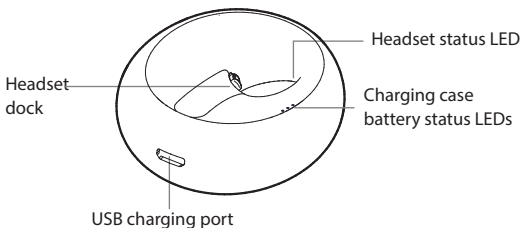

CHARGING CASE (BOTTOM VIEW)

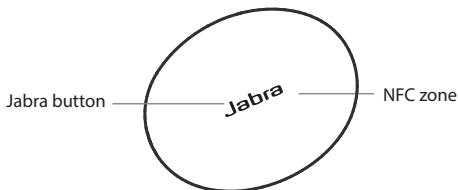

2.1 INCLUDED ACCESSORIES



USB cable



Large
EarGel



Medium
EarGel



Small
EarGel



Extra-
small
EarGel

NOTE: You can purchase an additional charging case and accessories online at jabra.com

3. HOW TO WEAR

The headset is designed for right ear wearing. For the optimal sound quality and the most comfortable fit, select the correct EarGel size and ensure the headset is fitted correctly into your ear.

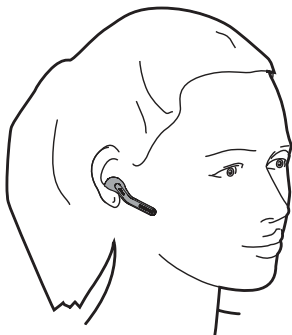

3.1 SELECTING THE CORRECT EARGELS

The headset is supplied with four EarGel sizes: large, medium, small and extra small. The correct EarGel will feel tight and decreases surrounding sounds.

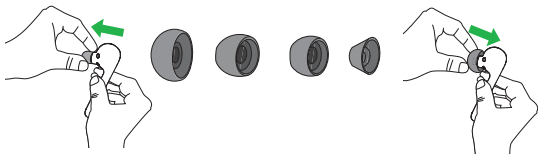

3.2 GETTING THE CORRECT FIT

Fit the headset firmly inside your right ear, and angle the microphone down towards your mouth.

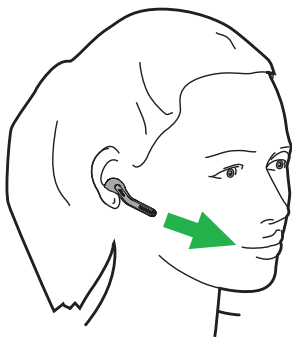
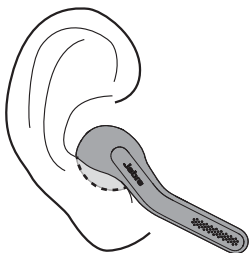

4. HOW TO CHARGE

It is recommended to fully charge the headset and the charging case before first-time use.

Fully charged the headset will have up to 3 hours of talk time, and the charging case will have up to 7 hours of battery.

4.1 ON-THE-GO CHARGING

Dock the headset in the charging case for on-the-go charging. It takes approx. 2 hours to fully charge the headset.

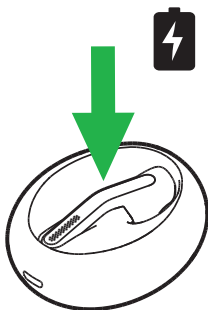

4.2 USB CHARGING

Plug the charging case into a USB power supply using the supplied USB cable to charge the headset and/or the charging case. It takes approx. 3 hours to charge the headset and the charging case together.

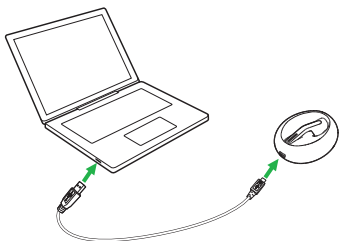

4.3 BATTERY STATUS

To hear the current remaining talk time in your headset, gently tap the headset when it is in your ear and you are not on a call.

To see the charging case battery status and/or the headset battery status (when docked), tap the Jabra button on the bottom of the charging case.

HEADSET BATTERY STATUS



20-100% battery



0-20% battery



20-100% battery



0-20% battery

CHARGING CASE BATTERY STATUS



66-100% battery



33-66% battery



0-33% battery

4.4 POWER NAP

To extend standby time the headset will automatically enter Power Nap mode when the headset is out of range of your connected mobile device for more than 15 minutes. Power Nap provides up to 7 days of battery readiness/standby time.

To exit Power Nap (or answer an incoming call) dock the headset in the charging case and then undock the headset. Your mobile device must be switched on, within range, and have Bluetooth enabled.

5. HOW TO CONNECT

5.1 TURNING THE HEADSET ON/OFF

ON: Undock the headset from the charging case.

OFF: Dock the headset in the charging case. The Headset status LED will briefly light up white when the headset is docked.

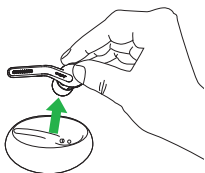

ON

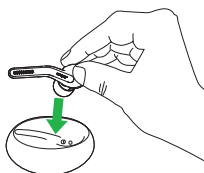

OFF

5.2 CONNECT USING THE APP

The quickest and easiest way to connect to your mobile device is to download and use the Jabra Assist app for iOS or Android devices.



5.3 CONNECT VIA BLUETOOTH

1. Dock the headset in the charging case, and ensure the headset is charged.
2. Press and hold (3 secs) the **Jabra** button on the bottom of the charging case until the light flashes blue.

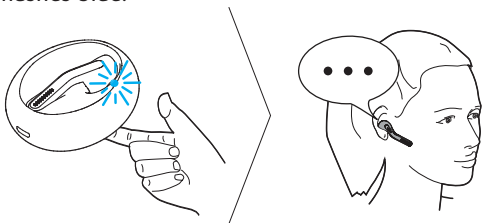

3. Wear the headset and follow the voice-guided instructions.

NOTE: Connecting via Bluetooth only needs to be completed the first time you are connecting to a new device.

5.4 CONNECT WITH AN NFC-ENABLED DEVICE

Dock the headset in the charging case, and slide your NFC-enabled device against the NFC zone on the bottom of the charging case until a connection is confirmed on your mobile device.

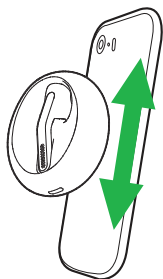

6. JABRA ASSIST APP

The Jabra Assist app is a free app for iOS or Android devices that enables you to:

- Customize your in-call audio
- Change headset language
- Automatic text message read-out
- Update headset firmware
- Enable/disable headset voice guidance
- And more..



Jabra Assist

Android download - Google Play
iOS download - App Store

7. HOW TO USE

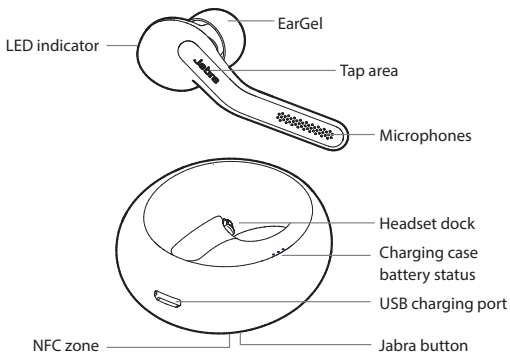

7.1 CALLS

USING THE CHARGING CASE



Turn on headset

Undock the headset from the charging case

Turn off headset

Dock the headset in the charging case

Answer call

Undock the headset from the charging case

End/reject call

Dock the headset in the charging case

HEADSET IN EAR

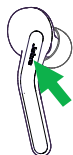

Answer call	Gently double-tap the headset, or say 'Answer'
-------------	--

End call	Gently double-tap the headset
----------	-------------------------------

Reject call	Say 'Ignore'
-------------	--------------

Activate Siri/ Google Now/ Cortana	Gently double-tap the headset when not on a call
--	--

Headset battery status	Gently tap the headset when not on a call
------------------------	---

7.2 VOICE COMMANDS

WHAT YOU CAN SAY

WHAT IT MEANS

Answer

Answer incoming call

Ignore

Reject incoming call

7.3 MULTIPLE CALL HANDLING

The headset can answer or reject calls when you are already on a call.

	FUNCTION	ACTION
	End current call and answer incoming call	Gently double-tap the headset
	Reject incoming call, when on a call	Gently tap the headset

7.4 HOW TO RESET

Resetting the headset will clear the list of connected devices. You will need to reconnect to your mobile device/s.

1. Dock the headset in the charging case, and connect the charging case to power using the USB cable.
2. Press and hold (8 secs) the **Jabra** button on the bottom of the charging case until the light flashes purple rapidly. Release the button.

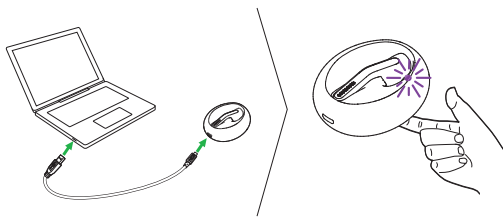

7.5 HOW TO UPDATE HEADSET FIRMWARE

Use the Jabra Assist app to update the headset firmware to the latest version, or go to jabra.com/eclipse for more help.

8. SUPPORT

8.1 FAQ

View the FAQs on jabra.com/eclipse

8.2 HOW TO CARE FOR YOUR HEADSET

- Always store the headset with the power off and safely protected.
- Avoid storage at extreme temperatures (above 70°C/158°F or below -20°C/-4°F). This can shorten battery life and may affect the headset.

9. TECHNICAL SPECIFICATIONS

JABRA ECLIPSE	SPECIFICATION
Weight:	Headset 5.5 g (0.19 oz) Charging case 35 g (1.23 oz)
Dimensions:	Headset L 49.95 mm x W 17.58 mm x H 24.82 mm Charging case L 62.2 mm x W 54 mm x H 25.5 mm
Microphones:	2 x Omnidirectional MEMS microphones
Microphone frequency range:	100 Hz - 8 kHz
Microphone sensitivity:	14 dB +/- 3 dB (SWR)
Speaker type:	6 mm dynamic speaker
Speaker sensitivity:	94 dB SPL at 1 mW /1 kHz
Speaker impedance:	16 ohm
Speaker max input power:	5 mW
Speaker frequency range:	20 Hz - 20 kHz
Operating range:	Up to 30 m/98 ft (phone dependent)

JABRA ECLIPSE	SPECIFICATION
Bluetooth version:	4.1
Paired devices:	Up to 8, connected to two at the same time (MultiUse™)
Supported Bluetooth profiles:	Headset profile (v1.2), hands free profile (v1.6), A2DP (v1.3), phone book access profile (v1.0)
Talk/battery time:	Up to 10 hours (up to 3 hours in headset, and up to 7 hours in charging case)
Standby time:	Up to 3 days
Power Nap time:	Up to 7 days
Charging time:	Approx. 2 hours for headset only. Approx. 3 hours for headset and charging case together
USB charging cable:	5 V, >100 mA
Operating temperature:	-10°C to 55°C (14°F to 131°F)
Storage temperature:	-20°C to 70°C (-4°F to 158°F)
Pairing passkey or PIN:	0000
Product materials:	Eargel: Thermoplastic Elastomer (TPE), Silicon Rubber. Headset and charging case: Polycarbonate/Acryl Butadien Styren (PC/ABS), Polycarbonate (PC), Silicon Rubber

