



Home Monitoring
**Wireless Color
Camera with
Receiver**

User Manual



www.jascoproducts.com

1-800-654-8483

Thank you for purchasing the GE 45234 Wireless Color Camera System with Receiver. Please review these instructions carefully before attempting to operate the unit.

PRODUCT FEATURES

- “Wi-Fi” internet friendly wireless system—won’t interfere with home wireless networks
- View up to two cameras automatically
- Audio Detection & Notification feature—alerts when sound is detected in a monitored area
- Night Vision feature for low or no light viewing up to 10 ft.
- Unique “axis-swivel” camera mount allows for desktop or wall installation
- Adjustable antenna for camera and receiver
- Wirelessly transmits audio and video up to 200 ft. (unobstructed line of sight).
- Receiver connects to any TV or monitor with AV inputs
- Camera for Indoor/Outdoor use

PACKAGE CONTENTS

Please check and identify all the parts before proceeding with the installation.

1. 45233 Wireless Color Camera
2. 45234 Wireless Receiver
3. Wall plate and mounting hardware for camera
4. 2 AC adapters
5. AV cable

BEFORE YOU INSTALL

When choosing the best location for the placement of the camera and receiver, it is best to avoid any sources of possible RF interference such as microwave ovens and cordless phones. Proximity to these and other sources of RF interference can inhibit the proper functioning of the receiver.

The 900MHz video signals pass easily through your home's interior walls, but the signal may be reflected by power wires or plumbing inside those walls. Usually a slight adjustment to the position of the Receiver and/or Camera antenna will improve reception. Position the antenna upwards to improve sensitivity, and downwards to reduce sensitivity. Take care not to force the antenna past its lock positions.

CHOOSING A CAMERA MOUNTING LOCATION

The 45233 Wireless Color Camera can be positioned on a desktop, or mounted to a wall. It is suitable for

indoor or outdoor use. When choosing a mounting location, please be advised:

- Do not use in wet locations. If using outside, position camera in a sheltered location.
- Do not position the camera so that it points directly into the sun or any bright light, as this may cause damage to the camera.
- Avoid viewing areas where half the area is in bright sunlight and the other half is dark, such as in the shadow of a building. All types of cameras have difficulty “seeing” into areas of such divergent light levels.
- In low light conditions, the camera will automatically activate the Infrared (IR) LED’s and switch the camera to Night Vision mode. Night Vision viewing distance is up to 10 feet.
- The AC adapter used to power the camera cannot be positioned farther than 8 ft. from an AC socket. Do not use the supplied adapter outside or run the cable through walls. If you need to extend the adapter cable, 15 ft. extensions are available by contacting Customer Service at 800-654-8483.
- The Camera has an unobstructed wireless transmission range up to 200 ft. from the receiver. Transmission distance indoors is

reduced due to interior walls, wiring, household fixtures and metal plumbing.

CONNECTING TO A TV OR MONITOR

To prepare for installation of the system, we recommend that you temporarily connect the 45234 Receiver to a TV or Monitor to help you choose the best location for installing the camera. The camera connects wirelessly and automatically to the receiver when both are powered on and within 200 ft (unobstructed view) of each other. This system will accommodate up to 2 cameras.

1. Connect one end of the cable (3.5mm male) to the rear of the receiver, and the other end (white/yellow) to your television's A/V inputs. Match the yellow

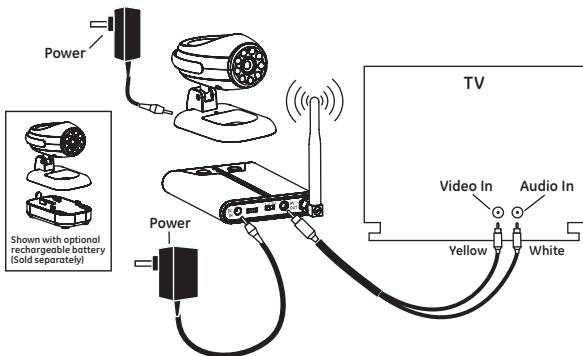

plug to the yellow VIDEO IN jack and the white plug to the white AUDIO IN jack.

2. Plug the AC adapter into the power jack (marked on the back of the receiver, then into an AC outlet.

3. Rotate the antenna to a vertical position. Do not over-tighten. Place the receiver either on top or near to your TV.

4. Set your TV to monitor the VIDEO INPUT designated for the Receiver.

CHANNEL SELECTION Manual Mode

To select one of the two channels manually, press the MANUAL button on the top panel of the Receiver. The green LED will light for the corresponding channel. The receiver will switch to a different channel (1 or 2) each time the MANUAL button is pressed. When you have selected the channel with the active camera, that video will appear on the monitor/TV screen. Each camera must be assigned to a specific channel; both cameras cannot be on the same channel or the signals will

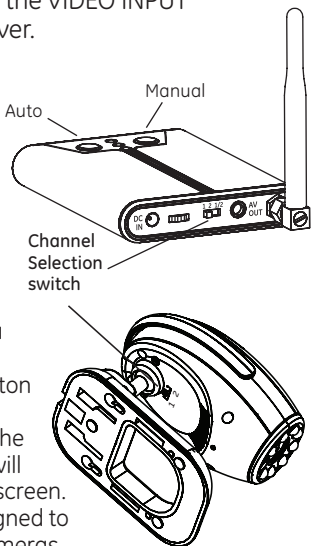

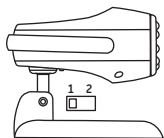

CAMERA 1
Channel Setting

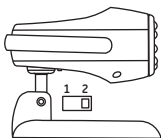

CAMERA 2
Channel Setting

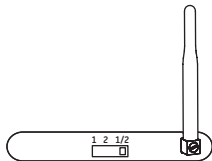

RECEIVER
Channel Setting

cancel out.

Multi-Camera Operation

This wireless surveillance system is designed to work with up to 2 cameras. Additional cameras are sold separately. **IMPORTANT: When using more than one camera, each camera must be assigned to a specific channel using the channel selection switch located on the underside of the camera housing.** Select either 1 or 2 for each camera. Each camera must be assigned to a specific channel; both cameras cannot be on the same channel or the signals will cancel out. If using only one camera you can select either Ch 1 or Ch 2, whichever provides the best picture. The slide switch located on the rear of the Receiver must be set to reflect the channels in use.

Auto Mode (2 Camera Operation)

To have the receiver automatically switch between two active channels, first check the receiver is set to 1/2 position. Next, press the AUTO button on the top panel of the receiver. The green LED will light and the receiver will automatically select between the two active cameras. The monitor will display images from both cameras alternately.

Cycle Time Setting (Time interval between camera selections)

The default cycle time for the receiver is preset to 4 seconds. To change the cycle time, press both of the buttons (Auto and Manual) on top of the receiver simultaneously. The LED will flash; each flash adds one extra second of cycle time. The cycle time can be verified by the number of flashes the LED makes when you release the buttons—one flash equals one second. Cycle time can be set between 2-30 seconds.

NIGHT VISION

The 45233 Wireless Color Camera features Night Vision technology. Objects and images can be seen in little or no light up to 10 ft. The camera uses a special image sensor that automatically detects available light levels. It turns on/off the Infra-Red (IR) LEDs on the front of the camera. These LEDs provide artificial light that allows the camera to 'see' in the dark.

Night Vision will appear as a Black and White image. When the image sensor detects enough light, color will return to the images.



AUDIO DETECTION AND NOTIFICATION FEATURE

This feature allows the system to emit an audio alert whenever sound is detected within a monitored area.

When the camera detects a sound, the receiver will sound an alert and a notification light will flash. The feature can be turned ON/OFF by pressing the button on the front panel of the receiver. The sensitivity for the level of audio detection (when the receiver will sound an alert) can be adjusted with the sensitivity control located at the back of the receiver.



CAMERA INSTALLATION

Once your preferred camera mounting location has been chosen, disconnect the AC adapter from the camera and power off the TV/monitor before proceeding.

Desktop Mount:

1. Place camera in desired location on a flat surface.
2. Set Channel switch on camera to 1 or 2.
3. Power ON the TV/monitor; reconnect AC adapter to the camera.
4. Select the channel (1 or 2) on the receiver that corresponds to the camera channel setting. (See Channel Selection)
5. Adjust antenna and camera angle as needed for the clearest picture. Positioning the antenna upwards to improve sensitivity, and downwards to reduce sensitivity. Take care not to force the antennas past their lock positions.

Wall Mount:

1. To simplify the wall mount process, you will find a custom wall mounting plate included with the mounting hardware.
2. Select the ideal location. Using the supplied mount as a template, drill two 3/16" holes in the desired mounting location, and install the two wall anchors (included) into the holes, or screw directly into a wall stud. Secure the mounting

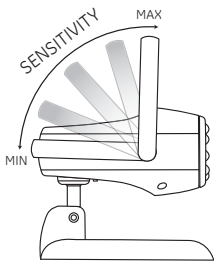

Antenna pivots to increase/decrease signal strength

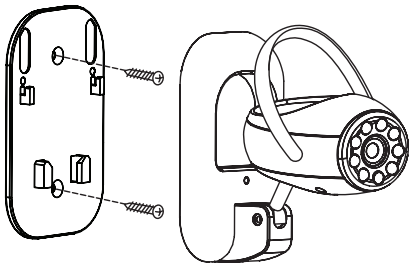
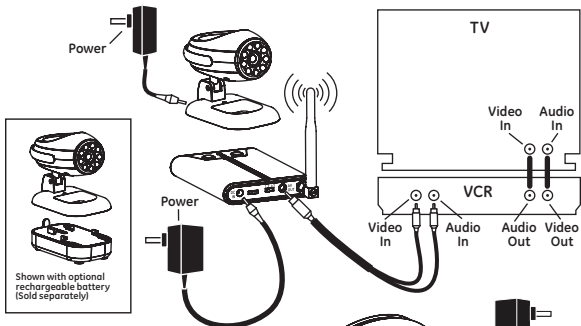

plate to the wall. Do not run the adapter cable in walls; when securing the cable, do not cut or puncture.

3. Set Channel switch on camera to 1 or 2. Slide the camera onto the alignment and locking pins of the mounting plate. Plug in AC adapter into camera.
4. Adjust antenna and camera angle as needed for the clearest picture.

USING THE 45234 WIRELESS COLOR CAMERA SYSTEM WITH A VCR or DVR

You can connect the 45234 camera system to a VCR or DVR in order to record the images received from up to 2 cameras. The VCR or DVR must also be connected a TV/Monitor in order to see live or recorded images. See diagram on next page.



OPTIONAL WIRELESS BATTERY PACK AVAILABLE (SOLD SEPARATELY)

Rechargeable NiMH Battery is available for use with the 45233 Wireless Color Camera. This 850mAh battery will power the 45233 camera for approximately 5 hours on a single charge. To order this battery,

please visit www.jascoproducts.com/batteryoffer or call our Technical Support department at 1-800-654-8483, Monday-Friday 8 a.m.-5 p.m. CST.



TROUBLE SHOOTING

If you are having trouble operating this product, please consult the guide below. If you have any questions or feel the camera system is not operating correctly, or you simply need additional information, please visit our web site www.jascoproducts.com, or contact our Technical Support Group 1-800-654-8483.

No camera picture

1. Check all connectors. Make sure camera(s) and receiver are powered ON.
2. Ensure camera(s) and receiver are set to correct channel(s).
3. Make sure camera is within range of receiver.
4. Adjust the antenna for the camera, receiver or both to obtain best image.

Blank monitor

1. Make sure receiver or monitor is switched ON, and the correct video input has been selected
2. If using AC adapter, make sure it is plugged in.
3. If using a battery, make sure it is installed correctly, and is fully charged.

Interference on camera picture

1. Make sure each camera (transmitter) is within

range, and that no large obstructions are blocking the signal.

2. Try repositioning the camera, receiver or both to improve the reception quality.
3. If a camera is positioned close to the receiver point antenna away from the receiver.
4. Reposition other nearby equipment transmitting on the 900MHz frequency.
5. Adjust the antenna for the camera, receiver or both to obtain best image.

Audio problems

1. Ensure the volume is turned up sufficiently on the Monitor (or TV).
2. Make sure the sound is within the microphone range.
3. If the unit emits a loud wailing sound (feeds back), try moving the camera away from the receiver or angle the receiver differently.

SPECIFICATIONS *(Subject to change without notice.)*

CAMERA

TV System.....	NTSC
Integrated Lens.....	5.6mm, F1.8 fixed focus
Resolution.....	360 horizontal TV Lines
High-Speed Electronic Shutter	1/60 - 1/15,000 sec
Image Sensor.....	1/3" CMOS

Min. Illumination.....	0 lux up to 3 feet, 0.5lux up to 10 ft
Voltage.....	9VDC
Current Consumption.....	150mA maximum
Overall Size.....	2.35"W x 2.74Hx3.16D
Frequency Range.....	902 - 928 MHz
Modulation.....	FM
Channel Selection	Manual
Case Finish.....	UV resistant ABS plastic

RECEIVER

Voltage.....	9VDC
Current Consumption.....	100 mA maximum
Frequency Range.....	902 - 928 MHz
Output.....	Audio/Video
Overall Size.....	3.8" L x 2.8" W x 0.6" H (Without antenna)

GENERAL

Operating Temperature.....	14°F to 104°F (-10°C to 40°C)
Humidity.....	Less than 85%

WARRANTY

ONE-YEAR LIMITED WARRANTY: Jasco Products Company warrants this product to be free from manufacturing defects for a period of one year from the original date of consumer purchase. This warranty is limited to the repair or replacement of this product only and does not extend to consequential or incidental damage to other products that may be used with this unit. This warranty is in lieu of all other warranties express or implied. Some states do not allow limitations on how long an implied warranty lasts or permit the exclusion or limitation of incidental or consequential damages, so the above limitations may not apply to you. This warranty gives you specific rights, and you may also have other rights which vary from state to state. If unit should prove defective within the warranty period, return prepaid with dated proof of purchase to:

Jasco Products Company

10 E. Memorial Road, Oklahoma City, OK 73114

⚠ WARNING**Risk of fire and shock**

- Only use the supplied cUL listed AC to DC adapter.
- The supplied adapter is for indoor use only.
- Do not run the camera cable inside walls; when securing the cable, do not cut or puncture
- Do not use in wet locations

FCC STATEMENT

This device complies with part 15 of the FCC rules. Operation is subject to the following two conditions:

- (1) This device may not cause harmful interference.
- (2) This device must accept

any interference received, including interference that may cause undesired operation.

FCC NOTE: The manufacturer is not responsible for any radio or TV interference caused by unauthorized modifications to this equipment. Such modifications could void the user's authority to operate the equipment.

NOTE: This equipment has been tested and found to comply with the limits for a Class B digital device, pursuant to Part 15 of the FCC Rules. These limits are designed to provide reasonable protection against harmful interference in a residential installation. This equipment generates, uses and can radiate radio frequency energy and, if not installed and used in accordance with the instructions, may cause harmful interference to radio communications. However, there is no guarantee that interference will not occur in a particular installation. If this equipment does cause harmful interference to radio or television reception, which can be determined by turning the equipment off and on, the user is encouraged to try to correct the interference by one or more of the following measures:

- Reorient or relocate the receiving antenna.
- Increase the separation between the equipment and receiver.
- Connect the equipment into an outlet on a circuit different from that to which the receiver is connected.
- Consult the dealer or an experienced radio/TV technician for help.



is a trademark of General Electric Company and is used under license to Jasco Products Company LLC, 10 E. Memorial Road, Oklahoma City, OK 73114 www.jascoproducts.com