

Dome Sensor LED Indicators

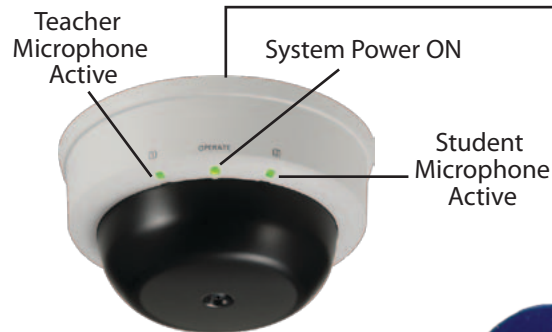

Turn power on to activate classroom sound system



Press and hold PWR button to turn microphone On/Off

A momentary press of PWR button will Mute/Unmute microphone audio

Press and hold for 3 seconds to activate **SAFE** alert system.

See the other side for detailed **SAFE** System information

Front Panel Controls

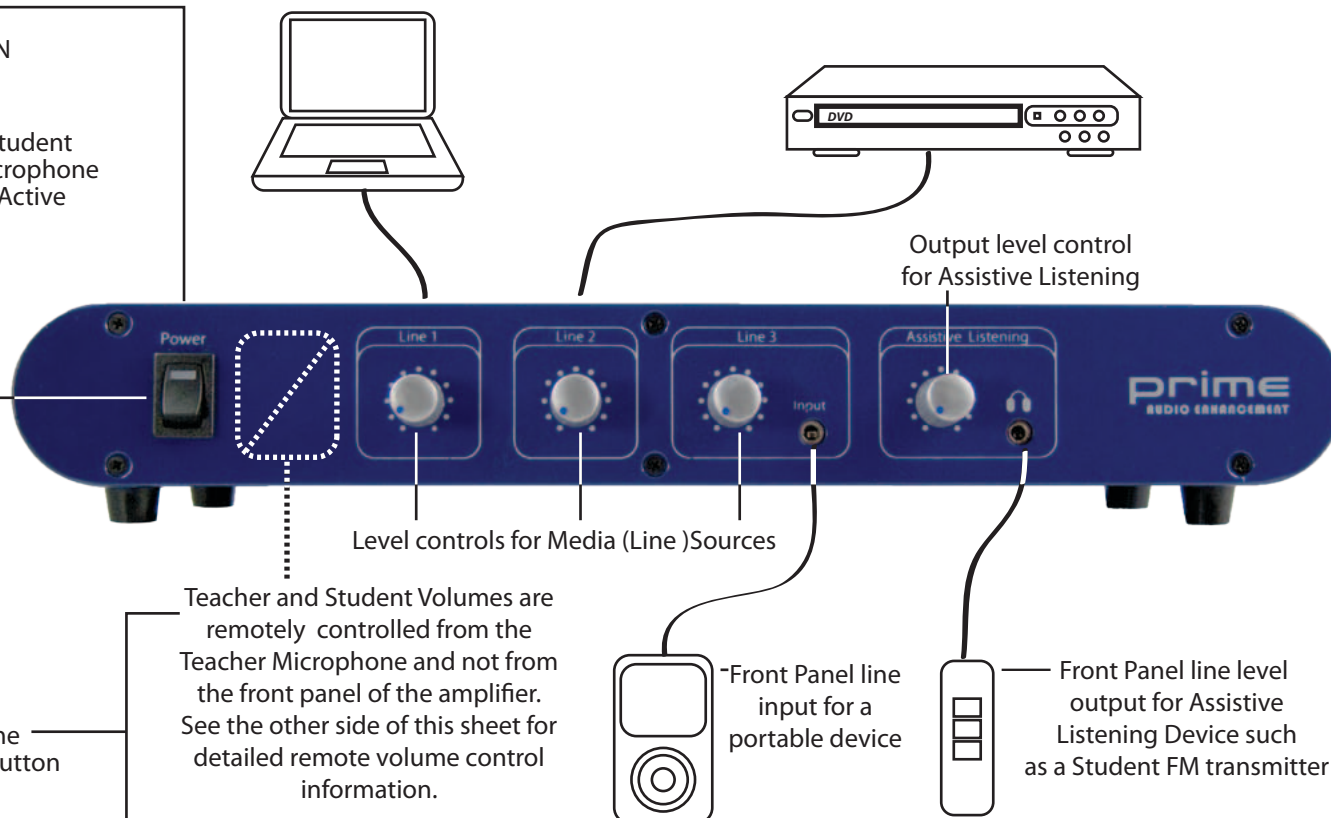

Teacher and Student Volumes are remotely controlled from the Teacher Microphone and not from the front panel of the amplifier. See the other side of this sheet for detailed remote volume control information.

Charging the Microphone

Step 1. Position the Micro Teardrop Teacher Microphone with the black back of the microphone facing towards you.

Step 2. Align the charger connector so that the small triangle shaped arrow on the charging connector is facing you.

Step 3. Insert the connector into the microphone.



Optional **SAFE** System Alert Activation

[Requires installation of **SAFE** (Security Alert For Education) System components]



If your classroom is equipped with the **SAFE** System you can send an alert by pressing and holding the Function button on your microphone. Three Blue LEDs will illuminate on the face of the microphone and three Red LEDs will illuminate on the ceiling mounted dome sensor indicating that the ALERT signal has been sent.

Press and hold the Function button for 3 seconds



You can tell that the microphone sent the Alert signal when the OWN, OTHER, and LINE LEDs are all Blue in color.

The three LEDs on the ceiling mounted dome sensor will turn Red indicating that the signal has been sent.



Remote Volume Control of the Teacher and Student Microphones

Teacher Microphone (OWN) Level Adjustment



UP Volume control button

DOWN Volume control button

Press either the UP or DOWN arrow button to increase or decrease the level of the Teacher microphone. A blue LED over the "OWN" (for own microphone) will flash with each press.

The Green LED (#1) on the dome sensor will blink with each button press of UP or DOWN.

Blinks with each button press



Student Microphone (OTHER) Level Adjustment



The "SELECT" button determines which microphone level will be controlled by the UP/DOWN buttons

To adjust the Student (OTHER) volume, first press the "SELECT" button so the blue LED over the "OTHER" label comes on. Now press the UP/DOWN buttons to control the level of the "OTHER" microphone which is typically the Student microphone.

Blinks with each button press

