



VIVO 105 **User Manual**



NewSound Hearing Aid

NewSound

VIVO105

Congratulations! Welcome to a New Life created by NewSound Behind-The-Ear hearing instrument(called BTE here). Please read this manual carefully before using.

Intended use

Hearing instrument is a kind of electronic device which amplifies sound from your surroundings. It is used to help hearing impaired people recover hearing ability by compensating for the hearing loss for them. Your BTE is only one type of hearing instrument.

Scope

This user manual only applies to VIVO105 BTE.

Precautions

For middle ear infection patient, hearing instrument can't be worn until cured or follow your doctor's recommendation. Please consult your hearing healthcare professional first when you have any questions about your hearing or your hearing instrument.

THE MANUFACTURER RESERVES THE RIGHT TO MODIFY WITHOUT ANY PRELIMINARY OPINION THE TECHNICAL SPECIFICATIONS OF THE PRODUCT.

BTE's whose earhook connected with earmold (eartip) fits comfortably in your canal.



1. Earhook
2. Volume Control
3. N-H Switch
4. ON-OFF Switch
5. Battery Door

How to Wear Your Hearing Instrument

VIVO105

Insert your earmold (or eartip) first, and then place the hearing instrument behind your ear.

Insert your earmold (or eartip) correctly, on the basis of patiently practice. Please consult your hearing healthcare professional when you have some difficulty inserting the earmold.

Step 1. Hold the earmold (or eartip) by the outer side near the tubing with your thumb and forefinger. Insert the canal tip of the earmold into your ear canal gently. Then softly press the earmold into place with your fingertip.

Step 2. Carefully place the BTE behind your ear with the ear hook and earmold tubing wrapped over the top.



NOTE:

Before placing the BTE earmold (or eartip) into your ear canal, insure the battery is inserted properly and the battery door is closed securely. Ensure the volume control is turned off before inserting the earmold (or eartip).

ON And OFF Function

VIVO105

Insert battery, and then close battery door. Set ON-OFF switch to "ON" for turn on instrument.

Turn off your hearing instrument by setting ON-OFF switch to "OFF". Battery door doesn't need to be open completely.

Note: Never force the battery door open or closed.

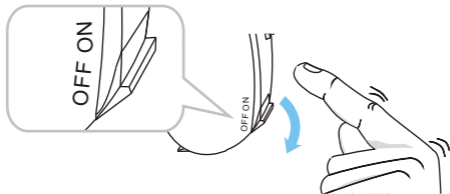

Volume Control

VIVO105

To adjust the volume, rotate the volume control by your fingertip up and down. The numbers indicates an orientation for the current volume setting.

To increase the volume, turn the volume control up. To decrease the volume, turn the volume control down.

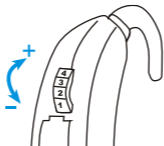

N-H Switch

VIVO105

Position "N": The instrument is switched on.

Position "H": Background noise reduction function.

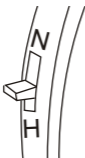

Replacing the battery

VIVO105

1. Turn off instrument by set "ON-OFF" switch to "OFF".
2. Rise battery door from the button.
3. Remove the old battery.
4. Remove the protective foil from the new battery.
5. Insert the new battery sure with the plus (+) up.
5. Close the battery door
6. Set "ON-OFF" switch to "ON" for turn on instrument.

Important: Handle the battery door gently. The operation requires only a minimum of force. If there is any resistance when closing the battery door, ensure that the battery is correctly inserted. The door can not be closed if the battery is reversed.

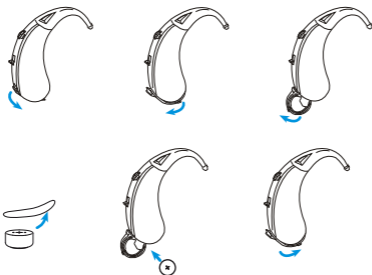

Troubleshooting

VIVO105

NO SOUND	
Volume may be turned down	Turn volume control up
Battery may be low or dead	Replace a new battery
Hearing instrument may not be working	Turn on the Hearing instrument
Start up delay is on	Wait a few seconds for device to turn on
Tip or earmold is blocked with moisture or debris	Use the vent cleaning tool to clear the tip or earmold
NO LOUD SOUND	
Earmold or tip not inserted properly	Re-insert earmold or tip
Battery may be low or dead	Replace the battery
Eartip or earmold is blocked	Clear the eartip or earmold
Program settings not optimum	Consult your hearing healthcare professional
Your hearing has changed	Consult your hearing healthcare professional
You may have excessive cerumen	Consult your hearing healthcare professional
Volume may be turned down	Rotate volume control wheel up

Technical Data

VIVO105

IEC-118-7/94(2cc-coupler) Operating Voltage 1.3V

Peak value(dB):125dB

Output at 1600Hz(dB): 120dB

Maximum gain (dB):45dB

Gain at 1600Hz(dB): 40dB

Total Harmonic Distortion: 1.3%

Equivalent Input Noise: 29dB

Battery Size:675A

Working Condition

VIVO105

Transportation and Storage

- ➔ Range of environmental temperature: -40~+70°C
- ➔ Range of relative humidity: 10%~100%
- ➔ Rang of atmospheric pressure: 500~1600hPa

Operation

Products could work in following combined environments and Inconformity with the standard mentioned in this user manual.

- ➔ Range of environmental temperature: -10~+40°C
- ➔ Range of relative humidity: 10%~90%
- ➔ Rang of atmospheric pressure: 700~1060hPa



Manufacturer

Xiamen NewSound technology co.ltd.
S305, Weiye Building, Innovation Center,
Xiamen Torch Hi-Tech Industrial Development Zone, P.R.C
www.usnewsound.com

USNewSound LLC
Headquarter
3948 Addison Woods Road,
Frederick, MD 21704-7904, U.S.A.
Email: sales@usnewsound.com
www.usnewsound.com



European Representative

Wellkang Tech Consulting
Suite B, 29 Harley Street, LONDON W1G9QR,
United Kingdom
www.CE-marking.com

NOTE: Detailed technical data for each models can be find in appendix.

NewSound

New sound , New life



[Http:// www.usnewsound.com](http://www.usnewsound.com)