

PLIKO COMBINATION

Dear Customer,

Thank you for choosing the Mamas & Papas Pliko Combination.

The stylish lightweight Pliko pushchair is an ideal as either a chassis or pushchair when travelling by car, public transport or on holiday, thanks to its easy and quick umbrella folding action.

The Mamas & Papas Primo Viaggio Car Seat and the Navetta Carrycot attach to the pushchair when it is converted into a chassis using the Surefix 'right first time' attachment system to give you the perfect all round travel solution.

CONTENTS

Subject	Page No.
Product Information	2
Instructions for safe use	3
Features	4
Opening the pushchair from the box	5
Attaching the wheels	6
Fitting & removing the basket	7
Fitting the cup holder	8
Fitting, adjusting & removing the bumper bar	9
Adjusting the handle length	10
Chassis or pushchair mode	11
Converting the chassis into a pushchair.....	12/13
Removing the cover and backrest	14/15
Adjusting the backrest	16
Operating the adjustable legrest	17
Operating the swivel wheels	18
Operating the brakes	19
Using the ride-on plate	19
Attaching the Navetta hood	20
Removing the Navetta hood	20
Folding the pushchair	21
Opening the pushchair	22
Using and adjusting the harness	23
Attaching the Navetta apron to the pushchair	24
Attaching the raincover to the pushchair	25
Fitting the Primo Viaggio car seat - Chassis mode	26/27
Fitting the Navetta carrycot - Chassis mode	28/29
Removing the fabric cover	30/31
Fitting the pram liner (accessory)	32/33
Fitting a footmuff or seat pad (accessory)	34
Care and maintenance	35

PRODUCT INFORMATION

This pushchair has been designed and tested to comply with the latest British and European safety standards.

IMPORTANT: Read these instructions carefully and keep them for future reference. Your child's safety may be affected if you do not follow the instructions.

- This pushchair is designed for children from birth to 15kg (3 years of age approximately)
- The Primo Viaggio Car Seat can be attached to the pushchair when converted into a chassis
- The Navetta Carrycot can be attached to the pushchair when it is converted into a chassis
- The Pushchair comes equipped with a five-point harness. Always use the harness when your child is in the seat unit
- The suspension on all four wheels gives your child a comfortable ride
- A footrest that can be adjusted to two positions
- A backrest that can be adjusted to four positions
- A shower resistant removable fabric hood (supplied with the Navetta carrycot)
- Adjustable handle length for added comfort
- Lockable swivel wheels for easy manoeuvring
- An opening, adjustable and removable bumper bar
- A removable shopping basket
- A removable PVC raincover
- The pushchair is free standing once it has been folded

ACCESSORIES

The Mamas & Papas range of co-ordinating pram and pushchair accessories are available. This range includes bags, footmuffs, sun canopies, raincovers, pram bedding & mattresses. Also included are pram toys



AFTER SALES SERVICE: If you need assistance, spare parts or you are unhappy with any aspect of the goods please contact **Customer Care** on: +44 (0)845 268 2000, or e-mail us at: customer.care@mamasandpapas.com
Visit our website at www.mamasandpapas.com for the latest product information.

INSTRUCTIONS FOR SAFE USE

- **WARNING: A CHILD'S SAFETY IS YOUR RESPONSIBILITY.**
- **WARNING: IT MAY BE DANGEROUS TO LEAVE YOUR CHILD UNATTENDED.**
- **THIS PRODUCT IS NOT SUITABLE FOR RUNNING OR SKATING.**
- **WARNING: ANY LOAD ATTACHED TO THE HANDLES AFFECTS THE STABILITY OF THE PRAM/PUSHCHAIR.**
- Always ensure that your pushchair is fully erect and all locking clips are engaged. (Take particular care if the PVC Raincover is fitted. Check that it is not entangled or preventing the locking mechanism from functioning correctly).
- Your pushchair is supplied with a five-point body harness. We recommend that the harness is worn by your child at all times. Ensure that the harness is correctly adjusted, providing a snug fit around your child. Adjustments can be made using the buckles on the shoulder, waist and crotch straps. Please refer to the "Using & adjusting the harness" section in these instructions. The pushchair is supplied with 'D' ring harness attachment points. These are located on either side at the base of the backrest and are for fitting a separate harness conforming to BS 6684 if required.
- Always ensure the brakes are correctly engaged whenever the pushchair is left for any reason, even if only for a short time on a flat surface.
- Care should be taken when using any PVC cover. Regularly check that your baby is comfortable and not over heating. There are mesh ventilation panels on the sides of the cover. These are essential to aid the flow of cool air around your baby. Unless it is raining, the raincover should either be removed or the top section opened, see 'Attaching the Raincover' section on page 25.
- Always ensure your child is clear of moving parts before you adjust the position of the backrest, footrest or canopy.
- Always manoeuvre your pushchair up and down kerbs and steps gently. Do not let your pushchair drop. Carry it up stairs whenever possible.
- Never overload your pushchair with additional goods.
- Do not hang shopping from the handles. Do not use any replacement parts or accessories e.g. child seats, raincovers, stand-on platforms etc, except those recommended or supplied by Mamas & Papas. The use of non-approved replacement parts or accessories may damage or make your pushchair unsafe.
- Never force your pushchair. Adjustments and locks should be free and easy to operate.
- Do not store your pushchair in a damp place. Always allow the fabric to dry naturally away from direct heat.
- The basket supplied with your pushchair is designed to hold a maximum of 3kg. Excessive weight could damage the basket or impede the safe operation of the pushchair.
- We recommend that you fit a Mamas & Papas Sun Canopy to shade your child from direct sunlight. We recommend that this is used in conjunction with the appropriate sun protection cream and clothing.

FEATURES

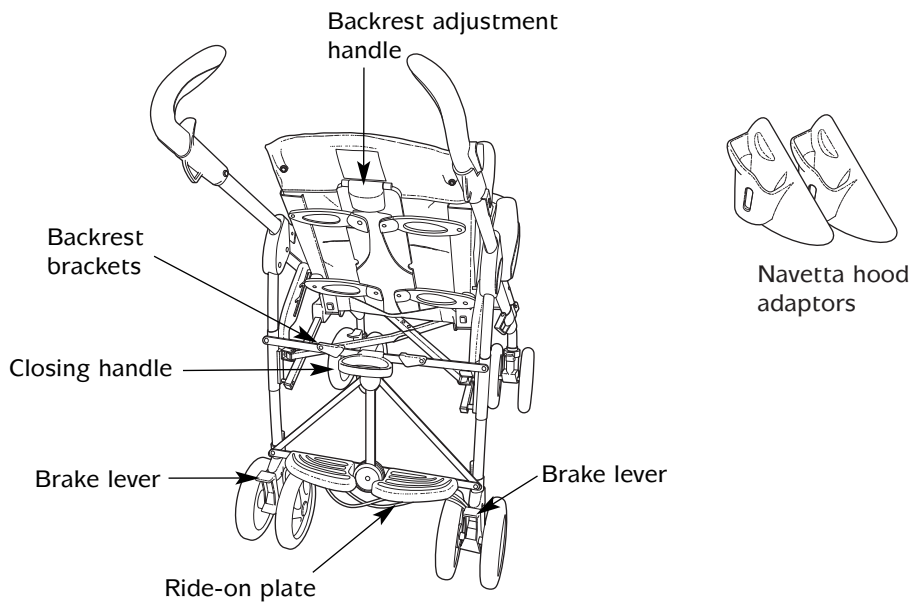
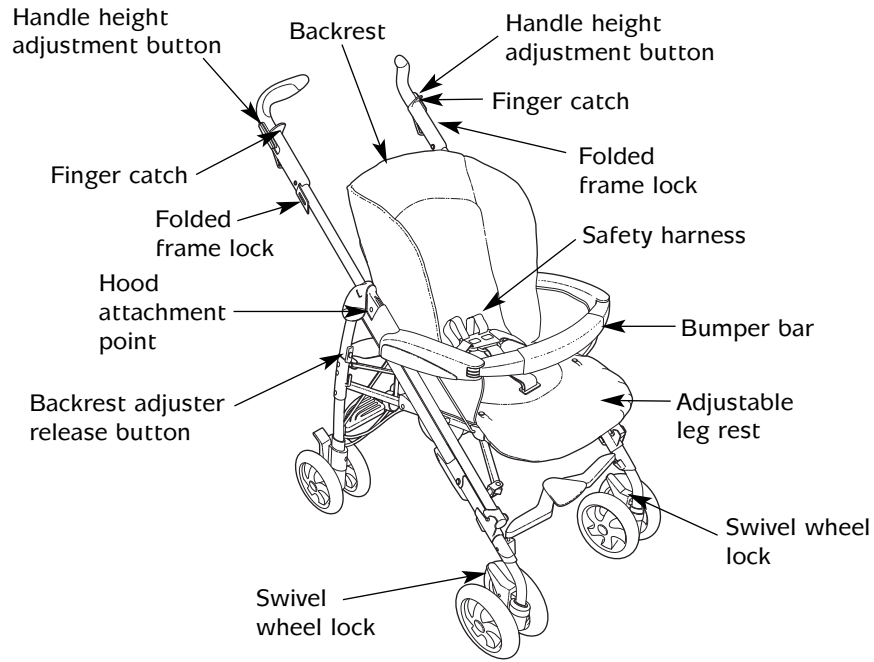

OPENING THE PUSHCHAIR FROM THE BOX

Remove the protective caps from the ends of the handle frame. Never attempt to use the pushchair with the covers fitted as the locks will not engage.

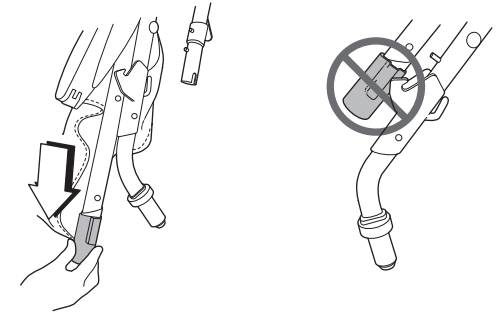

Release the finger catches located under both of the handles by pulling them upwards.

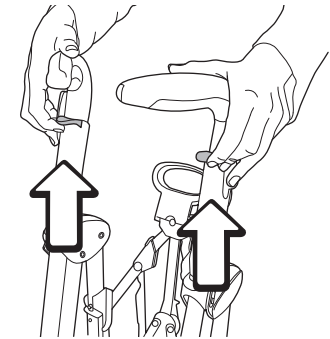

Lift the pushchair upwards and the frame will automatically start to open. You may need to press down lightly on the seat to ensure the safety locks have engaged. There are two safety locks, one on each side of the pushchair.

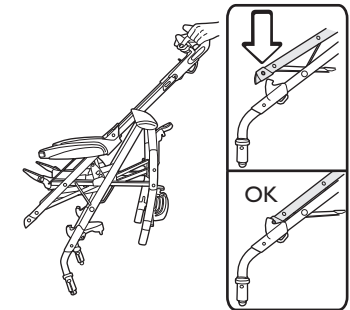

Ensure the handle in the centre of the pushchair's back is pushed down as far as possible by gently pushing the lever plates at the back fully down.

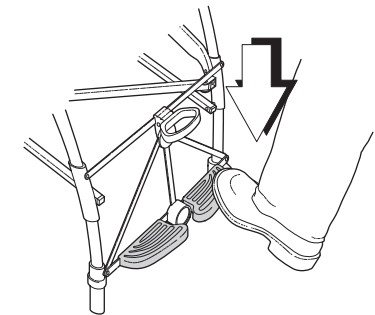

ATTACHING THE WHEELS

Attaching the front wheels:

Slot the two front wheels onto the ends of the pushchair's front legs.

Push the wheel housing onto the end of the leg until it locks into position.

Always check that the wheels are correctly fitted by attempting to pull them off again.

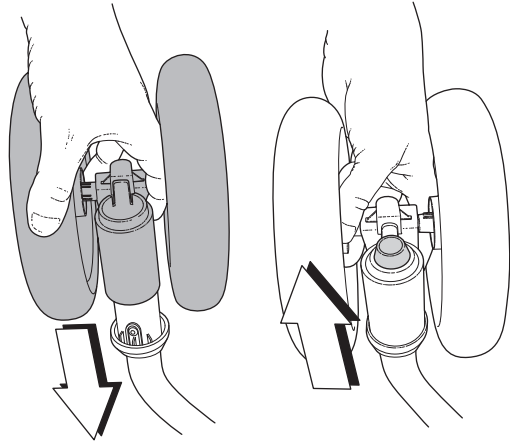

Attaching the back wheels:

Slot the rear wheels onto the back legs of the pushchair. Ensure that the brake peddles on the wheels are facing out from the back of the pushchair. Push the wheels down as far as they will go.

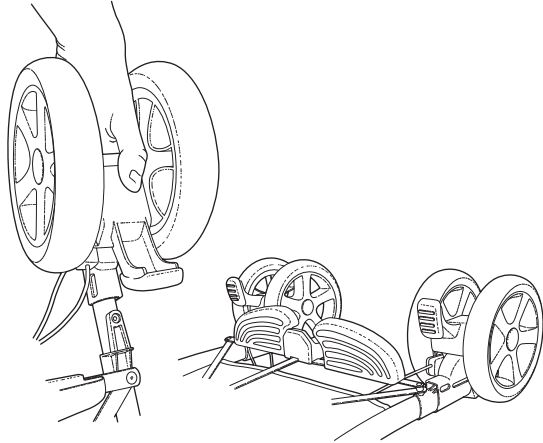

Check that the pins in the pushchair's legs are protruding through the wheel housings. Check the wheels are correctly fitted by trying to pull them off again.

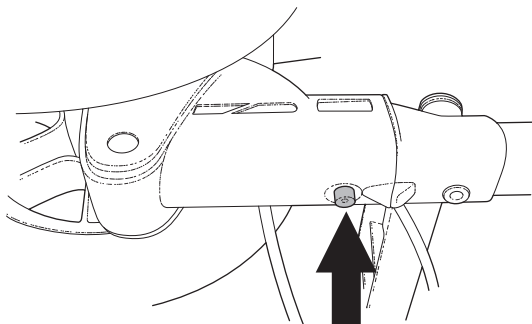

FITTING & REMOVING THE BASKET

The back section of the basket has four webbing loops and these fit over the four hooks attached to the back legs of the pushchair.

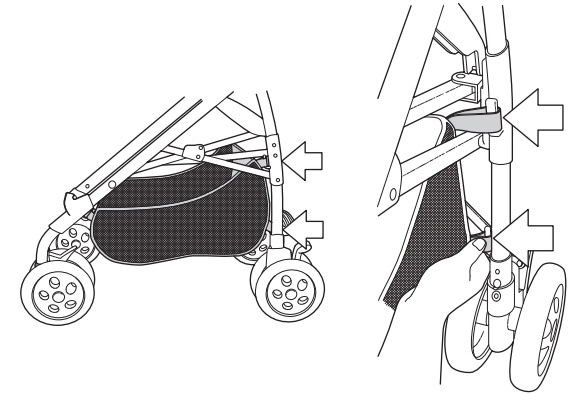

The two front webbing loops fit over the hooks on the front legs of the pushchair. The hooks are situated just below the frame locks on either side of the frame.

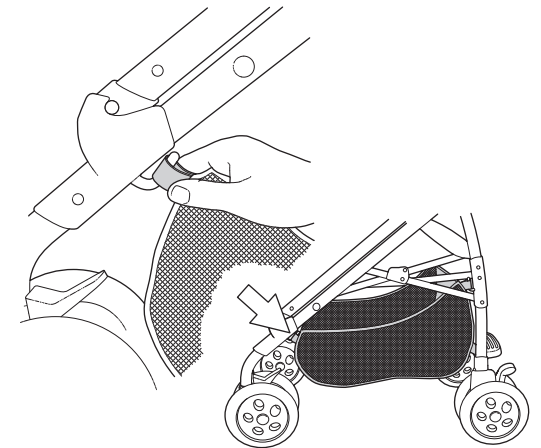

We recommend that you do not exceed a load of 3kg in the basket. Excessive weight could lead to the basket becoming damaged and the pushchair becoming unstable
Folding the pushchair with the basket fitted: When folding the pushchair always check that the basket is not trapped or preventing the pushchair from locking.

FITTING THE CUP HOLDER

The drinks holder can be attached to either the left or right hand side of the pushchair.

To fit the cup holder, slide the cup holder down onto the attachment point on the handle as shown in the diagram.

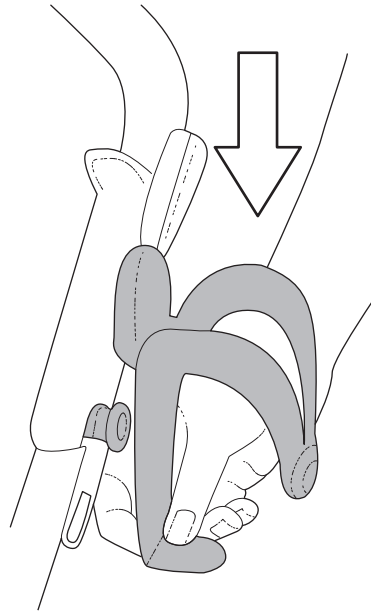

Click

Continue to push the cup holder down onto the attachment point until it 'clicks' into position.

Never place items weighing more than 0.5 Kg (1lbs) in the cup holder.

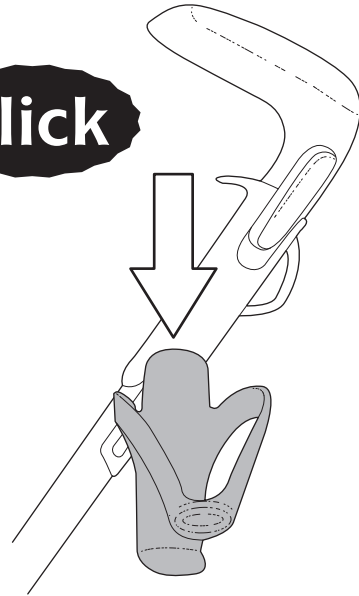

It is dangerous to place hot drinks in the cup holder. Never hang additional items on the cup holder.

FITTING THE BUMPER BAR

Remove the caps in the ends of the armrests by pushing the button on the underside of the armrest upwards.

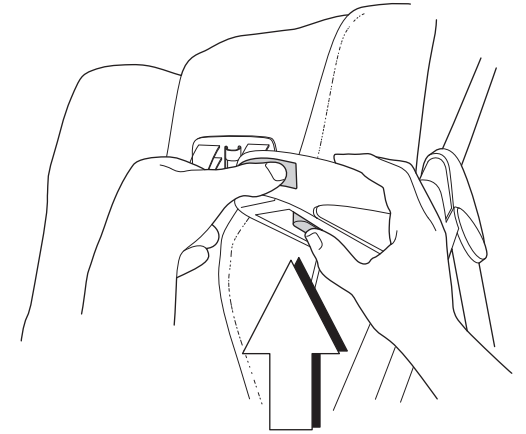

With the button still pushed in, slide the cap out of the armrest. Repeat the process for the other armrest.

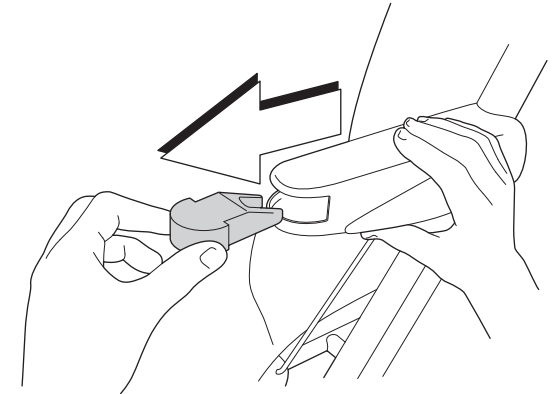

Insert the two ends of the bumper bar into the holes in the ends of the armrests. Push the bumper bar in until they click into position.

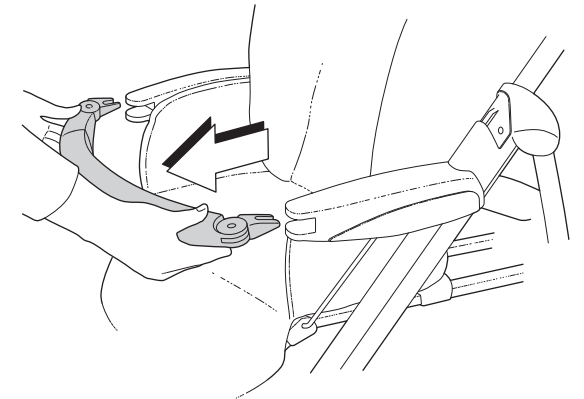

ADJUSTING THE HANDLE LENGTH

To lengthen the handle:
Push the top of the button in just below the hand-grip and pull towards you. Once the handle has been adjusted it will automatically lock into place.

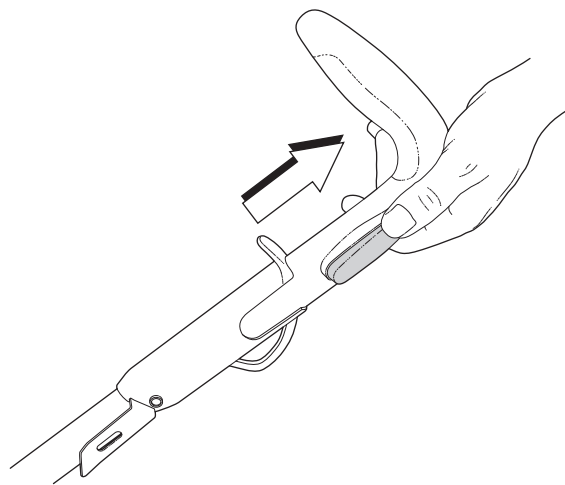

To shorten the handle:
Press the bottom of the button in and push the grip away from you.

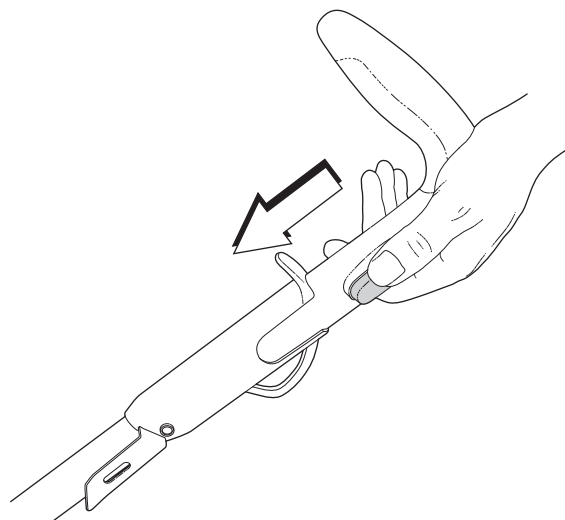

CHASSIS OR PUSHCHAIR MODE

Once all of the assembly has been completed the chassis can be combined with the Navetta Carrycot (see pages 28 to 29 for fitting instructions) or the Primo Viaggio Car Seat (see pages 26 to 27 for fitting instructions).

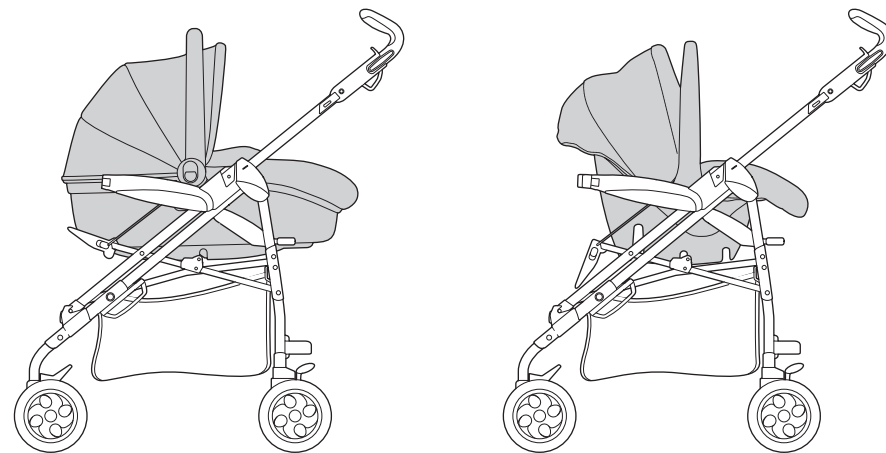

The chassis can also be converted into a pushchair by attaching the backrest and fabric cover (see pages 14 to 15 for fitting instructions).

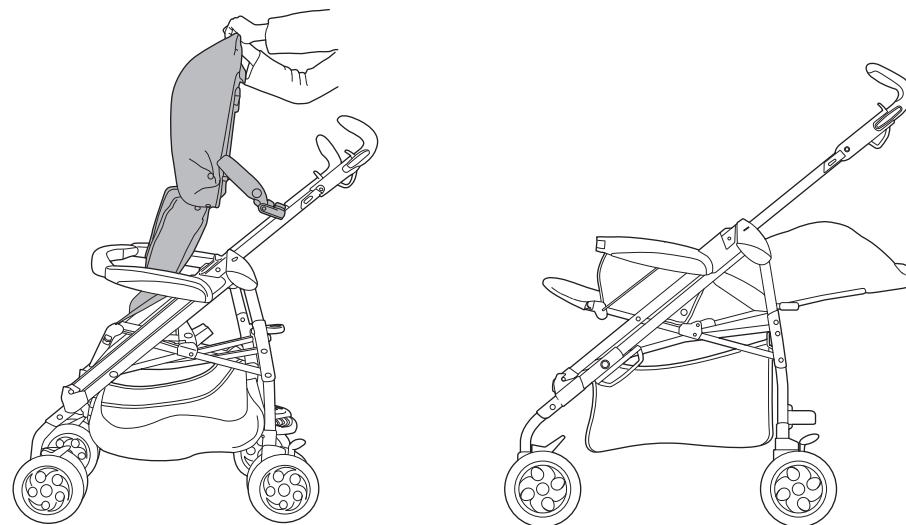

CONVERTING THE CHASSIS INTO A PUSHCHAIR

The Pliko combination can be used in either the chassis mode or the pushchair mode. This section shows how to fit the cover and backrest. Ensure that the two levers on the back frame are lowered as shown in the diagram.

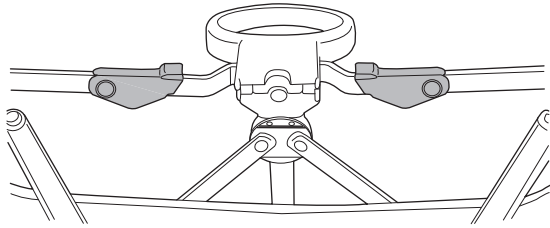

Place the cover and backrest onto the seat of the chassis as shown in the diagram.

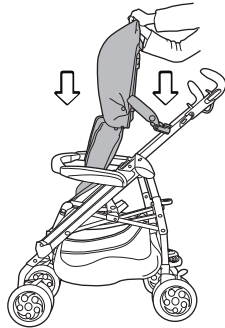

Insert the two ends of the backrest into the attachment brackets at the back of the chassis. Press the buttons on the ends of the backrest inwards (1) and fully insert the backrest into the attachment brackets (2).

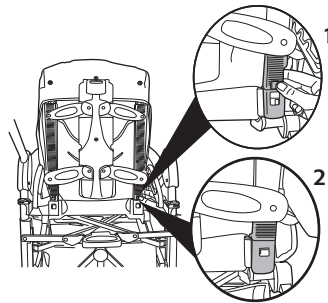

Attach the backrest adjusters to the rear legs of the chassis. Turn the attachment brackets on the backrest adjusters upwards (A). Align the attachment brackets with the braces on the pushchair's rear legs (B).

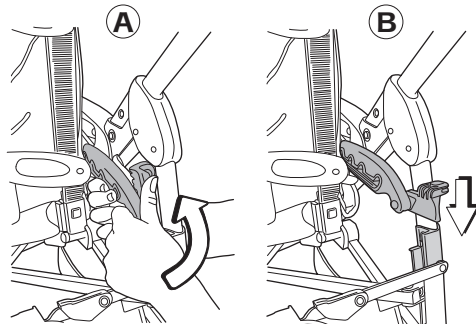

Push the two attachment brackets down until they click into place on the braces. Check they are fully attached by attempting to pull them out again.

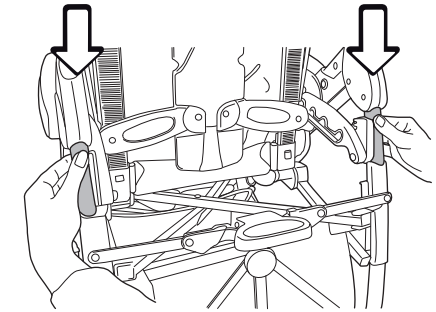

Fasten the sides of the cover to the chassis armrests as shown in the diagrams.

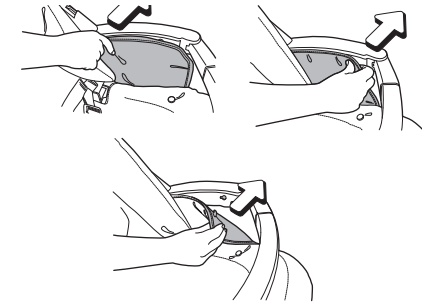

Insert the levers for the legrest into the pockets in the cover as shown in the diagrams.

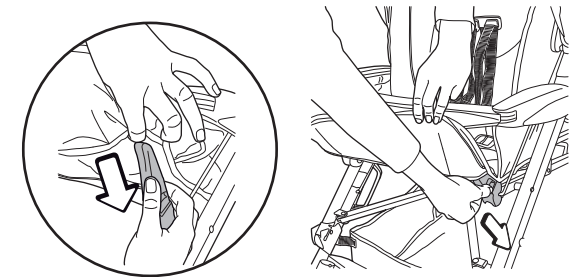

Fasten the front of the cover to the chassis using the press studs. Slot the end of the crotch strap through the seat cover and the seat of the chassis. Feed the waist sections of the safety harness around the sides of the cover.

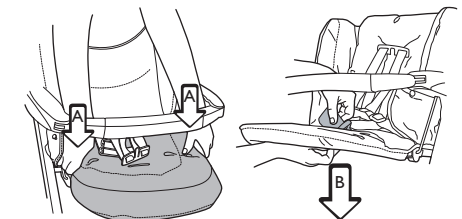

REMOVING THE COVER AND BACKREST

Unfasten the sides of of the covers as shown in the diagrams.

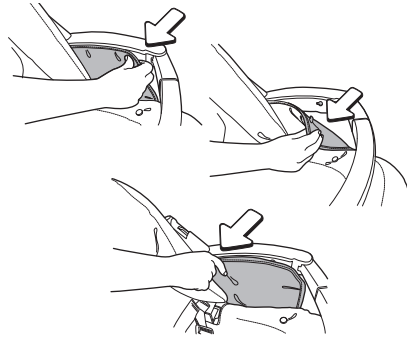

Slot the end of the crotch strap through the seat of the chassis and the slot in the seat cover.
Unfasten the the press studs on the front of the cover.

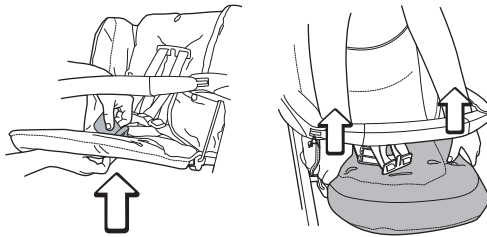

Pull the legrest cover off the legrest levers.

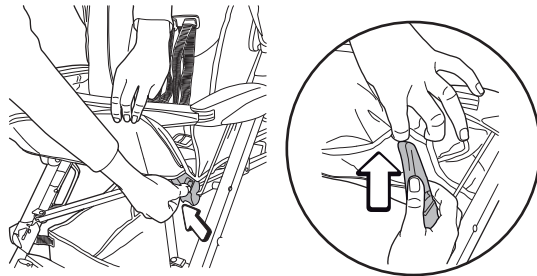

Push the buttons on the two backrest attachment brackets inwards and hold.

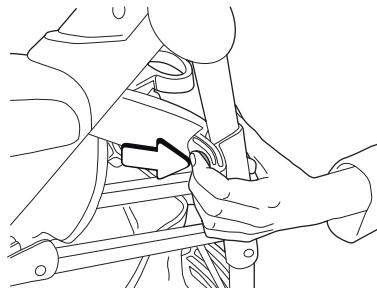

Push the two attachment brackets down until they click into place on the braces.
Check they are fully attached by attempting to pull them out again

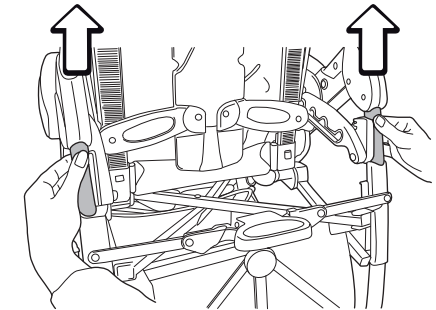

Press the buttons on the ends of the backrest inwards (1).
Lift the two ends of the backrest out of the attachment brackets at the back of the chassis (2).

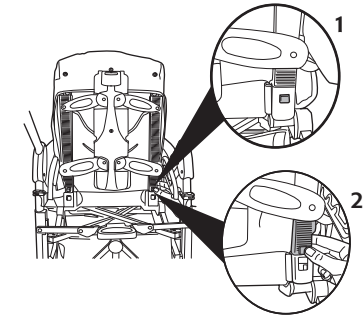

Pull the cover and backrest clear of the chassis.

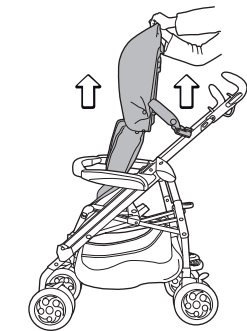

Unfasten the four press studs on the sides of cover and slide the backrest frame out.

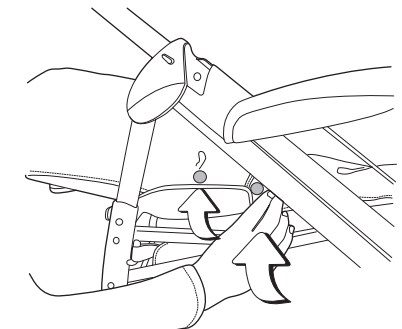

ADJUSTING THE BACKREST

The backrest can be adjusted to one of four positions.

To lower the backrest:

Pull the backrest adjustment handle upwards and lower the backrest into the position you require. Release the handle and move the backrest upwards or downwards until it locks into position.

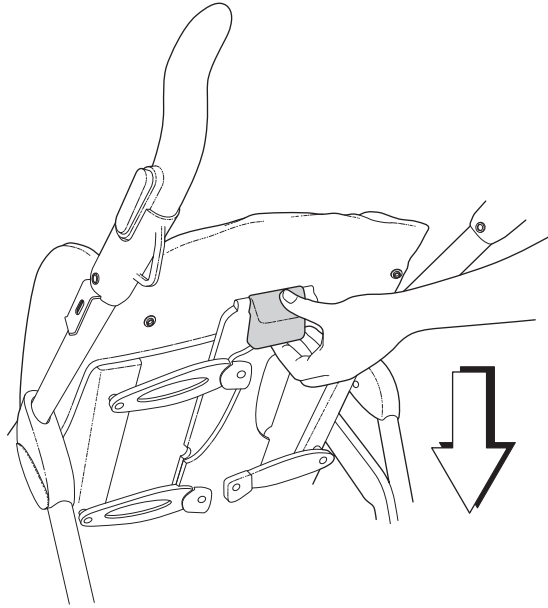

To raise the backrest:

Grip the middle of the backrest and lift upwards until it locks in the position you require.

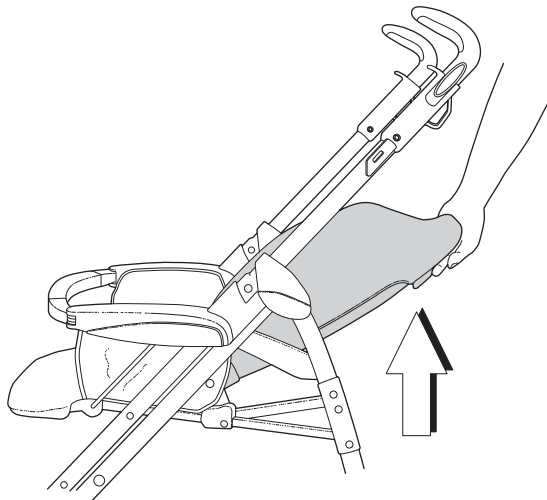

OPERATING THE ADJUSTABLE LEG REST

The leg rest on the front of the pushchair can be adjusted for the comfort of your child and so that the Navetta Carrycot can be attached.

Note: The leg rest must be in the most vertical (down) position when the pushchair is being used by a child that can sit unaided and the backrest is in an upright position.



Positions 1 & 2 are for general use. Position 3 is only used when the Navetta Carrycot is attached to the chassis, see pages 28 to 29 for more information

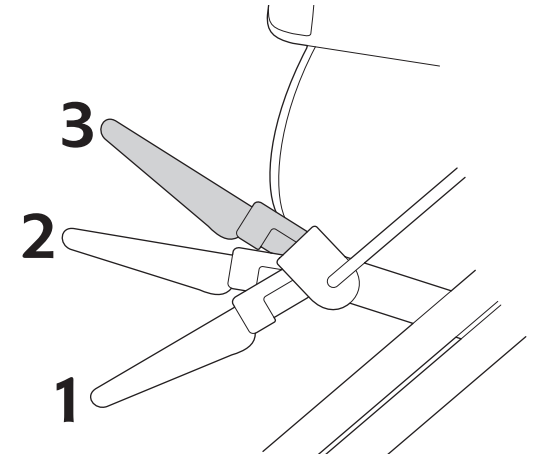

To adjust the leg rest, pull the locks on both sides of the leg rest in the direction of the arrows in the diagram. Now either lift or lower the leg rest whilst releasing the catches, the leg rest will lock automatically into position.

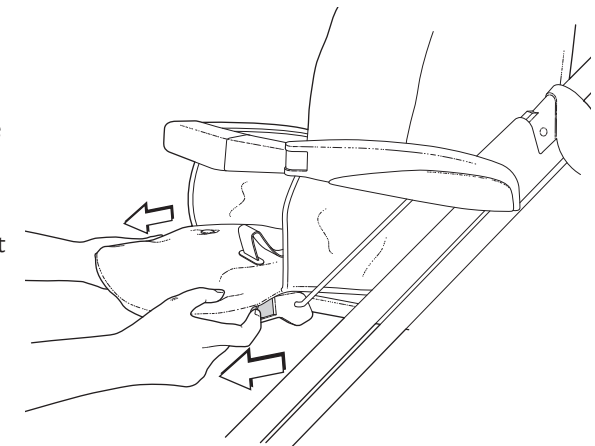

OPERATING THE SWIVEL WHEELS

The two front wheels on the pushchair can be used in either the fixed or swivel mode.



Fixed mode:
Push the catches between the front wheels upwards.
The wheels will now be fixed and will not swivel.

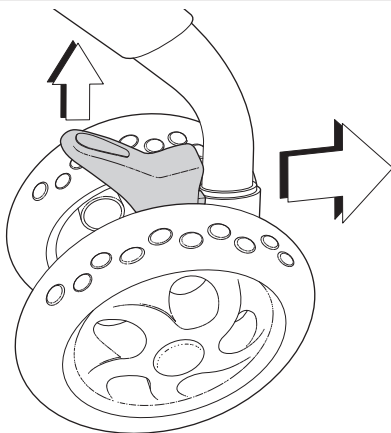

Swivel mode:
Push the catches between the front wheels downwards.
The wheels can now be rotated through 360°.

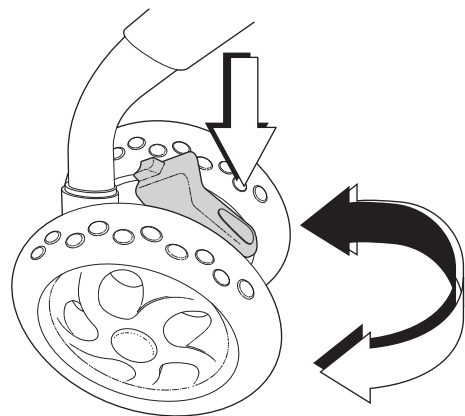

OPERATING THE BRAKES

To engage the brakes:
Press down on both ends of the brake bar with your toes.
Check the brakes are correctly engaged by rocking the pushchair backwards and forwards.

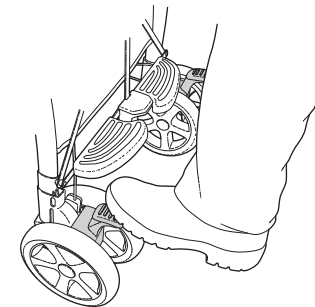

To release the brakes:
Push upwards on both ends of the brake bar with your toes until the pushchair's wheels move freely.

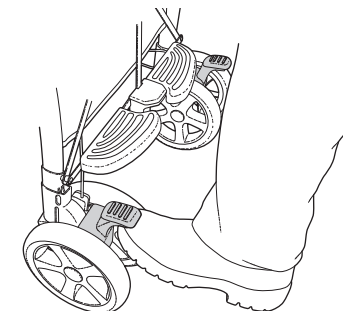

WARNING: Always engage the brakes when you leave or let go of the pushchair for whatever reason.

USING THE RIDE-ON PLATE

The rear ride-on plate can be used to carry an additional child on.

The maximum weight for a child on the ride-on plate is 20 kg (upto a maximum age of 4 years approximatly).

Before using the ride-on plate the hood must be removed and the backrest raised to the highest position.

Do not attempt to use theride-on plate with the backrest lowered.

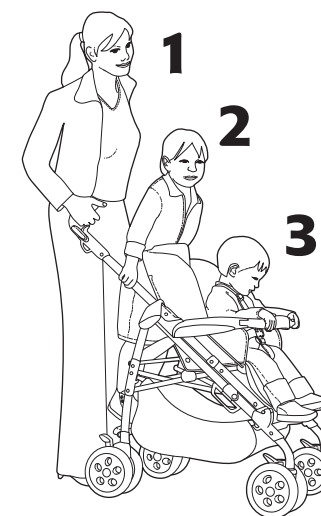

ATTACHING THE NAVETTA HOOD

To fit the Navetta hood to the pushchair:

Remove the hood from the Navetta following the instruction given in the products instruction booklet. Slot the two hood brackets onto the ends of the hood as shown.

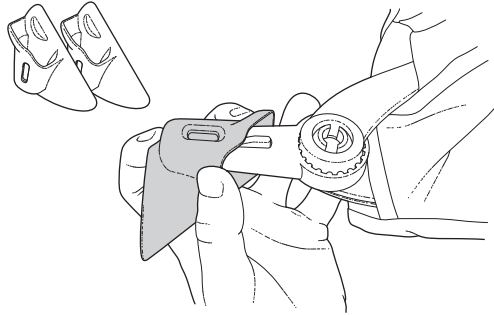

Slot the hood brackets onto the pushchairs frame as shown in the diagram. Undo the zip on the back of the hood to increase the hood length.



Fasten the three press studs on the back of the hood to the three studs on the top of the pushchairs backrest. Push the two tensioning bars down to lock the hood open.

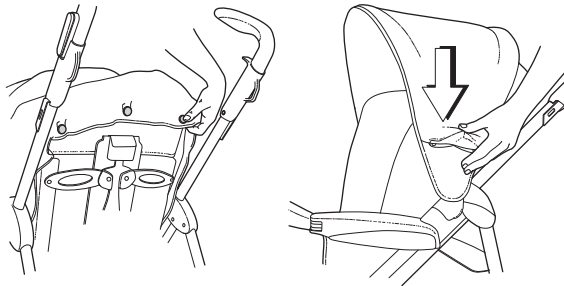

REMOVING THE HOOD

To remove the hood:

Undo all of the press studs and fold the tensioning bars upwards. Hold the hood brackets as shown in the diagram and pull outwards from the pushchair.

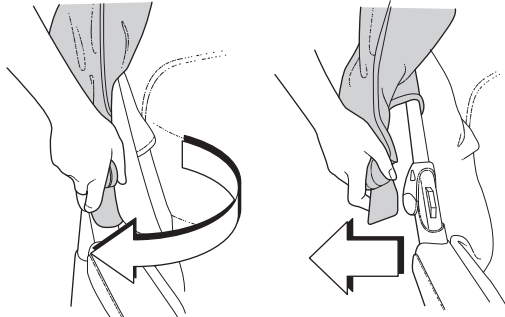

FOLDING THE PUSHCHAIR

Engage the brakes before closing the pushchair.

Pull one of the finger catches upwards until it locks into position, then repeat for the other finger catch.

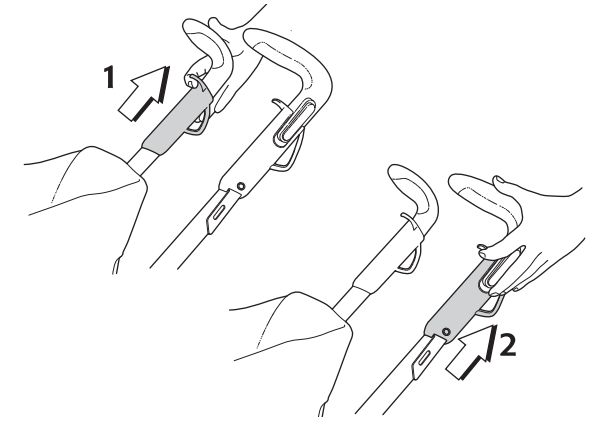

Grip the handle in the centre of the backrest and pull it upwards as shown in the diagram. Continue to pull the handle upwards until the pushchair is fully folded.

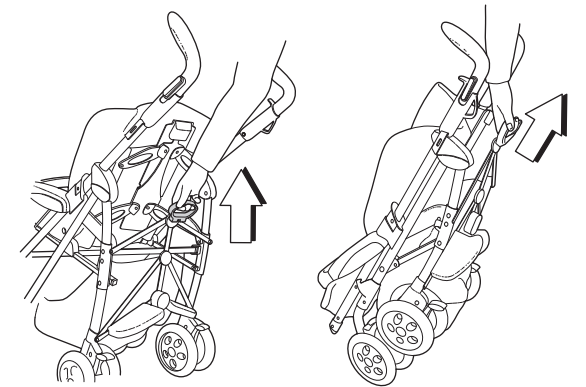

Ensure that the two locking catches below the finger catches lock over the clips on the rear leg attachment moulding, as shown in the diagram.

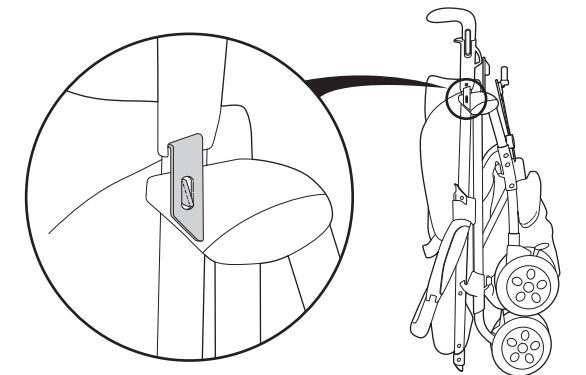

WARNING: Do not push down vertically on the frame when folding. This will cause the ends of the handles to hit the floor and may damage the frame.

OPENING THE PUSHCHAIR

Release the finger catches located under both of the handles by pulling them upwards.

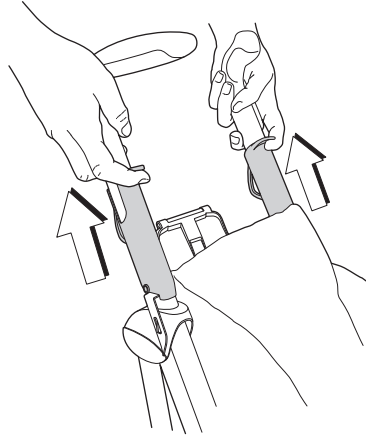

Lift the pushchair upwards and the frame will automatically start to open. Ensure that the pushchair is fully erected to enable the locks to engage. Press down lightly on the seat to ensure the pushchair is fully opened. There are two safety locks, one on each side of the pushchair.

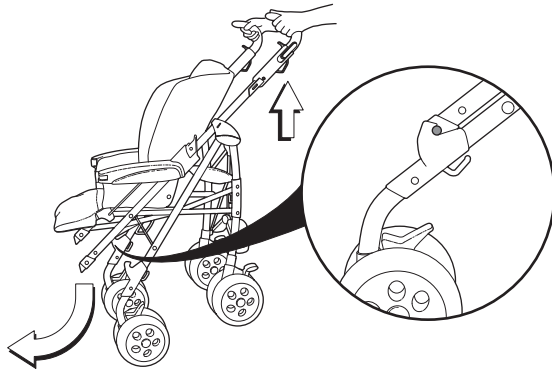

Ensure the handle in the centre of the pushchair's back is pushed down as far as possible by gently pushing the lever plates at the back fully down.

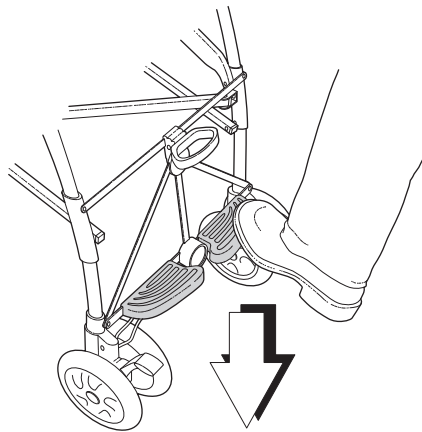

Warning: Ensure that all locking devices are engaged before use.

USING AND ADJUSTING THE HARNESS

Locking the harness: Lock the harness by pushing the tongues on the ends of the waist straps into the buckle on the crotch strap (1). The harness will automatically lock when the tongues have been fully pushed in.

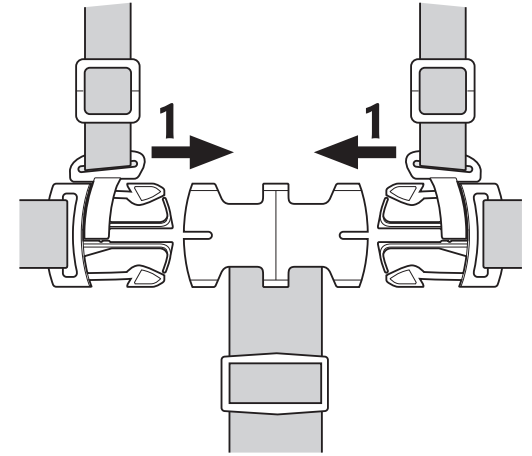

Unlocking the harness: Squeeze the ends of the tongues together (2) and then slide them out of the buckle (3). Your child can now be removed from the pushchair.

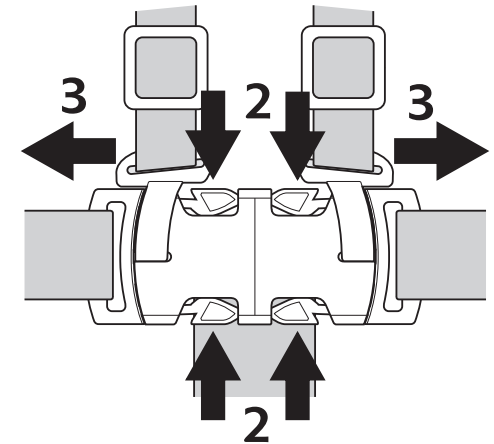

IMPORTANT: Every time you place your child in the pushchair or when you position of the backrest always check that the harness is correctly fitted and the shoulder and waist strap buckles are correctly adjusted and a snug fit around your child.
WARNING: Always use the crotch strap in conjunction with the waist belt.

ATTACHING THE NAVETTA APRON TO THE PUSHCHAIR

Slot the apron behind the bumper bar as shown in the diagram.

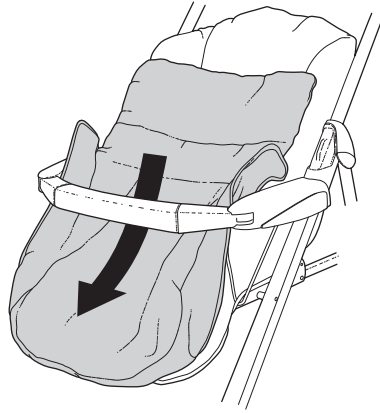

Fasten the zip on the bottom edge of the apron to the zip on the front edge of the footrest cover.

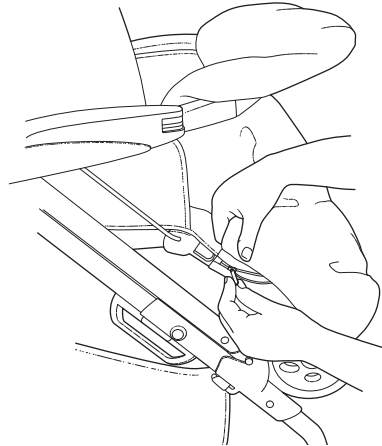

Pull the top of the apron down over the bumper bar and fasten the press studs together. Tuck the sides of the apron around the sides of the pushchair.

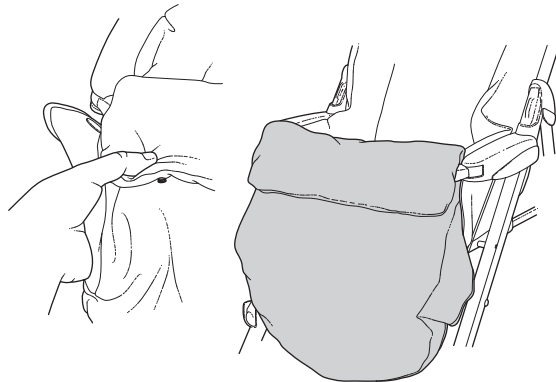

ATTACHING THE RAINCOVER TO THE PUSHCHAIR



Never leave your child unattended in the pushchair with the raincover fitted. This product is designed for outdoor use only. Take care when fitting or adjusting the raincover as undue force may damage the raincover. Open the front of the raincover when inside or in hot weather to prevent your child from over heating.

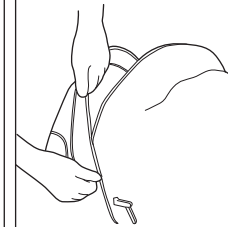

Place the elasticated top of the raincover onto the front of the pushchair's hood.

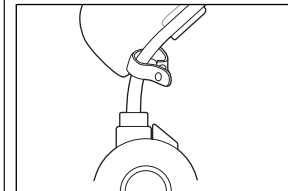

Attach the straps at the bottom of the raincover around the frame below the footrest.

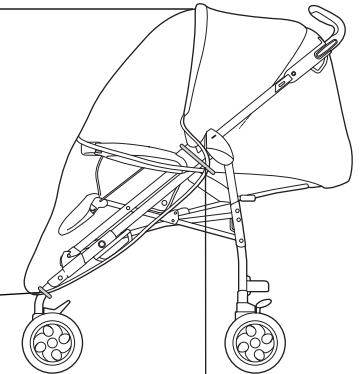

Attach the straps on the sides of the raincover around the frame. Fasten them in place with the press studs on the strap.

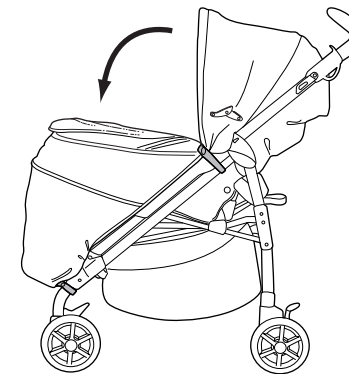
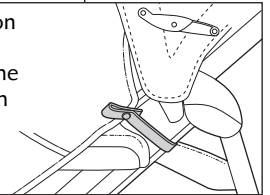

Opening the front of the raincover:
The top of the raincover should be folded onto the apron when taking your child inside or during warm dry spells

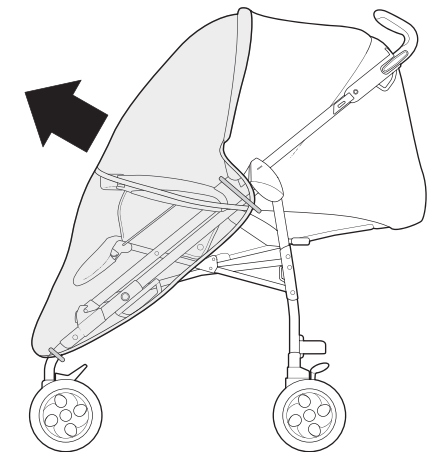

Always remove the raincover before folding the pushchair.

FITTING THE PRIMO VIAGGIO CAR SEAT - CHASSIS MODE

Apply the brakes on the chassis, see page 19.
Attach the bumper bar to the chassis, if not fitted, see page 9.

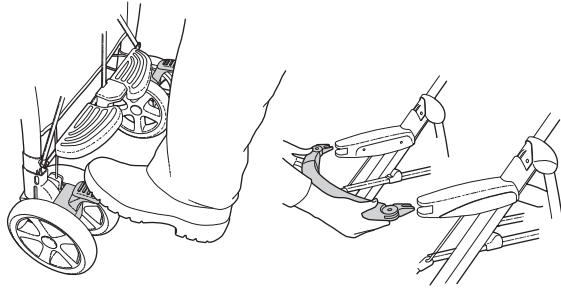

In the corners of the seat of the chassis are there are two attachment brackets. Rotate the attachment brackets upwards as far as they will go. The brackets will lock in a vertical position.

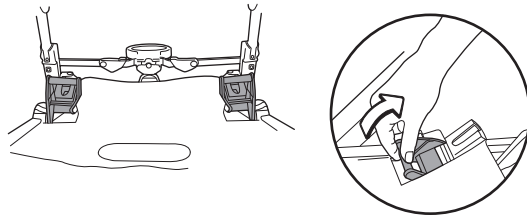

Align the locking clip of the car seat with the attachment brackets of the pushchair.

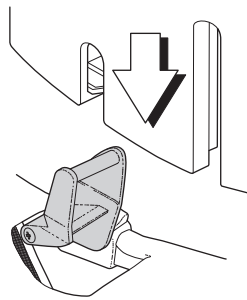

Push the car seat down onto the attachment brackets until it clicks into place.
Check the car seat is firmly in place by attempting to lift it upwards.
Note: You may find the car seat easier to fit if you open one side of the bumper bar.
Always lock the bumper bar once the seat is fitted.

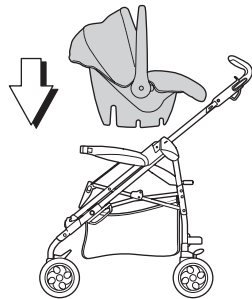

Apply the brakes on the pushchair before removing the car seat.

Pull the lever located on the back of the car seat upwards and hold in the fully pulled out position.

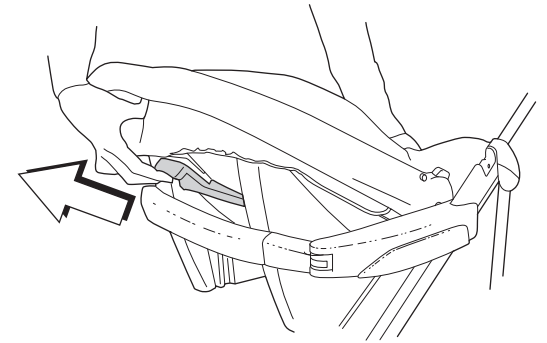

Lift the car seat clear of the pushchair.

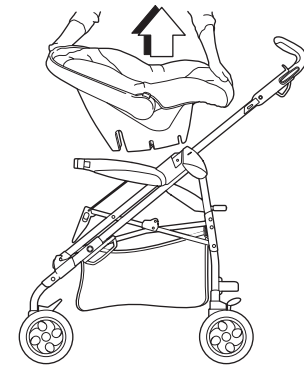

Slide the locking catches on sides of the chassis outwards and push the attachment brackets down.

Never place a child in the pushchair with the brackets up.

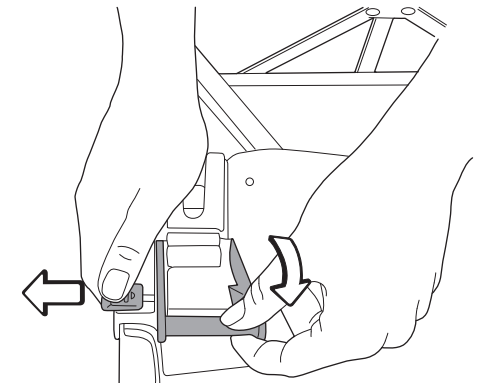

FITTING THE NAVETTA CARRYCOT - CHASSIS MODE

Apply the brakes on the chassis and remove the bumper bar if it is fitted. Turn the two Navetta brackets on the back of the chassis outwards as shown. Raise the legrest sections into the highest setting.

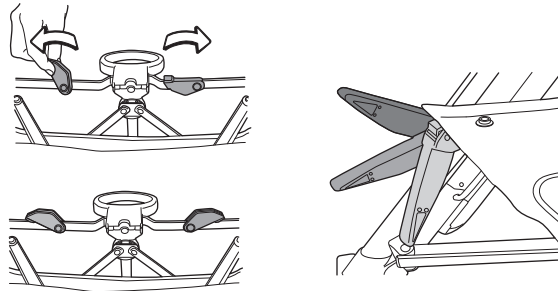

In the corners of the seat unit where the backrest joins the seat base there are two flaps. Under the flap are the attachment brackets. Rotate the attachment bracket upwards as far as it will go. The bracket will lock in a vertical position.

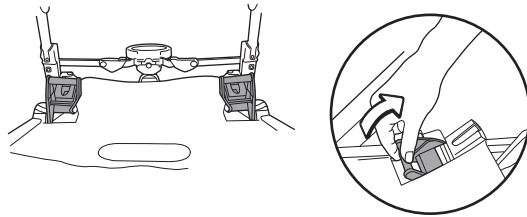

Before fitting the carrycot to the pushchair you will need to remove the bumper bar as shown on page 9.

Align the locking clip of the carrycot with the attachment brackets of the pushchair.

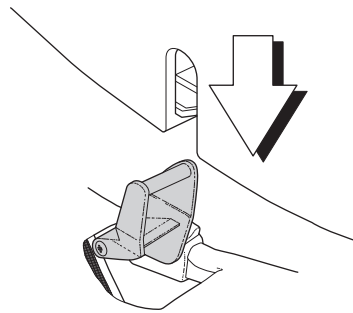

Push the carrycot down onto the attachment brackets until it clicks into place. Check the carrycot is firmly in place by attempting to lift it upwards.

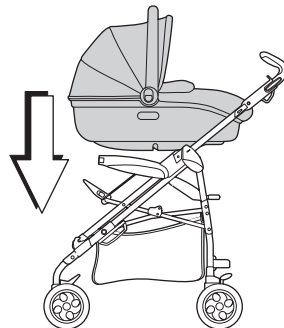

Removing the carrycot:

Grip the centre of the carrying handle with one hand.

With the other hand, slide the locking handle (positioned on the foot end of the carrycot) horizontally and then upwards and hold.

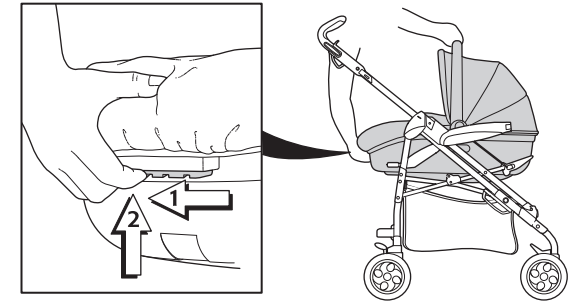

Still holding the lock up, lift the carrycot clear of the pushchair. Once the carrycot has been removed always refit the bumper bar, see page 9.

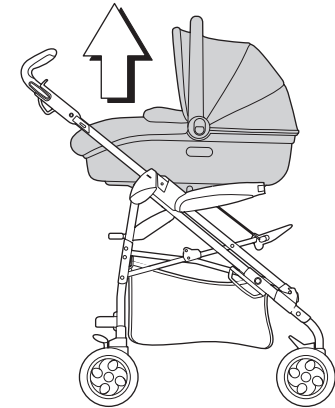

Slide the locking catches on sides of the chassis outwards and push the attachment brackets down.

Never place a child in the pushchair with the brackets up.

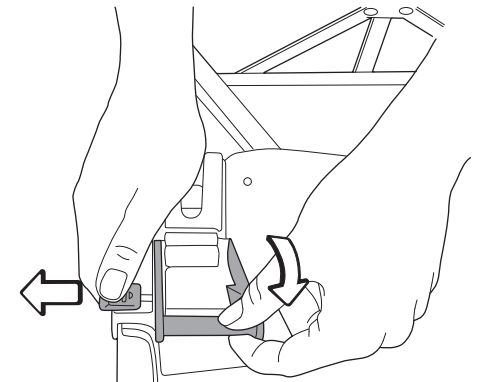

REMOVING THE FABRIC COVER

Slide the ends of the armrest covers towards the bumper bar, then pull away from the armrest to release the attachment studs.

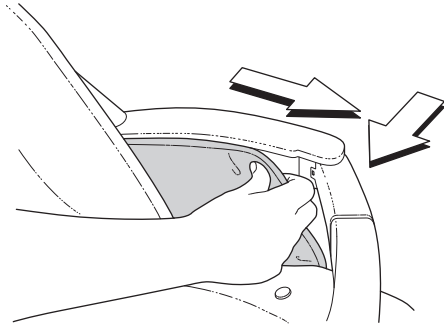

Repeat the same process to remove the rear attachment studs from the armrests.

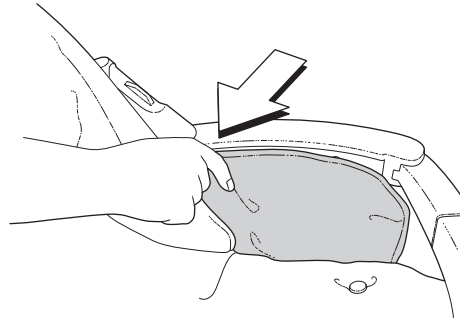

Unfasten the press studs at the bottom of the wings of the backrest.

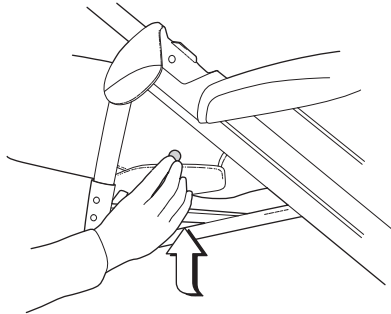

Slot the crotch strap through the slot in the seat of the pushchair's cover.

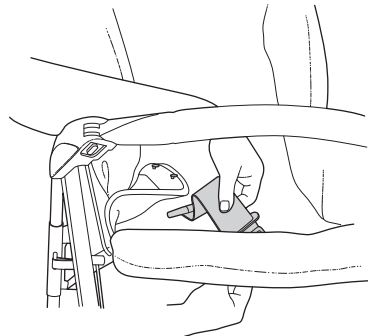

Unfasten one side of the harness by removing the screw as shown in the diagram, you will need to hold on the other side of the frame with your fingers.

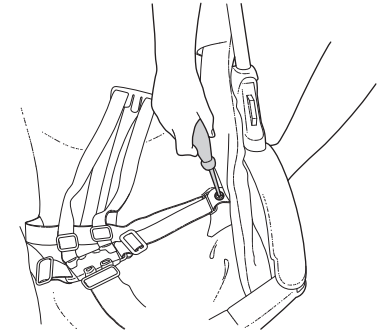

Unfasten the two press studs holding the seat fabric to the frame. Gently slide the cover off the front of the footrest.

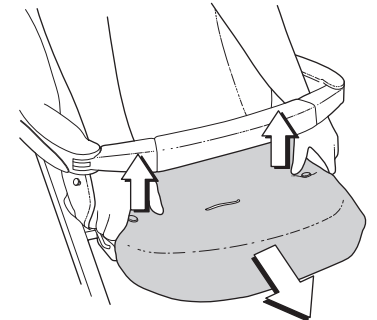

Slide the sides of the cover off the sides of the frame. Slide the harness through the slots in the sides of the cover.

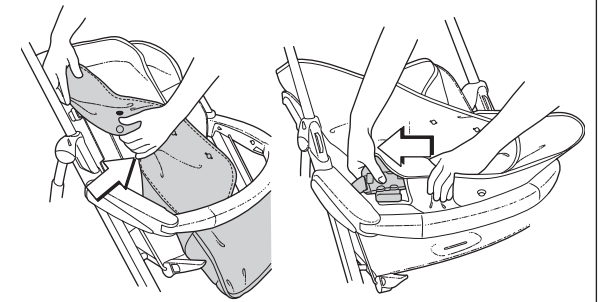

Finally, pull the cover off the back of the pushchair.

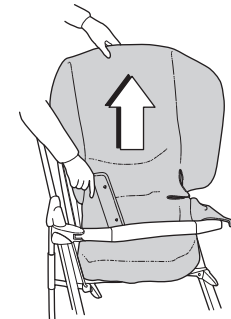

FITTING THE THE PRAM LINER (ACCESSORY)

The pram liner is used to convert the Pliko Combination into a pram for babies who cannot sit up by themselves.

Insert the five panels into the pockets in the sides of the liner. The longest panel (1) goes into the pocket in the end of the liner. The two small panels (2) go into the next pockets down from panel 1. The medium panels (3) go into the pockets in the other end of the liner.

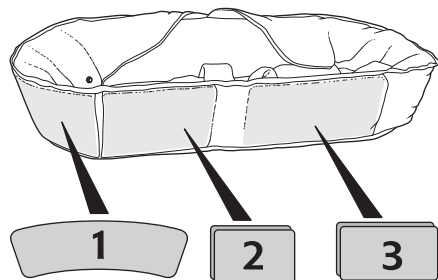

Fasten the press studs on the backrest end of the liner to the two press studs on the on the back of the backrest.

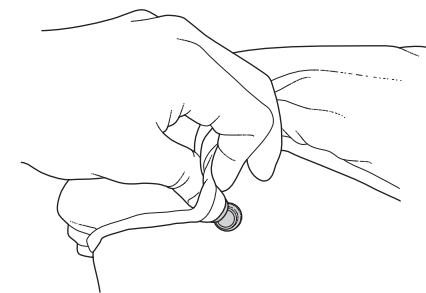

Attach the seat to the chassis in the rearward facing position. Lower the backrest into the lowest position and raise the footrest into the second highest position.

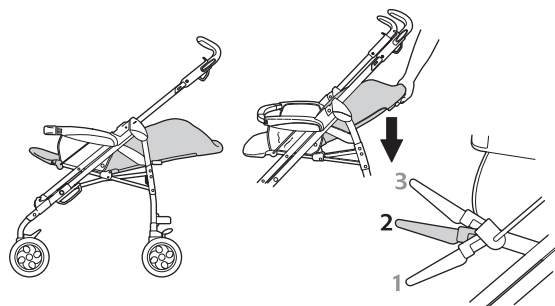

Place your baby on the liner with the crotch strap between its legs. Slot the two tabs through the loop in the top of the crotch strap and fasten the velcro pads together.

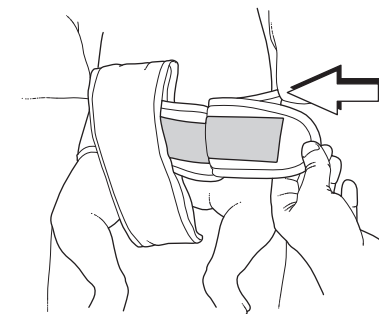

Slot the liner onto the seat units seat cover. Ensure that the end of the liner with the inserted panel (1) is at the backrest end of the seat unit.

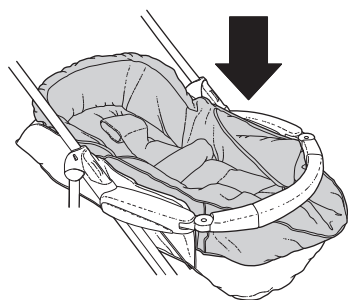

The hood and apron can be fitted to the seat unit to keep your baby warm. Attach the Navetta hood as shown on page 20. Slot the apron onto the backrest end of the pushchair.

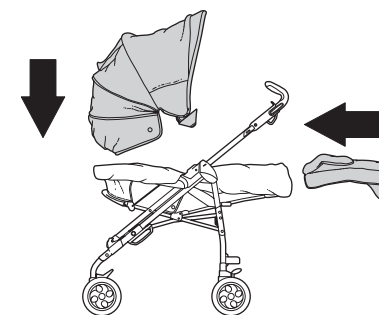

Push the sides of the liner over the sides and ends of the seat unit and over the bumper bar.

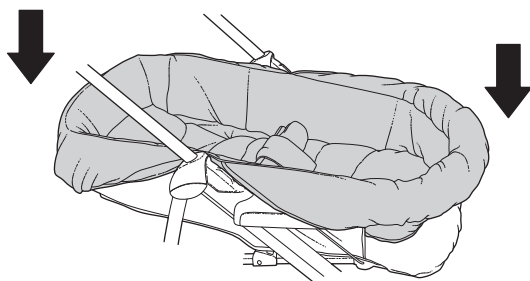

To remove the liner, simply reverse the process used for fitting it.

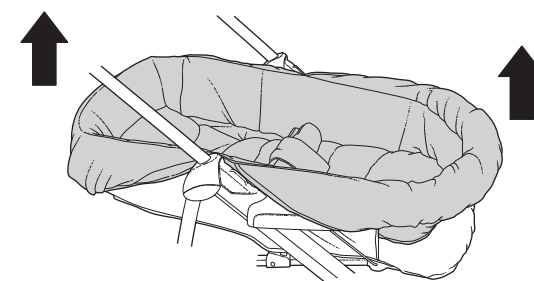

SPECIAL FEATURE

Not all models of the Pliko Pushchair are supplied with or use this special feature. For more information please consult your retailer.

FITTING A FOOTMUFF OR SEAT PAD

Before fitting the footmuff/seat pad unfasten the harness and slide the shoulder strap clips off the two tongues.

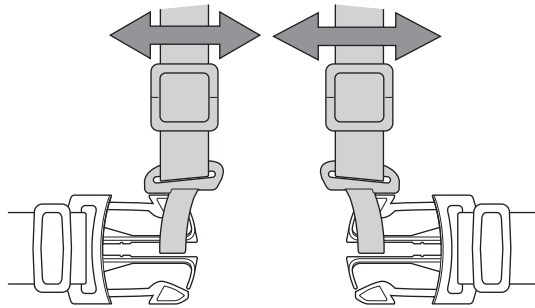

Version 1

Remove the crotch strap by slotting the buckle on the end of the crotch strap through the hole in the seat and fabric (see pages 30-31).

Refit the crotch strap but first slot the webbing through the lowest hole in the footmuff back pad or seat pad.

Slot the two shoulder straps through the horizontal hole in the middle of the footmuff back pad or seat pad.

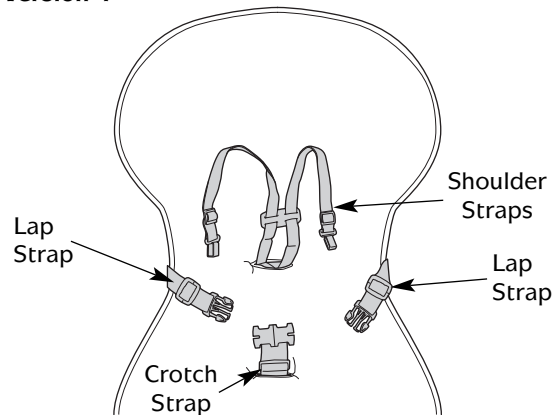

Version 2

The two lap straps can either go around the outside of the back pad or seat pad, as version 1.

Or slot through horizontal slots in the sides of the footmuffs back pad or seat pad, as shown on version 2.

Finally, slide the shoulder strap attachments onto the tongues of the buckle.

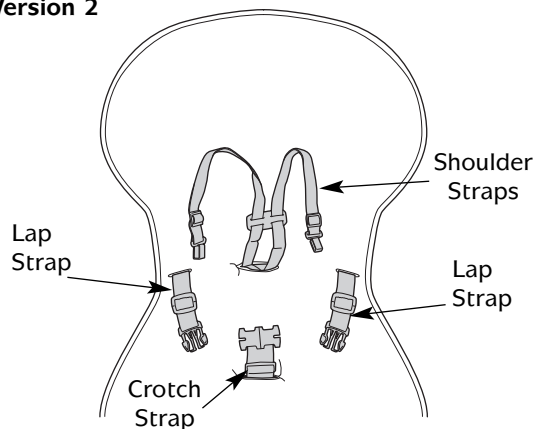

CARE AND MAINTENANCE

Your pushchair is a valuable piece of equipment and deserves careful handling.

- Regularly check that the safety harness is correctly fitted and that the webbing has not become frayed or damaged. If the harness is damaged, we recommend that a new one is fitted. For more information contact our Customer Care +44 (0)845 268 2000.
- Clean the plastic parts of the pushchair with a damp cloth, do not use abrasives or bleach.
- Clean and lubricate the wheels, safety locks (where appropriate) and sliding parts using a light oil or silicon spray. Do not use heavy oil as this will attract dust and grit which tend to clog and damage moving parts. If in any doubt contact our Customer Care +44 (0)845 268 2000.
- We strongly recommend that you have your pushchair serviced regularly, particularly after the first six months. To do this contact either your retailer or call our Customer Care +44 (0)845 268 2000.

Fabric care

- All the Mamas & Papas pushchair fabrics are shower resistant. Should your pushchair become wet do not fold the hood or apron when you take the item inside. Always allow the fabrics to dry naturally away from strong heat sources such as fires, radiators and out of direct sunlight.
- Whilst fabrics are carefully selected and tested, washing, wear and normal exposure to bright sunlight may cause their colour to change.
- The exposed edges of fabric covers are often the first to wear and fray, remember this when storing or transporting your pushchair/carrycot and accessories.
- Light soiling to the pushchair can be removed with a damp sponge and a mild detergent.
- **Washing instructions:** Remove the fabrics following the instructions given in these instructions. Wash the fabric following the instructions on the fabric care label attached to the cover.
- Should a fault arise with your pushchair please contact either your retailer or phone our Customer Care +44 (0)845 268 2000.

10158: V2/09/07



AFTER SALES SERVICE: If you need assistance, spare parts or you are unhappy with any aspect of the goods please contact **Customer Care** on: +44 (0)845 268 2000, or e-mail us at: customer.care@mamasandpapas.com
Visit our website at www.mamasandpapas.com for the latest product information.

Notes _____