



Security Engineered Machinery Co., Inc.

## **OPERATIONAL & MAINTENANCE MANUAL**

### **SEM Model 200/650 Disintegrator**



**As of September 1, 2009  
Rev. 0**

**Security Engineered Machinery Co., Inc**

#### **NATIONWIDE SERVICE**

Phone Toll Free: 1(800)225-9293

**Email: [Service@SEMSHRED.com](mailto:Service@SEMSHRED.com)**

Fax: (508)366-6814

Website: [WWW.SEMSHRED.COM](http://WWW.SEMSHRED.COM)

# Table of Contents

---

Index-----2

Important Safety Processes-----3

General Assembly Drawing-----4

Power Supply Requirements-----5

Plug and Receptacle Information -----6

Installation Instructions-----7-8

Operating and Troubleshooting-----9

Feed Information (See also label on top of machine) -----10

Maintenance (Changing of knives and screen) -----11-12  
(Sharpening knives see diagram page 12)

Cutting Chamber Assembly-----13

Rotor and Bed knife Settings-----14

Knife Sharpening Settings-----14

Electrical Panel-----15

Electrical Schematic-----16

Options / Spare Parts-----17

Instructions for the 650C in rear of this manual

# **\*\*\*IMPORTANT SAFETY PROCEDURES\*\*\***

Your new SEM Model 200 incorporates powerful, heavy duty cutting mechanisms, **serious and permanent injury may result** if proper precautions are not followed.



1. This equipment should never be operated by children or individuals that are untrained or incapable of understanding these safety precautions!



2. Do not reach into the feed opening for any reason! Never insert fingers, hands, other extremities, or objects not meant to be crushed into the feed opening!



3. Do not operate or come into close proximity to this equipment wearing loose clothing, neckties, dangling jewelry, or long hair which may become entangled in the crushing chamber.



4. Maintenance or repair of this equipment should be performed only by trained, authorized service personnel.

5. Always disconnect electric power (unplug) before removing or opening any cover or other panels providing access to the internal mechanisms.

## **Important:**

If you over feed the Disintegrator or have an Emergence and need to shut down the machine without using Time Shutdown open the front door of the disintegrator cabinet.

## **Warning:**

Opening the front door to bypass the Time Shutdown can result in a jammed cutting chamber or damage to the Cutting Chamber.

## **Warning:**

After inserting documents or other materials close Feed Door.

# General Assembly Drawing

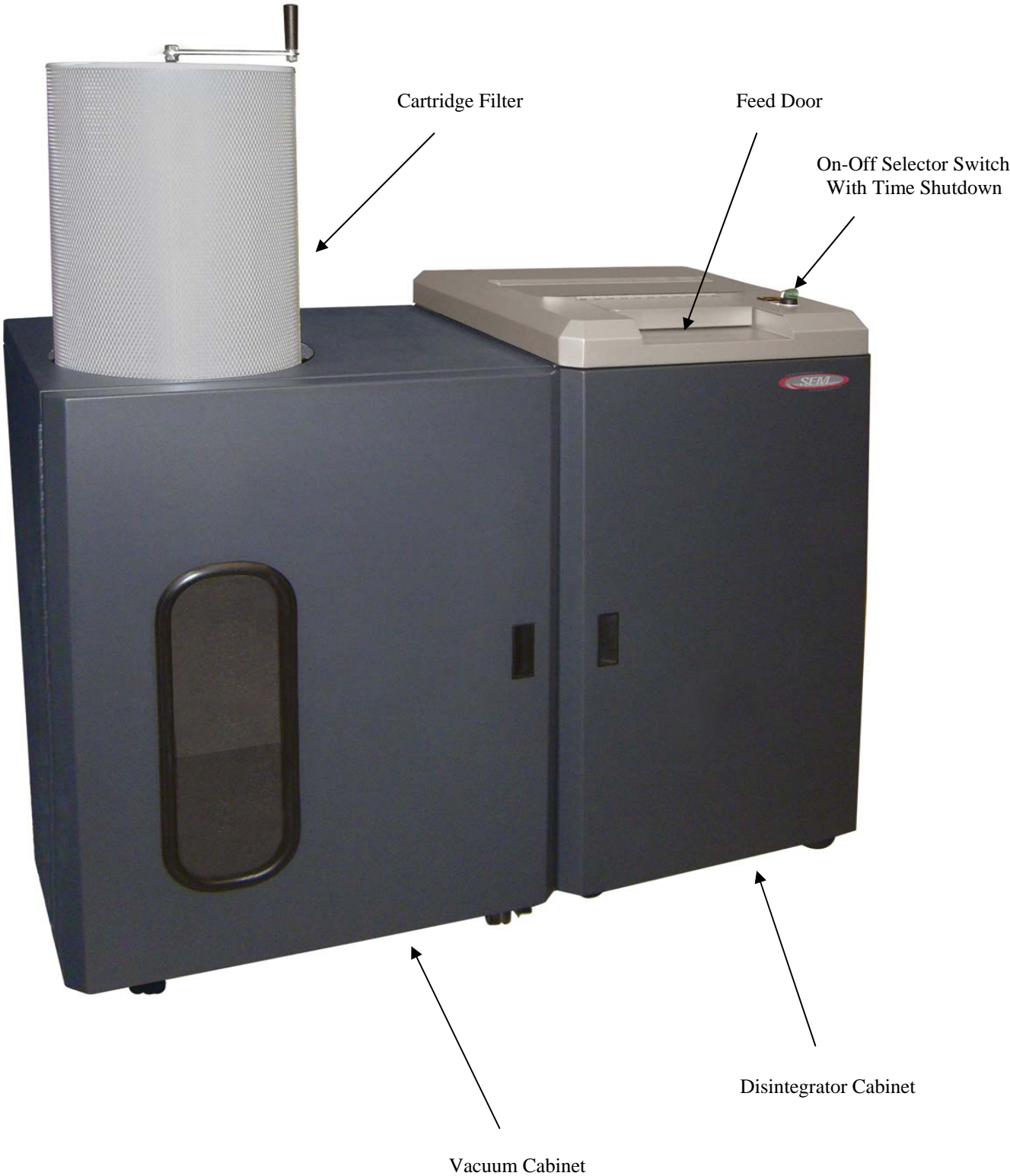

**For NATIONWIDE SERVICE Call 1(800)225-9293**

# Power Supply Requirements

---

## **MODEL 200**

For Connecting to Single Phase Power

### **FOR 115 VOLT/1 PH /60 HZ**

#### **Note to Installer:**

The Model 200 Disintegrator System has been supplied with a power cord and male plug for **20 amp** service.

The male plug is a **NEMA # 5-20P** and requires a female connection as noted below.  
Ref: **NEMA 5-20R.**

### **FOR 220 VOLT / 1 PH / 50-60 HZ**

#### **Note to Installer:**

SEM has provided a power cord with male plug for **15 amp** service.

The male plug is a NEMA # 6-15P and requires a female connection as noted below.

Ref: NEMA # 6-15R

On overseas applications, a round pin type plug with ground (**32 amp rating**) has been supplied.

#### **OPTIONS:**

- A) If it doesn't fit your power receptacle, cut off and replace plug to conform to local electrical requirements.
- B) Cut off plug and hardwire to a power disconnect switch.

# Plug and Receptacle Information

---

SEM normally supplies a male plug and cord prewired to the disintegrator unit for single phase.

The **NEMA** Configurations are as followed:

## Model 200

115 volts – 125 volts single phase SEM supplies a NEMA #5-20P the customer needs to supply a NEMA #5-20R receptacle 20 amps

220 volts – 250 volts single phase SEM supplies a NEMA #6-15P the customer needs to supply a NEMA #6-15R receptacle. 15 amps

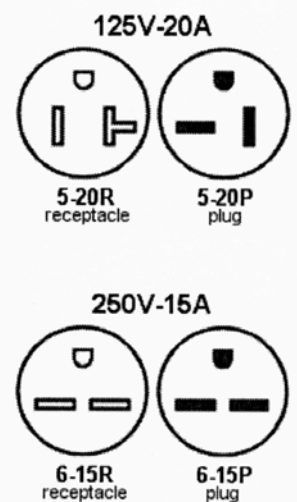

## Note:

**Any over sea or European shipments at 220 volts single phase 50 cycles must supply their own plug unless otherwise specified at time of the order.**



# Installation Instructions

## DISINTEGRATOR LOCATION:

The Model 200 can be located in an office area within **6 feet** of a wall receptacle with a dedicated **20 amp** line. It is recommended that the machine be **3 to 4 inches** away from the wall for proper ventilation.

- 1) Place Vacuum Cabinet next to the Disintegrator Cabinet (on the left side) so the handles are next to each other then open doors on the cabinets and feed vacuum hose thru hole in the bottom of the right side of cabinet and connect to the transition in the disintegrator cabinet.

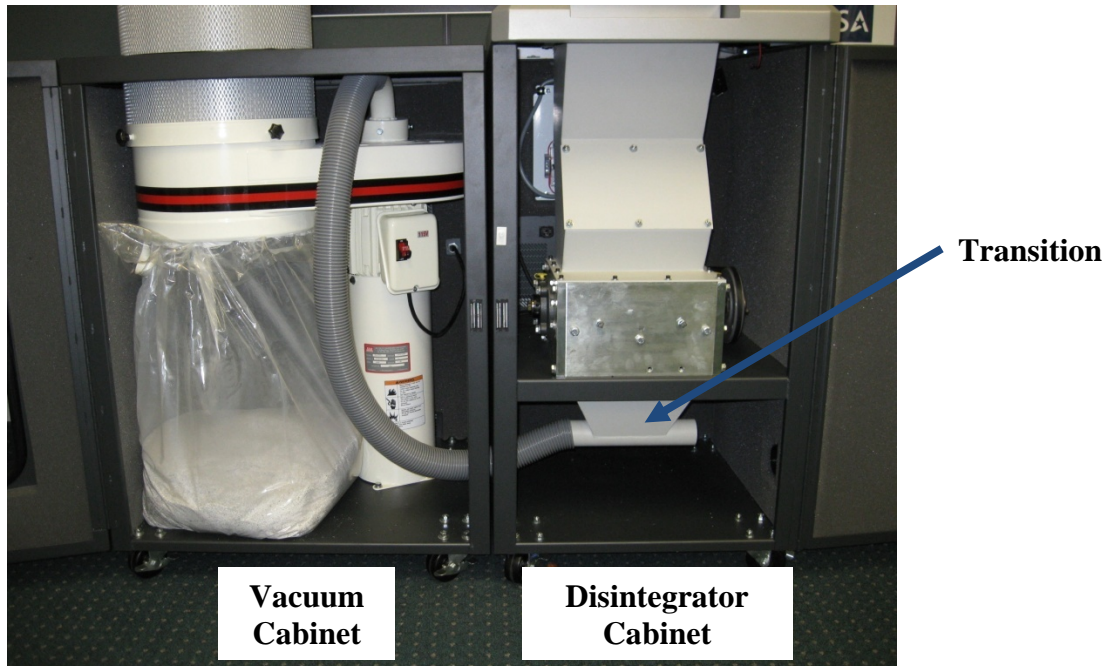

- 2) Plug Vacuum cabinet into the back of the Disintegrator Cabinet. Shredder will be plugged in when received.

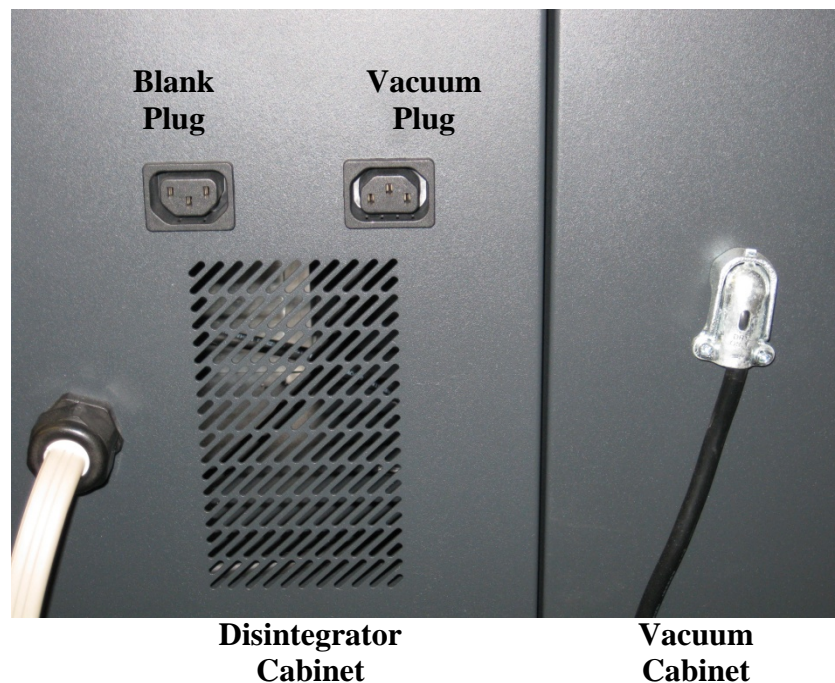

For **NATIONWIDE SERVICE** Call **1(800)225-9293**

# Installation Instructions

---

## Electrical Wiring:

(See Diagrams on pages 14, 15)

- A) The machine includes an appropriate power cord and **20-amp** male plug. The unit is activated by a top mounted selector switch with indicator light.
- B) Access to the cutting chamber for service is provided by the main cabinet door. A safety unit switch activated by the main door prohibits operation when door is open.
- C) The Model **200** has been wired per your specification. The motor supplied operates on single phase voltage.

**Note:** Some motors have manual overload reset button on motor, others are automatic. (Each machine will be clearly marked.)

- D) If for any reason the machine is rotating in the wrong direction remove metal plate on motor and change leads as shown on plate diagram.

**Note:** Motors are normally dual voltages, 115/230 but can only be operated at the specific voltage as wired at the factory, if voltage change is required in the field contact factory for proper instructions.

**Note:** Power required **115 volt /1 PH /60 CY 20 amps** Disintegrator motor **9.6 amps**, Vacuum motor **11.0 amps**.

- E) **220 volt /1 PH / 60 CY -20 amps** Disintegrator motor **4.9 amps**, Vacuum motor **5.5 amps**.
- F) The Disintegrator System is supplied with a power cord and plug. The vacuum and shredder are also supplied with plugs for cabinet receptacles.



# Operating and Troubleshooting

---

**Please read this section carefully**, most problems occur during the first hours of operation. Most problems can be eliminated by careful review of the operating, maintenance and recommended service instructions.

- A) The model 200 has been shipped complete tested and is operational when received.
- B) The Model 200 requires a dedicated line equipped with a **20 amp** receptacle. (See page 3 options)
- C) Once positioned, verify vacuum is connected, all access points are closed. By turning selector switch, the unit will start and will illuminate the green operating lamp.
- D) The Model 200 was designed to destroy plastics, film and light volumes of paper products. But as with any type of office machine, it can be overloaded or jammed if overfed. Product destruction rate depends on the material, size and desired particle size. When feeding the concept of "**less is more**" by feeding the unit less volume more often will result in better feed rates and reduce the operating costs.
- E) All Model 200's units are equipped with time shutdown to help prevent jamming of the disintegrator. When Selector Switch is in the **OFF DELAY** position the disintegrator will run for an additional 60 seconds to clear the chamber. This will help to prevent jamming of the unit which would require some disassembly to gain access to the cutting are.

## **Important:**

**If you over feed the disintegrator or have an emergence and need to shut down the machine open the front door of the disintegrator cabinet.**

## **Warning:**

**Opening the front door to bypass the Time Shutdown can result in a jammed cutting chamber or damage to the Cutting Chamber.**

- F) To clear a jammed or locked rotor:
  - a. Make sure selector switch is in OFF position
  - b. Unplug power cord
  - c. Open front door of disintegrator cabinet
  - d. Remove plate on front hopper to access the cutting area
  - e. Remove loose product
  - f. Rotate rotor counter clockwise by means of the drive belt by hand to clear clogged material

To restart:

- a. Re-secure plate on front hopper
- b. Re-plug power cord
- c. If necessary, reset circuit breaker switch or motor contactor, located above motor
- d. Close main door
- e. Turn selector switch to "on" start position

NOTE: Repetitive jams also can be a result of knives that require sharpening. If machine has no power, reset circuit breakers on electrical panel located above motor.

# Important Feeding Information

---

1. Before introducing any destruction material into feed slot, the Model 200 and its Vacuum must be turned on and operating. The material collection vacuum must be checked periodically and emptied for the continued operation.
2. **Destruction Material:** The Model 200 is capable of processing a variety of materials safely and effectively. Products that can be destroyed include products with light metals, plastics and paper. Listed below are products tested if you are trying to destroy anything that is not listed below and would like to verify contact SEM's Customer Service at 1-800-225-9293 before use.
3. **Paper Destruction:** The Model 200 is not a Shredder but a Rotary Knife Mill, which dictates how the unit is fed and the rate it can be fed at. Rule of thumb, "Less is More" which creates steady output without over feeding. Feed rate is 4-5 sheets approximately every 10 seconds averaging 18-20 pounds\* of paper per hour. (Approximately 4 reams of paper)
4. When destruction is complete, allow the Model 200 and vacuum to operate an additional 60 seconds after the last feed of material. This will prevent build up in the cutting area and evacuation line, ensuring proper operation for the next user.
5. **Vacuum Collector** as with a conventional shredder. The Model 200's waste collection bag must be periodically emptied for proper operation. **Bag capacity is 35 Gallons or approximately 200 sheets (5 reams) of paper.**

## Note:

**For optimal sound reduction after inserting documents or other materials close Feed Door.**

\*Destruction rates of paper are based on 20 lb. bond 8-1/2" x 11" using 3/32" destruction screen, rates can change depending on the screen size.

Other rates of material are:

- CD ROMS at 3-5 per feed approximately every 15 seconds
- Floppies at 3-5 per feed approximately every 20 seconds
- Zip disks at 1-2 per feed approximately every 35 seconds
- Audio Cassettes at 1 per feed approximately every 30 seconds
- Key Tape strips up to 10 inches in length, 6 per feed lot

# Maintenance

---

## **Important / Caution: Unplug Cord from Receptacle**

### **A) Belt Adjustment:**

Open front door and remove top cover (be shore to unplug top cover) the motor is mounted on a slotted frame. Loosen four (4) mounting bolts and adjust motor toward rear of machine to tighten or move forward for belt removal. Proper belt tension is determined by extending thumb pressure on belt causing a slight bow on slack side. This should be no more than  $\frac{1}{2}$ ".

**IMPORTANT:** Belt should be checked and tightened if required after first two (2) days of operation, after that check monthly.

### **B) Lubrication:**

Grease fittings are accessible when cabinet cover is opened. Grease twice yearly with Gulflex "A", multi-purpose or equivalent, grease fittings are located on rotor bearings (C-14).

### **KNIVES:**

For full efficiency, knives should be sharpened from two to five times a year, depending on use. If for example, your knives require sharpening after three months of operation, your sharpening schedule should be every three months. It is highly recommended that a spare set of knives be available for your Disintegrator.

**Changing Knives:** (See diagram pages 9 & 10)

- A) Unplug cord from receptacle/lock out power from device
- B) Remove top cabinet cover

**Note:** When cover is open a safety limit switch contact opens, this insures that no one accidentally starts the disintegrating if power cord has not been unplugged.

- C) Remove the Feed hopper from cutting chamber (unplug cord)
- D) Prior to removing or replacing the rotor knives, back off bed knife adjusting screws. Cover the edge of each knife with a heavy gauze tape such as scotch filament or cloth tape. Remove all knives prior to replacing any of the knives.

### **E) Bed Knife:**

First remove bolts, (2) on the right, and (2) on the left of each of the aluminum deflectors. Remove three bed knife bolts from each bed knife. Remove bed knife holder plate and bed knife. Take spare bed knife and insert exactly the way the dull knife came out. Insert bed knife bolts and hand tighten. Finally replace the rotor knives. Remove the tape covering the edge of both rotor knives and adjust the distance between the rotor knife and bed knife by manually rotating rotor in reverse direction. Adjust to a minimum of .001 to .002 inch clearance using feeler gauge.

**Note:** Tool kits are available from Factory

# Maintenance

---

## **Knives Continued:**

- F) **Caution:** Before tightening bed knife securely determine that the knives are set properly by manually rotating rotor in the operating direction to insure that no rotor knife touches the bed knife.

## **Knife Torque's**

Knife Bolt Torque's required: 45 FT lbs.  
for bed knives 50 FT lbs. for rotor knives

## **Sharpening Knives:**

(See Diagram Page 12)

Knives may be sent to Security Engineered Machinery (SEM) for sharpening or they may be sharpened by a capable machine shop in your area. When sharpening the rotor knives must be sharpened as a set to maintain proper tolerance between the bed knives. If knives are badly nicked the machine should not try to eliminate the entire nick so as to conserve the edge and prolong knife life. The knives will function very well with nicks after sharpening.

## **Changing a Screen:**

- A) Unplug power cord
- B) Open front main door
- C) Remove nuts from the combination screen/transition
- D) Lower screen
- E) Insert new screen and nuts, re-tighten
- F) Put transition back into place
- G) Close front access door

## **If Disintegrator will not start:**

- A) Front access door is fully closed to activate safety switch
- B) Top cover safety switch is fully closed or depressed
- C) Motor thermal overloads and a circuit breaker are located on the machine control panel, located in the rear of the cabinet. As a safety feature, the units in the controls may "kick out" after an overload; simply reset the control (s) to re-start machine operation.

# Cutting Chamber Assembly

ITEM	QTY	DESCRIPTION	PART/DWG#
1	1	Left Side Plate	3-20-6531-00
2	1	Right Side Plate	3-206532-00
3	1	Bed Knife support	3-20-6165-00
4	1	Rear Deflector	3-20-6168-00
5	1	Front Deflector	3-20-6167-00
6	2	Bed Knife Seat	3-20-6164-00
7	2	Flange Bearing	
8	1	Rotor 3 Blade	4-20-6991-SL
9	18	3/8-16x1-1/4 Hex Head Grade 5	
10	32	3/8 Lock Washers	
12	4	3/8 Flat Washers	
13	4	3/8-16 Hex Nut	
14	6	1/4" Roll Pin x 1"	
15	6	5/16-18x1-1/4 Hex Head	
16	14	5/16 Lock Washers	
17	6	3/8-16x1-1/2 Socket HD Cap Grade 8	
19	8	5/16 Flat Washers	
20	9	3/8-24x3/4" Socket HD Cap Grade 8	
21	4	1/4-20x1-1/4" Square Head	
22	4	1/4-20 Hex Nut	
23	1	Bed Knife Clamp (Front)	2-20-6274-00
24	1	Bed Knife Clamp (Rear)	2-20-6275-00
25	2	Bed Knife	
26	8	3/8-16x1-1/2" Hex HD Cap Grade 5	
27	3	Rotor Knife	
28	6	3/8 Hardened Washer	
29	6	5/16-18x1-1/4" Socket Set Screw	
30	4	3/8-16x1-1/2" Socket Set Screw	
31	8	5/16-18 Hex Nut	
32	2	5/16-18x1-1/2" Socket Set Screw	
33	1	1/2-13x3/4 LG-Hex HD Cap Screw Grade 8	
34	2	Motor Shim	4-20-6271
35	1	Bed Knife Support	320-6165-AB

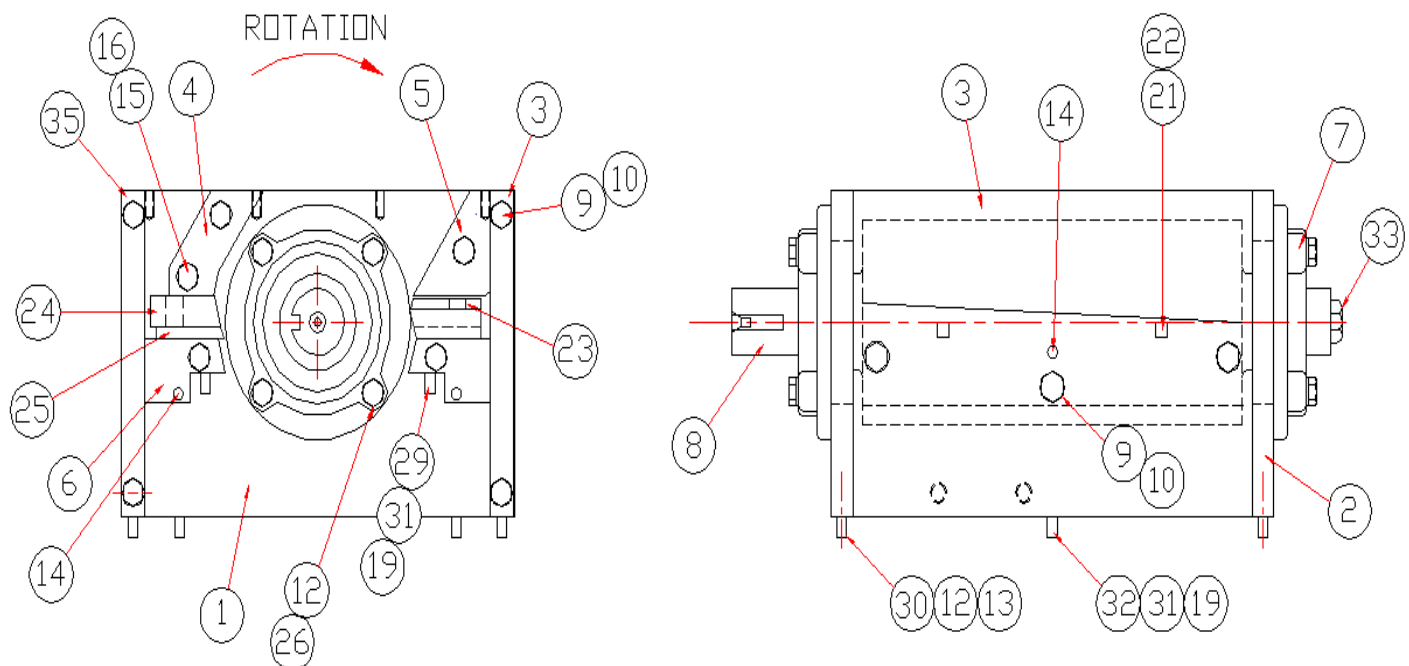

**For NATIONWIDE SERVICE Call 1(800)225-9293**

## Recommended Rotor and Bed Knives Settings

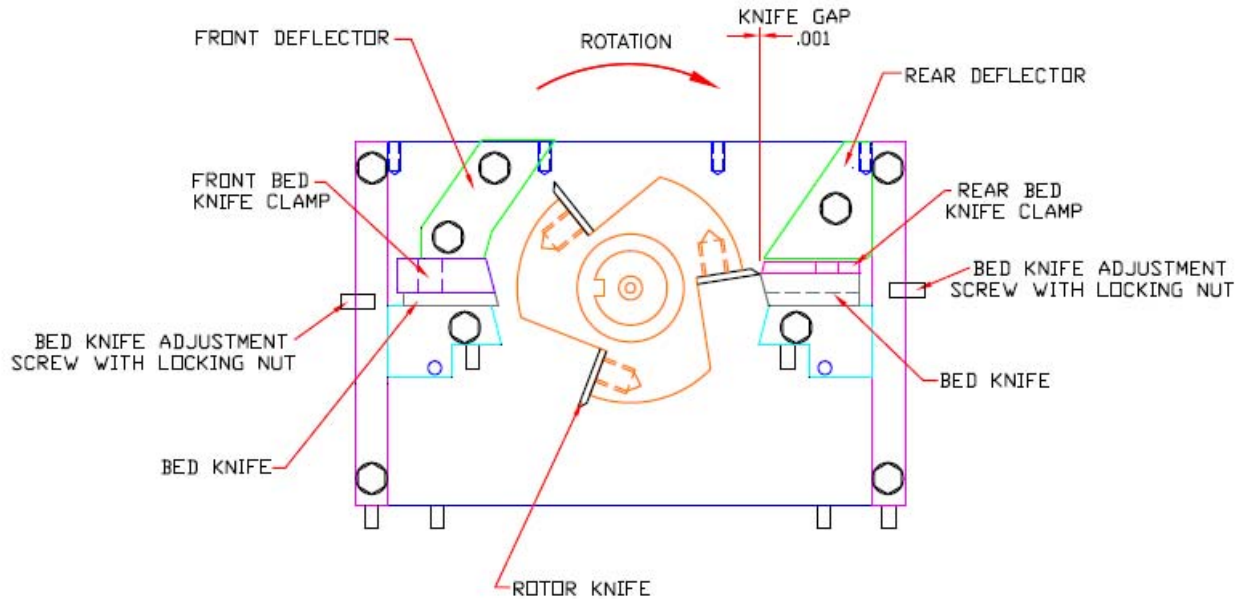

## Knife Sharpening Settings

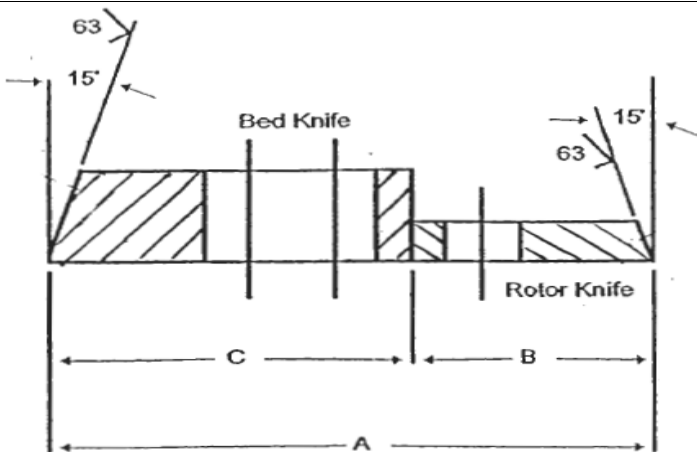

A= Minimum distance 2.625"

B= Bed knives must be held alike and parallel in sets within 0.010"

C= Rotor knives must be held alike and parallel in sets within 0.002"

### NOTES ON KNIFE GRINDING:

1. After regrinding number of times, the knives must be checked to be sure that there will be adjustment left in the bed knives. The general rule is to place a rotor knife and bed knife back as shown above, and measure the total dimension "A" distance
2. If dimension "A" is close to minimum, a new set of knives should be ordered from the S.E.M. Customer Service Department

## Recommended Rotor and Bed Knife Re-sharpening

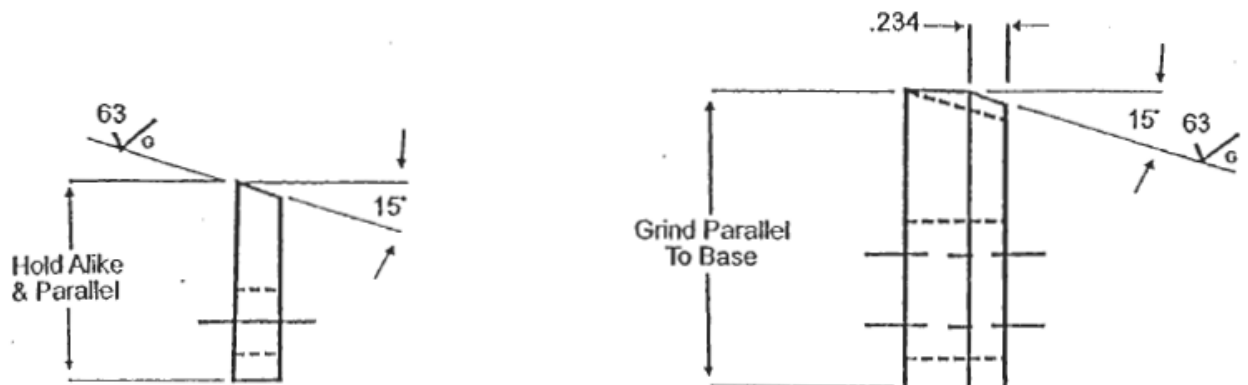

For NATIONWIDE SERVICE Call 1(800)225-9293



# Electrical Panel

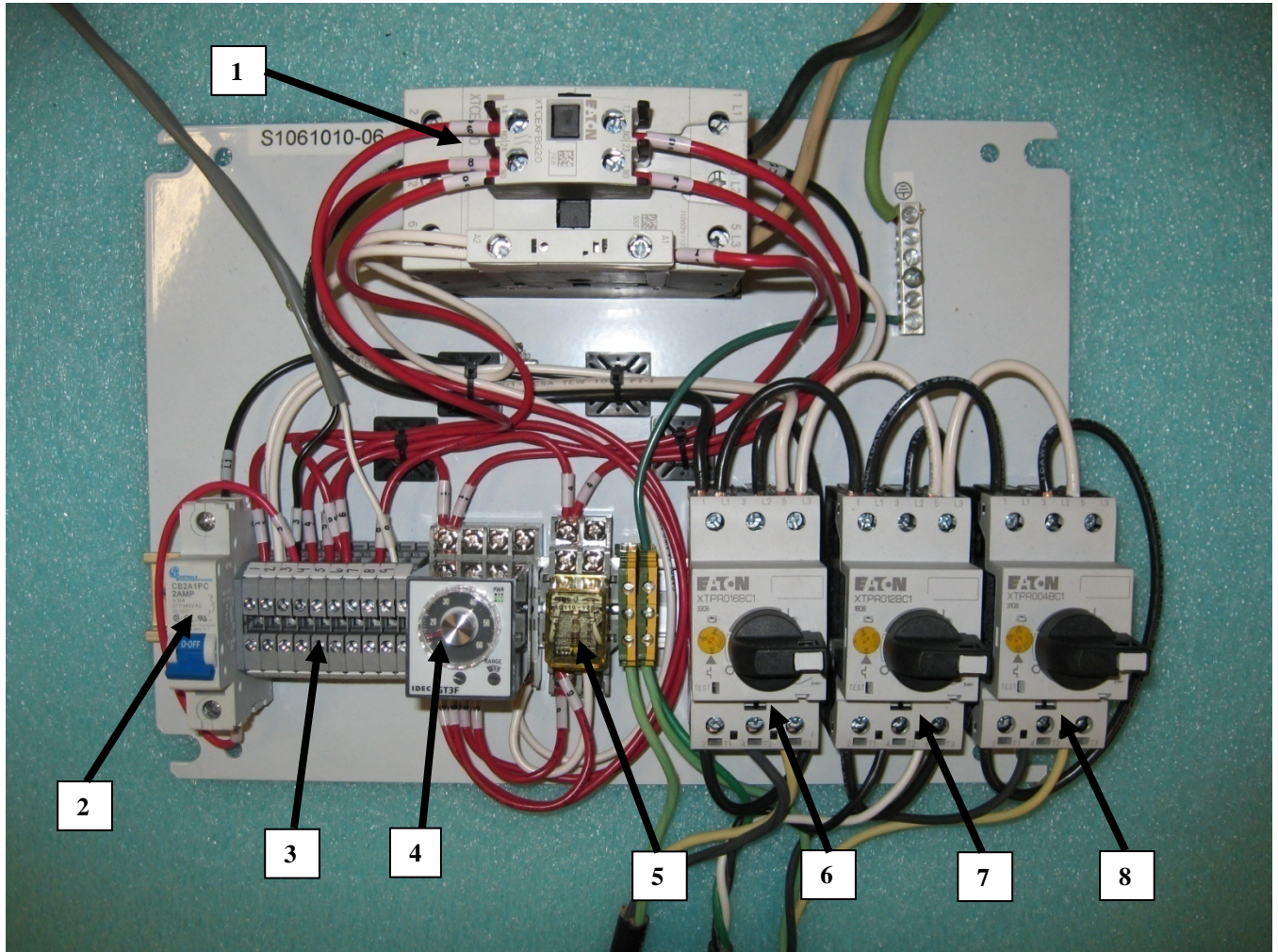

Item	Qty.	Description	Part Number
1	1	Contactor	
2	1	Main Circuit Bracker	
3	10	Terminal Board 1-9 with one spare	
4	1	Timer for Time Shutdown	
5	1	Relay to Activate Timer	
6	1	Motor Circuit Bracker	
7	1	Vacuum Circuit Braker	
8	0	Shredder Circuit Bracker (only on DS Models)	

**For NATIONWIDE SERVICE Call 1(800)225-9293**



# Electrical Diagram

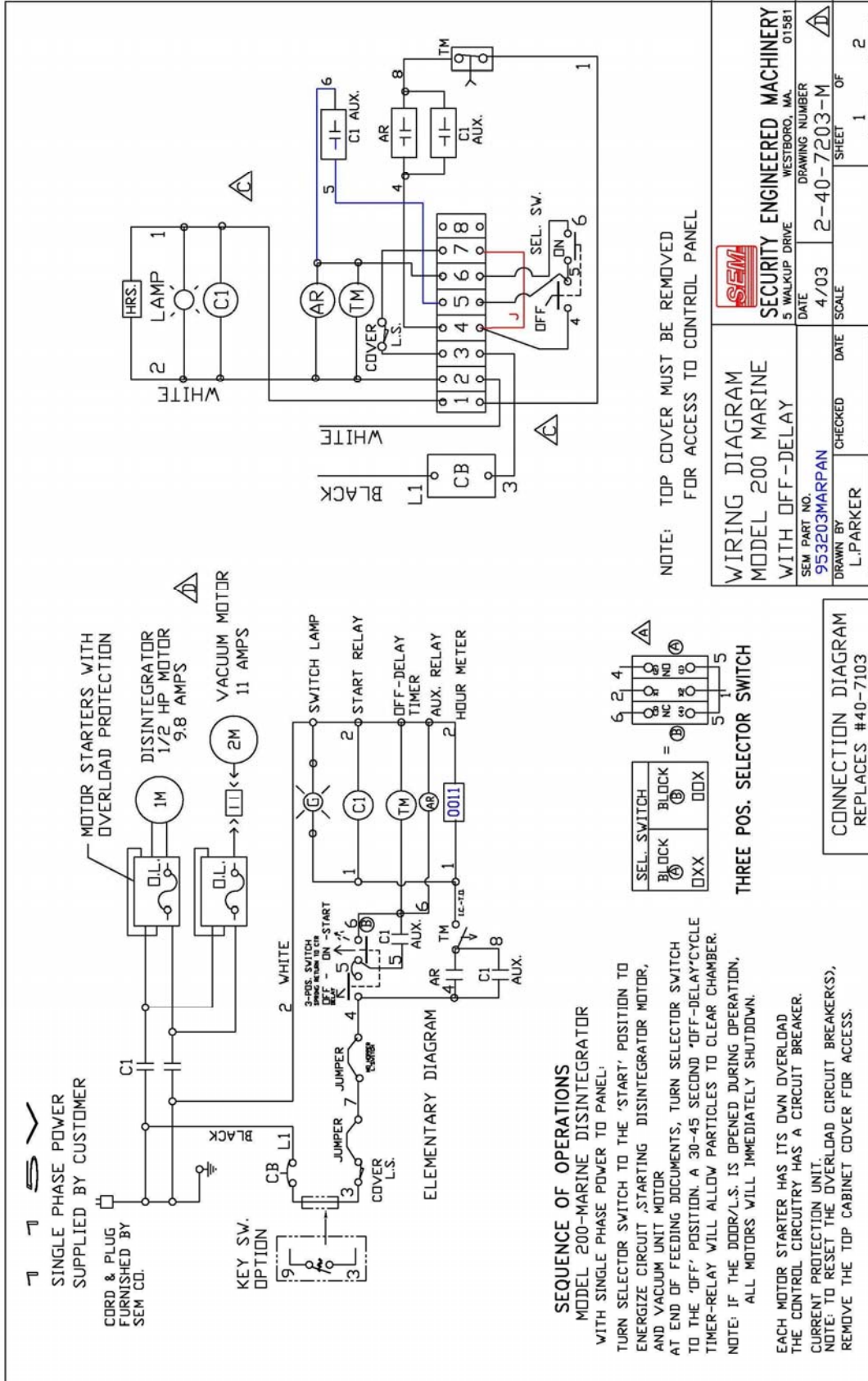

## Options and Spare Parts

---

### Options:

- ⊞ **Maintenance Kit**  
P/N DMK200  
Kit includes:
  - Spare Set of Knives Shipping Case
  - Lifetime Sharpening Knife
  - Hardware

### Spare Parts

- ⊞ **Standard Knives**  
P/N 391200K/3  
3 Rotor / 2 Bed
- ⊞ **Perforated Security Screens**  
P/N 341201332  
3/32" Dia.

### Services

- ⊞ **Knife Sharpening**
- ⊞ **Service Contracts**

**Contact our**  
**Customer Service Department**  
For details at 1-800-225-9293  
Or order online at [www.semshred.com](http://www.semshred.com)



## **OPERATIONAL & MAINTENANCE MANUAL**

### **Confetti Waste Collector Model 650C**



**As of January 1, 2008**

**Security Engineered Machinery Co., Inc.**

**NATIONWIDE SERVICE**

**Phone Toll Free 1(800)225-9293**

**Email: [Service@SEMSHRED.com](mailto:Service@SEMSHRED.com)**

**Fax: 1(508)366-1671**

**Website: [WW.SEMSHRED.COM](http://WW.SEMSHRED.COM)**

**For NATIONWIDE SERVICE Call 1(800)225-9293**

## **TABLE OF CONTENTS**

---

Table of Contents/Specifications-----	21
Warnings-----	22-23
Grounding Instructions-----	24
115V Operation-----	24
230V Operation-----	25
Unpacking/Contents-----	26
Assembly-----	27-28
Wiring Diagram-----	29
Parts Breakdown -----	30
Parts List-----	31-32

## **SPECIFICATIONS -DC-650C**

---

Stock Number -----	708640C
Blower Wheel Diameter-----	9 1/2"
Sound Rating at 3 feet-----	88dB
Hose Diameter-----	4"
Air Flow (CFM) -----	650
Velocity at 4" (FPM) -----	6,750
Static Pressure (inch of water) -----	6.3
Bag Diameter-----	13.9"
Filter & Collector Bag Length-----	33.5"
Collector Bag Capacity (cu. Ft.) -----	2.9
Overall Dimensions-----	26-1/2" x 14" x 61-1/2" w/Canister Filter
Motor (TEFC) -----	1 HP, 1Ph 115/230V, Previewed 115V
Net Weight (approx.) -----	69 lbs. without Canister filter

The Specifications in this manual are given as general information and are not binding. Group reserves the right to effect, at any time and without prior notice, changes or alterations to parts, fittings, and accessory equipment deemed necessary for any reason whatsoever.

# WARNING

## **READ THE FOLLOWING SAFETY TIPS - BEFORE OPERATING THIS VACUUM-TYPE COLLECTOR**

- REFER TO THE ELECTRICAL POWER REQUIREMENTS
- DO NOT USE THIS UNIT OUTDOORS OR ON WET SURFACES
- USE ONLY RECOMMENDED ATTACHMENTS SUPPLIED
- DO NOT PULL THIS UNIT BY THE ELECTRICAL CORD
- DO NOT HANDLE CORD/PLUG WITH WET HANDS
- DO NOT USE WITHOUT WASTE BAG OR FILTER IN PLACE
- DO NOT OPERATE UNIT WITHOUT HOSES IN PLACE
- CAUTION - HAZARDOUS MOVING PARTS INSIDE
- DO NOT USE COLLECTOR FOR ANYTHING BUT PAPER OR WOODEN PARTICLES. METAL ITEMS CAN CAUSE SPARKS
- ELECTRICALLY 'GROUND' THE 'WASTE COLLECTOR, AS OUTLINED IN THE ELECTRICAL SECTION OF THIS MANUAL

 **WARNING**

To reduce the risk of injury from moving parts, always keep inlet connected to a flexible hose. Failure to comply may result in serious injury!

#### Electrical Connections

 **WARNING**

All electrical connections must be done by a qualified electrician. All adjustments or repairs must be done with the dust collector disconnected from the power source, unplugged. Failure to comply may result in serious injury!

The DC-650C dust collector is rated at 115/230V, Prewired 115V. Use a plug and outlet rated at least 20 amps. The circuit for the machine should also be protected by at least a 20 amp circuit breaker or fuse. Keep in mind that a circuit being used by other machines, tools, lights, heaters, etc. at the same time will add to the electrical load. A dedicated circuit to the dust collector will give you the best results since dust collectors are generally used at the same time other tools are running.

Before hooking up to the power source, make sure that the switch is in the off position.

#### Turning the Machine On & Off

Before hooking up to the power source, make sure that the switch is in the off position.

The dust collector can be turned on by flipping the start switch up. Flip the switch down to turn the dust collector off. There is a removable key that can be used to lock the machine in the "OFF" position.

#### Maintenance

**WARNING**

Never perform maintenance on this machine before turning switch off and removing plug from power source, unplug.  
Failure to comply may cause serious injury!

#### Cleaning the Filter

Clean both the filter and collector bag frequently to keep the collector's performance at its optimum.

To clean the filter turn the handle a couple rotations so the dust falls into the collector bag.

#### Removing the Collector Bag

 **CAUTION**

Wearing a particle mask/respirator for protection against fine dust particles during cleaning is highly recommended.

1. Disconnect the machine from the power source, unplug.
2. Remove the collector bag by pushing the ring of the collector bag upwards at an angle and pulling the bag and snap ring out.
3. Empty the contents into an appropriate container.

#### Motor

Inspect the motor fan and blow out (with low pressure air hose) or vacuum any accumulation of foreign material in order to maintain normal motor ventilation.

#### Connecting the Dust collector to a Machine

Use the proper type hose to connect the dust collector to the machine being operated. Dryer vent hose is not acceptable for this purpose. Contact your nearest JET distributor for the full line of JET Dust Collector Hoses and Accessories. Customize your installation and obtain maximum performance with JET's dust hoods, hoses, clamps, fittings, and blast gates.

You can also purchase the JET *"Dust Collection Basics Video"* stock # JW1050V through your JET Distributor

#### Grounding the Dust Collection System

The dust collection system includes the dust collector and the hose, or duct work you use to connect the tools. The dust collector is grounded though the ground wire in the cord. The hose or duct work you use to connect the tool to the dust collector must also be grounded. To assist in grounding your system you can purchase the JET "Dust Collector Grounding Kit" stock # JW1053, and also the JET *"Dust Collection Basics Video"* stock # JW1050V through JET Distributors.

# Grounding Instructions

Caution: This tool must be grounded while in use to protect the operator from electric shock.

In the event of a malfunction or breakdown, grounding provides a path of least resistance for electric current to reduce the risk of electric shock. This tool is equipped with an electric cord having an equipment-grounding conductor and a grounding plug. The plug must be plugged into a matching outlet that is properly installed and grounded in accordance with all local codes and ordinances.

Do not modify the plug provided. If it will not fit the outlet, have the proper outlet installed by a qualified electrician.

Improper connection of the equipment-grounding conductor can result in a risk of electric shock. The conductor, with insulation having an outer surface that is green with or without yellow stripes, is the equipment-grounding conductor. If repair or replacement of the electric cord or plug is necessary, do not connect the equipment-grounding conductor to a live terminal.

Check with a qualified electrician or service personnel if the grounding instructions are not completely understood, or if in doubt as to whether the tool is properly grounded. Use only three wire extension cords that have three-prong grounding plugs and three-pole receptacles that accept the tool's plug.

Repair or replace a damaged or worn cord immediately.

## 115 Volt Operation

As received from the factory, your dust collector is ready to run at 115 volt operation. This dust collector, when wired for 115 volts, is intended for use on a circuit that has an outlet and a plug that looks the one illustrated in Figure A. A temporary adapter, which looks like the adapter as illustrated in Figure B, may be used to connect this plug to a two-pole receptacle, as shown in Figure B if a properly grounded outlet is not available. The temporary adapter should only be used until a properly grounded outlet can be installed by a qualified electrician. This **adapter is not applicable in Canada**. The green colored rigid ear, lug, or tab, extending from the adapter, must be connected to a permanent ground such as a properly grounded outlet box, as Shown in Figure B.

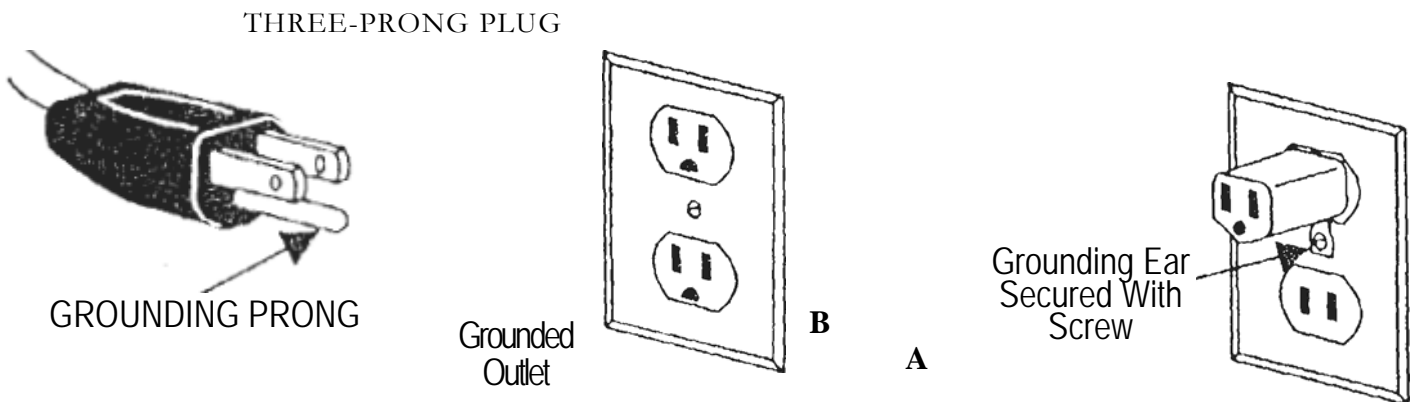



## 230 Volt Operation

If 230V, single phase operation is desired, the following instructions must be followed:

1. Disconnect the machine from the power source.
2. This dust collector is supplied with four motor loads that are connected for 115V operation, as shown in Figure A. Reconnect these four motor leads for 230V operation, as shown in Figure B.
3. The 115V attachment plug supplied with the dust collector must be replaced with a UL/CSA listed plug suitable for 230V operation. Contact your local Authorized JET Service Center or qualified electrician for proper procedures to install the plug. The dust collector must comply with all local and national codes after the 230V plug is installed.
4. The dust collector with a 230V plug should only be connected to an outlet having the same configuration. No adapter is available or should be used with the 230V plug.

**Important: In all cases (115 or 230 volts), make certain the receptacle in question is properly grounded. If you are not sure, have a registered electrician check the receptacle.**

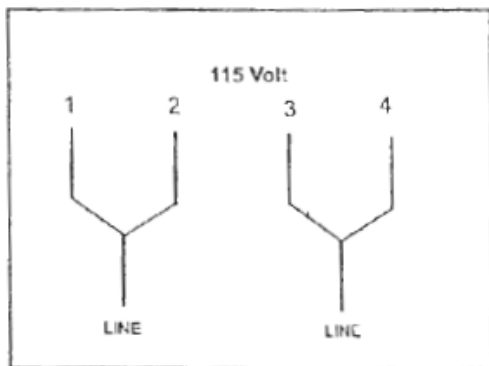

FIGURE A

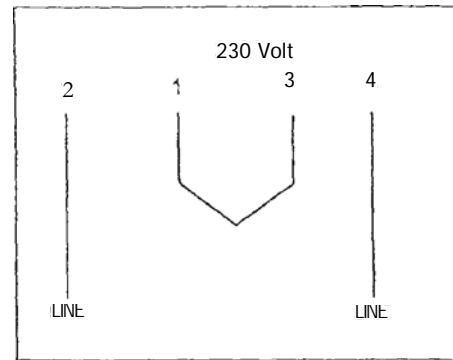
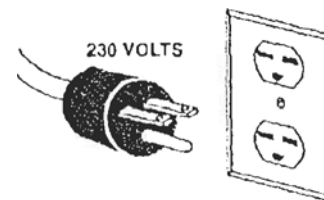
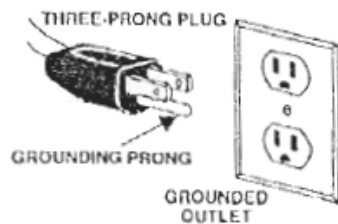

FIGURE B





## WARNING

Read and understand the entire contents of this manual before attempting assembly or operation of the dust collector!  
Failure to comply may cause serious injury!

### Unpacking

1. Remove all contents from the shipping cartons.
2. Report any damage to your distributor.
3. Do not discard any shipping material until after the dust collector has been assembled and is running properly.

### Contents of the Shipping Cartons

#### Canister Filter Box

1. Canister Filter
1. Handle
1. Bag of Hardware for handle
  2. M10 Hex Nuts
  2. M10 Flat Washers
  1. M10 Lock Washer
  4. Knobs
  1. M8 Hex Nut
  1. M8 Flat Washer
  1. M8 Lock Washer

#### DC-650C

1. Base
1. Owner's Manual
1. Warranty Card
1. Motor/Fan Assembly
5. Collector Bags
- 1 Snap Ring
4. Casters
1. Support Cylinder
1. Bag of Assembly Hardware
  4. M6x12 Hex Head Bolts
  4. MG Lock Washers
  4. MG Flat Washers
  2. 3/8"-16 Acorn Nuts
  2. 3/8" Hex Nuts
  4. M10 Flat Washers
  4. M8x12 Hex Cap Bolts
  4. M8 Flat Washers

### Tools Required for Assembly

2. 14mm Wrenches or Sockets
1. 10mm Wrench or Socket
1. 17mm Wrench



## Assembly



### WARNING

The dust collector must be disconnected from the power source during assembly. Failure to comply may result in serious injury!

1. Place motor housing on the floor with the motor fan facing upwards as shown in Figure 1.

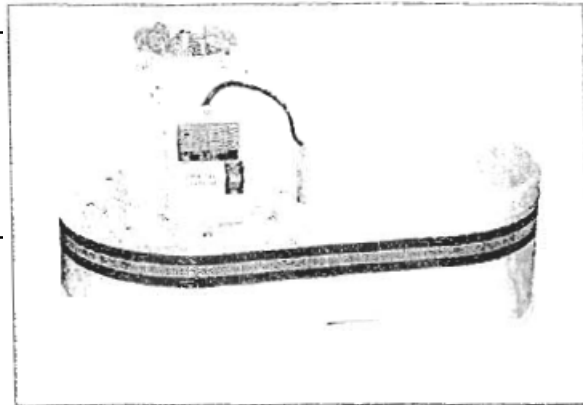

Fig. 1

2. Attach support cylinder (A, Fig. 2) to the motor housing with three M6x16 socket head cap screws and three M6 flat washers (B, Fig. 2).

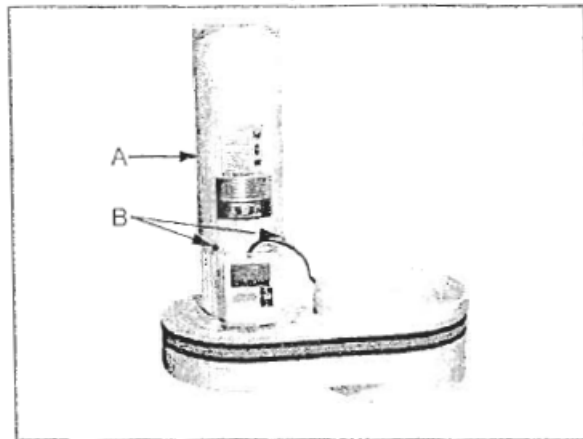

Fig. 2

3. Mount two fixed casters (C, Fig. 3) to the appropriate end of base (D, Fig. 3) using four M6 flat washers (E, Fig. 3), four M6 lock washers (F, Fig. 3) and four M6x12 hex cap bolts (G, Fig. 3).

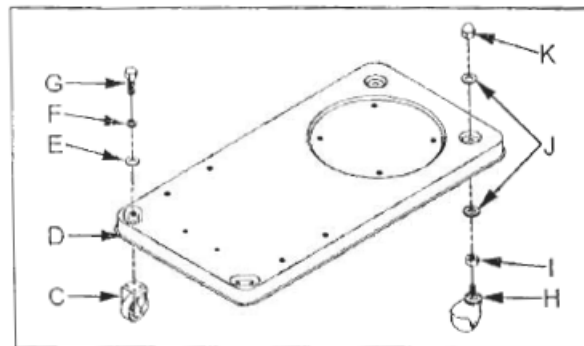

Fig. 3

4. Mount two swivel casters (H, Fig. 3) to the appropriate end of the base with two 3/8" hex nuts (I, Fig. 3), four M10 flat washers (J, Fig. 3), and two 3/8" acorn nuts (K, Fig. 3).

5. Mount support canister (L, Fig. 4) to base (M, Fig. 4) with four M8x12 hex cap bolts and four flat washers (N, Fig. 4).

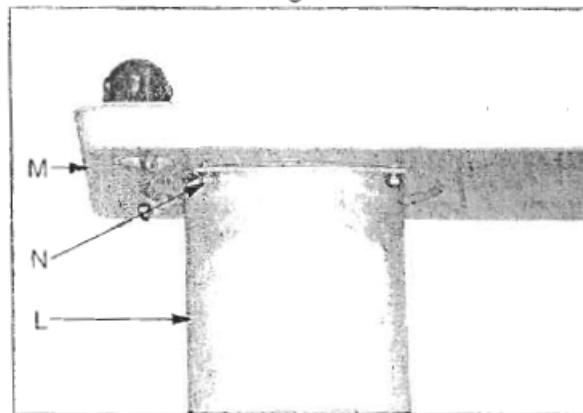

Fig. 4

6. Turn the dust collector over onto the casters. **Note:** Make sure the base and housing are relatively parallel. If not loosen the screws that secure the support cylinder to the motor and adjust as necessary. Tighten all hardware.

7. Place the canister filter so that it fits snugly over the housing and tighten the four knobs (A. Fig 5).
8. Mount handle (B, Fig 5) to arm (C. Fig 5 ) with a M8 flat washer (D, Fig. 5). M8 lock washer (E, Fig. 5), and a M8 hex nut (F, Fig 5).
9. Thread a M10 hex nut (G, Fig 5) onto the threaded rod found on top of the canister filter followed by a M10 lock washer (H, Fig. 5), and M10 flat washer (I, Fig 5).
10. Mount the arm (C, Fig. 5 ) to the threaded rod on top of canister with one M10 flat washer (J, Fig. 5) and a M10 hex nut (K, Fig. 5).
11. Place snap ring (K, Fig 6) over the top of plastic bag (L, Fig. 6) and fold over the bag approximately three inches.

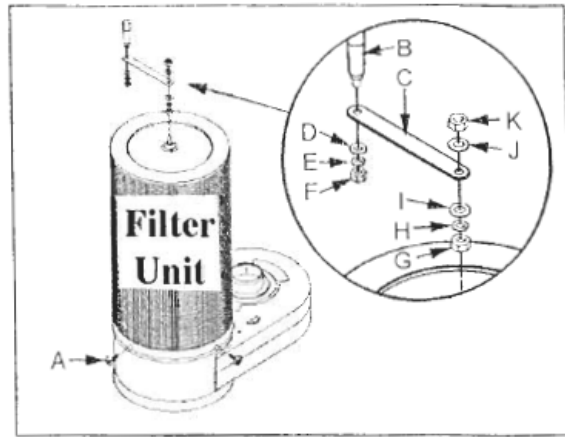

Fig. 5

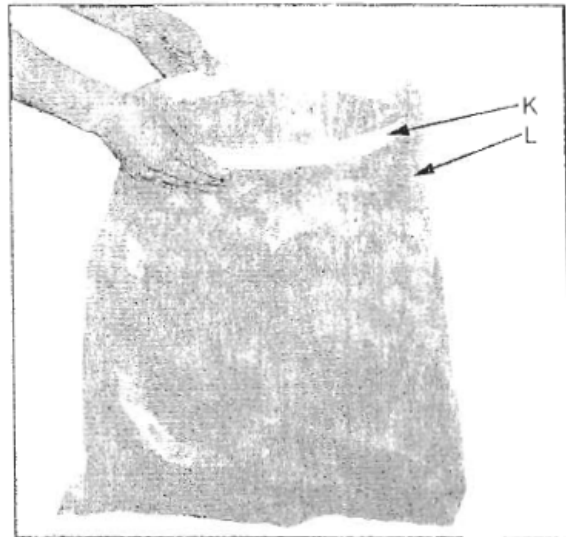

Fig. 6

12. Insert the snap ring of the collector bag into the bottom of the housing at an angle see figure 7.
13. Pull down on the ring to make sure it “seals” In the housing.

**Note:** Make sure the snap ring “snaps” into place in the housing, and also that the plastic bag hangs down approximately 3” so that There are no air leaks.

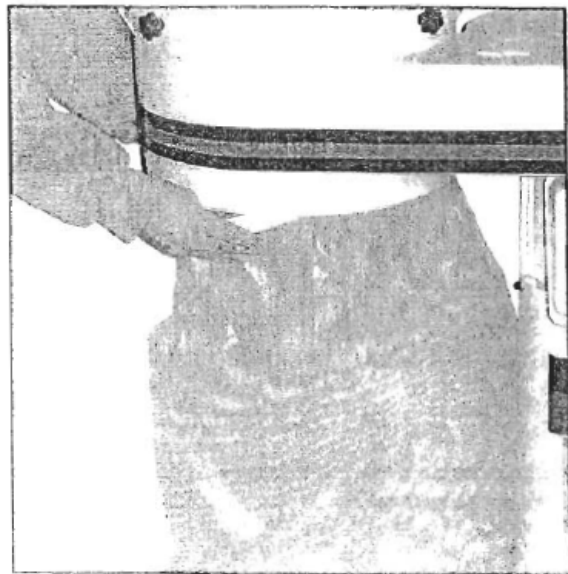
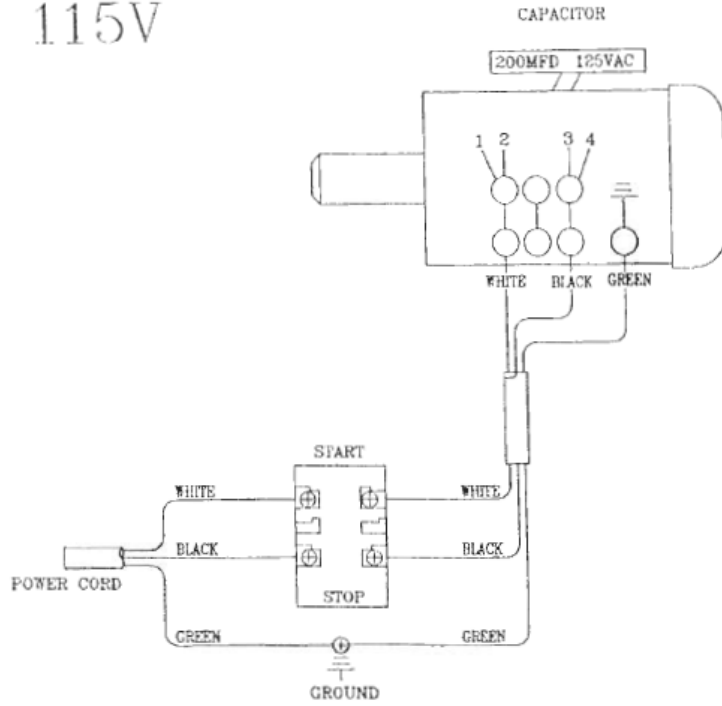

Fig. 7

Wiring Diagram

115V



230V

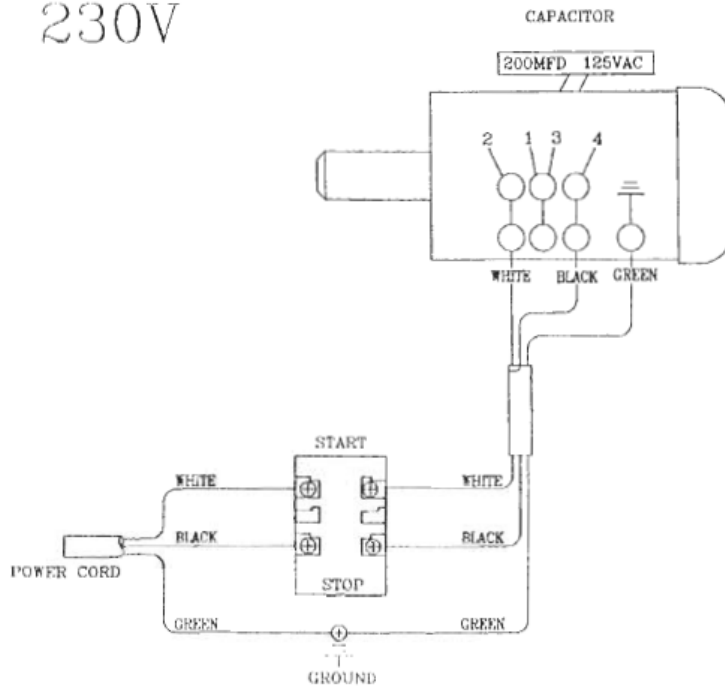

Parts Breakdown for DC-650C Dust Collector W/Canister Filter

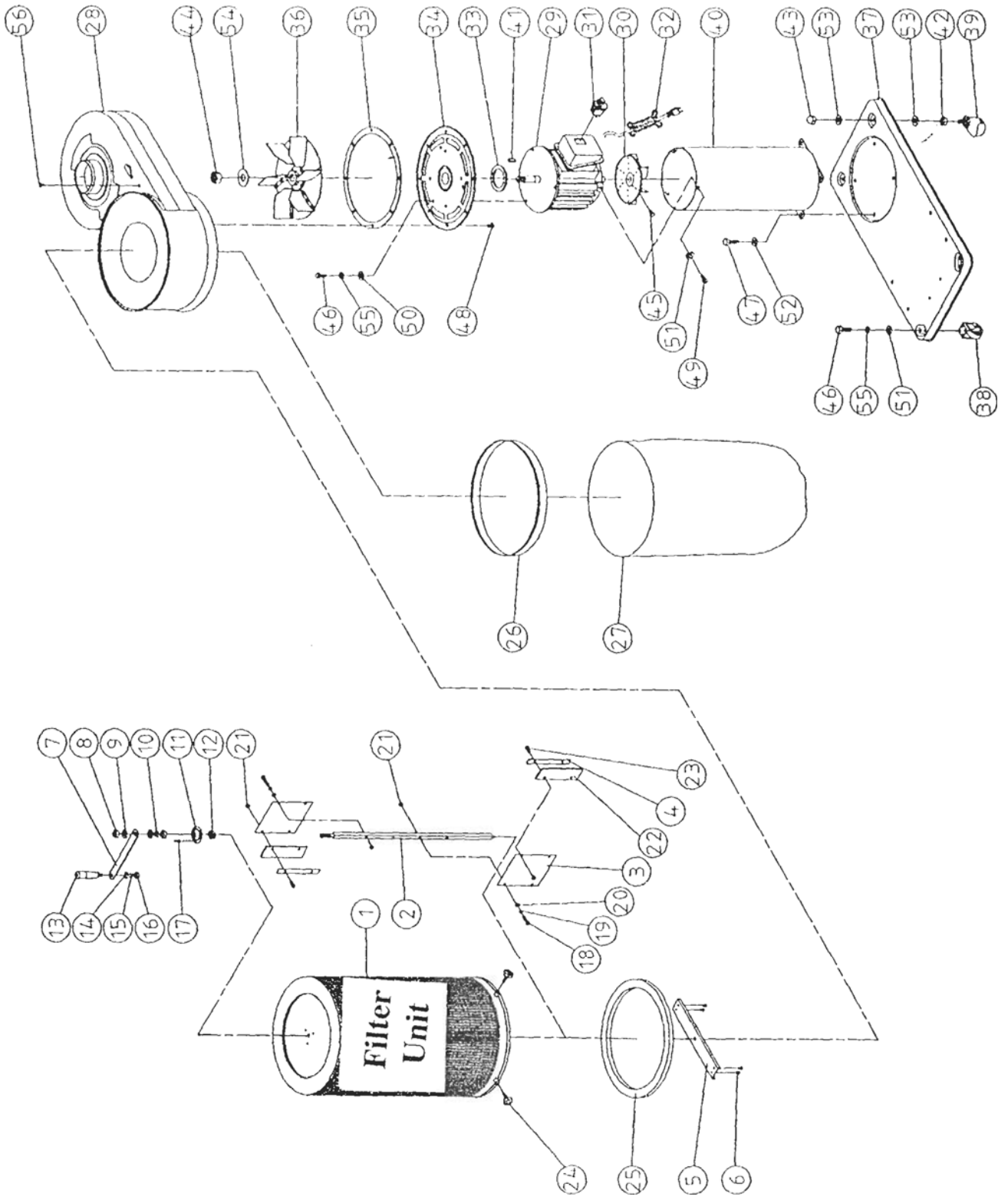

For **NATIONWIDE SERVICE** Call 1(800)225-9293

## PARTS LIST FOR THE DC-650C DUST COLLECTOR W/CANISTER FILTER

Index No.	Part No.	Description	Size	Qty
1	708737	Filter		1
2	331010	Shaft		1
3	331043	Scraper		2
4	331015	Plate		2
5	331042	Support		1
6	ST049200	Tapping Screw	M4x8	4
7	331011	Arm		1
8	TS-1540072	Hex Nut	M10	2
9	TS-1550071	Flat Washer	M10	2
10	TS-1551071	Lock Washer	M10	1
11	331014	Bracket		1
12	150623	Pad		1
13	200076	Handle		1
14	TS-1550051	Flat Washer	M8	1
15	TS-1551061	Lock Washer	M8	1
16	TS-1540061	Hex Nut	M8	1
17	BR000052	Rivet	5-2	3
18	TS-1503051	Hex Head Bolt	M6x20	4
19	TS-1551041	Lock Washer	M6	4
20	TS-1550041	Flat Washer	M6	4
21	TS-1540041	Hex Nut	M6	8
22	331017	Strip		2
23	TS-1503031	Hex Head Bolt	M6x12	4
24	331037	Jet Knob	M6x20	4
25	331047	Pad		1
26	331048	Snap Ring		1
27	709565	Clear Plastic Collection Bag		5
28	422109W	Impeller Housing		1
29	MH422001	Motor		1
	CA020010	Starting Capacitor (not shown)	200MFD, 125V	1
	994612	Centrifugal Switch (not shown)		1
	994613	Centrifugal Switch Rotor (not shown)		1
	MJ422001	Switch Box (not shown)		1
30	M4220F	Motor Fan		1
31	994532	Switch		1
32	IC422001	Power Cord		1
33	423023	Packing		1
34	412025W	Flange		1
35	410030	Flange Packing		1
36	AB410033	Impeller	9-1/2"	1



**PARTS LIST Cont.....**

<b>Index No.</b>	<b>Part No.</b>	<b>Description</b>	<b>Size</b>	<b>Qty</b>
37	423038W	Base		1
38	423044	Fixed Caster		2
39	410033	Pivoting Caster		2
40	422018W	Support Cylinder		1
41	KS050525	Key	5x5x25	1
42	TS-0561031	Hex Nut	3/8"	2
43	TS-0570031	Acorn Nut	3/8"	2
44	NH602303	Hex Nut (LH)	5//8"	1
45	TS-0207012	Hex Head Bolt	1/4"x3/8"	1
46	TS-1503031	Hex Head Bolt	M6x12	7
47	TS-1504021	Hex Head Bolt	M6x12	4
48	TS-1534042	Pan Head Screw	M6x12	8
49	TS-1514021	Hex Socket Cap Bolt	M6x16	3
50	TS-1550041	Flat Washer	M6	3
51	TS-1550041	Flat Washer	M6	7
52	TS-1550051	Flat Washer	M8	4
53	TS-1550071	Flat Washer	M10	4
54	TS-1550092	Flat Washer	M16	1
55	TS-1551041	Lock Washer	M6	7
56	TS-1534032	Pan Head Screw	M6x10	1
	DC650C-ID	Identification Label (not shown)		1
	DC650C-HP	Hardware Package (not shown)		1
	DC-IGW	Inlet Guard Warning Label (not shown)		1
	DC-MBW	Motor Bracket Warning Label		1