

**SPECIFICATIONS:**



	<b>SMS510</b>
<b>RANGE</b>	±1000 mV
<b>RESOLUTION</b>	1 mV
<b>ACCURACY (@25°C)</b>	±5 mV
<b>SETPOINT</b>	0 to 600 mV
<b>ALARM</b>	active when the measure is lower than setpoint
<b>OUTPUT POWER SOCKET</b>	active when the measure is lower than setpoint
<b>ORP ELECTRODE ENVIRONMENT</b>	MA921B/2 (included) 0 to 50°C, 95% RH max.
<b>POWER SUPPLY</b>	12 VDC (included)
<b>POWER DRIVERS</b>	115VAC, 2A, 60Hz or 230VAC, 1A, 50Hz
<b>DIMENSIONS</b>	160 x 80 x 40 mm
<b>WEIGHT</b>	220 g (meter only)

**OPTIONAL ACCESSORIES:**

<b>MA921B/2</b>	ORP Electrode with BNC connector and 2m cable
<b>M10000B</b>	Electrode rinse solution, 20 mL sachet (25 pcs)
<b>MA9015</b>	Electrode storage solution, 220 mL bottle
<b>MA950</b>	Portable meter wall fixing kit

**WARRANTY:**

This instrument is warranted from all defects in materials and manufacturing for a period of two years from the date of purchase.

The electrode is warranted for a period of 6 months.

If during this period, the repair or replacement of parts is required, where the damage is not due to negligence or erroneous operation by the user, please return the parts to either dealer or our office and the repair will be effected free of charge.

**Note:** We reserve the right to modify the design, construction and appearance of our products without advance notice.

SMS510 12/01



**USER MANUAL**

**PORTABLE  
ORP METER  
MODEL: SMS510**

*Smart Monitoring System*

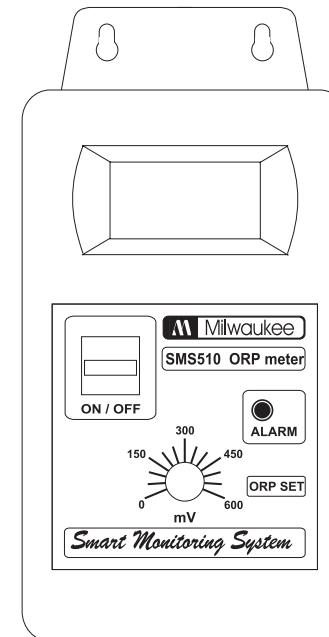

### **OPERATION:**

- Connect the supplied 12 VDC power adapter to the meter and to the mains.
- Connect the ORP electrode to the BNC socket on the bottom of the meter.
- Always remove the electrode protective cap before taking any measurement. If the electrode has been left dry, soak the tip (bottom 2.5 cm) in rinse solution (M10000B) for a few minutes to reactivate it.
- Turn the instrument on by pressing the ON/OFF key.
- Allow the reading to stabilize and the meter will start continuous monitoring.
- The meter is factory calibrated.
- A blinking alarm will indicate when the measured ORP value is lower than the setpoint.

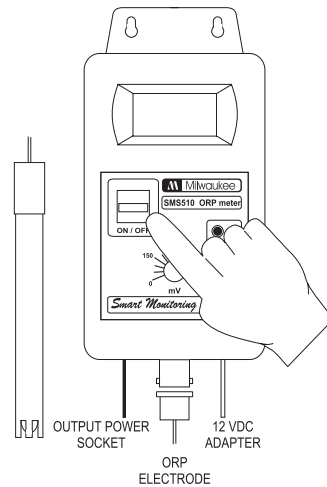

### **NOTE:**

- The power contact is not protected by fuse inside the meter. It is recommended to protect it outside, against failure.
- **WARNING:** when the alarm led is blinking, the mains voltage is present in the output power socket.

### **SETPOINT:**

- The setpoint can be selected by adjusting the central front knob to the desired value.
- The selectable range for **SMS510** is from 0 to 600 mV.

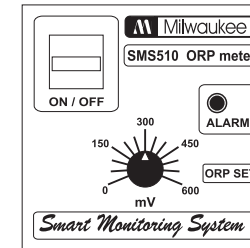

### **INSTALLATION PROCEDURE:**

