

Important Safeguards

To guard against injury, basic safety precautions should be observed, including the following:

1. Read and follow all safety instructions and important notices in these instructions as well as on the product itself.

2. This appliance is not intended for use by children or infirm persons without supervision. Young children should be supervised to ensure that they do not play with the appliance.

3. To avoid possible electric shocks, special care should be taken since water is employed in the use of aquarium equipment. For each of the following situations do not attempt repairs yourself. Return the appliance to an authorised service facility for service or discard the appliance.

a. If the appliance or any electrical component of the appliance (non-immersible equipment only) falls into the water or gets wet, do not reach for it. Unplug it and then retrieve it.

b. If the appliance shows any sign of abnormal water leakage, immediately unplug it from the power source.

c. Carefully examine the appliance after installation. It should not be plugged in if there is water on parts which are not intended to be wet.

d. Do not operate the appliance if it has a damaged cord or plug, or if it is malfunctioning, or dropped or damaged in any manner.

4. A "drip loop" (see graphic) should be arranged for each cable connecting an aquarium to a power supply. The drip loop is the part of the cable below the level of the power supply. It prevents water travelling down the cable and coming into contact with the power supply. If the plug or the socket does get wet, do not unplug the appliance. Disconnect the fuse or circuit breaker that supplies the power to the appliance, then unplug and examine for presence of water in the socket.

5. Always unplug the appliance from the electrical outlet when not in use, before putting on or taking off parts, before any type of maintenance or cleaning.

6. Never yank the cable to pull it from the socket. Pull the plug carefully to disconnect.

7. Do not use the appliance for reasons other than the intended use. The use of attachments that are not recommended or sold by the manufacturer may cause the product to be unsafe. This is not recommended.

8. Do not install or store the appliance where it will be exposed to weather or temperatures below freezing.

9. Make sure any component mounted on a tank is securely installed before operating it.

10. Ensure input voltage is the same voltage as your local power supply.

11. If an extension cable is used it should have the proper rating. Care should be taken to arrange the cord so that it will not be tripped or pulled.

12. A G.F.C.I (Ground fault circuit interrupter) & surge protector is recommended for all electrical appliances.

13. Ensure your hands are dry when turning the power switch on/off and when inserting/removing the power cable from the socket.

14. If you are in any doubt about the electrical installation or safety of this product you must consult a qualified electrician.

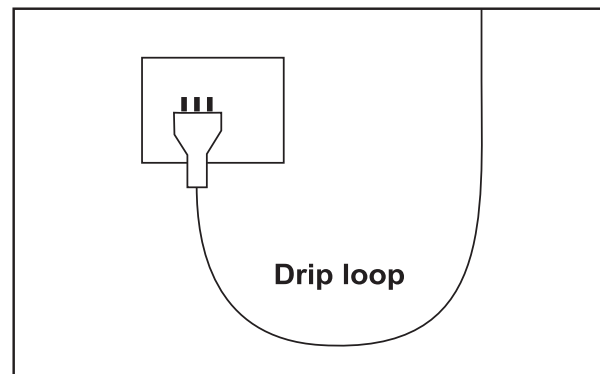

For Guarantee Conditions, please refer to the Guarantee form that is enclosed with this product.

All products are supplied with fitted plugs. This plug should not be tampered with in any way or removed. Removal or tampering with the plug invalidates our guarantee offered with this product.

For UK a 3 pin adaptor is supplied with the product and this must be used.

Before First Use / Preparation

Read and follow all the instructions, even if you feel you are familiar with the product and find a place to keep the instructions handy for future reference. Your attention is drawn particularly to the sections concerning “**IMPORTANT SAFEGUARDS**” and the “**GUARANTEE CONDITIONS**”. Please ensure you retain your original purchase receipt in the event that guarantee service is required.

Carefully unpack the filter making sure you keep all the packing material until all the parts of the product have been found and the product has been assembled.

This product is shipped to you in a factory sealed carton. Should the product malfunction in any way or if the unit is damaged and requires replacement, contact the retailer where the product was purchased for inspection.

Know Your Skimmer

G216, G220, G224

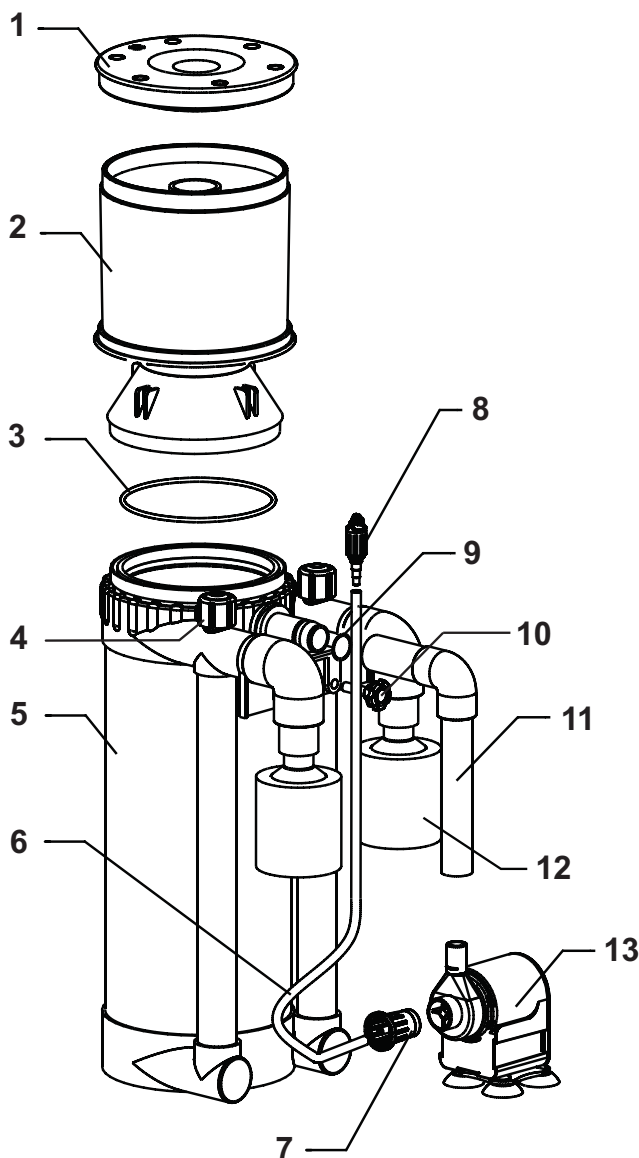

Set up/Parts

1. Collection Cup Lid
2. Collection Cup
3. O-ring
4. Outlet tap
5. Skimmer Body
6. Airline
7. Air intake
8. Air Flow Adjustor
9. Inlet O-ring
10. Fastening Screw
11. Inlet Pipe
12. Outlet Sponge
13. Pump

Replacement Parts & Filter Media

Use Aqua One Genuine Spare Parts Only. See your local Aqua One Dealer and look for the number listed below for the spare part you require. Alternatively you will find these numbers on the silver label located on the product.

G216/220 Impeller	931
G224 Impeller	941
G216/220/224 Sponge	93S



Installation

1. The pump and associated parts can be found in a small box. Unpack this box in order to assemble the pump.
 2. Ensure the air intake is attached firmly to the inlet of the pump.
 3. Attach the outlet of the pump to the base of the inlet pipe. In order to do this, unscrew the threaded connection, place it over the pump outlet, press the pump into place and tighten the threaded fitting.
 4. Remove the air flow adjustor from the top of the airline and feed the airline through the airline holder on the side of the skimmer outlet. Place the airline adjustor back on the airline.
 5. Ensure both outlet taps are fully open (turn anti-clockwise to open).
 6. Place the skimmer in the desired location. The skimmer can be placed externally, hanging on the side of the aquarium/sump, or internally in a sump. The pump must remain submersed at all times during operation.
 7. There is a second airline hose attached to the base of the collection cup. This is designed to drain the collection cup into a separate container. Ensure this airline always drains into a container such as an empty PET bottle.
 8. Switch the pump on at the power outlet. Ensure the water level does not fall too low, as the aquarium skimmer will fill with between 2.5-5L (depending on skimmer model).
 9. Adjust the water level using the outlet taps. The water level will dictate the amount of bubbles that accumulate in the collection cup. Water level should be checked daily and adjusted accordingly over the initial run-in period. For further advice concerning the adjustment of your protein skimmer, consult your local Aqua One retailer.
- For “wet” skimming (light coloured waste), adjust the outlet taps so that the water level is high in the skimmer and substantial amounts of foam are being forced into the collection cup.
- For “dry” skimming (dark, coffee coloured waste), adjust the outlet taps so that the water level is low and only small amounts of foam are being forced into the collection cup.

Maintenance

SPONGES

Remove and rinse the outlet sponges weekly to remove any accumulated waste.

PUMP

The impeller should be removed and rinsed once a month to remove any buildup. In the event that there is significant calcium buildup on the impeller (or any other part of the pump) it can be soaked in a container of vinegar for 24 hours.

To access the impeller, turn the base of the pump 90° and pull it away from the body of the pump. The impeller sits on a ceramic shaft with rubber grommets at each end. Ensure all these parts are in the pump when it is reassembled.

COLLECTION CUP

The collection cup and attached airline should be rinsed every 2-3 months. Airline should be checked regularly for blockages and replaced if required. After washing the collection cup, the skimmer should be checked daily for the subsequent 3-4 days to ensure water level is correct. Removing the film inside the neck of the collection cup during maintenance can result in slightly reduced effectiveness of the skimmer for a few days. The skimmer can be adjusted until performance is back to normal.

Trouble Shooting

SKIMMER ISN'T PRODUCING ENOUGH BUBBLES

1. Ensure air intake is attached firmly to the inlet of the pump.
2. Open air flow adjustor by turning clockwise.

SKIMMER IS COLLECTING NO WASTE

1. Ensure the water level is high enough. Adjust the outlet taps to raise water level.
2. Ensure sufficient air is entering the pump. Refer above for solution.
3. Ensure pump is running correctly. Check and clean the impeller.

COLLECTION CUP IS OVERFLOWING

1. Check airline drain. Replace if necessary.
2. Ensure water level is not too high in the skimmer. Waste exiting the skimmer should be coffee coloured. If the waste is very watery/light in colour, lower water level adjusting the outlet taps.

SKIMMER IS LEAKING

1. Check o-ring at neck of skimmer and replace if necessary.

OUTLET OR INLET PIPES ARE LOOSE

1. Check o-rings at connections and replace if necessary.

Specifications

Protein Skimmer Model: ProSkim G216
Dimensions: 21x13x40cm
Max Aquarium Volume: 400L
Flow Rate: 1400L/hr
Power Requirements: 220 – 240V
Power Consumption: 20W
Suitable: Marine

Protein Skimmer Model: ProSkim G220
Dimensions: 21x13x50cm
Max Aquarium Volume: 800L
Flow Rate: 1400L/hr
Power Requirements: 220 – 240V
Power Consumption: 35W
Suitable: Marine

Protein Skimmer Model: ProSkim G224
Dimensions: 21x13x60cm
Max Aquarium Volume: 1000L
Flow Rate: 1850L/hr
Power Requirements: 220 – 240V
Power Consumption: 35W
Suitable: Marine

Disposal of used Electrical & Electronic Equipment (Applicable in the European Union and other European countries with separate collection systems)



This symbol on the product or on its packaging indicates that the product must not be disposed of with normal household waste. Instead, it is your responsibility to dispose of your waste equipment by arranging to return it to a designated collection point for the recycling of waste electrical and electronic equipment. By separating and recycling your waste equipment at the time of disposal you will help to conserve natural resources and ensure that the equipment is recycled in a manner that protects human health and the environment. For more information about recycling this product, please contact your local city office, your household waste disposal service or the shop where you have purchased the product.