

## Control Station Operation with Infrared Remote Control

### 1. Product Descriptions

We wish to express our gratitude for your purchasing our digital product AL-KP II. You now hold a premiere, hybrid and simple RGB fixture controller. Its compact and portable design is convenient to mount and easy to operate for users. Its key features consists of as the following:



AL-KP II kit

- ☐ USITT DMX-512(1990) Multiplexed Digital Control
- ☐ Built-in 10 patterns to control up to 4 RGB fixtures
- ☐ Assignable fade setting in Auto mode
- ☐ Manually adjust RGB color saturation in manual mode
- ☐ Infrared remote control function
- ☐ With a Junction Box 1 as tension provider and DMX signal converter in the entire system
- ☐ RGB indicator on the panel to view on the output state in a real time
- ☐ US and EU versions optional

### 2. Control Panel View

#### **RGB button(1~3):**

Used to adjust the desired color.( Press the "Color 1" button to select Red, the "Color 2" button to select Green, and the "Color 3" button to select Blue).



#### **Up/Down button:**

Used to change color saturation in Manual mode; to change fade time level in Auto mode.

#### **AP button:**

Used to select built-in patters. And each tapping will activate one pattern.

#### **OFF button:**

Used to turn off the RGB fixtures.

#### **RGB indicator:**

Used to indicate the current output color of RGB fixture.

#### **Infrared Sensor:**

To receive infrared remote control signs from Infrared Remote.

#### **RJ45 Interface:**

To link with the Junction Box 1 via C-LAN cable for getting the tension and DMX output.

### 3. Infrared Remote

1)Some preset fade time levels in AL-KP II are available, consisting of 1s, 2s, 4s, 8s, 16s, 32s, 64s,128s, 256s,512s.

In Auto mode, each tapping the "Down" button represents a binary value and increase in sequence, each tapping the "Up" button represents a binary value and decrease in sequence.

2)Additionally, users can use the Infrared Remote to operate your AL-KP II.

## 4. Technical Specifications

<input type="checkbox"/> Power Requirement	Junction Box 1 (black or white for option)
<input type="checkbox"/> Connection	RJ45 interface
<input type="checkbox"/> Ingress Protection Rating	IP20
<input type="checkbox"/> Control Protocol	DMX-512 (1990)
<input type="checkbox"/> Listing	CE certified
<input type="checkbox"/> Operation temperature	-10 degC to +50 degC
<input type="checkbox"/> Dimensions	US: 112(L) x 70(W) x 45(H)mm EU: 86(L) x 86(W) x 45(H)mm
<input type="checkbox"/> Weights	Approx. 700g(Full Packing)
<input type="checkbox"/> Packing	1 AL-KP II, 1 Junction Box 1, 1 Remote Controller & 1 User Manual

## 5. Physical Dimensions

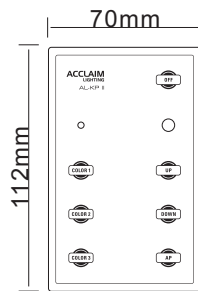

US version

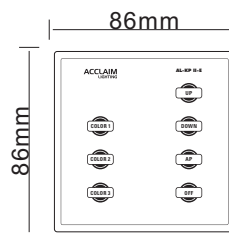

EU version

## 6. System Connection Diagram

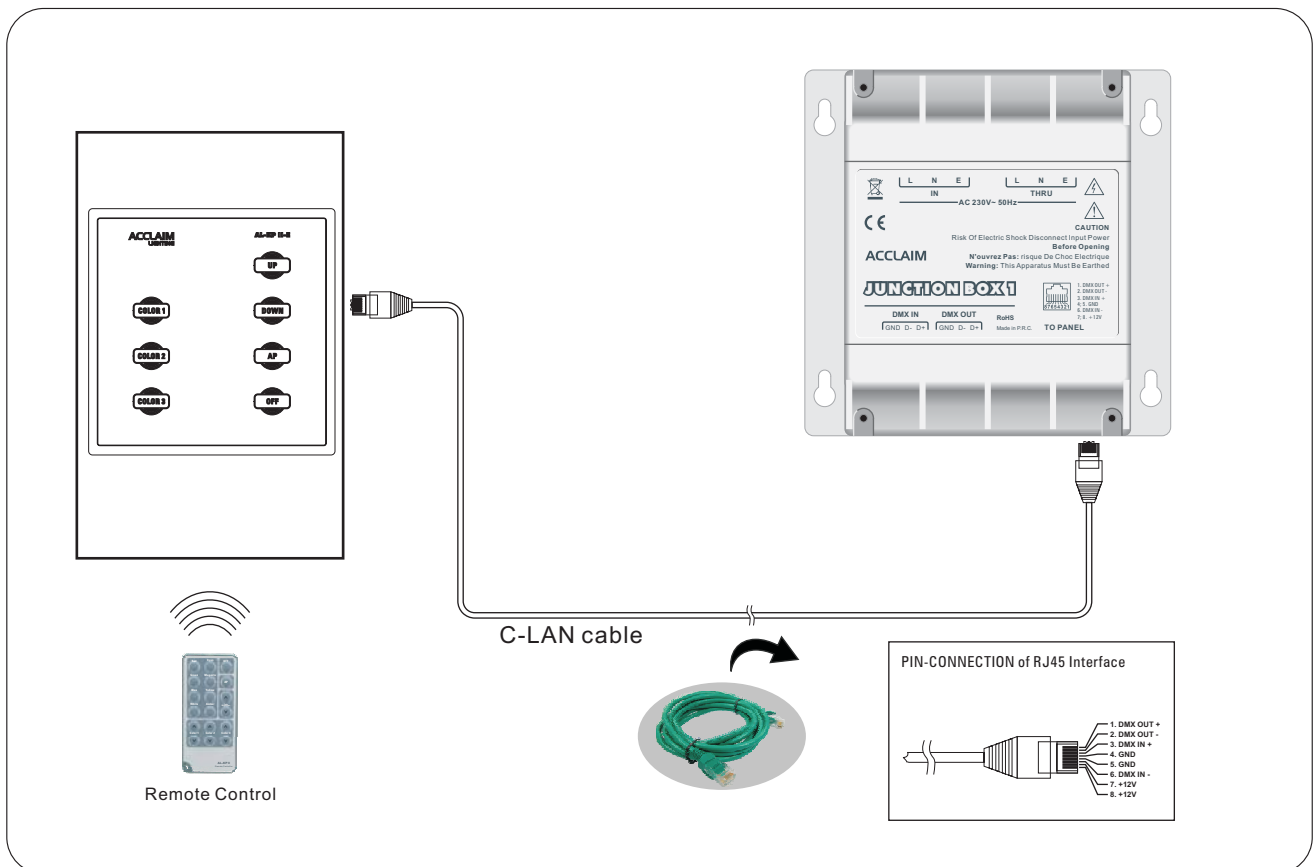

### NOTE:

Effective distance from the infrared sensor of AL-KP II to Infrared Remote shall be limited within the range of 10m. Otherwise, it results out of control.