

Your phone displays the following status indicators on the top of the screen:

Icon	Description	Icon	Description
	Signal strength ¹		Bluetooth activated
	GPRS network connected		New text message (SMS)
	EDGE network connected		New multimedia message (MMS)
	Call in progress		New Email message
	Call diverting activated		New voice mail message
	SOS message feature activated		Memory card inserted
	Alarm activated		Normal profile activated
	Connecting to secured web page		Silent profile activated
	Connected to PC		Battery power level
	FM radio on	10:00	Current time
	FM radio paused	1. This icon may vary depending on your SIM card setting.	
	Music playback in progress		
	Music playback paused		
	Roaming (outside of normal service area)		

Manage your SIM cards

Your phone supports Dual SIM mode that enables you to use two SIM cards at the same time without changing them. Learn to activate SIM cards and change the card settings.

Your device supports dual standby with two different networks. You cannot make or answer calls on both networks at the same time.

To switch networks

In Idle mode, press and hold the Back key to switch between networks. The icon of the selected SIM card is highlighted.

To activate SIM cards

- In Menu mode, select **Settings** → **SIM cards management** → **Network**.
- Select a SIM card → **On**.
- Select **Save**.

To switch SIM cards automatically

- In Menu mode, select **Settings** → **SIM cards management** → **SIM auto switch**.
- Select **SIM auto switch**.
- Set the starting and ending time to use the SIM card.
- Select **Save**.

Add a new contact

The memory location to save new contacts may be preset depending on your service provider. To change the memory location, in Menu mode, select **Contacts** → **More** → **Settings** → **Save new contact to** → a memory location → **Save**.

- In Idle mode, select **Keypad** and enter a phone number.
- Select .
- Select **Create contact** → a memory location (if necessary).
- Select a number type (if necessary).
- Enter contact information.
- Select **Save** to add the contact to memory.

Send and view messages

To send a text or multimedia message

- In Menu mode, select **Messages** → **Create message**.
- Select the recipient field → **Enter manually**.
- Enter a recipient number and select **Done**.
- Select the text input field.
- Enter your message text and select **Done**.
See "Enter text."
For sending as a text message, skip to step 7. For attaching multimedia, continue with step 6.
- Select **Add media** and add an item.
- Select **Send** to send the message.

Install the SIM card and battery

- Remove the back cover and battery and insert the SIM cards.

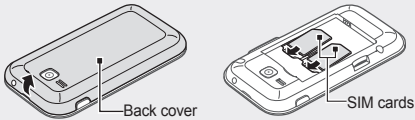

- Insert the battery and replace the back cover.

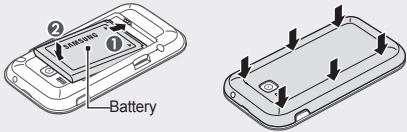

Charge the battery

- Plug a travel adapter.
- When charging is finished, unplug the travel adapter.

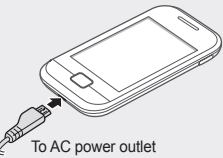

- Do not remove the battery before removing the travel adapter. Doing this may cause damage to the phone.
- To save energy, unplug the travel adapter when not in use. The travel adapter does not have a power switch, so you must unplug the travel adapter from the outlet when not in use to avoid wasting power. The travel adapter should remain close to the socket when in use.

Insert a memory card (optional)

Your phone accepts microSD™ or microSDHC™ memory cards up to 16 GB (depending on memory card manufacturer and type).



- Formatting the memory card on a PC may cause incompatibility with your phone. Format the memory card only on the phone.
- Frequent writing and erasing of data will shorten the life span of memory cards.

- Remove the back cover and the battery.
- Insert a memory card with the gold-coloured contacts facing down.

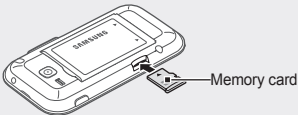

- Push the memory card in the memory card slot until it locks in place.
- Replace the battery cover.

Instructional icons

	Caution: situations that could cause damage to your phone or other equipment
	Note: notes, usage tips, or additional information
→	Followed by: the order of options or menus you must select to perform a step; for example: In Menu mode, select Messages → Create message (represents Messages , followed by Create message)
[]	Square brackets: phone keys; for example: [>] (represents the Power/End key)

Use the touch screen

Learn basic actions to use the touch screen.



To avoid scratching the touch screen, do not use sharp tools.



- For the optimal use of the touch screen, remove the protection film before using your phone.
- Your touch screen has a layer that detects small electrical charges emitted by the human body. For best performance, tap the touch screen with your fingertip. The touch screen will not react to touches of sharp tools, such as a stylus or pen.

- Tap: Touch once to select or launch a menu, option, or application.

Use widgets

Learn to use widgets on the idle screen.



- Some of your widgets connect to web services. Selecting a web-based widget may incur additional charges.
- Available widgets may vary depending on your region or service provider.

To open a widget

- In Idle mode, scroll left or right to a panel of the idle screen.
- Select a widget to activate on the idle screen.

To organize your widget

You can organize each panel of the idle screen with your favorite widgets.

- In Menu mode, select **Settings** → **Display** → **Widgets**.
- Select a widget for each panel.

Enter text

To change the text input mode

- Select **English** to change the input language.
- Select **T9** to switch between T9 and ABC modes. The dot turns green in T9 mode.
- Select **123** or **sym** to switch to Number or Symbol mode.

- Tap and hold: Tap an item and hold it for more than 2 seconds.
- Drag: Tap and hold on an item, and then drag your finger to move the item.

Turn your phone on or off

To turn your phone on,

- Press and hold [>].
- Enter your PIN and press **OK** (if necessary).
- When the setup wizard opens, customise your phone as desired by following the screen.



If the battery remains fully discharged or removed from the device, the time and date will be reset.

To turn your phone off, repeat step 1 above.

Access menus

To access your phone's menus,

- In Idle mode, press **Menu** to access Menu mode.
- Scroll left or right to a main menu screen.
- Select a menu or application.
- Press the Back key to move up one level; Press [>] to return to Idle mode.



- When you access a menu requiring the PIN2, you must enter the PIN2 supplied by the SIM card. For details, contact your service provider.
- Samsung is not responsible for any loss of passwords or private information or other damages caused by illegal software.

T9 mode

- Press the appropriate virtual keys to enter an entire word.
- When the word displays correctly, press to insert a space. If the correct word does not display, select to select an alternate word.

ABC mode

Press an appropriate virtual key until the character you want appears on the display.

Number mode

Press an appropriate virtual key to enter a number.

Symbol mode

Press an appropriate virtual key to enter a symbol.

To use other features for text input

- To move the cursor, select and then the virtual navigation key.
- To delete characters one by one, select . To delete words quickly, tap and hold .
- To enter punctuation marks, select **1** repeatedly.
- To change case, select . To type all the words in uppercase, double tap .

To view text or multimedia messages

- In Menu mode, select **Messages** → **Inbox**.
- Select a text or multimedia message.

Make fake calls

You can simulate an incoming call when you want to get out of meetings or unwanted conversations.

To activate the fake call feature

In Menu mode, select **Settings** → **Call** → **Fake call** → **Fake call hot key**.

To make a fake call

In Idle mode, press and hold the Volume key down.

Activate and send an SOS message

In an emergency, you can send SOS messages to your family or friends for help.

To activate the SOS message

- In Menu mode, select **Messages** → **Settings** → **SOS messages** → **Sending options**.
- Select **Sending SOS** to activate the SOS message feature.
- Select **Recipients** → **Add recipients** → **Contacts**. You can also enter phone numbers in the recipient list. Skip to step 7.
- Select **Multiple**.
- Select contacts → **Add**.
- Select a number (if necessary).

To adjust the volume of the touch tone

In Idle mode, press the Volume key to adjust the volume.

To adjust the volume of voice during a call

While a call is in progress, press the Volume key up or down to adjust the volume.



In noisy environments, you may have difficulty hearing the calls while using the speakerphone feature. For better audio performance, use the normal phone mode.

Change your ringtone

- In Menu mode, select **Settings** → **Sound profiles**.
- Select the profile you are using.



If you are using the silent profile, you are not allowed to change the ringtone.

- Select a SIM card.
- Select **Voice call ringtone**.
- Select a memory location (if necessary).
- Select a ringtone and select **Set**.

To switch to another profile, select it from the list.

Call a recently dialled number

- In Idle mode, press [>] to display a list of recent numbers.
- Select or to a call type.
- Scroll up or down to a number or name.
- Select the number or name to view details of the call and press [>] to dial the number.

- When you are finished setting the recipients, select **Save** to save the recipients.
- Select **Repeat**, set the number of times to repeat the SOS message, and select **Save**.
- Press the Back key → **Yes**.

To send an SOS message

- With the touch screen and the keys locked, press the Volume key four times to send an SOS message to preset numbers.
- To exit SOS mode, press [>].

Use the camera

To capture photos

- In Menu mode, select **Camera** to turn on the camera.
- Rotate the phone counterclockwise to landscape view.
- Aim the lens at the subject and make any adjustments.
- Press to take a photo. The photo is saved automatically.

To view photos

In Menu mode, select **My files** → **Images** → a photo file.

To record videos

- In Menu mode, select **Camera** to turn on the camera.
- Rotate the phone counterclockwise to landscape view.
- Select [>] to switch to Recording mode.

- Aim the lens at the subject and make any adjustments.
- Press to start recording.
- Press to stop recording. The video is saved automatically.

To view videos

In Menu mode, select **My files** → **Videos** → a video file.

Set and use alarms

To set a new alarm

- In Menu mode, select **Alarms**.
- Press **Create**.
- Set alarm details.
- Press **Save**.



The snooze feature sets the phone to repeat the alarm after a specified length of time. To set the length of time for the snooze feature, select **Settings** → **Snooze**.

To stop an alarm

- When the alarm sounds,
- Tap and hold **Stop** to stop the alarm.
 - Tap and hold **Snooze** to silence the alarm for the snooze period.

To deactivate an alarm

- In Menu mode, select **Alarms**.
- Select the dot next to the alarm you want to deactivate.

