

- \* Depending on the software installed or your service provider or country, some of the descriptions in this guide may not match your phone exactly.
- \* Depending on your country, your phone and accessories may appear different from the illustrations in this guide.

**SAMSUNG ELECTRONICS**



World Wide Web  
<http://www.samsungmobile.com>

Printed in Korea  
Code No.:GH68-11983A  
English (AUS). 10/2006. Rev. 1.1



# **SGH-A501 User's Guide**





# Important safety precautions



Failure to comply with the following precautions may be dangerous or illegal.

## **Use road safety at all times**

Do not use a hand-held phone while driving. Park the vehicle first.

## **Switch off the phone when refuelling**

Do not use the phone at a refuelling point (service station) or near fuels or chemicals.

## **Switch off in an aircraft**

Wireless phones can cause interference. Using them in an aircraft is both illegal and dangerous.

## **Switch off the phone near all medical equipment**

Hospitals or health care facilities may be using equipment that could be sensitive to external radio frequency energy. Follow any regulations or rules in force.

## **Interference**

All wireless phones may be subject to interference, which could affect their performance.



## Be aware of special regulations

Meet any special regulations in force in any area and always switch off your phone whenever it is forbidden to use it, or when it may cause interference or danger.

## Water resistance

Your phone is not water-resistant. Keep it dry.

## Sensible use

Use only in the normal position (held to the ear). Avoid unnecessary contact with the antenna when the phone is switched on.

## Emergency calls

Key in the emergency number for your present location, then press .

## Keep your phone away from small children

Keep the phone and all its parts, including accessories, out of the reach of small children.

## Accessories and batteries

Use only Samsung-approved batteries and accessories, such as headsets and PC data cables. Use of any unauthorised accessories could damage you or your phone and may be dangerous.

- The phone could explode if the battery is replaced with an incorrect type.
- Dispose of used batteries according to the manufacturer's instructions.



At very high volumes, prolonged listening to a headset can damage your hearing.

## Qualified service

Only qualified service personnel may repair your phone.

For more detailed safety information, see "Health and safety information" on page 97.

# About this Guide

This User's Guide provides you with condensed information about how to use your phone. To quickly learn the basics for your phone, please refer to "Get started" and "Step outside the phone."

In this guide, the following instruction icons appear:

- ☑ Indicates that you need to pay careful attention to the subsequent information regarding safety or phone features.
- ▶ Indicates that you can get more information on the referenced page.
- Indicates that you need to press the Navigation keys to scroll to the specified option and then select it.
- [ ] Indicates a key on the phone. For example, [  ]
- < > Indicates a soft key, whose function is displayed on the phone screen. For example, < **Menu** >



- **3G**  
Your phone is capable of operating in a 3G environment, allowing much greater data transfer speed, video streaming, and video conferencing.

## *Special features of your phone*

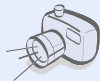

- **Camera and camcorder**  
Use the camera module on your phone to take a photo or record a video.



- **Media player**  
Play media files on your phone. You can enjoy high quality videos and music.



- **Bluetooth**

Transfer media files and personal data and connect to other devices using free, wireless Bluetooth technology.



- **Web browser**

Access the wireless web to get up-to-the-minute information and a wide variety of media content.



- **Get personal with photo caller ID**

See who's calling you with their very own photo displays.



- **Name card**

Create name cards with your number and profile. Whenever introducing yourself to others, use this convenient electronic name card.



- **Multimedia Message Service (MMS)**

Send and receive MMS messages with a combination of text, images, video, and audio.



- **E-mail**

Send and receive e-mails with image, video, and audio attachments.



- **Java**

Enjoy Java™-based embedded games and download new games.



- **Organizer**

Keep track of your daily, weekly, and monthly schedule.

## Contents

### **Unpack** **6**

*Make sure you have each item*

### **Your phone** **6**

*Keys, features, and locations*

### **Get started** **7**

*First steps to operating your phone*

Install and charge the phone .....	7
Power on or off.....	8
Keys and display .....	8
Access menu functions .....	11
Customise your phone.....	12
Make/Answer calls .....	15

### **Step outside the phone** **15**

*Begin with your camera, the media player, the web, and other special features*

Use the camera .....	15
Play media files .....	16
Browse the web.....	18
Use Phonebook.....	18
Send messages .....	20

View messages .....	21
Use Bluetooth .....	22
Switch applications .....	24
Use a memory card .....	24

### **Enter text** **26**

*ABC, T9, Number, and Symbol modes*

### **Call functions** **28**

*Advanced calling features*

### **Menu functions** **34**

*All menu options listed*

### **Solve problems** **95**

*Help and personal needs*

### **Health and safety information** **97**

### **Index** **105**

## Overview of menu functions

To access Menu mode, press **<Menu>** in Idle mode.

<b>1 Call Log</b>	p. 34	<b>4 Browser</b>	p. 51	<b>8 Messages</b>	p. 67
1 Recent Contacts	p. 34	1 BigPond Home	p. 51	1 Create New Message	p. 67
2 Missed Calls	p. 34	2 Bookmarks	p. 52	2 Inbox	p. 70
3 Dialed Calls	p. 34	3 Enter URL	p. 53	3 Sent	p. 72
4 Received Calls	p. 35	4 Browser Profiles	p. 53	4 Outbox	p. 72
5 Delete All	p. 35	5 Clear Cache	p. 53	5 Drafts	p. 73
6 Call Time	p. 35			6 Email Inbox	p. 73
7 Data Volume	p. 35	<b>5 My Place</b>	p. 53	7 Templates	p. 74
8 Data Call Time	p. 36	1 BigPond	p. 53	8 Voice Mail	p. 75
<b>2 Phonebook</b>	p. 36	2 FOXTEL	p. 54	9 Broadcast	p. 75
1 Contact List	p. 36	3 Search	p. 54	10 Delete All	p. 76
2 Add New Contact	p. 37	4 Email	p. 54	11 Settings	p. 76
3 Groups	p. 38	5 Music	p. 54	12 Memory Status	p. 81
4 Speed Dial	p. 39	6 Downloads	p. 54		
5 My Name Card	p. 39	7 Photos	p. 54	<b>9 Settings</b>	p. 81
6 Copy All	p. 40	8 Maps	p. 55	1 Profiles	p. 81
7 Own Number	p. 40	9 My Account	p. 55	2 Display Settings	p. 83
8 FDN List <sup>1</sup>	p. 40			3 Time & Date	p. 84
9 Service Number <sup>1</sup>	p. 41	<b>6 My Files</b>	p. 55	4 Phone Settings	p. 84
10 Settings	p. 41	Images	p. 55	5 Call	p. 85
11 Memory status	p. 41	Videos	p. 57	6 Video Call	p. 87
<b>3 Applications</b>	p. 41	Sounds	p. 58	7 Connectivity	p. 88
Media Player	p. 41	Music	p. 59	8 Application Settings	p. 92
Alarm	p. 43	Games	p. 60	9 Security	p. 93
Voice Recorder	p. 44	Other Files	p. 61	10 Memory Status	p. 94
Organizer	p. 45	Memory Card <sup>2</sup>	p. 61	11 Reset Settings	p. 95
Calculator	p. 49	Memory Status	p. 61	12 Phone Information	p. 95
Converter	p. 49				
World Time	p. 50	<b>7 Camera</b>	p. 61		
PocketNews <sup>1</sup>	p. 51				

1. Available only if supported by your USIM/SIM card.
2. Available only if a memory card is inserted.



## Unpack

Make sure you have each item

- Phone
- Battery
- Travel Adapter
- PC Data Cable
- PC Link CD
- User's Guide

You can obtain various accessories from your local Samsung dealer.

- The items supplied with your phone and the accessories at your Samsung dealer may vary, depending on your country or service provider.

## Your phone

Keys, features, and locations

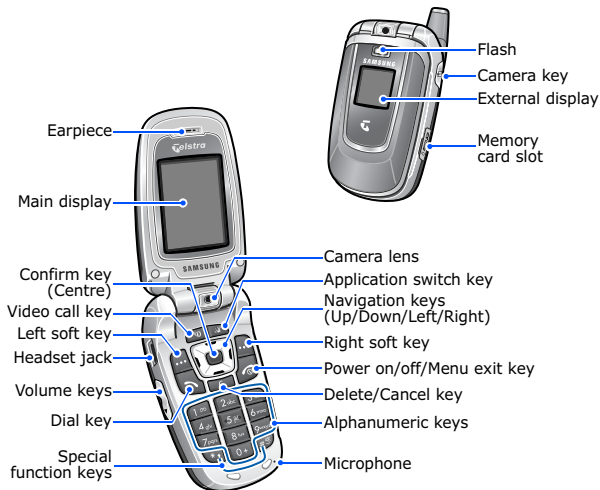

## Get started

First steps to operating your phone

### USIM/SIM card information

When you subscribe to a cellular network, you receive a plug-in SIM (Subscriber Identity Module) card loaded with your subscription details, such as your PIN, and available optional services. For 3G services, you can purchase a USIM (Universal Subscriber Identity Module) card.

### Install and charge the phone

- 1** Remove the battery.



- If the phone is already on, first turn it off by pressing and holding [Power].

- 2** Insert the USIM/SIM card.

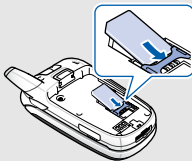

- Make sure that the gold-coloured contacts on the card are face down.

- 3** Install the battery. **4** Plug the travel adapter into the phone.

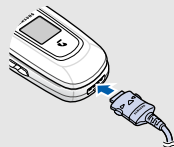
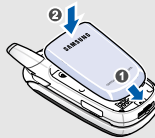

- 5** Plug the adapter into a standard AC wall outlet.

- 6** When the phone is completely charged (the battery icon becomes still), unplug the adapter from the power outlet.

- 7** Remove the adapter from the phone.

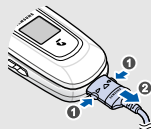

## Low battery indicator

When the battery is low:

- a warning tone sounds,
- the battery low message displays, and
- the empty battery icon  blinks.

If the battery level becomes too low, the phone automatically turns off. Recharge your battery.

## Power on or off

Switch on	1. Open the phone.
Do not turn on the phone when mobile phone use is prohibited.	2. Press and hold [  ].
	3. If necessary, enter the PIN and press <b>&lt;Confirm&gt;</b> .

### Switch off

1. Open the phone.
2. Press and hold [].

## Keys and display

### Keys



Make a video call.



Open the application switch window to access other applications without exiting the current application.



Perform the function indicated on the bottom line of the display.



In Idle mode, access your favourite menus directly.

► p. 84

In Menu mode, scroll through menu options.



In Idle mode, access Menu mode.

In Menu mode, select a highlighted menu option or confirm input.



Make or answer a call.

In Idle mode, retrieve numbers recently dialed, missed, or received.



Delete characters from the display or return to the previous menu level.



Press and hold to switch the phone on or off.

End a call.

In Menu mode, cancel input and return the phone to Idle mode.



Enter numbers, letters, and some special characters.



In Idle mode, press and hold [1] to access your voicemail server. Press and hold [0] to enter an international call prefix.



Enter special characters.



Press and hold [#] to activate or deactivate the Silent profile. Press and hold [\*] to enter a pause between numbers.



Adjust the phone volume.

In Idle mode, with the phone open, adjust the key tone volume. With the phone closed, press and hold to turn on the display.



Press to turn on the camera.





In Camera mode, take a photo or record a video.

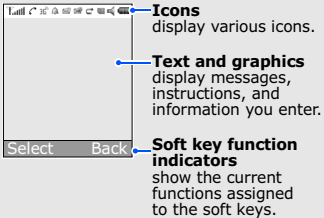











## Display



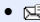

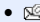

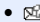







### Layout



### Icons

-  Received signal strength
-  Voice call in progress
-  Out of your service area; you cannot make or receive voice calls
-  Video call in progress
-  Out of your service area; you cannot make or receive video calls

-  Browsing Internet on PC using the phone as modem
-  Accessing services in a 2.5G (GPRS) network
-  Accessing services in a EDGE network
-  Accessing services in a 3G (UMTS) network
-  Accessing services in a HSDPA network
-  Alarm set ▶ p. 43
-  New message:
  -  : SMS
  -  : MMS
  -  : E-mail
  -  : Voicemail
  -  : Push
  -  : Configuration message

- 
 Inbox full:
  -  : SMS
  -  : MMS
  -  : E-mail
  -  : Voicemail
  -  : Configuration message
- 
 Call diverting feature active ▶ p. 85
- 
 Memory card inserted ▶ p. 25
- 
 Profile setting ▶ p. 83
  -  : Normal
  -  : Meeting
  -  : Car
  -  : Silent
  -  : Outdoor
- 
 Battery power level

## Access menu functions

### Use the soft keys

The roles of the soft keys vary depending on the function you are using. The bottom line of the display indicates their current role.



Press the left soft key to select the highlighted option.

Press the right soft key to return to the previous menu level.

### Select an option

1. Press a desired soft key.
2. Press the Navigation keys to move to the next or previous option.
3. Press **<Select>** or [Centre] to confirm the function displayed or option highlighted.
4. To exit, choose either of the following methods:
  - Press **<Back>** or [C] to move up one level.
  - Press [Ⓜ] to return to Idle mode.

### Use shortcuts

Press the number key corresponding to the option you want.

## Customise your phone

### Call ringer melody

You can change the call ringtone by changing the properties of the currently active sound profile.

#### To change the profile properties:

1. In Idle mode, press **<Menu>** and select **Settings** → **Profiles**.
2. Scroll to the sound profile you are using.
3. Press **<Options>** and select **Edit**.
4. Select **Voice Call Ringtone** and select a ringtone for voice calls.
5. Select **Video Call Ringtone** and select a ringtone for video calls.
6. Press **<Options>** and select **Save**.

---

### To change the sound profile:

1. In Idle mode, press <**Menu**> and select **Settings** → **Profiles**.
2. Select the profile you want.

---

### Idle mode Wallpaper

You can set a wallpaper for the idle screen on each display.

### For the main display:

1. In Idle mode, press <**Menu**> and select **Settings** → **Display Settings** → **Wallpaper**.
2. Scroll to an image folder.
3. Select an image.
4. Press <**Set**>.

---

### For the external display:

1. In Idle mode, press <**Menu**> and select **Settings** → **Display Settings** → **Sub LCD**.
2. Select an image type.
3. For **Clock**, scroll to a clock type and press <**Save**>.

For **Sub Title**, enter a greeting and press <**Save**>.

For **Images**, press <**Change**> and select an image. Press [Centre] to save the image.

4. Press <**Change**>.



### Menu shortcuts

You can set the Navigation keys to function as shortcuts to access your favourite menus.

1. In Idle mode, press **<Menu>** and select **Settings** → **Phone Settings** → **Short Cut**.
2. Select a key.
3. Select a menu to be assigned to the key.

### Silent profile

You can activate the Silent profile to avoid disturbing other people.

Press and hold [**#**] in Idle mode.

### Phone lock

You can protect the phone against unauthorised use with a phone password. The phone will require the password on power-up.

1. In Idle mode, press **<Menu>** and select **Settings** → **Security** → **Change Phone Password**.
2. Enter a new 4- to 8-digit password and press **<Confirm>**.
3. Enter the new password again and press **<Confirm>**.
4. Select **Phone Lock**.
5. Select **Enable**.
6. Enter the password and press **<Confirm>**.

## Make/Answer calls

### Make a call

To make a voice call:

1. Enter an area code and phone number.
2. Press [↵].
3. To end the call, press [⏏].

To make a video call:

1. Enter an area code and phone number.
2. Press [📹].
3. To end the call, press [⏏].

### Answer a call

1. When the phone rings, press [↵].
2. For a video call, press <Show Me> to allow the other person to see you.
3. To end the call, press [⏏].

### Adjust the volume during a call

Press [▲/▼].

## Step outside the phone

Begin with your camera, the media player, the web, and other special features

## Use the camera

### Take a photo

1. Open the phone.
2. In Idle mode, press [📷] to turn on the camera.
3. Aim the lens at the subject by rotating the camera lens and make any desired adjustments.

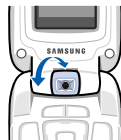

4. Press [Centre] or [📷] to take a photo. The photo is saved automatically.
5. Press [C] to take another photo.

### View a photo

1. In Idle mode, press <Menu> and select **My Files** → **Images**.
2. Select the photo you want from the **Photos** folder.

### Record a video

1. In Idle mode, press [📷] to turn on the camera.
2. Press [1] to switch to Record mode.
3. Press [Centre] or [📷] to start recording.
4. Press [Centre] or [📷] to stop recording. The video is saved automatically.
5. Press [Centre] or [C] to record another video.

### Play a video

1. In Idle mode, press <Menu> and select **My Files** → **Videos**.
2. Select the video you want from the **Videos** folder.

## Play media files

### Copy media files to the phone

Use these methods:

- Download from the wireless web ▶ p. 51
- Download from a computer using the optional Samsung PC Studio ▶ Samsung PC Studio User's Guide
- Receive via Bluetooth ▶ p. 90
- Copy to a memory card and insert the card into the phone ▶ p. 25

## Create a play list

1. In Idle mode, press <Menu> and select **Applications** → **Media Player**.
2. Press [Centre].
3. Press <Options> and select **Add** → **Folder** or **Files**.
4. Scroll to the folder you want, or press [Centre] to select the files you want.
5. Press <Select> or <Add>.
6. Press <Back> to return to the media player screen.

## Play media files

1. From the media player screen, press [Centre].
2. Select the file you want.
3. During playback, use the following keys:
  - Centre: pauses or resumes playback.
  - Up: opens the play list.
  - Left: returns to the previous file. Moves backward in a file when held down.
  - Right: skips to the next file. Skips forward in a file when held down.
  - ▲/▼: adjusts the volume.
4. Press [Down] to stop playback.

## Browse the web

Using a built-in web browser, you can easily access the wireless web to get a variety of up-to-date services and information and to download web content.

### Launch the web browser

In Idle mode, press **<BigPond>**.

### Navigate the web

- To scroll through browser items, press [Up] or [Down].
- To select an item, press **<Select>** or [Centre].
- To return to the previous page, press **<Back>** or [C].
- To access options, press **<Options>**.

## Use Phonebook

### Add a contact

#### To the phone's memory:

1. In Idle mode, enter a phone number.
2. Press [Centre] and select **Phone** → **New** → a number type.
3. Specify contact information: First Name, Last Name, Phone Number, Email Work, Email Home, Group, Homepage, Birthday, and More Information (Job Title, Department, Company, Nickname, and Notes).
4. Press **<Options>** and select **Save** to save the contact.

---

**To the USIM/SIM card:**

1. In Idle mode, enter a phone number.
2. Press [Centre] and select **SIM** → **New**.
3. Specify contact information: Name, Phone Number, Group (for USIM), and Location Number.
4. Press [Centre] to save the contact.

---

**Find a contact**

1. In Idle mode, press <**Menu**> and select **Phonebook** → **Contact List**.
2. Enter the first few letters of the name you want.
3. Select a contact.
4. Scroll to a number and press [↶] to dial, or press [Centre] to edit contact information.

**Create and send a name card**

1. In Idle mode, press <**Menu**> and select **Phonebook** → **My Name Card**.
2. Specify your contact information.
3. Press <**Options**> and select **Save** to save the name card.
4. To send the name card, access **My Name Card** again.
5. Press <**Options**> and select **Send Business Card via** → a sending method.

## Send messages

---

### Send a text message (SMS)

1. In Idle mode, press <Menu> and select **Messages** → **Create New Message** → **Text Message**.
2. Enter the message text and press [Centre].
3. Enter destination numbers.
4. Press [Centre] to send the message.

### Send a multimedia message (MMS)

1. In Idle mode, press <Menu> and select **Messages** → **Create New Message** → **Multimedia Message**.
2. Enter the message subject.
3. Select **Text**.

### Send an e-mail

4. Enter the message text and press [Centre].
  5. Select **Picture or Video** or **Audio**.
  6. Add an image, video clip, or sound clip.
  7. Press [Centre].
  8. Enter destination numbers or e-mail addresses.
  9. Press [Centre] to send the message.
- 
1. In Idle mode, press <Menu> and select **Messages** → **Create New Message** → **Email**.
  2. Enter the e-mail subject.
  3. Move to the **Message** field.

- 
4. Enter the e-mail text.
  5. Move to the **Attach Files** line.
  6. Press <**Options**> and select **Add Files, Add Name Card**, or **Add V-Calendar**.
  7. Select images, videos, sounds, name cards, or calendar data.
  8. Press <**Options**> and select **Attach**.
  9. Press [Centre].
  10. Enter e-mail addresses.
  11. Press [Centre] to send the e-mail.

## View messages

---

### View a text message

When a notification appears:

1. Press <**View**>.
2. Select the message from the Inbox.

From the Inbox:

1. In Idle mode, press <**Menu**> and select **Messages** → **Inbox**.
2. Select an SMS message (✉).

---

### View a multimedia message

When a notification appears:

1. Press <**View**>.
2. Select the message from the Inbox.



**View a multimedia message**  
(Continued)

From the Inbox:

1. In Idle mode, press <Menu> and select **Messages** → **Inbox**.
2. Select an MMS message (  ).

**View an e-mail**

1. In Idle mode, press <Menu> and select **Messages** → **Email Inbox**.
2. Press <Options> and select **Download** to download new e-mails or headers.
3. Select an e-mail or header.
4. If you selected a header, press <Options> and select **Retrieve** to view the body of the e-mail.

## Use Bluetooth

Your phone is equipped with Bluetooth technology, enabling you to connect the phone wirelessly to other Bluetooth devices and exchange data with them, talk hands-free, or control the phone remotely.

**Turn on Bluetooth**

1. In Idle mode, press <Menu> and select **Settings** → **Connectivity** → **Bluetooth** → **Activation** → **On**.
2. Select **My Phone's Visibility** → **On** to allow other devices to find your phone.

**Search for and pair with a Bluetooth device**

1. In Idle mode, press **<Menu>** and select **Settings** → **Connectivity** → **Bluetooth** → **My Devices** → **Search For New Device**.
2. Select a device.
3. Enter a Bluetooth PIN or the other device's Bluetooth PIN, if it has one, and press **<OK>**.  
When the owner of the other device enters the same code, pairing is complete.

**Send data**

1. Access an application, **Phonebook, My Files, Calendar, Schedule,** or **Task**.
2. Select the item you want to send.
3. Press **<Options>** and select **Send Business Card via/Send via/Send Schedule via/Send Task via** → **Bluetooth**.
4. Select a device.
5. If necessary, enter the Bluetooth PIN and press **<OK>**.

### Receive data

1. When a device attempts to access your phone, press **<Yes>** to permit the connection.
2. If necessary, press **<Yes>** to confirm that you are willing to receive.

## Switch applications

You can switch to other applications from a menu, without closing the menu screen you were using.

### Switch to an application

1. While using a menu, press [↵].
2. Select an application.

### Available applications

- **Call**: opens the dialling screen.
- **Messages**: accesses the **Messages** menu.
- **BigPond**: launches the web browser.

### Close all running applications

1. Press [⏏].
2. Scroll to **End All?**.
3. Press **<Yes>**.

## Use a memory card

You can use a memory card to increase your phone's memory capacity.

### Important memory card information

- Frequent erasing and writing will shorten a card's lifespan.
- Do not remove a card from the phone or turn off the phone while data is being accessed or transferred. This could result in loss of data and/or damage to the card or phone.
- Do not subject cards to strong shocks.

- Do not touch card terminals with your fingers or metal objects. If dirty, wipe the card with a soft cloth.
- Keep cards away from small children or pets.
- Do not expose cards in a place subject to electrostatic discharge and/or electrical noise.

**Insert a memory card**

1. Insert the card into the card slot, with the label side face down.

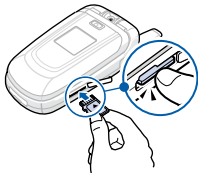

2. Press the card until it locks into place.

**Remove the memory card**

1. Press the card so that it is disengaged from the phone.
2. Remove the card from the slot.

**Use a card adapter**

Using a card adapter and a USB card reader/writer, you can read the card on a PC.

1. Insert a memory card into a card adapter, and then the adapter into a card reader/writer.
2. Plug the USB connector of the card reader/writer into the USB port on your PC.
3. Access the appropriate memory disk and copy to and from the card.

## Enter text

ABC, T9, Number, and Symbol modes

You can enter text for some features such as Messages, Phonebook, or Organizer, using ABC mode, T9 mode, Number mode, and Symbol mode.

### Changing the text input mode

- Press and hold [**\***] to switch between T9 (**T9**) and ABC (**ABC**) modes.
- Press [**\***] to change case or to switch to Number mode (**123**).
- Press and hold [**#**] to switch to Symbol mode (**SYM**).

### Using T9 mode

T9 is a predictive text input mode that allows you to enter any character using single keystrokes.

### Entering a word in T9 mode

1. Press [**2**] to [**9**] to start entering a word. Press each key once for each letter. For example, press [**4**], [**3**], [**5**], [**5**], and [**6**] to enter *Hello* in T9 mode. T9 predicts the word that you are typing, and it may change with each key that you press.
2. Enter the whole word before editing or deleting characters.
3. When the word displays correctly, go to step 4. Otherwise, press [**0**] to display alternative word choices for the keys that you have pressed. For example, *Of* and *Me* use [**6**] and [**3**].
4. Press [**#**] to insert a space and enter the next word.

### Other T9 mode operations

- Press [**1**] to enter periods or apostrophes automatically.
- Press [**#**] to insert a space.

- Press the Navigation keys to move the cursor.
- Press [C] to delete characters one by one. Press and hold [C] to clear the entire display.

### Adding a new word to the T9 dictionary

This feature may not be available for some languages.

1. Enter the word that you want to add.
2. Press [0] to display alternative words for your key presses. When there are no more alternative words, **Spell** displays on the bottom line.
3. Press <Spell>.
4. Enter the word you want using ABC mode and press <Add>.

### Using ABC mode

Press the appropriate key until the character you want appears on the screen.

Key	Characters in order displayed	
	Upper case	Lower case
1	. @ , - ? ! : / 1	
2	A B C Á Ä Æ Γ Ç 2	a b c á ä à æ Γ ç 2
3	D E F É Ê Æ 3	d e f é ê é 3
4	G H I Æ Ψ 4	g h i i Æ Ψ 4
5	J K L Λ 5	j k l Λ 5
6	M N O Ö Ñ Ø 6	m n o ö ñ ø ò 6
7	P Q R S Π Σ Ξ 7	p q r s β Σ Ξ 7
8	T U V Û 8	t u v ù Û 8
9	W X Y Z Ω 9	w x y z Ω 9
0	+ = < > € £ \$ % & ¥ ¢ 0	

(creating an SMS message with GSM Alphabet encoding)

### Other ABC mode operations

- To enter the same letter twice or to enter a different letter on the same key, wait for the cursor to move to the right automatically or press [Right]. Then, enter the next letter.
- Press [#] to insert a space.

- Press the Navigation keys to move the cursor.
- Press [**C**] to delete characters one by one. Press and hold [**C**] to clear the entire display.

## Using Number mode

Number mode enables you to enter numbers. Press the keys corresponding to the digits you want.

## Using Symbol mode

Symbol mode enables you to insert symbols.

To	Press
display more symbols	[Up] or [Down].
select a symbol	the corresponding number key.
clear the entered symbols	[ <b>C</b> ].
insert the symbols	< <b>OK</b> >.

## Call functions

### Advanced calling features

## Making a call

1. In Idle mode, enter the area code and phone number.



- Press [**C**] to clear the last digit or press and hold [**C**] to clear the whole display.
- Press and hold [**\***] to enter a pause between numbers.

2. Press [**↶**].
3. When you want to end the call, press [**ⓞ**].

## Making an international call

1. In Idle mode, press and hold [**0**]. The **+** character appears.
2. Enter the country code, area code, and phone number, then press [**↶**].

## Redialling recent numbers

1. In Idle mode, press [**↶**] to display the list of recent numbers.
2. Scroll to the number you want and press [**↶**].

## Making a call from Phonebook

Once you have stored a number in Phonebook, you can dial the number by selecting it from Phonebook. ▶ p. 36

You can also use the speed dial feature to assign your most frequently dialled numbers to specific number keys. ▶ p. 39

You can quickly dial a number from the USIM/SIM card using its location number assigned when stored.

1. In Idle mode, enter a location number and press [**#**].
2. Scroll through other numbers, if necessary.
3. Press <**Call**> or [**↶**] to make a voice call, or [**📞**] to make a video call.

## Answering a call

When you receive an incoming call, the phone rings and displays the incoming call image.

Press <**Accept**> or [**↶**] to answer the call.

## Tips for answering a call

- When **Anykey Answer** is active, you can press any key, except for <**Reject**> and [**📞**]. ▶ p. 85
- When **Open To Answer** is active, you can simply open the phone. ▶ p. 85
- Press <**Reject**> or [**📞**] to reject a call.
- Press [**▲/▼**] to mute the ringer, or press and hold [**▲/▼**] to reject a call.

## Viewing missed calls

If you have missed calls, the screen displays how many calls you have missed.

1. Press <**View**>.
2. If necessary, scroll through the missed calls.
3. Press [**↶**] to dial the number you want.



## Using the headset

Use the headset to make or answer calls without holding the phone.

Connect the headset to the jack on the left side of the phone. The button on the headset works as follows:

To	Press
redial the last call	the button twice.
answer a call	the button.
end a call	and hold the button.

## Options during a call

You can access a number of functions during a call.

### Adjusting the volume during a call

Use [▲/▼] to adjust the earpiece volume during a call.

Press [▲] to increase the volume level and press [▼] to decrease the volume level.

## Placing a call on hold/Retrieving

Press <Options> and select **Hold** to place a call on hold, or press <Resume> to retrieve the call.

## Making a second call

You can make another call if your network supports this function.

1. Press <Options> and select **Hold** to put the call on hold.
2. Make the second call in the normal way.
3. Press <Options> and select **Swap** to switch between the calls.
4. Press <Options> and select **Drop** → **Drop Held Call** to end the call on hold.
5. To end the current call, press [⏏].

## Answering a second call

You can answer an incoming call while already on the phone, if your network supports this function and you have activated the call waiting feature. ► p. 86

1. Press [↶] to answer the call. The first call is automatically put on hold.

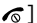
2. Press <**Options**> and select **Swap** to switch between the calls.
3. Press <**Options**> and select **Drop** → **Drop Active Call** to end the call on hold.
4. To end the current call, press [].

### Using the speakerphone feature

Use the phone as a speakerphone to talk and listen with the phone a short distance away.

Press [Centre] and then <**Yes**> to activate the speakerphone feature. Press [Centre] again to switch back to the earpiece.

### Switching off the microphone (Mute mode)

You can temporarily switch off your phone's microphone so that the person on the phone cannot hear you.

Press <**Mute**>. To turn the microphone back on, press <**Unmute**>.

### Using In-call options

During a call, press <**Options**> to access the following options:

- **Hold**: place the call on hold.
- **Swap**: place the current call on hold and reactivate the call on hold.
- **Join**: set up a multi-party call by adding a caller on hold to a currently active call. You can include up to 5 people on a multi-party call.
- **Split**: have a private conversation with one multi-party call participant. The other participants can converse with each other. After the private conversation, select **Join** to return both private participants to the multi-party call.
- **Drop**: disconnect the call currently on hold or active call.
- **Drop Call**: disconnect one multi-party call participant.
- **Video call**: switch to the video call.

- **Switch To Phone/Switch To Headset:** switch the call to a Bluetooth headset or hands-free car kit or back to the phone. To use this feature, you first need to connect your headset or car kit to the phone. ▶ p. 89

- **Mute Key Tone/Unmute Key Tone:** turn the key tones off or on.

To communicate with answering machines or computerised telephone systems, **Unmute Key Tone** must be selected.

- **New Call:** make a new voice call.
- **Send DTMF:** send DTMF (Dual tone multi-frequency) tones as a group. The DTMF tones are the tones used in phones for tone dialling, sounding when you press the number keys. This option is helpful for entering a password or an account number when you call an automated system, like a banking service.
- **Phonebook:** locate or store contacts in Phonebook.
- **Messages:** create and send a new SMS message.

- **Memo:** create a memo.

## Using the video call feature

In a 3G (UMTS) service area, your phone can make or receive a video call, allowing you to see another person on the screen during a conversation. The other person's phone must support the video call feature.

### Making a video call

1. In Idle mode, enter the area code and phone number.
2. Press [**Ⓜ**].

### Answering a video call

When you receive a video call, answer a video call as receiving a voice call. Press **<Show Me>** to allow the caller to see you.

### Using video call options

During a video call, press **<Options>** to access the following options:

- **Speaker Off/Speaker On:** switch back to Normal mode or turn on the speakerphone feature.

- **Show Call infobar/Hide Call infobar:** display or hide the information bar on the display.
- **Hide Information/Show Information:** hide or display information about the video call.
- **Mute/Unmute:** turn off or on the microphone.
- **Display options:** change the camera image settings:
  - Effects:** change the colour tone of the image.
  - Quality:** change the image quality of the camera.
  - Brightness:** adjust the image brightness.
- **Zoom:** display the zoom control bar and zoom in or out by pressing [Left] or [Right].
- **Settings:** change the settings for the video call.
- **Phonebook:** locate or store contacts in Phonebook.
- **Save Contact to:** save the contact to Phonebook.
- **Create SMS:** create and send a new SMS message.
- **Send DTMF:** send Dual tone multi-frequency (DTMF) tones as a group after entering the entire number you need to send or retrieving a number from Phonebook.
- **Memo:** create a memo.
- **Record video call/Stop video call:** record the video call or stop recording.
- **Switch to voice:** switch to the voice call.
- **End Call:** disconnect the video call.

## Menu functions

All menu options listed

### Call Log *(Menu 1)*

Use this menu to view the calls you have dialled, received, or missed, the length of the calls.

To access this menu, press <**Menu**> in Idle mode and select **Call Log**.

### Recent Contacts *(Menu 1.1)*

---

This menu displays all of the calls you have dialled, received, or missed.

#### Accessing a call log

1. Press [Left] or [Right] to move to another call type.
2. Press [Up] or [Down] to scroll through the call list.
3. Press [Centre] to view the details of a call, or [] to dial a number.

### Using call log options

While viewing call details, press <**Options**> to access the following options:

- **Voice Call:** make a voice call to the number.
- **Video Call:** make a video call to the number, if the 3G service is available.
- **Use Number:** paste the selected number to the normal dialling screen.
- **Save to Phonebook:** save the number to Phonebook.
- **Send Message:** send a message to the selected number via SMS or MMS.
- **Delete:** delete the selected call log or all logs.

### Missed Calls *(Menu 1.2)*

---

This menu displays the most recent calls you did not answer.

### Dialled Calls *(Menu 1.3)*

---

This menu displays the most recent calls you have dialled.

## Received Calls *(Menu 1.4)*

---

This menu displays the most recent calls you have received.

## Delete All *(Menu 1.5)*

---

Use this menu to delete all logs in each call type.

1. Press [Centre] to select the call types to be cleared.
2. Press <Delete>.
3. Press <Yes> to confirm the deletion.
4. Enter the phone password and press <Confirm>.

You can change this password. ▶ p. 94

## Call Time *(Menu 1.6)*

---

This menu displays the time log for voice and video calls made and received. The actual time invoiced by your service provider will vary.

- **Last Call Time:** check the last call time.
- **Total Dialed:** check the total length of calls dialed.

- **Total Received:** check the total length of calls received.
- **Total Time:** check the total length of calls made and received.
- **Reset Timers:** reset all counters. You need to enter the phone password.

You can change this password. ▶ p. 94

## Data Volume *(Menu 1.7)*

---

Use this menu to view the total amount of sent or received data.

- **Recent Volume:** check the last amount of data you have sent.
- **Total Volume:** check the total amount of data you have received.
- **Reset Volume:** reset all counters. You need to enter the phone password. s

You can change this password. ▶ p. 94

## **Data Call Time** *(Menu 1.8)*

---

This menu displays the time log for data calls made and received.

- **Recent Time:** check the last data call time.
- **Total Time:** check the total length of data calls sent and received.
- **Reset timers:** reset all counters. You need to enter the phone password.

You can change this password. ▶ p. 94

## **Phonebook** *(Menu 2)*

You can store phone numbers on your USIM/SIM card and in your phone's memory. The USIM/SIM card and phone's memory are physically separate, but they are used as a single entity called Phonebook.

To access this menu, press **<Menu>** in Idle mode and select **Phonebook**.

## **Contact List** *(Menu 2.1)*

---

Use this menu to search for contact information in Phonebook.

### **Finding a contact**

1. Enter the first few letters of the name that you want to find.
2. Select the name you want from the list.
3. Scroll to a number and press [**↵**] to dial, or press [**Centre**] to edit contact information.

### **Using contact options**

While viewing contact details, press **<Options>** to access the following options:

- **Edit:** edit contact information.

- **Send Message:** send a message to the selected number or e-mail address via SMS, MMS, or e-mail.
- **Special Options:** set the following options:
  - Picture:** assign a caller ID image to alert you to a call from the person.
  - Ring Tone:** assign a ringtone to alert you to a call from the person.
  - Msg. Alert Tone:** select a ringtone to alert you to an incoming message from the person.
- **Add to Speed Dial:** set the selected number as a speed dial entry.
- **Video Call:** make a video call to the number, if the 3G service is available.
- **Copy to SIM/Copy to phone:** copy the contact from the phone's memory to the USIM/SIM card, or vice versa.
- **Send Business Card via:** send the contact via SMS, e-mail, or Bluetooth.
- **Use Number:** paste the selected number to the normal dialling screen.
- **Delete:** delete the contact.

## Add New Contact *(Menu 2.2)*

---

Use this menu to add a new contact to Phonebook.

### Storing a contact to the phone's memory

1. Select **Phone**.
2. Change the settings or enter information about the contact:
  - **First Name/Last Name:** assign a name.
  - **Phone Number:** add a phone number.
  - **Email Work:** assign a business e-mail address.
  - **Email Home:** assign a personal e-mail address.
  - **Group:** assign a caller group.
  - **Homepage:** enter a homepage address.
  - **Birthday:** enter the person's birthday.
  - **More Information:** enter the job title, department, company, nickname, and additional note of the person.



3. Press <**Options**> and access the following options to add additional information:
  - **Special Options:** assign a caller ID image, call ringer, or message ringer for the contact.
  - **Add Item:** add a phone number in any type to the contact.
  - **Delete Item:** remove the selected number type from the contact.
  - **Change Type:** change the number type from the contact.
4. Press <**Options**> and select **Save** to save the contact.

### Storing a contact to the USIM/SIM card

1. Select **SIM**.
2. Enter information about the contact:
  - **Name:** assign a name.
  - **Phone Number:** add a phone number.
  - **Group:** (For USIM) assign a caller group.

- **Location Number:** enter a location number.
3. If you are using a USIM card, press <**Options**> to add additional information:
    - **Add Item:** add information type to the contact.
    - **Delete Item:** remove the selected type from the contact.
  4. Press [Centre] to save the contact.

### Groups *(Menu 2.3)*

---

Use this menu to organise your contacts in caller groups.

#### Creating a new caller group

1. Press <**Options**> and select **Add Group**.
2. Enter a group name and press <**Save**>.

#### Adding members to a caller group

1. Select a group.
2. Press [Centre] to select the contacts to be added.
3. Press <**Save**>.

## Managing caller groups

From the group list, press <**Options**> to access the following options:

- **View Members:** display the members of the selected group.
- **Add Member:** add contacts to the selected group, if the group does not have any.
- **Add Group:** add a new group.
- **Rename Group:** change the group name.
- **Delete:** delete the selected group or all groups. Group members, however, will not be deleted from Phonebook.

## Speed Dial *(Menu 2.4)*

---

Use this menu to assign speed dial numbers (2 to 9) to 8 of your most frequently dialled numbers.

### Assigning speed dial numbers

1. Select a key location from **2** to **9**. Key **1** is reserved for your voicemail server.
2. Select a contact from the contact list.

3. Select a number.

## Managing speed dial entries

From the Speed dial screen, press <**Options**> to access the following options:

- **Add:** assign a number to an unassigned key.
- **Details:** check the name and number assigned to a key.
- **Video Call:** make a video call to the number assigned to a key.
- **Change:** assign a different number to a key.
- **Remove:** clear the speed dial setting for a key.

## Dialling speed dial numbers

In Idle mode, press and hold the appropriate key.

## My Name Card *(Menu 2.5)*

---

Use this menu to create your name card and send it to other people.

### Saving your name card

The procedure for creating your name card is the same as the one for saving a phone number in the phone's memory. ► p. 37

### Using name card options

After saving your name card, press <**Options**> to access the following options:

- **Edit:** edit the name card.
- **Send Business Card via:** send the name card via SMS, e-mail, or Bluetooth.
- **Delete:** delete the name card.

### Copy All (Menu 2.6)

---

Use this menu to copy all of the contacts stored on the USIM/SIM card to the phone's memory, or vice versa.

### Own Number (Menu 2.7)

---

Use this feature to check your phone numbers, or to assign a name to each of the numbers. Changes made here do not affect the actual subscriber numbers on your USIM/SIM card.

### FDN List (Menu 2.8)

---

Use this menu to create a list of contacts to be used in FDN (Fixed Dialling Number) mode, in which the phone allows outgoing calls only to the specified phone numbers. This menu is available if your USIM/SIM card supports the FDN feature.

You can activate FDN mode in the **Fixed Dialling Mode** menu. ► p. 94

### Adding a contact

1. Press <**Options**> and select **New**.
2. Enter your PIN2 supplied with your USIM/SIM card and press <**Confirm**>.
3. Enter information about the contact:
  - **Name:** assign a name.
  - **Phone Number:** add a phone number.
  - **Location:** assign a location number.
4. Press [Centre].

### Using contact options

From the FDN list, you can access the same contact options as in Phonebook by pressing <**Options**>. ► p. 36

## Service Number *(Menu 2.9)*

---

Use this menu to view the list of Service Dialling Numbers (SDN) assigned by your service provider, including emergency numbers and numbers for directory enquiries. This menu is available if your USIM/SIM card supports SDN.

Scroll to the number you want and press [↶].

## Settings *(Menu 2.10)*

---

Use this menu to change the default settings for Phonebook entries.

- **Viewing Settings:** change the sort order of the contact list.
- **Default Storage Settings:** select a default memory location for saving contacts. If you select **Optionally**, the phone will ask you to select a memory location each time you save a number.

## Memory Status *(Menu 2.11)*

---

Use this menu to check the number of contacts you have stored in the phone's memory and on the USIM/SIM card.

## Applications *(Menu 3)*

Use this menu to play music and video files stored in your phone's memory or a memory card. You can also keep track of your schedule, set alarms, and use convenient features, such as a world clock, a voice recorder, calculator, and converter.

To access this menu, press <Menu> in Idle mode and select **Applications**.

## Media Player

---

You can play music and video files.

### Downloading or receiving music or video files

You can play the following types of files on your phone:

- Music: MP3, AAC
- Video: MP4, 3GP, RM

Use the following methods to save music or video files to your phone's memory:

- Download from the wireless web ▶ p. 51
- Download from a computer using Samsung PC Studio ▶ Samsung PC Studio User's Guide

- Receive via an active Bluetooth connection ► p. 90
- Copy to a memory card and insert the card into the phone ► p. 25

Downloaded or received files are stored in the **Downloads** folder in **Music** or **Videos**.

### Creating a play list

Add the media files to the play list so you can play them.

1. From the media player screen, press [Centre].
2. Press <**Options**> and select **Add**.
3. Select **Folder** or **Files**.
4. Scroll to the folder you want or press [Centre] to select the files you want.
5. Press <**Select**> or <**Add**>.
6. Press <**Back**> to return to the media player screen.

### Playing media files

1. From the media player screen, press [Centre].
2. Select a file. The file plays.

During playback, use the following keys:

Key	Function
Centre	Pauses or resumes playback.
Left	Returns to the previous file. Moves backward in a file when held down.
Right	Skips to the next file. Moves forward in a file when held down.
Up	Opens the play list.
▲/▼	Adjusts the volume.
Down	Stops playback.

### Using media player options

From the media player screen, press <**Options**> to access the following options:

- **Play:** play the selected file.
- **Resume:** resume playback.
- **Send via:** send the file via MMS, e-mail or Bluetooth.
- **Add to Play List:** add files to the play list.

- **Open Play List:** access the play list.
- **Go to My files:** access all music and video files.
- **Details:** access the file properties.
- **Player Settings:** change the default settings for playing media files:  
**Play Options:** select a repeat mode.  
**Volume:** select a volume level.  
**Audio Player Skin:** select a skin image.
- **VOD Settings:** select a connection profile to be used for accessing a video streaming server. You can also create or edit a profile. ► p. 91
- **Set as Ringtone:** set the file as your ringtone for voice calls or video calls.

### Using play list options

From the media player screen, press [Up]. Press <Options> to access the following options:

- **Play:** play the selected file.
  - **Add:** add files to the play list.
  - **Remove:** remove the selected file or all files from the current play list.
- **Move:** move the selected file to the position you want within the current play list or another play list.
  - **Copy:** make a copy of the selected file in the current play list or another play list.
  - **New List:** add a new play list.

### Alarm

Use this menu to set alarms to sound at specific times. The alert type for a normal alarm corresponds to the call alert type settings in the currently selected profile. A wake-up alarm is not be affected by your profile setting.

### Setting an alarm

1. Select the type of alarm.
2. Set each alarm option:
  - **Alarm:** activate the alarm.
  - **Time:** enter the time for the alarm to sound.
  - **Repeat:** select a repeat option.
  - **Alert Tone:** select an alarm tone.
3. Press <Options> and select **Save**.

### Stopping an alarm

When the time for an alarm comes and the alarm sounds:

- For a non-wake-up alarm, press any key.
- For a wake-up alarm, press <OK> or [Centre]. Press any key, except for <OK> and [Centre], to cause it to sound again after 5 minutes.

### Deactivating an alarm

1. Select the alarm you want to deactivate.
2. Select **Off** on the **Alarm** line.
3. Press [Centre].

### Voice Recorder

Use this menu to record voice memos. A voice memo can be up to one hour long.

#### Recording a voice memo

1. Press [Centre] to start recording.
2. Speak into the microphone.  
Press [Centre] to pause or resume the recording.
3. Press <Stop> or [Down]. The voice memo is saved automatically.

4. Press [Centre] to review the memo, or press [Up] to record additional memos.

#### Playing a voice memo

1. From the voice recorder screen, press <Options> and select **Go to Sounds**.
2. Select a voice memo from the **Voice Memos** folder. The memo plays.

During playback, use the following keys:

Key	Function
Centre	Pauses or resumes playback.
Left	Returns to the previous file. Moves backward in a file when held down.
Right	Skips to the next file. Moves forward in a file when held down.
▲/▼	Adjusts the volume.
Down	Stops playback.

#### Using voice recorder options

After playback, press <Options> to access the following options:

- **Play:** play the selected voice memo in Review mode.

- **Record:** record a new voice memo.
- **Send via:** send the file via MMS, e-mail, or Bluetooth.
- **Set as Ringtone:** set the file as your ringtone for voice calls or video calls.
- **Go to Sounds:** access the voice memo list.
- **Rename:** change the file name.
- **Delete:** delete the file.
- **Details:** access the file properties.
- **Record Settings:** customise the default settings for the voice recorder:
  - Default Name:** change the default prefix of file names.
  - Recording Time:** select a maximum recording time.

## Organizer

---

The Organizer feature enables you to keep track of your schedule.

## Calendar

Use this menu to keep track of your schedule.

## Selecting a day on the calendar

When you enter the **Calendar** menu, the calendar appears with today's date indicated by a colored box.

- Press [Left] or [Right] to move by day.
- Press [Up] or [Down] to move by week.
- Press [▲/▼] to move by month.

## Creating an item

You can store scheduled items, anniversaries, tasks, and memos on the calendar. More than one item per day can be stored.

To enter a scheduled item:

1. Select a date on the calendar.
2. Press <**Options**> and select **New** → **Schedule**.
3. Enter information or change the settings:
  - **Title:** enter the title for the scheduled item.
  - **Details:** enter the details of the scheduled item.



- **Start** and **End**: enter the starting and ending times for the scheduled item.
  - **Start Date** and **End Date**: enter the starting and ending dates for the scheduled item.
  - **Location**: enter information about the scheduled item.
  - **Alarm**: set an alarm for the scheduled item.
  - **Before**: set how long before the scheduled item the alarm is to alert you.
  - **Repeat**: set the scheduled item to recur. You can select a repeat unit.
  - **Until**: set the ending date, if the scheduled item will recur.
  - **Expiry**: change the expiry setting.
4. Press <**Options**> and select **Save** to save the scheduled item.

To enter an anniversary:

1. Select a date on the calendar.
2. Press <**Options**> and select **New** → **Anniversary**.

3. Enter information or change the settings:
  - **Occasion**: enter information about the anniversary.
  - **Date**: enter the date.
  - **Alarm**: set an alarm for the anniversary.
  - **Before**: set how long before the anniversary the alarm is to alert you.
  - **Alarm Time**: enter the time for the alarm to sound.
  - **Repeat Every Year**: set the phone to remind you of the anniversary every year.
4. Press <**Options**> and select **Save** to save the anniversary.

To enter a task:

1. Select a date on the calendar.
2. Press <**Options**> and select **New** → **Task**.
3. Enter information or change the settings:
  - **Title**: enter the title for the task.
  - **Task**: enter the task content.
  - **Start Date**: enter the starting date.
  - **Due Date**: enter the ending date.

- **Priority:** select a priority level.
4. Press <**Options**> and select **Save** to save the task.





To enter a memo:

1. Select a date on the calendar.
2. Press <**Options**> and select **New** → **Memo**.
3. Enter the memo text and press [Down].
4. Enter the date.
5. Press <**Options**> and select **Save** to save the memo.

### Consulting the calendar

Once you have scheduled items, the square brackets appear on the corner of the date cell.

### Viewing an item

1. Select a date on the calendar to display the items for the day. The following icons indicate the type of item:
  -  Scheduled items
  -  Anniversaries
  -  Tasks
  -  Memos

2. Select an item to view its details.

From the item list, press <**Options**> to access the following options:

- **View:** access the item.
- **New:** add a new item.
- **Completed/To Do:** change the status of the selected task.
- **Month View:** switch to the monthly view screen.
- **Week View:** switch to the weekly view screen.
- **Change Date/Change Due Date/Reschedule:** change the date of the item.
- **Delete:** delete the selected item or all of the items for the selected day.
- **Send Schedule via/Send Task via:** send the item via SMS, e-mail, or Bluetooth.
- **Send Memo:** send the memo via SMS.

### Using calendar options

On the calendar, press <**Options**> to access the following options:

- **View:** display the items stored for the selected date.
- **New:** add a new item.
- **Week View:** display the weekly view screen.
- **Go to Today:** go to today's date.
- **Go to Date:** enter a specific date.
- **Starting Day:** set whether the calendar starts with Sunday or Monday.
- **Delete:** delete the items for the specific period or all of the items in the calendar.

### Week View



You can view items for the selected week. A coloured box on the timetable indicates the presence of a scheduled item. Select a box for the date you want.

### Today's Event

You can view items for the selected date.



Select an item to view its details. The item opens in Edit mode.

### Schedule

This menu displays the scheduled items. If you have set the Repeat and Alarm options, the  and  icons display.

Select a scheduled item to view its details.

### Anniversary

This menu displays anniversaries you have created. If you have set the Repeat and Alarm options, the  and  icons display.

Select an anniversary to view its details.

### Task

Use this menu to display tasks you have created. The icons on the right indicate the importance; the lower the number on the icon, the higher the priority. A check mark appears in the status check box if the task has been completed.

Select a task to view its details.

### Memo

This menu displays the memos you have created.

Select a memo to view its details.

## Missed Event Alarm

When you are unable to acknowledge an alarm for an item, the phone stores the missed alarm until you confirm it.

1. Select an item.
2. Press <**Confirm**> to confirm and delete the item.

## Memory Status

This menu displays the number of items of each type you have created, and the total number of items you can store.

## Calculator

---

Use this menu to perform basic arithmetic functions such as addition, subtraction, multiplication, and division.

### Performing a calculation

1. Enter the first number.  
Press [#] to include a decimal point.
2. Press one of the Navigation keys to access the math function you want.
3. Enter the second number.

4. Press [Centre] to view the result.
5. If necessary, repeat from step 2 to continue the calculation.

### Using calculator options

Press <**Options**> to access the following options:

- **Equal**: view the result.
- **Recent Calculation**: display the last result you calculated.
- **Save to Memory**: save a value into the calculator memory.
- **Recall Memory**: retrieve the saved value.
- **Clear Memory**: clear the saved value.

## Converter

---

Use this menu for common conversions, such as currency and temperature.

### Performing a conversion

1. Select a converter.
2. Press [Left] or [Right] to select the original unit and press [Down].

3. Enter the value to be converted and press [Down].
  - Press [#] to insert a decimal point.
  - Press [\*] to change the temperature to above zero (+) or below zero (-).
4. Press [Left] or [Right] to select the unit to which you want to convert.  
The equivalent value for the amount you entered displays.

### Using converter options

Press <Options> to access the following options:

- **Clear:** clear the current values.
- **Reverse:** reverse the conversion.
- **Currency Rates:** display the currency rate list.

### World Time

---

Use this menu to set your local time zone and find out the current time in another part of the world.

### Setting the local time zone

1. From the world map, press [Left] or [Right] to scroll to the city you want on the upper line (🏠). As the time line moves, the time and date of the given zone display.
2. Press [Centre] to save the city as your local time zone.

### Viewing world time

1. From the world map, move to the lower line (📍).
2. Press [Left] or [Right] to scroll to the city you want.
3. Press [Centre] to save the time zone.

### Applying daylight saving time

1. From the world map, press <Options> and select **Summer Time**.
2. Press [Centre] to select the time zones you want.
3. Press <Select>.
4. Press [Centre] to save the time zone.

## PocketNews

---

This menu is available if you use a USIM/SIM card that supports SIM Application Toolkit menus and provides additional services, such as news, weather, sports, entertainment, and location services.

Available services may vary, depending on your service provider's plans.

For details, see your USIM/SIM card instructions or contact your service provider.

## Browser *(Menu 4)*

The web browser on your phone allows you to access the wireless web. Using the web browser, you can access up-to-date information and a wide variety of media contents, such as wallpapers, ringtones, and music files.

To access this menu, press **<Menu>** in Idle mode and select **Browser**.

## BigPond Home *(Menu 4.1)*

---

Use this menu to connect your phone to the network and load the homepage of the wireless web service provider.

### Navigating the web browser

To	Press
scroll through browser items	[Up] or [Down].
select a browser item	<b>&lt;Select&gt;</b> or [Centre].
return to the previous page	<b>&lt;Back&gt;</b> or [C].

### Using browser options

From any web page, press **<Options>** to access the following browser options:

- **Home:** return to the homepage.
- **Go To:** go to the currently linked web page.
- **Go:** move backward or forward through pages in history.
- **Reload:** reload the current page with updated information.

- **To Desktop View/To SmartFit View:** change the display mode of the browser.
- **Bookmarks:** bookmark the current page or access the bookmark list.
- **Enter URL:** enter a URL address manually.
- **Send URL via:** send the URL of the current page via SMS or e-mail.
- **Save:** save the image of the current web page or the current page.
- **Saved Pages:** access the list of web pages you have saved.
- **History:** access the list of web pages you have accessed.
- **Advanced:** change the various settings for the browser.

**Empty Cache:** clear the cache. The cache is a temporary memory site that stores recently accessed web pages.

**Empty Cookies:** delete cookies. Cookies are pieces of personal information sent to a web server while navigating the web.

**Cookie Options:** set whether or not cookies are stored. If you select

**Prompt**, the phone will ask you to save the cookies of the current page.

**Preferences:** change the settings for the web browser to suit your preference.

**Certificates:** access certificate information.

**Page Properties:** access the page properties.

**About Browser:** access version and copyright information about the browser.

### Exiting the web browser

Press [] to end the network connection and exit the browser.

### Bookmarks (Menu 4.2)

---

Use this menu to save URL addresses in order to quickly access web pages, or access the preset bookmarks.

### Adding a new bookmark

1. Press <**Options**> and select **Add Bookmark**.
2. Enter a title and press [Down].
3. Enter a URL address and press <**Save**>.

## Using bookmark options

From the bookmark list, press <**Options**> to access the following options:

- **Go To:** access the bookmarked web page.
- **Enter URL:** enter a URL address manually.
- **Edit:** edit the URL address and title of the bookmark, if you selected an added one.
- **Add Bookmark:** add a new bookmark.
- **Send URL via:** send the URL address of the bookmark via SMS or e-mail.
- **Delete:** delete the selected bookmark or all bookmarks.
- **Delete All:** delete all bookmarks.

## Enter URL (Menu 4.3)

---

Use this menu to manually enter a URL address and access the associated web page.

You can add the entered URL to the Bookmark list by selecting **Add Bookmark**.

## Browser Profiles (Menu 4.4)

---

Use this menu to select a connection profile to be used for connecting to the Internet. You can also create or edit a profile. ▶ p. 91

## Clear Cache (Menu 4.5)

---

Use this menu to clear the cache. The cache is a temporary memory site that stores recently accessed web pages.

## My Place (Menu 5)

The **My Place** menu enables you to use various Internet services supported by your service provider.

To access this menu, press <**Menu**> in Idle mode and select **My Place**.

## BigPond (Menu 5.1)

---

Use this menu to access a range of mobile entertainment from the BigPond homepage, only available on Telstra's Next G network. For further details, please refer to your Next G User Guide.



### **FOXTEL** *(Menu 5.2)*

---

Use this menu to access the online TV service supported by your service provider. You can watch TV and use various Mobile TV services. Using this link, you can access to watch 12 exclusive FOXTEL channels on your phone wherever you are. For further details, please refer to your Next G User Guide.

### **Search** *(Menu 5.3)*

---

Use this menu to access the Internet on your phone and launch the Telstra search engine. For further details, please refer to your Next G User Guide.

### **Email** *(Menu 5.4)*

---

Use this menu to access the E-mail service supported by your service provider. With your Telstra's Next G mobile, you can check your BigPond, Hotmail, Yahoo! Mail and other Internet provider e-mail accounts, wherever you are, whenever it suits you. For further details, please refer to your Next G User Guide.

### **Music** *(Menu 5.5)*

---

Use this menu to access the BigPond Music Player and download music files. For further details, please refer to your Next G User Guide.

### **Downloads** *(Menu 5.6)*

---

Use this menu to access the website preset by your service provider and have entertainment at your fingertips to download. Download and watch music videos, movie trailers, ringtones and much more with Download Manager. For further details, please refer to your Next G User Guide.

### **Photos** *(Menu 5.7)*

---

Use this menu to access the website preset by your service provider and download pictures. You can shoot, store, view, and share photos with your family and friends, wherever you are, from your mobile or PC. For further details, please refer to your Next G User Guide.

## **Maps** (Menu 5.8)

---

Use this menu to access a location service based on GPS positioning technology. With access to Whereis Mobile on your phone, you can quickly find your way to any location around Australia. For further details, please refer to your Next G User Guide.

## **My Account** (Menu 5.9)

---

Use this menu to manage your Telstra Accounts. View and pay your Telstra bills, manage your content subscriptions and more. For further details, please refer to your Next G User Guide.

## **My Files** (Menu 6)

The **My Files** menu allows you to access images, videos, music files, and sounds stored in the phone's memory or on a memory card.

To access this menu, press **<Menu>** in Idle mode and select **My Files**.

- As a result of the Digital Rights Management (DRM) system, some of the media items you download from the Internet or receive by MMS may require a licence key to access them.

## **Images**

---

Use this menu to access photos you have taken and images you have downloaded, received in messages, or imported from your computer.

### **Viewing an image**

1. Scroll to an image folder.
2. Select an image.

### Viewing a slide show

You can view your images as a slide show, a sequential presentation of each image in the current folder.

1. While viewing an image, press **<Options>** and select **Slide Show**. The slide show begins.
2. Press **<Back>** to stop the slide show.

### Editing an image

1. While viewing an image, press **<Options>** and select **Edit**.
2. Press **<Options>** and edit the photo using the following options:
  - **Save as:** save the file as a different name.
  - **Resize:** change the image size.
  - **Effects:** change the colour tone or apply a special effect to the photo.
  - **Adjust:** adjust the brightness, contrast, or colour balance.
  - **Frames:** apply a decorative frame.
  - **Cliparts:** add an image clip to the photo.
  - **Insert Text:** add text to the photo.

- **Rotate:** rotate the photo clockwise or counterclockwise.
  - **Flip:** flip the photo vertically or horizontally.
  - **Crop:** select a variously sized and shaped section of the photo.
3. When you have finished, press **<Done>** or press **<Options>** and select **Done**.
  4. Press [Centre].
  5. Enter a photo name and press **<Save>**.

### Using image options

While viewing a file, press **<Options>** to access the following options:

- **Send via:** send the file via MMS, e-mail, or Bluetooth.
- **Set as:** set the image as your wallpaper for the main display or a caller ID image for a Phonebook entry.
- **Move:** move the file to another folder.
- **Copy:** copy the file to another folder.
- **Real Size:** view the image in its actual size. Press **<Phone Size>** to fit the image to the display.

- **Slide Show:** view all images as a slide show.
- **Edit:** edit the image and save it as a different file.
- **Delete:** delete the file.
- **Rename:** change the file name.
- **Details:** access the file properties.

### Downloading images

1. Scroll to the **Downloads** folder.
2. Select **Get Graphics**. You are connected to the website preset by your service provider.
3. Search for the file you want and follow the onscreen instructions to download it.

### Videos

Use this menu to access video clips you have recorded, downloaded, received in messages, or imported from your computer.

- Video clips recorded on other devices, such as camcorders, may not play correctly.

### Playing a video clip

1. Scroll to a video folder.
2. Select a video clip. The media player opens. ▶ p. 42

### Using video options

From the video list, press <**Options**> to access the following options:

- **Play:** play the video clip.
- **Add to Play List:** add the file to the play list.
- **Send via:** send the file via MMS, e-mail, or Bluetooth.
- **Move:** move the file to another folder.
- **Copy:** copy the file to another folder.
- **Delete:** delete the selected file or all files.
- **Rename:** change the file name.
- **Lock/Unlock:** lock the file to prevent it from being deleted, or unlock the file.
- **Details:** access the file properties.
- **New Folder:** add a new folder.
- **Memory Status:** access the memory information for each folder in **My Files**.

### Downloading video clips

1. Scroll to the **Downloads** folder.
2. Select **Get Video**. You are connected to the website preset by your service provider.
3. Search for the file you want and follow the onscreen instructions to download it.

### Sounds

Use this menu to access voice memos you have recorded, and sound clips you have downloaded, received in messages, or imported from your computer.

#### Playing a sound clip

1. Scroll to a sound folder.
2. Select a sound clip. The selected sound plays.

For a voice memo, see **Voice Recorder**.

▶ p. 44

During playback, use the following keys:

Key	Function
Left	Returns to the previous file.
Right	Skips to the next file.
Up/Down/ ▲/▼	Adjusts the volume.
Centre	Allows you to send the selected file to other people.

#### Using sound options

From the sound list, press <**Options**> to access the following options:

- **Play**: play the selected file.
- **Send via**: send the file via MMS, e-mail, or Bluetooth.
- **Set as Ringtone**: set the file as your ringtone for voice calls or video calls.
- **Set as Caller ID**: set the sound clip as a ringtone for a Phonebook entry.
- **Move**: move the file to another folder.
- **Copy**: copy the file to another folder.

- **Delete:** delete the selected file or all files.
- **Rename:** change the file name.
- **Lock/Unlock:** lock the file to prevent it from being deleted, or unlock the file.
- **New Folder:** add a new folder.
- **Details:** access the file properties.
- **Memory Status:** access memory information for each folder in **My Files**.

### Downloading sound clips

1. Scroll to the **Downloads** folder.
2. Select **Get Ringtones**. You are connected to the preset website by your service provider.
3. Search for the file you want and follow the onscreen instructions to download it.

### Music

---

This menu displays music files you have downloaded or received in messages.

#### Playing a music file

1. Select a music folder.
2. Select a music file. The media player opens. ▶ p. 42

### Using music options

From the music list, press <**Options**> to access the following options:

- **Play:** play the music file.
- **Add to Play List:** add the file to the play list.
- **Send via:** send the file via MMS, e-mail, or Bluetooth.
- **Set as Ringtone:** set the file as your ringtone for voice calls or video calls.
- **Set as Caller ID:** set the music file as a ringtone for a Phonebook entry.
- **Move:** move the file to another folder.
- **Copy:** copy the file to another folder.
- **Delete:** delete the selected file or all files.
- **Rename:** change the file name.
- **Lock/Unlock:** lock the file to prevent it from being deleted, or unlock the file.
- **New Folder:** add a new folder.
- **Details:** access the file properties.
- **Memory Status:** access the memory information for each folder in **My Files**.

### Downloading music files

1. Scroll to the **Downloads** folder.
2. Select **Get Music**. You are connected to the website preset by your service provider.
3. Search for the file you want and follow the onscreen instructions to download it.

### Games

---

Use this menu to access the embedded Java games and download Java applications.

#### Accessing an applications

Select an application from the application list and follow the onscreen instructions. The procedure may differ from application to application.

#### Using Java application options

From the application list, press **<Options>** to access the following options:

- **Launch**: launch the selected application.
- **Network Settings**: select a connection profile to be used for applications requiring network access. You can also create or edit a profile. ▶ p. 91

- **Details**: access the application properties.
- **Move Up/Move Down**: move the selected application within the application list.
- **New Folder**: add a new folder.
- **Delete**: delete the selected application or application folder, except for embedded applications and default application folders.
- **Rename**: change the name of the application or application folder.
- **Lock/Unlock**: lock the application to prevent it from being deleted, moved, and renamed, or unlock the application.
- **Memory Status**: access memory information for each folder in **My Files**.

#### Downloading new applications

1. Select **Get Games**. You are connected to the website preset by your service provider.
2. Search for the application you want and follow the onscreen instructions to download it.

## Other Files

---

Files that you have received but which are not supported by your phone are stored in this folder. You cannot open these files on the phone.

From the file list, press <**Options**> to access the following options:

- **Send via:** send the file via e-mail or Bluetooth.
- **Delete:** delete the selected file or all files.
- **Rename:** change the file name.
- **Lock/Unlock:** lock the file to prevent it from being deleted, or unlock the file.
- **Details:** access the file properties.
- **New Folder:** add a new folder.

## Memory Card

---

Use this menu to access the files stored on the memory card. This option is only available when you insert a memory card into the phone.

For details about using files, see the corresponding menu.

## Memory Status

---

Use this menu to check memory information for each folder in **My Files**.

## Camera (Menu 7)

You can use the camera module embedded in your phone to take photos and record videos.

To access this menu, press <**Menu**> in Idle mode and select **Camera** or press [Ⓜ].

- Do not take photos of people without their permission.
- Do not take photos in a place where cameras are not allowed.
- Do not take photos in a place where you may interfere with another person's privacy.

## Taking a photo

---

You can take photos in various modes. The camera produces jpeg photos.

- When you take a photo in direct sunlight or in bright conditions, shadows may appear on the photo.



## Taking a photo

1. Access the **Camera** menu to turn on the camera. You can also press [] in Idle mode.
2. Aim the lens at the subject by rotating the camera lens and make any desired adjustments.
  - Press <**Options**> or < > to use camera options. ▶ next section
  - Use the keypad to change the camera settings or switch to other modes. ▶ p. 63
3. Press [Centre] or [] to take a photo. The photo is saved in the **Photos** folder.

To	Press
use photo options	< <b>Options</b> > or < >. ▶ p. 64
delete the photo	< <b>Delete</b> > and then < <b>Yes</b> >.
send the photo via MMS	[Centre]. ▶ p. 67
return to Capture mode	[ <b>C</b> ].

## Using camera options in Capture mode

In Capture mode, press <**Options**> or < > to access the following options:

- **Record Video:** switch to Record mode.
- **Shooting Mode:** take a photo in the following modes:
  - Single Shot:** take a photo in Normal mode. You can select whether or not the camera automatically saves a photo.
  - Multi Shot:** take a series of action stills. You can select the number of photos the camera will take.
  - Mosaic Shot:** take several stills and save them in one frame. You can select the layout. Press [Centre] to take each photo.
- **Effects:** change the colour tone of the image.
- **Frames:** apply a decorative frame.
- **Flash:** determines the use of the flash.
- **Timer:** set a time delay before the camera takes a photo.
- **Go to Photos:** access the **Photos** folder.

- **Camera Settings:** change the default settings for taking a photo:  
**Size:** select an image size.  
**Photo Quality:** select an image quality.  
**Viewfinder:** select a preview screen.  
**Spot Focus:** adjust the exposure based on a specific area of the image. Select **On** to display the spot focus frame in the middle of the image, and change the exposure according to the brightness of the image fragment in the frame.  
**White Balance:** adjust the colour temperature of the camera, depending on the current lighting conditions. You can make the photo look warmer or cooler.  
**ISO:** change the ISO setting, which controls the sensitivity of your camera. For low light situations, select a higher ISO number. The higher the ISO number, the faster the camera shutter functions and the more sensitive the camera is to light. Higher ISO settings may bring some distortion to an image.

**Zoom Sound:** turn the sound effect for zooming on or off.

**Brightness Sound:** turn the sound effect for brightness adjustment on or off.

**Save:** select the memory location to store photos, if a memory card is inserted.

**Multi Shot Speed:** select the shooting speed in Multi Shot mode.

**Default Name:** change the default prefix of file names.

- **Camera Shortcuts:** view the functions of the keys you can use in Capture mode.

### Using the keypad in Capture mode

You can use the keypad to customise your camera settings in Capture mode.

Key	Function
Left/Right	Zooms in or out. (Not available for the maximum size)
Up/Down	Adjusts the brightness.

Key	Function
▲	Flips the image vertically.
▼	Shows the mirror image.
1	Switches to Record mode. ▶ p. 64
2	Changes the image size.
3	Changes the image quality.
4	Changes the shooting mode.
5	Changes the colour tone or applies a special effect.
6	Changes the ISO setting.
7	Adds a decorative frame.
8	Sets the timer.
9	Goes to the <b>Photos</b> folder.
*	Changes the white balance setting.
0	Determines the use of the flash.
#	Changes the preview screen.

## Using photo options



After saving a photo, press <**Options**> to access the following options:

- **Take Another:** return to Capture mode.
- **View:** access one of the multi-shot photos.
- **Send via:** send the file via MMS, e-mail or Bluetooth.
- **Delete:** delete the file, or all of the multi-shot photos.
- **Set as:** set the photo as wallpaper for the main display, or as a caller ID image for a Phonebook entry.
- **Rename:** change the file name.
- **Go to Photos:** access the **Photos** folder.  
▶ p. 55
- **Lock/Unlock:** lock the file to prevent it from being deleted, or unlock the file.
- **Properties:** access the file properties.

## Recording a video

You can record a video of what is displayed on the camera screen and save it.

## Recording a video

1. Access the **Camera** menu to turn on the camera. You can also press [  ] in Idle mode.
2. Press [ **1** ] to switch to Record mode.
3. Make any desired adjustments.
  - Press <**Options**> to use camera options. ▶ next section
  - Use the keypad to change the camera settings or switch to other modes. ▶ p. 66
4. Press [Centre] or [  ] to start recording.
5. Press [Centre] or [  ] to stop recording. The video is saved in the **Videos** folder.

6. To	Press
use video options	< <b>Options</b> >. ▶ p. 66
delete the video clip	< <b>Delete</b> > and then < <b>Yes</b> >.
return to Record mode	[Centre] or [ <b>C</b> ].

## Using camera options in Record mode

In Record mode, press <**Options**> to access the following options:

- **Take Photo**: switch to Capture mode.
  - **Effects**: change the colour tone of the image.
  - **Flash**: determine the use of the flash.
  - **Go to Videos**: access the **Videos** folder. ▶ p. 57
  - **Video Settings**: change the following settings for recording a video:
    - Default Name**: change the default prefix of file names.
    - Save**: select the memory location to store video clips, if a memory card is inserted.
    - Quality**: select an image quality.
    - Recording Time**: select a video recording mode.
- Select **Limit for MMS** to record a video suitable for an MMS message.

Select **Normal** to record a video within the limit of the currently available memory. The length of your video is determined by how much memory has been used.

**Size:** select a frame size.

**Audio Record:** turn the audio on or off.

- **Video Shortcuts:** view the functions of the keys you can use in Record mode.

### Using the keypad in Record mode

You can use the keypad to customise your camera settings in Record mode.

Key	Function
Left/Right	Zooms in or out.
Up/Down	Adjusts the brightness.
▲	Flips the image vertically.
▼	Shows the mirror image.
1	Switches to Capture mode. ▶ p. 61
2	Changes the frame size.
3	Changes the image quality.

Key	Function
4	Changes the video recording mode.
5	Changes the colour tone or applies a special effect.
7	Mutes or unmutes audio.
9	Goes to the <b>Videos</b> folder.
0	Determines the use of the flash.

### Using video options

After saving a video clip, press <**Options**> to access the following options:

- **Play:** play back the file.
- **Viewfinder:** return to Record mode.
- **Send via:** send the file via MMS, e-mail or Bluetooth.
- **Delete:** delete the file.
- **Rename:** change the file name.
- **Go to Videos:** access the **Videos** folder.  
▶ p. 57

## Messages (Menu 8)

Use the **Messages** menu to send and receive text messages, multimedia messages, and e-mails. You can also access push messages, voicemails, broadcast messages, and configuration messages.

To access this menu, press <**Menu**> in Idle mode and select **Messages**.

### Create New Message (Menu 8.1)

Use this menu to create and send text messages, multimedia messages, or e-mails.

#### Text Message (Menu 8.1.1)

Short Message Service (SMS) allows you to send or receive text messages.

#### Creating and sending an SMS message

1. Enter your message and press [Centre].



- The maximum number of characters allowed in a message varies by service provider. If your message exceeds the maximum number of characters, the phone will split the message.
- You can use various options by pressing <**Options**>. ▶ next section

2. Enter a destination number.

To send the message to more than one recipient, fill in additional destination fields.

3. Press [Centre] to send the message.

#### Using options while composing an SMS message

While composing a message, press <**Options**> to access the following options:

- **Send**: send the message.
- **Input Method**: change the text input mode.
- **Insert**: insert a text template, Phonebook entry, or bookmarked URL address.
- **Save to Drafts**: save the message in the **Drafts** folder.

#### Multimedia Message (Menu 8.1.2)

Multimedia Message Service (MMS) delivers messages containing a combination of text, image, video, and audio, from phone to phone or from phone to e-mail.

## Creating and sending an MMS message

1. Enter the message subject.

You can use various options by pressing **<Options>** in each field. ▶ next section

2. Select the **Text** line.
3. Enter the message text and press [Centre].
4. Select the **Picture or Video** or **Audio** line and add an image, video, or sound clip.

- The maximum size allowed for a message can differ, depending on your service provider.
- Depending on the file type or DRM (Digital Rights Management) system, some files may not be able to be forwarded.

5. When you have finished, press [Centre].
6. Enter a phone number or e-mail address. To send the message to more than one recipient, fill in additional destination fields.
7. Press [Centre] to send the message.

## Using options while composing an MMS message

While composing a message, press **<Options>** to access the following options:

- **Input:** enter the message text.
- **Add File:** add an image, video, or sound clip.
- **Send:** send the message.
- **Preview:** view the message as it will be shown on the recipient's phone.
- **Input Method:** change the text input mode.
- **Insert Text Template:** insert a text template.
- **Save to Drafts:** save the message in the **Drafts** folder.
- **Add Page:** add pages. Move to each page by pressing [Left] or [Right].
- **Move Page:** move the current page backward or forward to change the page order.
- **Delete Page:** delete a page.

- **Edit Style:** change the page properties.  
**This Page:** set the page duration and change font colour and style for the selected page.  
**All Pages:** change the background colour and page layout.
- **Edit Text/Change File:** edit the added text, image, video, or sound clip.
- **Delete Text/Delete File:** delete the added text, image, video, or sound clip.
- **Save as Template:** save the message as a template in the **MMS Templates** folder.

### Email (Menu 8.1.3)

You can send and receive e-mails that include text, audio, and images. To use this feature, you need to subscribe to an e-mail service and set up your e-mail account.

▶ p. 79

### Creating and sending an e-mail

1. Enter the e-mail subject.

You can use various options by pressing **<Options>** in each field. ▶ next section

2. Move to the **Message** field.

3. Enter the message text.
4. Move to the **Attach Files** line.
5. Press **<Options>** and select **Add Files**, **Add Name Card**, or **Add V-Calendar**.
6. Select images, videos, sounds, name cards, or calendar data.
7. Press **<Options>** and select **Attach**.
8. When you have finished, press [Centre].
9. Enter an e-mail address.  
To send the e-mail to more than one recipient, fill in additional destination fields.
10. Press [Centre] to send the e-mail.

### Using options while composing an e-mail

While composing an e-mail, press **<Options>** to access the following options in each field:

- **Send:** send the message.
- **Input Method:** change the text input mode.
- **Insert Text Template:** insert a text template.



- **Insert:** insert a text template, Phonebook entry, or bookmarked URL address.
- **Attached File List:** access the file list you attached.
- **Add Files:** add images, videos, or sounds.
- **Add Name Card:** attach a Phonebook entry as a name card.
- **Add V-Calendar:** attach calendar data as a data format attachment.
- **Delete All Attachments:** delete all attachments.
- **Save to Drafts:** save the e-mail in the **Drafts** folder.



### **Inbox** (Menu 8.2)



---

This folder stores all types of messages you have received, except for e-mails.

#### **Viewing a message**

The following icons may appear on the list to show the message type:

-  SMS message
-  MMS message

-  MMS notification
-  Push message from web servers
-  Configuration message, containing network parameters from your service provider



- Depending on the DRM (Digital Rights Management) system, messages having web content may not be able to be forwarded.
- A ! icon next to a message means that the message is of high priority. A grey-coloured message icon indicates low priority.

#### **Using message options**

While viewing a message, press <**Options**> to access the following options:

#### **SMS messages**

- **Call/Go to URL/Go to RTSP:** dial the highlighted phone number or access the highlighted web link.
- **Add to Favorites:** save the highlighted web link to the bookmark list.
- **Send:** send an SMS, MMS, or e-mail to the highlighted phone number or e-mail address.

- **Reply:** reply to the sender via SMS or MMS.
  - **Forward:** forward the message to other people.
  - **Call Back:** dial the phone number of the sender.
  - **Save to Phonebook:** save the sender's phone number to Phonebook. If a phone number, e-mail address, or URL address within the message is selected, you can also save it to Phonebook.
  - **Move to SIM/Move to Phone:** move the message between the phone's memory and the USIM/SIM card.
  - **Delete:** delete the message.
- ### MMS messages
- **Call/Go to URL/Go to RTSP:** dial the highlighted phone number or access the highlighted web link.
  - **Add to Favorites:** save the highlighted web link to the bookmark list.
  - **Send:** send an SMS, MMS, or e-mail to the highlighted phone number or e-mail address.
  - **Play:** play the sound file attached to the message.
  - **Reply:** reply to the sender via SMS or MMS.
  - **Reply All:** send a reply to the sender and all recipients.
  - **Forward:** forward the message to other people.
  - **Call Back:** dial the phone number of the sender.
  - **Save As Template:** save the message as a template in the **MMS Templates** folder.
  - **Save Files:** save media items from the message into your phone's memory or a memory card.
  - **Save to Phonebook:** save the sender's phone number to Phonebook. If a phone number, e-mail address, or URL address within the message is selected, you can also save it to Phonebook.
  - **Delete:** delete the message.
  - **Details:** access the message properties.

### Push messages

- **Go to URL/Go to RTSP:** connect to the URL specified in the message.
- **Delete:** delete the message.

### Configuration messages

- **Install:** apply the configuration value in the message to your phone.
- **Delete:** delete the message.

### Delivery reports

- **Call Back:** dial the phone number of the sender.
- **Save to Phonebook:** save the sender's phone number to Phonebook. If a phone number, e-mail address, or URL address within the message is selected, you can also save it to Phonebook.
- **Delete:** delete the report.

### Sent *(Menu 8.3)*

---

This folder stores messages that you have sent.

From the message list, press <**Options**> to access the following options:

- **View:** open the selected message.



- **Forward:** forward the message to other people.
- **Sort By:** change the sort order of the message list.
- **Delete:** delete the selected message or all messages.
- **Details:** access the message properties.

### Outbox *(Menu 8.4)*

---

This folder stores messages that the phone is attempting to send or has failed to send.

The following icons on the message list indicates the sending status:

-  Being sent
-  Failed to be sent

From the message list, press <**Options**> to access the following options:

- **View:** open the selected MMS message.
- **Edit:** edit the message.
- **Send Again:** resend the message.
- **Cancel Sending:** cancel sending the message.
- **Sort By:** change the sort order of the message list.

- **Delete:** delete the selected message or all messages.
- **Details:** access the MMS message properties.

### **Drafts** *(Menu 8.5)*

---

This folder stores messages you have saved to send them at a later time.

From the message list, press <**Options**> to access the following options:

- **View:** open the selected MMS message.
- **Edit:** edit the selected message.
- **Send:** send the message.
- **Sort By:** change the sort order of the message list.
- **Delete:** delete the selected message or all messages.

### **Email Inbox** *(Menu 8.6)*

---

This folder stores e-mails that you have received.

### **Viewing received e-mails**

1. Press <**Options**> and select **Download**.  
The phone checks the e-mail server and downloads new e-mails.
2. Select an e-mail or a header.
3. If the e-mail has more than one page, press [**▲/▼**] to scroll through pages one by one.
4. Select an attached file to view or play it.

Depending on the DRM (Digital Rights Management) system, messages having web content may not be able to be forwarded.

### **Using e-mail options**

While viewing the e-mail or header, press <**Options**> to access the following options:

- **View:** open the selected e-mail.
- **Retrieve:** retrieve the body of the selected e-mail header from the e-mail server.
- **Reply:** send a reply to the sender.
- **Reply to All:** send a reply to the sender and all recipients.

- **Forward:** forward the e-mail to other people.
- **Download:** download new e-mails or headers from the e-mail server.
- **Sort By:** change the sort order of the e-mail list.
- **Save Files:** save the selected file.
- **Save to Phonebook:** extract phone numbers or e-mail addresses from the e-mail and save them in Phonebook.
- **Block:** add the sender's e-mail address or e-mail subject to the Block list to reject e-mails from that address or containing that subject.
- **Delete from Phone:** delete the selected e-mail or all e-mails from the phone's memory.
- **Delete Permanently:** delete the selected e-mail or all e-mails from both the phone's memory and the e-mail server.
- **Details:** access the e-mail properties.

## Templates (Menu 8.7)

---

Use this menu to create, edit, and send SMS templates and MMS templates.

### Text Templates (Menu 8.7.1)

You can create SMS templates with the sentences you use frequently so that you can retrieve and insert them when composing an SMS message.

### Creating a template

1. Press **<Options>** and select **New**.
2. Enter a message and press [Centre].

### Using template options

From the template list, press **<Options>** to access the following options:

- **Send:** create and send a new message using the template via SMS, MMS, or e-mail.
- **Edit:** change the selected template.
- **New:** add a new template.
- **Delete:** delete the selected template or all templates.

## MMS Templates (Menu 8.7.2)

You can create MMS templates so that you can use them in composing an MMS message.

### Creating a template

1. Press **<New>**, or press **<Options>** and select **New**, if one has been already stored.
2. Create a template as you would when creating an MMS message.
3. Press [Centre] save the template.

### Using template options

From the template list, press **<Options>** to access the following options:

- **View**: open the selected template.
- **Send**: send the selected template via MMS.
- **New**: add a new template.
- **Edit**: edit the selected template.
- **Delete**: delete the selected template or all templates.

## Voice Mail (Menu 8.8)

---

Use this menu to store the number of the voicemail server and access your voicemails.

- **Connect to Voice Mail**: connect to the voicemail server to listen to your messages.
- **Voice Server Number**: enter the voicemail server number.

You must store the voicemail server number before accessing the server. Your service provider can give you the number.

## Broadcast (Menu 8.9)

---

Your phone receives broadcast messages, which are text messages related to various topics, such as weather forecast, traffic, and news report, from networks. Use this menu to access received broadcast messages.

### Viewing a broadcast message

All broadcast messages are stored in the **Temporary** folder and will be deleted after a period of time. If you do not want a message to be deleted, save it to the **Archive** folder. While viewing the message, press **<Options>** and select **Save**.

### Using message options

While viewing a message, press <**Options**> to access the following options:

- **Call/Go to URL/Go to RTSP:** dial the highlighted phone number or access the highlighted web link.
- **Create Email:** send an e-mail to the highlighted e-mail address.
- **Save:** save the message in the **Archive** folder.
- **Delete:** delete the message.

### Delete All *(Menu 8.10)*

---

Use this menu to delete messages in each message type at once.

1. Press [Centre] to select the message types to be cleared.
2. Press <**Delete**>.
3. Press <**Yes**> to confirm the deletion.

### Settings *(Menu 8.11)*

---

Use this menu to set up various options for using messaging services.

### Text Message *(Menu 8.11.1)*

You can configure SMS settings.

- **Settings x:** set the properties of each profile:
  - Center Address:** store or change the number of your SMS server.
  - Expiration:** set the length of time your messages are stored in the SMS server.
  - Default Type:** set the default message type. The network can convert messages into the selected format.
  - Name:** enter a profile name.
- **Sending Options:** set up the options for sending SMS messages:
  - Keep a Copy:** leave copies of your messages in the **Sent** folder after sending.
  - Email Gateway Address:** check the e-mail gateway address.
  - Character Support:** select a character encoding type. When you select **Automatic**, the phone switches the encoding type from GSM Alphabet to Unicode if you enter a Unicode character.

Using Unicode encoding will reduce the maximum number of characters in a message to about half. If this menu is not shown, your phone provides automatic character encoding by default.

### **Multimedia Message** (Menu 8.11.2)

You can configure MMS settings.

- **Sending Options:** set up the options for sending MMS messages:

**Priority:** set the priority level of messages.

**Expiration:** set the length of time messages are stored in the MMS server.

**Custom Time(Hour):** enter the length of time you want if you select **Custom Time** in the **Expiration** option.

**Delivery:** set a time delay before messages are sent.

**Custom Time(Hour):** enter the length of time you want if you select **Custom Time** in the **Delivery** option.

**Hide Address:** set your address to be hidden from the recipient's phone.

**Request Delivery Report:** set the network to inform you when your messages have been delivered.

**Request Read Report:** send a read-replay request along with your messages.

**Keep a Copy:** leave copies of your messages in the **Sent** folder after sending.

**Add Signature:** allow your signature to be attached to your message.

**Input Signature:** enter your signature.

**Message Size:** select a maximum file size of allowed for messages. Available message size may vary, depending on your country.

- **Receiving Options:** set up the options for receiving MMS messages:

**Download Type:** determine if your phone retrieves new messages automatically when you are in your home service area.

**Roaming Network:** determine if your phone retrieves new messages automatically when you are roaming in another network.



Reception within your home network or while roaming has the following options:

- **Auto Download:** the phone automatically retrieves messages from the server.
- **Manual:** the phone receives notifications first from the server. Use the **Retrieve** option to manually retrieve new messages.
- **Restricted:** the phone receives notifications first from the server. When you attempt to retrieve new messages, the phone informs you of additional charges.

**Send Delivery Report:** set the network to inform the sender when a message has been delivered to you.

**Send Read Report:** determine whether or not the phone sends a read-reply when an incoming message has been read.

**Reject Anonymous:** reject messages from unknown senders.

**Reject Advertisement:** reject advertisements.

- **MMS Profiles:** select a connection profile to be used for MMS. You can also create or edit a profile. ▶ p. 91
- **Creation Mode:** select an MMS creation mode:
  - Free:** you can create a message with any type of content and of any size.
  - Restrict:** you can create a message with any type of contents and size.
  - Warning:** you can create a message with any type of content and of any size, but the phone will inform you when the content and size exceed the maximum.
- **Slide Interval:** select the length of time the display shows each page in a message.

### Email (Menu 8.11.3)

You can configure e-mail settings.



You cannot change e-mail profile settings while an e-mail is being sent or retrieved.

- **Sending Options:** set up the options for sending e-mails:
  - From:** set the sender name.

**Sending Account:** select the default account.

**Priority:** select the priority level of e-mails.

**Keep a Copy:** leave copies of your e-mails in the **Sent** folder after sending.

**Include Body When Replying:** set whether or not the phone includes the original e-mail text in a reply.

**Delivery Report:** set the network to inform you when your e-mails are delivered.

**Add My Name Card:** allow your contact information to be attached to e-mails.

**Add Signature:** attach your signature to e-mails.

**Input Signature:** enter your signature.

- **Receiving Options:** set up the options for receiving e-mails:

**Set Download Limit:** determine the maximum size for incoming e-mails. Your phone will reject e-mails that exceed the specified size.

**Auto Polling:** set the phone to automatically check the e-mail server to

download e-mails at the specified intervals.

**Polling Frequency:** set how often the phone checks the e-mail server for automatic polling.

**Block Address:** specify e-mail addresses to reject e-mails from those addresses, and activate or deactivate mail blocking.

**Block Subject:** specify subjects to reject e-mails which contain those subjects you specify, and activate or deactivate mail blocking.

- **Email Profiles:** select a network connection profile to be used for e-mail services. You can also create or edit a profile. ▶ p. 91
- **Email Accounts:** set up an e-mail account and select an account to be used. Press <**Options**> and select **Edit** to access the following options for setting up an account:

**Account Name:** enter a name for the currently selected account.

**SMTP Server:** enter the IP address or host name of the outgoing e-mail server.

**SMTP Port:** enter the SMTP port number.

**Use SSL:** activate the use of the SSL (Secure Sockets Layer) protocol.

**Retrieving Server Type:** select the protocol for the incoming e-mail server. The remaining options depend on the protocol type setting.

**POP3 Server/IMAP4 Server:** enter the IP address or host name of the POP3 or IMAP4 server.

**POP3 Port/IMAP4 Port:** enter the POP3 or IMAP4 port number.

**Use SSL:** activate the use of the SSL (Secure Sockets Layer) protocol.

**IMAP4 Retrieving Option:** (IMAP4 protocol only): set whether the phone retrieves only new messages or all messages.

**Retrieving Option:** set whether the phone downloads e-mail headers only or the complete e-mail.

**Keep in Server:** leave the copies of e-mails on the e-mail server after retrieving.

**My Address:** set your e-mail address.

**User Name:** enter the POP3 or IMAP4 user name.

**Password:** enter the POP3 or IMAP4 password.

**Use SMTP Authentication:** enable SMTP authentication, which requires the user to log in before sending e-mails.

**Same as POP3/IMAP4:** select if you want the SMTP server to have the same parameters as the POP3 or IMAP4 server.

**User Name:** enter the SMTP user name.

**Password:** enter the SMTP password.

### **Voice Mail** (*Menu 8.11.4*)

Use this menu to set the number of your voicemail server.

- You must store the voicemail server number before accessing the server. Your service provider can give you the number.

### **Push Messages** (*Menu 8.11.5*)

You can set whether or not to receive push messages from the web server.

## **Broadcast** (Menu 8.11.6)

You can change the settings for receiving broadcast messages.

- **Receive:** select whether or not the phone receives broadcast messages.
- **Channel:** indicate the channels from which you wish to receive broadcast messages. Please contact your service provider for further details.

## **Memory Status** (Menu 8.12)

---

Use this menu to view the number of messages or the amount of memory currently in use for each message type in each folder.

## **Settings** (Menu 9)

The **Settings** menu provides you with various setting options to customise the phone to your preferences and needs. You can also reset the settings to their default status.

To access this menu, press <**Menu**> in Idle mode and select **Settings**.

## **Profiles** (Menu 9.1)

---

Your phone provides you with sound profiles that allow you to quickly and easily change the sound settings of the phone for different events or situations. Use this menu to adjust the properties of each profile and activate the profile you need.

### **Editing a profile**

1. Scroll to the profile you want.
2. Press <**Options**> and select **Edit**.
3. Change the sound settings:
  - **Call Alert Type:** select an alert type for the call ringer.

- **Voice Call Ringtone:** select a ringtone for voice calls.
- **Video Call Ringtone:** select a ringtone for video calls.
- **Tone Volume:** adjust the volume for the call ringer.
- **Message Alert Type:** select an alert type for the message ringer.
- **Message AlertTone:** select a ringtone for the message ringer.
- **Message Alert Repetition:** select if the phone repeatedly reminds you of a new message.
- **Phone Sounds:** turn the various sounds on the phone on or off:
  - All On:** enable all tones.
  - Popup Box Alerts:** set the phone to beep when a pop-up window displays.
  - Minute Minder:** set the phone to beep every minute during an outgoing call to keep you informed of the length of your call.

**Call Connect Tone:** set the phone to beep when an outgoing call is connected to the system.

**Call End Tone:** set the phone to beep when a call is disconnected by the other person or due to a faded signal.

**Power On/Off:** set the phone to beep when you turn it on or off.

**Flip Open/Close:** set the phone to sound when you open or close it.

**Alerts On Call:** set the phone to beep when you receive a new message or when the time for an alarm comes during a call.

- **KeyTones:** select a tone which sounds when you press a key.
  - **KeyTone Volume:** adjust the key tone volume.
  - **Call Answer Mode:** (For Car) select how to answer an incoming call.
4. When you have finished, press **<Options>** and select **Save**.

## Changing an active profile

From the profile list, select the profile you want.

## Display Settings *(Menu 9.2)*

---

Use this menu to change settings for the display.

### Greeting Message *(Menu 9.2.1)*

Use this menu to enter the greeting that is displayed on the main display or external display.

### Wallpaper *(Menu 9.2.2)*

You can change the background image that is displayed on the main display. You can select one of the images in the **Images** folder.

### Sub LCD *(Menu 9.2.3)*

Use this menu to select an image or enter text to be displayed on the external display.

- **Clock:** select a clock type.
- **Sub Title:** enter the text you want.
- **Images:** press <**Change**> and select an image.

### LCD Brightness *(Menu 9.2.4)*

Use this menu to adjust the brightness of the main display.

### Sub LCD Contrast *(Menu 9.2.5)*

You can adjust the contrast for the external display. Adjust this setting with the display brightness to see the display clearly in different lighting conditions.

### Backlight *(Menu 9.2.6)*

You can select the length of time the backlight or display stays on.

- **On:** select the length of time the backlight stays on in times of inactivity.
- **Dim:** select the length of time the display stays on in Dim mode after the backlight turns off. After a specified time, the display turns off.

### Dialing Display *(Menu 9.2.7)*

Use this menu to customise the settings for the numbers entered and the background.

### Menu Style *(Menu 9.2.8)*

You can select a display style for the main menu screen.

## **Time & Date** (Menu 9.3)

---

Use this menu to change the time and date displayed on your phone. Before setting the time and date, specify your time zone in the **World Time** menu. ▶ p. 50

- **Time:** enter the current time. To select AM or PM for 12-hour time format, press [Right].
- **Date:** enter the current date.
- **Time Format:** select a time format.
- **Date Format:** select a date format.
- **Auto Update:** activate the auto time update feature. Your phone will read the MCC (Mobile Country Code) from the network and automatically update the current time for the country that you are in when you travel abroad.

Time information may not be updated when you move to one time zone to another within a country.

## **Phone Settings** (Menu 9.4)

---

Many different features of your phone's system can be customised to suit your preferences.

### **Short Cut** (Menu 9.4.1)

You can use the Navigation keys as shortcut keys to access specific menus directly from Idle mode. Use this menu to assign a shortcut to a key.

#### **Assigning a shortcut menu**

1. Select a key to be used as a shortcut key.
2. Select a menu to be assigned to the key.

#### **Using shortcut options**

On the Short Cut screen, press **<Options>** to access the following options:

- **Assign:** assign a shortcut menu.
- **Change:** change a shortcut menu assignment.
- **Remove:** deactivate the shortcut assignment to the selected key.
- **Remove All:** deactivate all shortcut assignments.

### **Open To Answer** (Menu 9.4.2)

Use this menu to answer incoming calls by opening the phone.

### **Anykey Answer** (Menu 9.4.3)

Use this menu to answer an incoming call by pressing any key, except for <**Reject**>, [>, and Volume keys.

### **Call** (Menu 9.5)

---

Use this menu to set options for call functions.

#### **Caller ID** (Menu 9.5.1)

This network service allows you to hide your phone number from the person you are calling. If you select **Default**, the phone will use the default setting provided by the network.

- Some networks do not allow the user to change this setting.

### **Forwarding** (Menu 9.5.2)

This network service reroutes incoming calls to a different phone number that you specify.

1. Select the type of calls to be diverted.
2. Select a call diverting option:
  - **Always:** divert all calls.
  - **Busy:** divert calls when you are on another call.
  - **No Reply:** divert calls when you do not answer the phone.
  - **Unreachable:** divert calls when you are not in your service area or when your phone is switched off.
  - **Cancel All:** cancel all call diverting options.
3. Enter the number to which the calls will be diverted in the **Forward To** line.
4. If you selected **No Reply**, move to the **Waiting Time** line and select the length of time the network delays before diverting a call.



5. Press <**Options**> and select **Activate**. To deactivate the call diverting, select **Deactivate**.

### **Barring** (Menu 9.5.3)

This network service allows you to restrict your video calls.

1. Select the type of calls to be barred.
2. Select a call barring option:
  - **All Outgoing Calls:** prohibit all outgoing calls.
  - **Outgoing Int'l Calls:** prohibit international calls.
  - **Int'l Calls Exc. Home:** only allow calls to numbers within the current country when you are abroad, and to your home country.
  - **All Incoming Calls:** prohibit incoming calls.
  - **Incoming Calls When Roaming:** prohibit incoming calls when you use your phone outside of your home service area.
  - **Cancel All:** cancel all call barring settings, allowing calls to be sent and received normally.

3. Enter the call barring password supplied by your service provider.
4. Press <**Options**> and select **Activate**. To deactivate the call barring, select **Deactivate**.

- You can change the call barring password obtained from your service provider. From the call type list, press <**Options**> and select **Change Password**.

### **Waiting** (Menu 9.5.4)

This network service informs you when someone is trying to reach you while you are on another call.

1. Select the type of calls to which the call waiting option will apply.
2. Press <**Options**> and select **Activate**. To deactivate the call waiting, select **Deactivate**.

### **Auto Redial** (Menu 9.5.5)

Use this menu to make up to ten attempts to redial a phone number after an unsuccessful call.

### **Closed User Group** (Menu 9.5.6)

Use this menu to set incoming and outgoing calls to be restricted to a selected user group (CUG). For details about how to create a closed user group, contact your service provider.

- **Use User Group:** activate CUG index numbers.
- **Outside Access:** enable calls to numbers other than those in the Closed user group. This feature depends on the nature of your CUG subscription.
- **Default Group:** enable the default CUG, if you have set one with your service provider. When making a call, you are given the option of using your default CUG, instead of selecting one from the list.
- **Group Index:** add, delete, or activate CUG index numbers.

### **Video Call** (Menu 9.6)

---

Use this menu to change the default settings for using the video call feature.

### **Show My Image** (Menu 9.6.1)

You can set whether or not the phone displays your image on the other's phone via the camera. If you select **Ask Always**, the phone will ask you to turn on the camera.

### **Select Still Image** (Menu 9.6.2)

You can select an image to be displayed on the other's phone if you will not show your image via the camera. Press <**Change**> and select an image.

### **Retry with** (Menu 9.6.3)

You can set what to do when a video call does not connect:

- **Ask Always:** the phone always asks you to whether or not to retry.
- **Voice Call:** the phone retries with a voice call.
- **Camera:** the phone turns on the camera and switches to Record mode so that you can record a video and send it as an MMS message.

- **Messages:** the phone will turn on the camera and switch to Record mode so that you can record a video and send it as an MMS message.
- **None:** the phone does not retry.

### **Forwards** (Menu 9.6.4)

Use this menu to reroute incoming video calls to a different phone number that you specify. ▶ p. 85

### **Restrict Calls** (Menu 9.6.5)

Use this menu to restrict video calls. ▶ p. 85

### **Connectivity** (Menu 9.7)

---

Use this menu to set options for connection available on your phone.

#### **Bluetooth** (Menu 9.7.1)

Using Bluetooth wireless, you can connect the phone wirelessly to other Bluetooth devices and exchange data with them, talk hands-free, or control the phone remotely.

Bluetooth technology allows free wireless connections between all Bluetooth-compliant devices within a range of 10 metres. Since the devices communicate using radio waves, they do not need to be in line of sight to each other.



- If there are obstacles between the devices, the operating distance may be reduced.
- It is recommended that you do not use the Bluetooth feature while using multimedia features, such as voice recorder, camera, and media player, or vice versa, for the better performance.
- Some devices, especially those that are not tested or approved by SIG, may be incompatible with your phone.

#### **Setting up the Bluetooth feature**

The **Bluetooth** menu provides the following options:





- **Activation:** activate or deactivate the Bluetooth feature.
- **My Devices:** search for connectable Bluetooth devices.

- **My Phone's Visibility:** allow other Bluetooth devices to locate to your phone, or not.
- **My Phone's Name:** assign a Bluetooth device name to your phone, which is then displayed on other devices.
- **Secure Mode:** determine if the phone asks for your confirmation when other devices access your data.
- **Bluetooth Service:** display available Bluetooth services.

### Searching for and pairing with a Bluetooth device

1. From the **Bluetooth** menu, select **My Devices**.
2. Select **Search For New Device**.

After searching, a list of devices to which you can connect displays. The following icons indicate the type of device:

-  Hands-free car kit or headset
-  Mobile phone
-  Computer
-  PDA
-  Unknown device

The colour of the icon indicates the status of the device:

- Grey for unpaired devices
- Blue for paired devices
- Red for devices that are currently connected to your phone

3. Select a device.
4. Enter a Bluetooth PIN and press **<OK>**. This code is used just once and you do not need to memorise it.

When the owner of the other device enters the same code, pairing is complete.

- Some devices, especially headsets or hands-free car kits, may have a fixed Bluetooth PIN, such as **0000**. If the other device has one, you must enter the code.

### Using device options

From the device list, press **<Options>** to access the following options:

- **Connect:** connect to a headset or hands-free car kit.
- **Disconnect:** end the connection with the connected device.

- **Browse Device:** search for data from the device and import data directly to your phone.
- **Rename:** rename the selected device.
- **Authorize Device/Unauthorize Device:** determine whether or not the phone asks you to permit connection when other devices try to connect to your phone.
- **Delete:** remove the selected device or all devices from the list.

### **Sending data via Bluetooth**

1. Activate the Bluetooth feature.
2. Select the application in which the item you want to send is stored.
3. Scroll to the item you want and press **<Options>**.
4. Select **Send Business Card via/Send via/Send Schedule via/Send Task via** → **Bluetooth**.
5. Select **Search For New Device**.

The phone searches for devices within range and displays a list of available devices.

6. Select a device.
7. If necessary, enter the Bluetooth PIN needed for pairing and press **<OK>**.

### **Receiving data via Bluetooth**

To receive data via Bluetooth, your phone's Bluetooth feature must be active and its visibility must be enabled.

1. If an unauthorised Bluetooth device sends data to your phone, press **<Yes>** to allow the device to access your phone.
2. Press **<Yes>** to receive data.

### **Network** (*Menu 9.7.2*)

Use this menu to change the settings for connecting to your cellular network.

- **Network Selection:** select to either manually select the network to be used while roaming outside of your home area, or to let the network be chosen automatically. You can select a network other than your home network only if there is a valid roaming agreement between the two.
- **Network Mode:** select the network you use.

**Automatic:** the phone scans for available networks.

**GSM 900/1800:** the phone operates in the combined GSM 900/1800 network.

**GSM 850/1900:** the phone operates in the combined GSM 850/1900 network.

**UMTS:** the phone operates in UMTS (3G network) networks. You can get a higher speed quality than on lower generation networks, and use advanced data and information services, such as video calls.

### Connections *(Menu 9.7.3)*

Use this menu to create and customise the profiles containing the settings for connecting your phone to the network. You need these settings to use the web browser or send MMS messages or e-mails.

- Your phone is set up by default for connecting to the network. If you change the settings without first checking with your service provider, the web browser, MMS, and e-mail features may not work properly.

### Creating a profile

1. Press <**Options**> and select **New**.
2. Specify profile parameters:
  - **Set Name:** enter a profile name.
  - **Access Name:** edit the access point name used for the address of the GPRS network gateway.
  - **Auth Type:** choose the type of authentication used.
  - **User ID:** enter the user ID.
  - **Password:** enter the user password.
  - **Protocol:** select the protocol from among **WAP**, **HTTP**, and **Other**.
  - **Home URL:** enter the URL address of the page to be used as your homepage.
  - **Gateway Address:** (WAP only) enter the gateway address of the proxy server.
  - **Proxy Address/Port:** (HTTP only) set the proxy server address and port.
  - **Secure Connection:** (WAP only) turn the secure mode on or off.

- **Linger Time (Sec.):** set a time period after which the network is disconnected if there has been no new data traffic in that time.
- **Advanced Settings:** provide you with the following options:
  - Static IP:** specify if you want to manually enter an IP address; see the **Local Phone IP** option. If you want the IP address to be automatically assigned by the server, remove the check mark.
  - Local Phone IP:** enter the IP address obtained from the network operator, if you checked the **Static IP** option.
  - Static DNS:** specify if you want to manually enter the Domain Name Server (DNS) address; see the **Server 1/Server 2** option. If you want the address to be automatically assigned by the server, remove the check mark.
  - Server 1/Server 2:** enter the Domain Name Server (DNS) addresses.

**Traffic Class:** select the traffic class.

3. Press **<Save>** to save the profile.

### Using profile options

From the profile list, press **<Options>** to access the following options:

- **View:** view the properties of the selected profile.
- **Edit:** edit the selected profile.
- **New:** add a new profile.
- **Delete:** delete the profile.
- **Rename:** change the profile name.
- **Restore:** restore the changed settings to the default status.



You cannot edit or delete the default connection profiles.

### Application Settings (Menu 9.8)

---

You can customise the settings for using applications available on the phone.

#### Browser (Menu 9.8.1)

Use this menu to select a connection profile to be used for accessing the Internet. You can also create or edit a profile. ► p. 91

**Messages** (Menu 9.8.2)

Use this menu to change the default settings for using the messaging services. ▶ p. 76

**Phonebook** (Menu 9.8.3)

Use this menu to change the settings for using Phonebook. ▶ p. 41

**Camera** (Menu 9.8.4)

Use this menu to change the default settings for taking photos. ▶ p. 63

**Video Recorder** (Menu 9.8.5)

Use this menu to change the default settings for recording videos. ▶ p. 65

**Record Audio** (Menu 9.8.6)

Use this menu to change the default settings for the voice recorder. ▶ p. 45

**Media Player** (Menu 9.8.7)

Use this menu to change the default settings for playing media files in the media player.  
▶ p. 43

**VOD** (Menu 9.8.8)

Use this menu to activate a connection profile to be used for accessing streaming servers to use VOD (Video on Demand) services. You can also create or edit a profile. ▶ p. 91

**Security** (Menu 9.9)

Use this menu to protect the phone against unauthorised use by managing the several access codes of your phone and USIM/SIM card.

- If you enter an incorrect PIN/PIN2 three times, the USIM/SIM card is blocked. To unblock it, you need to enter your PUK/PUK2 (Personal Unblocking Key). The codes are supplied by your network operator.

**Phone Lock** (Menu 9.9.1)

Use this menu to protect the phone from unauthorised use. When this feature is enabled, you must enter a 4- to 8-digit phone password each time the phone is switched on.

To change the password, use the **Change Phone Password** menu.



### **SIM Lock** (Menu 9.9.2)

This menu allows your phone to work only with the current USIM/SIM by assigning a USIM/SIM lock code. You must enter the USIM/SIM lock code to use a different USIM/SIM card.

### **PIN Lock** (Menu 9.9.3)

The 4- to 8-digit PIN (Personal Identification Number) protects your USIM/SIM card against unauthorised use. When this feature is enabled, the phone requires your PIN each time it is switched on.

### **Fixed Dialing Mode** (Menu 9.9.4)

If supported by your USIM/SIM card, Fixed Dialling Number (FDN) mode restricts your outgoing calls to a limited set of phone numbers. When this feature is enabled, you can make calls only to phone numbers stored on the USIM/SIM card.

### **Change Phone Password** (Menu 9.9.5)

Use this menu to change your phone password.

### **Privacy Lock** (Menu 9.9.6)

Use this menu to lock access to messages, media files, Phonebook entries, or call logs. When a privacy option is enabled, you must enter the phone password to access the locked items.

### **Change PIN Code** (Menu 9.9.7)

Use this menu to change your PIN. The PIN Lock feature must be enabled to change the PIN.

### **Change PIN2 Code** (Menu 9.9.8)

If supported by your USIM/SIM card, use this menu to change your current PIN2.

### **Memory Status** (Menu 9.10)

---

Use this menu to check the amount of memory being used for storing data, such as messages, media, calendar data, or contacts entries.

## Reset Settings (Menu 9.11)

---

Use this menu to reset the phone's settings you have changed and clear all data you have added.

1. Enter the phone password and press **<Confirm>**.

You can change this password. ▶ p. 94

2. Press **<Yes>**. The phone automatically turns itself off and then back on.

## Phone Information (Menu 9.12)

---

Use this menu to check phone information, such as your phone number, software version, and model name.

## Solve problems

### Help and personal needs

To save the time and expense of an unnecessary service call, perform the simple checks in this section before contacting a service professional.

### When you switch on your phone, the following messages may appear:

"Please insert SIM card"

- Be sure that the USIM/SIM card is correctly installed.

"Phone lock"

- The automatic locking function has been enabled. You must enter the phone's password before you can use the phone.

"PIN lock"

- You are using your phone for the first time. You must enter the PIN supplied with the USIM/SIM card.
- The PIN Lock feature is enabled. Every time the phone is switched on, the PIN has to be entered. To disable this feature, use the **PIN Lock** menu.

### “PUK lock”

- The PIN code was entered incorrectly three times, and the USIM/SIM card is now blocked. Enter the PUK supplied by your service provider.

### “No service” or “Network error” displays

- The network connection has been lost. You may be in a weak signal area. Move and try again.
- You are trying to access an option for which you have no subscription with your service provider. Contact the service provider for further details.

### You have entered a number but it was not dialled

- Be sure that you have pressed [↵].
- Be sure that you have accessed the right cellular network.
- Be sure that you have not set an outgoing call barring option.

### Your correspondent cannot reach you

- Be sure that your phone is switched on. ([📶] pressed for more than one second.)
- Be sure that you have accessed the right cellular network.
- Be sure that you have not set an incoming call barring option.

### Your correspondent cannot hear you speaking

- Be sure that you have switched on the microphone.
- Be sure that you are holding the phone close enough to your mouth. The microphone is located at the bottom of the phone.

### The phone starts beeping and “Low Battery” flashes on the display

- Your battery is insufficiently charged. Recharge the battery.

### The audio quality of the call is poor

- Check the signal strength indicator on the display (📶). The number of bars indicates the signal strength from strong (📶) to weak (📶).

- Try moving the phone slightly or moving closer to a window if you are in a building.

### **No number is dialled when you re-call a Phonebook entry**

- Use the **Contact List** feature to ensure the number has been stored correctly.
- Re-store the number, if necessary.

### **The battery does not charge properly or the phone sometimes turns itself off**

- Wipe the charging contacts both on the phone and on the battery with a clean soft cloth.

### **If the above guidelines do not help you to solve the problem, take note of:**

- The model and serial numbers of your phone
- Your warranty details
- A clear description of the problem

Then contact your local dealer or Samsung after-sales service.

## *Health and safety information*

### **SAR certification information**

This phone meets European Union (EU) requirements concerning exposure to radio waves.

Your mobile phone is a radio transmitter and receiver. It is designed and manufactured to not exceed the limits for exposure to radio-frequency (RF) energy, as recommended by the EU Council. These limits are part of comprehensive guidelines and establish permitted levels of RF energy for the general population. The guidelines were developed by independent scientific organisations through the periodic and thorough evaluation of scientific studies. The limits include a substantial safety margin designed to ensure the safety of all persons, regardless of age and health.

The exposure standard for mobile phones employs a unit of measurement known as Specific Absorption Rate (SAR). The SAR limit recommended by the EU Council is 2.0 W/kg.<sup>1</sup>

The highest SAR value for this model phone was 0.822 W/kg.

SAR tests are conducted using standard operating positions with the phone transmitting at its highest certified power level in all tested frequency bands. Although the SAR is determined at the highest certified power level, the actual SAR level of the phone while operating can be well below the maximum value. This is because the phone is designed to operate at multiple power levels so as to use only the power required to reach the network. In general, the closer you are to a base station, the lower the power output of the phone.

---

1. The SAR limit for mobile phones used by the public is 2.0 watts/kilogram (W/kg) averaged over ten grams of body tissue. The limit incorporates a substantial margin of safety to give additional protection for the public and to account for any variations in measurements. The SAR values may vary, depending on national reporting requirements and the network band.

Before a new model phone is available for sale to the public, compliance with the European R&TTE Directive must be shown. This directive includes as one of its essential requirements the protection of the health and safety of the user and any other person.

### **Precautions when using batteries**

---

- Never use a charger or battery that is damaged in any way.
- Use the battery only for its intended purpose.
- If you use the phone near the network's base station, it uses less power. Talk and standby time are greatly affected by the signal strength on the cellular network and the parameters set by the network operator.
- Battery charging time depends on the remaining battery charge, the type of battery, and the charger used. The battery can be charged and discharged hundreds of times, but it will gradually wear out. When the operation time is noticeably shorter than normal, it is time to buy a new battery.

- If left unused, a fully charged battery will discharge itself over time.
- Use only Samsung-approved batteries, and recharge your battery only with Samsung-approved chargers. Disconnect the charger from the power source when it is not in use. Do not leave the battery connected to a charger for more than a week, since overcharging may shorten its life.
- Extreme temperatures will affect the charging capacity of your battery: it may require cooling or warming first.
- Do not leave the battery in hot or cold places because the capacity and lifetime of the battery will be reduced. Try to keep the battery at room temperature. A phone with a hot or cold battery may not work temporarily, even when the battery is fully charged. Li-ion batteries are particularly affected by temperatures below 0°C (32°F).
- Do not short-circuit the battery. Accidental short-circuiting can occur when a metallic object like a coin, clip or pen causes a direct connection between the + and – terminals of the battery (metal strips on the battery). For example, do not carry a spare battery in a pocket or bag where the battery may contact metal objects. Short-circuiting the terminals may damage the battery or the object causing the short-circuiting.
- Dispose of used batteries in accordance with local regulations. Always recycle. Do not dispose of batteries in a fire.

## Road safety

---

Your wireless phone gives you the powerful ability to communicate by voice, almost anywhere, anytime. But an important responsibility accompanies the benefits of wireless phones, one that every user must uphold.

When you are driving a car, driving is your first responsibility. When using your wireless phone while driving, follow local regulations in the country or region you are in.

## **Operating environment**

---

Remember to follow any special regulations in force in the area you are in, and always switch off your phone whenever it is forbidden to use it, or when it may cause interference or danger.

When connecting the phone or any accessory to another device, read its user's guide for detailed safety instructions. Do not connect incompatible products.

As with other mobile radio transmitting equipment, users are advised that for the satisfactory operation of the equipment and for the safety of personnel, it is recommended that the equipment should only be used in the normal operating position (held to your ear with the antenna pointing over your shoulder).

## **Electronic devices**

---

Most modern electronic equipment is shielded from radio frequency (RF) signals. However, certain electronic equipment may not be shielded against the RF signals from your wireless phone. Consult the manufacturer to discuss alternatives.

### **Pacemakers**

Pacemaker manufacturers recommend that a minimum distance of 15 cm (6 inches) be maintained between a wireless phone and a pacemaker to avoid potential interference with the pacemaker. These recommendations are consistent with the independent research and recommendations of Wireless Technology Research. If you have any reason to suspect that interference is taking place, switch off your phone immediately.

### **Hearing aids**

Some digital wireless phones may interfere with some hearing aids. In the event of such interference, you may wish to consult your hearing aid manufacturer to discuss alternatives.

## **Other medical devices**

If you use any other personal medical devices, consult the manufacturer of your device to determine if it is adequately shielded from external RF energy.

Your physician may be able to assist you in obtaining this information.

Switch off your phone in health care facilities when regulations posted in these areas instruct you to do so.

## **Vehicles**

RF signals may affect improperly installed or inadequately shielded electronic systems in motor vehicles. Check with the manufacturer or its representative regarding your vehicle.

You should also consult the manufacturer of any equipment that has been added to your vehicle.

## **Posted facilities**

Switch off your phone in any facility where posted notices require you to do so.

## **Potentially explosive environments**

Switch off your phone when in any area with a potentially explosive atmosphere, and obey all signs and instructions. Sparks in such areas could cause an explosion or fire resulting in bodily injury or even death.

Users are advised to switch off the phone while at a refuelling point (service station). Users are reminded of the need to observe restrictions on the use of radio equipment in fuel depots (fuel storage and distribution areas), chemical plants, or where blasting operations are in progress.

Areas with a potentially explosive atmosphere are often but not always clearly marked. They include the areas below decks on boats, chemical transfer or storage facilities, vehicles using liquefied petroleum gas, such as propane or butane, areas where the air contains chemicals or particles, such as grain, dust or metal powders, and any other area where you would normally be advised to turn off your vehicle engine.



## **Emergency calls**

---

This phone, like any wireless phone, operates using radio signals, wireless, and landline networks as well as user-programmed functions, which cannot guarantee connection in all conditions. Therefore, you should never rely solely on any wireless phone for essential communications like medical emergencies.

To make or receive calls, the phone must be switched on and in a service area with adequate signal strength. Emergency calls may not be possible on all wireless phone networks or when certain network services and/or phone features are in use. Check with local service providers.

To make an emergency call:

1. Switch on the phone.
2. Key in the emergency number for your present location. Emergency numbers vary by location.
3. Press [↶].

Certain features like Call Barring may need to be deactivated before you can make an emergency call. Consult this document and your local cellular service provider.

## **Other important safety information**

- Only qualified personnel should service the phone or install the phone in a vehicle. Faulty installation or service may be dangerous and may invalidate any warranty applicable to the device.
- Check regularly that all wireless phone equipment in your vehicle is mounted and operating properly.
- Do not store or carry flammable liquids, gases, or explosive materials in the same compartment as the phone, its parts, or accessories.
- For vehicles equipped with an air bag, remember that an air bag inflates with great force. Do not place objects, including installed or portable wireless equipment, in the area over the air bag or in the air bag deployment area. Improperly installed wireless equipment could result in serious injury if the air bag inflates.
- Switch off your phone before boarding an aircraft. It is dangerous and illegal to use wireless phones in an aircraft because they can interfere with the operation of the aircraft.

- Failure to observe these instructions may lead to the suspension or denial of telephone services to the offender, or legal action, or both.

## Care and maintenance

---

Your phone is a product of superior design and craftsmanship and should be treated with care. The suggestions below will help you fulfill any warranty obligations and allow you to enjoy this product for many years.

- Keep your phone and all its parts and accessories out of the reach of small children and pets. They may accidentally damage these things or choke on small parts.
- Keep the phone dry. Precipitation, humidity, and liquids contain minerals that corrode electronic circuits.
- Do not use the phone with a wet hand. Doing so may cause an electric shock to you or damage to the phone.
- Do not use or store the phone in dusty, dirty areas, as its moving parts may be damaged.
- Do not store the phone in hot areas. High temperatures can shorten the life of electronic devices, damage batteries, and warp or melt certain plastics.
- Do not store the phone in cold areas. When the phone warms up to its normal operating temperature, moisture can form inside the phone, which may damage the phone's electronic circuit boards.
- Do not drop, knock, or shake the phone. Rough handling can break internal circuit boards.
- Do not use harsh chemicals, cleaning solvents, or strong detergents to clean the phone. Wipe it with a soft cloth slightly dampened in a mild soap-and-water solution.
- Do not paint the phone. Paint can clog the device's moving parts and prevent proper operation.
- Do not put the phone in or on heating devices, such as a microwave oven, stove, or radiator. The phone may explode when overheated.

- When the phone or battery gets wet, the label indicating water damage inside the phone changes colour. In this case, phone repairs are no longer guaranteed by the manufacturer's warranty, even if the warranty for your phone has not expired.
- If your phone has a flash or light, do not use it too close to the eyes of people or animals. This may cause damage to their eyes.
- Use only the supplied or an approved replacement antenna. Unauthorised antennas or modified accessories may damage the phone and violate regulations governing radio devices.
- If the phone, battery, charger, or any accessory is not working properly, take it to your nearest qualified service facility. The personnel there will assist you, and if necessary, arrange for service.

## *Index*

### **A**

- ABC mode, text input • 27
- Alarm • 43
- Answering
  - call • 29, 32
  - second call • 30
- Anykey answer • 85
- Auto redial • 86

### **B**

- Background image • 83
- Backlight time, set • 83
- Barring, calls • 86, 88
- Battery
  - charging • 7
  - low indicator • 8
  - precautions • 98

### **Bluetooth**

- receiving, data • 90
- sending, data • 90
- settings • 88

### **Broadcast messages • 75**

### **Browser, web • 51**

### **C**

- Calendar • 45
- Call log
  - dialled • 34
  - missed • 34
  - received • 35

### **Call time • 35**

- Caller groups • 38
- Caller ID • 85

### **Calls**

- answering • 29, 32
- barring • 86, 88
- diverting • 85, 88
- holding • 30
- making • 28
- redialling • 29
- rejecting • 29
- waiting • 86

### **Camera**

- photos • 61
- videos • 64

### **Characters, enter • 26**

### **Configuration messages • 72**

### **Connection tone • 82**

### **Creating messages**

- e-mail • 69
- MMS • 67
- SMS • 67

### **CUG (Closed User Groups) • 87**

### **D**

- Date, set • 84
- Deleting
  - call log • 35
  - e-mail • 72, 73, 74, 76
  - MMS • 71, 72, 73, 76

- photos • 57, 64
- SMS • 71, 72, 73, 76
- video clips • 57, 66

### **Dialled calls • 34**

### **Display**

- backlight, set • 83
- brightness • 83
- contrast • 83
- layout • 10
- settings • 83

### **Diverting, calls • 85, 88**

### **DRM (Digital Rights Management) • 55**

### **DTMF tones, send • 32**

### **E**

### **E-mails**

- creating/sending • 70
- deleting • 74
- settings • 78
- viewing • 73

### **Emergency calls • 102**

### **F**

### **FDN (Fixed Dialling Number) mode • 94**

- File manager • 55
- Flip tone • 82

**G**

- Games • 81
- Greeting message • 83

**H**

- Health and safety • 97
- Holding, call • 30

**I**

- Icons, description • 10
- Images, downloaded • 55
- Inbox, messages
  - e-mail • 73
  - SMS/MMS • 70
- International calls • 28
- Internet • 51

**J**

- Java applications • 81

**K**

- Key tones
  - selecting • 82
  - sending/muting • 31
  - volume • 82

**L**

- Last number, redial • 29
- LCD brightness • 83
- Locking
  - call log • 94
  - contacts • 94
  - media contents • 94
  - messages • 94

- phone • 93
- USIM/SIM card • 94
- Low battery indicator • 8

**M**

- Media player • 93
- Memory card
  - accessing files • 61
  - installing • 24
- Memory status
  - contacts • 41
  - downloaded items • 61
  - messages • 81
  - phone • 94
  - scheduled things • 49

- Menu style • 83

**Messages**

- broadcast • 75
- configuration • 73
- e-mail • 73
- greeting • 83
- MMS • 67, 71
- push • 72
- SMS • 67, 70
- Minute minder • 82
- Missed alarm events • 45
- Missed calls • 34
- MMS messages
  - creating/sending • 67
  - deleting • 71
  - settings • 77
  - viewing • 71
- Multiparty-call • 31

- Music, downloaded • 59
- My Files • 55

**N**

- Names
  - entering • 26
  - searching • 36
- Network selection • 90
- Numbers
  - searching • 36
  - storing • 37

**O**

- Organiser • 41
- Outbox, messages • 72

**P**

- Password
  - barring • 86
  - phone • 94
- Phone
  - care and maintenance • 103
  - display • 10
  - icons • 10
  - locking • 93
  - password • 94
  - resetting • 95
  - switching on/off • 8
  - unpacking • 6
- Phonebook
  - adding • 37
  - editing • 36
  - finding • 36

- options • 36
- speed-dialling • 39
- Photos
  - editing • 56
  - taking • 61
  - viewing • 55
- PIN, change • 94
- PIN2, change • 94
- Privacy • 94
- Problems, solve • 95
- Profiles • 81
- Push messages • 72, 80

**R**

- Received calls • 35
- Received messages
  - e-mail • 73
  - MMS/SMS • 70
- Recording
  - videos • 64
  - voice memos • 44
- Redialling
  - automatically • 86
  - manually • 29
- Resetting phone • 95
- Ringer
  - incoming calls • 82
  - messages • 82
- Road safety • 99
- Roaming • 90

**S**

- Safety
  - information • 97
  - precaution • 1
- Security calls • 94
- Sent messages • 72
- Shortcuts • 84
- Silent mode • 14
- SIM card
  - inserting • 7
  - locking • 94
- SMS messages
  - creating/sending • 67
  - deleting • 71, 76
  - settings • 76
  - viewing • 70
- Sound profiles • 81
- Speakerphone • 31
- Speed-dial • 39
- Switching applications • 24
- Switching on/off
  - microphone • 31
  - phone • 8

**T**

- T9 mode, text input • 26
- Templates, message • 74
- Text, enter • 26
- Time, set • 84

**U**

- USIM card

- inserting • 7
- locking • 94

**V**

- Video calls
  - answering • 32
  - making • 32
  - options • 32
  - setting • 87
- Videos
  - playing • 57
  - recording • 64
- Voice recorder
  - playing • 44
  - recording • 44
- Voicemail server • 80

**W**

- Waiting call • 86
- Wallpaper • 83
- Web browser
  - access • 51
  - bookmarks • 52