

# User's Manual

## Specification

Line Thermal Printers

### PT-280 Series

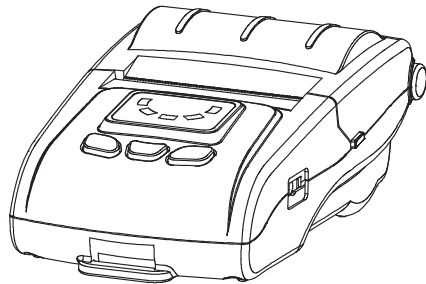

Portable Thermal Receipt Printers

### Safety warning

- Only the supplied AC power adapter and lithium battery is allowed to use, otherwise it may cause device damage, battery leakage, fire, and even explosion.
- Do not put the battery into a fire or apply direct heat to it or disassemble it, otherwise cause the battery leakage, fire, and even explosion.
- As the battery's liquid is corrosive, if there any case of operational mistakes to cause leakage, please wash immediately with plenty of clean water if skin or clothes contact it carelessly. If entering eyes, wash with plenty of clean water at once and seek medical advice.

### Safety notice

- Do not touch the paper tear-off knife.
- The print head is a heated part, please do not touch the print head and other parts around it during or after the printing process.
- Do not touch the print head and plug-in parts to avoid print head damage.
- Do not open the top cover when printing, otherwise may cause printer work failure.
- In order to get good print quality, and extend the device service life, we suggest that using the recommended thermal paper roll or which is the same quality of.
- Do not print when it's out of paper, which will seriously damage the print head and rubber roller.
- Do not let water or conducting material (eg. Metal) into the printer, please turn off the power immediately if happened.
- Please make sure to charge the battery for 60% or above and then remove the battery from the printer and store separately if the printer will not be used for a long period of time.
- Please keep this manual for your reference.

### Main Features:

- Streamlined structure.
- Drop in paper loading, easy operation.
- Support thermal paper width 58mm, diameter 50mm, thickness 0.06~0.08mm.
- Rechargeable lithium battery: 1800mAh~1900mAh/7.4V, long cycle life.
- Power adapter: 9V-1A, AC100-240V.
- Use supplied battery and power adapter, charge time will be 2.5~3.5h.
- Low-power mechanism.
- Automatic sleep mode function.
- Two kinds of Interface optional: USB+Bluetooth (standard), USB+WIFI (optional)
- USB+Bluetooth: BT3.0 and BLE4.0, support Android and iOS system.
- USB+WIFI: AP/STA/AP+STA mode to set up the networks.
- Support USB virtual COM port for developing and testing by developer.
- Compatible with ESC/POS printing commands, support NV logo download printing, various 1D bar code and QR code.
- Low power consumption, good print quality, 50km mechanism lifespan.
- Support GB18030 Simplified Chinese, Big5 traditional Chinese, Korean, international character set and extended code pages.
- LED indicator (standard), LCD display(optional)
- LED can be showed abnormal condition of the printer, battery capacity status, charging and connection status ect.
- LCD can be showed the printer work status more directly.
- Freely offer DLL, SDK, Demo for developing.

### Unpacking

After unpacking the unit, please check that all the necessary accessories are included in the package.

User's manual	1 pcs
Printer	1 pcs
Lithium battery	1 pcs
USB cable	1 pcs
Power adapter	1 pcs

### Technique Spec

Printing	Print method	Direct thermal line
	Print width	48mm
	Dot density	384dot/line
	Print speed	60mm/s (max)
	Interface	USB+Bluetooth3.0/BLE4.0 (Standard) USB+WIFI (Optional)
	Paper width	58mm
	Paper diameter	50mm (max)
	Paper thickness	0.06~0.08mm
Barcode	Print commands	Compatible with ESC/POS
	Fonts	GB18030, Big5, Korean
	Character size	ANK Font: Font A: 12*24dots Font B: 9*17dots Simplified/Traditional Chinese Character, Korean: 24*24dots
Buffer	Barcode	UPC-A/UPC-E/EAN(JAN)13/EAN(JAN)8/ CODE39/CODABAR/ITF/CODE93/ CODE128/QR code
	Data	4K bytes
Physical Properties	NV Flash	60K bytes
	Dimension	148.5*86*58.5mm
Power	Weight (including battery)	288g
	Power adapter	Input: AC100-220V output: DC 9V/1A
Environment	Lithium battery	1800mAh~1900mAh/7.4V
	Charge period	2.5h-3.5h
Reliability	Work Environment	Temperature: 5~45°C, Humidity: 10~80%
	Storage Environment	Temperature: -10~50°C, Humidity: 10~90%
	Mechanism	50km

## Printer parts:

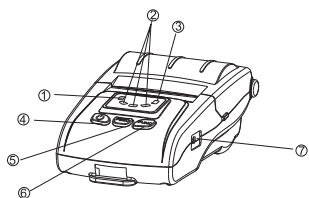

1. Error indicator (red)
2. Battery status indicator (Green)
3. Status indicator (Blue)
4. Power button
5. Feed button

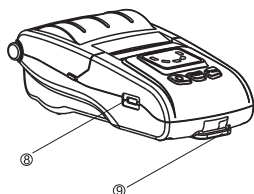

6. Function key button
7. Power port
8. USB port
9. Hook

## Battery Installation

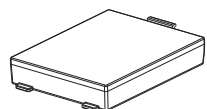

1. Specified battery.

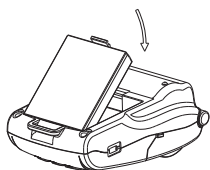

2. Install the battery as the picture showing direction.

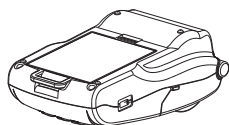

3. Push the battery into the slot until you hear it snap in place.

Note: The printer can not be printed without using battery.

## Paper Roll Installation

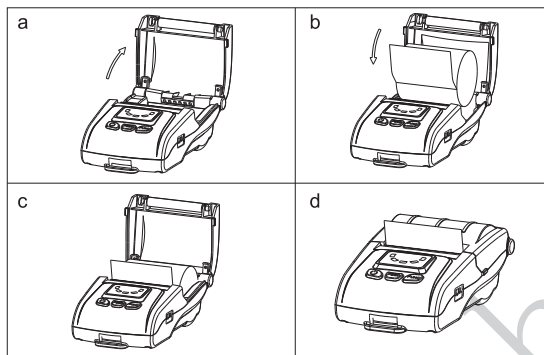

- a. Open the top cover as shown in the picture.
- b. Install the paper roll correctly as shown in the picture.
- c. Pull the leading edge 5mm of the paper outside the slot.
- d. Close the top cover.

## Battery Charging

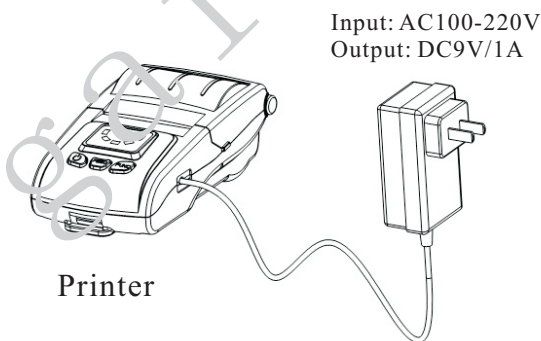

### Printer

1. Turn off the printer power.
2. Plug the supplied power adapter into the printer's power input socket properly, and then connect AC power.
3. Turn on the printer power and then it starts to charge.

NOTE: Charge the battery must be in the state of power-on.

## Indicators, Beeper and Buttons:

ERROR indicator (Red)	Battery status indicator (Green)	STATUS indicator (Blue)	Beeper	Status
OFF	OFF	OFF	No	Printer power off.
Blinking	ON	OFF	Yes	Printer power on, but out of paper.
OFF	ON	OFF	No	Printer is powered on and in normal print mode.
OFF	ON	ON	No	Bluetooth/WiFi connected.
Long press the power button for 3 seconds.				Printer power ON/OFF.
Press the POWER button and FUNC button simultaneously, wait for the green lights light in turn, then release the POWER button firstly. the red light and blue light lights up in turn, after the blue light dims, release the FUNC button; red light dims, the printer motor will vibrate.				Factory data reset
To feed paper manually, press the FEED button.				Paper feed
Press the FEED button and the POWER button simultaneously, wait for all the lights are bright, then release the POWER button firstly, wait for STATUS indicator (blue light) dims, then release the FEED button.				Print Self-test page
Press the FEED button and the POWER button simultaneously, wait for all the lights are bright, then release the POWER button firstly; after the blue light and red light dims in turn, then release the FEED button, meanwhile the printer prints out "Hexadecimal Dump" page, then printer is changed to Dump mode.				Hexadecimal Dumping
Turn on the printer, press the function button.				Interface information