

# PLAYSONIC

## Refrigerator USER'S MANUAL

PSF105W

This product was supplied by Shomar Ltd Dublin. If you have a questions regarding your appliances please contact us on 01- 4505327 or visit our website.[www.shomar.ie](http://www.shomar.ie)

To register and extend your warranty please go to [www.playsonic.ie](http://www.playsonic.ie)

**Dear customer:**

Thank you for buying this upright freezer. To ensure that you get the best results from your new freezer, please take time to read through the simple instructions in this booklet.

Please ensure that the packing material is disposed of in accordance with the current environmental requirements.

When disposing of any Freezer equipment please contact your local waste disposal department for advice on safe disposal.

This appliance must be only used for its intended purpose.

**CAUTION :**

The appliance is not intended for use by young children or infirm persons without supervision.

Young children should be supervised to ensure that they do not play with the appliance

**General**

This type of refrigerator is widely used in places such as hotels ,offices, student dormitories and houses. It is mostly suitable for refrigerating and preserving foods such as fruits and beverage. It enjoys the advantages of small size, Lightweight, Low electric consumption and easy use.

## Chief Technical Data

Item \ Model	PSF105W
Type of Preventing From Electric Shock	I
Refrigerant (g)	<b>R600a,35g</b>
Total Storage Volume(L)	<b>83</b>
Rated Voltage(V)	<b>220-240~</b>
Rated Frequency(Hz)	<b>50</b>
Energy(kWh/24h)	<b>0.47</b>
Weight (kg)	<b>33.5</b>

## Main configuration:

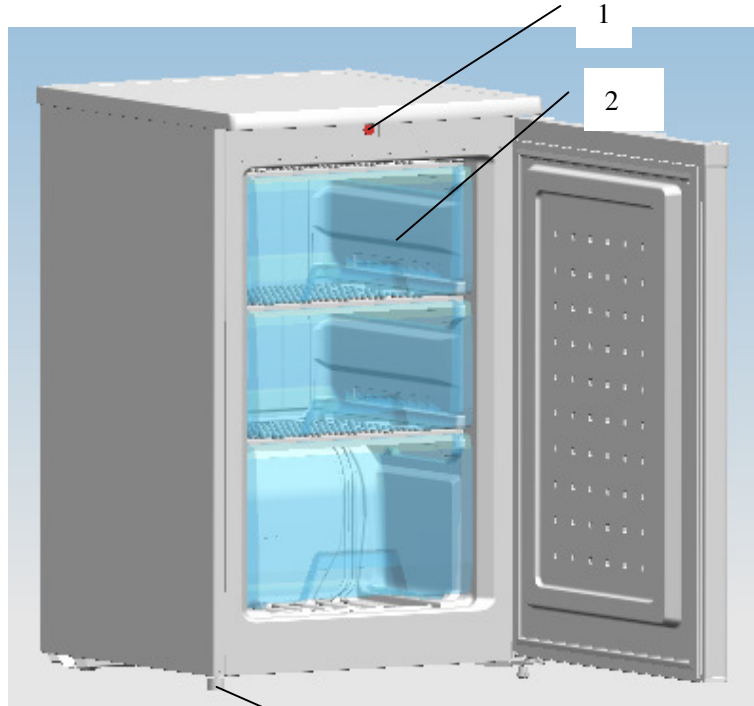

1、Thermostat

3

2、Drawer

3、Leveler leg

## **UNPACKING YOUR FREEZER**

**WARNING: Use two or more people to move Freezer.**

**Failure to do so can result in back or other injury.**

- Remove tape and any labels from your Freezer before using(except the rating label).
- To remove any remaining tape or glue, rub the area briskly with your thumb.
- Tape or glue residue can also be easily removed by rubbing a small amount of liquid dish soap over the adhesive with your fingers. Wipe with warm water and dry.
- Do not use sharp instruments, rubbing alcohol, flammable fluids, or abrasive cleaners to remove tape or glue. These products can damage the surface of your Freezer.
- When moving the Freezer, do not tilt the Freezer beyond 45°from upright position.

### **CLEANING BEFORE USE:**

After you remove all of the packaging materials, (especially the foam between outside condenser and cabinet should be removed) clean the inside of your Freezer before using it.

### **SPACE REQUIREMENTS**

**WARNING: Keep flammable materials and vapors, such as gasoline, away form Freezer.**

**Failure to do so can result in death, explosion, fire or burns.**

- To ensure proper ventilation for your Freezer, allow for 200mm space on each side between walls, 200mm space between back of your Freezer and the wall, and 300mm

space between counter top and the roof or ceiling.

- If you are installing your Freezer next to a fixed wall, leave sufficient space on the hinge side to allow for the door to swing open.
- Never install your Freezer near heat source and direct sun shins.

### **ELECTRICAL REQUIREMENT**

**WARNING: DO NOT REMOVE GROUND PRONG.**

**DO NOT USE AN ADAPTOR.**

**DO NOT USE EXTENSION CORD.**

Failure to follow these instructions can result in death, fire or electrical shock.

Before you move your Freezer into its final location, it is important to make sure you have the proper electrical connection.

#### **Recommended Earthing Method**

A 220~240 Volt /50 Hz AC only 10 ampere fused and properly earthed electrical supply is required. It is recommended that a separate circuit serving only this appliance be provided. Use a receptacle which cannot be turned off with a switch or pull chain. Do not use an extension cord.

**NOTE:** Before performing any type of installation, disconnect the Freezer from the electrical source. When you are finished, connect the Freezer to the electrical source and reset the control to the desired setting.

## LEVELING

If the Freezer is not leveled during installation. The doors may not close or seal properly, causing cooling, frost, or moisture problems. It is very important of the Freezer to be level in order to function properly.

To level your Freezer you may either turn the level leg clockwise to raise that side to the Freezer or turn counter – clockwise to lower that side.

**NOTE:** Having someone push against the top of the Freezer take some weight off the leveling leg. This makes it easier to adjust the leveling leg.

## USE OF THE APPLIANCE

To obtain the best possible results form your Freezer, it is important that you operate it properly.

### Temperature Control

The temperature in the freezer is controlled by the thermostat control knob. It is located in the top-front of the freezer. Turn the thermostat control knob up or down to regulate the temperature inside the freezer. The markings on control knob indicated the “1~4” for the different temperature grades. The temperature decreases with position “1” being the warmest and position “4” being the coldest. the marking “black point” means the freezer stop working。

Set the control to position between “1” and “4” for normal use, the exact position is beyond the temperature in the freezer, generally , choose the number “2”。

## Store Frozen Food

When using the freezer for the first time or after defrosting, turn the temperature control to set “4” for at least two hours before introducing the food to be stored.

All frozen food products you purchase should be placed in the freezer as soon as possible to avoid the frozen food from defrosting.

Storage recommendation printed on the packaging of frozen food by the manufacturers should be always be followed.

Be careful that the drawer mustn't mangle the refrigeration pipeline

## Freezing Fresh Food

Ensure that your freezing operations are carried out under the most hygienic conditions as freezing alone does not sterilize the food. It is advisable to freeze the food by packing it into separate meal portions and not in bulk form. Never put hot or even warm foodstuffs into the freezer. Prior to storing the frozen food, pack it in plastic bags, aluminum sheets or freezing containers and place into the freezer. See the data sheet at the rear of this booklet for the maximum permissible amount in kilograms of fresh food that can be frozen in any 24 hour period with a room temperature of 25°. Never freeze more than the maximum permissible.

**Note:** Never put bottled food or drinks in the freezer compartment.



.For best performance, leave enough space in the Freezer compartment for air to circulate around the packages.

Notice: You can use it without drawer under some conditions.

### **Defrosting**

Remove the mains plug from the wall socket, open the door and remove all the food to a cool place. Defrost using a plastic scraper, or let the temperature rise naturally until the frost melts. Then wipe away the remaining ice and water, after this plug the freezer back into the mains supply.

**Note:** To avoid damaging the freezing compartment wall, do not use any sharp objects to remove the frost or separate the frozen food.

## **Cleaning your freezer**

Before you start to clean your freezer remove the mains plug from the power supply.

Use a clean sponge or soft and a mild detergent in warm water.

Do not use abrasive or harsh cleaners.

Hand wash, rinse and dry all surfaces thoroughly.

Do not use cleaning waxes, concentrated detergents, bleaches or cleaners containing petroleum on plastics and rubber parts.

Never use paper towels, window sprays, scouring cleansers or flammable fluids on plastic parts as these can scratch or damage material.

Clean with a cloth soaked in this solution and then dry with a soft cloth.

## PROLONGED OFF PERIODS

If the freezer is not in use for a long period of time, proceed as follows:

Disconnect the freezer from the main supply by removing the plug from the wall socket.

Clean and dry the inside as instructed under the heading of cleaning the Freezer.

Leave the door open to prevent any unpleasant smells from building up while the freezer is not in use.

## TROUBLESHOOTING

In case of malfunction, you can solve many common problems easily.

**Your Freezer will not operate...**Check if

- The power supply cord is unplugged.

**The doors will not close completely...**Check if

- The drawers are out of position.
- The gaskets are dirty.
- The Freezer is not level.

**The freezer is noisy when running...**Check if

- Check the freezer is level and it is not in contact with another appliance or kitchen furniture.

**The freezer does not cool sufficiently...**Check if

- If the door has been opened too often, or it has been left open for a while it will take time for the freezer to reach its set temperature.
- Check the airflow the rear of the freezer has not been

reduced due to insufficient clearance.

**The following characteristics should not be looked upon as a problem.**

- A gentle tricking sound caused by coolant flowing the pipe.
- Compressor operating at high temperature.

## WARNING

### REQUESTING ASSISTANCE OR SERVICE

If the problem is not due to one of the items listed in Troubleshooting, Contact the dealer or authorized Service Company.



Caution: risk of fire

### RECOMMENDATIONS

- 1) **WARNING** – Keep ventilation openings, in the appliance enclosure or in the built-in structure, clear of obstruction.

- 2) WARNING – Do not use mechanical devices or other means to accelerate the defrosting process, other than those recommended by the manufacturer.
- 3) WARNING – Do not damage the refrigerant circuit.
- 4) WARNING – Do not use electrical appliances inside the food storage compartments of the appliance, unless they are of the type recommended by the manufacturer.
- 5) The appliance has to be unplugged after use and before carrying out user maintenance on the appliance.
- 6) This appliance is not intended for use by persons (including children) with reduced physical, sensory or mental capabilities, or lack of experience and knowledge, unless they have been given supervision or instruction concerning use of the appliance by a person responsible for their safety.
- 7) Children should be supervised to ensure that they do not play with the appliance.
- 8) If the supply cord is damaged, it must be replaced by the manufacturer, its service agent or similarly qualified persons in order to avoid a hazard.
- 9) Please abandon the refrigerator according to local regulators for it use flammable blowing gas and refrigerant.
- 10) Please according to local regulations regarding disposal of

the appliance for its flammable refrigerant and blowing gas. Before you scrap the appliance, please take off the doors to prevent children trapped.



**Correct Disposal of this product**

This marking indicates that this product should not be disposed with other household wastes throughout the EU. To prevent possible harm to the environment or human health from uncontrolled waste disposal, recycle it responsibly to promote the sustainable reuse of material resources. To return your used device, please use the return and collection systems or contact the retailer where the product was purchased. They can take this product for environmental safe recycling.

**Name Of Company:** Shomar Ltd

**Address:** Shomar Ltd, Unit 9 Western Industrial Estate, Dublin 12, Ireland.

**Telephone:** 01 450 9150

**Fax:** 01 450 9606

**Email:** info@shomar.ie

## Refrigerator door install guidelines about swapping left&right

- 1、 Disassemble the screws behind the fixed roof with cross-slot screwdriver and remove the cover from the refrigerator.

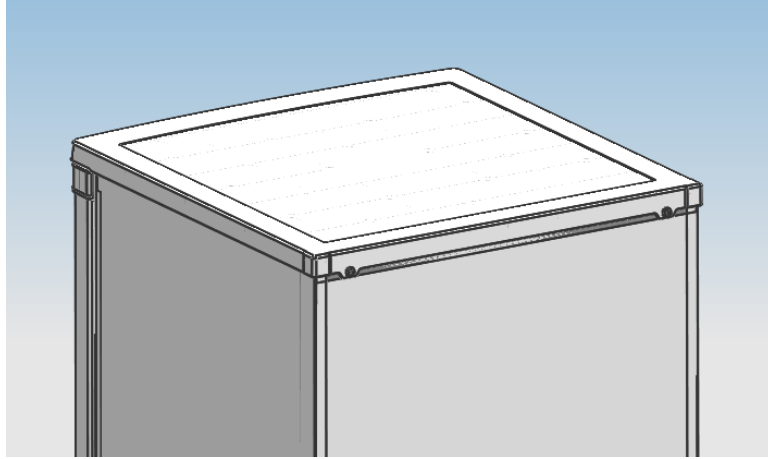

The two  
screws  
the cover

- 2、 Remove the screws fixed the top-hinge with cross-slot screwdriver.

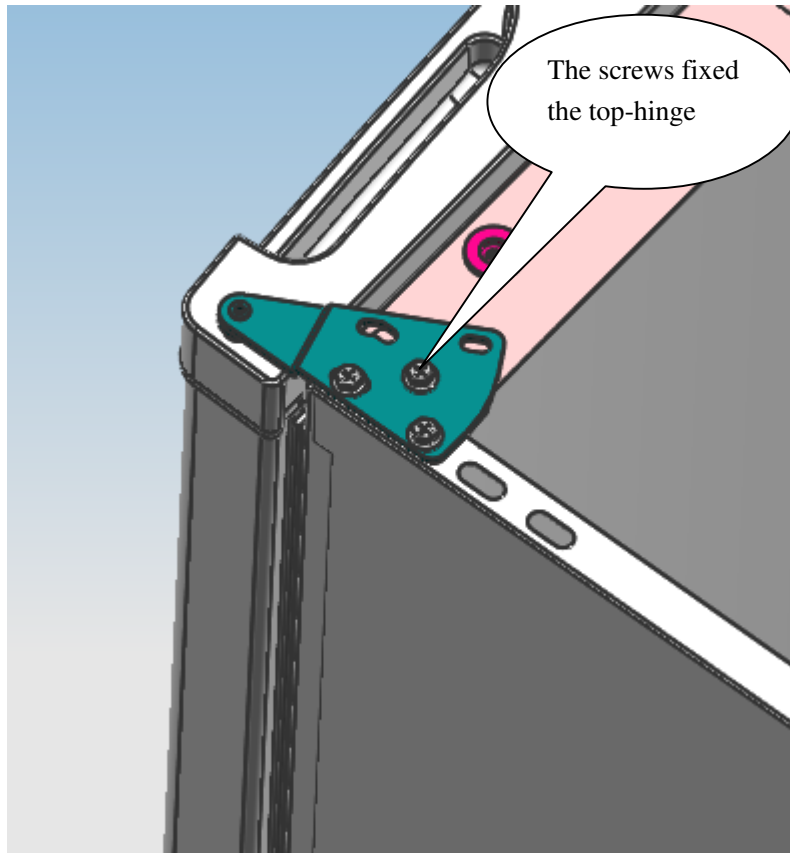

3、 Replace the top-hinge and the door limit block and the door bearing bush to the other side

A、 replace the top-hinge.

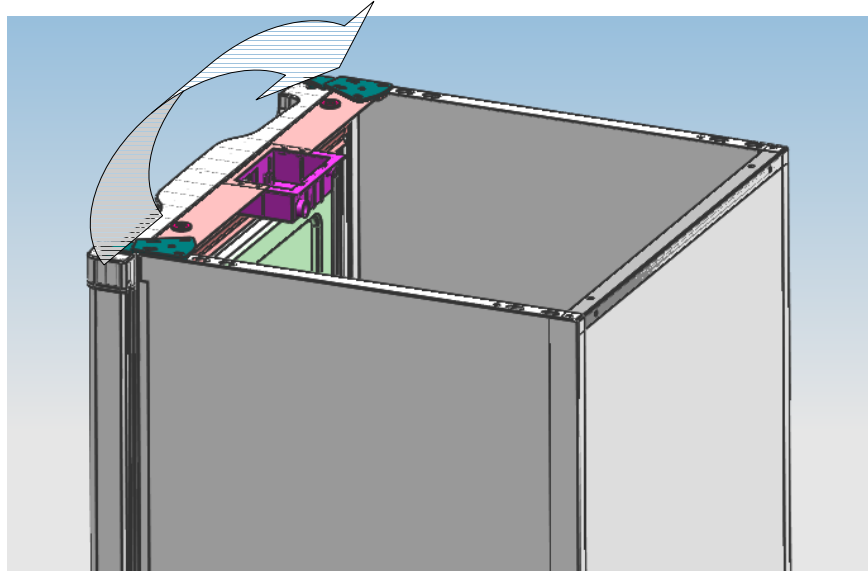



B、 replace the door bearing bush and the limit block.

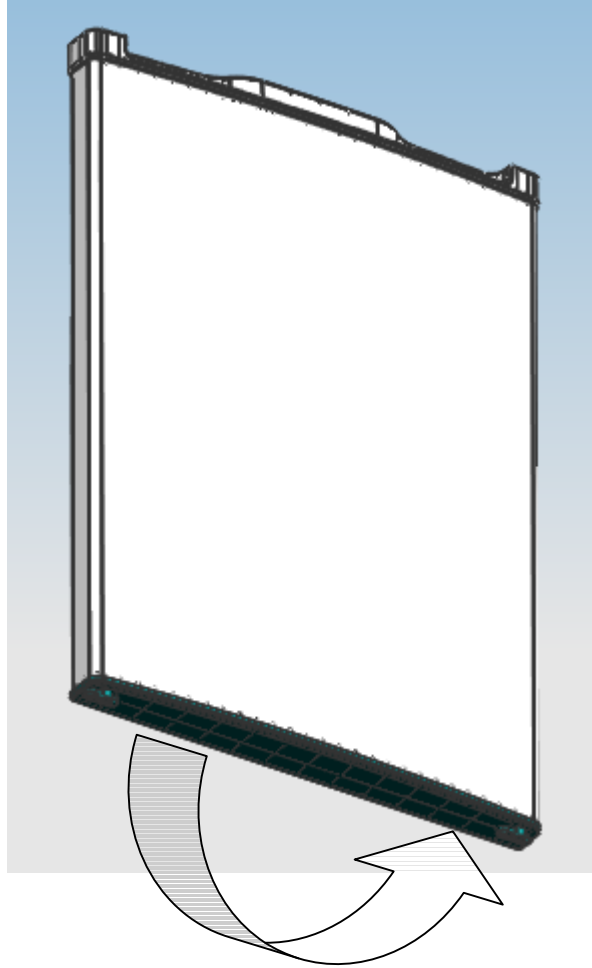

- 4、 Disassemble the screws fixed the bottom-hinge with cross-slot screwdriver and replace the hinge to the other side then fix it with screws。

note: the refrigerator incline angle less  $45^{\circ}$  .

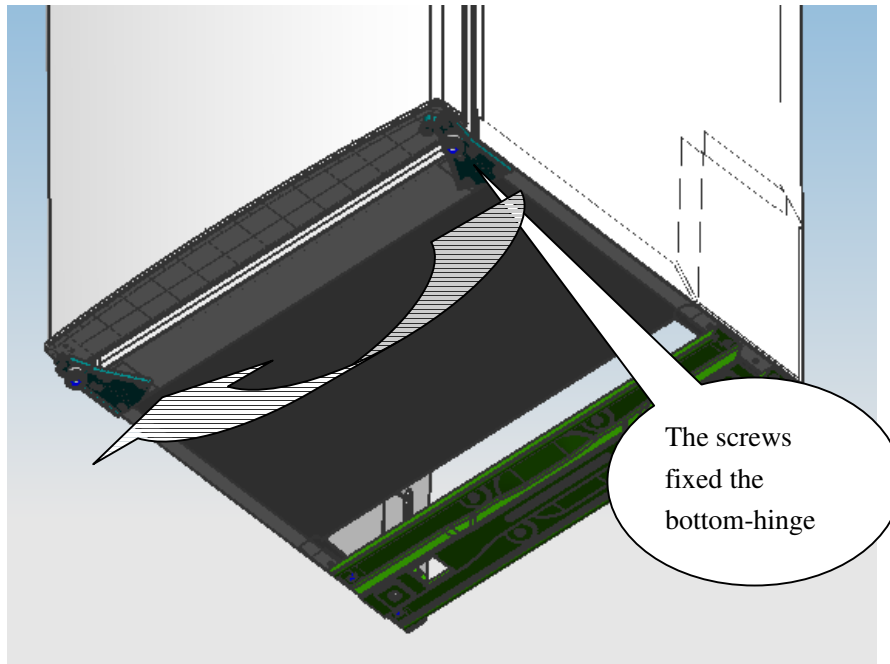

5、 replace the leveler to the other side and adjust it to make sure the cabinet level

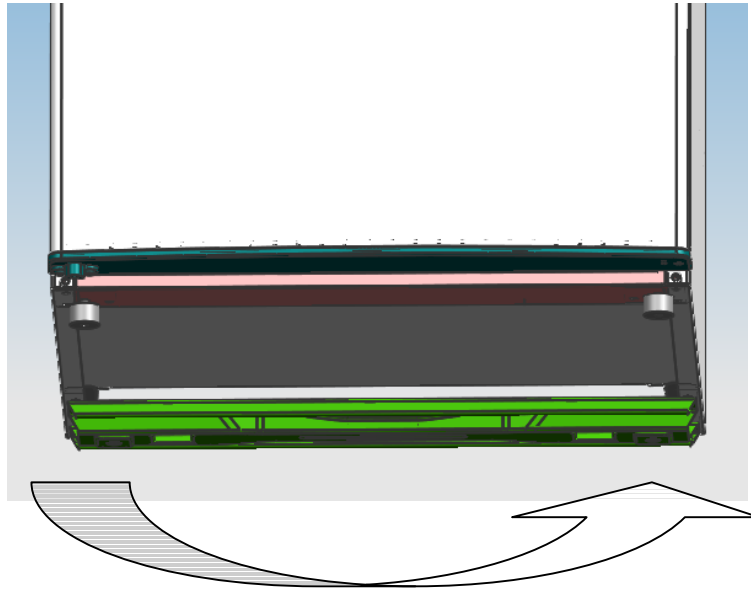

6、 Set the door right position,fix the top-hinge and then the roof cover.

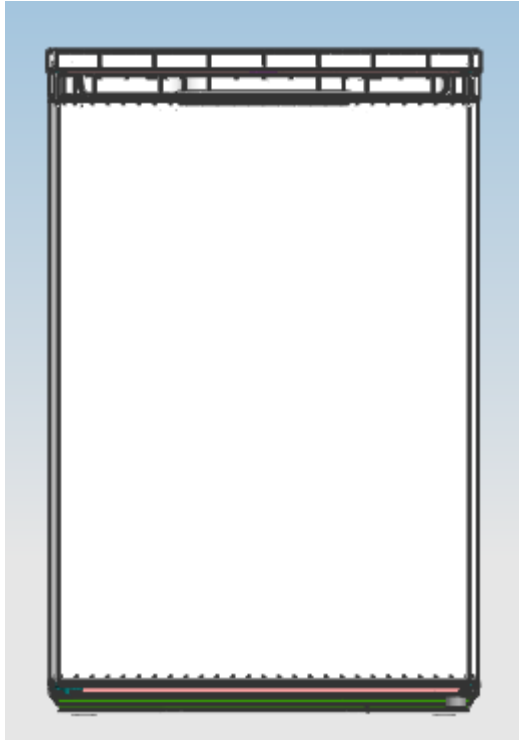

Ensure the Appliance is unplugged and empty。  
Adjust the two leveling feet to their highest position。  
We recommend you have someone to assist you。

**NOTE:**

To take the door off it is necessary to tilt the Appliance backward。

You should rest the Appliance on something solid e.g.a chair just below the top panel.

Do not lay the Appliance completely flat as this may damage the coolant system.