

# FM/AM Digital Radio

Operating Instructions

XDR-S10HDiP



©2008 Sony Corporation Printed in China

<http://www.sony.net/>

## Owner's Record

The model number and the serial number are located on the bottom.  
Record the serial number in the space provided below. Refer to them whenever you call upon your Sony dealer regarding this product.  
Model No. XDR-S10HDiP  
Serial No. \_\_\_\_\_

For customers who purchased this product in the USA  
Please register this product on line at <http://www.sony.com/productregistration>.  
Proper registration will enable us to send you periodic mailings about new products, services, and other important announcements. Registering your product will also allow us to contact you in the unlikely event that the product needs adjustment or modification. Thank you.

**To reduce the risk of fire or electric shock, do not expose this apparatus to rain or moisture.**

To reduce the risk of fire, do not cover the ventilation opening of the apparatus with newspapers, tablecloths, curtains, etc. Do not place the naked flame sources such as lighted candles on the apparatus.

To reduce the risk of fire or electric shock, do not expose this apparatus to dripping or splashing, and do not place objects filled with liquids, such as vases, on the apparatus.

Do not install the appliance in a confined space, such as a bookcase or built-in cabinet.

Do not expose the batteries (battery pack or batteries installed) to excessive heat such as sunshine, fire or the like for a long time.

As the main plug is used to disconnect the unit from the mains, connect the unit to an easily accessible AC outlet. Should you notice an abnormality in the unit, disconnect the main plug from the AC outlet immediately.

You are cautioned that any changes or modifications not expressly approved in this manual could void your authority to operate this equipment.

These following indications are located on the bottom exterior of the power supply unit.



This symbol is intended to alert the user to the presence of uninsulated "dangerous voltage" within the product's enclosure that may be of sufficient magnitude to constitute a risk of electric shock to persons.

This symbol is intended to alert the user to the presence of important operating and maintenance (servicing) instructions in the literature accompanying the appliance.

- 1) Read these instructions.
- 2) Keep these instructions.
- 3) Heed all warnings.
- 4) Follow all instructions.
- 5) Do not use this apparatus near water.
- 6) Clean only with dry cloth.
- 7) Do not block any ventilation openings. Install in accordance with the manufacturer's instructions.
- 8) Do not install near any heat sources such as radiators, heat registers, stoves, or other apparatus (including amplifiers) that produce heat.
- 9) Do not defeat the safety purpose of the polarized or grounding-type plug. A polarized plug has two blades with one wider than the other. A grounding type plug has two blades and a third grounding prong. The wide blade or the third prong are provided for your safety. If the provided plug does not fit into your outlet, consult an electrician for replacement of the obsolete outlet.
- 10) Protect the power cord from being walked on or pinched particularly at plugs, convenience receptacles, and the point where they exit from the apparatus.
- 11) Only use attachments/accessories specified by the manufacturer.
- 12) Use only with the cart, stand, tripod, bracket, or table specified by the manufacturer, or sold with the apparatus. When a cart is used, use caution when moving the cart/apparatus combination to avoid injury from tip-over.



- 13) Unplug this apparatus during lightning storms or when unused for long periods of time.
- 14) Refer all servicing to qualified service personnel. Servicing is required when the apparatus has been damaged in any way, such as power-supply cord or plug is damaged, liquid has been spilled or objects have fallen into the apparatus, the apparatus has been exposed to rain or moisture, does not operate normally, or has been dropped.

HD Radio™ Technology Manufactured Under License From iBiquity Digital Corp. U.S. and Foreign Patents. HD Radio™ and the HD Radio logo are proprietary trademarks of iBiquity Digital Corp.

## INFORMATION

This equipment has been tested and found to comply with the limits for a Class B digital device, pursuant to Part 15 of the FCC Rules. These limits are designed to provide reasonable protection against harmful interference in a residential installation. This equipment generates, uses and can radiate radio frequency energy and, if not installed and used in accordance with the instructions, may cause harmful interference to radio communications. However, there is no guarantee that interference will not occur in a particular installation. If this equipment does cause harmful interference to radio or television reception, which can be determined by turning the equipment off and on, the user is encouraged to try to correct the interference by one or more of the following measures:

- Reorient or relocate the receiving antenna.
- Increase the separation between the equipment and receiver.
- Connect the equipment into an outlet on a circuit different from that to which the receiver is connected.
- Consult the dealer or an experienced radio/TV technician for help.

## What is HD Radio™ Technology?

HD Radio Broadcasting was approved by the Federal Communications Commission in October 2002 as the system for digital AM and FM broadcasting in the U.S.

- HD Radio technology features include:
- Static-free, clear radio reception.
  - FM Multicasting – the ability to broadcast multiple program streams over a single FM frequency.
  - A variety of "data services," including text-based information – artist name, song title, etc. scrolled across your receiver display.
  - Digital broadcasts in the same frequencies as analog broadcasts; listeners do not need to learn a new station number and today's stations remain at their current place on the dial.

HD Radio technology is developed and licensed by iBiquity Digital Corporation and supported by the leaders of the broadcasting, consumer electronics and automotive industries.

**SONY**

Portable Audio

## LIMITED WARRANTY (U.S. Only)

Sony Electronics Inc. ("Sony") warrants this product against defects in material or workmanship for the time periods and as set forth below. Pursuant to this Limited Warranty, Sony will, at its option, (i) repair the product using new or refurbished parts or (ii) replace the product with a new or refurbished product. For purposes of this Limited Warranty, "refurbished" means a product or portions that has been returned to its original specifications. In the event of a defect, these are your exclusive remedies.

**Labor:** For a period of one (1) year from the original date of purchase of the product ("Labor Warranty"), Sony will, at its option, repair or replace with new or refurbished product, product determined to be defective. If Sony elects to replace the product after this Labor Warranty has expired but while the Parts Warranty below is still in effect, it will do so for the applicable labor charge.

**Parts:** For a period of one (1) year from the original date of purchase of product ("Parts Warranty"), Sony will supply new or refurbished replacement parts in exchange for parts determined to be defective.

This Limited Warranty covers only the hardware components packaged with the Product. It does not cover technical assistance for hardware or software usage and it does not cover any software products whether or not contained in the Product; any such software is provided "AS IS" unless expressly provided for in any enclosed software Limited Warranty. Please refer to the End User License Agreements included with the Product for your rights and obligations with respect to the software.

**Instructions:** To obtain warranty service, you must deliver the product, freight prepaid, in either its original packaging or packaging affording an equal degree of protection to the Sony authorized service facility specified. It is your responsibility to backup any data, software or other materials you may have stored or preserved on your unit. It is likely that such data, software, or other materials will be lost or reformatted during service and Sony will not be responsible for any such damage or loss. A dated purchase receipt is required. For specific instructions on how to obtain warranty service for your product,

Visit Sony's Web Site:  
[www.sony.com/service](http://www.sony.com/service)

Or call the Sony Customer Information Service Center  
1-800-222-SONY (7669)

For an accessory or part not available from your authorized dealer, call:

1-800-488-SONY (7669)

**Repair / Replacement Warranty:** This Limited Warranty shall apply to any repair, replacement part or replacement product for the remainder of the original Limited Warranty period or for ninety (90) days, whichever is longer. Any parts or product replaced under this Limited Warranty will become the property of Sony.

This Limited Warranty only covers product issues caused by defects in material or workmanship during ordinary consumer use; it does not cover product issues caused by any other reason, including but not limited to product issues due to commercial use, acts of God, misuse, limitations of technology, or modification of or to any part of the Sony product. This Limited Warranty does not cover Sony products sold AS IS or WITH ALL FAULTS or consumables (such as fuses or batteries). This Limited Warranty is invalid if the factory-applied serial number has been altered or removed from the product. This Limited Warranty is valid only in the United States.

**LIMITATION ON DAMAGES:** SONY SHALL NOT BE LIABLE FOR ANY INCIDENTAL OR CONSEQUENTIAL DAMAGES FOR BREACH OF ANY EXPRESS OR IMPLIED WARRANTY ON THIS PRODUCT.

**DURATION OF IMPLIED WARRANTIES:** EXCEPT TO THE EXTENT PROHIBITED BY APPLICABLE LAW, ANY IMPLIED WARRANTY OF MERCHANTABILITY OR FITNESS FOR A PARTICULAR PURPOSE ON THIS PRODUCT IS LIMITED IN DURATION TO THE DURATION OF THIS WARRANTY.

Some states do not allow the exclusion or limitation of incidental or consequential damages, or allow limitations on how long an implied warranty lasts, so the above limitations or exclusions may not apply to you. This Limited Warranty gives you specific legal rights and you may have other rights which vary from state to state.

## What is iTunes Tagging?

The iTunes Tag button on the new XDR-S10HDiP allows you to tag songs you like that are broadcast by HD Radio stations. Information about these tagged songs is stored by the receiver and transferred to your iPod. When you connect your iPod to your computer, iTunes automatically presents the songs in a new Tagged playlist so you can preview, buy, and download them. iTunes Tagging is a great way to discover new music add it to your collection!

## Features

- FM/AM Digital Radio with HD Radio technology and iPod / iPhone compatibility
- iTunes Tagging capability, enabling the user to save song information with the touch of a button while listening to an HD Radio station.
- Large LCD displays HD Radio information
- Stereo speakers with surround sound function
- Fully adjustable tone control for fine tuning of bass and treble
- Supplied remote commander

## Precautions

- Play the unit on the power source specified in "Specifications".
- To disconnect the AC power cord (mains lead), pull it out by the plug, not the cord.
- The unit is not disconnected from the mains as long as it is connected to the AC outlet, even if the unit itself has been turned off.
- The dating code and the nameplate are located on the bottom exterior of the unit.
- Since a strong magnet is used for the speaker, keep personal credit cards using magnetic coding or spring-wound watches away from the unit to prevent possible damage from the magnet.
- Do not leave the unit in a location near a heat source such as a radiator or airtight, or in a place subject to direct sunlight, excessive dust, mechanical vibration, or shock.
- Allow adequate air circulation to prevent internal heat build-up. Do not place the unit on a surface (a rug, a blanket, etc.) or near materials (a curtain) which might block the ventilation holes.
- Should any solid object or liquid fall into the unit, unplug the unit and have it checked by a qualified personnel before operating it any further.
- To clean the casing, use a soft cloth dampened with a mild detergent solution.
- Never touch the wire of the external FM antenna during a thunderstorm. Furthermore, immediately disconnect the AC power cord from the radio.

If you have any questions or problems concerning your unit, please consult your nearest Sony dealer.

## Troubleshooting

Should any problem persist after you have made the following checks, consult your nearest Sony dealer.

### A broadcast is received in analog only, even though the area is within HD Radio reception.

- Depending on the conditions, if the incoming signal strength is too weak or unstable, the HD indicator will not flash or light up. In that case, the HD Radio broadcast will be received as an analog signal.

### The radio or iPod alarm is activated but no sound comes on at the preset alarm time.

- Has **VOLUME** been adjusted?

### There is no sound from the iPod.

- Make sure the iPod is securely connected.
- Adjust the **VOLUME**.

### The iPod cannot be operated with this unit.

- Make sure the iPod is securely connected.

### The iPod cannot be charged.

- Make sure the iPod is securely connected.

### "CANNOT DETECT" appears in the display when connecting an iPod.

- Disconnect the iPod once and then reconnect it securely.

## Specifications

### Time display

12-hour system

### Frequency range

Band	Frequency	Channel step
FM	87.5 – 108 MHz	0.1 MHz
AM	530 – 1 710 kHz	10 kHz

### Speaker

Approx. 6.6 cm (2 5/8 inches) dia. 8 Ω

### Input

AUDIO IN jack (ø 3.5 mm stereo minijack)

### Antenna terminal

75 Ω antenna terminal for FM

Antenna terminal for AM

### Audio power specifications

POWER OUTPUT AND TOTAL HARMONIC DISTORTION

With 8-ohm loads, both channels driven from 150-10,000 kHz; rated 3W per channel-minimum RMS, with no more than 10% total harmonic distortion.

### Power output

4 W + 4 W (maximum power)

### Power requirements

120 V AC, 60 Hz

### Dimensions

Approx. 330 × 130 × 135 mm (w/h/d)  
(13 × 5 1/8 × 5 3/8 inches) not incl. projecting parts and controls

### Mass

Approx. 3.1 kg (6 lb 13.3 oz) incl. power supply unit

### Supplied accessories

- Remote commander (1)
- FM wire antenna (1)
- FM dipole antenna (1)
- AM loop antenna (1)
- Audio connecting cable (1)
- Universal dock adapter for iPhone (1)
- Connector cover (1)

Design and specifications are subject to change without notice.

## Compatible iPod models

The compatible iPod models are as follows. Update your iPod to use the latest software before you use it.

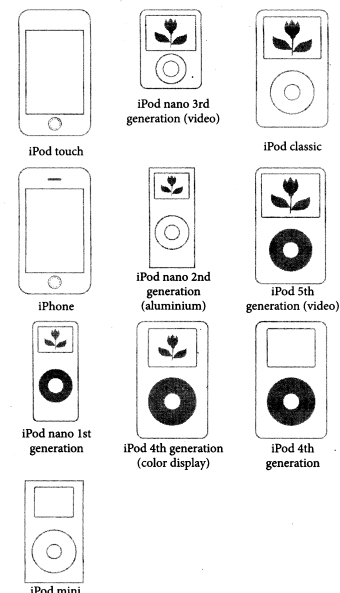

The iPod models that are compatible with iTunes Tagging are as follows:

- iPod nano 3<sup>rd</sup> generation
- iPod classic
- iPod 5<sup>th</sup> generation
- \* The models above may vary without notice. For the latest information, check the website of Apple Inc.

### Notes

- In these Operating Instructions, "iPod" is used as a general reference for the iPod functions on the iPod and iPhone, unless otherwise specified by the text or illustrations.
- iTunes Tagging requires iTunes 7.4 or later.

## Connecting the antenna

### To connect the AM loop antenna

The shape and the length of the antenna is designed to receive AM signals. Do not dismantle or roll up the antenna.

- 1 Remove only the loop part from the plastic stand.
- 2 Set up the AM loop antenna.

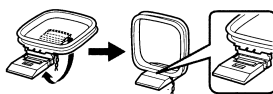

- 3 Connect the cords to the AM antenna terminals. Cord (A) or cord (B) can be connected to either terminal.

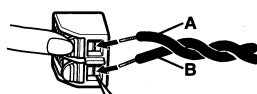

Insert the cord while pushing down the terminal clamp.  
Only insert up to here.

- 4 Make sure the AM loop antenna is connected firmly by pulling softly.

### Adjusting the AM loop antenna

Find a place and an orientation that provide good reception.

- Do not place the AM loop antenna near the unit or other AV equipment, as noise may result.

### Tip

Adjust the direction of the AM loop antenna for best AM broadcast sound.

### To connect the FM antenna

This unit comes supplied with an FM wire antenna and FM dipole antenna. Connect whichever antenna that provides the best reception to the FM antenna terminal.

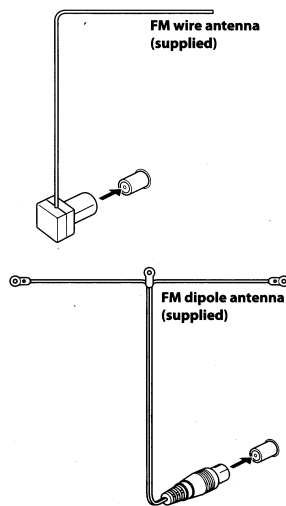

### Adjusting the FM wire antenna

Be sure to fully extend the FM wire antenna, and keep it as horizontal and vertical as possible.

### Adjusting the FM dipole antenna

Be sure to fully extend the FM dipole antenna. Align the antenna in the shape of a T and place in a high position on a wall away from this unit.

### Tip

If you have poor FM reception, use a 75 Ω coaxial cable (not supplied) to connect the unit to an outdoor FM antenna as shown below.

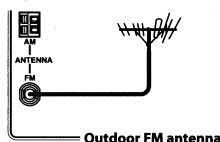

## Notes on radio reception

- Keep away digital music player or mobile phone from the AM loop antenna or the FM antenna, as this may lead to interference of reception.
- When you are listening to the radio with an iPhone connected to the unit, interference with radio reception may occur.
- When you are listening to the radio while charging an iPod, interference with radio reception may occur.

## Using the connector cover

To protect the connector of the unit from dust or dirt, you can put the connector cover on.

### Attaching the connector cover

Match both claws of the connector cover with the pits inside of the connector and press the other side down until it clicks.

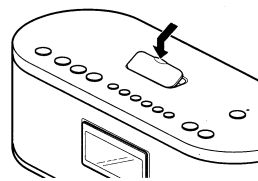

### Removing the connector cover

Pull up the tab of the connector cover using your finger.

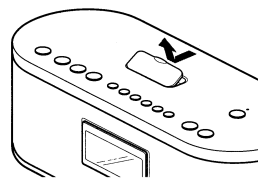

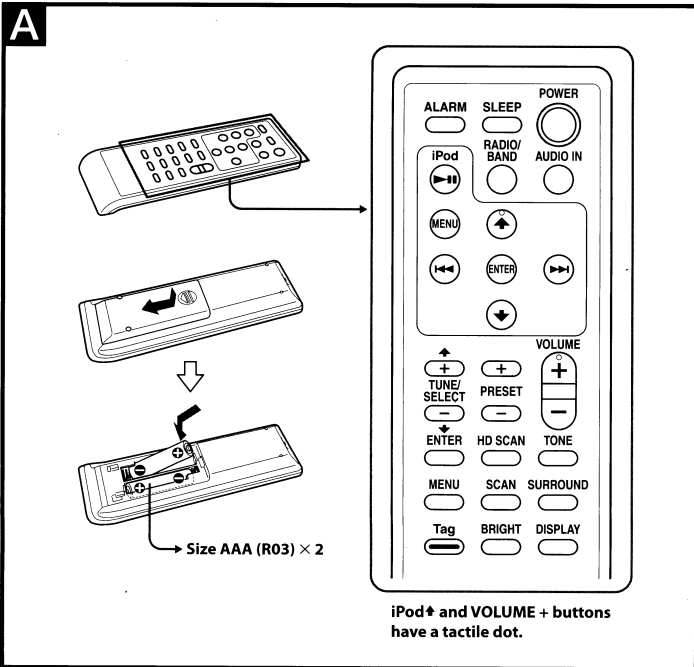

## Preparing the remote commander

### Installing the batteries into the remote commander (See Fig. A)

Insert two size AAA (R03) batteries (not supplied).

### When to replace the batteries

With normal use, the batteries should last for about six months. When the remote commander no longer operates the unit, replace all the batteries with new ones.

### Notes

- Do not charge dry batteries.
- When you are not going to use the remote commander for a long time, remove the batteries to avoid any damage caused by leakage and corrosion.

## Using the remote commander

Common buttons that appear on both the remote commander and the unit control the same functions.

### ALARM button

Press to set the alarm to "ON" or "OFF". Press and hold for 2 seconds to enter "ALARM TIME SET".

### TONE button

To set the tone directly.

### HD SCAN button

The selected band is scanned, and receivable HD Radio stations are played for 3 seconds in order of frequency.

### SCAN button

The selected band is scanned, and receivable radio stations are played for 3 seconds in order of frequency.

### BRIGHT button

To adjust the brightness of the display.

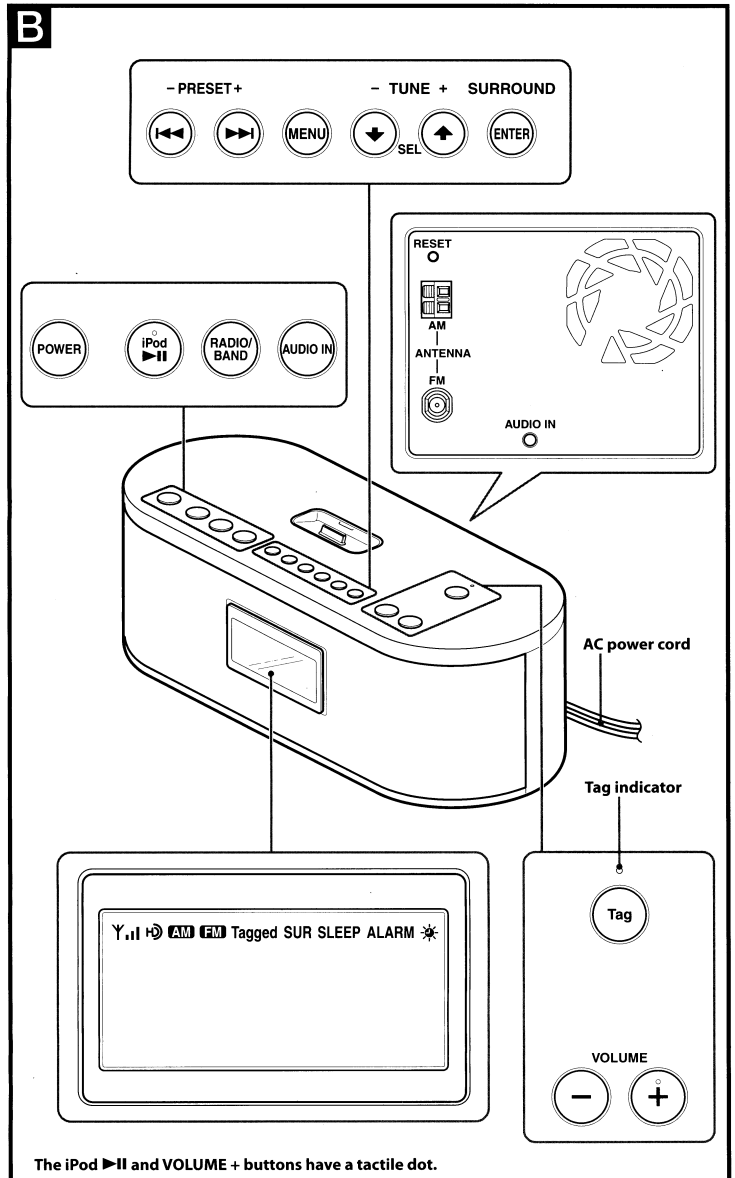

## Setting the clock

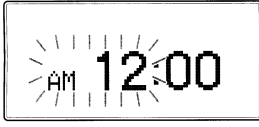
- 1 Plug in the unit.  
The display will flash "AM 12:00."
- 2 Press **MENU** to show the menu display.  

- 3 Press **SEL**  $\uparrow$  or  $\downarrow$  to select "TIME SET," then press **ENTER**.  
The hour will start to flash in the display.  

- 4 Press **SEL**  $\uparrow$  or  $\downarrow$  until current hour appears in the display, then press **ENTER**.  
The hour is set and the minutes start to flash.
- 5 Repeat step 4 to set the minute.

### Note

If you do not set the menu within 65 seconds, the setting mode is canceled.

## To change the display to the daylight saving time (summer time) indication

- 1 Press **MENU** to show the menu display.
- 2 Press **SEL**  $\uparrow$  or  $\downarrow$  to select "DST," then press **ENTER**.
- 3 Press **SEL**  $\uparrow$  or  $\downarrow$  to select "ON," then press **ENTER**.  
"\*" appears and the time indication changes to summer time.

To deactivate the DST function, select "OFF" in step 3.

## Playing the radio

### –Manual tuning

- 1 Press **RADIO/BAND** to turn on the radio and select the AM or FM band.
- 2 Press **TUNE +** or **-** to tune in to a desired frequency.
- 3 Adjust the volume using **VOLUME +** or **-**.

### –Preset tuning

You can preset 20 stations each for AM and FM.

#### Presetting a station

- 1 Follow steps 1 and 2 in “Manual tuning” to tune the frequency you wish to preset.
- 2 Press and hold **ENTER** for a few seconds. The display changes as follows:

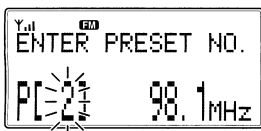

The next preset number from the most recent preset is displayed (but if the last preset number was 20, 20 is displayed).

- 3 Press **PRESET +** or **-** to select the preset number, then press **ENTER**. The frequency is stored with the selected preset number and you will hear a beep.

To preset another station, repeat these steps.

#### Note

If you try to store another station with the same preset number, the previously stored station will be replaced.

#### Tuning in to a station

- 1 Press **RADIO/BAND** to turn on the radio and select the AM or FM band.
- 2 Press **PRESET +** or **-** to select the desired preset number.
- 3 Adjust the volume using **VOLUME +** or **-**.

### –Scan tuning

The unit will automatically scan the selected band. In HD scan, HD Radio stations are scanned.

- 1 Press **RADIO/BAND** to turn on the radio and select the AM or FM band.
- 2 Press **MENU** to show the menu display.
- 3 Press **SEL ↑** or **↓** to select “SCAN” or “HD SCAN,” then press **ENTER**. Scanning of the selected band starts. When a station is received, scanning pauses for 3 seconds and then continues.
- 4 When the unit tunes in to the desired station, do any of the following operations to stop scanning.
  - Press **ENTER** on the unit or remote commander.
  - Press **SCAN** or **HD SCAN** on the remote commander.
- 5 If necessary, press **TUNE +** or **-** to tune in to the station more precisely.
- 6 Adjust the volume using **VOLUME +** or **-**.

#### Tip

You can scan for stations directly by pressing **SCAN** or **HD SCAN** on the remote commander.

## Changing the display mode and settings

### To change the display mode

Press **DISPLAY** on the remote commander. The display changes as follows:

#### When an analog radio station is received

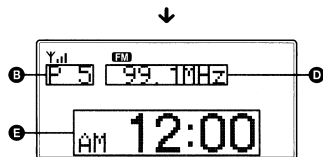
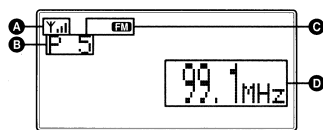

- A Field strength level indicator
- B Preset number\*
- C Band
- D Frequency
- E Current time

\* When you tune in a station by selecting a preset number.

#### When an analog FM broadcast that supports RBDS (Radio Broadcast Data System) is received

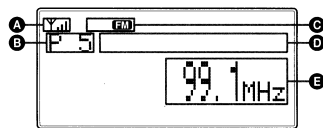

#### When text information is received

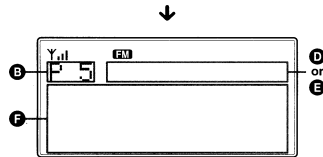
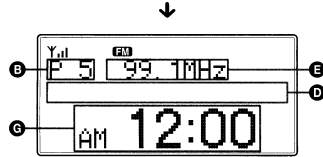
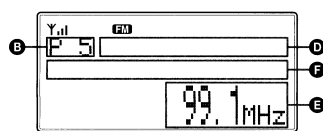

- A Field strength level indicator
- B Preset number\*
- C Band
- D Station name
- E Frequency
- F Text information
- G Current time

\* When you tune in a station by selecting a preset number.

#### Note

The display item differs depending on the content of a broadcast or the station.

#### When an HD Radio station is received

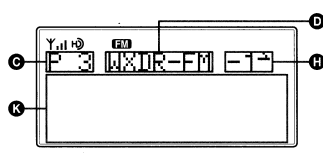
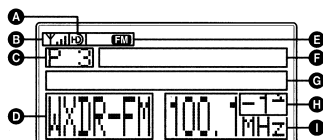

A HD indicator	Reception status
Stays lit	Strong HD signal, digital reception*
Flashes	Weak HD signal, analog reception
Not displayed	No HD signal, analog reception

\* The HD indicator flashes momentarily at first, and then stays lit.

- B Field strength level indicator
- C Preset number\*
- D Current station's call letters
- E Band
- F Station name and information
- G Title/Artist name
- H Sub channel (FM only)

Appears when the HD Radio station broadcasts multiple programs.

Press **TUNE +** or **-** to select a sub channel.

- I Frequency
- J Current time
- K Text information

\* When you tune in a station by selecting a preset number

#### Note

The display item differs depending on the content of a broadcast or the station.

### To change the display settings (BRIGHTNESS/CONTRAST)

- 1 Press **MENU** to show the menu display.
- 2 Press **SEL ↑** or **↓** to select “BRIGHTNESS” or “CONTRAST,” then press **ENTER**.
- 3 Press **SEL ↑** or **↓** to select the setting or to adjust the level, then press **ENTER**.

#### BRIGHTNESS:

The brightness of the display is selected from “HIGH,” “MIDDLE” or “LOW.”

#### CONTRAST:

The contrast of the display can be adjusted by 11 levels.

#### Note

If you do not set the menu within 10 seconds, the setting mode is completed.

#### Tip

You can adjust “BRIGHTNESS” directly by pressing **BRIGHT** on the remote commander.

## Playing an iPod

You can enjoy iPod audio by connecting to this unit. To use an iPod, refer to the user's guide of your iPod.

#### Notes

- The connector of the unit is exclusively for use with iPod. When you use the device that does not match the connector, connect it to the AUDIO IN terminal of this unit with the supplied audio connecting cable.
- Sony cannot accept responsibility in the event that data recorded on an iPod is lost or damaged when using an iPod connected to this unit.
- For details of environmental conditions for operating your iPod, check the website of Apple Inc.

- 1 Attach the Apple iPod Universal Dock Adapter (not supplied) to your iPod and insert into the connector of the unit. If you are using an iPhone, attach the supplied universal dock adapter for iPhone before inserting into the connector.

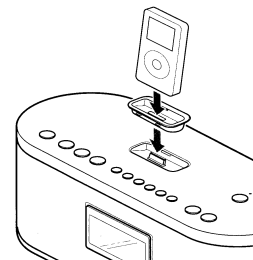

- 2 Press **iPod ▶▶**.

The iPod begins to play automatically.

You can operate the connected iPod by this unit or the iPod buttons.

- 3 Adjust the volume using **VOLUME +** or **-**.

To	Press
Turn off the iPod	<b>POWER</b> , or press and hold <b>iPod ▶▶</b>
Pause playback	<b>iPod ▶▶</b>
Go to the next track	<b>▶▶</b>
Go back to the previous track	<b>◀◀</b>
Locate a point while listening to the sound	<b>▶▶</b> (forward) or <b>◀◀</b> (backward) while playing and hold it until you find the point.
Locate a point while observing the display	<b>▶▶</b> (forward) or <b>◀◀</b> (backward) in pause and hold it until you find the point.
Go back to the previous menu	<b>MENU</b> **
Select a menu item or a track for playback	<b>▲/▼</b> **
Execute the selected menu or begin playback	<b>ENTER</b> **

\* During playback, this operation goes back to the beginning of the current track. To go back to the previous track, press twice.

\*\*These operations are available only when using the supplied remote commander.

#### Notes

- When inserting an iPod into the unit, be sure to use the universal dock adapter supplied with your iPod or commercially available from Apple Inc.
- When inserting an iPhone into the unit, be sure to use the universal dock adapter supplied with the unit or commercially available from Apple Inc.
- When placing or removing the iPod in the same angle as that of the connector on this unit and do not twist or bend the iPod to prevent connector damage.
- Do not carry the unit with an iPod set on the connector. Doing so may cause a malfunction.
- When placing or removing the iPod, brace the unit with one hand and take care not to press the controls of the iPod by mistake.
- Before disconnecting the iPod, pause playback.

#### To use the unit as a battery charger

You can use the unit as a battery charger.

The charging begins when the iPod is placed on the connector.

The charging status appears in the iPod display. For details, see the user's guide of your iPod.

#### Note

Charging for connected iPod is not available when you are listening to the radio at volume level 25 or more.

#### On copyrights

- iPod is a trademark of Apple Inc., registered in the U.S. and other countries.
- iTunes is a registered trademark of Apple Inc.
- iPhone and iTunes Tagging are trademarks of Apple Inc.
- All other trademarks and registered trademarks are of their respective holders. In this manual, ™ and ® marks are not specified.

## Using iTunes Tagging

You can save the name of a song which is broadcast on an HD Radio station to this unit with a few easy steps. After transferring the song information to the connected iPod using this unit, sync your iPod to your computer. These songs will show up in a "Tagged" playlist in iTunes, enabling easy preview or purchase of the songs.

For details about iTunes Tagging and the latest iTunes Tagging compatible models, check the iTunes website at - <http://www.apple.com/itunes/>

For the details on purchasing a song using the "Tagged" information, check the iTunes website at - <http://www.apple.com/support/itunes/>

### To get song information

The Tag indicator lights up when song information is broadcast on an HD Radio station.

- 1 Press **Tag** while the Tag indicator lights. The Tag indicator starts blinking and the unit starts retrieving the song information. After getting the song information, the unit starts saving the data and "Tagged" appears in the display during the save. The Tag indicator goes off after the unit completes saving the song information. The Tag indicator lights up again at the beginning of the next song.

#### Notes

- If the song information is not included in the HD Radio station broadcast, the Tag indicator does not light up.
- It takes approx. 10 seconds maximum to retrieve song information.
- If the AC power cord is unplugged during song information retrieving, the information will disappear.
- If **Tag** is pressed right after the beginning of a song, the unit may retrieve the information of the previously broadcast song as well as the current song.
- If **Tag** is pressed right before the ending of a song, the unit may retrieve the information of the current song and the next broadcast song as well.
- The maximum number of tagged songs that you can save to this unit is 50. If you press **Tag** when 50 tagged songs are already saved, "Storage Full" appears in the display and retrieving of song information cannot be completed.

### To transfer retrieved song information

You can transfer song information retrieved to an iPod using this unit.

For details of compatible iPod models, see "Compatible iPod models."

- 1 Place your iPod into the connector of the unit.

The unit automatically starts transferring the saved song information, and "Tagged" appears in the display and starts blinking during the transfer.

If an iPod is inserted into the unit during tagged song retrieval, the unit immediately starts transferring the data to the iPod, after the data is saved.

Once the unit completes transferring tagged song information to the iPod, the saved data will be erased from the unit.

#### Notes

- Do not remove the iPod while "Tagged" is blinking in the display. The unit cannot transfer song information if the iPod is removed.
- If the connected iPod is not compatible for iTunes Tagging, song information will not be transferred even after this unit saves the data. The message "Tagging is not Supported by this iPod" appears in the display.
- If the connected iPod does not have enough free space in the memory, song information will not be transferred even after this unit saves the data. The message "iPod Full" appears in the display.

### To delete unnecessary song information

You can delete unnecessary song information using this unit.

- 1 Press **MENU** to show the menu display.
- 2 Press **SEL**  $\uparrow$  or  $\downarrow$  to select "Tag DELETE," then press **ENTER**.

- 3 Select "Yes" or "No," then press **ENTER**.  
Yes: Deletes all the retrieved data.  
No: Cancels the delete operation and ends this delete menu.

#### Note

The song information once deleted cannot be restored.

## Adjusting the tone

- 1 Press **POWER** to turn on the unit.
- 2 Press **MENU** to show the menu display.
- 3 Press **SEL**  $\uparrow$  or  $\downarrow$  to select "TONE", then press **ENTER** to show the setting display.

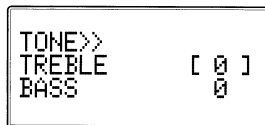

- 4 Press **SEL**  $\uparrow$  or  $\downarrow$  to adjust "TREBLE," then press **ENTER**.
- 5 Press **SEL**  $\uparrow$  or  $\downarrow$  to adjust "BASS," then press **ENTER**.

#### Tips

- The adjustable range of "TREBLE" and "BASS" is from -6 to +6.
- You can adjust "TONE" directly by pressing **TONE** on the remote commander.

## Listening to surround sound

- 1 Press **SURROUND**. "SURROUND" appears in the display. Every time you press the button, the menu of "ON" or "OFF" appears in the display in turn. When the surround sound is on, "SUR" appears in the display.

## Setting the alarm

You can set the unit to turn on automatically at a preset time. The alarm can be set, even if the unit is off.

To adjust the hour and minute, see "Setting the clock."

### To set the alarm time

- 1 Press **MENU** to show the menu display.
- 2 Press **SEL**  $\uparrow$  or  $\downarrow$  to select "ALARM TIME SET," then press **ENTER**. The hour sign starts flashing.

Example of display when unit is off



- 3 Press **SEL**  $\uparrow$  or  $\downarrow$  to set the hour, then press **ENTER**. The minute sign starts flashing.
- 4 Press **SEL**  $\uparrow$  or  $\downarrow$  to set the minutes, then press **ENTER**. The source sign starts flashing.
- 5 Press **SEL**  $\uparrow$  or  $\downarrow$  to select the source from "RADIO AM," "RADIO FM," "iPod," "AUDIO IN" or "BUZZER," then press **ENTER**. If you select "RADIO AM" or "RADIO FM," press **SEL**  $\uparrow$  or  $\downarrow$  to select the preset number, then press **ENTER**.
- 6 Press **SEL**  $\uparrow$  or  $\downarrow$  to set the volume, then press **ENTER**.

#### When using iPod touch/iPhone

To use music stored in an iPod touch/iPhone to wake up, put the iPod touch/iPhone into the unit first, follow the steps above to set alarm time, and then select the desired music.

### To set the alarm

- 1 Press **MENU** to show the menu display.
- 2 Press **SEL**  $\uparrow$  or  $\downarrow$  to select "ALARM SET," then press **ENTER**.

- 3 **SEL**  $\uparrow$  or  $\downarrow$  to select "ON," then press **ENTER**. "ALARM" appears in the display.

Example of display when unit is off

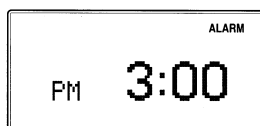

If you press **DISPLAY** on the remote commander while the display above appears, the display changes to the following.

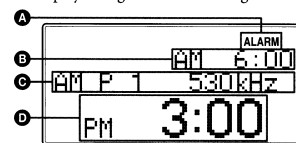

To return to the previous display, press **DISPLAY** on the remote commander again.

- A ALARM indicator
- B Alarm setting time
- C Alarm setting (Source, Frequency, etc.)
- D Current time

To deactivate the alarm function, **SEL**  $\uparrow$  or  $\downarrow$  to select "OFF" in step 3.

### To stop the alarm

Press **POWER** on the unit or remote commander.

#### Tips

- To enter "ALARM TIME SET" mode directly, press and hold **ALARM** on the remote commander for 2 seconds.
- You can activate or deactivate the alarm function directly by pressing **ALARM** on the remote commander.

#### Notes

- If you do not set the menu within 10 seconds, the setting mode is canceled.
  - If you do not operate the unit for 60 minutes after the alarm sounds, the power is turned off.
  - If you select "AUDIO IN" as source in "ALARM TIME SET," start playback on the external equipment. You cannot control the external equipment from this unit.
  - If you select "iPod" without connecting an iPod to this unit, the alarm source will switch to "BUZZER" automatically.
  - Make sure the iPod is installed correctly after setting the iPod alarm.
- Notes on using iPod touch/iPhone**
- If you set the iPod alarm while iPod touch/iPhone music is playing, and then turn the unit power off, when the alarm time comes on, the alarm music will resume from the point where the power was turned off.
  - Even if the iPod alarm setting is complete, if you turn the iPod touch/iPhone power off before the unit, the alarm source will switch to "BUZZER" automatically.

## Setting the sleep timer

You can enjoy falling asleep to the radio using the built-in sleep timer that turns off the radio automatically after a preset duration.

- 1 Press **SLEEP** on the remote commander. "SLEEP" and the digits for the sleep timer duration appear.



If you press **SLEEP** on the remote commander while the unit is turned off, the unit is turned on.

- 2 Press **SLEEP** on the remote commander repeatedly to select the desired sleep timer setting. Each press changes the setting time as follows:

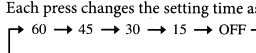

A beep sounds when the display returns to "SLEEP 60."

After about 4 seconds, "SLEEP" lights in the display when the duration time is set.

The unit automatically turns off when the duration time is passed.

### To change the sleep timer setting

You can press **SLEEP** on the remote commander repeatedly to select the desired sleep timer setting even after the sleep timer has been activated.

### To deactivate the sleep timer

Press **POWER** to turn off the unit before the setting time has elapsed, or press **SLEEP** on the remote commander repeatedly to set the sleep timer to "SLEEP OFF" in step 2.

#### Note

These operations are available only when using the remote commander.

## Listening to external equipment

- 1 Connect the AUDIO IN jack of the unit to the line out jack or headphone jack of the external equipment using the audio connecting cable (supplied).

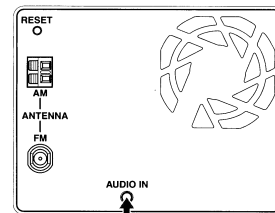

Audio connecting cable (supplied)

To external equipment

- 2 Press **AUDIO IN** to turn on the unit. "AUDIO IN" appears in the display.



- 3 Play the equipment connected to the AUDIO IN jack.
- 4 Adjust the volume using **VOLUME +** or **-**.

#### Tip

To display the current time, press **DISPLAY** on the remote commander.

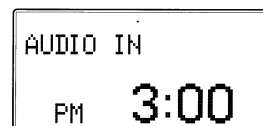

### To return to the radio

Press **RADIO/BAND**.

The band (AM or FM) is shown in the display.

#### Notes

- Refer also to the connected equipment's manual.
- The supplied audio connecting cable may not be used with some external equipment. In this case, use a cord suitable for the external equipment you are using.
- When you listen to the radio with external equipment connected, turn off the connected equipment to prevent noise. If noise occurs, even when the equipment is turned off, disconnect and place the external equipment away from the unit.

## Resetting the unit

The **RESET** button is located on the rear of the unit.

Press this button with a pointed object if the radio fails to function properly. The clock settings and stations you have preset, etc., will revert to the factory preset.

#### Note

The song information stored in this unit will not be erased by pressing the **RESET** button.