



US 20120116381A1

(19) **United States**(12) **Patent Application Publication**  
**Houser et al.**(10) **Pub. No.: US 2012/0116381 A1**(43) **Pub. Date: May 10, 2012**(54) **SURGICAL INSTRUMENT WITH CHARGING  
STATION AND WIRELESS  
COMMUNICATION****Publication Classification**(51) **Int. Cl.**  
**A61B 18/18** (2006.01)(52) **U.S. Cl.** ..... **606/33; 606/1**(57) **ABSTRACT**

An apparatus comprises an electrically power surgical instrument having a handle assembly. The apparatus also comprises a communication device positioned within the handle assembly. The communication device is operable to communicate with at least a portion of the electrically powered surgical instrument. The apparatus further comprises an external device in wireless communication with the communication device. The external device is operable to receive information from the communication device and the external device is operable to provide an output viewable to the user.

(76) Inventors: **Kevin L. Houser**, Springboro, OH (US); **Daniel W. Price**, Loveland, OH (US); **Gavin M. Monson**, Oxford, OH (US); **Hitesh Jain**, Chittorgarh (IN)(21) Appl. No.: **13/275,547**(22) Filed: **Oct. 18, 2011****Related U.S. Application Data**

(60) Provisional application No. 61/410,603, filed on Nov. 5, 2010, provisional application No. 61/487,846, filed on May 19, 2011.

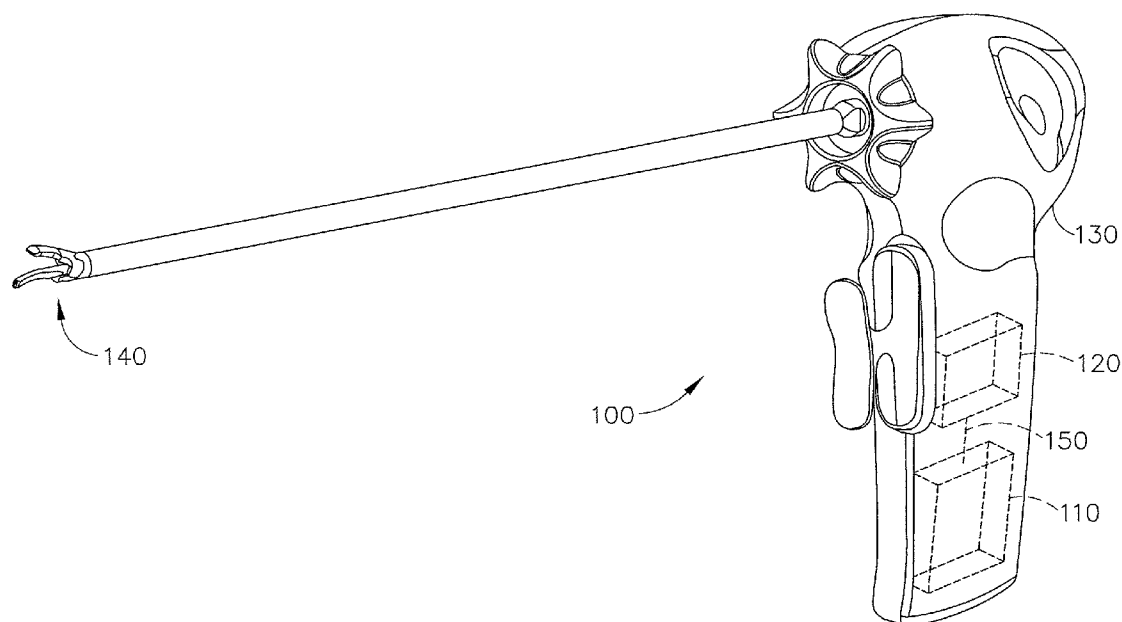

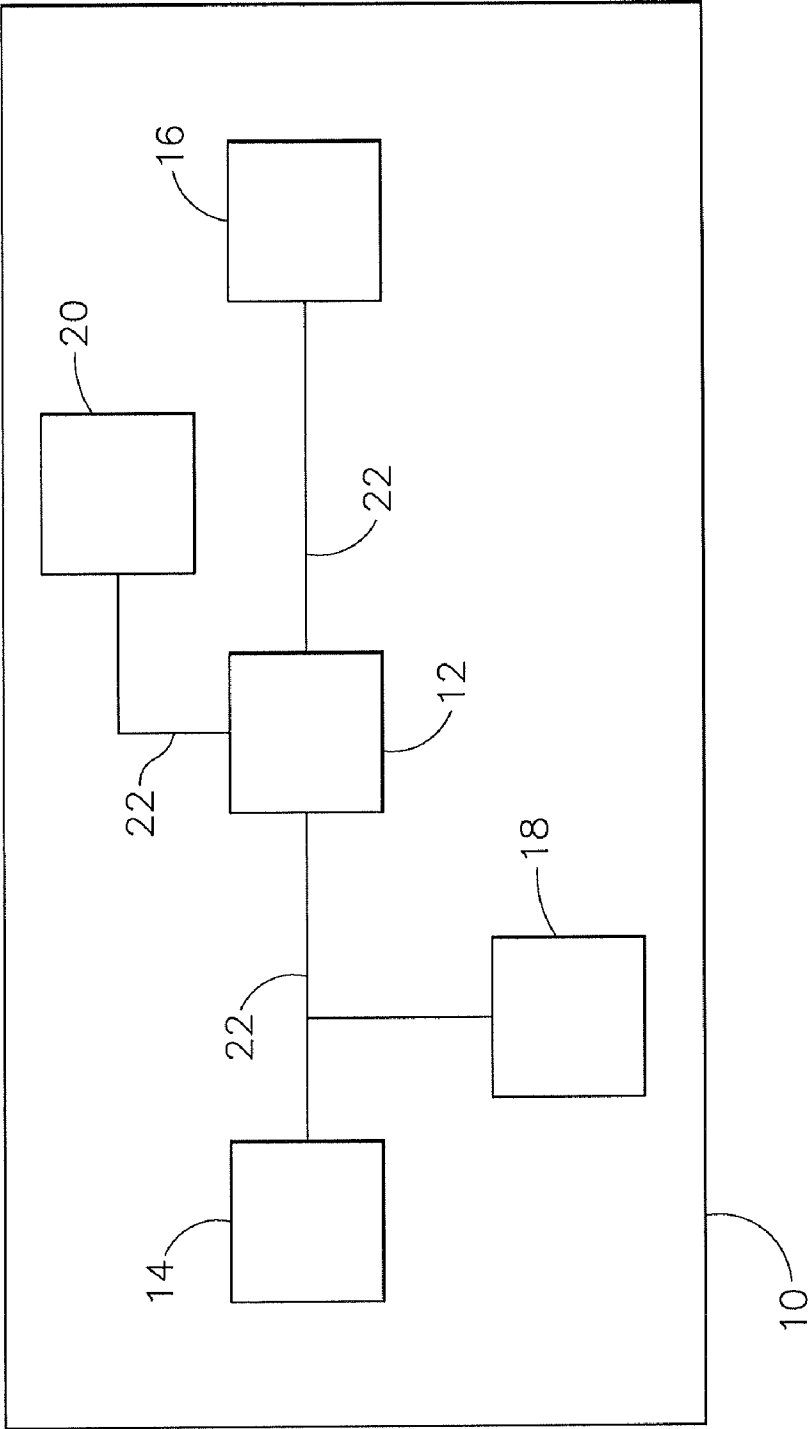

Fig.1

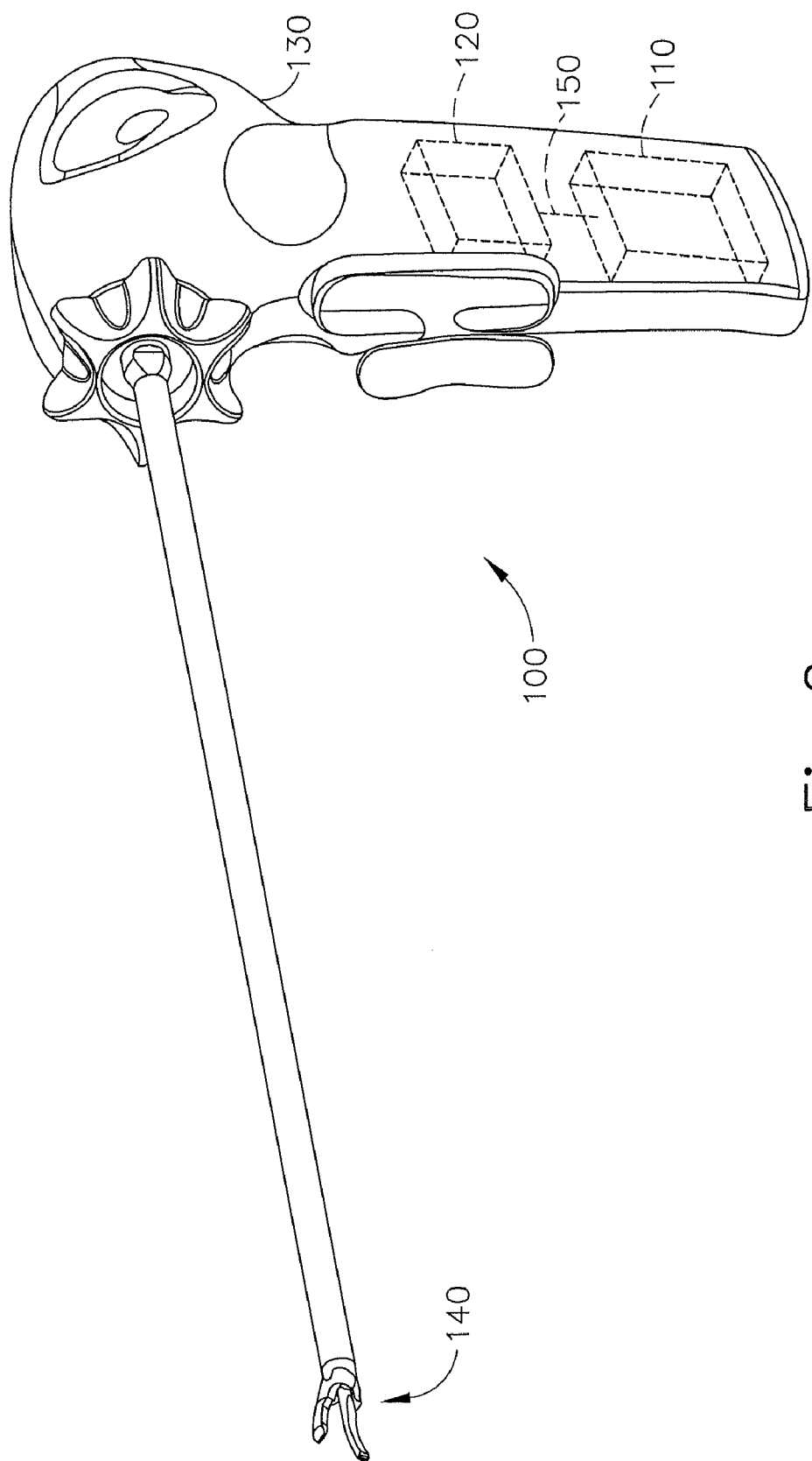

Fig. 2

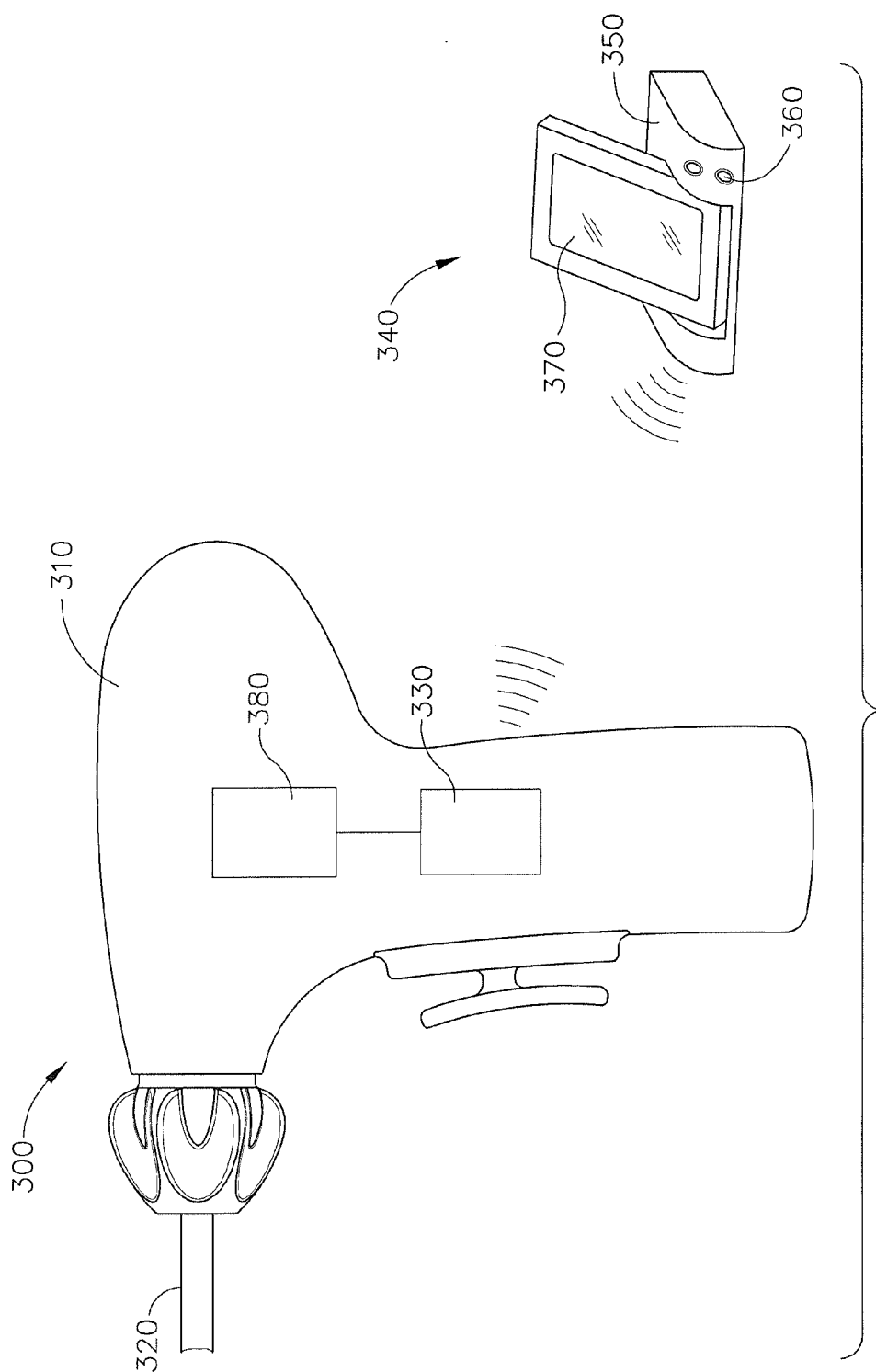

Fig. 3

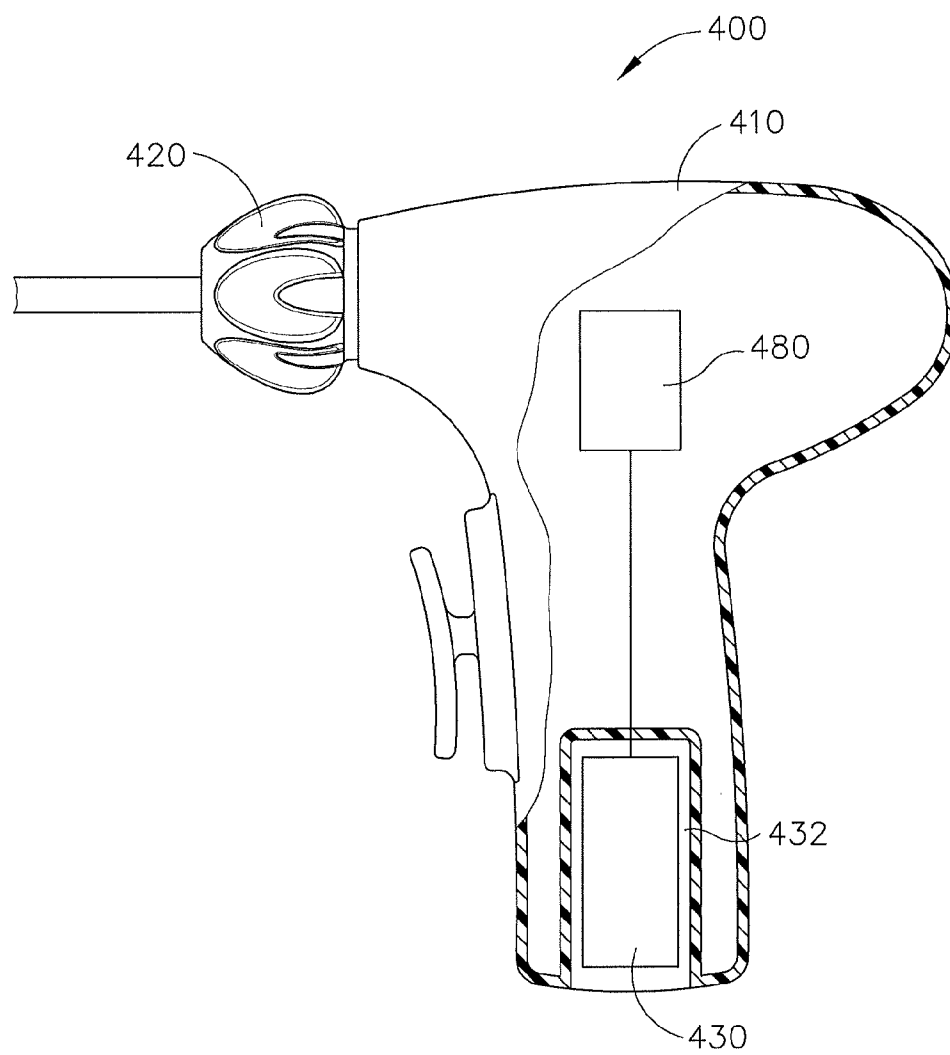

Fig.4

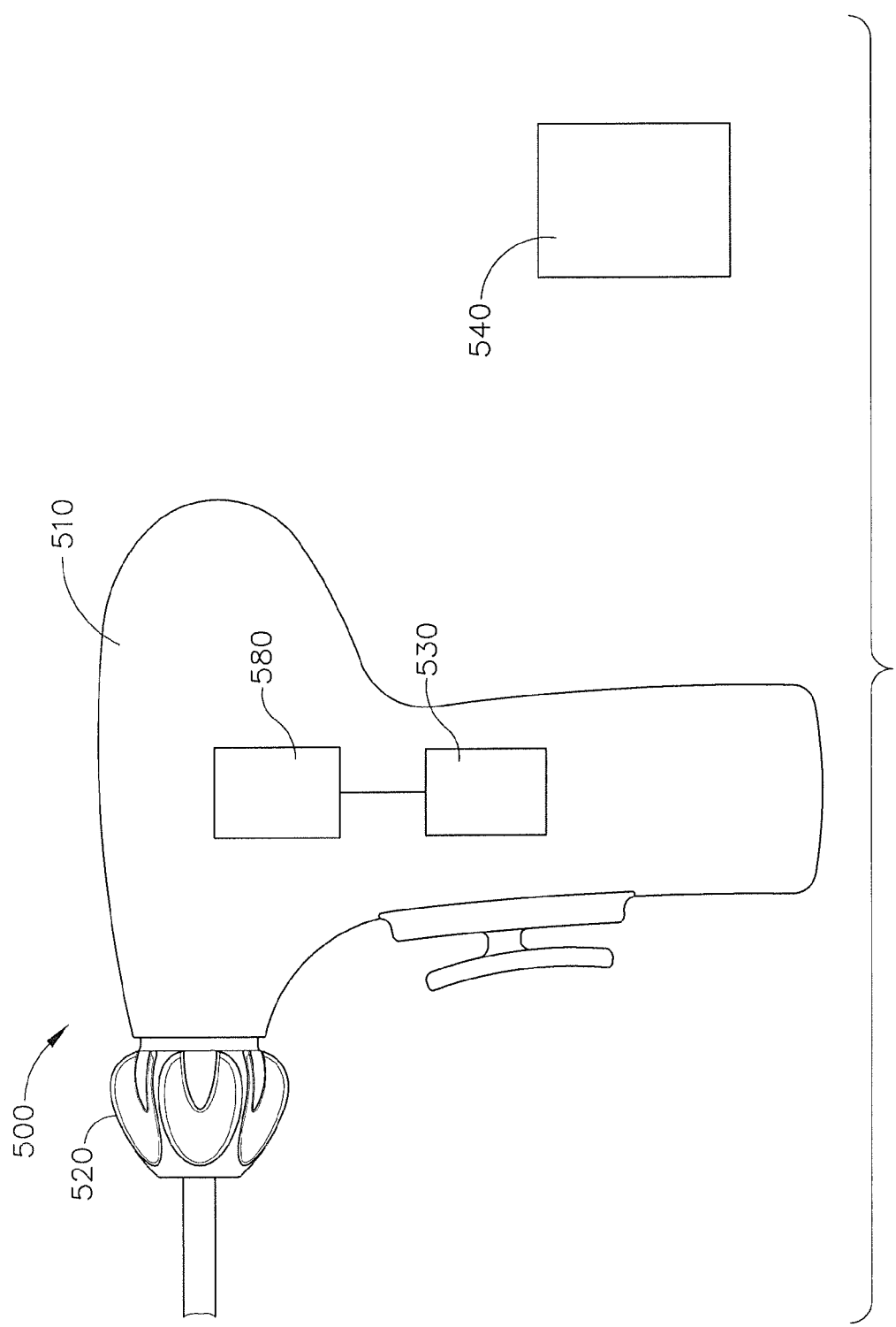

Fig.5

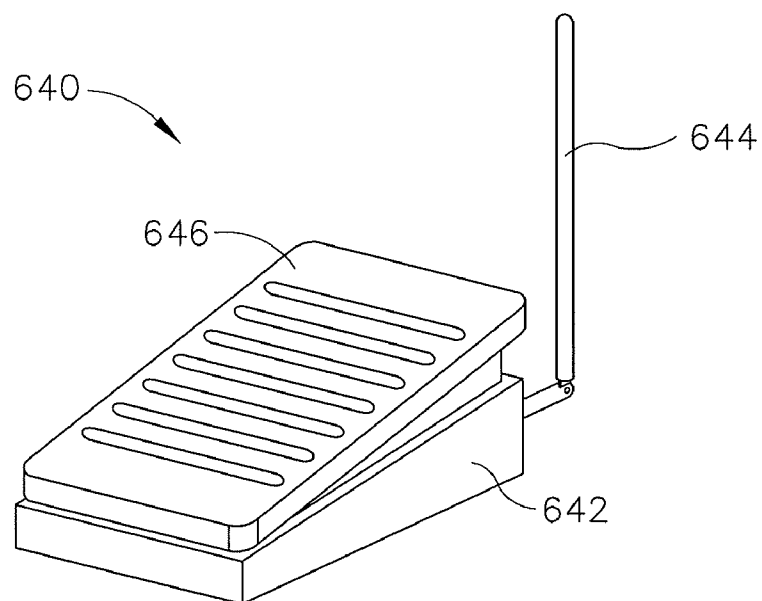

Fig.6

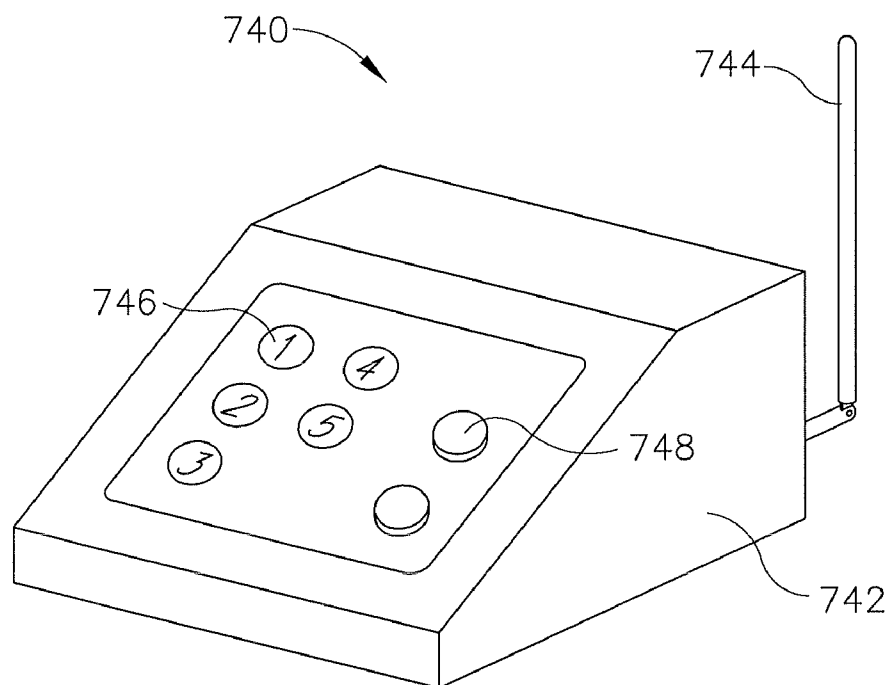

Fig.7

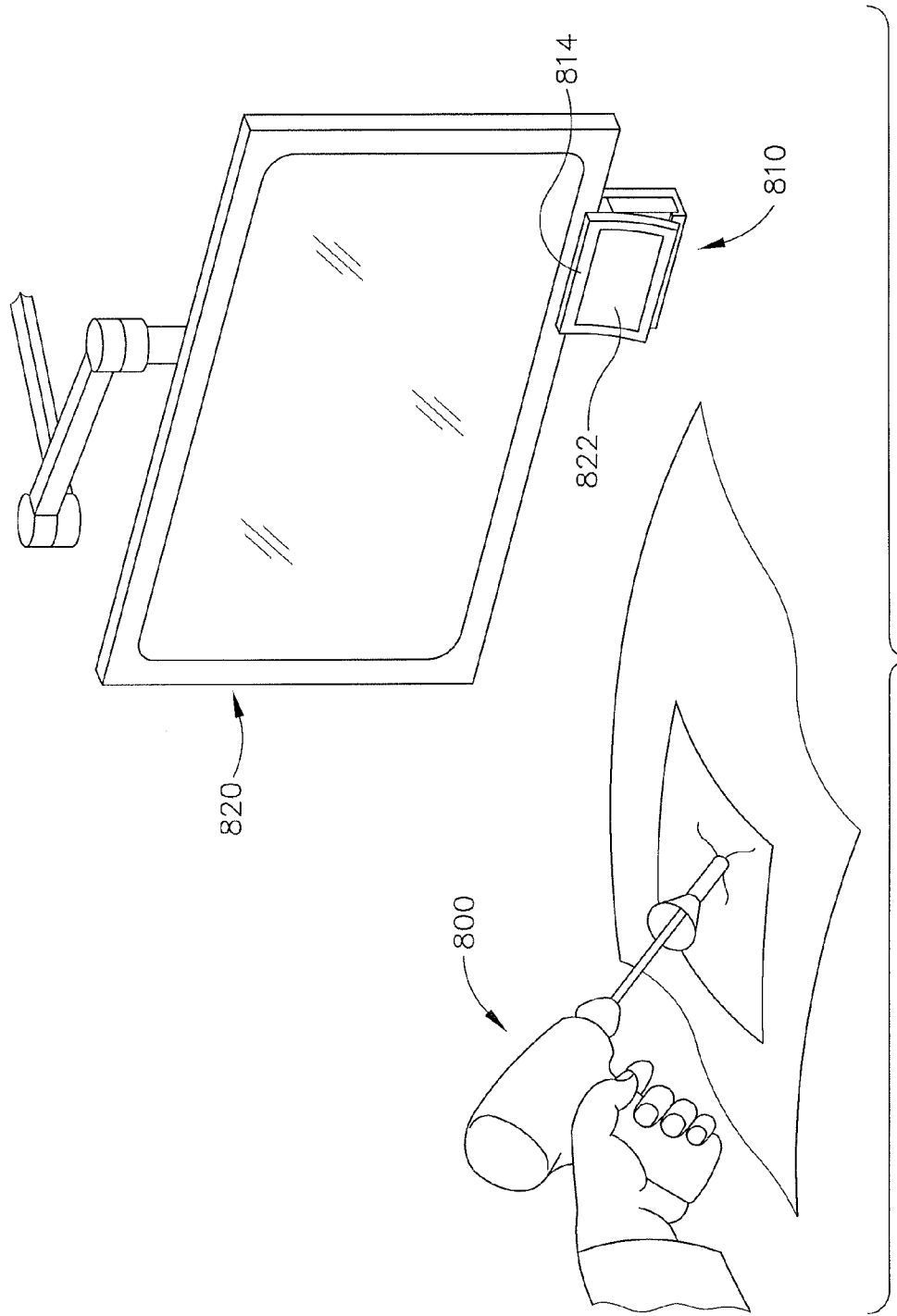

Fig. 8



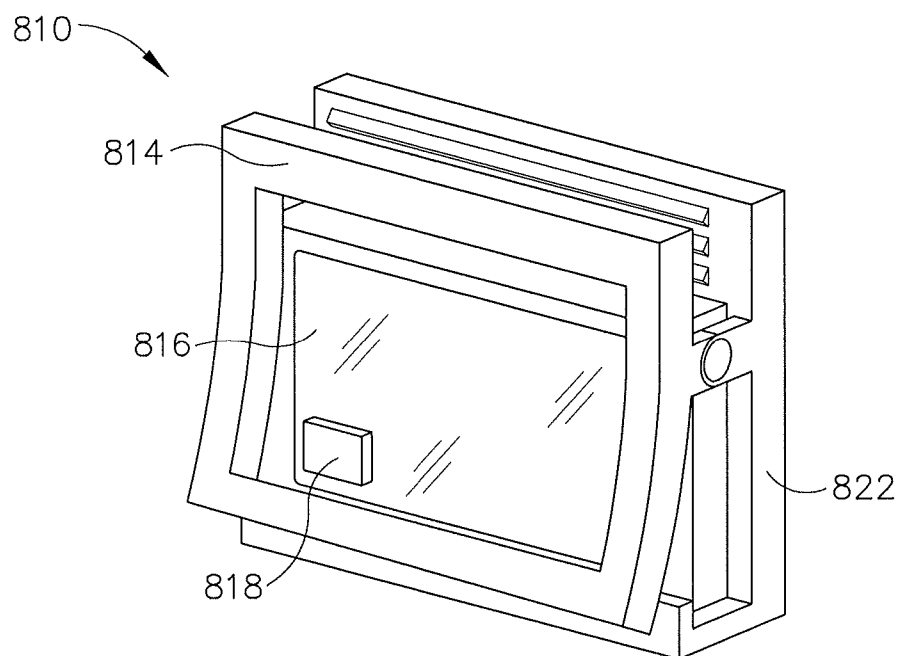

Fig.9

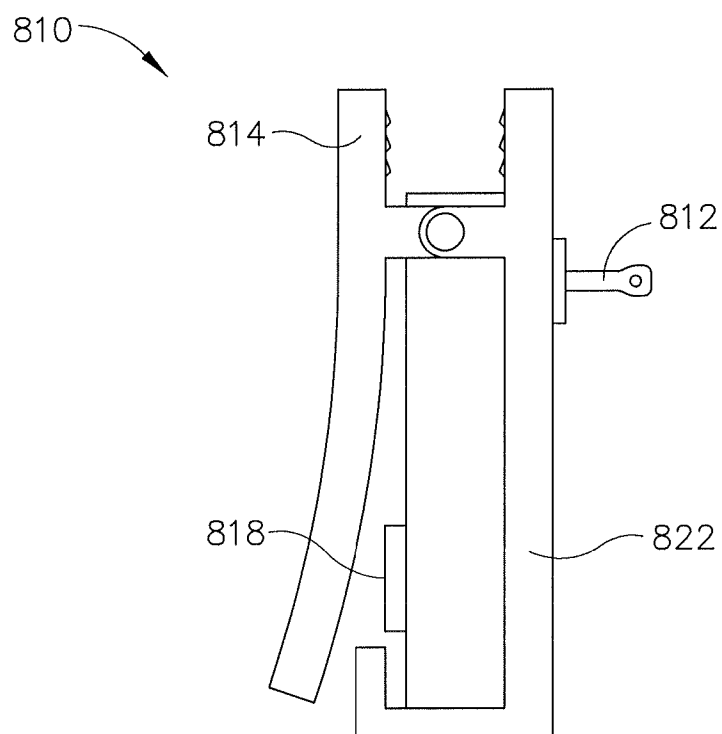

Fig.10

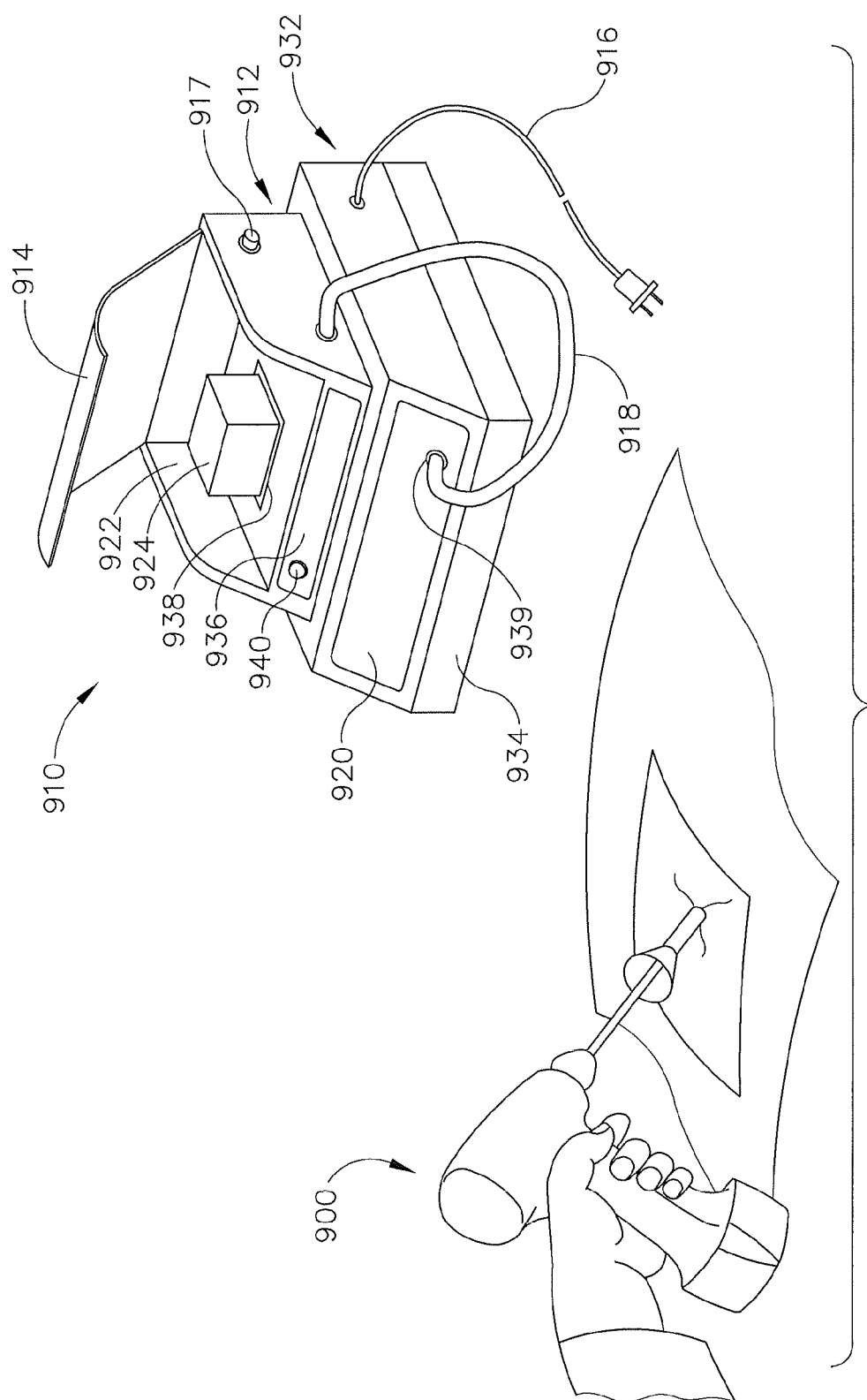

Fig. 11

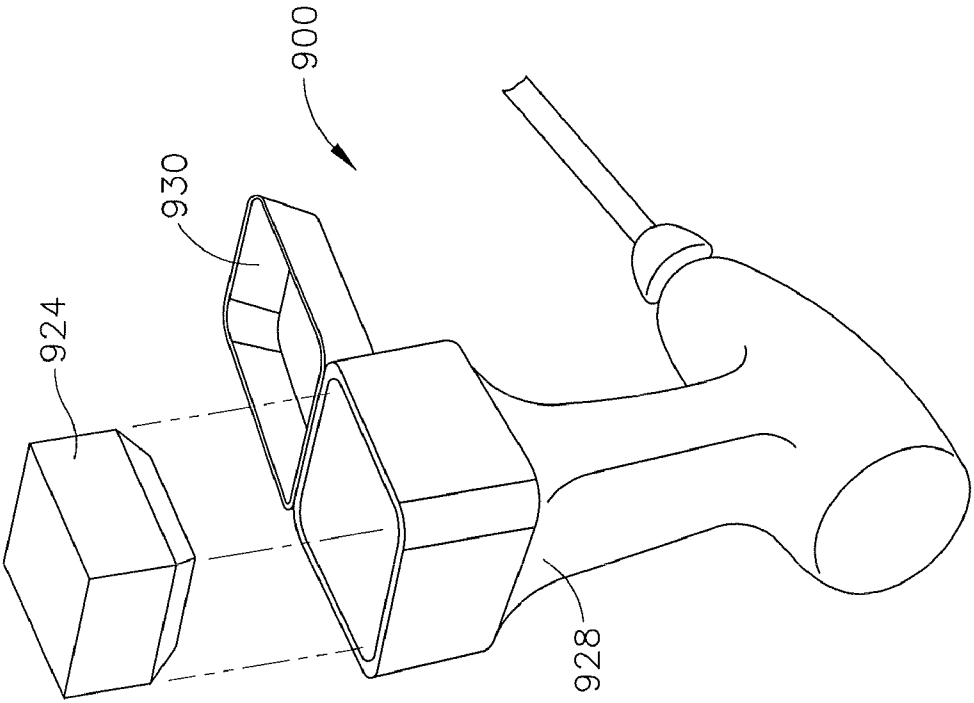

Fig. 12

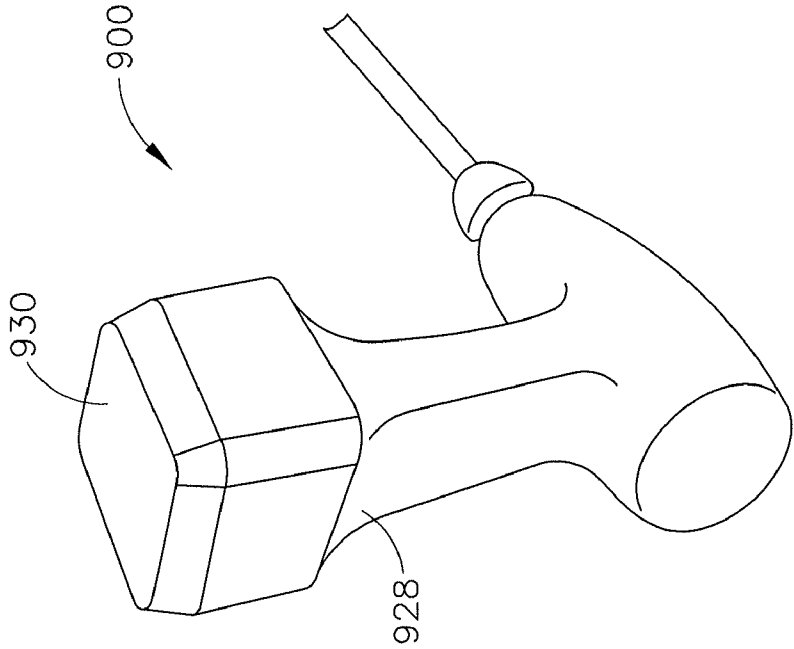

Fig. 13

## SURGICAL INSTRUMENT WITH CHARGING STATION AND WIRELESS COMMUNICATION

### PRIORITY

[0001] This application claims priority to U.S. Provisional Application Ser. No. 61/410,603, filed Nov. 5, 2010, entitled “Energy-Based Surgical Instruments,” the disclosure of which is incorporated by reference herein. This application also claims priority to U.S. Provisional Application Ser. No. 61/487,846, filed May 19, 2011, entitled “Energy-Based Surgical Instruments,” the disclosure of which is incorporated by reference herein.

### BACKGROUND

[0002] In some settings, endoscopic surgical instruments may be preferred over traditional open surgical instruments since a smaller incision may reduce the post-operative recovery time and complications. Consequently, some endoscopic surgical instruments may be suitable for placement of a distal end effector at a desired surgical site through a cannula of a trocar. These distal end effectors may engage tissue in a number of ways to achieve a diagnostic or therapeutic effect (e.g., endocutter, grasper, cutter, stapler, clip applier, access device, drug/gene therapy delivery device, and energy delivery device using ultrasound, RF, laser, etc.). Endoscopic surgical instruments may include a shaft between the end effector and a handle portion, which is manipulated by the clinician. Such a shaft may enable insertion to a desired depth and rotation about the longitudinal axis of the shaft, thereby facilitating positioning of the end effector within the patient.

[0003] Examples of endoscopic surgical instruments include those disclosed in U.S. Pat. Pub. No. 2006/0079874, entitled “Tissue Pad Use with an Ultrasonic Surgical Instrument,” published Apr. 13, 2006, the disclosure of which is incorporated by reference herein; U.S. Pat. Pub. No. 2007/0191713, entitled “Ultrasonic Device for Cutting and Coagulating,” published Aug. 16, 2007, the disclosure of which is incorporated by reference herein; U.S. Pat. Pub. No. 2007/0282333, entitled “Ultrasonic Waveguide and Blade,” published Dec. 6, 2007, the disclosure of which is incorporated by reference herein; U.S. Pat. Pub. No. 2008/0200940, entitled “Ultrasonic Device for Cutting and Coagulating,” published Aug. 21, 2008, the disclosure of which is incorporated by reference herein; U.S. Pat. Pub. No. 2011/0015660, entitled “Rotating Transducer Mount for Ultrasonic Surgical Instruments,” published Jan. 20, 2011, the disclosure of which is incorporated by reference herein; U.S. Pat. No. 6,500,176, entitled “Electrosurgical Systems and Techniques for Sealing Tissue,” issued Dec. 31, 2002, the disclosure of which is incorporated by reference herein; and U.S. Pat. Pub. No. 2011/0087218, entitled “Surgical Instrument Comprising First and Second Drive Systems Actuable by a Common Trigger Mechanism,” published Apr. 14, 2011, the disclosure of which is incorporated by reference herein. Additionally, such surgical tools may include a cordless transducer such as that disclosed in U.S. Pat. Pub. No. 2009/0143797, entitled “Cordless Hand-held Ultrasonic Cautery Cutting Device,” published Jun. 4, 2009, the disclosure of which is incorporated by reference herein. In addition, the surgical instruments may be used, or adapted for use, in robotic-assisted surgery settings such as that disclosed in U.S. Pat. No. 6,783,524, entitled “Robotic Surgical Tool with Ultrasound Cauter-

izing and Cutting Instrument,” issued Aug. 31, 2004, the disclosure of which is incorporated by reference herein.

[0004] While several systems and methods have been made and used for surgical instruments, it is believed that no one prior to the inventors has made or used the invention described in the appended claims.

### BRIEF DESCRIPTION OF THE DRAWINGS

[0005] While the specification concludes with claims which particularly point out and distinctly claim the invention, it is believed the present invention will be better understood from the following description of certain examples taken in conjunction with the accompanying drawings, in which like reference numerals identify the same elements and in which:

[0006] FIG. 1 depicts a schematic view of an exemplary medical device having an internal power source;

[0007] FIG. 2 depicts a perspective view of an exemplary medical device having an internal power source;

[0008] FIG. 3 depicts a diagrammatic view of an exemplary surgical instrument with an external device;

[0009] FIG. 4 depicts a side partially cross sectional view of an exemplary surgical instrument with a memory unit;

[0010] FIG. 5 depicts a side diagrammatic view of an exemplary surgical instrument with and external control;

[0011] FIG. 6 depicts a side view of an exemplary foot pedal for use with the surgical instrument of FIG. 5;

[0012] FIG. 7 depicts a perspective view of an exemplary external control for use with the surgical instrument of FIG. 5;

[0013] FIG. 8 depicts a perspective view of an exemplary surgical instrument with a monitor and an exemplary charger unit;

[0014] FIG. 9 depicts a front, perspective view of the exemplary charger unit of FIG. 8;

[0015] FIG. 10 depicts a side view of the exemplary charger unit of FIG. 8;

[0016] FIG. 11 depicts a perspective view of an exemplary surgical instrument with an exemplary charging station;

[0017] FIG. 12 depicts a rear, perspective view of the surgical instrument of FIG. 11 with a battery door opened; and

[0018] FIG. 13 depicts a rear, perspective view of the surgical instrument of FIG. 11 with the battery door closed.

[0019] The drawings are not intended to be limiting in any way, and it is contemplated that various embodiments of the invention may be carried out in a variety of other ways, including those not necessarily depicted in the drawings. The accompanying drawings incorporated in and forming a part of the specification illustrate several aspects of the present invention, and together with the description serve to explain the principles of the invention; it being understood, however, that this invention is not limited to the precise arrangements shown.

### DETAILED DESCRIPTION

[0020] The following description of certain examples of the invention should not be used to limit the scope of the present invention. Other examples, features, aspects, embodiments, and advantages of the invention will become apparent to those skilled in the art from the following description, which is by way of illustration, one of the best modes contemplated for carrying out the invention. As will be realized, the invention is capable of other different and obvious aspects, all without departing from the invention. For example, while various

Accordingly, the drawings and descriptions should be regarded as illustrative in nature and not restrictive.

[0021] It will be appreciated that the terms “proximal” and “distal” are used herein with reference to a clinician gripping a handpiece assembly. Thus, an end effector is distal with respect to the more proximal handpiece assembly. It will be further appreciated that, for convenience and clarity, spatial terms such as “top” and “bottom” also are used herein with respect to the clinician gripping the handpiece assembly. However, surgical instruments are used in many orientations and positions, and these terms are not intended to be limiting and absolute.

[0022] I. Medical Devices for Use with Insertable or Reclaimable Components

[0023] FIG. 1 shows components of an exemplary medical device and/or surgical instrument (10) in diagrammatic block form. As shown, medical device (10) comprises a control module (12), a power source (14), and an end effector (16). Merely exemplary power sources (14) may include NiMH batteries, Li-ion batteries (e.g., prismatic cell type lithium ion batteries, etc.), Ni-Cad batteries, or any other type of power source as may be apparent to one of ordinary skill in the art in light of the teachings herein. Control module (12) may comprise a microprocessor, an application specific integrated circuit (ASIC), memory, a printed circuit board (PCB), a storage device (such as a solid state drive or hard disk), firmware, software, or any other suitable control module components as will be apparent to one of ordinary skill in the art in light of the teachings herein. Control module (12) and power source (14) are coupled by an electrical connection (22), such as a cable and/or traces in a circuit board, etc., to transfer power from power source (14) to control module (12). Alternatively, power source (14) may be selectively coupled to control module (12). This allows power source (14) to be detached and removed from medical device (10), which may further allow power source (14) to be readily recharged or reclaimed for resterilization and reuse, such as in accordance with the various teachings herein. In addition or in the alternative, control module (12) may be removed for servicing, testing, replacement, or any other purpose as will be apparent to one of ordinary skill in the art in view of the teachings herein.

[0024] End effector (16) is coupled to control module (12) by another electrical connection (22). End effector (16) is configured to perform a desired function of medical device (10). By way of example only, such function may include cauterizing tissue, ablating tissue, severing tissue, ultrasonically vibrating, stapling tissue, or any other desired task for medical device (10). End effector (16) may thus include an active feature such as an ultrasonic blade, a pair of clamping jaws, a sharp knife, a staple driving assembly, a monopolar RF electrode, a pair of bipolar RF electrodes, a thermal heating element, and/or various other components. End effector (16) may also be removable from medical device (10) for servicing, testing, replacement, or any other purpose as will be apparent to one of ordinary skill in the art in view of the teachings herein. In some versions, end effector (16) is modular such that medical device (10) may be used with different kinds of end effectors (e.g., as taught in U.S. Provisional Application Ser. No. 61/410,603, etc.). Various other configurations of end effector (16) may be provided for a variety of different functions depending upon the purpose of medical device (10) as will be apparent to those of ordinary skill in the art in view of the teachings herein. Similarly, other types of components of a medical device (10) that may receive power

from power source (14) will be apparent to those of ordinary skill in the art in view of the teachings herein.

[0025] Medical device (10) of the present example includes a trigger (18) and a sensor (20), though it should be understood that such components are merely optional. Trigger (18) is coupled to control module (12) and power source (14) by electrical connection (22). Trigger (18) may be configured to selectively provide power from power source (14) to end effector (16) (and/or to some other component of medical device (10)) to activate medical device (10) when performing a procedure. Sensor (20) is also coupled to control module (12) by an electrical connection (22) and may be configured to provide a variety of information to control module (12) during a procedure. By way of example only, such configurations may include sensing a temperature at end effector (16) or determining the oscillation rate of end effector (16). Data from sensor (20) may be processed by control module (12) to effect the delivery of power to end effector (16) (e.g., in a feedback loop, etc.). Various other configurations of sensor (20) may be provided depending upon the purpose of medical device (10) as will be apparent to those of ordinary skill in the art in view of the teachings herein. Of course, as with other components described herein, medical device (10) may have more than one sensor (20), or sensor (20) may simply be omitted if desired.

[0026] FIG. 2 depicts a merely exemplary form that medical device (10) may take. In particular, FIG. 2 shows a medical device (100) comprising a power source (110), a control module (120), a housing (130), end effector (140), and an electrical connection (150). In the present example, power source (110) is located internally within housing (130) of medical device (100). Alternatively, power source (110) may only partially extend into housing (130) and may be selectively attachable to a portion of housing (130). In yet a further exemplary configuration, a portion of housing (130) may extend into power source (110) and power source (110) may be selectively attachable to the portion of housing (130). Power source (110) may also be configured to detach from medical device (100) and decouple from control module (120) or electrical connection (150). As a result, power source (110) may be completely separated from medical device (100) in some versions. As is readily apparent, this may allow the power source (110) to be removed to be recharged or reclaimed for resterilization and reuse, such as in accordance with various teachings herein. After recharging, or after an initial charge, power source (110) may be inserted or reinserted into medical device (100) and secured to housing (130) or internally within housing (130). Of course, medical device (100) may also allow power source (110) to be charged and/or recharged while power source (110) is still in or otherwise coupled relative to housing (130).

[0027] It should also be understood that control module (120) may be removed for servicing, testing, replacement, or any other purpose as will be apparent to one of ordinary skill in the art in view of the teachings herein. Further, end effector (140) may also be removable from medical device (100) for servicing, testing, replacement, or any other purpose as will be apparent to one of ordinary skill in the art in view of the teachings herein. While certain configurations of an exemplary medical device (100) have been described, various other ways in which medical device (100) may be configured will be apparent to those of ordinary skill in the art in view of the teachings herein.

[0028] By way of example only, medical devices (10, 100) and/or any other medical device referred to herein may be constructed in accordance with at least some of the teachings of U.S. Pat. No. 5,980,510; U.S. Pat. No. 6,500,176; U.S. Pat. No. 6,783,524; U.S. Pat. No. 7,112,201; U.S. Pat. No. 7,125,409; U.S. Pat. No. 7,169,146; U.S. Pat. No. 7,186,253; U.S. Pat. No. 7,189,233; U.S. Pat. No. 7,220,951; U.S. Pat. No. 7,309,849; U.S. Pat. No. 7,311,709; U.S. Pat. No. 7,354,440; U.S. Pat. No. 7,381,209; U.S. Pat. No. 7,416,101; U.S. Pat. No. 7,738,971; U.S. Pub. No. 2006/0079874; U.S. Pub. No. 2007/0191713; U.S. Pub. No. 2007/0282333; U.S. Pub. No. 2008/0200940; U.S. Pub. No. 2009/0143797; U.S. Pub. No. 2009/0209990; U.S. Pub. No. 2010/0069940; U.S. Pub. No. 2011/0015660; U.S. Pat. Pub. No. 2011/0087218; U.S. patent application Ser. No. 13/151,181; and/or U.S. Provisional Application Ser. No. 61/410,603. The disclosures of each of those documents are incorporated by reference herein in their entirety.

[0029] It is further understood that any one or more of the teachings, expressions, embodiments, examples, etc. described herein may be combined with any one or more of the other teachings, expressions, embodiments, examples, etc. that are described herein. The following-described teachings, expressions, embodiments, examples, etc. should therefore not be viewed in isolation relative to each other. Various suitable ways in which the teachings herein may be combined will be readily apparent to those of ordinary skill in the art in view of the teachings herein. Such modifications and variations are intended to be included within the scope of the claims.

#### [0030] II. Exemplary RF Communication Device

[0031] In some instances, it may be desirable to provide wireless communication of information to and/or from a medical device (10, 100). For instance, such information may relate to characteristics of medical device (10, 100), operation of medical device (10, 100), the surgical environment of medical device (10, 100) and/or other information. Such information may be stored and/or may be presented to the user of medical device (10, 100), such that the user may receive feedback in real time. Various examples of ways in which such wireless communication may be provided and implemented will be discussed in greater detail below, while additional examples will be apparent to those of ordinary skill in the art in view of the teachings herein. It should be understood that the below teachings may be readily incorporated with medical device (10, 100) and with the instruments taught in the various references cited herein.

[0032] FIG. 3 depicts an exemplary surgical instrument (300) having a handle assembly (310) connected to a transmission assembly (320). Surgical instrument (300) further comprises a communication device (330) positioned in the present example within handle assembly (310). Surgical instrument (300) is further in communication with an external device (340) through communication device (330). In the exemplary versions, surgical instrument (300) is in communication with external device (340) through RF communication, but any suitable communication means may be used as would be apparent to one of ordinary skill in the art in view of the teachings herein. For example, Bluetooth communication, Wi-Fi, or any other suitable communication may be used. It will also be appreciated that a software handshake may be used to verify that surgical instrument (300) and external device (340) are authorized to communicate with each other and/or to register surgical instrument (300) with

external device (340). In some other exemplary versions, surgical instrument (300) and external device (340) are operable to establish communication with each other based primarily on proximity such that surgical instrument (300) simply attempts to connect to nearby devices, such as external device (340). For instance, communication device (330) may periodically and/or continuously broadcast a signal until external device (340) responds. Conversely, external device (340) may broadcast until a communication device (330) responds.

[0033] Communication device (330) of surgical instrument (300) is in communication with a control unit (380), which may comprise a microprocessor or any other suitable computing chip as would be apparent to one of ordinary skill in the art in view of the teachings herein. It will be appreciated that control unit (380) is in communication with many or all of the working components of surgical instrument (900) through the use of sensors operable to measure parameters associated with the functionality/operation of surgical instrument (900). As a result, control unit (380) is operable to monitor the operation of surgical instrument (900) and record various diagnostic readings of surgical instrument (900). The diagnostic readings may be communicated to communication device (330); and/or, in some versions, as will be discussed in further detail below, to a memory card for storage. In addition to diagnostic information, it will be appreciated that identification information of surgical instrument (300) may be recorded. Furthermore, information regarding operation of surgical instrument (300) may be recorded as well. For example, after a use of surgical instrument (300), control unit (380) may be operable to determine whether the operation was successful or not. Other suitable pieces of information will be apparent to one of ordinary skill in the art in view of the teachings herein.

[0034] External device (340) comprises a console (350) having user controls (360), and video output (370). Video output (370) may comprise an LCD screen, an LED LCD screen, and/or a touch screen, or any other suitable screen operable to display information to the user as would be apparent to one of ordinary skill in the art in view of the teachings herein. User controls (360) comprise tactile buttons alongside video output (370), but in some other exemplary versions, user controls (360) may comprise soft keys embedded into video output (370). In some versions, user controls (360) are incorporated into video output (370) in the form of a touch screen. Other suitable components and configurations for user controls (360) will be apparent to one of ordinary skill in the art in view of the teachings herein. User controls (360) are operable to change the display of video output (370) so as to display different information to video output (370). Furthermore, user controls (360) may be operable to simply change the format of video output (370) to display the information in, for example, a different type face or different colors. In some merely exemplary versions, external device (340) may comprise software incorporated into a Smartphone, such as the iPhone or any other suitable mobile devices.

[0035] In some versions, communication device (330) is in one-way communication with external device (340) such that information is transferred only from communication device (330) of surgical instrument (300) to external device (340). For example, in the event that any errors occur during the use of surgical instrument (300), an error code may be sent wirelessly from surgical instrument (300) to external device (340). Furthermore, any other relevant diagnostic information may

be sent from surgical instrument (300) to external device (340) as would be apparent to one of ordinary skill in the art in view of the teachings herein. Once an error code is sent to external device (340), external device (340) may output the error code to video output (370) for user to read the error code. In some versions, a corresponding explanation for the error code may also be output. Furthermore, console (350) may be operable to output an audible warning. The audible warning could comprise a generic warning for any error that occurs, or in other exemplary versions, audible warning may comprise a specific sound corresponding to a particular warning such that the user may be able to tell what error (if any) has occurred by simply listening to the warning. Video output (370) may further be operable to output a full diagnostic report regarding the various components of surgical instrument (300) such that a user may be able to tell version, functionality, identification, etc. information of the various components of surgical instrument (300). In yet some other exemplary versions, when an error code is transmitted to external device (350), external device (350) may be operable to send the error code information to the manufacturer or any other suitable location for reporting or diagnosis purposes. External device (350) may be operable to send the error code information by using, for example, cellular, WiFi, modem communication, or any other suitable communication means as would be apparent to one of ordinary skill in the art in view of the teachings herein. Furthermore, in addition to the error code, external device (350) may be operable to send contextual troubleshooting instructions based on the error code sent by external device (350), to enable the user to correct the errors.

**[0036]** If the identification of surgical instrument (300) is transmitted to external device (340), it will further be appreciated that a user manual corresponding to the model of surgical instrument (300) may be output to video output (370) and navigated using user controls (360). Furthermore, external device (340) may be operable to display useful information to a user with respect to individual components (rather than an entire user manual).

**[0037]** It should be understood that communication device (330) may comprise an RF communications module operable to engage in two-way communication with external device (340) such that communication device (330) may send information and/or commands to external device (340) and external device (340) may send information and/or commands to communication device (330). It will be appreciated that in a two-way communication setup, all of the features of a one-way communication may be implemented. In addition, diagnostic instructions may be sent to surgical instrument (300) via communication device (330), which may include instructions to record readings at particular sensors within surgical instrument (300) or any other suitable instructions as would be apparent to one of ordinary skill in the art in view of the teachings herein. In yet other exemplary versions, the user may be able to select a user profile on external device (340), which may then be sent to surgical instrument (300) to customize the functionality of surgical instrument (300). For example, the user may establish custom maximum and minimum settings for buttons on surgical instrument (300). In some versions, the user may use external device (340) to indicate the type of procedure to be performed using surgical instrument (300). External device (340) may use this information to selectively enable/disable certain functionalities, parameters, and/or diagnostics in surgical instrument (300).

For example, the maximum power level of surgical instrument (300), the blade amplitude at various power levels of surgical instrument (300), and/or the pattern of power provided to surgical instrument (300) may be determined based on the procedure selected by the user.

**[0038]** In some versions, software/firmware revisions for surgical instrument (300) may be sent to surgical instrument (300), which are operable to modify various functionalities of surgical instrument (300). For example, when external device (340) is in communication with surgical instrument (300) through communication device (330), surgical instrument (300) may send firmware/software version information to external device (340). External device (340), which may be in communication with a computer or a remote site via the Internet, may then check whether the firmware version of surgical instrument (300) is the most updated version. If a newer firmware/software version exists, then external device (340) may automatically send the updated software to surgical instrument (300). In the alternative, external device (340) may send instructions prompting a user to confirm intent to receive a software update prior to sending updated software to surgical instrument (300). It will be appreciated that such software may be delivered to control unit (380) for implementation or to any other suitable component. Some other merely exemplary versions may include instructions transmitted to control unit (380) from external device (340) operable to enable and disable functionalities of surgical instrument (300). For example, the instructions may be operable to only allow surgical instrument (300) to be used a certain number of times. Furthermore, the instructions may prevent surgical instrument (300) from being used outside of particular hours. Other suitable variations of enabling and disabling components will be apparent to one of ordinary skill in the art in view of the teachings herein. In some versions, external device (340) may be operable to send automated diagnostic and/or troubleshooting commands to surgical instrument (300). For example, the user may press a key on external device (340) operable to send directions to surgical instrument (300) where the user may walk through a set of pre-defined instructions and/or routines to enable the user to diagnose and/or troubleshoot any issues with surgical instrument (300).

**[0039]** While the present example contemplates RF communication between communication device (330) and external device (340), it will be appreciated that any suitable method of communication between communication device (330) and external device (340) may be used. Furthermore, it is contemplated that communication device (330) and external device (340) may be located remotely in relation to each other with communication device (330) and external device (340) being in cellular communication or some other form of substantially remote communication. In versions where communication device (330) and external device (340) are in cellular communication, an intermediate cellular tower and/or other communication points may be used to transmit information between communication device (330) and external device (340). In yet other merely exemplary versions, it will be appreciated that communication device (330) and external device (340) may be in communication through a hardware connection such as a USB or Ethernet cable.

**[0040]** III. Exemplary Memory Unit

**[0041]** FIG. 4 depicts an exemplary surgical instrument (400) having a handle assembly (410) and a working end (420), which may comprise, for example, a transmission

assembly with an end effector. Surgical instrument (400) further comprises a control unit (480) and a memory unit (430). It will be appreciated that surgical instrument (400) may be constructed according to or similar to the teachings regarding surgical instrument/medical device (10, 100).

**[0042]** Memory unit (430) may comprise a fixed memory or a removable memory in communication with control unit (480). Memory unit (430) may comprise a flash memory card that may be removable or fixed. In some versions where memory unit (430) is fixed in relation to handle assembly (410), it will be appreciated that handle assembly (410) may include a port for wired and/or wireless communication with memory unit (430). The present example comprises a removable memory plugged into a memory slot (432). Control unit (480) is operable to monitor the operation of surgical instrument (400) during use and write information regarding the use of surgical instrument (400) to memory unit (430). Such information may include technical specifications of surgical instrument (400) including, number of times operated, details of the last use, specifications during use of the various components making up surgical instrument (400). After usage and/or diagnostic information regarding surgical instrument (400) is written to memory unit (430), memory unit (430) information may be downloaded to be sent to the manufacturer. As a result, in the event that any errors occur during use of surgical instrument (400), the manufacturer or any other suitable party may be able to use information collected from memory unit (430) to diagnose any potential issues. In yet other exemplary versions, the entire memory unit (430) could be shipped to the manufacturer for diagnosis purposes. As a result, it will be appreciated that in either of these scenarios, the manufacturer or any other suitable support group may be able to diagnose surgical instrument (400) without the entire surgical instrument (400) being sent back to the manufacturer. It should be understood that surgical instrument (400) may be fully outfitted with sensors to facilitate operation of surgical instrument (400) being written to memory unit (430). As a result, memory unit (430) may serve as a "black box" for operations of surgical instrument (400), which may later be used for diagnosis and/or analyzing the operation of surgical instrument (400).

**[0043]** Memory unit (430) may also be loaded with user preference information such that when memory unit (430) is connected to surgical instrument (400), control unit (480) of surgical instrument (400) is operable to configure surgical instrument (400) according to the user preference data. Such user preference information may include maximum and minimum settings for surgical instrument (400) along with the particular procedure being performed by surgical instrument (400). Other suitable types of user preference information may be used as would be apparent to one of ordinary skill in the art in view of the teachings herein.

**[0044]** IV. Exemplary Remote Activation of Surgical Instrument

**[0045]** FIG. 5 depicts an exemplary surgical instrument (500) having a handle assembly (510) and a working end (520), which may comprise, for example, a transmission assembly with an end effector. Surgical instrument (500), which may be constructed similar to or in accordance with medical device and/or surgical instrument (10, 100), further comprises a control unit (580) and a communication device (530) in wireless communication with an external control (540). FIG. 6 shows one merely exemplary form that external control (540) may take. In particular, FIG. 6 shows an external

control (640) comprising a footswitch having a body (642), an antenna (644), and a pedal (646). Antenna (644) is operable to transmit signals to communication device (530). Body (642) comprises a stable housing for external control (640), which may include a weighted bottom such that pedal (646) may be depressed without creating instability in the overall external control (640). Actuation of pedal (646) is operable to send an instruction signal from external control (640) to surgical instrument (500). For example, depressing pedal (646) may change the power level, speed, on/off state, or any other attribute of surgical instrument (500) as would be apparent to one of ordinary skill in the art in view of the teachings herein. FIG. 7 shows yet another exemplary form that external control (540) may take. In particular, FIG. 7 depicts external control (740) having a body (742) with user controls (748) and power level meter (746). As with the exemplary version shown in FIG. 6, external control (740) is operable to send instructions to surgical instrument (500) via antenna (744). Additionally, antenna (744) of FIG. 7 is operable to receive signals that may include information regarding power usage of surgical instrument (500). User controls (748) may comprise hardware buttons or soft keys on an LCD screen operable to determine the instructions to be transmitted to surgical instrument (500). For example, user controls (748) may be operable to set the power level of surgical instrument (500). In yet other versions, user controls (748) are operable to set the operating mode of surgical instrument (500), which may include selecting between a cutting mode and a coagulation mode. Power level meter (746) in the present example comprises a series of numerical indicators corresponding to a particular power level of surgical instrument (500) operable to inform the user of the current power level of surgical instrument (500). While the present example uses numerical indicators for power level meter (746), it will be appreciated that any suitable indicator may be used as would be apparent to one of ordinary skill in the art in view of the teachings herein. For example, power level meter (746) may comprise a bar meter, a circular meter, or any other suitable indicator.

**[0046]** V. Exemplary Battery Pack with Charger Unit

**[0047]** FIGS. 8-10 depict an exemplary charger unit (810) for use in conjunction with a surgical instrument (800) and a laparoscope monitor (820). In the present example, charger unit (810) comprises a body (822), a clamp portion (814), a plug (812), a display (816), and a communication module (818). Body (822), which can be seen in FIG. 9 from the front of body (822), has a rectangular shape, but it will be appreciated that any suitable shape for body (822) may be used as would be apparent to one of ordinary skill in the art in view of the teachings herein. Clamp portion (814), shown in FIG. 10 through a side view of body (822), comprises a pair of jaws biased toward each other such that clamp portion (814) is operable to grasp laparoscope monitor (820). Clamp portion (814) may be operable to grasp any suitable surface or member as would be apparent to one of ordinary skill in the art in view of the teachings herein. Plug (812) is operable to connect charger unit (810) to a wall outlet and draw power from the outlet to recharge rechargeable batteries contained within charger unit (810). In the present example, plug (812) is operable to fold into a recess formed within body (822). However, it will be appreciated that plug (812) may be fixed without being able to fold inward.

**[0048]** In some versions, charger unit (810) is operable to removably receive and recharge one or more batteries that are used to power surgical instrument (800). For instance, one



rechargeable battery may be used in surgical instrument (800) while another rechargeable battery is charged/held in charger unit (810). Once the battery in surgical instrument (800) is depleted, it may be replaced with the fully charged battery from charger unit (810), and charger unit (810) may begin recharging the depleted battery. Since rechargeable batteries are stored within charger unit (810), it will be appreciated that the rechargeable batteries may be used to power the electrical functions of charger unit (810) as well. For instance, in settings where charger unit (810) is not coupled with plug (812) or plug (812) is not coupled with a wall outlet, charger unit (810) may run on one or more batteries in charger unit (810). Such batteries may be the same batteries used to power surgical instrument (800) or a dedicated backup battery. In versions where charger unit (810) has a dedicated backup battery, such a backup battery may also be used to recharge one or more batteries from surgical instrument (800). As another variation of charger unit (810) having a dedicated backup battery, charger unit (810) may simply run on the backup battery without also charging a battery from surgical instrument when charger unit (810) is not coupled with plug (812) or when plug (812) is not coupled with a wall outlet. Other suitable schemes will be apparent to those of ordinary skill in the art in view of the teachings herein.

[0049] Communication module (818) is operable to communicate wirelessly with surgical instrument (800). As a result, communication module (818) is operable to send and receive data from surgical instrument (800), which may include various diagnostic readings from surgical instrument (800). Charger unit (810) is then operable to output information from surgical instrument (800) to display (816). Display (816) may comprise an LCD screen operable to show diagnostic information and/or information regarding the operation of surgical instrument (800). Display (816) may output statuses regarding surgical instrument (800), alarms, troubleshooting help and advice, tissue feedback indicators, information related to the performance of surgical instrument (800), minimum and maximum values for battery and/or surgical instrument (800) power, power activation information of charger unit (810) or surgical instrument (800), tissue thickness information, cycle complete indicators, blade heat information, and/or any other suitable pieces of information as would be apparent to one of ordinary skill in the art in view of the teachings herein. For example, display (816) may be used to show the current power level of surgical instrument (800) or may be used to show a graphical representation of the internal operation of surgical instrument (800) such that the user may be able to use display (816) to monitor surgical instrument (800) during a surgical procedure. Laparoscope monitor (820) may be operable to view the surgical site as the surgical procedure is taking place. By attaching clamp portion (814) of charger unit (810) to laparoscope monitor (820), it will be appreciated that the user may simultaneously watch a real-time view of the surgical procedure while also monitoring diagnostic information regarding surgical instrument (800) on charger unit (810).

[0050] In some exemplary versions, it will be appreciated that charger unit (810) may further comprise a gravity sensor operable to detect the orientation of charger unit (810) such that charger unit (810) may be held in either a horizontal or a vertical orientation while maintaining a readable orientation for the user. In yet other exemplary versions, charger unit (810) may comprise a USB or other hardware ports operable to connect charger unit (810) to an external device to update

the software of charger unit (810). In other exemplary versions, updated software may be transferred wirelessly to charger unit (810) to update the firmware or other software of charger unit (810).

#### [0051] VI. Exemplary Wireless Power Station

[0052] FIGS. 11-13 show an exemplary surgical instrument (900) having a handle assembly (928) with a battery compartment (926) operable to hold a rechargeable battery (924). It will be appreciated that surgical instrument (900) may be constructed in accordance with the above teachings relating to medical device (10, 100) and/or the teachings of any of the references cited herein. FIG. 11 shows surgical instrument (900) being used in a surgical procedure and in communication with a charging station (910). Charging station (910) comprises a recharging container (912), a generator (932), and a platform (934). In the present example, recharging compartment (912) sits atop of generator (932), but any suitable configuration may be used. For example, recharging container (912) may be placed alongside generator (932), under generator (932), or may be incorporated into a single housing with generator (932). Other suitable configurations will be apparent to one of ordinary skill in the art in view of the teachings herein.

[0053] Recharging container (912) comprises a battery compartment (922) operable to hold a plurality of batteries (924). Recharging container (912) further comprises a lid (914) to selectively cover battery compartment (922). Battery compartment (922) comprises a rectangular receptacle operable to hold batteries (924), though it should be understood that any other suitable shape may be used. While recharging container (912) of the present example has just a single tier battery compartment (922), it should be understood that recharging container may include a plurality of tiers of battery compartments (922). The base of battery compartment (922) comprises a plurality of battery slots (938) where each slot (938) is operable to receive battery (924). Slots (938) may be constructed such that slots (938) provide a snapping sound or other form of feedback once battery (924) is sufficiently plugged into a slot (938). Slots (938) are spaced out such that batteries (924) may be individually grasped and removed from slots (938) without causing stress or undesirable forces being applied to adjacent batteries (924) from the user removing battery (924).

[0054] Slots (938) may be used with a light (940) such as an LED light operable to light up in different colors based on the charge status of batteries (924). In some exemplary versions, light (940) may be positioned adjacent to slot (938). For example, light (940) may light up red in the event that battery (924) attached to slot (938) is empty of charge. Slot (938) may light up yellow if battery (924) attached to slot (938) is currently charging, and slot (938) may light up green if battery (924) is fully charged. Other suitable configurations will be apparent to one of ordinary skill in the art in view of the teachings herein. For example, rather than different color lights (940), numerical indicators or any other suitable indicators may be used to indicate the relative charge states of battery (924) and/or other information relating to battery (924).

[0055] Lid (914) covering battery compartment (922) comprises a hinged lid attached to the rear of battery compartment (922). Furthermore, lid (922) is constructed of a translucent or transparent material such that the user may see into recharging container (912) as batteries (924) are being charged. By viewing batteries (924) through lid (922), the

user can ascertain the charge states of batteries (924) without opening recharging container (912). While the present example comprises a hinged lid for lid (914), it will be appreciated that other configurations for lid (914) may be used such as a snap top lid, a sliding cover, etc., or any other suitable variation as would be apparent to one of ordinary skill in the art in view of the teachings herein.

[0056] The front of recharging container (912) comprises a display panel (936) operable to provide various information to the user including battery (924) charge levels. Other exemplary information may include displaying the total number of batteries (924) in battery compartment (922) as well as an on/off status of recharging container (912). Any other suitable information may be displayed on panel (936) as would be apparent to one of ordinary skill in the art in view of the teachings herein. Display panel (936) may be used in addition to or in lieu of lights (940).

[0057] Recharging container (912) is coupled with generator (932) via a communication cable (918), which is plugged into a universal port (939) of generator (932). Communication cable (918) is operable to deliver power as well as operation instructions from generator (932) to recharging container (912). Communication cable (918) may also transmit data from recharging container (912) to generator (932). In the present example, cable (918) is selectively retractable within recharging container (912). In particular, when retracted, cable (918) may be pulled to extend from recharging container (912). Recharging container (912) includes a retraction button (917) that may be pressed to retract extended cable (918) back into recharging container (912). A resilient member may bias cable (918) to a retracted position. Of course, retractability of cable (918) is merely optional.

[0058] Generator (932) is coupled with a power source (e.g., a wall outlet, etc.) via a power cord (916). Power cord (916) is thus operable to deliver power to generator (932) to thereby deliver power to recharging container (912) to recharge batteries (924). Generator (932) comprises a generator panel (920) operable to show the status of generator (932). Universal port (939) is shown as accepting a connection from recharging container (912) via cable (918), though it should be understood that universal port (939) is also operable to accept connections from ultrasonic surgical instruments and RF electrosurgical instruments. Generator (932) is thereby also operable to deliver power directly to ultrasonic surgical instruments and RF electrosurgical instruments. For instance, generator (932) may be compatible with any of the instruments taught in any of the references cited herein, among other types of instruments. Universal port (939) may comprise an RFID chip reader operable to read an RFID chip contained in a cable plug that is plugged into universal port (939). Thereafter, generator (932) can determine the identity of the device plugged into universal port (939) and determine the appropriate instructions and/or power parameters for properly operating the plugged in device. Other suitable ways of identifying a device plugged into generator (932) may be used as would be apparent to one of ordinary skill in the art in view of the teachings herein.

[0059] In some versions, recharging unit (912) may be connected to a network (e.g., the Internet, etc.) such that information stored on any memory units associated with recharging unit (912) transmitted over the network. Such information may include information regarding batteries (924), surgical instrument (900), the network, etc.; and may be sent to the user, a hospital, or the manufacturer, etc. Recharging unit

(912) may also comprise a keyboard and/or other suitable input device such that the user may use to provide instructions to recharging unit (912) for charging batteries (924) and/or to command the transmission of information to and from recharging unit (912). It should be understood that generator (932) need not necessarily be included in such communications.

[0060] It will be appreciated that recharging container (912) is operable to transmit information to generator (932) including battery charge level information and identification information of generator (932) or any suitable information as would be apparent to one of ordinary skill in the art in view of the teachings herein. Generator panel (920) is operable to display information transferred from recharging container (912) and/or any other suitable information as would be apparent to one of ordinary skill in the art in view of the teachings herein. In the event that an ultrasonic instrument or an RF based instrument is connected directly to generator (932), the ultrasonic and/or RF based instrument may be able to transmit information regarding the operation and/or status of the ultrasonic and/or RF based instrument, which may be output entirely or in part to generator panel (920). By way of example only, generator (932) and associated components may be configured in accordance with the teachings of U.S. Patent App. Publ. No. 2011/0087212, entitled "Surgical Generator for Ultrasonic and Electrosurgical Devices," published Apr. 14, 2011, the disclosure of which is incorporated by reference herein. While the present example shows generator (932), it will be appreciated that in some versions, generator (932) may be removed such that recharging station (912) is simply plugged directly into a wall.

[0061] Furthermore, it is contemplated that recharging container (912) may be in wireless communication with surgical instrument (900) such that surgical instrument (900) is operable to transfer information to recharging container (912) regarding diagnostic and/or status information of surgical instrument (900) or any other information as would be suitable to one of ordinary skill in the art in view of the teachings herein. For instance, surgical instrument (900) may transmit information to recharging container (912) regarding the charge status of a battery (924) contained within surgical instrument (900). Recharging container (912) may provide an audio and/or visual alert to the user when the charge level of the battery (924) in surgical instrument (900) falls below a threshold, thereby alerting the user to replace battery (924). It will be appreciated that any information sent from surgical instrument (900) may also be output to generator (932) to display on generator panel (912) and/or for other processing by generator (932). It will be appreciated that generator (932) may be used to show information regarding surgical instrument (900) as if generator (932) were directly connected to surgical instrument (900).

[0062] When battery (924) is ready for use, FIG. 12 shows battery (924) being dropped into handle assembly (928) of surgical instrument (900) by opening battery door (930) and dropping in battery (924). In some exemplary versions, battery (924) may have an asymmetrical shape with handle assembly (928) having a complementary shape such that battery (924) can only be dropped into handle assembly (928) in one orientation. Battery (924) may be handled appropriately by, for example, a technician or surgeon with sterile hands, such that replacing battery (924) does not compromise

the sterility of handle assembly (928). FIG. 13 shows battery door (930) being shut and surgical instrument (900) being ready for use.

**[0063]** It should be appreciated that any patent, publication, or other disclosure material, in whole or in part, that is said to be incorporated by reference herein is incorporated herein only to the extent that the incorporated material does not conflict with existing definitions, statements, or other disclosure material set forth in this disclosure. As such, and to the extent necessary, the disclosure as explicitly set forth herein supersedes any conflicting material incorporated herein by reference. Any material, or portion thereof, that is said to be incorporated by reference herein, but which conflicts with existing definitions, statements, or other disclosure material set forth herein will only be incorporated to the extent that no conflict arises between that incorporated material and the existing disclosure material.

**[0064]** Embodiments of the present invention have application in conventional endoscopic and open surgical instrumentation as well as application in robotic-assisted surgery. For instance, those of ordinary skill in the art will recognize that various teaching herein may be readily combined with various teachings of U.S. Pat. No. 6,783,524, entitled "Robotic Surgical Tool with Ultrasound Cauterizing and Cutting Instrument," published Aug. 31, 2004, the disclosure of which is incorporated by reference herein.

**[0065]** Embodiments of the devices disclosed herein can be designed to be disposed of after a single use, or they can be designed to be used multiple times. Embodiments may, in either or both cases, be reconditioned for reuse after at least one use. Reconditioning may include any combination of the steps of disassembly of the device, followed by cleaning or replacement of particular pieces, and subsequent reassembly. In particular, embodiments of the device may be disassembled, and any number of the particular pieces or parts of the device may be selectively replaced or removed in any combination. Upon cleaning and/or replacement of particular parts, embodiments of the device may be reassembled for subsequent use either at a reconditioning facility, or by a surgical team immediately prior to a surgical procedure. Those skilled in the art will appreciate that reconditioning of a device may utilize a variety of techniques for disassembly, cleaning/replacement, and reassembly. Use of such techniques, and the resulting reconditioned device, are all within the scope of the present application.

**[0066]** By way of example only, embodiments described herein may be processed before surgery. First, a new or used instrument may be obtained and if necessary cleaned. The instrument may then be sterilized. In one sterilization technique, the instrument is placed in a closed and sealed container, such as a plastic or TYVEK bag. The container and instrument may then be placed in a field of radiation that can penetrate the container, such as gamma radiation, x-rays, or high-energy electrons. The radiation may kill bacteria on the instrument and in the container. The sterilized instrument may then be stored in the sterile container. The sealed container may keep the instrument sterile until it is opened in a medical facility. A device may also be sterilized using any other technique known in the art, including but not limited to beta or gamma radiation, ethylene oxide, or steam.

**[0067]** Having shown and described various embodiments of the present invention, further adaptations of the methods and systems described herein may be accomplished by appropriate modifications by one of ordinary skill in the art without

departing from the scope of the present invention. Several of such potential modifications have been mentioned, and others will be apparent to those skilled in the art. For instance, the examples, embodiments, geometrics, materials, dimensions, ratios, steps, and the like discussed above are illustrative and are not required. Accordingly, the scope of the present invention should be considered in terms of the following claims and is understood not to be limited to the details of structure and operation shown and described in the specification and drawings.

I/We Claim:

1. An apparatus comprising:

- (a) an electrically powered surgical instrument comprising a handle assembly;
- (b) a communication device positioned within the handle assembly, wherein the communication device is configured to communicate with at least a portion of the electrically powered surgical instrument; and
- (c) an external device, wherein the communication device is configured to wirelessly transmit information to the external device, wherein the external device is configured to receive and process information from the communication device, wherein the external device is configured to provide an output viewable to a user.

2. The apparatus of claim 1, wherein the information sent to the external device comprises identification information regarding the surgical instrument.

3. The apparatus of claim 1, wherein the information sent to the external device comprises status information regarding the surgical instrument.

4. The apparatus of claim 1, wherein the external device is further configured to transmit information to the communication device.

5. The apparatus of claim 4, wherein the external device is configured to send updated software to the communication device.

6. The apparatus of claim 4, wherein the external device is configured to send user preferences to the communication device.

7. The apparatus of claim 4, wherein the external device is configured to send instructions to the communication device operable to modify the functionality of the electrically powered surgical instrument.

8. The apparatus of claim 1, wherein the communication device and the external device are in communication through RF communication.

9. The apparatus of claim 1, wherein the handle assembly comprises a removable memory unit.

10. The apparatus of claim 1, wherein the external device comprises a charger unit operable to hold a rechargeable battery.

11. The apparatus of claim 10, wherein the charger unit is configured to clamp onto a laparoscope monitor.

12. The apparatus of claim 11, wherein the charger unit comprises an LCD display operable to display information associated with the surgical instrument.

13. The apparatus of claim 1, wherein the external device comprises a foot pedal operable to control the surgical instrument.

14. The apparatus of claim 1, wherein the external device is configured to display a power meter operable to show the power level of the surgical instrument.

15. The apparatus of claim 1, wherein the external device comprises a charging station.

**16.** An apparatus comprising:

- (a) an electrically powered surgical instrument;
- (b) a communication device positioned within the electrically powered surgical instrument; and
- (c) an external device operable to hold at least one rechargeable battery, wherein the external device is in communication with the communication device, wherein the external device is configured to display information associated with the electrically powered surgical instrument received from the communication device, wherein the external device is configured to recharge the at least one rechargeable battery.

**17.** The apparatus of claim **16**, wherein the external device comprises a visual indicator operable to show the charge state of the at least one rechargeable battery.

**18.** The apparatus of claim **16**, further comprising a memory unit in communication with the at least one rechargeable battery, wherein the memory unit is operable to send and receive information to and from the external device.

**19.** The apparatus of claim **16**, wherein the external device is configured to be in wireless communication with the communication device.

**20.** A method of providing information to a user during a surgical procedure using an electrically powered surgical instrument, a communication device contained within the surgical instrument, and an external device in wireless communication with the communication device, the method comprising:

- (a) using the surgical instrument in a surgical procedure;
- (b) sending information from the surgical instrument to the communication device;
- (c) transmitting information wirelessly from the communication device to the external device; and
- (d) displaying information to the user with the external device.

\* \* \* \* \*