

Thank you for purchasing the Mobile Wi-Fi . This Mobile Wi-Fi brings you a high speed wireless network connection.

This document will help you understand your Mobile Wi-Fi so you can start using it right away. Please read this document carefully before using your Mobile Wi-Fi .

For detailed information about the functions and configurations of the Mobile Wi-Fi , refer to the online help on the web management page that comes with the Mobile Wi-Fi .

For detailed instructions for logging in to the web management page, refer to "Logging In to the Web Management Page" on page 20.

Getting to Know Your Mobile Wi-Fi

Note:

The Mobile Wi-Fi function descriptions and illustrations in this document are for your reference only. The product you have purchased may vary.

Main Features

The E5372 mainly supports the following features:

- LTE Cat.4 150Mbps DL / 50Mbps UL
- Wi-Fi 2*2; 2.4G/5G support; Wi-Fi 802.11 a/b/g/n
- 1780mAh Battery: Up to 6 hours working time. 300h standby time
- 10 Wi-Fi users + 1 USB user.
- HUAWEI Mobile Wi-Fi app(Download from Apple Store or Google play Store)
- Charger other devices as a power bank
- To extend Wi-Fi coverage as a Wi-Fi repeater

Application Scenarios

Wi-Fi devices (such as smartphones, tablet computers, and game consoles) or computers can all access the Internet through Mobile Wi-Fi . The specific connection procedure depends on the operating system of the Wi-Fi device or computer. Establish a connection according to your device's specific instructions.

To access the Internet through a USB port connection, install the driver according to the instructions.

Scenario 1: Connecting multiple devices through Wi-Fi



Scenario 2: Connecting a single device through USB

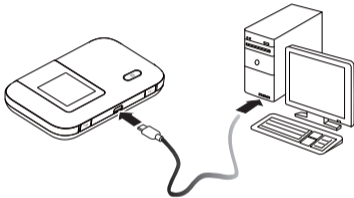

Scenario 3: Connecting multiple devices through Wi-Fi and USB simultaneously

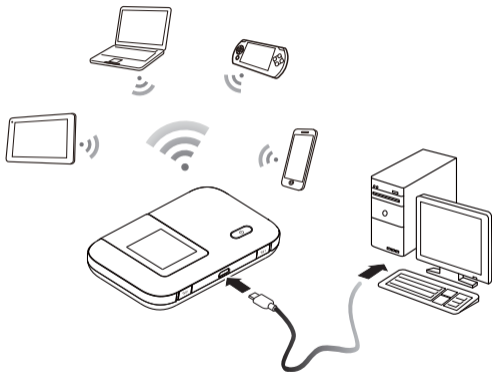

Appearance

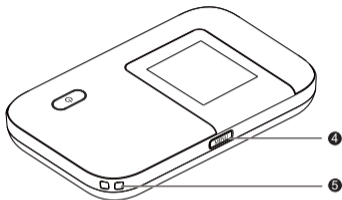
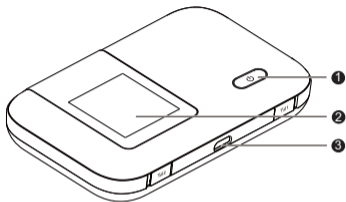

- ❶ Power button
- ❷ Screen
- ❸ Micro USB port
- ❹ MENU button
- ❺ Lanyard hole

Screen

Home screen

❶ Roaming

R: Data roaming turned on.

❷ Signal strength

📶: Signal strength from weak to strong.

❸ Network type

2G/3G/4G: Connected to a 2G/3G/4G network.

❹ Wi-Fi

- Wi-Fi turned on.
- Number of connected Wi-Fi devices.
- 5G: 5G turned on.

❺ Battery

🔋: Battery level from low to high.

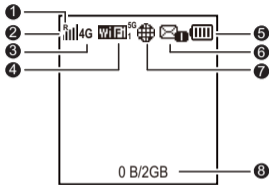

⑥ SMS

- New messages.
- Number of new messages.

⑦ Network connection status

Internet connection is set up.

⑧ Traffic statistics

- Data usage this month.
- Monthly data usage limit.

Note:

- To set the start date of the monthly data usage statistics and data usage limit, go to the web management page.
- Data traffic information is for your reference only. For more accurate data traffic information, please consult your service provider.

Menu screen

❶ Back

Return to the previous screen.

❷ Options

❸ Operation tips

Press the **MENU** button to scroll down, and press the  button to confirm your selection.

Update screen

❶ New software

Updates are available.

❷ Update

Press the  button to start the update.

❸ Cancel

Press the **MENU** button to ignore the update.

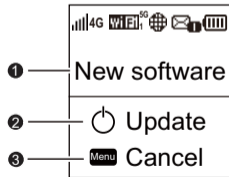
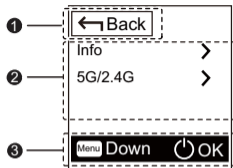

SSID and Wireless Network Encryption Key

When a Wi-Fi device establishes a connection to the Mobile Wi-Fi for the first time, you may need to enter the default Service Set Identifier (SSID) and wireless network encryption key.

The default SSID and encryption key are printed on the Mobile Wi-Fi label.

It is recommended that you can log in to the web management page and change your SSID and wireless network encryption key.

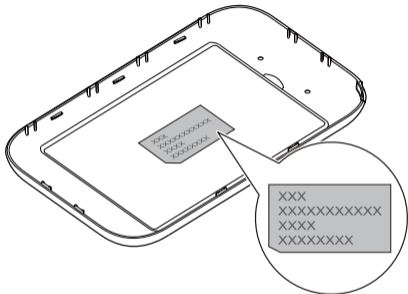

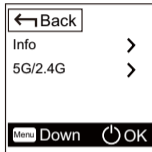

To view the current SSID and wireless network encryption key on the screen:

1. Press the **MENU** button to display the menu.

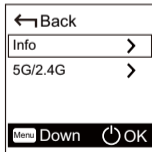

2. Press the **MENU** button to scroll to **Info**.



3. Press the  button to enter **Info**.



Getting Started

Installing

Install the SIM card, microSD card, and battery according to the illustration.

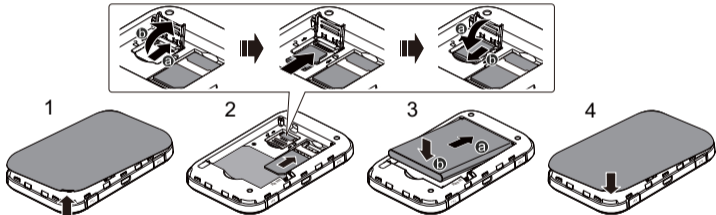

Note:

The microSD card is an optional accessory. If no microSD card is included in the package, please purchase one separately.

Charging the Battery

If the Mobile Wi-Fi has not been used for a long time or if the battery is fully depleted, the Mobile Wi-Fi may not power on immediately after the charger is plugged in. Please charge the battery for a while before attempting to power on the Mobile Wi-Fi .

Method 1: Use the charger to charge the device

Note:

- Only use chargers compatible with the Mobile Wi-Fi and provided by a designated manufacturer. Use of an incompatible charger or one from an unknown manufacturer may cause the Mobile Wi-Fi to malfunction, fail, or could even cause a fire. Such use voids all warranties, whether expressed or implied, on the product.

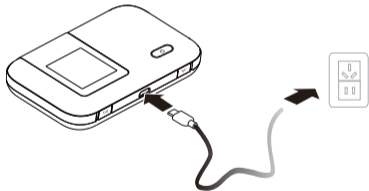

- The charger is an optional accessory. If it is not included in the package, you may contact an authorized dealer to buy a charger compatible with the Mobile Wi-Fi .
- The Mobile Wi-Fi 's charger model is HW-050100XYW. X and Y represent letters or numbers that vary by region. For details about the specific charger model, contact an authorized dealer.

Method 2: Charge the device through a computer connection

Use the data cable provided with your device to connect the Mobile Wi-Fi to the computer.

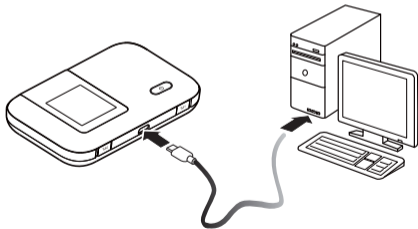

Supplying Power to Devices

You can connect the Mobile Wi-Fi to the AF10, and then connect the AF10 to other devices, such as a mobile phone, MP3 player, MP4 player, or Bluetooth headset. In this case, the Mobile Wi-Fi works as a charger and supplies power to those devices.

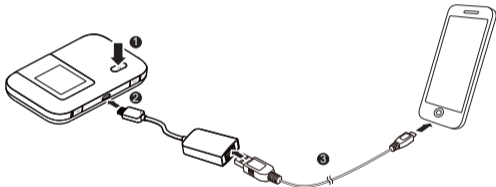

Note:

- The AF10 is an optional accessory. If it is not included in the package, you can purchase one separately.
- For details about the AF10, see its user manual.

Connecting to the Internet via Wi-Fi



The Mobile Wi-Fi 's management parameters have been preset according to your operator's requirements. You can quickly connect to the Internet by following these steps:

Step 1: Turn on the Mobile Wi-Fi

Press and hold the  button until the screen lights up, indicating that the Mobile Wi-Fi is turned on.

You can log in to the web management page and turn the fast boot function on or off. This function greatly reduces the Mobile Wi-Fi 's boot-up time.

Note:

- Press and hold the  button to turn off the Mobile Wi-Fi .
- If your Mobile Wi-Fi malfunctions or cannot be properly powered off, press and hold the  button for at least 10 seconds to forcibly power off your Mobile Wi-Fi .
- Please turn the fast boot function off when you are on an airplane.

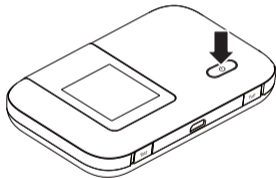

Step 2: Establish a Wi-Fi connection (using a computer running the Windows 7 operating system as an example)

1. Ensure that the Mobile Wi-Fi 's Wi-Fi function is on.
2. Select **Start > Control Panel > Network and Internet > Connect to a network**.

Note:

Before establishing a Wi-Fi connection, ensure that the computer is equipped with a wireless network adapter. If the computer indicates a wireless network connection, the wireless network adapter can be used. Otherwise, verify that your wireless network adapter is working properly.

3. Select the wireless network connection with the Mobile Wi-Fi 's SSID and click **Connect**.

Note:

- If the wireless network connection is encrypted, enter the correct wireless network encryption key.
- To view the current SSID and wireless network encryption key, see the operations in the "SSID and Wireless Network Encryption Key" section on page 10.

4. Wait a moment for the wireless network connection icon to appear in the system tray in the lower right corner of the computer screen. The wireless network connection is then established.

Step 3: Connect to the Internet

If data is transmitted, the Mobile Wi-Fi will automatically connect to the Internet. If data is not transmitted for a period of time, the Mobile Wi-Fi will automatically disconnect from the network connection.

Note:

You can log in to the web management page and enable or disable the automatic dialing while roaming function. If this function is turned off, when the Mobile Wi-Fi enters a roaming network, it will automatically disconnect from the Internet connection that has already been established. You will need to manually establish this network connection again.

Logging In to the Web Management Page

1. Make sure the connection between the Mobile Wi-Fi and the Wi-Fi device or computer is working normally.
2. Open the browser, and enter **http://192.168.8.1** in the address box.
3. Enter the user name and password to log in to the web management page.

Note:

- The default user name is **admin**.
- The default password is **admin**.

Daily Use

Battery Saving Mode

If the Mobile Wi-Fi has been inactive for some time, the Mobile Wi-Fi enters the standby mode, in which the display screen turns off. Pressing any button causes the display screen to light up.

When the Mobile Wi-Fi is being powered only by the battery, you can choose to enable or disable the automatic Wi-Fi turnoff function. If this function is enabled and if no Wi-Fi devices access the Mobile Wi-Fi for a period of time, the Wi-Fi turns off automatically. You can press any button to turn the Wi-Fi on again.

Verifying the PIN

If the PIN verification function is enabled, log in to the web management page and enter the correct PIN according to the instructions. PIN/PUK codes are supplied by your operator along with the SIM card. For details, please consult your operator.

Restoring to Factory Settings

If you forget some configuration parameters, you can restore the Mobile Wi-Fi to its factory settings and then configure the Mobile Wi-Fi again.

Press and hold the **Reset** button until the display screen turns off. The Mobile Wi-Fi is then restored to its factory settings.

Note:

After you carry out this operation, the Mobile Wi-Fi 's personal configuration parameters will all be deleted. All configurations on the web management page will be restored to the factory settings.

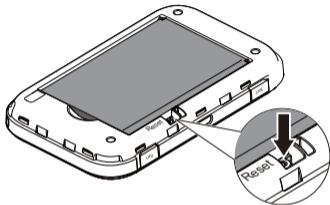

Example 1: Connecting to a Game Console (for example, PSP) through Wi-Fi

1. On the PSP, turn on the WLAN.
2. Choose **Settings** > **Network Settings**.
3. Select **Infrastructure Mode**.
4. Select **New Connection**, and enter the connection name.
5. Select **Scan** to search for wireless networks. A list of access points will be displayed on the screen.
6. Select the access point with the Mobile Wi-Fi 's SSID, and press the ► button on the PSP. Confirm the SSID, and enter the correct wireless network encryption key.
7. Press the ► button to proceed to the next step, and then press the X button to save settings.

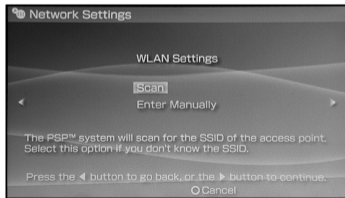
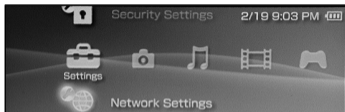

8. Select **Test Connection** to test whether the network connection is successful.
9. You can now open the browser and access the network.

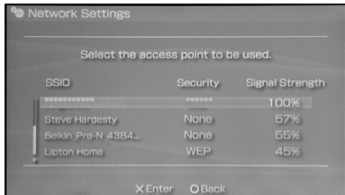

Example 2: Connecting to a Tablet Computer (for example, iPad) through Wi-Fi

1. Touch **Settings** > **WLAN** to turn on WLAN.
2. The tablet computer automatically searches for wireless connections and displays a list of access points.
3. Select the access point with the Mobile Wi-Fi 's SSID.
4. If required, enter the correct wireless network encryption key, and tap **Join**.
(The lock icon indicates that the encryption key is required to connect to this wireless network.)

Note:

Wi-Fi devices, such as an iPhone, iPod touch, PS3 and NDSi, can all access the Internet through the Mobile Wi-Fi . For specific operations, refer to the Wi-Fi device's user manual.

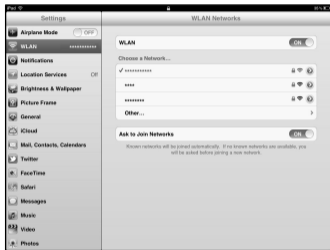

Tips

When the Mobile Wi-Fi is in use for an extended period of time, it will become warm and may overheat. Should this happen, the Mobile Wi-Fi will automatically close the network connection and turn off to protect itself from damage. If this occurs, place the Mobile Wi-Fi in a well ventilated space to allow the heat to dissipate, then turn it on and continue to use it as normal.

If you are unable to use the Mobile Wi-Fi as normal, try the following:

- Consult the online help on the web management page.
- Restart the Mobile Wi-Fi .
- Restore the Mobile Wi-Fi to the factory settings.
- Consult your operator.