

# **TOSHIBA**

INSTRUCTION MANUAL

MODE D'EMPLOI



# PDR-M70

DIGITAL STILL CAMERA

[Downloaded From camera.usermanual.com](http://camera.usermanual.com)

# TOSHIBA

## INSTRUCTION MANUAL

ENGLISH

To ensure that you use the Toshiba PDR-M70 Digital Still Camera safely and correctly, read this Instruction Manual carefully before you start using the camera. Once you have finished reading this Instruction Manual, keep it handy at all times.

DIGITAL STILL CAMERA

# PDR-M70

In the space provided below, please record the model and Serial No. of your camera.

Model No. PDR-M70 [www.toshiba.com/usermanual.com](http://www.toshiba.com/usermanual.com)

Serial No. \_\_\_\_\_

Please retain this information for future reference.

# Attention

## For customers in the U.S.A.

DIGITAL STILL CAMERA PDR-M70



Tested To Comply  
With FCC Standards

FOR HOME OR OFFICE USE

### FCC Statement

This device complies with Part 15 of the FCC Rules. Operation is subject to the following two conditions:

- (1) This device may not cause harmful interference, and
- (2) this device must accept any interference received, including interference that may cause undesired operation.

### NOTE

This equipment has been tested and found to comply with the limits for a Class B digital device, pursuant to Part 15 of the FCC Rules. These limits are designed to provide reasonable protection against harmful interference in a residential installation.

This equipment generates, uses and can radiate radio frequency energy and, if not installed and used in accordance with the instructions, may cause harmful interference to radio communications. However, there is no guarantee that interference will not occur in a particular installation. If this equipment does cause harmful interference to radio or television reception, which can be determined by turning the equipment off and on, the user is encouraged to try to correct the interference by one or more of the following measures:

- Change the direction of the radio or TV antenna.  
Move the equipment or the radio or TV. For example, if the equipment is to the right of the TV, move it to the left of the TV.  
Or, move the equipment farther away from the radio or TV.
- Plug the equipment into a different outlet. Don't plug your radio or TV into the same circuit as your equipment.
- Ensure that all expansion slots (on the back or side of the equipment) are covered.  
Also, ensure that all metal retaining brackets are tightly attached to the equipment.
- If these suggestions don't help, consult your equipment dealer or experienced radio/TV technician for help.

[Downloaded From camera-usermanual.com](http://camera-usermanual.com)

led From camera-usermanual.com

# Before Reading This Manual

Thank you for purchasing the Toshiba PDR-M70 Digital Still Camera.

To ensure that you use this camera safely and correctly, read this Instruction Manual carefully before you start using the camera. Once you have finished reading this Instruction Manual, keep it handy at all times.

## Trademark Information

- **Macintosh** and **QuickTime** are trademarks of Apple Computer, Inc.
- **MS-DOS** and **Windows** are registered trademarks of the Microsoft Corporation of the U.S. registered in the USA and other countries.  
Windows is an abbreviated term referring to the Microsoft Windows Operating System.
- **SmartMedia** is a trademark of Toshiba Corporation.
- Other companies or product names are trademarks or registered trademarks of the respective companies.

## Conventions Used In This Manual

### IMPORTANT

- Indicates items or details that you should observe to prevent loss of data, malfunction and impaired performance. Also indicates information relating to specifications and functions.

### Memo

- Indicates extra useful information.

☞ Indicates another page to refer to for extra information.





# The Function Map (continued)

## Playing back your photographed images

**STEP1** – Let's play back some images. (P. 80)

**STEP2** – Selecting the various ways to play back images.

- Playing Back Movies (P. 81)
- Enlarging Photographed Images (P. 85)
- Auto Playback (P. 86)
- Simple Movie Playback (P. 87)
- Displaying a List of Images (P. 84)
- Displaying Detailed Information of Images (P. 88)
- Switching LCD Monitor Display (P. 88)

## Setting the basic camera settings

- Setting the Date and Time (P. 115)
- Formatting SmartMedia™ (P. 94)
- Adjusting the LCD Monitor Brightness (P. 119)
- Turning the LCD Monitor Display OFF (P. 79)
- Turning the Beep OFF (P. 115)
- Switching the Folder (P. 89)
- Setting the Color of Images (Color/Black and White/Sepia) (P. 77)
- Changing the Power OFF Time (P. 114)
- Changing the LCD Monitor Display Language (P. 116)
- Resetting the Frame No. (P. 116)

## Erasing images

**STEP1** – Erasing Images (P. 90)

**STEP2** – Other ways to erase images

- Erasing All Images in a Folder (P. 92)
- Erasing All Still Image Folders (P. 92)
- Formatting SmartMedia™ (P. 94)

## You can also do this

–The PDR-M70 also has lots of other features.–

- Protecting Images (P. 107)
- Changing the size of Images (P. 95)
- Compressing Images (P. 97)
- Copying Images to another SmartMedia™ (P. 99)
- Print Information (P. 103)
- Displaying Detailed Information of Images (P. 88)
- Taking and Playing Back Photographs on a TV (P. 121)
- Recording and Playing Back Only Audio (P. 110)
- Using an External Flash (P. 75)

## Loading images on a personal computer

Loading Images on a Personal Computer (P. 123), separate "Personal Computer Interface User's Manual"





# Contents (continued)

The name in parentheses ( ) is the function name on the PDR-M70.

■ Changing the Preset Conditions (RECORDING MENU) .....	76
PREVIEW .....	77
COLOR .....	77
ISO .....	78
SHARPNESS .....	78
CONTRAST .....	78
DIGITAL ZOOM .....	79
LCD DISPLAY .....	79
LCD * .....	79

## Playing Back Images

■ Playing Back Photographed Images (Single-Frame Playback) .....	80
■ Playing Back Movies .....	81
■ Displaying a List of Images (Thumbnail Display) .....	84
■ Enlarging Photographed Images (Zoom Playback) .....	85
■ Auto Playback (Slideshow) .....	86
■ Playback of Multi Image Pictures .....	87
■ Switching Displays/Displaying Image Information .....	88
■ About Folders .....	89

## Erasing Images

■ Erasing Images (Erase Frame) .....	90
■ Erasing Folders (All Images in a Folder/ All Still Images) .....	92
■ Formatting the SmartMedia™ .....	94

## Handy Functions

■ Reducing the Image Size (Resize) .....	95
■ Compressing Images (Quality) .....	97
■ Copying Images .....	99

■ Print Information .....	103
■ Protecting Images .....	107
Protecting an Image .....	107
Removing the Protection .....	109
■ Recording/Playing Back Audio .....	110
Recording Audio .....	110
Playing Back Audio .....	111
Erasing Files .....	112

## Other Applications

■ Basic Photographic Settings (SET-UP mode) .....	113
AUTO POWER OFF .....	114
SOUND .....	115
TIME & DATE .....	115
OSD LANGUAGE .....	116
VIDEO OUT .....	116
FRAME NUMBER .....	116
RESET .....	118
■ Adjusting the LCD Monitor Brightness .....	119
■ About the Color of the Viewfinder LED .....	120
■ Taking and Playing Back photographs on a TV .....	121
■ Transferring Images to a PC .....	123
■ Separately Sold Accessories .....	124
■ Connecting to Other Devices .....	125

## Additional Information

■ Demo Mode .....	126
How to enter the Demo Mode .....	126
How to return to the Normal Mode .....	126
■ Specifications .....	127
■ Warnings and Messages Displayed on LCD Monitor .....	132
■ Troubleshooting .....	134
■ Glossary .....	137



## Safety Precautions (continued)

### **DANGER**

**Do not heat, disassemble or throw the battery into fire or water.**

Doing might cause it to rupture, ignite or heat up, resulting in fire or major injury.



**Do not strike the battery with a hammer, or step on, drop or subject the battery to strong impact.**

Doing so might cause it to rupture, ignite or heat up, resulting in fire or major injury.



**Use only the optional, recommended battery charger. Do not use any other battery charger.**

Charging the battery by any other battery charger might cause it to rupture, ignite or heat up, resulting in fire or major injury.



**Use the battery only for its originally intended purpose.**

Using the battery for any other purpose might cause it to rupture, ignite or heat up, resulting in fire or major injury.



### **DANGER** (continued)

**Do not carry the battery or store it together with other metallic objects such as a ball-point pen or necklace.**

This might short-circuit the battery's + and - terminals. This might cause the battery to rupture, ignite or heat up, resulting in fire or major injury.





## Safety Precautions (continued)

### **WARNING** (continued)

Do not disassemble, change or repair the camera.

This might cause fire or electric shock. For details on repair and internal inspection, consult the store of purchase, or please contact the technical support number.



Do not touch power or TV antenna cords during a thunderstorm.

This might cause electric shock.



Do not use the camera while you are walking, driving or riding a motorcycle.

This might cause you to fall over or result in a traffic accident.



Use only the specified batteries or the specified AC adapter.

Use of a battery or AC adapter other than specified, might cause fire, defects or malfunctions.



### **WARNING** (continued)

Keep the batteries out of the reach of children.

If a child swallows a battery, this might result in poisoning. If a child swallows a battery, immediately consult a physician.



If battery fluid enters the eyes, immediately rinse with fresh water and consult with a physician to receive treatment.

If left untreated, damage to the eye could be permanent.



Use the AC adapter only with the indicated power supply voltage (100 to 120V, 230V AC)

Use with any other power supply voltage might cause fire or electric shock.





### Additional Information

When playing back movie images, switching is between standard and image only.

## Safety Precautions (continued)

### CAUTION (continued)

Do not look at the sun through the camera viewfinder.

This may cause injury of the eyes.



Do not use the flash close to anyone's eyes.

This might cause temporary damage to the person's eyesight.



Do not walk around with the camera swinging from the shoulder strap.

If you walk around with the camera hanging from your hand through the shoulder strap, the camera might bump into people or other objects, damaging the camera or causing an injury.



Before you store or dispose of used batteries insert them in their battery covers or tape the plus (+) and (–) terminals with insulating tape.

If stored or disposed of without doing this, the batteries may make contact with metal objects, resulting in fire or injury due to leaking of battery fluid, overheating or bursting of the battery.



### CAUTION (continued)

Do not subject the LCD monitor to impact.

If the status display is impacted, the glass on the screen may be broken and internal fluid may leak.

If the internal fluid enters your eyes or sticks to your body or clothes, immediately rinse with fresh water. If the internal fluid enters your eyes, immediately consult a physician to receive treatment.



Consult your dealer regarding the internal cleaning of the camera once every two years.

If dust is allowed to accumulate inside the camera for a long time, this might result in fire or defects. Consult your dealer regarding the cleaning costs.





## Using Your Camera Correctly (continued)

### ● Carrying Out Maintenance on Your Camera

- To prevent the lens, surface of the LCD monitor or viewfinder from being scratched, blow off any dust on these parts with a blower brush and lightly wipe with a soft dry cloth.
- Clean the body of the camera with a soft dry cloth. Do not use volatile liquids such as paint thinner, benzene or insecticide, as these may react with the camera body and cause deformation or remove the coating.

Getting  
Ready

Taking  
Photographs

Playing  
Back Images

Erasing  
Images

Handy  
Functions

Other  
Applications

Additional  
Information



## Separately Sold Accessories

[illegible]

\* The image before the photograph is taken is slightly less clear than playback images. (This is because they are displayed at a lower resolution.)

¥ The display unit varies according to the output system.

With the NTSC system, images can be displayed simultaneously on the LCD monitor and TV during photography and playback.

Charges the lithium-ion battery pack (PDR-BT2) in a short time

With the PAL system, images cannot be displayed simultaneously. During photography, images are displayed only on the LCD monitor, and during playback, images are displayed only on the TV.

Color Adapter ring (PDR-AR52)

[illegible]

Copyright © 2014 by the author(s). All rights reserved. No part of this publication may be reproduced, stored in a retrieval system, or transmitted, in any form or by any means, electronic, mechanical, photocopying, recording, or by any information storage or retrieval system, without prior written permission from the author(s).

[illegible]

¥ To cancel write-protect signal processing in progress after photography canceled if set at step 4.

Memo ON ¥ Charging of flash in progress

Memo Auto Power OFF (Photography is not possible.)

• **Auto Power Off** (function does not operate during automatic playback).

¥ Only when playing back movie images, switching is between standard and image only.



## Using Your Camera Correctly (continued)

- When the battery is not in use, be sure to remove it from the camera body or battery charger (sold separately). If the battery is left attached to the camera body or battery charger, a minute current will flow even if the power is turned OFF. This will result in overdischarge and the battery may no longer be useable.
- Store the battery in a cool place with the battery cover attached. We recommend a dry place with a surrounding temperature of +15°C (+59°F) to +25°C (+77°F). Avoid storing the battery in extremely hot or cold places.

### Charging the Battery

- When you use the battery for the first time or when the battery has not been used for a long time, be sure to charge the battery before use.
- The battery can be charged within this camera body using the AC adapter supplied with the PDR-M70 (▶ page 28). The battery takes about five hours to charge.
- If you use the battery charger (sold separately), the battery (PDR-BT2) can be charged in about 70 minutes.
- This rechargeable battery does not need to be fully discharged or exhausted before being charged.
- The battery may feel warm after it has been charged or immediately after being used. This is normal and not a malfunction.
- The battery can be charged at temperatures between 0°C (+32°F) and +40°C (+104°F), but should be charged between +10°C (+50°F) and +30°C (+86°F) to obtain maximum battery performance.
- Do not recharge a fully charged battery.

### Caution when disposing a battery

Bij dit produkt zijn batterijen geleverd. Wanneer deze leeg zijn, moet u ze niet weggooien maar inleveren als KCA.



Batteries are included with this product. When they are no longer useable, you should not throw them away. Instead, properly dispose of them as small chemical waste.

- 109 -

# Accessories

Make sure that you have all of the items below before you start using your camera.

Lithium-ion battery pack (1)

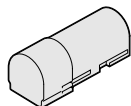

Shoulder strap (1)

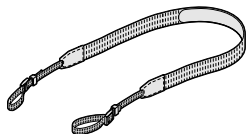

SmartMedia™  
(16MB, 3.3V) (1)



- Anti-static case (1)
- Labels (2)

AC adapter (1)  
(PDR-AC10, PDR-AC10E or PDR-AC10U)

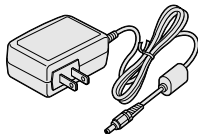

PDR-AC10  
(for U.S.A. and Canada)

Strap attachment fitting



Software application  
(CD-ROM)

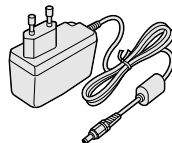
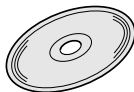

PDR-AC10E  
(for European Continent)

AV cable (1)

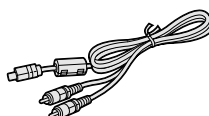

Soft case

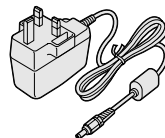
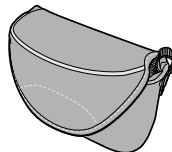

PDR-AC10U  
(for U.K.)

USB cable (1)

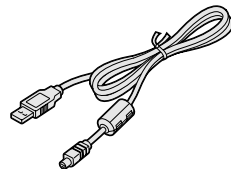

Lens cap



- Instruction Manual (this manual)
- Software Manual

# Separating the Head from the Body (continued)

Getting Ready	The LED color may differ from the actual color of the subject. The LED color may differ from the actual color of the subject. The LED color may differ from the actual color of the subject.
Taking Photographs	When the camera is in the standby mode, the LCD monitor is turned off. When the camera is in the standby mode, the LCD monitor is turned off. When the camera is in the standby mode, the LCD monitor is turned off.
Playing Back Images	When the camera is in the playback mode, the LCD monitor is turned on. When the camera is in the playback mode, the LCD monitor is turned on. When the camera is in the playback mode, the LCD monitor is turned on.
Erasing Images	When the camera is in the playback mode, the LCD monitor is turned on. When the camera is in the playback mode, the LCD monitor is turned on. When the camera is in the playback mode, the LCD monitor is turned on.
Handy Functions	When the camera is in the playback mode, the LCD monitor is turned on. When the camera is in the playback mode, the LCD monitor is turned on. When the camera is in the playback mode, the LCD monitor is turned on.
Other Applications	When the camera is in the playback mode, the LCD monitor is turned on. When the camera is in the playback mode, the LCD monitor is turned on. When the camera is in the playback mode, the LCD monitor is turned on.
Additional Information	When the camera is in the playback mode, the LCD monitor is turned on. When the camera is in the playback mode, the LCD monitor is turned on. When the camera is in the playback mode, the LCD monitor is turned on.

# Names of Parts (continued)

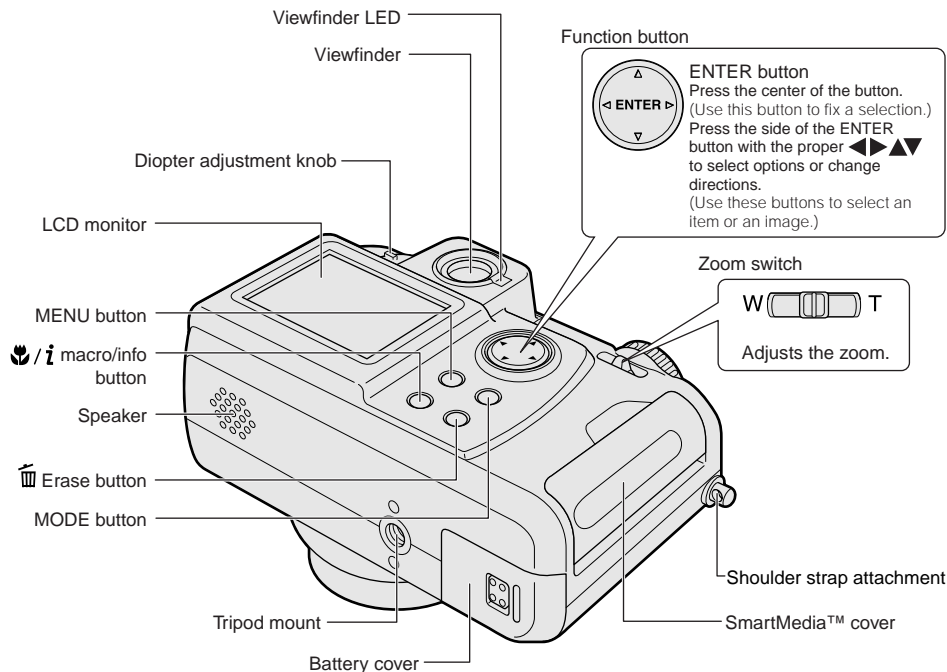





# Names of Parts (continued)

## Status display

This display indicates the camera's status. You can verify the camera's status even if the LCD monitor is not on.

The text, numbers and icons that are displayed in the status display vary according to the setting. The status display backlight lights for about five seconds in the following instances:

- When the shutter button is pressed
- When one of the self-timer, image quality or flash buttons is pressed

**Example of counter display**  
(The display varies according to the mode dial setting.)

	Time display: Power switch OFF, in [ ] or [SET-UP] mode
	Possible number of shots: In [ ], [Tv] or [Av] mode
	Possible photographic time: In [ ] mode
	PC indication: In [ ] mode
	Recording/playback elapsed time: In [ ] mode

**In [ ] mode (↪ P. 110)**

- : Playing back
- : Stop
- : Pause
- : Recording

**Remaining battery power**

**SmartMedia™ loaded symbol**

**Flash photography (↪ P. 58)**  
 AUTO : Auto  
 AUTO : Red-eye Auto  
 : Red-eye forced flash  
 : Forced flash  
 : Suppressed flash  
 : Slow synchro

**Image quality**  
 ★★ ★ : FINE  
 ★ ★ : NORMAL  
 ★ : BASIC

**Macro photography (↪ P. 56)**

**Self-timer time**  
 10s : After 10 seconds  
 2s : After 2 seconds

**Self-timer photography (↪ P. 57)**

**1-shot photography**

**Burst photography (↪ P. 61)**

**Image size (↪ P. 46)**  
 HALF: 1024 x 768 pixel (still image), 160 x 120 pixel (movie)  
 FULL: 2048 x 1536 pixel (still image), 320 x 240 pixel (movie)

**Example of counter display**  
 000:00:00  
 AUTO HALF FULL 102s  
 ★ ★ ★



## Attaching the Shoulder Strap (continued)

- 3** Pass the leading end through the fastener and pull tight.

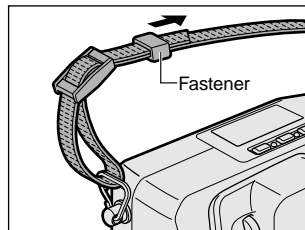

- 4** Attach the shoulder strap in the same way on the shoulder strap attachment fitting on the opposite side of the camera.







## Preparing the Battery (continued)

- 3** Load the battery in the battery compartment making sure that it is loaded in the correct direction as shown in the figure on the right.

Insert the terminal (metal-colored part) first when loading the battery.

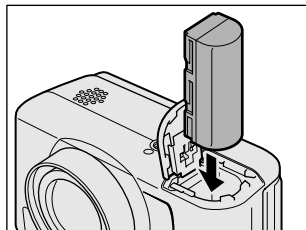

- 4** Close the battery cover <sup>1</sup>, and slide the battery cover <sup>2</sup>.

Make sure that the battery cover is firmly closed.

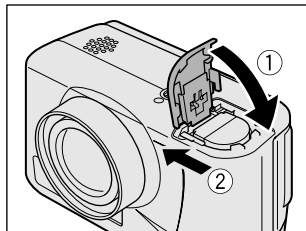

## Removing the Battery

Reverse the procedure for "Loading the Battery" and remove the battery.

### IMPORTANT

- When removing the battery, take care not to drop it by mistake.
- Store batteries with the electrode cover attached.

The meaning of the LED color may differ  
on Other Devices (page 125)

[illegible]

Color Adapter III (SLATE) (R-AR52) 16MBEX 13 display 13





...the power on. ... So the

- When playing back movie images, switching is between standard and image only.

# Preparing the Battery (continued)

## Battery Wear

When the power is ON, the remaining battery power is displayed on the LCD monitor and the status display.

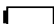
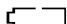
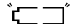
LCD Monitor	Status Display	Remaining Battery Power
		Sufficient battery power
		Half battery power or less
		Little battery power left (Power is cut.) Either recharge, or replace with a new battery.
No indication	 Blinks twice	No battery power left (Power does not turn ON.) Either charge, or replace with a new battery.

### Memo

- When you use the camera for the first time or if you have left the camera for a long time without the battery loaded, set the date (▶ Page 115).
- The battery can be charged in about 70 minutes if the battery charger (sold separately) is used.
- The following shows the approximate number of images that can be photographed continuously using a fully charged battery (PDR-BT2) in room temperature with the flash used for half of the images. Note, however, that these figures vary according to the operating temperature of the camera and the detail of the image being photographed, or length of time viewing the images in play mode.  
The number of photographs you can take is reduced when battery (PDR-BT1) is used.  
    With the LCD monitor on: Approx. 110 images  
    With the LCD monitor off: Approx. 165 images



# About SmartMedia™

"SmartMedia™" is a storage medium for saving images that you have photographed. Even if the camera's power is turned OFF, the images saved on the SmartMedia™ are not erased. SmartMedia™ can be repeatedly read and written.

SmartMedia™ having the following storage capacity can be used on your camera.

2MB /4MB/8MB/16MB (standard accessory)/32MB/64MB (all 3.3 V types)

You can also connect the PC card adapter and floppy disk adapter (► Page 124) sold separately to transfer images to a PC.

## Notes on SmartMedia™

- Remove and insert SmartMedia™ with the camera's power turned OFF.
- Recorded data may be erased (destroyed) in the situations listed below. Note that Toshiba Corporation accepts no responsibility whatsoever for the loss (destruction) of recorded data in these situations:
  - When the SmartMedia™ is used incorrectly by the user or a third party
  - When the SmartMedia™ is exposed to static electricity or electrical noise
  - When the SmartMedia™ is removed or the camera is then switched OFF during data recording, data erasing, frame advance when images are being played back or during formatting of the SmartMedia™.
- We recommend copying and saving important data onto another storage medium (floppy disk, hard disk, MO disk, etc.).
- Never remove the SmartMedia™ or switch the camera OFF during data recording or during data erasing (SmartMedia™ formatting). These actions might damage the SmartMedia™.
- Use only the SmartMedia™ specified for use with the PDR-M70. The use of other SmartMedia™ could damage the camera.
- SmartMedia™ are precision electronic devices. Do not bend, drop, or subject SmartMedia™ to excessive shocks. Also, do not carry SmartMedia™ in locations such as a trouser pocket. This might subject the SmartMedia™ to excessive force when you sit down, damaging the SmartMedia™.
- Do not use or store SmartMedia™ in environments likely to be affected by strong static electricity or electrical noise.
- Do not use or store SmartMedia™ in very hot, humid or corrosive environments.





## About SmartMedia™ (continued)

- 3** Gently insert the SmartMedia™ as far as it can go with the SmartMedia™ electrodes (metal contacts) facing the rear of the camera.

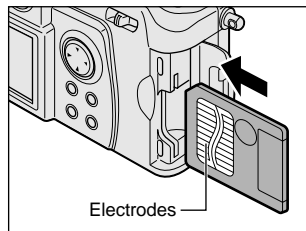

- 4** Close the SmartMedia™ cover.  
Before you use a new SmartMedia™, be sure to format the SmartMedia™ (▶ Page 94).

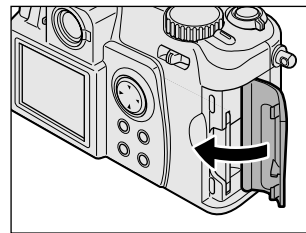

## Removing SmartMedia™

### IMPORTANT

- Never open the SmartMedia™ cover or remove the SmartMedia™ while data is being recorded to the SmartMedia™ (viewfinder is lit red). This might damage the SmartMedia™ or corrupt the data on the SmartMedia™.

- 1** Set the Power switch to [OFF].

▶ Turning the Power OFF ▶ Page 39

# Set the language of the camera (page 125)

The language of the camera is set to English. The language of the camera can be changed to any of the following languages: English, Spanish, French, German, Italian, Portuguese, Russian, Chinese, Japanese, Korean, Thai, Vietnamese, and Indonesian. The language of the camera can be changed by the following steps:

1. Press the **Language** button on the LCD monitor.
2. The language of the camera is displayed on the LCD monitor.
3. Press the **Language** button on the LCD monitor.
4. The language of the camera is changed to the language you selected.

The language of the camera can be changed by the following steps:

1. Press the **Language** button on the LCD monitor.
2. The language of the camera is displayed on the LCD monitor.
3. Press the **Language** button on the LCD monitor.
4. The language of the camera is changed to the language you selected.

**MEMO**

The image of the photograph is taken is slightly less clear than playback images. (This is because they are displayed at a lower resolution.)

✕ The display of the photograph is according to the output system.

With the LSC system, the LCD monitor is displayed simultaneously on the LCD monitor and TV during this charger is connected to a household power outlet and the photograph and playback.

✕ The LCD monitor displays the photograph and playback.

With the LSC system, images cannot be displayed simultaneously. During photography, images are displayed only on the LCD monitor, and during playback, images are displayed only on the TV.

**Color Adapter (PDR-AR52)**

**TV**

The camera can be connected to a television set by the following steps:

1. Press the **TV** button on the LCD monitor.
2. The camera is connected to the television set.
3. The camera is displayed on the television set.

The camera can be connected to a television set by the following steps:

1. Press the **TV** button on the LCD monitor.
2. The camera is connected to the television set.
3. The camera is displayed on the television set.

**MEMO**

The camera can be connected to a television set by the following steps:

1. Press the **TV** button on the LCD monitor.
2. The camera is connected to the television set.
3. The camera is displayed on the television set.

The camera can be connected to a television set by the following steps:

1. Press the **TV** button on the LCD monitor.
2. The camera is connected to the television set.
3. The camera is displayed on the television set.

**MEMO**

The camera can be connected to a television set by the following steps:

1. Press the **TV** button on the LCD monitor.
2. The camera is connected to the television set.
3. The camera is displayed on the television set.

The camera can be connected to a television set by the following steps:

1. Press the **TV** button on the LCD monitor.
2. The camera is connected to the television set.
3. The camera is displayed on the television set.

# About SmartMedia™ (continued)

## Write Protection

To prevent valuable data from being erased inadvertently, attach the write-protect sticker at the write-protect area. Data can no longer be recorded or erased from SmartMedia™. To write or erase data from SmartMedia™, peel off the sticker.

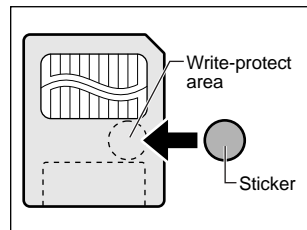

### IMPORTANT

- The write protection may not function if the write-protect sticker becomes dirty. Use a soft dry cloth to wipe away any dirt. Once a sticker is peeled off it cannot be used again.







# LCD Monitor Display (during photography) (continued)

## In [ Tv ] and [ Av ] mode

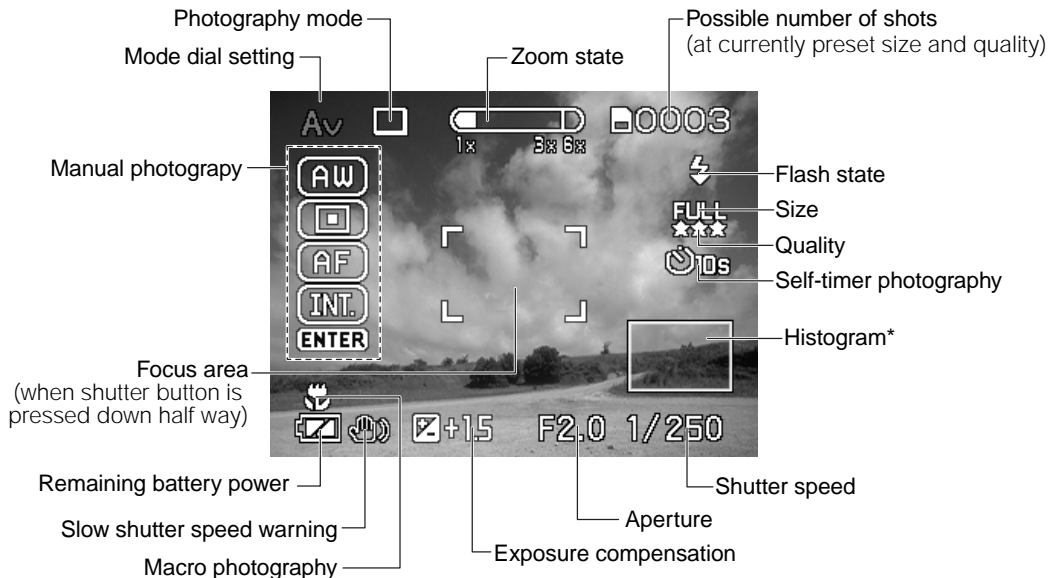

\* Histogram

A histogram is a graphic representation of the tones of the subject. The horizontal axis of the histogram shows the brightness (increasing brightness from left to right) and the vertical axis shows the number of pixels at each brightness level.



# Turning the Power ON/OFF

## Turning the Power ON

**1** Make sure that the SmartMedia™ is correctly loaded. (▶ Page 32)

**2** Set the Power switch to [ON].

When the camera is turned ON, set the mode dial to the desired mode. In the photography modes ([], [], [] or []), the lens extends from the camera body. Remove the lens cap during photography. When the camera is turned ON, the Auto Power OFF function starts to work.

The default setting for the language display for this camera is English. To match the language in your Instruction Manual with the language in the camera, change the language display in the LCD monitor. (▶ Page 113)

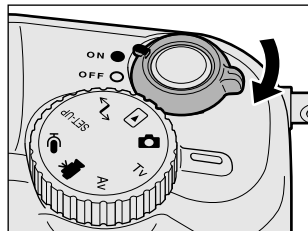

### IMPORTANT

- If no operation is carried out for a fixed amount of time (default: about 1 minute), the power is turned OFF to prevent battery wear. This is called "Auto Power OFF". To return to the normal state, either change the mode dial or press the shutter down half way (▶ Page 41).

About the Auto Power OFF Function ▶ Additional Information, "AUTO POWER OFF (page 114)"

## Turning the Power OFF

**1** Set the Power switch to [OFF].

This turns the power OFF.

Attach the lens cap when you are not using the camera.

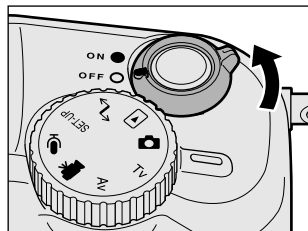

**Sensitive Information (e.g., PII, PHI, NPI, SSN) (continued)**

[illegible]

**Thermium-ion battery pack (PDR-BT2)** The thermium-ion battery pack (PDR-BT2) is taken in slightly less clear than playback images. (This is because they are displayed at a lower resolution.)

**Charger (PDR-CC1, PDR-CC2, PDR-CC3)** The display of SC system images can be displayed simultaneously on the LCD monitor and TV during photography and playback.

**Thermium-ion battery pack (PDR-BT2)** In a short time, with the SC system, images cannot be displayed simultaneously. During photography, images are displayed only on the LCD monitor, and during playback, images are displayed only on the TV.

Color	Adapter ring (PDR-AR52)	Meaning
Blue	Blue	Blue
Green	Green	Green
Yellow	Yellow	Yellow
Red	Red	Red
Purple	Purple	Purple
Brown	Brown	Brown
Black	Black	Black
White	White	White
Grey	Grey	Grey
Orange	Orange	Orange
Pink	Pink	Pink
Lavender	Lavender	Lavender
Cyan	Cyan	Cyan
Magenta	Magenta	Magenta
Olive	Olive	Olive
Slate	Slate	Slate
Gold	Gold	Gold
Silver	Silver	Silver
Platinum	Platinum	Platinum
Rose Gold	Rose Gold	Rose Gold
Dark Grey	Dark Grey	Dark Grey
Light Grey	Light Grey	Light Grey
Dark Blue	Dark Blue	Dark Blue
Light Blue	Light Blue	Light Blue
Dark Green	Dark Green	Dark Green
Light Green	Light Green	Light Green
Dark Yellow	Dark Yellow	Dark Yellow
Light Yellow	Light Yellow	Light Yellow
Dark Red	Dark Red	Dark Red
Light Red	Light Red	Light Red
Dark Purple	Dark Purple	Dark Purple
Light Purple	Light Purple	Light Purple
Dark Brown	Dark Brown	Dark Brown
Light Brown	Light Brown	Light Brown
Dark Black	Dark Black	Dark Black
Light Black	Light Black	Light Black
Dark White	Dark White	Dark White
Light White	Light White	Light White
Dark Grey	Dark Grey	Dark Grey
Light Grey	Light Grey	Light Grey
Dark Blue	Dark Blue	Dark Blue
Light Blue	Light Blue	Light Blue
Dark Green	Dark Green	Dark Green
Light Green	Light Green	Light Green
Dark Yellow	Dark Yellow	Dark Yellow
Light Yellow	Light Yellow	Light Yellow
Dark Red	Dark Red	Dark Red
Light Red	Light Red	Light Red
Dark Purple	Dark Purple	Dark Purple
Light Purple	Light Purple	Light Purple
Dark Brown	Dark Brown	Dark Brown
Light Brown	Light Brown	Light Brown
Dark Black	Dark Black	Dark Black
Light Black	Light Black	Light Black
Dark White	Dark White	Dark White
Light White	Light White	Light White

1. Press the **Power** button to turn the camera on. The camera will start up and the LCD screen will turn on. The camera will be in the **Standby** mode. The LCD screen will show the **Standby** mode screen. The camera will be ready to take pictures.

When the LCD monitor displays the last image, the image is stored in the camera's memory. When the LCD monitor is turned off, the image is stored in the camera's memory. When the LCD monitor is turned on, the image is displayed on the LCD monitor. When the LCD monitor is turned off, the image is stored in the camera's memory. When the LCD monitor is turned on, the image is displayed on the LCD monitor.

- When playing back movie images, switching is between standard and image only.



# How to Press the Shutter Button

The shutter button can be pressed down in two stages: half way down and fully down. When pressed half way down, AF (auto-focus) and AE (auto exposure) are carried out. When pressed fully down, the camera takes a picture.



## Press the shutter button down half way 1 .

AF (auto-focus) and AE (auto exposure) (▶ Additional Information, Glossary) start to function.

When AF or AE are locked, the beep tone (▶ Page 115) sounds and the viewfinder LED turns green.

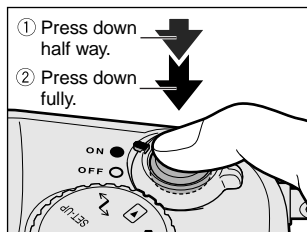

## Press the shutter button down fully 2 .

The camera takes a picture.

The viewfinder LED turns red while image data is being recorded onto the SmartMedia™.

### IMPORTANT

- Never open the SmartMedia™ cover or remove the SmartMedia™ while an image is being recorded. This may corrupt the data on the SmartMedia™ or damage the SmartMedia™ itself.

## D

[led From camera-usermanual.com](http://www.camera-usermanual.com)

# Photography (Auto Photography)

This is the most commonly used photography mode.

In this mode, exposure (combination of shutter speed and aperture) is automatically controlled to facilitate photography. There are two ways of taking photographs in this mode: using the viewfinder and using the LCD monitor.

## Using the Viewfinder

1

**Get ready to take the photograph.**

Load the battery (▶ Page 26) and the SmartMedia™ (▶ Page 32) into the camera.

2

**Set the Power switch to [ON].**

☞ Turning the Power ON ▶ Page 39

3

**Set the mode dial to [  ].**

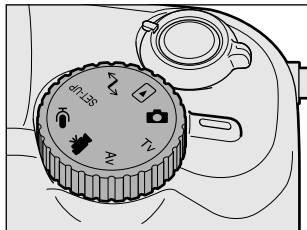

4

**Turn the LCD monitor OFF. (▶ Page 79)**

To reduce the amount of battery wear, we recommend turning the LCD monitor display OFF, and using the viewfinder to take photographs.



**Sensitive Information (continued)**



# Photography (Auto Photography) (continued)

**3** Set the mode dial to [  ].

**4** Look at the image on the LCD monitor to compose the picture.

 To adjust the brightness of the LCD monitor  Page 119



**5** Press the shutter button down half way **1** , and press it down fully **2** .

- Pressing the shutter button down half way adjusts the exposure, and pressing the shutter button down fully takes the shot.
- When the focus and exposure are correctly adjusted, the viewfinder lamp lights (green), and the AF icon turns green.
- If you shoot a still picture, when preview is set to ON (  Page 77 ), a preview image is displayed on screen for about two seconds.
- The viewfinder LED turns red while image data is being recorded onto the SmartMedia™.

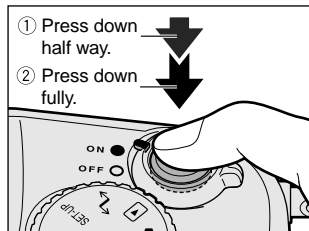

## Memo

- The LCD monitor sometimes displays bright, dark or colored spots at all times. This is not a malfunction. These spots do not appear in the photographed image.
- The image is not displayed on the LCD monitor while the shutter button is pressed down fully.

### Additional Information

When playing back movie images, switching is between standard and image only.

## Setting the Image Size and Quality (continued)



### Take the photograph.

☞ For details on how to take photographs ► Photograph

#### Memo



- To make the image smaller, it is more effective to reduce the size 1 and then reduce image quality 2 .
- After you have taken a photograph, you can change its size (► Page 95) and quality (► Page 97).
- The memory size of the image varies according to the subject.
- The compression ratio is given for reference only.





# Taking Photographs in the [ ] Mode

Select this option to make people stand out with the background out-of-focus.

- 1** Set the mode dial to [  ].
- 2** Press **▲** or **▼** to select [  ] while viewing the LCD monitor.  
[  ] in the LCD monitor is displayed in green.



- 3** Compose the picture, press the shutter button down half way, and press it down fully.  Page 41

**Series Title:** ~~U.S. Bureau of Economic Analysis (continued)~~

The **SPRANGUAGI** also available as separate video items. The meaning of the LED color may differ from the text in the manual. **Graphs or play them back** (page 125) **Other Devices** (page 125)

For the first time, the LCD already contains a D-OF information. The LCD information is used to determine the position of the LCD on the screen.

current state of the art in the field of natural language processing (NLP) and machine learning (ML) for sentiment analysis. The paper discusses the challenges of sentiment analysis, such as the ambiguity of language and the need for large amounts of training data. It also reviews various approaches to sentiment analysis, including rule-based methods, machine learning models, and deep learning architectures. The paper concludes by discussing the future of sentiment analysis and the potential for further research in this area.

**EO OUT** Memo   

The image before the phosphor is taken is slightly less clear than playback images. (This is because

• The display unit varies according to the output system

With the NTSC system, images can be displayed simultaneously on the LCD monitor and TV during

With the PAL system, images cannot be displayed simultaneously. During photography, images are

View: displayed only on the LCD monitor, and during playback, images are displayed only on the TV.

Color Adapter ring (PDR-AR52) is displayed.



...the camera lens off automatically. This function

...ing into the... the LCD...

...the way for an... records

**Turn down fully again & press**

© 2006 American Psychological Association or one of its allied publishers. This article is intended solely for the personal use of the individual user and is not to be disseminated widely. SAGE full-text for this article can be accessed at <http://dx.doi.org/10.1177/0898010106289015>

4. Press the **OK** key. The first image displays the last image in the image sequence.

When the PROTECT screen is displayed again, [ ] is displayed under protected images.

- To cancel write-protect signal or in progress write progress after photography canceled if set at step 4.
- Charging of flash in progress

Auto Power Off (Photography is not possible.)

When playing back movie images, switching is between standard and image only.

# Taking Photographs in the [ ] Mode

Select this option to take photographs of fast-moving subjects.

- 1 Set the mode dial to [  ].
- 2 Press  or  to select [  ] while viewing the LCD monitor.

[  ] in the LCD monitor is displayed in green.



- 3 Compose the picture, press the shutter button down half way, and press it down fully.  Page 41





# Taking Photographs in the [ ] Mode (36-frame multi photography)

This mode takes 36 shots continuously at 0.07 second intervals (15 frames/second). The 36 photographed images are saved as one image (FULL size: 2048 x 1536 pixels).

This mode is effective for continuously photographing moving subjects.

1

Set the mode dial to [  ].

2

Press **▲** or **▼** to select [  ] while viewing the LCD monitor.

[  ] in the LCD monitor is displayed in green.

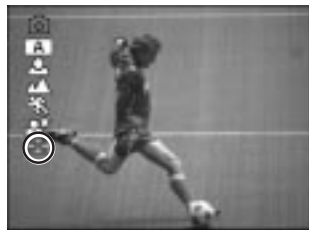

3

Compose the picture, press the shutter button down half way, and press it down fully. **▶ Page 41**

The shutter is opened and closed 36 times.

## Memo

- Though zoom playback is not possible, playback of multi image pictures (▶ Page 87) is possible.
- Photographs cannot be taken at HALF size. When HALF size is set before you set multi photography, the setting is automatically changed to FULL size. When multi photography is canceled, the setting returns to HALF size.

Getting  
Ready

Taking  
Photographs

Playing  
Back Images

Erasing  
Images

Handy  
Functions

Other  
Applications

Additional  
Information



# Zoom Photography (continued)

## Digital Zoom Photography

Set digital zoom as follows.

- 1 Press the MENU button.
  - 2 Use ▲ or ▼ to select [DIGITAL ZOOM] and press ►.
  - 3 Use ▲ or ▼ to select [APPROVED] and press ENTER.
  - 4 Press the MENU button.
  - 5 Pressing the Zoom switch towards the "T" to set the zoom to maximum, and continue to hold down the Zoom switch.
- The image size is fixed to 1024 x 768 pixels.
  - The LCD monitor turns ON automatically. So, compose the picture while viewing the LCD monitor.

**3** Press the shutter button down half way, and press it down fully. **Page 41**

### Memo

- The Zoom switch setting is automatically canceled by either turning the camera OFF or by activation of the Auto Power OFF function.
- You can check the zoom status in the LCD monitor.

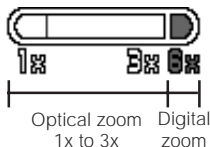

**Sensitive Information (e.g., PII, PHI, NPI, SSN) (continued)**

The **SP** LANGUAGE **graph or play them back** **Viewfinder LED**

## EO 00 Memo

The image on the left (PDR-BT2) is taken is slightly less clear than playback images. (This is because they are displayed at a lower resolution.)

With the LTRC system images can be displayed simultaneously on the LCD monitor and TV during photography and playback.

With the PAL system, images cannot be displayed simultaneously. During photography, images are displayed only on the LCD monitor, and during playback, images are displayed only on the TV.

Color Adapter ring (PDR-AR52)

[illegible]

...with AC Adapter (connected)

When the PROTECT screen is displayed again, [P] is displayed under protected images.

• To cancel write-protect signal processing in progress, press the **ON** button. (Photography is not possible.)

When playing back movie images, switching is between standard and image only.





# Photography Using the Self-timer (Self-timer Photography)

When the self-timer is used, the shutter automatically closes after the preset time (two or ten seconds).

- 1 Set the mode dial to [  ], [  ], [ Tv ] or [ Av ].**
- 2 Press the  self-timer button while viewing the status display area.**

When you press the self-timer button, the following are displayed on the LCD monitor and status display area in the following order:

→ [No display] setting OFF → [  10s ] 10 seconds → [  2s ] 2 seconds

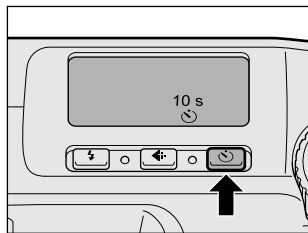

- 3 Compose the picture.**
- 4 Press the shutter button down half way, and press it down fully.  Page 41**

The self-timer LED lights red, and then flashes. The photograph is then taken after the preset time (two or ten seconds).

When photographs are taken using the LCD monitor, the count down is displayed.

To cancel photography midway, press .

## Memo

- Burst photography is not possible.
- To stop making movies, press the shutter button down fully.  
If this operation is not performed, photography is automatically stopped when the SmartMedia™ runs out of free space or when the size of a single picture has reached the maximum recordable size of 16 MB.



# Photography Using the Flash (continued)



## [ A ] Auto

In this mode, the flash fires automatically according to the photography conditions. This mode is ideal for general photography where you are not trying to achieve any particular effect.

## [ A ] Red-Eye Auto/[ ] Red-Eye Forced Flash

Use this mode to avoid the red-eye effect (▶ Additional Information, Glossary) when photographing people in low-light conditions.

In the [  A ] Red-Eye Auto mode, the flash fires according to the photographic conditions. When firing is set to automatic, the flash fires twice.

In the [   ] Red-Eye Forced Flash mode, the flash always fires twice.

Red-eye is reduced more effectively if the subject looks directly towards the camera. Effectiveness is also increased if the distance between the subject and camera is kept as short as possible.

## [ ] Forced Flash

In this mode, the flash always fires. Use the Forced Flash mode when the subject is backlit, or in artificial light (fluorescent lighting, etc.).

The flash also fires during macro photography.

## [ ] Suppressed Flash

Use the Suppressed Flash mode when you are taking pictures in indoor lighting at distances too great for the flash to have any effect, such as theater performances or indoor sporting events.

## [ ] Slow Synchro

The flash is fired at a slower shutter speed.

This flash mode is effective when shooting pictures so that not only the subject but also the background are both clearly reproduced in artificial light (backlighting, fluorescent lighting, etc.) or with people against the night as a background scene.

**Additional Information**

- 108 -



# Taking Photographs Continuously

In this mode, photographs are taken continuously at a maximum speed of 0.8 second intervals (five images per 4 seconds).

The maximum number of photographs that can be taken continuously is eight photographs.

Images are not recorded directly to SmartMedia™ but are stored temporarily within the buffer memory. After photography is finished, check the images and record the selected ones to SmartMedia™.

## 1 Set the mode dial to [ ], [ Tv ] or [ Av ].



Burst photography is not possible when [  ] or [  ] is selected in the [  ] mode.

## 2 Press the MODE button, and select burst photography.

Each press of the MODE button switches the photography mode as follows:

In the [  ] mode: [  ] 1-shot ↔ [  ] burst

In the [ Tv ] or [ Av ] mode:

[  ] 1-shot → [  ] burst → [AEB] AEB photography  
(↻ Page 71)

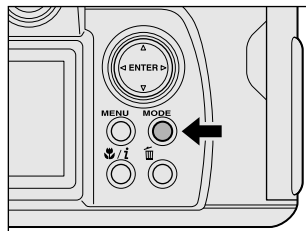

If burst photography is set when the shutter speed is set to a speed of 1 sec. or more in the [ Tv ] mode, the shutter speed is automatically changed to 1/2 second.

 is displayed in the LCD monitor or the status display.

## 3 Compose the picture, press the shutter button down half way, and press it down fully. ◀ Page 41

The shutter opens and closes up to a maximum of eight times.

If you release the shutter button before the camera captures eight images, the camera will stop taking pictures at that point.

After photography is finished, the LCD monitor automatically turns ON.

# Separation of the Lens (SLR) (continued)

The SP LANGUAGE already contains a D.P.O.F. information line. The message REC/CLAF indicates that the camera has already taken a picture. The message REC/CLAF indicates that the camera has already taken a picture. The message REC/CLAF indicates that the camera has already taken a picture.

**Viewfinder LED**

The viewfinder LED is a small light that is located on the right side of the viewfinder. It is used to indicate when the camera is in the "Viewfinder LED" mode. When the camera is in this mode, the viewfinder LED will be lit.

**Memory**

The memory is a small chip that is located on the back of the camera. It is used to store the data from the pictures that are taken. The memory is a small chip that is located on the back of the camera. It is used to store the data from the pictures that are taken.

**Image**

The image is a small picture that is located on the back of the camera. It is used to show the picture that is being taken. The image is a small picture that is located on the back of the camera. It is used to show the picture that is being taken.

**Color Adapter ring (PDR-AR52)**

The color adapter ring is a small ring that is located on the back of the camera. It is used to adapt the camera to different color systems. The color adapter ring is a small ring that is located on the back of the camera. It is used to adapt the camera to different color systems.

**Power**

The power is a small button that is located on the back of the camera. It is used to turn the camera on and off. The power is a small button that is located on the back of the camera. It is used to turn the camera on and off.

**ENTER**

The ENTER button is a small button that is located on the back of the camera. It is used to enter the menu system. The ENTER button is a small button that is located on the back of the camera. It is used to enter the menu system.

**PROTECT**

The PROTECT button is a small button that is located on the back of the camera. It is used to protect the pictures that are stored in the memory. The PROTECT button is a small button that is located on the back of the camera. It is used to protect the pictures that are stored in the memory.

**Auto Power Off**

The Auto Power Off function is a feature that automatically turns the camera off after a certain amount of time. The Auto Power Off function is a feature that automatically turns the camera off after a certain amount of time.

**Charging of flash in progress**

The charging of flash in progress message is a message that is displayed on the LCD monitor when the flash is being charged. The charging of flash in progress message is a message that is displayed on the LCD monitor when the flash is being charged.

**When playing back movie images, switching is between standard and image only.**

When playing back movie images, switching is between standard and image only. When playing back movie images, switching is between standard and image only.

# Taking Photographs Continuously (continued)



Use ▼ to select [ ➡ ] and press ENTER.

The image is saved or erased, and the camera is then ready to take photographs.

## Memo

- You can also carry out steps 5 and 6 while verifying the image in step 4.
- Even if photography is terminated midway before capturing eight images by releasing the shutter button, images already photographed can be saved and erased by the above method.
- The photography time varies according to the photographic conditions.
- Self-timer photography and flash photography are not possible.
- The burst photography setting is canceled by the power being turned OFF or the auto power OFF function working, and the photography mode returns to the 1-shot photography mode.

Getting  
Ready

Taking  
Photographs

Playing  
Back Images

Erasing  
Images

Handy  
Functions

Other  
Applications

Additional  
Information





# Photography in the Aperture-priority Mode

In this mode, photographs are taken with the priority given to aperture. The camera automatically sets the shutter speed according to the aperture.

A small aperture value produces a portrait photo with an out-of-focus background. The smaller the aperture value, the more out-of-focus the background becomes.

A large aperture value produces sharp images on both close objects and distant objects like landscapes. The larger the aperture value, the larger the area for sharp images.

**1** Set the mode dial to [ Av ].

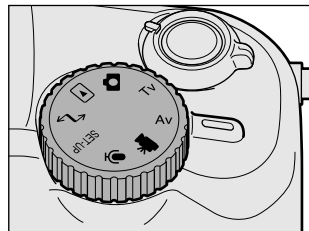

**2** Press **▲** or **▼** to adjust the aperture value.

The setting range is as follows: F8 / F5.6 / F4 / F2.8 / F2.3 / F2.0. The aperture value and the shutter speed corresponding to that value are displayed on the LCD monitor. If the appropriate combination cannot be set even if the shutter speed is adjusted to its limit, the shutter speed is displayed in red. Photography, however, is possible in this state.

Press **▲** to reduce aperture size. Press **▼** to increase aperture size. Note: The larger the F value, the smaller the aperture size become and vice versa.

Exposure compensation (▶ Page 69) using **◀** or **▶**, and manual setting (▶ Page 72) or film speed setting (▶ Page 78) using **ENTER** are also possible.



Aperture value

Shutter speed

**3** Compose the picture, press the shutter button down half way, and press it down fully. ▶ Page 41

[illegible]

The image taken from the lithium-ion battery pack (PDR-BT2) is taken is slightly less clear than playback images. (This is because they are displayed at a lower resolution.)

The display will operate according to the output system.  
With the LSC system, images can be displayed simultaneously on the LCD monitor and TV during  
this charger is connected to a household power outlet and  
photography and playback.

NAME NU charges the lithium-ion battery pack (PDR-BT2) in a short time (approx. 40 minutes). During photography, images are View displayed only on the LCD monitor, and during playback, images are displayed only on the TV.

Color Adapter ring (PDR-AR52)

[illegible]

When the LCD monitor is OFF, the LCD monitor automatically turns ON, and the

- recorded file can be played back. [ ] is displayed under protected images.
- To cancel write-protection for processing video progress of photograph.
  - Charging of flash in progress
- (Photography is not possible.)

- When playing back movie images, switching is between standard and image only.

## Photography in the Shutter speed-priority Mode (continued)



Compose the picture, press the shutter button down half way, and press it down fully. ➤ Page 41

### Memo

- When the shutter speed is set to a speed of 1 sec. or slower, burst photography is not possible as photographs are taken at a long exposure (➤ Page 68).
- In AEB photography (➤ Page 71), the shutter speed cannot be set at 1 second or longer.
- If a mode other than [ ] suppressed flash mode is set in flash photography, the shutter speed is limited to between 1/2 second and 1/250 second.
- If the shutter speed is set to 1/350 second or less, the shutter speed is automatically changed to 1/250 second if the flash setting is changed to the [ ] forced flash mode or [ ] red-eye forced flash mode.
- If the [ ] forced flash or [ ] red-eye forced flash mode is set in flash photography when the shutter speed is set to a speed of 1 sec. or more, the shutter speed is automatically changed to 1/2 second.

**Sensitive Information (e.g., PII, PHI, NPI, SSN) (continued)**

The **SP** LANGUAGE **graph or play them back** **Viewfinder LED**

## CEO Memo

The image taken before the recording is taken is slightly less clear than playback images. (This is because they are displayed at a lower resolution.)

With the N-SC system, images can be displayed simultaneously on the LCD monitor and TV during playback. This charger is connected to a household power outlet and a video camera.

With the PAL system, images cannot be displayed simultaneously. During photography, images are displayed only on the LCD monitor, and during playback, images are displayed only on the TV.

Color Adapter ring (PDR-AR52)

[illegible]

...with AC Adapter (connected)

When the PROTECT screen is displayed again, [ ] is displayed under protected images.

ON

- To cancel write-protected or processing in progress files photographically canceled if set at step 4.
- Charging of flash in progress

(Photography is not possible.)

- When playing back movie images, switching is between standard and image only.



# Exposure Compensation

This setting allows you to intentionally lighten or darken the entire image. Use this setting when the optimum brightness (exposure) cannot be obtained, for example, when the brightness between the subject and the background is not balanced or when the subject to photograph occupies only an extremely small part of the screen.

## 1 Set the mode dial to [ ], [ Tv ] or [ Av ].

In the [  ] mode, exposure compensation is possible at the [  ] setting.

## 2 Press ◀ or ▶ to adjust the exposure.

The setting range is as follows. A larger value lightens the exposure, and a smaller value darkens the exposure.

The value that you set is displayed on the LCD monitor.

Press ▶ to increase (brighten) exposure, and ◀ to decrease (darken) exposure.



Exposure Setting Value

◀ (to - side)

-1.5 / -1.2 / -0.9 / -0.6 / -0.3 / 0 (default) / +0.3 / +0.6 / +0.9 / +1.2 / +1.5

▶ (to + side)

## 3 Compose the picture, press the shutter button down half way, and press it down fully. ◀ Page 41

The ideal brightness sometimes cannot be obtained even if a large exposure value is set in dark photographic conditions.

In this case, press the shutter button, and check the brightness in the preview image (photographed still image). (PREVIEW ▶ Page 77)

# Setting the Language (continued)

Getting Ready  
Taking Photographs  
Playing Back Images  
Erasing Images  
Handy Functions  
Other Applications  
Additional Information

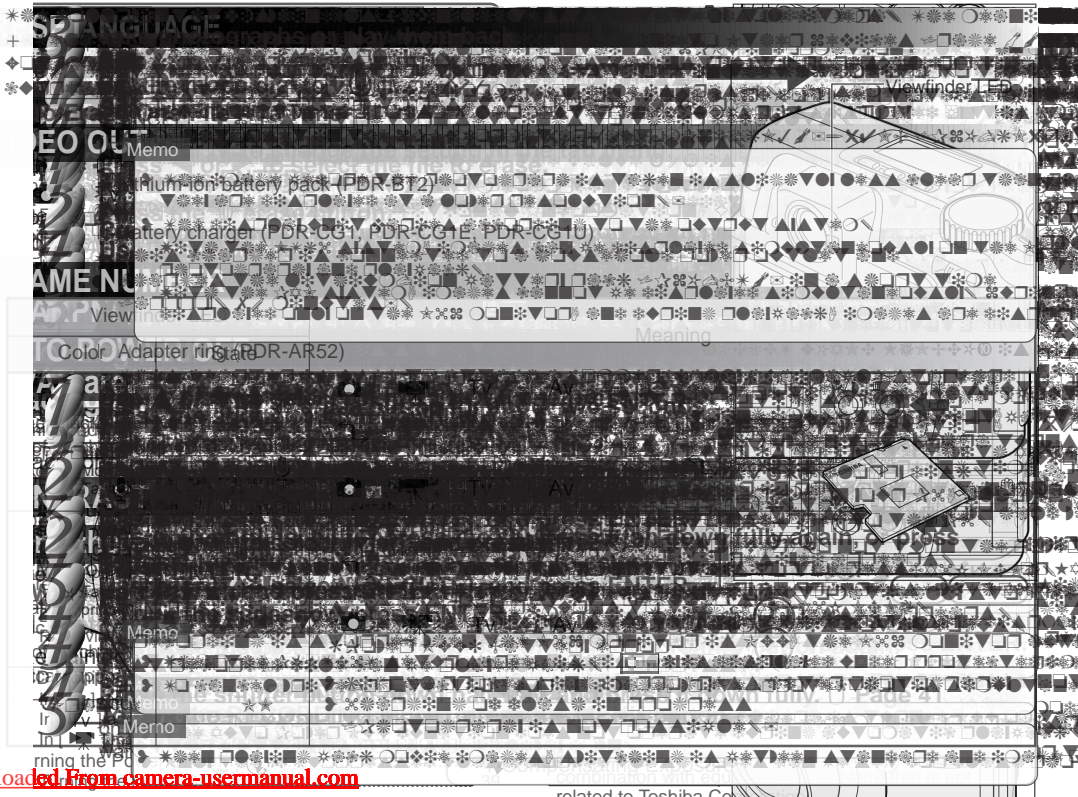

## Taking Shots With the Automatic Exposure Bracketing (AEB Photography)



The exposure is automatically switched in three stages ( $-0.3/0/+0.3$ ) when taking photographs.

- 1 Set the mode dial to either of [ Tv ] or [ Av ].
- 2 Press the **MODE** button, and select **AEB** photography.

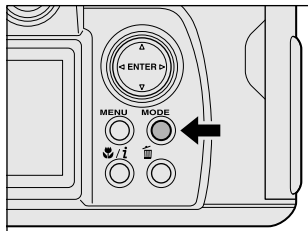
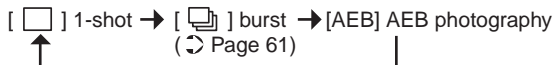
Each press of the MODE button switches the photography mode as follows:



If AEB photography is selected when the shutter speed is set to a speed of 1 sec. or more, the shutter speed becomes 1/2 sec.

[  ] is displayed on the LCD monitor and [  ] will flash on and off on the status display.

- 3** Compose the picture, press the shutter button down half way, and press it down fully.  Page 41

The shutter operates three times, and one image is saved for each shutter operation.

## Memo

- AEB photography is not possible when the shutter speed is set to 1 sec. or more in the [ **Tv** ] mode.

# Separating the Lens (Shooting Mode) (continued)

Getting Ready	The video image on the LCD monitor is slightly less clear than playback images. (This is because they are displayed at a lower resolution.)
Taking Photographs	<p>When the shutter button is pressed, the camera automatically switches to the shooting mode. The video image on the LCD monitor is slightly less clear than playback images. (This is because they are displayed at a lower resolution.)</p> <p>With the camera, the LCD monitor is displayed simultaneously on the LCD monitor and TV during photography and playback.</p> <p>When the camera is connected to a household power outlet and the LCD monitor is displayed only on the LCD monitor, and during playback, images are displayed only on the TV.</p>
Playing Back Images	<p>When the camera is connected to a household power outlet and the LCD monitor is displayed only on the LCD monitor, and during playback, images are displayed only on the TV.</p> <p>When the camera is connected to a household power outlet and the LCD monitor is displayed only on the LCD monitor, and during playback, images are displayed only on the TV.</p>
Erasing Images	<p>When the camera is connected to a household power outlet and the LCD monitor is displayed only on the LCD monitor, and during playback, images are displayed only on the TV.</p> <p>When the camera is connected to a household power outlet and the LCD monitor is displayed only on the LCD monitor, and during playback, images are displayed only on the TV.</p>
Handy Functions	<p>When the camera is connected to a household power outlet and the LCD monitor is displayed only on the LCD monitor, and during playback, images are displayed only on the TV.</p> <p>When the camera is connected to a household power outlet and the LCD monitor is displayed only on the LCD monitor, and during playback, images are displayed only on the TV.</p>
Other Applications	<p>When the camera is connected to a household power outlet and the LCD monitor is displayed only on the LCD monitor, and during playback, images are displayed only on the TV.</p> <p>When the camera is connected to a household power outlet and the LCD monitor is displayed only on the LCD monitor, and during playback, images are displayed only on the TV.</p>
Additional Information	<p>When the camera is connected to a household power outlet and the LCD monitor is displayed only on the LCD monitor, and during playback, images are displayed only on the TV.</p> <p>When the camera is connected to a household power outlet and the LCD monitor is displayed only on the LCD monitor, and during playback, images are displayed only on the TV.</p>



## Other Manual Settings (continued)

**3** Press ▲ or ▼ to select the setting item.

Setting items



**4** Press ►, press ▲ or ▼ to select options and press ENTER.

Pressing ENTER fixes the setting. To cancel, press ◀.

☞ [W.B.] White balance ► Page 74

[AREA] AF/AE area ► Page 74

[FOCUS] Focus ► Page 75

[FLASH] Strobe ► Page 75



Set values

**5** Press ENTER.

The camera is ready to take photographs.

**6** Compose the picture, press the shutter button down half way, and press it down fully. ► Page 41

The camera takes the picture.

Getting Ready

Taking Photographs

Playing Back Images

Erasing Images

Handy Functions

Other Applications

Additional Information

Getting Ready

Taking Photographs

Playing Back Images

Erasing Images

Handy Functions

Other Applications

Additional Information

SP LANGUAGE

graphs on a keyboard

Viewfinder L.F.P.

EO OUT

Memo

lithium-ion battery pack (PDR-BT2)

battery charger (PDR-GB, PDR-CC-E, PDR-CC-U)

AME NU

View

Color Adapter ring (PDR-AR52)

Meaning

TV

AV

press

Memo

no

no

no

no

no

no

no

no

no

no

## Other Manual Settings (continued)

### Focus (FOCUS)

Sets the focusing method.

[AF] : Automatically adjusts the focus. (default)

[ $\infty$ ] : Fixes the focus at infinity.

### Strobe (FLASH)

Change this setting when an external flash (sold separately) is to be used. This setting is displayed in the [Av] mode. When [EXT.] is set, the built-in flash does not fire.

When an external flash is used, the camera's shutter speed is fixed to 1/125 sec.

Referring to the instruction manual for the external flash you are using, adjust the camera's aperture and take photographs with the distance up to the subject adjusted.

[INT.] : Built-in flash is used (default)

[EXT.] : External flash is used

Getting  
Ready

Taking  
Photographs

Playing  
Back Images

Erasing  
Images

Handy  
Functions

Other  
Applications

Additional  
Information

# Separating Color and Audio (continued)

Getting Ready  
Taking Photographs  
Playing Back Images  
Erasing Images  
Handy Functions  
Other Applications  
Additional Information

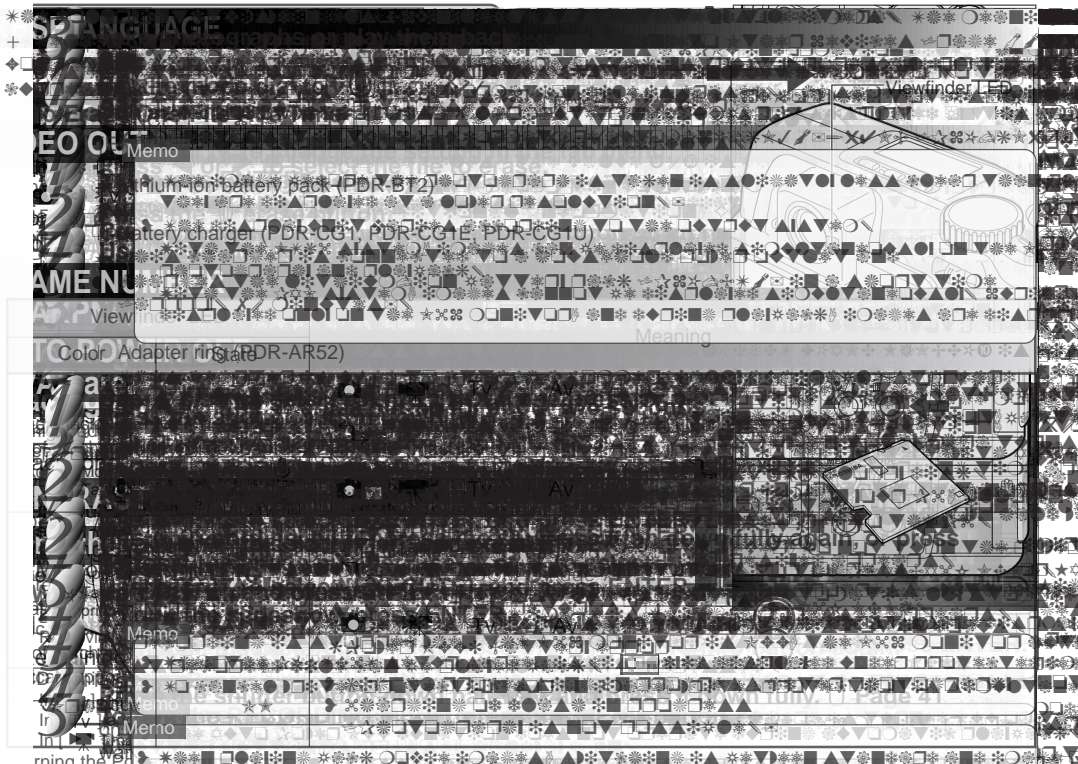



# Changing the Preset Conditions (RECORDING MENU) (continued)

## PREVIEW

This setting allows you to display a photographed image on the LCD monitor for two seconds immediately after you have taken the shot.

This allows you to check the composition and brightness of the photographed image.

Note, however, that detailed areas are sometimes not sharp as the resolution of preview images is low. To check detailed areas and focus, check it in the [▶] playback mode (▶ Page 80).

To cancel preview, press the shutter button half way down again.

The three images that you took are displayed for about two seconds each in the AEB photography mode (▶ Page 71)

[OFF] : Do not display preview (default)

[ON] : Display preview

## COLOR

Set the color of the image to be photographed.

[STANDARD] : Standard color (default)

[VIVID] : Vivid color

[MONOCHROME] : Black and white

[SEPIA] : Sepia

Getting  
Ready

Taking  
Photographs

Playing  
Back Images

Erasing  
Images

Handy  
Functions

Other  
Applications

Additional  
Information

[illegible]

# Changing the Preset Conditions (RECORDING MENU) (continued)

## DIGITAL ZOOM

Enlarges the center of the screen and takes photographs with apparent effect that the focal distance is set to twice the distance.

 Zoom Photography  Page 54

[ON] : Enables digital zoom photography.

[OFF] : Disables digital zoom photography. (default)

## LCD DISPLAY

Sets whether or not to display images on the LCD monitor.

The LCD monitor automatically turns ON in macro photography, digital zoom photography and movie photography.



[ON] : Display (default)

[OFF] : Do not display

## LCD

Adjusts the brightness of the LCD monitor. This adjustment does not adjust the brightness of the image to be recorded.

[-5] to [+5]

 To adjust the brightness of the LCD monitor  Page 119

Getting  
Ready

Taking  
Photographs

Playing  
Back Images

Erasing  
Images

Handy  
Functions

Other  
Applications

Additional  
Information

**Sensitive Information (e.g., PII, PHI, NPI, SSN) (continued)**

The **SP** LANGUAGE **graph or play them back** **Viewfinder LED**

## EO 00 Memo

The image taken before the recording is taken is slightly less clear than playback images. (This is because they are displayed at a lower resolution.)

With the N-SC system, images can be displayed simultaneously on the LCD monitor and TV during playback. This charger is connected to a household power outlet and a video camera.

With the PAL system, images cannot be displayed simultaneously. During photography, images are approx. 70 minutes.

Color Adapter ring (PDR-AR52)

### Meaning

[illegible]

...with AC Adapter (connected)

When the PROTECT (protected screen) is displayed again, [ ] is displayed under protected images.

- To cancel write-protection for an image with progress indicator, press the **OK** button. The image will be canceled if set at step 4.
- Charging of flash in progress

**Memo** Auto Power OFF (Photography is not possible.)

- When playing back movie images, switching is between standard and image only.



# Playing Back Movies

Play back movies that you have recorded. Audio can also be played back.

## 1 Set the mode dial to [ ].

Movies are displayed as thumbnails on the LCD monitor. (▶ Page 84)

☞ To adjust the brightness of the LCD monitor ▶ Page 119

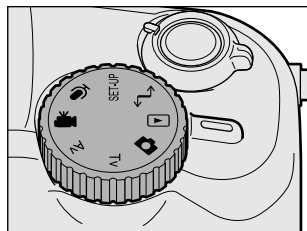

### IMPORTANT

- When the mode dial setting is changed to [  ] immediately after taking a still image, press the MODE button to change the selection of the folder to play back. If the image is played back without the folder selection changed, the images of the still image folder are displayed. Each press of the MODE button toggles the selection of the folder to play back between still image folder and movie folder.

☞ For details of folder to play back (▶ Page 89)

## 2 Press , , or to select the movie to play back.

The cursor is at the image surrounded by the green frame.

Pressing the buttons continuously moves the cursor continuously.

## 3 Press ENTER.

The selected moving image data is displayed.

☞ Changing the LCD monitor display ▶ Page 88

### Additional Information

- 100 -

## Playing Back Movies (continued)

	During playback	During pause
▶	<b>2x-speed playback</b> <ul style="list-style-type: none"> <li>• 2x-speed playback is performed for the duration that ▶ is held down.</li> </ul>	<b>1-frame feed</b> <ul style="list-style-type: none"> <li>• Each press of ▶ feeds the image by one frame.</li> <li>• 1-frame feed is continued for the duration that ▶ is held down.</li> </ul>
◀	<b>Reverse playback</b> <ul style="list-style-type: none"> <li>• Playback becomes 2x-speed reverse playback for the duration that ◀ is held down.</li> </ul>	<b>Reverse 1-frame feed</b> <ul style="list-style-type: none"> <li>• Each press of ◀ feeds the image in reverse by one frame.</li> <li>• 1-frame feed is continued for the duration that ◀ is held down.</li> </ul>
▲	<b>Pause</b> <ul style="list-style-type: none"> <li>• Playback is paused in any playback state.</li> </ul>	<b>Canceling pause</b> <ul style="list-style-type: none"> <li>• After pause is cancelled, playback resumes at the last state that was active before the pause.</li> </ul>
▼	<b>Stop</b> Playback returns to the start of the movie.	
ENTER	<b>Stop</b> The display returns to thumbnail playback.	
Pressing the Zoom switch to "T"	Increases the volume.	
Pressing the Zoom switch to "W"	Decreases the volume.	



### To play back another movie, press ENTER.

The LCD monitor returns to the thumbnail display.

#### Memo

- The image size displayed on the LCD monitor becomes Full (320 x 240) or HALF (160 x 120). So, the image is not displayed on the entire LCD monitor but in the center of the screen.

[illegible]



# Enlarging Photographed Images (Zoom Playback)

Enlarges selected portions of images being played back 1.6 times or 3.2 times actual size. Images can be displayed enlarged when being played back one image at a time. Movies and images photographed in the multi mode (▶ Page 53) cannot be displayed using the zoom playback feature.

## 1 Set the mode dial to [▶].

The last image frame appears on the LCD monitor.

## 2 Use ◀ or ▶ to select the frame you want to enlarge.

You can also select the image by the same operation as for thumbnail playback (▶ Page 84).

## 3 Adjust the zoom ratio by the Zoom switch.

Pressing the Zoom switch to the "T" will enlarge the image initially to 1.6X and to 3.2X when pressed again.

To return to normal magnification, press the Zoom switch towards "W".

The image is displayed enlarged, and a white frame and green frame are displayed on the LCD monitor.

The white frame indicates the entire image, while the green frame shows the location of the currently enlarged area.



## 4 Use ▲, ▼, ◀ or ▶ to select the area to enlarge.

Adjust the display area to enlarge while viewing the white and green frames.

## 5 To return to the regular display, press ENTER.

### Memo

- The scale applied during zoom playback is the scale applied when the photograph is taken on this camera. When you play back an image taken on another camera, the scale to be applied may vary.

Sei  $\mathbf{v}_1, \mathbf{v}_2, \mathbf{v}_3, \mathbf{v}_4, \mathbf{v}_5, \mathbf{v}_6, \mathbf{v}_7, \mathbf{v}_8, \mathbf{v}_9, \mathbf{v}_{10}$  (column images)

The color and brightness of the LED may differ from the actual color and brightness of the LED color may differ

For more information on the new Viewfinder Express, visit [apple.com/viewfinderexpress](http://apple.com/viewfinderexpress).

**Introducing Our Time-Changing Camera**

The image before the promotion is taken is slightly less clear than playback images. (This is because

• The display unit varies according to the output system.

With the NTSC system, images can be displayed simultaneously on the LCD monitor and TV during photography and playback.

With the PAL system, images cannot be displayed simultaneously. During photography, images are (approx. 70 minutes).

Color	Meaning
● Adapter ring (PDR-AR52)	is displayed.



When the camera is in the Auto mode, the camera will automatically turn off automatically. This function

2001

...the way for all records  
...fully again & press

1. **NAME** \_\_\_\_\_  
 2. **ADDRESS** \_\_\_\_\_  
 3. **CITY** \_\_\_\_\_  
 4. **STATE** \_\_\_\_\_  
 5. **ZIP** \_\_\_\_\_  
 6. **PHONE** \_\_\_\_\_  
 7. **E-MAIL** \_\_\_\_\_  
 8. **DATE** \_\_\_\_\_  
 9. **SIGNATURE** \_\_\_\_\_  
 10. **PRINTED NAME** \_\_\_\_\_  
 11. **PRINTED ADDRESS** \_\_\_\_\_  
 12. **PRINTED CITY** \_\_\_\_\_  
 13. **PRINTED STATE** \_\_\_\_\_  
 14. **PRINTED ZIP** \_\_\_\_\_  
 15. **PRINTED PHONE** \_\_\_\_\_  
 16. **PRINTED E-MAIL** \_\_\_\_\_  
 17. **PRINTED DATE** \_\_\_\_\_  
 18. **PRINTED SIGNATURE** \_\_\_\_\_  
 19. **PRINTED NAME** \_\_\_\_\_  
 20. **PRINTED ADDRESS** \_\_\_\_\_  
 21. **PRINTED CITY** \_\_\_\_\_  
 22. **PRINTED STATE** \_\_\_\_\_  
 23. **PRINTED ZIP** \_\_\_\_\_  
 24. **PRINTED PHONE** \_\_\_\_\_  
 25. **PRINTED E-MAIL** \_\_\_\_\_  
 26. **PRINTED DATE** \_\_\_\_\_  
 27. **PRINTED SIGNATURE** \_\_\_\_\_  
 28. **PRINTED NAME** \_\_\_\_\_  
 29. **PRINTED ADDRESS** \_\_\_\_\_  
 30. **PRINTED CITY** \_\_\_\_\_  
 31. **PRINTED STATE** \_\_\_\_\_  
 32. **PRINTED ZIP** \_\_\_\_\_  
 33. **PRINTED PHONE** \_\_\_\_\_  
 34. **PRINTED E-MAIL** \_\_\_\_\_  
 35. **PRINTED DATE** \_\_\_\_\_  
 36. **PRINTED SIGNATURE** \_\_\_\_\_  
 37. **PRINTED NAME** \_\_\_\_\_  
 38. **PRINTED ADDRESS** \_\_\_\_\_  
 39. **PRINTED CITY** \_\_\_\_\_  
 40. **PRINTED STATE** \_\_\_\_\_  
 41. **PRINTED ZIP** \_\_\_\_\_  
 42. **PRINTED PHONE** \_\_\_\_\_  
 43. **PRINTED E-MAIL** \_\_\_\_\_  
 44. **PRINTED DATE** \_\_\_\_\_  
 45. **PRINTED SIGNATURE** \_\_\_\_\_  
 46. **PRINTED NAME** \_\_\_\_\_  
 47. **PRINTED ADDRESS** \_\_\_\_\_  
 48. **PRINTED CITY** \_\_\_\_\_  
 49. **PRINTED STATE** \_\_\_\_\_  
 50. **PRINTED ZIP** \_\_\_\_\_  
 51. **PRINTED PHONE** \_\_\_\_\_  
 52. **PRINTED E-MAIL** \_\_\_\_\_  
 53. **PRINTED DATE** \_\_\_\_\_  
 54. **PRINTED SIGNATURE** \_\_\_\_\_  
 55. **PRINTED NAME** \_\_\_\_\_  
 56. **PRINTED ADDRESS** \_\_\_\_\_  
 57. **PRINTED CITY** \_\_\_\_\_  
 58. **PRINTED STATE** \_\_\_\_\_  
 59. **PRINTED ZIP** \_\_\_\_\_  
 60. **PRINTED PHONE** \_\_\_\_\_  
 61. **PRINTED E-MAIL** \_\_\_\_\_  
 62. **PRINTED DATE** \_\_\_\_\_  
 63. **PRINTED SIGNATURE** \_\_\_\_\_  
 64. **PRINTED NAME** \_\_\_\_\_  
 65. **PRINTED ADDRESS** \_\_\_\_\_  
 66. **PRINTED CITY** \_\_\_\_\_  
 67. **PRINTED STATE** \_\_\_\_\_  
 68. **PRINTED ZIP** \_\_\_\_\_  
 69. **PRINTED PHONE** \_\_\_\_\_  
 70. **PRINTED E-MAIL** \_\_\_\_\_  
 71. **PRINTED DATE** \_\_\_\_\_  
 72. **PRINTED SIGNATURE** \_\_\_\_\_  
 73. **PRINTED NAME** \_\_\_\_\_  
 74. **PRINTED ADDRESS** \_\_\_\_\_  
 75. **PRINTED CITY** \_\_\_\_\_  
 76. **PRINTED STATE** \_\_\_\_\_  
 77. **PRINTED ZIP** \_\_\_\_\_  
 78. **PRINTED PHONE** \_\_\_\_\_  
 79. **PRINTED E-MAIL** \_\_\_\_\_  
 80. **PRINTED DATE** \_\_\_\_\_  
 81. **PRINTED SIGNATURE** \_\_\_\_\_  
 82. **PRINTED NAME** \_\_\_\_\_  
 83. **PRINTED ADDRESS** \_\_\_\_\_  
 84. **PRINTED CITY** \_\_\_\_\_  
 85. **PRINTED STATE** \_\_\_\_\_  
 86. **PRINTED ZIP** \_\_\_\_\_  
 87. **PRINTED PHONE** \_\_\_\_\_  
 88. **PRINTED E-MAIL** \_\_\_\_\_  
 89. **PRINTED DATE** \_\_\_\_\_  
 90. **PRINTED SIGNATURE** \_\_\_\_\_  
 91. **PRINTED NAME** \_\_\_\_\_  
 92. **PRINTED ADDRESS** \_\_\_\_\_  
 93. **PRINTED CITY** \_\_\_\_\_  
 94. **PRINTED STATE** \_\_\_\_\_  
 95. **PRINTED ZIP** \_\_\_\_\_  
 96. **PRINTED PHONE** \_\_\_\_\_  
 97. **PRINTED E-MAIL** \_\_\_\_\_  
 98. **PRINTED DATE** \_\_\_\_\_  
 99. **PRINTED SIGNATURE** \_\_\_\_\_  
 100. **PRINTED NAME** \_\_\_\_\_  
 101. **PRINTED ADDRESS** \_\_\_\_\_  
 102. **PRINTED CITY** \_\_\_\_\_  
 103. **PRINTED STATE** \_\_\_\_\_  
 104. **PRINTED ZIP** \_\_\_\_\_  
 105. **PRINTED PHONE** \_\_\_\_\_  
 106. **PRINTED E-MAIL** \_\_\_\_\_  
 107. **PRINTED DATE** \_\_\_\_\_  
 108. **PRINTED SIGNATURE** \_\_\_\_\_  
 109. **PRINTED NAME** \_\_\_\_\_  
 110. **PRINTED ADDRESS** \_\_\_\_\_  
 111. **PRINTED CITY** \_\_\_\_\_  
 112. **PRINTED STATE** \_\_\_\_\_  
 113. **PRINTED ZIP** \_\_\_\_\_  
 114. **PRINTED PHONE** \_\_\_\_\_  
 115. **PRINTED E-MAIL** \_\_\_\_\_  
 116. **PRINTED DATE** \_\_\_\_\_  
 117. **PRINTED SIGNATURE** \_\_\_\_\_  
 118. **PRINTED NAME** \_\_\_\_\_  
 119. **PRINTED ADDRESS** \_\_\_\_\_  
 120. **PRINTED CITY** \_\_\_\_\_  
 121. **PRINTED STATE** \_\_\_\_\_  
 122. **PRINTED ZIP** \_\_\_\_\_  
 123. **PRINTED PHONE** \_\_\_\_\_  
 124. **PRINTED E-MAIL** \_\_\_\_\_  
 125. **PRINTED DATE** \_\_\_\_\_  
 126. **PRINTED SIGNATURE** \_\_\_\_\_  
 127. **PRINTED NAME** \_\_\_\_\_  
 128. **PRINTED ADDRESS** \_\_\_\_\_  
 129. **PRINTED CITY** \_\_\_\_\_  
 130. **PRINTED STATE** \_\_\_\_\_  
 131. **PRINTED ZIP** \_\_\_\_\_  
 132. **PRINTED PHONE** \_\_\_\_\_  
 133. **PRINTED E-MAIL** \_\_\_\_\_  
 134. **PRINTED DATE** \_\_\_\_\_  
 135. **PRINTED SIGNATURE** \_\_\_\_\_  
 136. **PRINTED NAME** \_\_\_\_\_  
 137. **PRINTED ADDRESS** \_\_\_\_\_  
 138. **PRINTED CITY** \_\_\_\_\_  
 139. **PRINTED STATE** \_\_\_\_\_  
 140. **PRINTED ZIP** \_\_\_\_\_  
 141. **PRINTED PHONE** \_\_\_\_\_  
 142. **PRINTED E-MAIL** \_\_\_\_\_  
 143. **PRINTED DATE** \_\_\_\_\_  
 144. **PRINTED SIGNATURE** \_\_\_\_\_  
 145. **PRINTED NAME** \_\_\_\_\_  
 146. **PRINTED ADDRESS** \_\_\_\_\_  
 147. **PRINTED CITY** \_\_\_\_\_  
 148. **PRINTED STATE** \_\_\_\_\_  
 149. **PRINTED ZIP** \_\_\_\_\_  
 150. **PRINTED PHONE** \_\_\_\_\_  
 151. **PRINTED E-MAIL** \_\_\_\_\_  
 152. **PRINTED DATE** \_\_\_\_\_  
 153. **PRINTED SIGNATURE** \_\_\_\_\_  
 154. **PRINTED NAME** \_\_\_\_\_  
 155. **PRINTED ADDRESS** \_\_\_\_\_  
 156. **PRINTED CITY** \_\_\_\_\_  
 157. **PRINTED STATE** \_\_\_\_\_  
 158. **PRINTED ZIP** \_\_\_\_\_  
 159. **PRINTED PHONE** \_\_\_\_\_  
 160. **PRINTED E-MAIL** \_\_\_\_\_  
 161. **PRINTED DATE** \_\_\_\_\_  
 162. **PRINTED SIGNATURE** \_\_\_\_\_  
 163. **PRINTED NAME** \_\_\_\_\_  
 164. **PRINTED ADDRESS** \_\_\_\_\_  
 165. **PRINTED CITY** \_\_\_\_\_  
 166. **PRINTED STATE** \_\_\_\_\_  
 167. **PRINTED ZIP** \_\_\_\_\_  
 168. **PRINTED PHONE** \_\_\_\_\_  
 169. **PRINTED E-MAIL** \_\_\_\_\_  
 170. **PRINTED DATE** \_\_\_\_\_  
 171. **PRINTED SIGNATURE** \_\_\_\_\_  
 172. **PRINTED NAME** \_\_\_\_\_  
 173. **PRINTED ADDRESS** \_\_\_\_\_  
 174. **PRINTED CITY** \_\_\_\_\_  
 175. **PRINTED STATE** \_\_\_\_\_  
 176. **PRINTED ZIP** \_\_\_\_\_  
 177. **PRINTED PHONE** \_\_\_\_\_  
 178. **PRINTED E-MAIL** \_\_\_\_\_  
 179. **PRINTED DATE** \_\_\_\_\_  
 180. **PRINTED SIGNATURE** \_\_\_\_\_  
 181. **PRINTED NAME** \_\_\_\_\_  
 182. **PRINTED ADDRESS** \_\_\_\_\_  
 183. **PRINTED CITY** \_\_\_\_\_  
 184. **PRINTED STATE** \_\_\_\_\_  
 185. **PRINTED ZIP** \_\_\_\_\_  
 186. **PRINTED PHONE** \_\_\_\_\_  
 187. **PRINTED E-MAIL** \_\_\_\_\_  
 188. **PRINTED DATE** \_\_\_\_\_  
 189. **PRINTED SIGNATURE** \_\_\_\_\_  
 190. **PRINTED NAME** \_\_\_\_\_  
 191. **PRINTED ADDRESS** \_\_\_\_\_  
 192. **PRINTED CITY** \_\_\_\_\_  
 193. **PRINTED STATE** \_\_\_\_\_  
 194. **PRINTED ZIP** \_\_\_\_\_  
 195. **PRINTED PHONE** \_\_\_\_\_  
 196. **PRINTED E-MAIL** \_\_\_\_\_  
 197. **PRINTED DATE** \_\_\_\_\_  
 198. **PRINTED SIGNATURE** \_\_\_\_\_  
 199. **PRINTED NAME** \_\_\_\_\_  
 200. **PRINTED ADDRESS** \_\_\_\_\_  
 201. **PRINTED CITY** \_\_\_\_\_  
 202. **PRINTED STATE** \_\_\_\_\_  
 203. **PRINTED ZIP** \_\_\_\_\_  
 204. **PRINTED PHONE** \_\_\_\_\_  
 205. **PRINTED E-MAIL** \_\_\_\_\_  
 206. **PRINTED DATE** \_\_\_\_\_  
 207. **PRINTED SIGNATURE** \_\_\_\_\_  
 208. **PRINTED**

slides have been added to the presentation. The last image displays the last

When the power is restored, the LCD monitor automatically turns ON, and the recorded file can be played back.

- To cancel write-protection for an image, write protection is automatically canceled if set at step 4.
- Charging of flash in progress  
(Photograph is not available)

When playing back movie images, switching is between standard and image only.

related to Toshiba Corporation.

# Playback of Multi Image Pictures

Automatically plays back the 36 images photographed in the multi photography mode like an animation.

- 1 Set the mode dial to [  ].**  
The last image frame appears on the LCD monitor.
- 2 Use ◀ or ▶ to select the images photographed in the multi photography mode.**  
You can also select the image by the same operation as for thumbnail display (▶ Page 84).
- 3 Press the Zoom switch towards “T” to begin playback.**  
Automatic playback begins.

Getting  
Ready

Taking  
Photographs

Playing  
Back Images

Erasing  
Images

Handy  
Functions

Other  
Applications

Additional  
Information

## aTV (continued)

## SPRING LANGUAGE

**The mode dial is**  **Viewfinder LEA**

## EO 00 Memo

The image displayed on the LCD monitor is taken is slightly less clear than playback images. (This is because they are displayed at a lower resolution.)

The display is controlled according to the output system.

Images can be displayed simultaneously on the LCD monitor and TV during photography and playback.

Images cannot be displayed simultaneously. During photography, images are displayed only on the LCD monitor, and during playback, images are displayed only on the TV.

Color Adapter ring (PDR-AR52)

1  
2  
3  
4  
5  
6  
7  
8  
9  
10  
11  
12  
13  
14  
15  
16  
17  
18  
19  
20  
21  
22  
23  
24  
25  
26  
27  
28  
29  
30  
31  
32  
33  
34  
35  
36  
37  
38  
39  
40  
41  
42  
43  
44  
45  
46  
47  
48  
49  
50  
51  
52  
53  
54  
55  
56  
57  
58  
59  
60  
61  
62  
63  
64  
65  
66  
67  
68  
69  
70  
71  
72  
73  
74  
75  
76  
77  
78  
79  
80  
81  
82  
83  
84  
85  
86  
87  
88  
89  
90  
91  
92  
93  
94  
95  
96  
97  
98  
99  
100

[illegible]

- When playing back movie images, switching is between standard and image only.



# About Folders

Images photographed on this camera are recorded to the [100TOSHI] folder in the case of still images and to the [ ] folder in the case of moving images (movies). You cannot set which folder to store images to as you like. The [100TOSHI] folder is created when you have photographed still images, and the [ ] folder is created when you have photographed moving images.

When playing back images, the folder to play back changes according to whether the image is a still image or a movie. When the [ ] mode is entered, a folder corresponding to the previous mode dial setting is selected. To switch between still image and movies, press the MODE button in the [ ] mode.

In the case of still images, when the images number reaches the largest number (9999), a new folder [101TOSHI] is created. When there are two or more [xxxTOSHI] folders, the playback folder default is the folder assigned the largest "xxx" value.

When a SmartMedia™ that is formatted or contain images taken with another camera is used on this camera, [xxxTOSHI] or [ ] is created, and the data of the photographed images is recorded to this folder.

[xxxTOSHI]

- Indicates the folder used by this camera.
- The largest number is automatically assigned according to the status of the existing folders.

To view images photographed on this camera, select [xxxTOSHI] or [ ].

## Memo

- To play back images photographed by another camera, select the desired [xxxAAAA] folder.

Same as above [ ] Varies according to camera brand

The folder [xxxAAAA] is created for each camera.

- Images currently recorded to these folders can only be played back.
- Sometimes the size of the image prevents it from being played back.
- Images cannot be played back unless the file name and folder name are set correctly.



## Erasing Images (Erase Frame) (continued)

**5** To continue erasing images, repeat the above procedure from step 2.

### Memo

- When [PROTECTED] is displayed on the LCD monitor, cancel the protection (▶ Page 109) or remove DPOF write-protection (▶ Page 103).
- If you take a photograph after erasing an image, a number continuing from the last photographed image is assigned as the image number.
- Images can also be erased in the thumbnail mode. In this case, the camera enters the single frame playback (frame playback) mode, and enters the thumbnail playback mode after the image is erased.

Getting  
Ready

Taking  
Photographs

Playing  
Back Images

Erasing  
Images

Handy  
Functions

Other  
Applications

Additional  
Information

**Sensitive Information (continued)**

**SP** LANGUAGE

English of the LED color may differ from the actual color of the LED.

Graphs or play them back

Other Devices (page 125)

For more information, see the user manual.

Viewfinder LED

English

<h1>EO OUT</h1>	<p>Memo</p> <p>The image of the battery pack (PDR-BT2) is taken is slightly less clear than playback images. (This is because they are displayed at a lower resolution.)</p> <p>The display (PDR-CG1, PDR-CG2, PDR-CG3, PDR-CG4) is controlled by the PDR-CG5 system.</p> <p>With the NTSC system, images can be displayed simultaneously on the LCD monitor and TV during photography and playback.</p> <p>This charger is connected to a household power outlet and</p> <p>charges the lithium-ion battery pack (PDR-BT2) in a short time</p> <p>approximately 10 minutes. Images cannot be displayed simultaneously. During photography, images are displayed only on the LCD monitor, and during playback, images are displayed only on the TV.</p>	
-----------------	---	--

Color	Adapter ring (PDR-AR52)	Meaning
Blue	Adapter ring (PDR-AR52)	Blue is displayed.

[illegible]

When the camera is in the **Still** mode, the LCD monitor displays the last image. When the camera is in the **Movie** mode, the LCD monitor displays the last image. When the camera is in the **Still** mode, the LCD monitor displays the last image. When the camera is in the **Movie** mode, the LCD monitor displays the last image.

- When playing back movie images, switching is between standard and image only.



## Erasing Folders (All Images in a Folder/All Still Images) (continued)



Use ▲ or ▼ to select [  ] or [  ] and press ENTER.

[  ] : Erases images in the currently selected folder and folders.

[  ] : Erases all still image folders.

The images or folders are erased, and the camera returns to the respective mode.

To cancel erasing of image data, select [  ].

When [  ] is selected, [NO IMAGE] is displayed after the images are erased (unless the SmartMedia™ contains protected images).



### Memo

- When all images in a folder are erased, that folder also is erased.

Getting  
Ready

Taking  
Photographs

Playing  
Back Images

Erasing  
Images

Handy  
Functions

Other  
Applications

Additional  
Information



# Reducing the Image Size (Resize)

Changes the size of FULL size (2048 x 1536 pixels) images to half the size (1024 x 768 pixels) in the horizontal and vertical directions, and overwrites the old FULL size image with the new size image. This is called "resizing" in this manual.

Resizing a previously saved image when the SmartMedia™ has run out of storage space during photography increases space on SmartMedia™ so that you can continue taking photographs.

The following images cannot be resized:

- HALF size images
- Images taken with another camera
- Images taken in the multi photography mode
- Protected images (▶ Page 107)
- Movies
- Images cannot also be resized when the SmartMedia™ is write-protected.

**1**

**Set the mode dial to [ ].**

The last image frame appears on the LCD monitor.

**2**

**Press the MENU button.**

The PLAYBACK MENU is displayed.

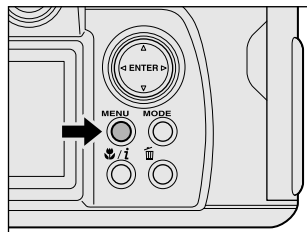





# Compressing Images (Quality)

Compresses images to half their size, and overwrites the old size image with the new compressed image. Compressing a previously saved image when the SmartMedia™ has run out of storage space during photography increases space on SmartMedia™ so that you can continue taking photographs.

The following images cannot be compressed:

- [★] (BASIC) image quality images
- Images taken with another camera
- Protected images (▶ Page 107)
- Movies
- Images cannot also be compressed when the SmartMedia™ is write-protected.

1

**Set the mode dial to [▶].**

The last image frame appears on the LCD monitor.

2

**Press the MENU button.**

The PLAYBACK MENU is displayed.

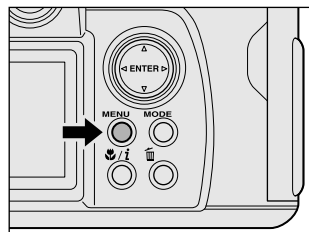

- 100 -

# Copying Images

Copies images stored on the SmartMedia™. This feature is useful when you want to copy an image from one SmartMedia™ to another.

**1 Set the mode dial to [▶].**  
The last image frame appears on the LCD monitor.

**2 Press the MENU button.**  
The PLAYBACK MENU is displayed.

**3 Use ▲ or ▼ to select [COPY], and press ▶.**  
The COPY menu is displayed.

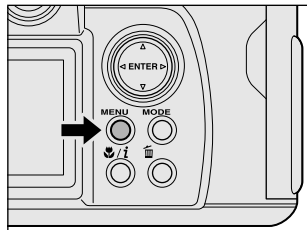





## Copying Images (continued)

### 7 Use ▲ or ▼ to select [OK], and press ENTER.

The screen indicating that the image is being copied appears.

To quit copying, select [CANCEL].

If the SmartMedia™ has insufficient memory space, [CARD FULL] appears on the screen. Replace the SmartMedia™ with another one.



When copying is completed, the above screen is displayed.

When this screen is displayed, you can swap the SmartMedia™ with the original SmartMedia™. The camera need not be turned OFF for this operation.

#### IMPORTANT

- Do not remove the SmartMedia™ or turn the camera OFF while images are being copied. This might damage the SmartMedia™.

### 8 Press ENTER.

The screen returns to the PLAYBACK MENU.

To quit the PLAYBACK MENU, press the MENU button.

## Separately Sold Accessories

[illegible]

The information battery pack (PDR-BT2) is taken is slightly less clear than playback images. (This is because they are displayed at a lower resolution.)

The display can operate according to the output system.  
With the NTSC system, images can be displayed simultaneously on the LCD monitor and TV during photography and playback.  
This charger is connected to a household power outlet and charges the lithium-ion battery pack (PDR-BT2) in a short time (approximately 40 minutes).  
During photography, images are displayed only on the LCD monitor, and during playback, images are displayed only on the TV.

Color Adapter ring (PDR-AR52)

[illegible]

When the LCD monitor is turned on, the last image displayed under protected images is displayed again. [ ] is displayed under protected images.

- To cancel write-protect or processing in progress of a photograph, cancel it set at step 4.
- Charging of flash in progress (Photography is not possible.)

- When playing back movie images, switching is between standard and image only.

# Print Information

The number of prints or the image date can be set in a DPOF (Digital Print Order Format) file for images to be printed (developed). (► Additional Information, Glossary.) This feature applies to still images only. Printing can be done easily if you just take the SmartMedia™ containing the images and DPOF file to the photo lab.

- 1** Set the mode dial to [  ].
- 2** Press the MENU button.  
The PLAYBACK MENU is displayed.
- 3** Press ▲ or ▼ to select [DPOF] and press ►.
- 4** Press ▲ or ▼ to select [SELECT IMAGE], and press ENTER.







## Print Information (continued)

### 7 Press **▲** or **▼** to select [EXECUTE], and press ENTER.

To continue setting, select [CHANGE SETTINGS]. To quit setting without creating a DPOF file, select [CANCEL].

The DPOF information file is created, and the screen returns to the initial display when the operation ends.



### 8 To end setting, press **▲** or **▼** to select [END], and press ENTER.

To cancel confirmation of settings, proceed to step 9.



### 9 Select the desired operation.

[CONFIRM]: Press this to confirm the settings.

- 1 Press **▲** or **▼** to select [CONFIRM], and press ENTER.
- 2 After confirming the settings, press ENTER.
- 3 Select [END] and press ENTER.

[CLEAR ALL]: Press this button to clear all settings.

- 1 Press **▲** or **▼** to select [CLEAR ALL], and press ENTER.
- 2 To clear all settings, select [EXECUTE] and press ENTER.  
To cancel [CLEAR ALL], select [CANCEL].
- 3 To remove the write-protection, select [YES] and press ENTER.  
Select [END] and press ENTER.

Getting  
Ready

Taking  
Photographs

Playing  
Back Images

Erasing  
Images

Handy  
Functions

Other  
Applications

Additional  
Information



# Protecting Images

This feature prevents images from being erased.

## IMPORTANT

- Formatting erases all the images on a SmartMedia™, regardless of whether they are protected or not.
- To protect the entire SmartMedia™, see "Write Protection" (▶ Page 35).

## Protecting an Image

1

**Set the mode dial to [▶].**

The last image frame or the thumbnail display appears on the LCD monitor.

2

**Press the MENU button.**

The PLAYBACK MENU is displayed.

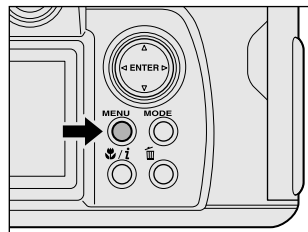

## Secondary/Other Air Flow Indicator (LED) (continued)

[illegible]

# EO OUT

The image before the projection is slightly less clear than playback images. (This is because they are displayed at a lower resolution.) Media is limited to 10000

The display system, according to the output system, is divided into two types. When the NTSC system is selected, the LCD monitor and TV are connected simultaneously. When the PAL system is selected, the LCD monitor and TV are connected alternately. During photography, images are displayed only on the LCD monitor, and during playback, images are displayed only on the TV.

Color Adapter ring (PDR-AR52)

1. Press the **Auto** button. The Auto button is located on the front panel of the unit. This button is used to automatically set the unit to the correct mode for the selected input source. Pressing the Auto button will cause the unit to automatically select the correct mode for the selected input source. This function is useful when you are unsure of the correct mode for the selected input source. Pressing the Auto button will cause the unit to automatically select the correct mode for the selected input source. This function is useful when you are unsure of the correct mode for the selected input source.

• To cancel write-protect signal or processing in progress of less than 100% photography canceled if set at step 4.  
 • Charging of flash in progress.  
 (Photography is not possible.)

- When playing back movie images, switching is between standard and image only.



# Protecting Images (continued)

## Removing the Protection

- 1 Carry out steps 1 to 3 in “Protecting An Image”.
- 2 Use ◀ or ▶ to select the image to unprotect, and press ENTER.

This fixes the images whose protection is to be removed, and [  ] under the image changes to [  ].

To unprotect an image, press ENTER again.

To remove the protection from two or more images, repeat this procedure for the necessary number of images.



- 3 Carry out step 5 in “Protecting An Image”.

### Memo

- To write-protect another image, write-protection can be simultaneously carried out if set at step 2.
- [  ] is displayed for images that are specified in the DPOF format, and write-protection cannot be removed. To remove write-protection, cancel the DPOF format setting.

## Setting Up the Settings (continued)

[illegible]

## DEO 00 Memo

The image on battery pack (PDR-BT2) is taken is slightly less clear than playback images. (This is because they are displayed at a lower resolution.)

The display will vary according to the output system.  
With the NTSC system, images can be displayed simultaneously on the LCD monitor and TV during playback.  
When this charger is connected to a household power outlet and photography and playback, each (PDR, BTG) is a short time.

**NAME** **Model** **Function**

NAME	Model	Function
View	Harden the PDR system, images cannot be displayed simultaneously. During photography, images are displayed only on the LCD monitor, and during playback, images are displayed only on the TV.	

Color Adapter ring (PDR-AR52)

**are**...  
...and packed with the...  
...This is called the Auto...  
...of automatic ch... This functio...  
...the LED...  
...press

[illegible]

When the PROTECT screen is displayed again, [P] is displayed under protected images.

Recorded time can be played back:

- To cancel write-protection for processing, the progress bar is automatically canceled if set at step 4.
- Charging of flash in progress

Auto Power OFF (Photography is not possible.)

- When playing back movie images, switching is between standard and image only.

# Recording/Playing Back Audio (continued)

## Playing Back Audio

**1** Press ◀ or ▶ to select the file.

**2** Press ▲.

Playback starts. Buttons and keys function as follows when pressed.

Button	During Playback	During Stop
▲	Pauses playback.	Playback audio file.
▼	Stops playback (returns to the beginning of the playback file).	
▶	Fast forwards the playback file (for duration that button is held down).	Proceeds to the next file.
◀	Rewinds the playback file (for duration that button is held down).	Goes back to the previous file.
ENTER	A list of recorded files is displayed after a stop.	A list of recorded files is displayed.
macro/info button	Switches the LCD monitor ON and OFF.	
Pressing the Zoom switch to "T"	Increases the volume.	
Pressing the Zoom switch to "W"	Decreases the volume.	

### Memo

- You can also listen to files on the earphone connected to the earphone jack terminal.

Additional Information

## SPRING LANGUAGE

**SP** LANGUAGE graphs or play them back on other devices (page 125).  
For more information, see the already contains a DPO information file, the message "REC READY".  
The mode dial has been moved to the left side of the camera body.  
The mode dial has been moved to the left side of the camera body.

## EO 00 Memo

The image on the battery pack (PDR-BT2) is taken is slightly less clear than playback images. (This is because they are displayed at a lower resolution.)

The display (PDR-CG1, PDR-CG1E, PDR-CG1U) with the SC system images can be displayed simultaneously on the LCD monitor and TV during this charge. This is convenient for household power outlet and charging the monitor for battery pack (PDR-BT2) in a short time. With the PAL system, images cannot be displayed simultaneously. During photography, images are displayed only on the LCD monitor, and during playback, images are displayed only on the TV.

Color Adapter ring (PDR-AR52)

[illegible]

When the LCD monitor automatically turns OFF, the last image displayed is stored in the camera's memory. When the LCD monitor is turned ON, the last image stored in the camera's memory is displayed again. [ ] is displayed under protected images.

- To cancel write-protect signal processing in progress, press the **ENTER** key.
- Charging of flash in progress.

(Photography is not possible.)

- When playing back movie images, switching is between standard and image only.



# Basic Photographic Settings (SET-UP mode)

This feature allows you to set up the environment for using your camera in addition to image-related settings. This is called "setup". The following items can be changed in the SET-UP mode:

AUTO POWER OFF/SOUND/TIME & DATE/OSD LANGUAGE/VIDEO OUT/FRAME NUMBER/RESET

The details set here are held in memory even if the camera is turned OFF.

- 1 Set the mode dial to [ SET-UP ].**  
The SETUP MENU appears.

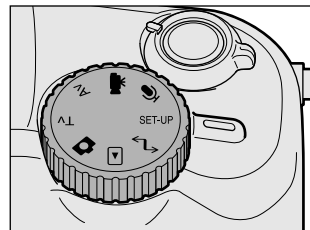

- 2 Use ▲ or ▼ to select the item you want to set.**

- ☞ AUTO POWER OFF ► Selects the time for automatic power off (P. 114)
- SOUND ► Turns on and off the sound (P. 115)
- TIME & DATE ► Setting the Time and Date (P. 115)
- OSD LANGUAGE ► Selecting the Monitor Display Language (P. 116)
- VIDEO OUT ► Setting Video Output (P. 116)
- FRAME NUMBER ► Resetting the Frame No. (P. 116)
- RESET ► Returning Settings to the Defaults (P. 118)

Setting item



[illegible][illegible]

ded from camera-usermanual.com

# Basic Photographic Settings (SET-UP mode) (continued)

## SOUND

Sets whether or not to sound the beep tone.

[ON] (default) : Sounds the beep tone according to the operating state or operation.

[OFF] : Does not sound the beep tone in any state.

## TIME & DATE

Sets the date and time.

Seconds cannot be set.

**1** Using ◀ or ▶ to select the item you want to set, and use ▲ or ▼ to set the value for each item.

Pressing ▶ advances the selection in the following order:

YEAR → MONTH → DAY → Hour → Minute → OK → CANCEL



**2** Select [OK] and press ENTER.

To quit setting, select the [CANCEL] button.

[illegible]





# Basic Photographic Settings (SET-UP mode) (continued)

## About Still Image Numbers and Folder Numbers

- When the image number is reset, a number starting from 0001 is assigned to an empty folder having the smallest number of the SmartMedia™ that is inserted.  
The folder number varies according to the state of the inserted SmartMedia™. To also reset the folder number, format the SmartMedia™ first and reset the image number.
- A running number continuing from the last photographed image is assigned as the image number regardless of whether or not only one image or all images were erased. A folder is assigned as a running number in the same way.
- The largest image number is 9999. When this number is reached, a new folder is created, and the image number is assigned starting from 0001.  
☞ Selecting the FOLDER ◀ Page 89
- The largest folder number is 999. When the folder number reaches 999, format the SmartMedia™.
- When you use SmartMedia™ that was used for taking photographs on another camera, or swap between two or more SmartMedia™, the data held by this camera is given priority as the image number. The folder number is assigned according to the state of your camera or the SmartMedia™.

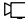
## About Image Numbers and Folders

- The image number assigned to the [  ] of the inserted SmartMedia™ starting from 0001.
- The image number is assigned as a continuous number from the next number following the largest number in the [  ] folder.
- The largest image number is 9999. When this number is reached, format the SmartMedia™.
- All moving image data is recorded to the [  ] folder.
- When you use SmartMedia™ that was used for taking photographs on another camera, or swap between two or more SmartMedia™, the image number is assigned according to the state of the SmartMedia™.

### Additional Information

When playing back movie images, switching is between standard and image only.

# Adjusting the LCD Monitor Brightness

This adjustment adjusts the brightness of the LCD monitor and not the brightness of the recorded image.

**1** Set the mode dial to [  ], [  ], [  ], [ TV ] or [ Av ].

**2** Press the **MENU** button.

The RECORDING MENU or PLAYBACK MENU is displayed.  
You can set the LCD monitor brightness in either of these menus.

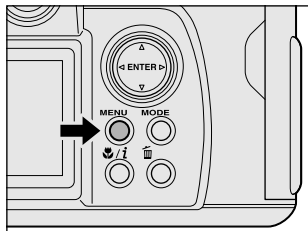

**3** Use **▲** or **▼** to select [LCD ] and press **▶**.  
The image and the LCD menu are displayed.

**4** Use **◀** or **▶** to adjust the brightness.

Press **◀** to darken (-) the LCD monitor, or **▶** to lighten (+) the LCD monitor.  
The LCD monitor can be adjusted within the range [-5] to [+5].  
(Default is 0.)



**5** Press **ENTER**.

This returns the camera to the previous mode.





# Taking and Playing Back Photographs on a TV

Television sets can be used to compose images for photography or playback. To do this, the camera must first be connected to the TV. We recommend using the AC adapter on an indoor power outlet when available.

## IMPORTANT

- Before you connect your camera to other equipment, be sure to turn all other connected equipment OFF. If you connect your camera to other equipment with the power still ON, the screen may flicker or the image may not be displayed normally.



**Connect the plug of the AV cable (provided) to the PC/AV terminal on the camera.**

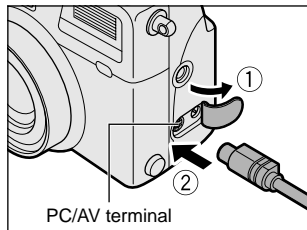

**Connect the plug of the AV cable to the video input terminal on the TV.**

## Memo

- Switch to the video output system, NTSC or PAL, according to the TV or country in which your camera is used.  
➡ For details on how to switch the system ► Page 116

...le).

**NAME** **NU** **Chatterbox** **With this charging phone**

Color Adapter



**led From camera**

**Log**

display  
charge  
in the N  
larger is  
tograph  
the lik  
in the P  
70 m  
played

018124

# Transferring Images to a PC

You can transfer images photographed on your camera to a PC using the packaged CD-ROM and USB cable. Images recorded on SmartMedia™ can also be transferred to a PC using the PC card adapter (sold separately) or floppy disk adapter (sold separately, PDR-FLP2). (▶ Page 124)

To transfer images to a PC, software must be installed and special cables connected.

For details, refer to the User's Guides for your PC and the Software Manual.

## Using SmartMedia™ on a PC

- When you use SmartMedia™, do not change or erase folders or file names (image data) on the SmartMedia™. Doing so might prevent the SmartMedia™ from being used on the camera.
- Format the SmartMedia™ only on your camera.
- To edit image data, copy the image data to hard disk on the PC, and edit the copied image data.

Getting  
Ready

Taking  
Photographs

Playing  
Back Images

Erasing  
Images

Handy  
Functions

Other  
Applications

Additional  
Information

## Separately Sold Accessories

**English** **Viewfinder LED**

## EO 00 Memo

The image on the left (PDR-BT2) is taken is slightly less clear than playback images. (This is because they are displayed at a lower resolution.)

With the NFC system, images can be displayed simultaneously on the LCD monitor and TV during photography and playback.

With the PAL system, images cannot be displayed simultaneously. During photography, images are displayed only on the LCD monitor, and during playback, images are displayed only on the TV.

Color Adapter ring (PDR-AR52)

When the battery is low, the LCD will display "Low Battery". This is called the Auto Low Battery Warning. When this message appears, you can turn off automatically this function by pressing the **Auto** button. The LCD will display "Auto Off". The LED indicator will blink. The LCD will return to the normal display after 10 seconds. Press the **Auto** button again to turn the function fully again. Or press the **Auto** button to turn the function off again.

[illegible]

- When playing back movie images, switching is between standard and image only.



# Connecting to Other Devices

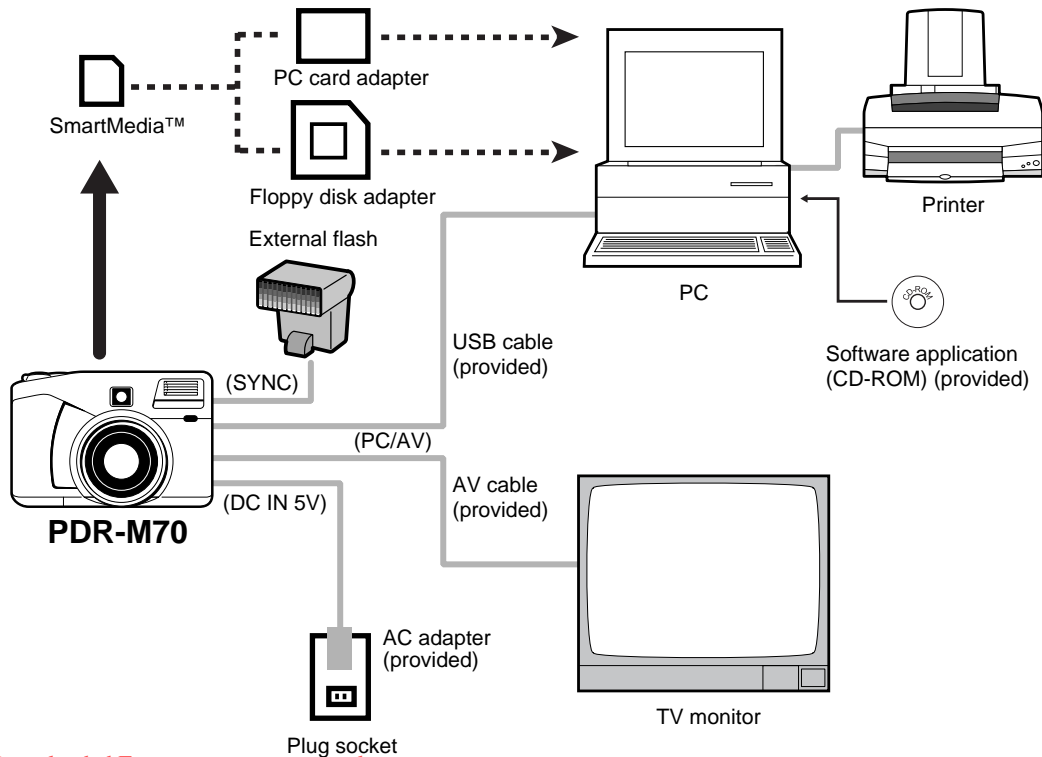

# Global Shutter (Continued) Displayed on LCD Monitor

	● SmartMedia <sup>®</sup>	Causes	Remedy	See Page
Getting Ready	No image is displayed on the LCD monitor.	The camera is in the PC mode. Change the camera to the photography or movie mode.		P.43
Taking Photographs	Even if the recording medium can be used over and over again, the LCD monitor displays "No image" or "No data".	The camera is in the playback mode.	Change the camera to the photography or movie mode.	P.64 See Page P.65
Playing Back Images	When the screen contains an extremely bright or dark area, the LCD monitor displays the message "Changed to Demo Mode" and the power is automatically turned OFF.	The battery is exhausted. The battery is not initialized.	Recharge the battery. Initialize the battery.	P.16 P.26 P.15
Handy Functions	When the screen contains an extremely bright or dark area, the LCD monitor displays the message "Changed to Demo Mode" and the power is automatically turned OFF.	The battery is exhausted. The battery is not initialized.	Recharge the battery. Initialize the battery.	P.16 P.26 P.15
Other Applications	When the screen contains an extremely bright or dark area, the LCD monitor displays the message "Changed to Demo Mode" and the power is automatically turned OFF.	The battery is exhausted. The battery is not initialized.	Recharge the battery. Initialize the battery.	P.16 P.26 P.15
Additional Information	When the screen contains an extremely bright or dark area, the LCD monitor displays the message "Changed to Demo Mode" and the power is automatically turned OFF.	The battery is exhausted. The battery is not initialized.	Recharge the battery. Initialize the battery.	P.16 P.26 P.15

## How to enter the Demo Mode

1. Set the mode dial to "SET-UP".

2. Return the settings in the SET-UP menu to their defaults. (RESET ○ Page 118)

3. Press the button while pressing the shutter button.

4. Power ON the camera again, and set the mode dial to the desired mode.

## How to return to the Normal Mode

1. Follow steps 1 to 3 in the above procedure again.

2. Power ON the camera again.

3. Set the mode dial to the desired mode.

When taking photographs by Burst Photography in the Demo Mode, there is a limit to the number of photographs you can take. You can take up to eight photographs in the Normal Mode.

# Specifications

## Camera Body

Recording medium	SmartMedia™ (3.3V) 2/4/8/16/32/64MB compatible							
Compression system	JPEG-compliant							
Image file format	Exif Ver.2.1-compliant							
<b>&lt;Still Image Mode&gt;</b>	Quality Mode	Compression Ratio	Image Size	File Size	8MB	16MB	32MB	64MB
Number of frames	FINE ★★★	1/5	FULL	Approx. 1.2MB	6	13	26	53
FULL size:			HALF	Approx. 300KB	27	55	110	221
2048 x 1536 pixels	NORMAL ★★	1/7.5	FULL	Approx. 800KB	9	19	39	79
HALF size:			HALF	Approx. 200KB	41	82	166	332
1024 x 768 pixels	BASIC ★	1/15	FULL	Approx. 400KB	19	39	79	159
			HALF	Approx. 100KB	82	165	332	665
<b>&lt;Movie Image Mode&gt;</b>	Quality mode	Compression Ratio	Image Size	Frame Size	Photography Time (secs) 16MB or more			
Standard movie photography time	FINE ★★★	1/10	FULL	16KB	60			
FULL size:		1/7	HALF	6KB	150			
320 x 240 pixels	NORMAL ★★	1/14	FULL	11KB	90			
HALF size:		1/10	HALF	4.5KB	200			
160 x 120 pixels	BASIC ★	1/19	FULL	8KB	120			
		1/4	HALF	3KB	300			
Conversion rules	DCF Ver. 1.0-compliant							

Getting Ready

Taking Photographs

Playing Back Images

Erasing Images

Handy Functions

Other Applications

Additional Information

# Global Shutter (Continued) Displayed on LCD Monitor

	Problem	Causes	Remedy	See Page
Getting Ready	No image is displayed on the LCD monitor.	The camera is in the standby mode.	Press the <b>Power</b> button to turn the camera on.	P.43
Taking Photographs	The LCD monitor displays the message "Changed to Demo Mode" and the power is automatically turned OFF.	The camera is in the Demo Mode.	Press the <b>Power</b> button to turn the camera on. The camera will return to the Normal Mode.	P.64
Playing Back Images	The LCD monitor displays the message "Changed to Demo Mode" and the power is automatically turned OFF.	The camera is in the Demo Mode.	Press the <b>Power</b> button to turn the camera on. The camera will return to the Normal Mode.	P.64
Erasing Images	The LCD monitor displays the message "Changed to Demo Mode" and the power is automatically turned OFF.	The camera is in the Demo Mode.	Press the <b>Power</b> button to turn the camera on. The camera will return to the Normal Mode.	P.64
Handy Functions	The LCD monitor displays the message "Changed to Demo Mode" and the power is automatically turned OFF.	The camera is in the Demo Mode.	Press the <b>Power</b> button to turn the camera on. The camera will return to the Normal Mode.	P.64
Other Applications	The LCD monitor displays the message "Changed to Demo Mode" and the power is automatically turned OFF.	The camera is in the Demo Mode.	Press the <b>Power</b> button to turn the camera on. The camera will return to the Normal Mode.	P.64
Additional Information	The LCD monitor displays the message "Changed to Demo Mode" and the power is automatically turned OFF.	The camera is in the Demo Mode.	Press the <b>Power</b> button to turn the camera on. The camera will return to the Normal Mode.	P.64

## How to enter the Demo Mode

1. Set the mode dial to "SET-UP".
2. Return the settings in the SET-UP menu to their defaults. (RESET) (Page 118)
3. Press the **Power** button while pressing the shutter button.
4. Power ON the camera again, and set the mode dial to the desired mode.

## How to return to the Normal Mode

1. Follow steps 1 to 3 in the above procedure again.
2. Power ON the camera again.



## Specifications (continued)

Date/Time		Simultaneously recorded to image data (Exif file format)
Automatic calendar function		Automatically adjusted until the year 2030
LCD monitor (*1)		1.8" wide viewing angle, low-temperature polysilicon TFT (113,578 pixels)
I/O terminal	DC IN 5V terminal	DC 5 V
	PC/AV terminal	Selectable Audio/Video cable or USB cable connections.
	Earphone jack terminal	3.5 mm diameter monaural
	SYNC terminal	Sync terminal for connection of external flash
Power supply		Rechargeable Lithium-ion battery pack (PDR-BT1, PDR-BT2) or AC adapter provided (PDR-AC10, PDR-AC10E or PDR-AC10U)
Operating conditions	Temperature	+5°C (+41°F) to +40°C (+104°F) (during operation)/-20°C (-4°F) to +60°C (+140°F) (during storage)
	Humidity	30 to 80% (during operation) no condensation
Camera dimensions		116 mm (4.6") (W) x 76 mm (3") (H) x 62 mm (2.4") (D) (excluding protrusions)
Weight		Approx. 340 g (12 oz) (excluding accessories, battery and SmartMedia™)

\*1 The LCD monitor on your digital camera is manufactured using advanced high-precision technology. Though fine spots may appear on the LCD monitor, this is not a malfunction. The LCD monitor can be used as it is.

# Glossary (continued)

	SmartMedia™	Causes	Remedy	See Page
Getting Ready	No image is displayed on the LCD monitor.	The battery is exhausted. The battery is not inserted correctly. The battery is not fully charged.	Change the camera to the photography or playback mode.	P.43
Taking Photographs	The LCD monitor displays the message "Changed to Demo Mode" and the power is automatically turned OFF.	The battery is exhausted. The battery is not inserted correctly. The battery is not fully charged.	Change the camera to the photography or playback mode.	P.43
Playing Back Images	The LCD monitor displays the message "Changed to Demo Mode" and the power is automatically turned OFF.	The battery is exhausted. The battery is not inserted correctly. The battery is not fully charged.	Change the camera to the photography or playback mode.	P.43
Erasing Images	The LCD monitor displays the message "Changed to Demo Mode" and the power is automatically turned OFF.	The battery is exhausted. The battery is not inserted correctly. The battery is not fully charged.	Change the camera to the photography or playback mode.	P.43
Handy Functions	The LCD monitor displays the message "Changed to Demo Mode" and the power is automatically turned OFF.	The battery is exhausted. The battery is not inserted correctly. The battery is not fully charged.	Change the camera to the photography or playback mode.	P.43
Other Applications	The LCD monitor displays the message "Changed to Demo Mode" and the power is automatically turned OFF.	The battery is exhausted. The battery is not inserted correctly. The battery is not fully charged.	Change the camera to the photography or playback mode.	P.43
Additional Information	The LCD monitor displays the message "Changed to Demo Mode" and the power is automatically turned OFF.	The battery is exhausted. The battery is not inserted correctly. The battery is not fully charged.	Change the camera to the photography or playback mode.	P.43

## How to enter the Demo Mode

1. Set the mode dial to "SET-UP".
2. Return the settings in the SET-UP menu to their defaults. (RESET) (Page 118)
3. Press the  $\Delta/\nabla$  button while pressing the shutter button.
4. Power ON the camera again, and set the mode dial to the desired mode.

## How to return to the Normal Mode

1. Follow steps 1 to 3 in the above procedure again.
2. Power ON the camera again.

## Specifications (continued)

### Lithium-ion battery pack (PDR-BT2)

Nominal voltage	3.7V
Nominal capacity	1300mAh
Operating temperature	0°C (+32°F) ~ +40°C (+104°F)
Dimensions	19.8 mm ( <sup>7</sup> / <sub>8</sub> " (W) x 20.4 mm ( <sup>4</sup> / <sub>5</sub> " (H) x 55.5 mm (2- <sup>1</sup> / <sub>6</sub> " (D)
Weight	Approx. 40 g (1.4 oz)
High-speed charging	Approx. 70 minutes * Battery charger (PDR-CG1, PDR-CG1E or PDR-CG1U) used

### SmartMedia™





Type	Image memory card for digital cameras (SmartMedia™)
Type of memory	NAND flash memory
Operating voltage	3.3V
Operating conditions	Temperature 0°C (+32°F) ~ +40°C (+104°F) Humidity 80% or less (no condensation)
Dimensions	37 mm (1- <sup>4</sup> / <sub>9</sub> " (W) x 0.76 mm ( <sup>3</sup> / <sub>100</sub> " (H) x 45 mm (1- <sup>7</sup> / <sub>9</sub> " (D)
Accessories	Anti-static case (x1), index labels (x2), write-protect stickers (x4)

These specifications are subject to change without notice.





## Warnings and Messages Displayed on LCD Monitor (continued)

Display		Meaning
LCD monitor	Status display	
FRAME NUMBER FULL	----	The maximum number of images (999 frames) that can be set is exceeded when setting DPOF setting files.
NO IMAGE AVAILABLE	----	No images are recorded to the SmartMedia™.
DPOF ERROR	----	There is a parameter that is not supported in the DPOF setting file.
DPOF PROTECT OFF	----	This is a confirmation for checking whether or not to remove DPOF write-protection when clearing DPOF settings.
NO FILE AVAILABLE	----	The data to be played back in the [  ] mode does not exist.
	----	The zoom lens cannot be correctly set up. Is the lens cap still attached to the lens? Check the lens cap, and turn the power ON again.
	----	You tried to play back an image not supported on this camera.
ERROR***	----	A camera problem has occurred. Contact a Support Center.
	----	Poor lighting conditions. Image will be vulnerable to vibrations.

# Global Shooting (Continued) Displayed on LCD Monitor

	● SmartMedia™	Causes	Remedy	See Page
Getting Ready	No image is displayed on the LCD monitor.	1. The camera is in the PC mode. 2. The camera is in the photography or playback mode.	1. Change the camera to the photography or playback mode.	P.43
Taking Photographs	● The LCD monitor displays the message "Changed to Demo Mode" and the power is automatically turned OFF.	1. The battery is exhausted. 2. The battery is overloaded. 3. The battery is damaged.	1. Recharge the battery. 2. Remove the battery and wait for 10 minutes. 3. Replace the battery.	P.64 See Page P.64
Playing Back Images	● The LCD monitor displays the message "Changed to Demo Mode" and the power is automatically turned OFF.	1. The battery is exhausted. 2. The battery is overloaded. 3. The battery is damaged.	1. Recharge the battery. 2. Remove the battery and wait for 10 minutes. 3. Replace the battery.	P.64 See Page P.64
Handy Functions	● The LCD monitor displays the message "Changed to Demo Mode" and the power is automatically turned OFF.	1. The battery is exhausted. 2. The battery is overloaded. 3. The battery is damaged.	1. Recharge the battery. 2. Remove the battery and wait for 10 minutes. 3. Replace the battery.	P.64 See Page P.64
Other Applications	● The LCD monitor displays the message "Changed to Demo Mode" and the power is automatically turned OFF.	1. The battery is exhausted. 2. The battery is overloaded. 3. The battery is damaged.	1. Recharge the battery. 2. Remove the battery and wait for 10 minutes. 3. Replace the battery.	P.64 See Page P.64
Additional Information	● The LCD monitor displays the message "Changed to Demo Mode" and the power is automatically turned OFF.	1. The battery is exhausted. 2. The battery is overloaded. 3. The battery is damaged.	1. Recharge the battery. 2. Remove the battery and wait for 10 minutes. 3. Replace the battery.	P.64 See Page P.64

## How to enter the Demo Mode

1. Set the mode dial to "SET-UP".
2. Return the settings in the SET-UP menu to their defaults. (RESET) (Page 118)
3. Press the **1/2** button while pressing the shutter button.
4. Power ON the camera again, and set the mode dial to the desired mode.

## How to return to the Normal Mode

1. Follow steps 1 to 3 in the above procedure again.
2. Power ON the camera again.

## Troubleshooting (continued)

Problem	Causes	Remedy	See Page
I cannot use the flash to take pictures.	The mode dial has been changed to another setting.	Set the mode dial to the correct setting.	–
	The flash is set to Suppressed Flash mode.	Set the flash to Auto, Red-Eye Reduction or Forced Flash mode.	P.58
	You pressed the shutter button while the flash was charging.	Wait until charging is completed before pressing the shutter button.	P.120
The flash will not charge.	The camera is set to Suppressed Flash mode.	Set the flash to Auto, Red-Eye Reduction or Forced Flash mode.	P.58
	The battery is exhausted.	<ul style="list-style-type: none"> <li>• Charge the battery.</li> <li>• Load a fully charged battery.</li> </ul>	P.26
The playback image is too dark even though I used the flash.	The subject is too far away.	Move closer to the subject. (about 0.8 m (2.64 ft) ~ 4.0 m (13.12 ft) (WIDE side setting))	P.58
Still/moving images cannot be played back.	Wrong playback mode	Switch the folder to play back.	P.89
The playback image is blurred.	The lens is not clean.	Clean the lens.	–
	The image is out of focus.	Set macro photography to ON or OFF according to the distance up to the subject.	P.56
I cannot format the SmartMedia™.	The SmartMedia™ is write-protected.	Remove the write-protection.	P.35
I cannot erase all the frames.	The frame is protected.	Remove the write-protection. Cancel the DPOF setting.	P.109 P.103
	The SmartMedia™ is write-protected	Remove the write-protection.	P.35
Nothing happens when I use the buttons and switches.	Camera malfunction.	Turn the power OFF and remove the battery once, and try again.	–
	The mode dial is not at the correct position.	Set the mode dial to the correct setting.	–
	The camera is in the Auto Power OFF mode.	Either press the shutter button half way down, or change the mode dial setting.	P.114

# Glossary (continued) Displayed on LCD Monitor

	Problem	Causes	Remedy	See Page
Getting Ready	No image is displayed on the LCD monitor.	The camera is not powered on.	Press the power button.	P.43
Taking Photographs	The LCD monitor displays the message "Changed to Demo Mode" and the power is automatically turned OFF.	The camera is not powered on.	Press the power button.	P.43
Playing Back Images	No image is displayed on the LCD monitor.	The camera is not powered on.	Press the power button.	P.43
Erasing Images	No image is displayed on the LCD monitor.	The camera is not powered on.	Press the power button.	P.43
Handy Functions	No image is displayed on the LCD monitor.	The camera is not powered on.	Press the power button.	P.43
Other Applications	No image is displayed on the LCD monitor.	The camera is not powered on.	Press the power button.	P.43
Additional Information	No image is displayed on the LCD monitor.	The camera is not powered on.	Press the power button.	P.43

## How to enter the Demo Mode

1. Set the mode dial to "SET-UP".
2. Return the settings in the SET-UP menu to their defaults. (RESET) (Page 118)
3. Press the  $\Delta/\nabla$  button while pressing the shutter button.
4. Power ON the camera again, and set the mode dial to the desired mode.

## How to return to the Normal Mode

1. Follow steps 1 to 3 in the above procedure again.
2. Power ON the camera again.



# Glossary

## ● AF/AE

AF (auto-focus) ... A function for automatically focusing your camera.

AE ... A function for automatically setting your camera's exposure.

AF/AE lock ... Locking of the focus and exposure settings.

## ● DPOF (Digital Print Order Format)

A standard for directly writing print information to the SmartMedia™. Files in this format can be printed easily by printers or photo print service bureaus that support this format.

## ● DCF (Design rule for Camera File System)

A file system standard defined by the JEIDA (Japan Electronic Industry Development Association) that is required for exchanging data between digital still cameras or a digital camera and a printer. This standard defines the hierarchy and file names used when storing image files on memory cards or other recording medium.

## ● Exif File Format (Exchangeable Image File Format)

A color still image format for digital still cameras approved by the JEIDA (Japan Electronic Industry Development Association). JPEG-compliant, this format is compatible with TIFF and JPEG and can be used in image processing software for most personal computers.

## ● JPEG

A file format used for compressing and saving color images. The compression ratio can be selected, but the higher the compression ratio, the worse image quality becomes. This format is widely used in the paint software for PCs and on the Internet.

## ● NTSC (National Television System Committee)

Method of television transmission in use in Japan and North America

## ● PAL (Phase Alternate Line)

Method of television transmission in use in the United Kingdom, Germany and other western European countries

## ● PC Card

A generic term for cards that meet the PC Card Standard.

## ● Red-Eye Effect

The phenomenon where people's eyes sometimes appear red in the picture when you use a flash to photograph them in low-light conditions. This is caused by the light of the flash reflecting off the inside of the eye.

## ● White Balance

When the brightness of the light changes, the human eye adapts so that a white object still looks white. On the other hand, devices such as digital still cameras see a white subject as white by first adjusting the balance to suit the color of the ambient light around the subject. This adjustment process is referred to as matching the white balance.

# Glossary (continued)

## Messages Displayed on LCD Monitor

	● SmartMedia™	Causes	Remedy	See Page
Getting Ready	No image is displayed on the LCD monitor.	1. The camera is not properly loaded. 2. The camera is not properly loaded. 3. The camera is not properly loaded.	1. Check the camera is properly loaded. 2. Check the camera is properly loaded. 3. Check the camera is properly loaded.	P.43
Taking Photographs	● Error message is displayed on the LCD monitor.	1. The camera is not properly loaded. 2. The camera is not properly loaded. 3. The camera is not properly loaded.	1. Check the camera is properly loaded. 2. Check the camera is properly loaded. 3. Check the camera is properly loaded.	P.43
Playing Back Images	● Error message is displayed on the LCD monitor.	1. The camera is not properly loaded. 2. The camera is not properly loaded. 3. The camera is not properly loaded.	1. Check the camera is properly loaded. 2. Check the camera is properly loaded. 3. Check the camera is properly loaded.	P.43
Erasing Images	● Error message is displayed on the LCD monitor.	1. The camera is not properly loaded. 2. The camera is not properly loaded. 3. The camera is not properly loaded.	1. Check the camera is properly loaded. 2. Check the camera is properly loaded. 3. Check the camera is properly loaded.	P.43
Handy Functions	● Error message is displayed on the LCD monitor.	1. The camera is not properly loaded. 2. The camera is not properly loaded. 3. The camera is not properly loaded.	1. Check the camera is properly loaded. 2. Check the camera is properly loaded. 3. Check the camera is properly loaded.	P.43
Other Applications	● Error message is displayed on the LCD monitor.	1. The camera is not properly loaded. 2. The camera is not properly loaded. 3. The camera is not properly loaded.	1. Check the camera is properly loaded. 2. Check the camera is properly loaded. 3. Check the camera is properly loaded.	P.43
Additional Information	● Error message is displayed on the LCD monitor.	1. The camera is not properly loaded. 2. The camera is not properly loaded. 3. The camera is not properly loaded.	1. Check the camera is properly loaded. 2. Check the camera is properly loaded. 3. Check the camera is properly loaded.	P.43

### How to enter the Demo Mode

1. Set the mode dial to "SET-UP".
2. Return the settings in the SET-UP menu to their defaults. (RESET) (Page 118)
3. Press the  $\frac{1}{2}$  button while pressing the shutter button.
4. Power ON the camera again, and set the mode dial to the desired mode.

### How to return to the Normal Mode

1. Follow steps 1 to 3 in the above procedure again.
2. Power ON the camera again.

## Contact Numbers

Country	Company name	Phone number for inquiry	e-mail address for inquiry	website
United Kingdom	Toshiba (UK) Ltd.	(01932) 828828	NA	www.toshiba.co.uk
Germany	Toshiba Europe Gmbh	(02131) 158 01	consumer@toshiba-teg.com	www.toshiba.de/consumer
Italy	Toshiba Consumer Products (Italia)	(039) 6099342	toshiba.italia@toshiba-tuk.com	www.toshiba.it/
France	Toshiba Systems (France)	01 47 28 28 50	consommateur@toshiba-tsfc.com	www.toshiba.fr/produits/video/index.htm
Switzerland	Toshiba Europe Gmbh Swiss Branch	01-946 07 77	info@toshiba.ch	www.toshiba.ch/
Singapore	Toshiba Singapore Pte	270-7776	NA	www.cp.toshiba.com.sg
Hong Kong	Toshiba Hong Kong Ltd	2956-0222	NA	www.toshiba.com.hk

## Numéros à appeler

Pays	Nom de la compagnie	Numéro de téléphone pour toute demande	Adresse e-mail pour toute demande	Site Web
Royaume-Uni	Toshiba (UK) Ltd.	(01932) 828828	NA	www.toshiba.co.uk
Allemagne	Toshiba Europe Gmbh	(02131) 158 01	consumer@toshiba-teg.com	www.toshiba.de/consumer
Italie	Toshiba Consumer Products (Italia)	(039) 6099342	toshiba.italia@toshiba-tuk.com	www.toshiba.it/
France	Toshiba Systems (France)	01 47 28 28 50	consommateur@toshiba-tsfc.com	www.toshiba.fr/produits/video/index.htm
Suisse	Toshiba Europe Gmbh Swiss Branch	01-946 07 77	info@toshiba.ch	www.toshiba.ch/
Singapour	Toshiba Singapore Pte	270-7776	NA	www.cp.toshiba.com.sg
Hong Kong	Toshiba Hong Kong Ltd	2956-0222	NA	www.toshiba.com.hk

TOSHIBA DIGITAL STILL CAMERA

# PDR-M70

DIGITAL STILL CAMERA



For customers in the U.S.A.

For technical support, please contact:  
(800)829-8318

5:00 a.m. to 5:00 p.m. PST, Monday to Friday except holidays,  
or e-mail us at: [dsc.support@tais.toshiba.com](mailto:dsc.support@tais.toshiba.com)

Toshiba America Information Systems, Inc.  
Imaging Systems Division

9740 Irvine Boulevard, Irvine, California 92618-1697

\* Address and telephone number are subject to change without notice.