

TEC-HU

USER MANUAL

TE 53 & TE 54 Waterproof TDS meters

SPECIFICATIONS

Range	TE 53	0 to 1999 ppm (mg/L)
	TE 54	0 to 9990 ppm (mg/L)
Resolution	TE 53	1 ppm (mg/L)
	TE 54	10 ppm (mg/L)
Accuracy (@20°C)		±2% F.S.
Typical EMC Deviation		±2% F.S.
Temperature Compensation		Automatic, 0 to 50°C with $\beta=2\%/^{\circ}\text{C}$
TDS factor		0.5
Calibration		Manual, at 1 point through trimmer
Probe	TE 53	TE73075 (replaceable)
	TE 54	TE73076 (replaceable)
Environment		0 to 50°C; 100% RH
Battery type		3 x 1.5V, alkaline
Battery life		approx. 250 hours of continuous use
Dimensions		165 x 30 x 30 mm
Weight		80 g

ACCESSORIES

TE73075	Replaceable Conductivity probe, LR
TE73076	Replaceable Conductivity probe, HR

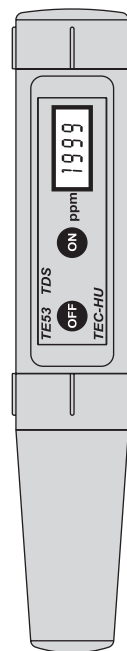

CALIBRATION:

- Immerse the meter in the proper calibration solution: 1382 ppm for **TE 53** and 6.44 ppt for **TE 54**.
- Unscrew the battery compartment cap on the top of the meter.
- Allow the reading to stabilize and with a small screwdriver turn the calibration trimmer inside the battery compartment until the display shows "1382" for **TE 53** or "6440" for **TE 54**.
- Replace the battery compartment cap.



The calibration is now complete.

OPERATION:

- Remove the protective cap.
- Turn the meter on by pressing the ON key.
- Immerse the probe in the solution to be tested.
- Stir gently and wait for the reading to stabilize.
- After use, rinse the electrode with water to minimize contamination.
- Always replace the protective cap after use.

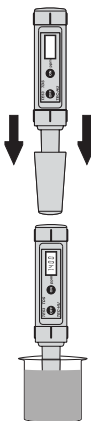

Note: If the reading is over-range, **TE 53** will display "1" while **TE 54** shows "...".



PROBE REPLACEMENT:

The probe can be easily replaced in the following way:

- Remove the protective cap.
- Unscrew the plastic ring on the top of the probe.
- Pull out the **TE73075** (or **TE73076**) probe and replace it with a new one (aligning the colored pin towards the LCD side).
- Make sure the gaskets are in place before screwing back the plastic ring.

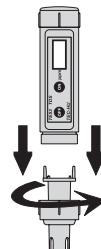

BATTERY REPLACEMENT:

The meter is supplied with BEPS (Battery Error Preventing System) which avoids any erroneous reading due to low battery level, by switching the meter off. To replace the batteries unscrew the battery compartment cap and replace all three 1.5V batteries while paying attention to their polarity. Make sure the gasket is in place before screwing back the cap.

Batteries should only be replaced in a non-hazardous area using the battery type specified in this instruction manual.