

EX-LUXD D&D DOME CAMERA

1/3" SONY 960H EX-VIEW HAD CCD

MODEL : EX-LUXD(4mm)



Features

- High Resolution 700TV Lines
- Super Low Light Camera (0.0003Lux @F1.2)
- Weatherproof Housing
- Simple OSD Setting
- 3D-DNR, WDR, Sense-up (X512)
- De-Fog Function
- Video Test Output

AVE. 20 DE NOVIEMBRE NO.805 COL. CENTRO. C.P. 31000,
CHIHUAHUA, CHIH., MEXICO
SYSCOM VIDEO



INSTALLATION

< FUNCTION >

Video Test Output

OSD Control

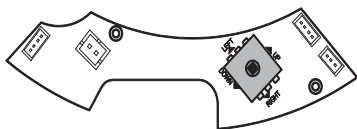

1. Dome Base Mounting
 - Open the dome cover.
 - Mount the base of camera to a sturdy surface using screws with accessories supplied through premade holes on the base of the dome.
2. Power Connection & Monitor Impedance
 - To avoid fire or shock hazard, always use a CE listed power supply.
 - Check Monitor impedance switch if the image is blurred.
3. Camera Adjustment
 - Adjust camera angel by moving the gymbal bracket.
 - Adjust Zoom and Focus by lever attached to lens if it is varifocal lens.
 - Use the OSD control to select the different camera functions if it is OSD model.
4. Dome Cover Mounting
 - Put the dome cover back and make sure it is properly fixed.

Connector

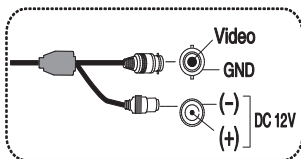

Accessories



Manual



L-Wrench



Screw &
Anchor for fixing



Video
Test Cable



When you install the camera, please glue up the end of cable to keep it stable in order to protect the camera from the humidity problems.

CAUTIONS

1. Assemble the main body of the camera with lens quickly at a clear place to avoid dust.
2. Be careful not to drop this camera and not to impact on it. CCTV camera is a precision machine.
3. Do not install the camera opposite of the sun so that it be avoided direct light.
4. The camera must be installed at a steady place without shaking or something else.
5. Do not pull the cable. if you pull the cable, it will make electrical problems such as disconnection.
6. Installation this camera at safety place where is no water. If the camera has some problems with water accidentally. You have to contact A/S center that sold the camera to you.
7. If you would like to relocate the already installed product, be sure to turn off the power and then move or reinstall it.

WARRANTY

6. If you need warranty service, please return the product to your distributor/dealer. Proof of purchase may be required.

Dimension & Specification

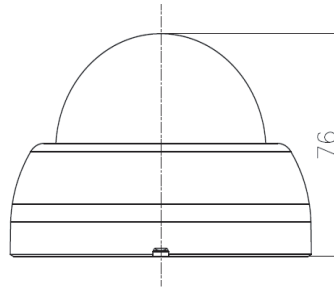
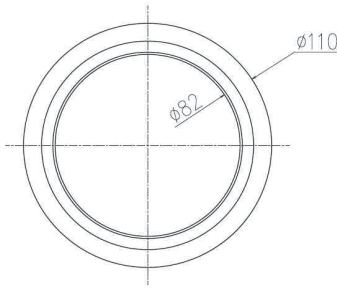

[Unit:mm]

ITEM

DND-D900

Image Sensor	1/3" 960H EX-VIEW HAD CCD II (SONY)
Total Pixels	1020(H) x 508(V)(NTSC), 1020(H) x 596(V) (PAL)
Effective Pixels	976(H) x 494(V)(NTSC), 976(H) x 582(V) (PAL)
Scanning System	2:1 Interlace
Sync. System	Internal
H.Resolution	700TV Lines
Signal Process	Digital Signal Process
Min. Illumination	0.0003Lux @ 30IRE, F1.2
LENS	f4mm / f6mm / f8mm Board Lens (F1.1)
S/N Ratio	More than 50dB (AGC Off)
Iris Adjustment	ALC / ELC
AGC	OFF / LOW / MIDDLE / HIGH
Shutter Speed	1/60~1/120,000 (NTSC) 1/50~1/120,000 (PAL)
SENSE-UP	OFF / AUTO (X2 ~ X512)
DAYNIGHT	DAY / AUTO / NIGHT / SMART IR
BACKLIGHT	OFF / WDR / D-WDR / BLC / HSBLC
Digital Zoom	OFF / ON (x1 ~ x16)
WHITE BALANCE	ATW (1,700°K ~ 11,000°K) / AUTO / AWC-> SET KEY / MANUAL
3D-DNR	3D-DNR (Level Adjustment, 0~100)
Digital Effect	OFF / V-FLIP / MIRROR / ROTATE
MOTION DETECTION	OFF, ON (8 AREAS)
PRIVACY	OFF, ON (8 AREAS)
LANGUAGE	English, Korean, Japanese, German, French, Italian, Polish, Russian, Portuguese, Spanish, Turkish, Arabic, Hebrew
Power Consumption	DC 12V - 130mA / AC 24V - 2W
Operating Temperature	-10 ~ 50 (Humidity : 0%RH ~ 80%RH)
Storage Temperature	-20 ~ 60 (Humidity : 0%RH ~ 85%RH)
Dimension	80(W)mm x 76mm(H) x 100(D)mm
Weight	Approx. 550g

OSD MENU

EXPOSURE	ALC/ELC	BACK LIGHT (OFF/WDR/D-WDR/BLC/HSBLC)
		BRIGHTNESS
		AGC
		SHUTTER
		SENS-UP EXIT
WHITE BALANCE	ATW	-
	AUTO	-
	AWC->SET KEY	-
	MANUAL	RED/BULE/EXIT
DAY/NIGHT	DAY	-
	NIGHT	BURST
		EXIT
	AUTO	BURST
		LEVEL
		DWELL TIME
		EXIT
	SMART IR	BURST
		LEVEL
		POSITION
SIZE		
EXIT	-	
MOTION DET	OFF	-
	ON	AREA SETUP
		SENSITIVITY
		DISPLAY
		ALARM OUT
EXIT	-	
3D-DNR	ON/OFF	-
PRIVACY MASK	OFF	-
	ON	RECTANGLE
		CIRCLE
		POLYGON
EXIT	-	
SPECIAL	D-ZOOM	ON/OFF
	D-EFFECT	OFF/V-FLIP/ROTATE/MIRROR
	SHARPNESS	(0~100)
	COLOR	(0~100)
	DEFOG	-
	SYNC	INT/L&L
	USER TITLE	OFF/ON
	LANGUAGE	14 LANGUAGES SELECTABLE
	EXIT	-
SYSTEM	FACTORY RESET	-
	COMMUNICATION	CAMERA ID
		PROTOCOL
		BAUD RATE
		SAVE&REBOOT
	EXIT	-
DEFECT PIXEL	-	
EXIT	-	
EXIT	RET/TOP/END	-