

ESCORT®

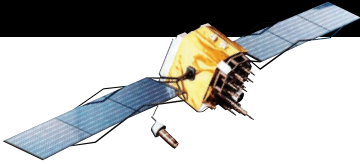

PASSPORT® iQ



**Ultimate Radar/Laser Detection
Easy 3D Navigation**

U L T I M A T E D R I V I N G C O M P A N I O N

User's Manual

SECTION 1: SETTING UP PASSPORT iQ

What's Included

5" GPS/radar-detection device
 SmartCord
 USB cable
 Mounting bracket
 Owner's Manual on CD
 Quick-Reference Guide

Device Controls and Features



Component	Description
Power Switch	Switches PASSPORT iQ on or off, or locks the screen
Charge Light	<i>Red:</i> Unit is plugged in, and battery is not fully charged <i>Alternating red and green:</i> Battery is almost completely charged <i>Green:</i> Battery is completely charged
LCD Screen	5" touch-sensitive screen
USB Port	Used only for connecting PASSPORT iQ to your PC or laptop to download software updates or charge the battery
Reset Button	Press to reset the device if unit stops responding
Power Jack (telephone-type jack)	For connecting your SmartCord to power PASSPORT iQ with your vehicle's battery
Earphone Jack	For connecting 3.5 mm mono earphone
Micro SD Card Slot	For adding future optional features

Alert Light	For indicating radar or laser alerts
Rear Laser Lens	For receiving laser alerts
Audio Speaker	For audible alerts and voice prompts
External GPS Port	Accepts external GPS device for improved reception
Mount Release Button	For conveniently releasing PASSPORT iQ from the windshield mount
Front Laser Lens	For receiving laser alerts (ensure clear view of road ahead)
Radar Antenna	For receiving radar alerts (ensure clear view of road ahead)

SmartCord

The SmartCord is a special power cord with a power-on indicator (which only lights up when PASSPORT iQ is turned on), a bright LED alert light that warns of radar or laser, and a mute button right on the plug for convenient access to PASSPORT iQ's Mute and TrueLock features. It's perfect for any car where reaching the device's mute button on the windshield is a stretch. For details on connecting PASSPORT iQ to the Smart Cord, see "Connecting the Power."

Connecting the Power

PASSPORT iQ is supplied with a SmartCord for power while in a vehicle.



Caution: Disconnect PASSPORT iQ from the SmartCord when starting the vehicle.

To power PASSPORT iQ, plug the small end of the SmartCord (telephone-type connector) into the modular jack on the device's right side and plug the lighter-plug adapter into your vehicle's lighter socket or accessory socket, as shown in the illustration below.



PASSPORT iQ operates on 12-volt DC negative ground only. The lighter plug provided is a standard size and will work in most vehicles.



Note: Depending on your vehicle, the lighter socket power may be continuously on or it may be switched on and off with your ignition switch.

Charging the Battery

PASSPORT iQ comes with a built-in rechargeable battery. Charge the battery fully before using it for the first time. To charge the battery, connect PASSPORT iQ to a desktop or laptop computer via the USB cable or to an AC/DC 12-volt wall adapter via the SmartCord. Charging time is normally about eight hours (or overnight) via USB computer connection or two hours via wall adapter. A fully charged battery delivers about two hours of use.



Note: Radar/laser detection features cannot run on the PASSPORT iQ battery alone. These functions will only work when your device is connected to your vehicle via the SmartCord.



Battery warnings

If these guidelines are not followed, the internal lithium-ion battery may experience a shortened lifespan or may present a risk of damage to PASSPORT iQ, fire, chemical burn, electrolyte leak, and/or injury.

- Do not remove or attempt to remove the non-user-replaceable battery.
- Do not leave PASSPORT iQ exposed to a heat source or in a high-temperature location, such as in the sun in an unattended vehicle. To prevent damage, remove from the vehicle or store it out of direct sunlight, such as in a glove box.
- Do not puncture or incinerate.
- When storing PASSPORT iQ for an extended time, store within the following temperature range: 32°F to 77°F (0°C to 25°C).
- Do not operate PASSPORT iQ outside of the following temperature range: -4°F to 131°F (-20°C to 55°C).
- When disposing of PASSPORT iQ, take it to a professional, such as a waste electronics treatment facility, to have the battery removed and recycled.



Warning: PASSPORT iQ, its packaging, and its components contain chemicals known to the state of California to cause cancer, birth defects, or reproductive harm. This notice is provided in accordance with California's Proposition 65.

Mounting in Your Vehicle



Warning: Do not mount PASSPORT iQ where it impairs the driver's view of the road. Make sure that airbags are not obstructed by the device.

Mounting location

Be sure to mount PASSPORT iQ level and high enough on your front windshield to provide a clear view of the road ahead. In order for the GPS features to work properly, the top case must have a clear view of the sky. For optimum radar and laser sensitivity, center PASSPORT iQ between the driver and passenger and ensure the back of the device faces forward.

Mount PASSPORT iQ away from windshield wipers, other solid objects, and heavily tinted areas that might obstruct the radar antenna or laser lens.

Mounting instructions

PASSPORT iQ's EasyMount windshield bracket is designed for unobtrusive and hassle-free mounting.

To attach the EasyMount bracket to your windshield, press the suction cup firmly onto the glass, then flip the locking clamp to ensure the suction cup is adhered to the windshield securely. Be sure to keep both your windshield and the suction cup clean.

To attach PASSPORT iQ to the EasyMount bracket, slide PASSPORT iQ downward so the EasyMount bracket locks into the slot on the back of the device.

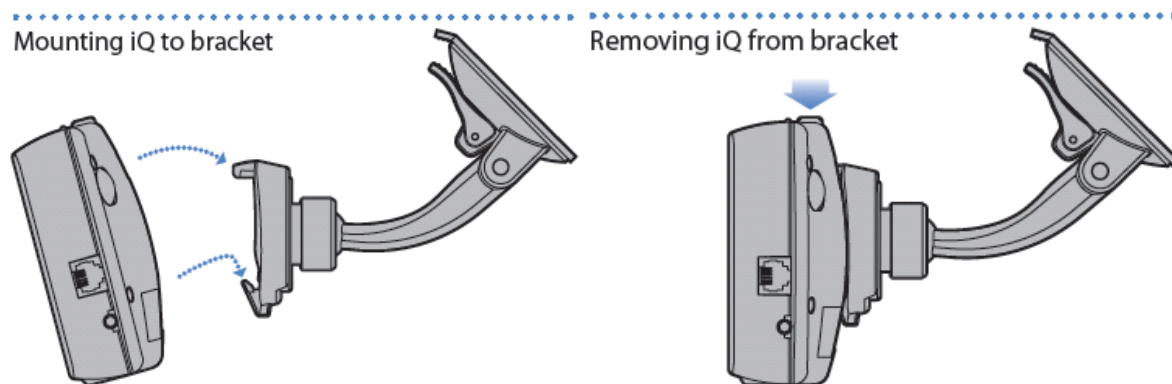

To adjust PASSPORT iQ on your windshield, move the adjustable EasyMount bracket arm to your preferred view.

You can leave the EasyMount bracket in place on your windshield and easily remove PASSPORT iQ by pressing the EasyMount release button and sliding PASSPORT iQ off the mount. Again, be sure to position the bracket where it won't present a hazard in the event of an accident.

Important Safety and Product Information

1. Read these instructions.
2. Keep these instructions.
3. Heed all warnings.
4. Follow all instructions.
5. Do not use this device near water.
6. Clean only with a damp cloth.
7. Maintain well-ventilated conditions around PASSPORT iQ to avoid overheating. Install this device according to the instructions in this manual.
8. Do not install near any heat sources, such as radiators, heat registers, stoves, or other devices (including amplifiers) that produce heat.
9. Only use attachments and accessories specified by the manufacturer.
10. Disconnect this device during lightning storms or when it will not be used for a long period of time.
11. Refer all servicing to qualified service personnel. Servicing is required when PASSPORT iQ has been damaged in any way, such as damage to a power supply cord or plug, exposure to rain or moisture, operational failure, or if dropped.
12. Keep PASSPORT iQ away from liquids that might drip or splash on it. Do not place liquid-filled containers on it.
13. **Failure to avoid the following potentially hazardous situations could result in an accident or collision resulting in death or serious injury:**
 - When installing PASSPORT iQ in a vehicle, place the unit securely, so it does not obstruct the driver's view of the road or interfere with vehicle operating controls, such as the steering wheel, foot pedals, or transmission levers. Do not place in front of or above any airbag.
 - When navigating, carefully compare information displayed on PASSPORT iQ to all available navigation sources, including information from street signs, visual sightings, and maps. For safety, always resolve any discrepancies or questions before continuing navigation and defer to posted road signs.
 - Always operate the vehicle in a safe manner. **Do not become distracted by PASSPORT iQ while driving and always be fully aware of all driving conditions** Minimize the amount of time spent viewing PASSPORT iQ's screen while driving and use voice prompts when possible. Do not input destinations, change settings, or access any functions requiring prolonged use of PASSPORT iQ's controls while driving. Pull over in a safe and legal manner before attempting such operations.
 - PASSPORT iQ is designed to provide route suggestions. It is not designed to replace the need for driver attentiveness regarding road closures or road conditions, traffic congestion, weather conditions, or other factors that may affect safety while driving.



Important: Always be sure that PASSPORT iQ and any external device connected to it are switched off and unplugged from the power supply before you attempt to connect it to another external device.