

User manual for 2-Port USB KM Switch

RP-KVM02C is designed for users who are in need for operating notebook and desk top PC simultaneously. It allows users to share a USB mouse and a USB keyboard between two computers. It offers an out-of-box solution with no additional cables needed, entirely plug-n-play and requires no software drivers. It is also powered through the USB bus and does not require a power supply.

It is the ideal KM Switch to save your money, time, & space., let you access and control up to two USB-enabled multimedia computers using only one USB keyboard and mouse.

Features:

- * One USB keyboard and USB mouse control two computers
- * Long molded-in cables 1.2M to simplify setup
- * Support Hot-Key switching & Push button control
- * No software drivers required - simply connect the cables to the computers
- * Plug-n-Play monitor support
- * No power adapter required
- * Support Win2000/ME/XP/Vista/Win 7 /Linux ...etc

Specification:



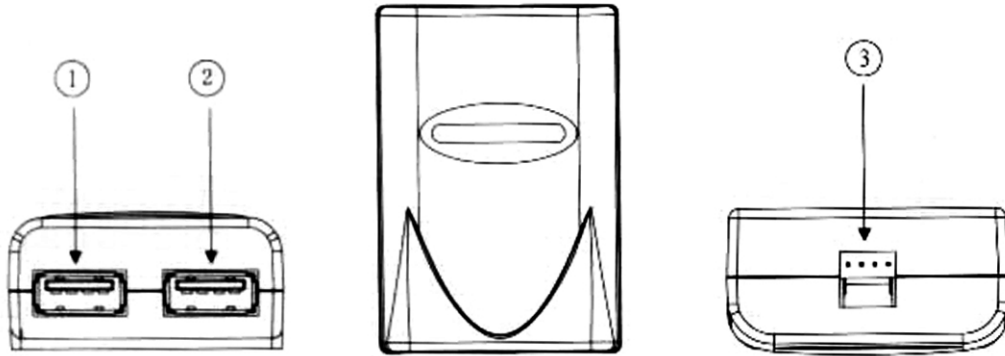

PC Side Connector	<ul style="list-style-type: none">• 1 Set of Keyboard & Mouse to 2PCs (2 Display Screens)
Console Side Connector	<ul style="list-style-type: none">• USB A-Type (F) Cable x 2 (10cm)
Compatible USB Device	<ul style="list-style-type: none">• Standard Keyboard & Mouse
Selection method	<ul style="list-style-type: none">• Push Button/Hot-key
LED Status	<ul style="list-style-type: none">• PC1-1, PC2-2
Case design	<ul style="list-style-type: none">• Plastic
Environment	<ul style="list-style-type: none">• Operating temperature : 0°C to 40°C
Dimension	<ul style="list-style-type: none">• 60 * 42 * 25mm
Weight	<ul style="list-style-type: none">• 90g
Certification	<ul style="list-style-type: none">• FCC, CE

Introduction



Number	Model	Funtion
1	USB A- Type(F)	USB Mouse
2	USB A- Type(F)	USB Keyboard
3	USB A- Type(M) Cable	USB Cable(120cm)

Keyboard Hot Key:

Hot Key Definiton	
Scroll+Scroll+1	Switch to PC1
Scroll+Scroll+2	Switch to PC2
Scroll+Scroll+  or 	Switch to Next PC
Scroll+Scroll+  or 	Switch to Previous PC
Scroll+Scroll+S	Auto-scan mode every 10 second

Remark:

* After shot down each PC, please switch to the other one before the power shot down.

*The right side port only for USB Keyboard.

*The left side port only for USB Mouse.

Application:

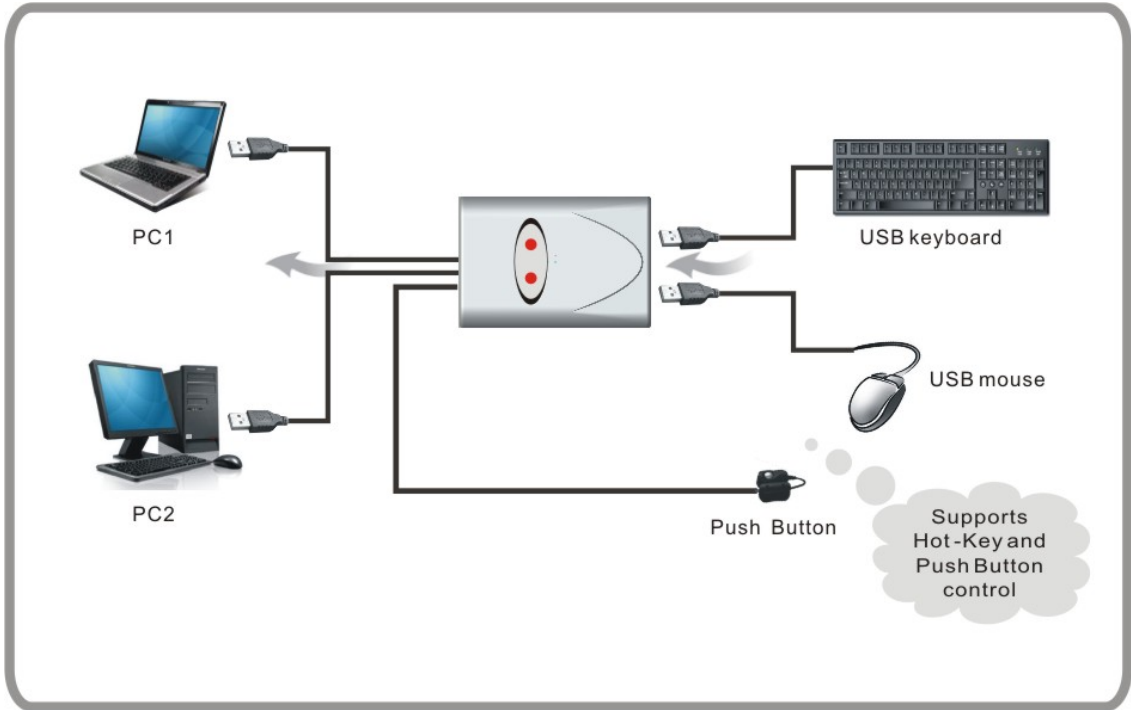

Mini-style, carrying light



USB powered, no need to carry additional accessories