

**UK** Subject to change

**Document Ref:**  
FTB-13/19847/PMR24/Issue 1/April 02

**Copyright©**  
These instructions are the sole property of Ferm-Omega Tools and may not be reproduced

**USER'S MANUAL**

## ***Ferm Table Drilling Machine***

***FTB-13***

**CE**

**Ferm<sup>®</sup>**

Art.nr. 733500  
Screwfix Art.nr. 19847

**FERM TABLE DRILLING MACHINE  
FTB-13  
USERS MANUAL**

**TECHNICAL SPECIFICATIONS**

Voltage	230V
Frequency	50Hz
Power input	350 W
No load speed	580-2650/min
Number of speeds	5
Chuck capacity/Morse Conical	13mm/B-16
Weight	20kg
Lpa (sound pressure level)	62.1 dB(A)
Lwa (sound power level)	75.1 dB(A)
Vibration value	<2,5 m/s <sup>2</sup>

**PRODUCT INFORMATION**

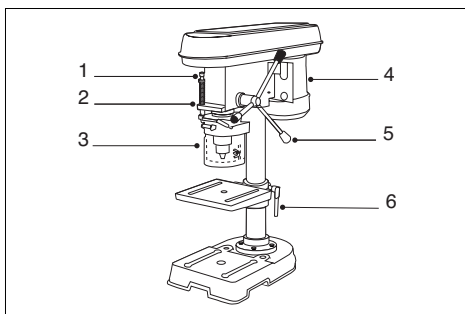

1. On/off switch
2. Drill dept gauge
3. Protection guard
4. Motor
5. Drill dept lever
6. Table adjustment

Check first whether or not the delivery has been damaged by transport and/or whether all the parts are present.

**SAFETY INSTRUCTIONS**

The following pictograms are used in these instructions for use:

 Denotes risk of personal injury, loss of life or damage to the tool in case of non-observance of the instructions in this manual.

 Denotes risk of electric shock.

Carefully read this manual before using the machine. Make sure that you know how the machine functions and how to operate it. Maintain the machine in accordance with the instructions to make sure it functions properly. Keep this manual with the machine.

Ferm products are manufactured to high quality standards they are safe and fit for purpose at time of sale, but all tools can be dangerous if the correct precautions are not taken. Always follow these instructions, do not carry out the operation until you are sure you can do so in safety. Remember consider the work environment for safe operation as well as safety for tool use.

 **Warning!** When using electric tools, basic safety precautions should always be followed to reduce the risk of fire, electric shock and personal injury. Read all these instructions before attempting to operate this product. Save these instructions for future reference.

**PERSONAL SAFETY**

**Use Personal Protection Safety Equipment**

Protect eyes with safety glasses or goggles note: the use of safety protective eyewear without the CE mark can lead to serious injury if the glass breaks. A suitable dust mask should be worn if cutting drilling or sanding is dusty, in particular chipboard or MDF. Approved safety footwear and headgear should worn as appropriate, for example on building works or when heavy weights are involved.

**Dress properly**

Do not wear loose clothing or jewellery. It can get caught in moving parts. Non-skid footwear is recommended when working out doors. Wear protective hair covering to contain long hair.

**Stay alert**

Watch what you are doing Use common sense. Do not operate tools when tired or after taking alcohol or prescription/ non-prescription drugs.

**EXPLODED VIEW**

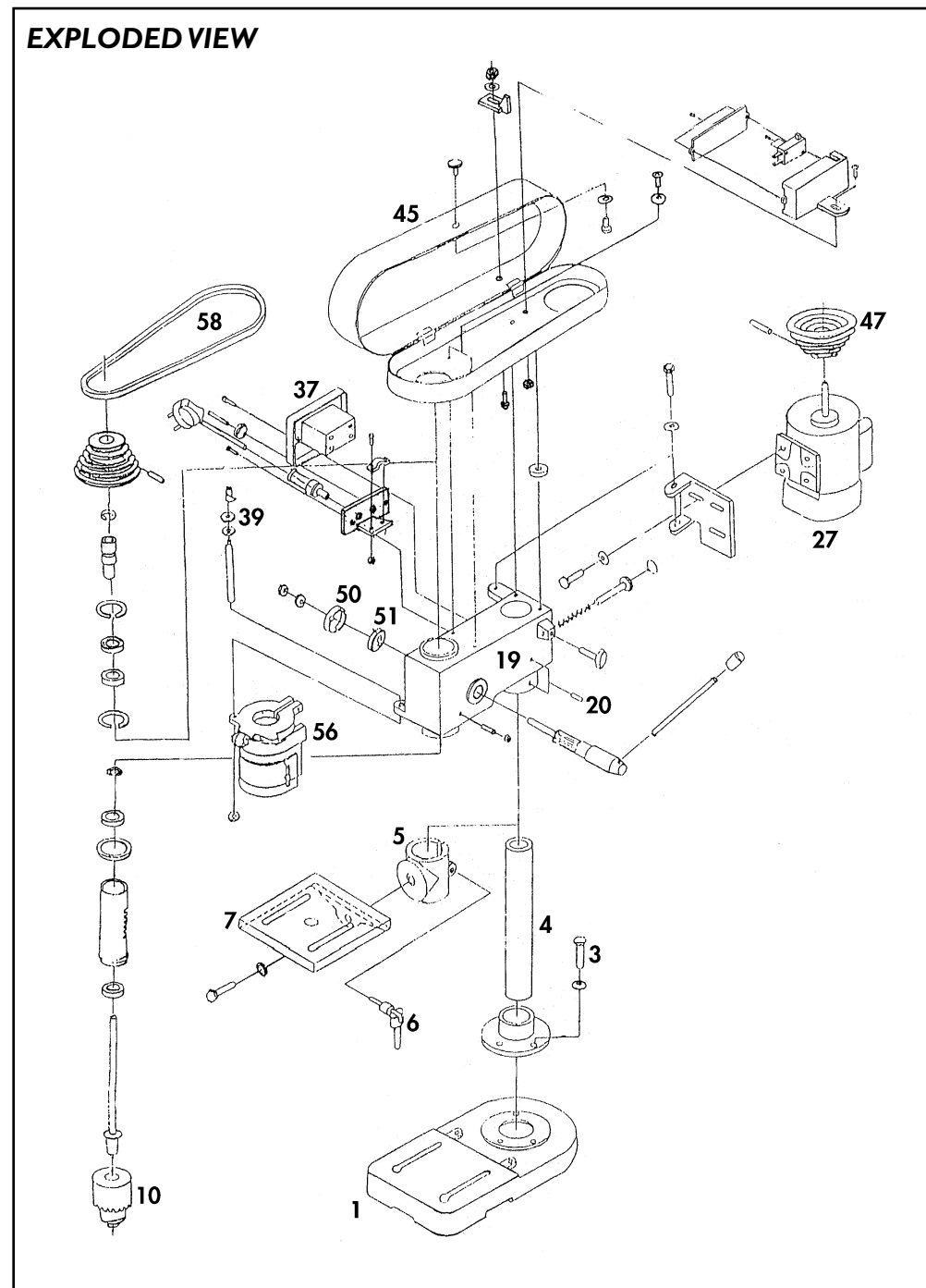

## SPARE PARTS LIST FTB-13

REF NR	DESCRIPTION	FERM NR
27	MOTOR	311053
37	MAGNETIC SWITCH	311051
50	COVER FOR SPRING	311059
51	SPRING	311058
56	CHUCK GUARD	311055
58	V-BELT	800157
10	CHUCK	311054
-	CHUCK KEY	311057
-	CONDENSER	311056

### OPERATIONAL SAFETY

#### Concentrate

Do not allow routine, which occurs when using the machine frequently, to lead to mistakes. Remember that a slight lack of concentration can result in serious injuries in a split second.

#### Keep work area clean

Cluttered areas and benches invite injuries.

#### Consider the work environment

Do not expose power tools to rain or use them in damp or wet locations. Keep work area well lit. Do not use power tools in the presence of flammable liquids, vapours or gases.

#### Guard against electric shock

This unit contains dangerous voltages. Use a RCD (residual current device) to provide protection against electrical shock. Prevent body contact with grounded surfaces (e.g. pipes, radiator, ranges or refrigerators).

#### Keep children and pets away

Do not let children or pets come into contact with the tool, extension cable or work area.

#### Do not force the tool

It will work better and safer at the rate for which it was intended.

#### Use the right tool

Do not force small tools or attachments to do the job of a heavy-duty tool. Do not use tools for purposes for which they were not intended; for example do not use a circular saw for cutting trees or logs.

#### Do not abuse cable

Never carry tool by the cable or pull it to disconnect it from the power socket. Keep cable away from heat, oil and sharp edges. Do not touch the metal plug pins when connecting or removing the plug.

#### Secure Work

Use clamps or a vice to hold work. It is safer than using your hand and it frees both hands to operate the tool.

#### Do not over-reach

Keep a proper footing and balance at all times.

#### Disconnect tools from power supply

When not in use, before servicing and when changing accessories such as blades, bits and cutters.



*Always switch off and unplug the appliance from the power supply when making adjustments*

#### Remove adjusting keys and wrenches

Ensure that they are removed from the tool before switching on.

#### Avoid unintentional starting

Do not carry plugged in tools with your finger on the switch. Check that the switch is off before plugging in to socket.

#### Outdoor use extension cables

When the tool is used outdoors use only an extension cable intended for outdoor use and marked accordingly. Use a RCD (residual current device) to provide protection against electrical shock. Do not use in rain or damp conditions.

#### Connect a dust extraction device

Whenever there are facilities for fitting a dust extraction system, make sure it is connected and used.

#### Use recommended accessories

The use of any other accessory or attachment other than recommended in the instructions or catalogue may present a risk of personal injury.

## BEFORE USING THE TABLE DRILL



Ensure the drill is unplugged from mains and the drill is switched off.

Refer to illustration below.

- The drill should be mounted on a stable surface and secured with suitable bolts/screws (not supplied) through the two holes in the centre of the footplate (13). Use washers as necessary to make sure the unit is securely fixed – the footplate is cast iron, do not over tighten the fixings.
- Route the mains cable well away from the chuck and front side of drill, ensure that it cannot get caught in moving parts or the workpiece.

## ASSEMBLY

### Fasten the column to footplate

- Fasten the column (11) to footplate (13) with the three bolts/washers/lock washers provided.
- Insert the bolts, with their washers, through the flange on the column and screw finger tight into threads in footplate.
- Tighten with suitable spanner.

### Slide the table assembly

- Slide the table assembly with the degree scale facing up over the column and lock with the lever (6)
- Put the drill head assembly onto the top of the column and slide down until the top of the column hits the stop. Line up the front of the drill with front face of foot and secure the drill head with the set pins (8) using the 4mm Allen key provided,

### Fit the chuck guard

- Fit the chuck guard (3) into the red housing on the chuck spindle and secure with the bolts/washers/nuts provided.
- Do not operate this drill without the guard in place and in the down position.

### Fitting the drill chuck (9)

- Put the chuck guard in its upper position. Degrease the inside of the chuck and the drill spindle using a suitable biodegradable solvent, dry off and push the chuck onto the tapered spindle.
- Tap the chuck gently onto the spindle with a soft face hammer.

### Fit the depth adjustment levers

- Screw the three levers (5) into the boss on the left hand side of the drill head hand tight.
- Run idle for 15 minutes.
- Check the V-belt tension (see section below) - start the drill and run idle for 15 minutes to distribute the factory-applied grease through out the bearings. This is done only when using the drill for the first time.

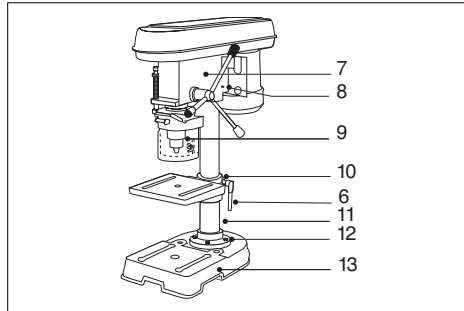
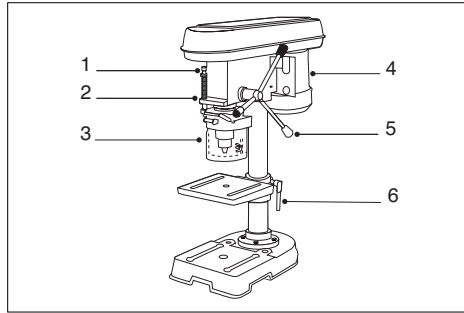

## ADJUSTING THE DRILL SPINDLE SPEED



Ensure the drill is unplugged from mains and the drill is switched off.

Refer to illustration below.

- Remove the crosshead screw on right hand side of pulley cover (14) and open the cover.
- Loosen the thumbscrew (18) and push the motor towards front of drill.
- Move the V-belt to set the desired speed; the speed chart is on the inside of the pulley cover. Make sure the V-belt runs parallel as illustrated on the chart, if the belt is installed diagonally it will slip and wear out quickly.
- Tighten the thumbscrew.
- Close cover and secure with crosshead screw.
- When you have changed speeds the V-belt tension must be checked. See section below

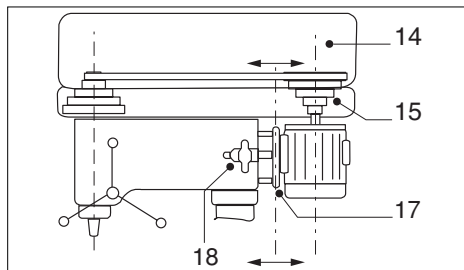

### Checking the V-belt tension



Ensure the drill is unplugged from mains and the drill is switched off

Refer to illustration below

- Open the pulley cover, loosen thumbscrew (18)
- Move the motor plate (17) backwards /forwards to adjust the V-belt tension. The correct tension is +/- 1 cm in middle of belt as illustrated.
- After adjustment close and secure pulley cover.

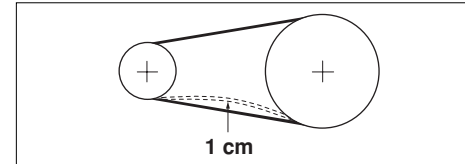

### INSERT A DRILL INTO THE CHUCK

- Make sure the drill is suitable for the material you are using, that it is sharp and the shank is in good condition.
- Tighten using the chuck key provided. Remove the chuck key.
- Make sure the drill is secure in the chuck, if it slips during drilling the shank will be damaged and you will not be able to centre it in the chuck next time its used.

### SETTING THE DEPTH STOP

- Set the drilling depth by moving the nut on the threaded part of the depth stop. The amount of travel is indicated on the scale on front of drill head.

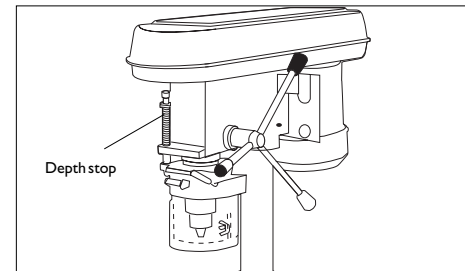

### SECURING THE WORKPIECE

- Always use clamps or a drill vice to secure the workpiece.
- The slots in the drill table are for attaching the clamps or a drill vice



Never hold the workpiece with your hand.

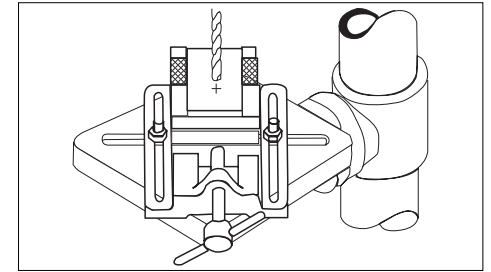

### ADJUSTING THE DRILL TABLE

The drill table can be adjusted for height and angle.

#### To adjust height

Loosen clamp lever and move table to desired height, tighten clamp lever to secure.

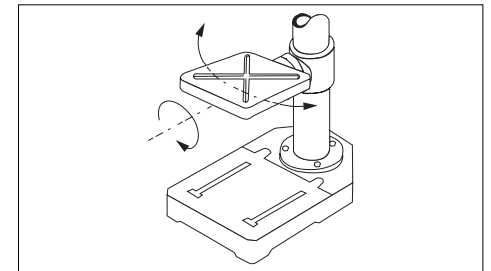

#### To adjust angle

- Loosen the hexagon headed nut (20) on the underside of table (19) with a suitable spanner.
- Rotate the table to the desired angle and tighten nut to secure.
- The angle is indicated on the scale on clamp collar.

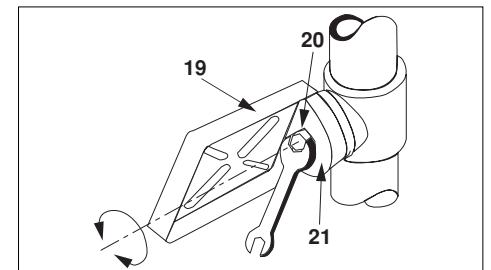

## OPERATING THE DRILL

- Plug into a suitable mains supply and switch on.
- Check that the chuck guard is in the down position.

### To switch the drill ON

Push the green button on the left hand side of the drill head in.

### To switch the drill OFF

Push the red button on the left hand side of drill head in.

**Note:** This is a no volt release switch and will not operate without the power connected.

## DURING USE

- Let the bit come to full speed before drilling the work piece.
- Use appropriate speed and feed rate for the drill bit/material being used.
- Do not force the drill. Press the drill head downwards with gentle pressure. Let the drill do the work.
- Clamp material properly. Do not use hand or foot to support the work piece. Use a suitable clamp or drill vice to secure the workpiece against the table.
- Be aware that this is a powerful drill. Unclamped or unsupported workpieces can kick causing injury.
- Do not hold workpieces with your hands while drilling them. Do not wear gloves while drilling; they can get caught in the bit resulting in injury.
- Never drill several workpieces at the same time.
- Use constant gentle pressure.
- If the bit seizes, switch off, unplug and rotate the bit anticlockwise to release. Never switch the drill on with the bit jammed.
- Do not use the drill without the guards in position.
- Remove swarf and chips from the table and clamps etc with a suitable brush (switch the drill off first). Do not use your hands.
- Regularly inspect the bit (switch the drill off first) during use for signs of damage or wear and sharpen/replace when required. Only use recommended drill bits suitable for the material and speed you are using.
- Use the right speed and feed rate.
- Follow the bit manufacturers recommendations, as a general rule use a slower speed and feed rate for larger diameter drills and higher speed and faster feed rate for smaller drills.
- Cutting oils. Use the drill bit manufacturers recommended cutting oil/lubricant when required. Do not use water.
- Ensure you remove the chuck key. After tightening the drill bit make it a habit to remove the key straight away.
- Switch the machine off before removing the plug from the mains socket.
- Be careful. Keep your hands away from the bit.
- Do not use the drill as a press.

## MAINTENANCE, CARE AND REPAIR

### CLEANING

Clean the drill with a soft brush or a wiper moistened with a suitable biodegradable solvent. Do not use inflammable liquids like petrol or alcohol, they are a fire risk and will damage the plastic parts.

### FAULTS

**Switch OFF immediately at the mains plug and remove the plug when:**

- The plug or cable is damaged.
- The switch on the machine is defective.
- You smell or see smoke caused by scorched insulation in the machine.

### The saw does not work when switched on

- Damaged plug/fuse.  
*Replace as required.*
- Defective switch.  
*Take to local dealer for repair.*

### Excessive Sparking

- Indicates dirt in the motor or worn brushes.  
*Take the drill to your Ferm dealer.*

### Overheating

- Clean the motor ventilation with brush or dry cloth.
- The drill is overloaded.  
*Apply less load. Use sharp drills.*
- The motor is defective.  
*Take to your Ferm Dealer.*

## MAINTAIN TOOLS WITH CARE

Keep tools sharp and clean for better and safer performance.

Follow instructions for changing accessories. Inspect tool and extension cables periodically and if damaged, have them repaired by a qualified person or authorised service body. Keep handles free from oil or grease. Keep the ventilation slots clean to prevent motor overheating.

### Check for damaged parts

Do not use a tool with damaged parts, before further use a damaged tool must be carefully checked by a qualified person to determine that it will operate properly. Check for alignment of moving parts, binding or breakage of parts, mounting and other conditions that may affect its operation.

A damaged part or guard should be properly repaired by an authorised service centre, unless indicated otherwise in the instruction manual. Have defective switches replaced by an authorised service centre. Do not use a tool if the switch does not turn on and off.

### Have your tool repaired by an expert

This appliance is manufactured in accordance with relevant safety standards. Only experts must carry out repairing of electrical appliances, otherwise considerable danger for the user may result.

### Storing tools

When not in use tools should be stored in the dry, out of reach of children.

## ELECTRICAL INFORMATION

This product is complete with a pre-wired mains plug. If the plug needs replacing follow these instructions.

### Wire correctly

The mains wires in this machine are coloured in the following way:

- BLUE** • Neutral (N)
- BROWN** • Live (L)
- EARTH** • Green/Yellow (E)

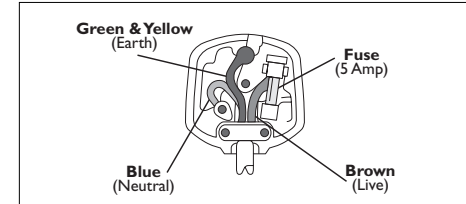

### Securing wires

Secure wires carefully and firmly to the correct terminals. Secure the mains cable in the plug cord grip firmly. Fit a 5-amp fuse. If a 13 amp (BS1363) plug is used a 5 amp fuse must be fitted.

### Recycle/Dispose of old plug and cable

Prevent inadvertent connection to socket and risk of electric shock. **If in doubt always consult a Qualified Electrician.**

## ENVIRONMENT

Recycle At the end of this products or its accessories life please recycle where facilities exist. Phone the Helpline for current advice on recycling.

### Helpline

**For any questions relating to operational or safety matters contact:**

Ferm Customer Helpline on: **0115 966 1199**  
Monday-Friday **8am – 6pm**  
Saturday **9am – 1pm**

## GUARANTEE

The guarantee conditions can be found on the separately enclosed guarantee card.

## CE DECLARATION OF CONFORMITY (UK)

We declare under our sole responsibility that this product is in conformity with the following standards or standardized documents

**EN61029-1, EN55014-1, EN55014-2**  
**EN61000-3-2, EN61000-3-3**  
in accordance with the regulations.

**98/37/EEC**  
**73/23/EEC**  
**89/336/EEC**

from 03-02-2000  
**GENEMUIDEN NL**  
W. Kamphof  
Quality department