

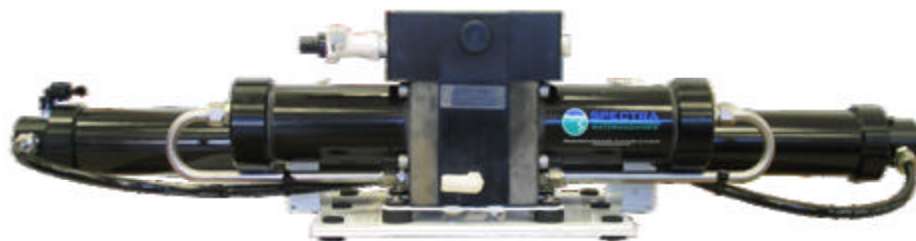

SPECTRA
WATERMACHINES™

**LAND BASED 800
INSTALLATION MANUAL
&
OWNER'S MANUAL**



Spectra Watermakers, Inc.
20 Mariposa Road, San Rafael, CA 94901
Phone 415-526-2780 Fax 415-526-2787
E-mail: spectra@spectrawatermakers.com
www.spectrawatermakers.com

April-18-06

Introduction to the LB 800

Pressure Gauge and Product Flow Meter



The Spectra Intensifier known as the Clark Pump was introduced in 1997 and has continually improved since. It is built of modern non corrosive composites.

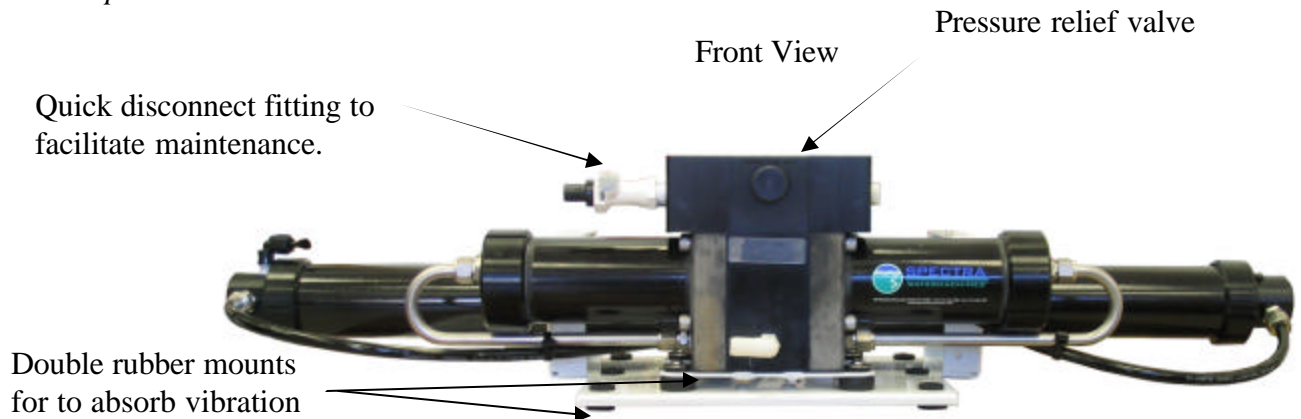

Filter Module



Optional Flush & Service module

Getting Started

Unpack the system and inspect it to make sure that it has not been damaged in shipment.

Refer to the shipping list for your system to make sure you have received all of the components listed. Do not discard any packaging until you have found and identified all of the parts. The small installation parts are listed on the kit list.

Warning! We will not be held responsible for shortages and or freight damage that are not reported within thirty days of the ship date.

Study the system layout diagram, component photos and descriptions before beginning your installation. This will assist you in understanding the function of each component.

Layout the system. Before starting the installation identify the location where each module and component will be placed. Insure that there is proper clearance around the components for removal of filters and system service. Also check to make sure you have adequate tubing and hose before starting so additional parts may be ordered.

Shipping List

- ? (2) High Pressure Clark Pump and a 40" Reverse Osmosis Membrane Modules.
- ? Accumulator Tank
- ? Monitor Gauge panel
- ? Installation Fittings Kit
- ? Hand held Salinity monitor
- ? 5/8"(14.75mm) Hose 25 Feet
- ? (2) 3/4" (19.05mm) Hose 10 Feet
- ? 1/4 product tubing (50')
- ? Feed Water flow meter
- ? DF-1 prefilter assembly
- ? Product sampling 3-way valve
- ? (2) Brine Service Hose
- ? Optional Flush/Service Module
- ? Product Water Manifold



Plumbing Layout

Plastic fittings should have 3-4 wraps of Teflon tape and will thread almost all the way in. Leave the first pipe thread uncoated. Avoid getting dirt or debris in the system during assembly. Avoid tight bends and elbows. Secure piping away from moving objects and protect from chafe.

Brine Discharge to Adjacent well or drain

Fresh water flush inlet to charcoal filter. Plumb to fresh water system.

Accumulator, Factory pre-charged. Install in any position and plumb as shown.

20 & 5 micron filters. Do not mount over electrical equipment. Leave clearance below for filter change.

Optional Service/flush Module
Wire pump power terminal strip to specified power source.
12 Volt DC pump uses 10 Amps
24 Volt DC pump uses 5 Amps
AC Pumps use 1 amp

Pressure Gauge

Feed Water Inlet from Customer supplied pump. 3GPM, 100PSI

Feed Flow Meter

Product Water and Pressure Gauge Tube Installation

Sampling Tap for testing the product water or for service procedures. Put enough tube on this port to reach your service (pickling) container.

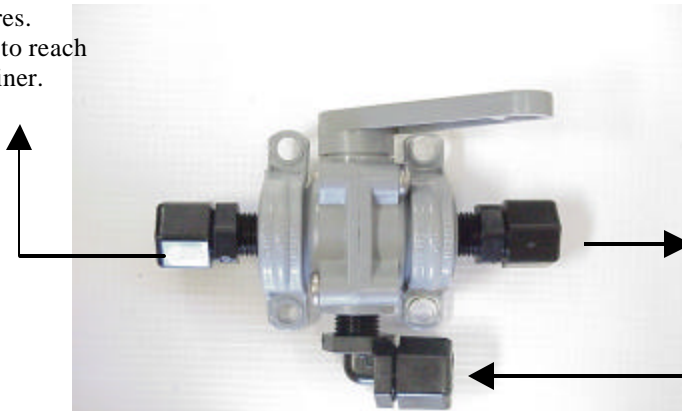

Product to tank.

Route the product water from the valve into the top of the tank. Install a tee in the water fill or tap a pipe thread into an inspection port.

DO NOT! feed into a vent line, manifold or the bottom of the tank. Make sure that there is no restriction in this piping.

Product sampling valve . Mount using the supplied plastic straps as shown.

Note: the handle is pointing in the direction of the flow.

Plastic fittings should have 3-4 wraps of Teflon tape and will thread almost all the way in. Leave the first pipe thread uncoated. Avoid getting dirt or debris in the system during assembly. Secure piping away from moving objects and protect from chafe. Exercise care not to cross thread the fittings. See the tube assembly instructions next page.

Product Flow meter

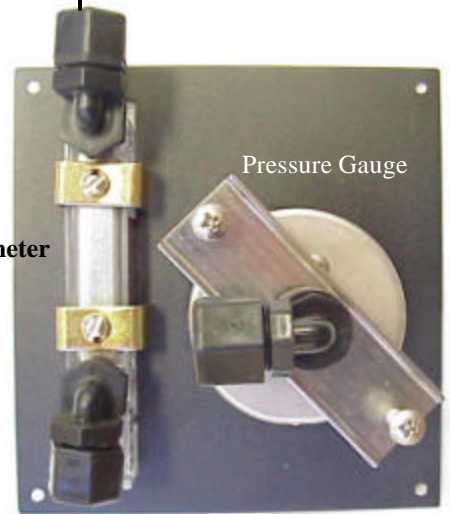

Back view of instrument panel.

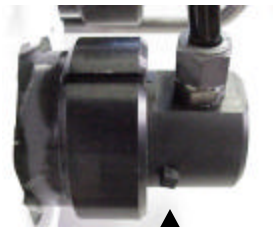

Product Ports are located here

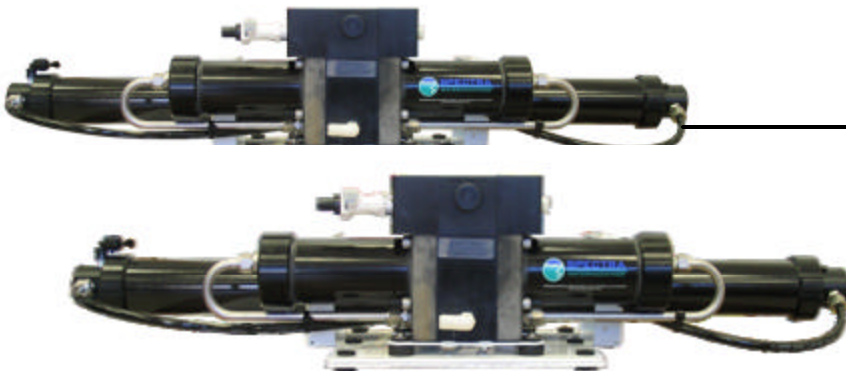

Product fitting



Product Water Manifold

Remove one of the product port plugs (from either end) on both membranes and thread in the product fitting with Teflon tape sealant.

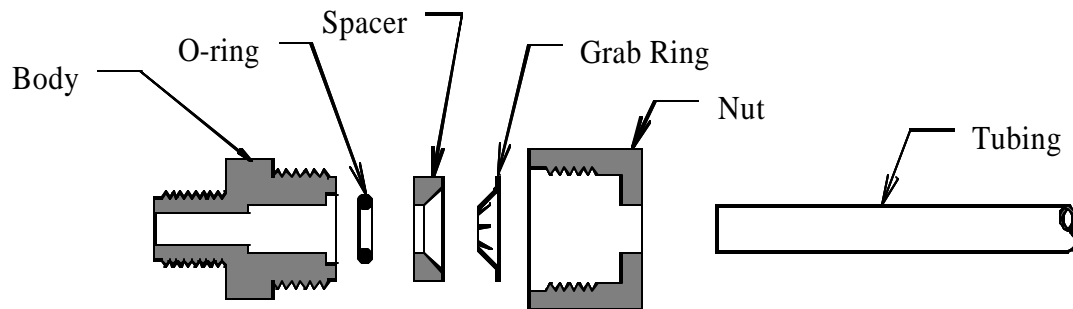

Step 1: Disassemble fitting components

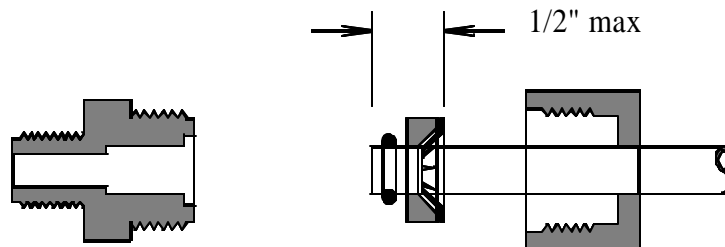

Step 2: Install the Nut first then use the bevelled side of the Spacer to push the Grab Ring onto the tube no more than 1/2". Slip the O-ring over the tube to hold the Spacer in place. If the Grab Ring is pushed too far, trim back the tube so about 1/4" of tube extends past the O-ring.

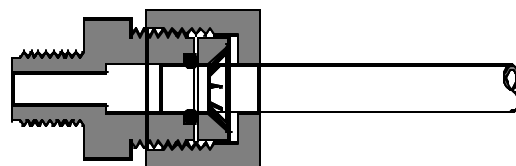

Step 3: Gently fit the tube into the body and loosely thread on the nut.

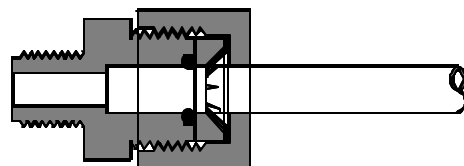

Step 4: Push the tube into the body until it bottoms out then hand tighten the nut.
DO NOT OVER TIGHTEN!

1/4" Tube Fitting Assembly

New System Start-Up and Testing

Warning! Damage may occur if the purge sequence is bypassed and the membrane is pressurized with storage chemical in it.

1. First Check That:

- ?? The feed water pump is ready and primed
- ?? All of your hose connections are tight.
- ?? The pressure relief valve is open 1/2 turn.
- ?? The sampling valve is set to the sample position.

Remove Tag and Washer!



Open 1/2 Turn to Purge Chemicals!

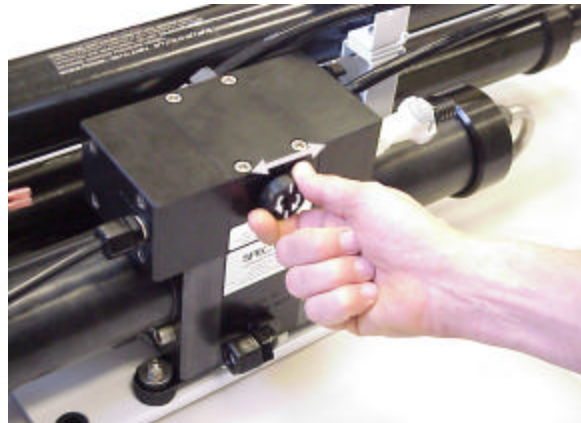

2. Disconnect the feed water hose at the prefilters or Clark Pump Inlet. Start the feed pump and regulate the feed flow to 6.3 GPM (22.5LPH). Reconnect the hoses.

3. Start the feed pump and run the system without pressure for 20 minutes to purge the storage chemicals. The system should have an open flow pressure on the gauge of about 30 PSI (2 Bar)

4. Close the pressure relief valve. The pressure should rise to 100 PSI (7 Bar) and after several minutes start making water. If the feed water is brackish or fresh the pressure will be lower. Regulate the feed flow to 6 GPM.

5. Allow the system to run for 5-10 minutes and then test the product with your hand held salinity tester. If the product is below 750 PPM it is considered potable and may be diverted to the tank.

6. If the system is equipped with a customer supplied fresh water flush Charcoal filter and valve, the **flush water flow rate must be regulated to 1.5GPM or less**. Ensure that this is the case by timing the flow rate of brine out of the system. Close the service valve, open the flush valve, and collect the brine in a graduated container to time the flow.

System Operation

Normal operation

If the system has been pickled or stored use the New system startup procedure.

1. Check to see that the feed water regulator valve is open to its correct position.
2. Turn the product valve to the "Sample" position.
3. Start the feed pump and check for flow. After five minutes check the product water with your hand held salinity tester. If it is good you may divert it into your tank.
4. Run the system until you have filled your tank or have made enough to meet your requirements for several days.
5. Stop the feed pump.
6. Open the fresh water flush valve and start the flush pump.
7. Flush for 2 1/2 minutes or until fresh water begins to appear at the brine discharge.
8. Return flush valve to its run position.

You may now leave the system unattended for up to five days without further attention. We recommend operating the system for longer periods and effecting a FW flush than running the machine every day and not flushing the system.

NOTE: Flush water must be chlorine free! Use only product water or water filtered through an activated charcoal filter at the manufacturer's specified flow rate.

Long Term Storage Procedures

Watermakers are best run continuously. When not in use, biological growth in the membrane is the leading cause of membrane fouling. A warm environment will cause more growth than a cold environment. The fresh water flush system will greatly reduce biological growth but may not stop it completely in certain conditions. If an optional “Zeta Guard” or Z-Brane water treatment system is installed in the system, then three to five day flushing intervals will maintain the system as long as fresh water is provided and the charcoal filter maintained.

System Storage or “Pickling”

If the system is to be left unused for more than five days, perform the following storage procedure. The procedure introduces a chemical compound into the system that prevents biological growth. This procedure requires de-chlorinated water which can be made with the Spectra’s charcoal filter. **Charcoal filters last a maximum of 6 months once wetted.**

Spectra SC-1 a special storage compound used by the US Navy. It is formulated to be compatible with the modern engineering plastics and composites in the Spectra pumps. Do not use any substitute except propylene Glycol. If you wish to use glycol for storage-follow the winterizing instructions. SC-1 Storage Compound has to be mixed at a ratio of 1 Spectra container to 3 gallons (12L) of fresh water to have the proper solution for short term storage (under two months use 1/2 of a container)

Caution! Avoid contact with skin, eyes, or lungs with the storage chemical.



Storage Procedure

1. Perform a fresh water flush as described in the normal operation section.
2. Connect the Intake Service Hose to the Service connection on the Service/Flush Module and set the valve to “Service”. Place the Hose in a clean bucket containing 1 gallon of chlorine free water.
3. Disconnect the brine discharge hose and connect the brine service hose to the Clark Pump Brine discharge fitting. Run the hose to the bucket.
4. Mix 1 container of SC-1 storage compound with the water in the bucket.
5. **Make sure the pressure relief valve on the Clark pump is Open (unpressurized) by turning 1/2 turn counterclockwise**

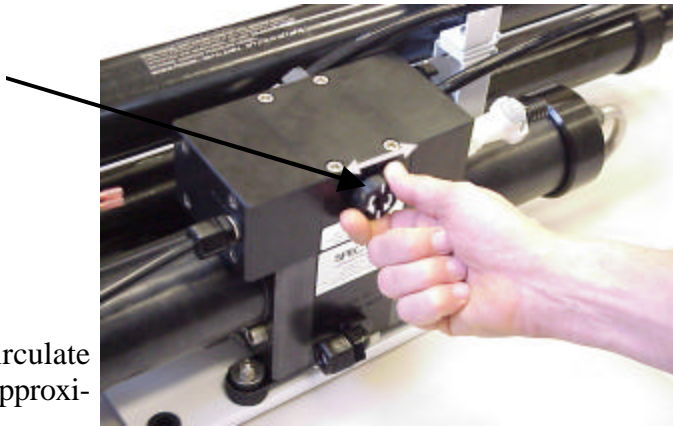

6. Turn on the service/flush pump. Circulate the storage chemical in the system for approximately 10 minutes.

Clean Up:

Remove the quick disconnect from the Clark pump brine discharge, and replace the original hose. Remove the prefilters, drain the filter housings, and replace the prefilters with clean dry ones.

Turn the service valve 180° back to its original position, restore the system to its operating configuration.

Note: If the system is not equipped with a Service/Flush Module use a portable pump rated at 3GPM or less and at least 40 psi. Use Chlorine free water. Disconnect the feed hose at the flow meter and connect the portable pump discharge hose to the meter.

Winterizing Storage Procedure

1. Perform a fresh water flush as described in the normal operation section.

Connect the Intake Service Hose to the Service connection on the Service/Flush Module and set the valve to “Service”. Place the Hose in a clean bucket containing 1 gallon of chlorine free water.

3. Disconnect the brine discharge hose and connect the brine service hose to the Clark Pump Brine discharge fitting. Run the hose to the bucket.

4. Pour 2 gallons of Propylene Glycol Potable water antifreeze into the bucket.

5. Make sure the pressure relief valve on the Clark pump is Open (unpressurized) by turning 1/2 turn counterclockwise

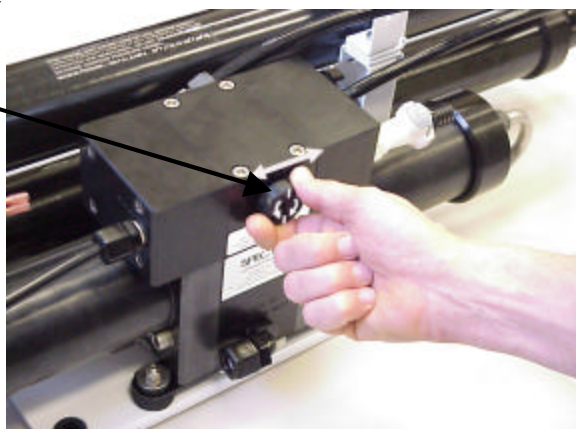

6. Turn on the service/flush pump. Circulate the antifreeze in the system for approximately 10 minutes.

Clean Up:

Remove the quick disconnect from the Clark pump brine discharge, and replace the original hose. Remove the prefilters, drain the filter housings, and replace the prefilters with clean dry ones.

Turn the service valve 180° back to its original position, restore the system to its operating configuration.

The product water system will not be protected and should be drained or blown out with compressed air.

Note: If the system is not equipped with a Service/Flush Module use a portable pump rated at 3GPM or less and at least 40 psi. Use Chlorine free water. Disconnect the feed hose at the flow meter and connect the portable pump discharge hose to the meter.

Maintenance

General

Periodically inspect the entire system for leakage and chafe on the tubing and hoses. Repair any leaks you find as soon as practical. Some crystal formation around the Clark pump blocks is normal. Wipe down any salt encrusted areas with a damp cloth. Do not tolerate leaks or corrosion, as they will damage the watermaker.

The Prefilter

- ?? Service the prefilter on a regular basis. The pressure will rise on the remote gauge when the filter becomes dirty. Extremely dirty filters will harm system performance and may cause the feed pump to cycle on the high pressure switch.
- ?? To service the filters shut off the service valve open the housing, discard the old filter, Clean out the housing bowl, reassemble the housing with new 5 micron filter element. Leave dry until next startup.
- ?? Use only Spectra approved filters or you may void your warranty. The filters may be cleaned several times with a soft brush and water in a bucket. Occasionally, lightly lube the filter housing O-ring with silicone grease.

The Charcoal Fresh Water Flush Filter

- ?? Replace the charcoal filter element at least every 6 months! This filter protects the membrane by removing chlorine from the fresh flush water. Use only a Spectra replacement!

The Clark Pump

Clark pump requires no routine maintenance except inspection for leaks. Tighten any hose clamps or fittings that show signs of leakage. The High Pressure fittings threaded into the Clark pump are o-ring seals with a straight thread. These should never leak and should never be over tightened. If one of the tube nuts starts to leak it can be un-threaded, sealed with a bit of silicone grease or silicone seal and with two wrenches, tightened very tight!

The Membranes

- ?? The membranes need to be cleaned only when they have lost up to 15% of their capacity due to fouling or the product quality degrades. The leading cause of fouling is from biological growth that occurs when the system is left unused without flushing or pickling. Fouling from mineral scaling can happen during operation under certain sea water conditions, and from rust. Monitor the product salinity and feed pressure for higher than normal readings for the conditions. Other conditions can cause high pressure such as cold feed water or clogged filters. Low product flow is usually due to low voltage, damaged feed pump or Clark pump. Look for all other causes before cleaning the membrane. Membrane life can be shortened by excessive cleaning.
- ?? There are two types of cleaners: acid and alkaline. The acid cleaner (SC-3) will remove mineral scaling. The alkaline cleaner (SC-2) is used to remove biological by-products, oil, and dirt particles that get past the prefilters. If membrane performance is reduced and they have not been pickled recently, cleaning with both chemicals is recommended. The acid cleaner should be used first. If the membrane fails to respond to both cleanings, this is an indication of another problem with the system, or that it is time to replace the membrane. Contact Spectra Watermakers before removing a membrane.

Membrane Cleaning

For normal cleaning, the SC-3 Acid Cleaning Compound is used first, then the SC-2 Alkaline Cleaning Compound. If known bio-fouling is present, the SC-2 may be used first. Using hot water if possible, up to 120° (45C) is recommended as it greatly enhances the ability of the cleaners to do their jobs.

If the history of the system is unknown or has been left “unpickled” for an extended length of time and biological growth is present, it is recommended that the system is cleaned with SC-2, using an alternate source of unchlorinated fresh water before the system is run under pressure. A simple test can be performed to see if biological growth has occurred. Before running the system, remove the prefilters and examine their condition. If the housings are full of smelly discolored water, the system was not properly stored. Install clean prefilters if they were bad. Next check the membrane. Detach the brine discharge hose and lead to a bucket. Open the pressure relief valve one turn, and manually run the system for 30 seconds. Examine the brine water: if it's discolored and smells bad, perform an SC-2 cleaning with an alternate source of unchlorinated water before running the system pressurized. If the brine is fairly clean, the system can be purged, run normally, and checked for performance. Clean the membranes only if performance is reduced.

Heating the water is preferable. One way to do this is to find a camp stove and use a large stainless steel pot to heat the solution in. The cleaning solution throughout the system will heat as it circulates in and out of the pot. An alternative is to heat the one or two gallons of initial water to 120° on the main stove before mixing in the cleaner and circulating it into the system. Periodically stop and reheat the solution.

Perform the cleaning procedures while the ship is in acceptable sea water for purging and testing.

Note: Procedures are the same for the SC-2 and SC-3 cleaners

A Spectra Cleaning Compound (SC-2 or SC-3) must be mixed with fresh water at a ratio of 1 container of compound to 3 gallons (12L) of unchlorinated water to have the proper solution. An average of two gallons (8L) of water is already present inside a 150 system. This water has to be figured into the mixture. A 150 system will use 1 container of compound,

Note: If the system is not equipped with a Service/Flush Module use a portable pump rated at 3GPM or less and at least 40 psi. Use Chlorine free water. Disconnect the feed hose at the flow meter and connect the portable pump discharge hose to the meter.

1. Perform a fresh water flush as described in the normal operation section.
2. Connect the Intake Service Hose to the Service connection on the Service/Flush Module and set the valve to "Service". Place the Hose in a clean bucket containing 1 gallon of chlorine free water.
3. Disconnect the brine discharge hose and connect the brine service hose to the Clark Pump Brine discharge fitting. Run the hose to the bucket.
4. Mix 1 container of SC-2 or SC-3 cleaning compound with the water in the bucket.

5. Make sure the pressure relief valve on the Clark pump is Open (unpressurized) by turning 1/2 turn counterclockwise

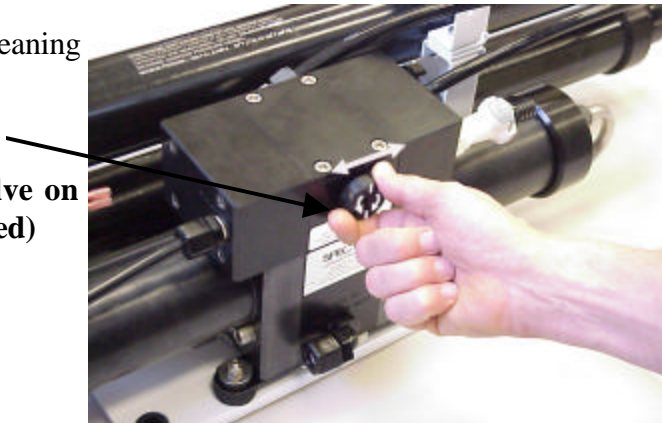

6. Turn on the flush module pump. Circulate the cleaning chemical in the system for approximately 20 minutes. Allow the chemical to stand in the system for about 2 hours, circulating it occasionally. The solutions act more rapidly if kept warm.

Clean Up:

Remove the quick disconnect from the Clark pump brine discharge, and replace the original hose. Remove the prefilters, drain the filter housings, and replace the prefilters with clean dry ones.

Turn the service valve 180° back to its original position, restore the system to its operating configuration.

Follow the New System Startup Procedures to purge the chemicals from the system.

Suggested Spares

| | Part Number |
|--|--------------|
| Spectra Watermakers parts list: | |
| SC-1 STORAGE CHEMICAL..... | KIT-CHEM-SC1 |
| SC-2 CLEANER..... | KIT-CHEM-SC2 |
| SC-3 CLEANER..... | KIT-CHEM-SC3 |
| BASIC CRUISE B | KIT-BCK-B |
| 5 MIC FILTER..... | FT-FTC-5 |
| CHARCOAL FILTER..... | FT-FTC-CC |
| 20 MICRON FILTER..... | FT-FTC-20 |
| FILTER HOUSING O-RING..... | SO-FHS-10H |
| OFF SHORE KIT..... | KIT-OFFSH |

Part Numbers

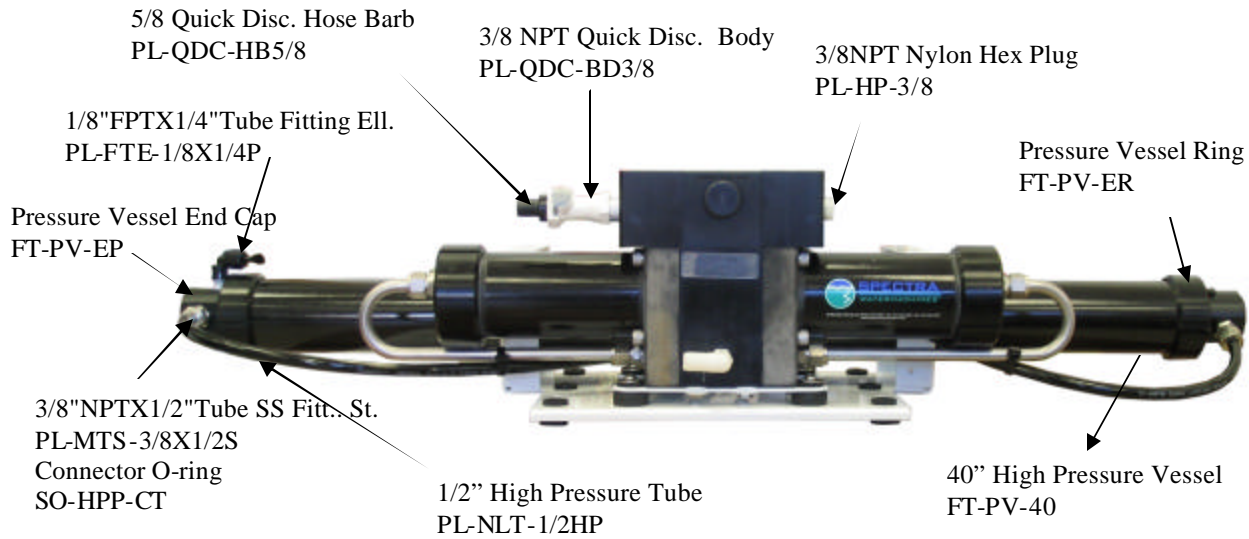

DUAL HIGH-PRESSURE FILTER HOUSING

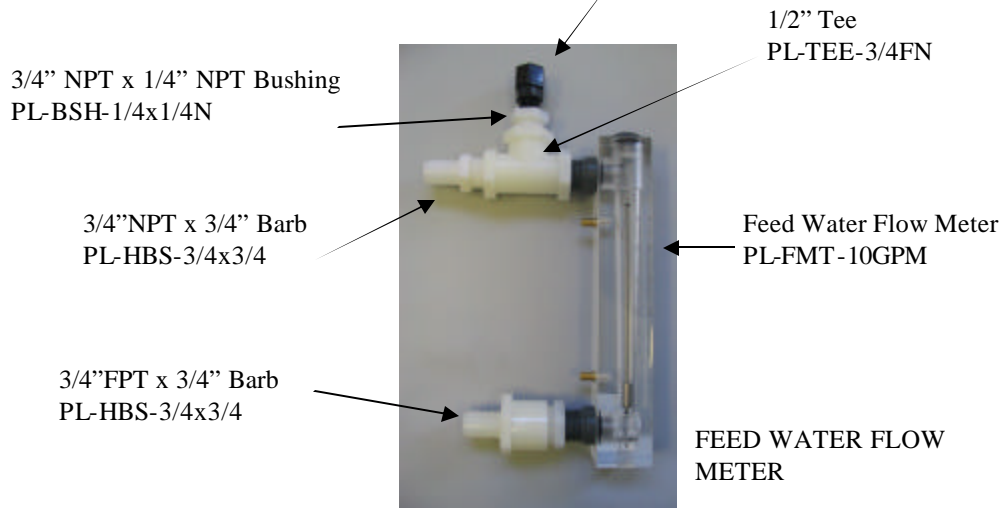
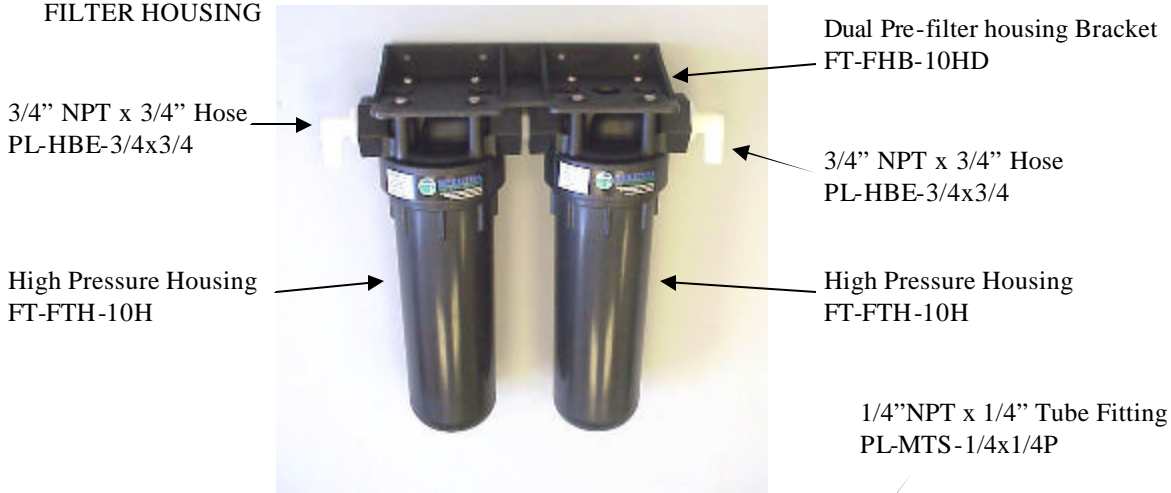

Part Numbers

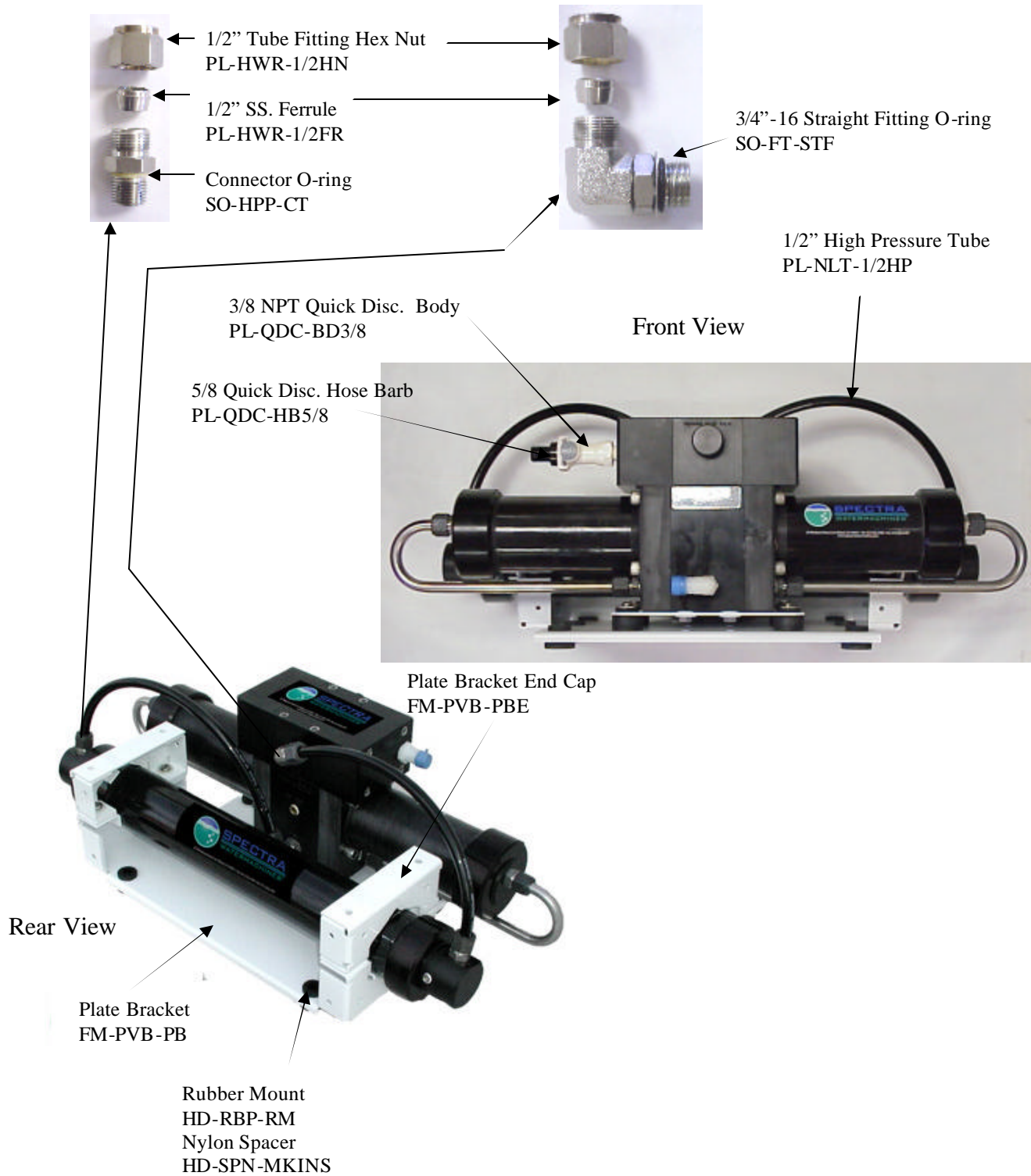

Part Numbers

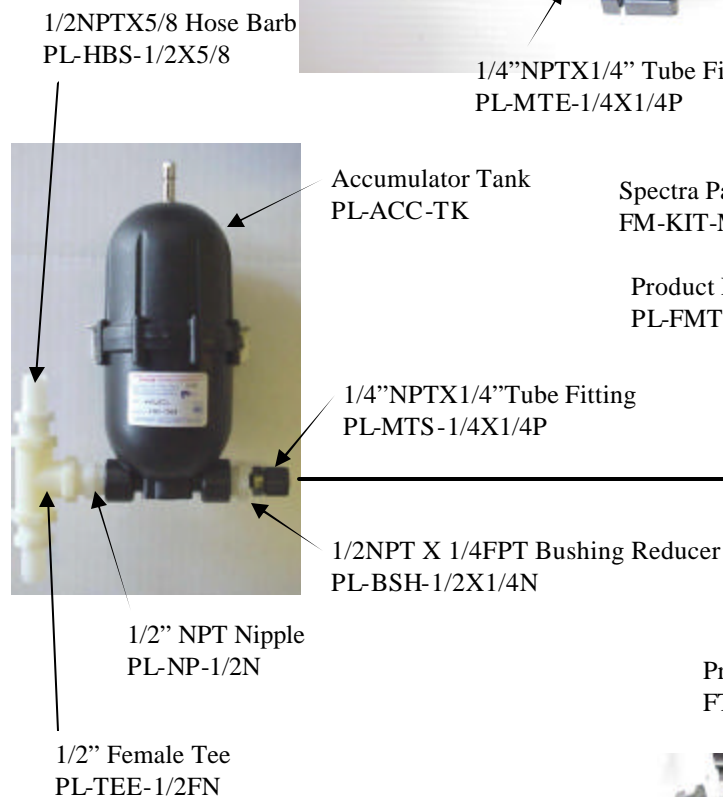
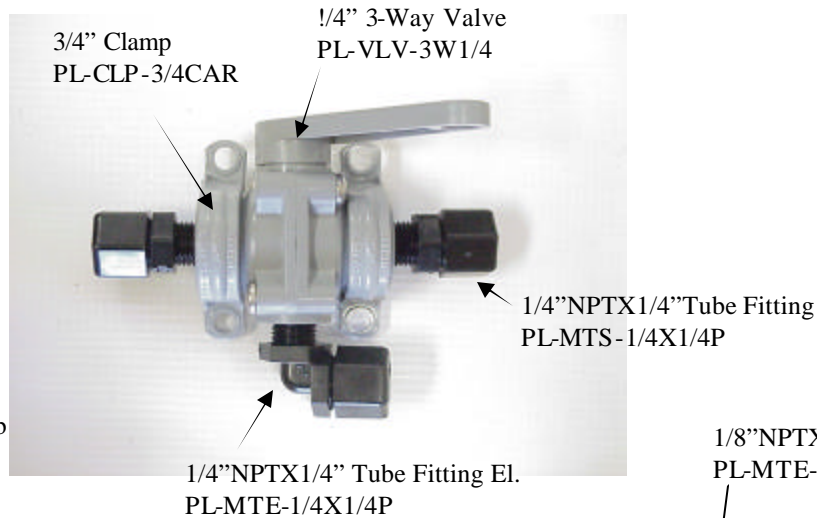

Spectra Panel
FM-KIT-MP

Product Flow Meter
PL-FMT-60GPHDS

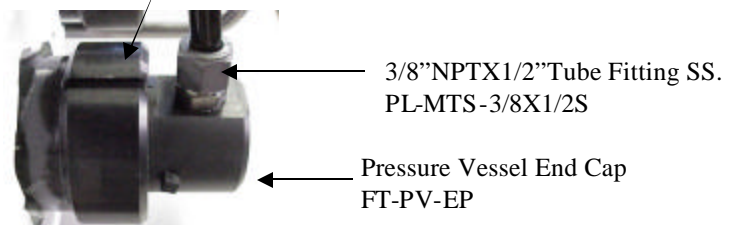
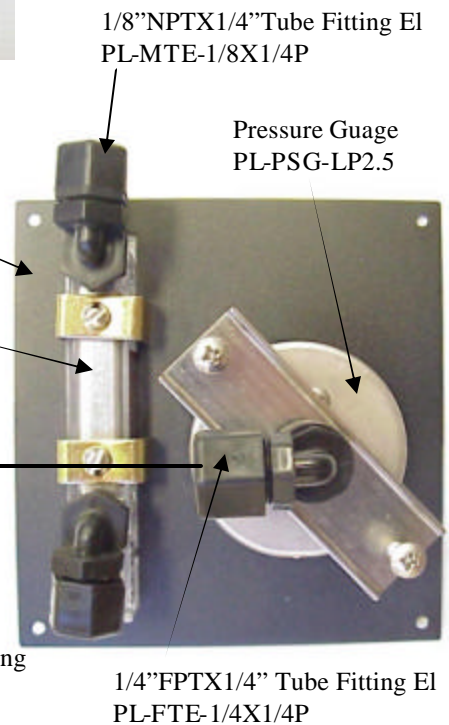

Product Manifold
PL-MNF-PD

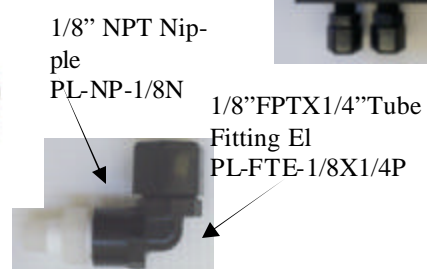
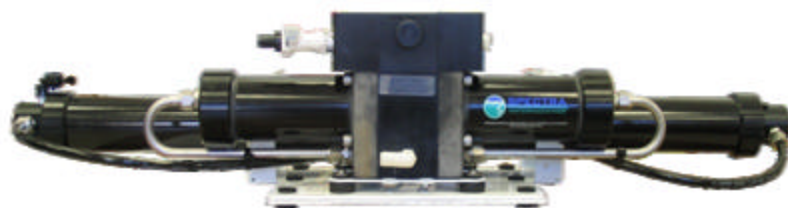

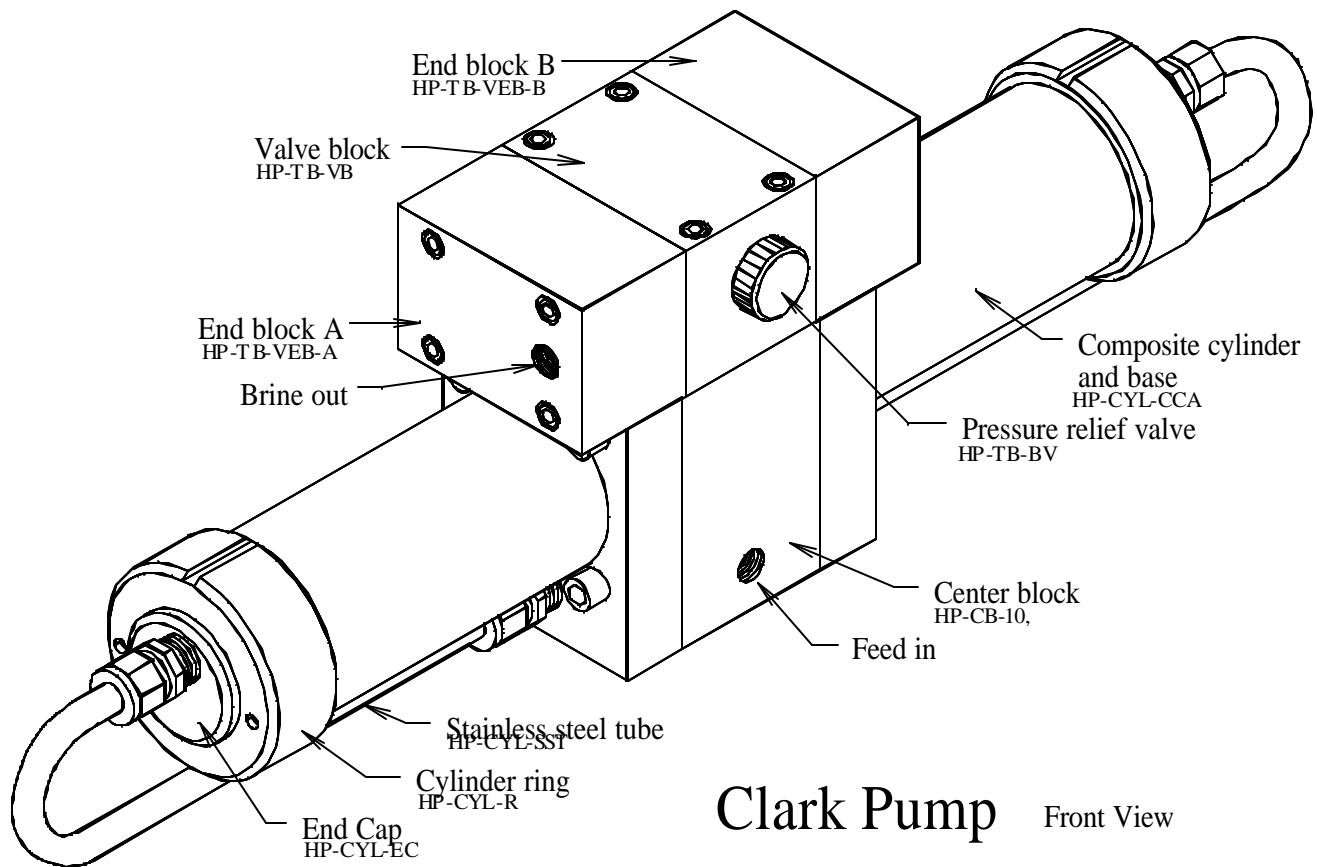

Clark Pump Front View

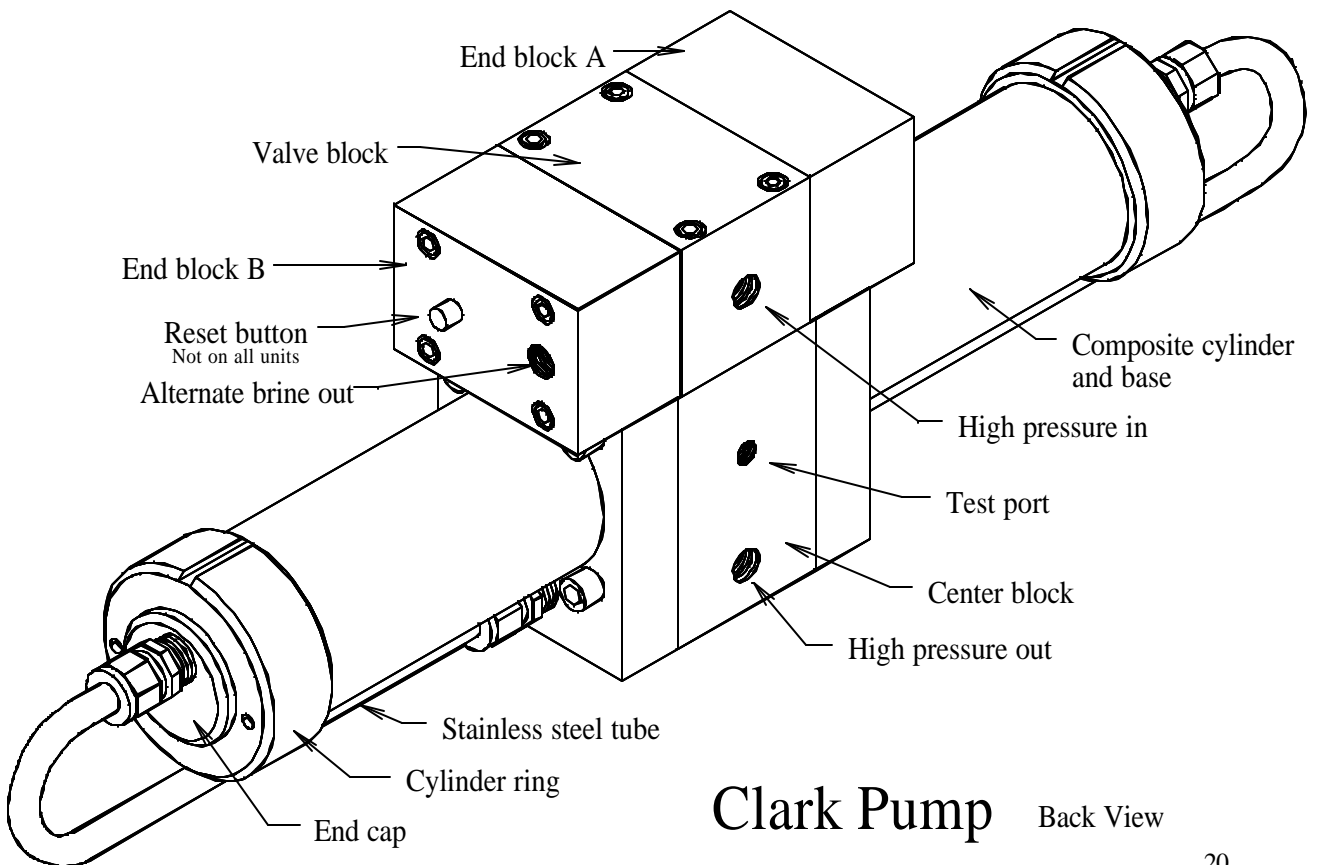

Clark Pump Back View

Spool Assembly Exploded View

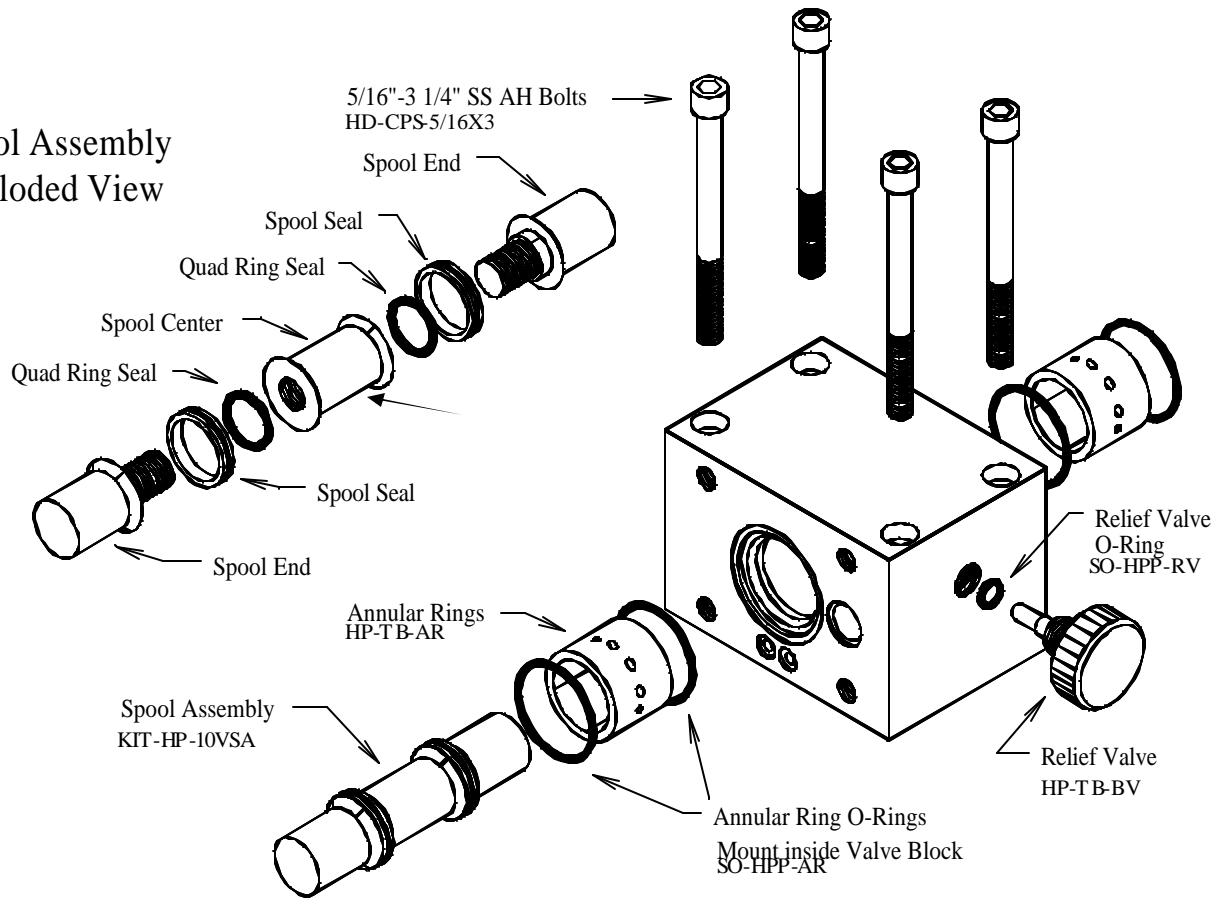

Valve Block

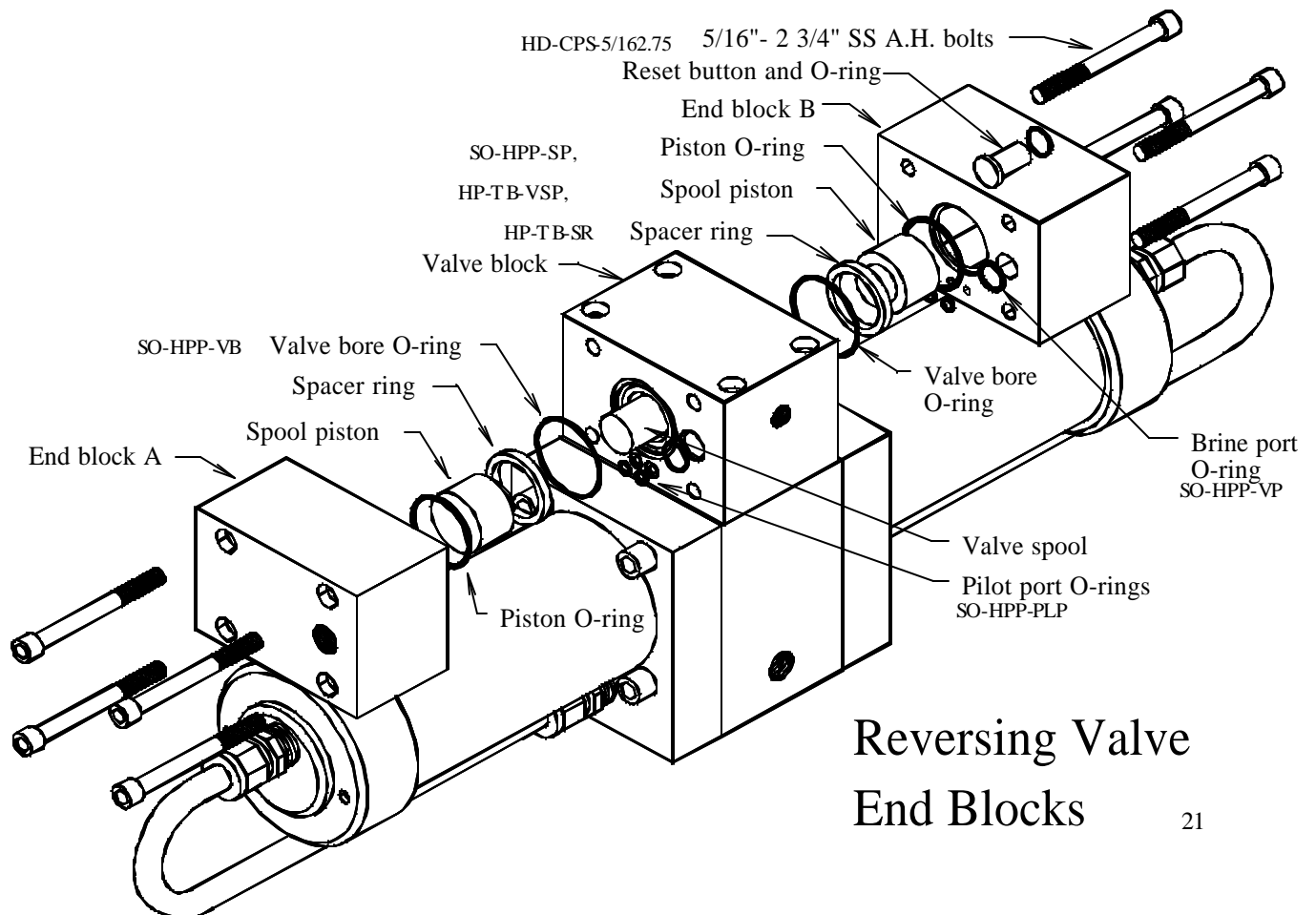

Reversing Valve End Blocks

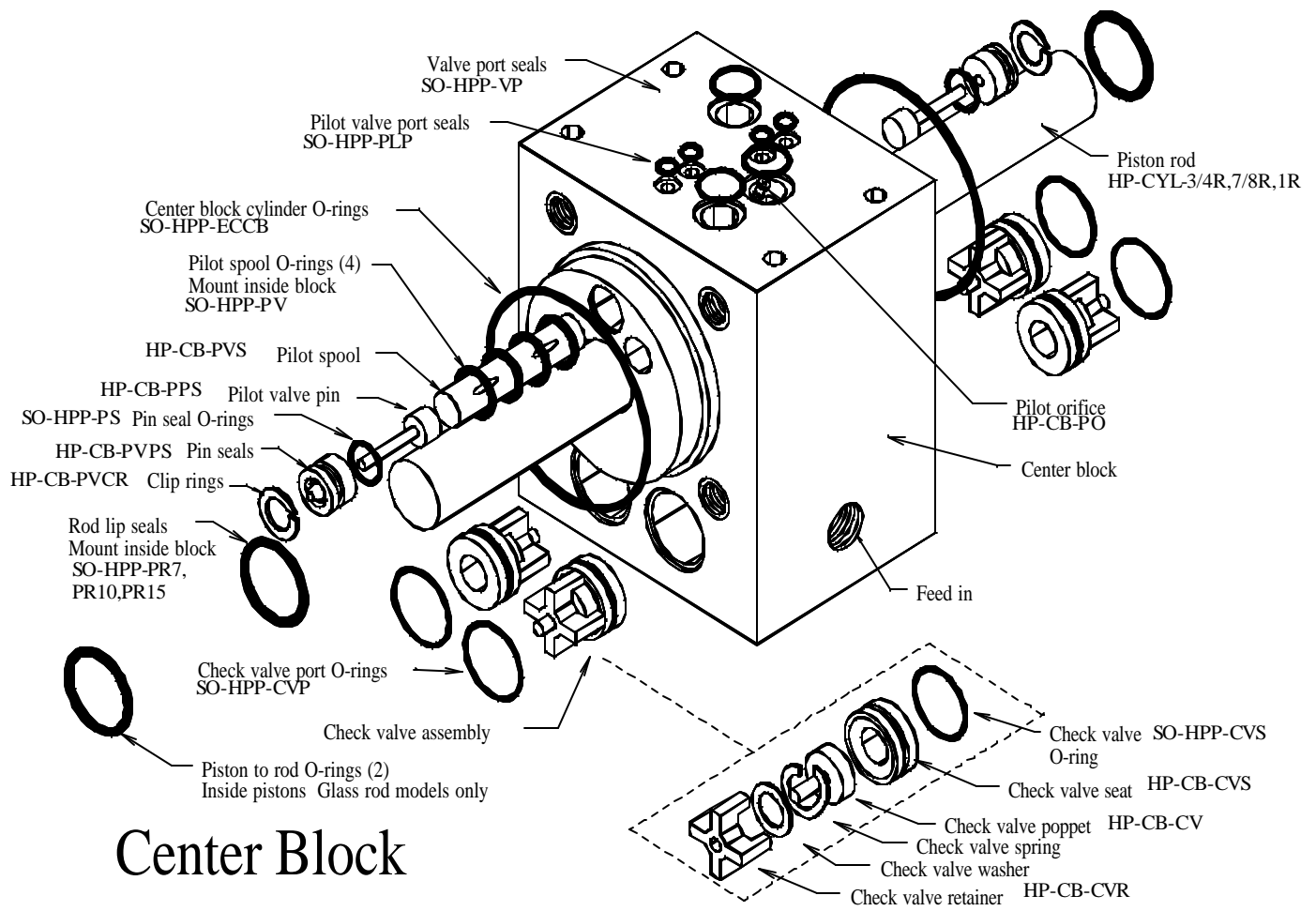

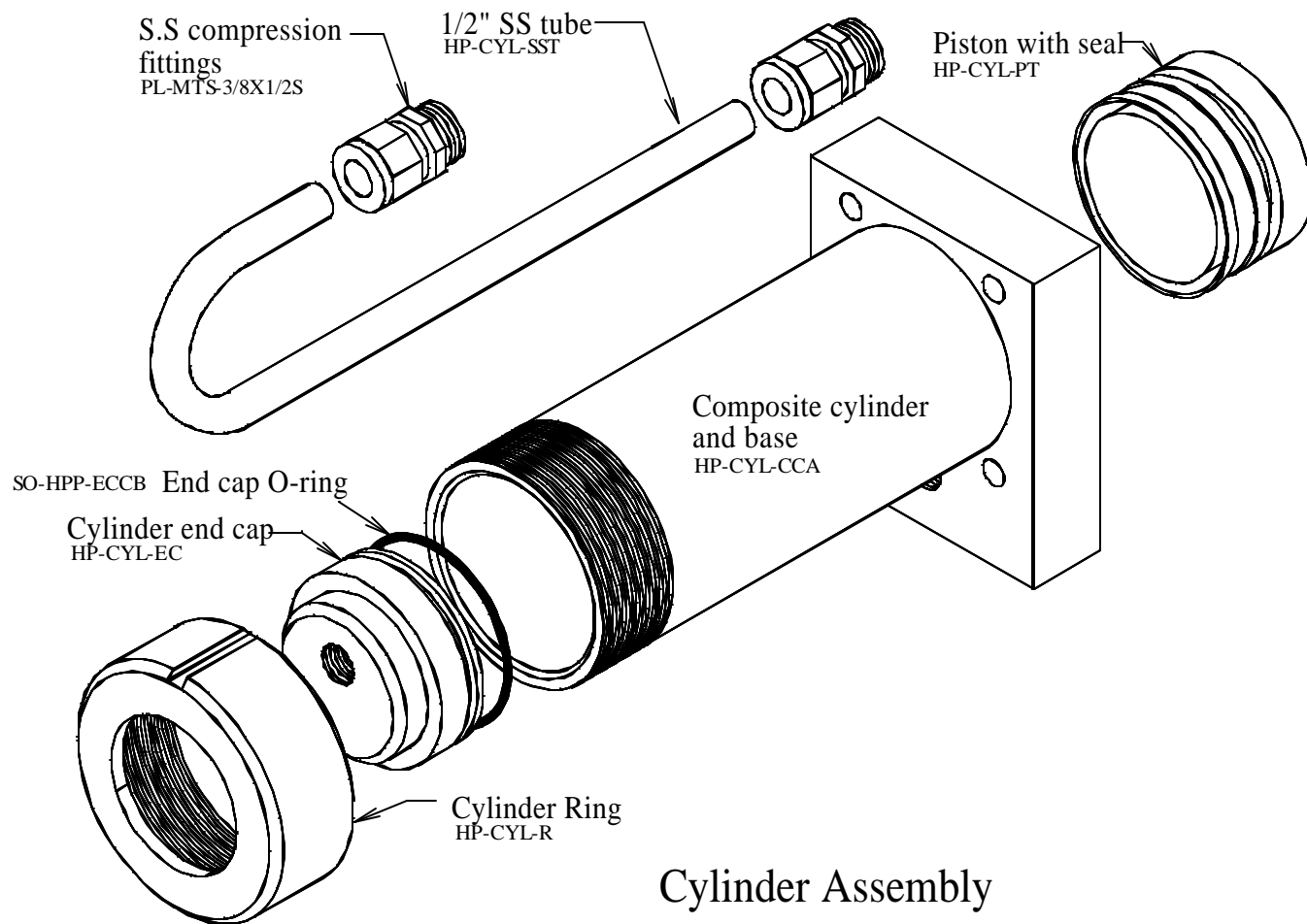

Cylinder Assembly