

Invacare® **XTERRA GT**

***Power Chair
User Manual***

CE





ISO 7176-15: 1996 Requirements for Information Disclosure,

Documentation and Labelling

Manufacturer: Invacare Limited

Address: South Road, Bridgend Industrial Estate, Bridgend. CF31 3PY

Model Designation: XTERRA GT Mid wheel drive power chair

Maximum Occupant Mass (Weight): 114kg (250lbs)

ISO Test Method	Requirement	Min.	Max.	ISO Test Method	Requirement	Min.	Max.
ISO 7176 Pt 5	Overall Length with Legrest	1065mm	1065mm	ISO 7176 Pt 7	Seat Plane Angle	5deg	5deg
ISO 7176 Pt 5	Overall Width	657mm	657mm	ISO 7176 Pt 7	Effective Seat Depth	500mm	500mm
ISO 7176 Pt 5	Folded Length	N/A	N/A	ISO 7176 Pt 7	Effective Seat Width	515mm	515mm
ISO 7176 Pt 5	Folded Width	N/A	N/A	ISO 7176 Pt 7	Seat Surface Height at Front Edge	523mm	523mm
ISO 7176 Pt 5	Folded Height	N/A	N/A	ISO 7176 Pt 7	Backrest Angle	12deg	12deg
ISO 7176 Pt 5	Total Mass (Weight)	118.5kg	118.5kg	ISO 7176 Pt 7	Backrest Height	335mm	335mm
C.E.N.	Mass (Weight) of the Heaviest Part	114.5kg	114.5kg	ISO 7176 Pt 7	Footrest to Seat Distance	436mm	436mm
ISO 7176 Pt 1	Static Stability Downhill	25deg	28deg	ISO 7176 Pt 7	Leg to Seat Surface Angle	85deg	85deg
ISO 7176 Pt 1	Static Stability Sideways	27deg	29deg	ISO 7176 Pt 7	Armrest to Seat Distance	190mm	190mm
ISO 7176 Pt 4	Energy Consumption (Range)	22.8km	22.8km	ISO 7176 Pt 7	Front Location of Armrest Structure (Front Armrest to Backrest)	365mm	365mm
ISO 7176 Pt 2	Dynamic Stability Uphill	3	3	ISO 7176 Pt 7	Handrim Diameter	N/A	N/A
ISO 7176 Pt 10	Obstacle Climbing	40mm	80mm	ISO 7176 Pt 7	Horizontal Location of Axle	120mm	120mm
ISO 7176 Pt 6	Maximum Speed Forward	11.8km	11.8km	ISO 7176 Pt 5	Minimum Turning Radius	577mm	577mm
ISO 7176 Pt 3	Minimum Braking Distance from Maximum Speed	2260mm	2260mm	ISO 7176 Pt 5	Turn Around Width Between Limiting Walls	1250mm	1250mm

The Wheelchair conforms to the following standards:

ISO 7176 Pt 8	Static, Impact and Fatigue Strength	PASS
ISO 7176 Pt 9	Climatic Tests	PASS
ISO 7176 Pt 15	power and Controls	PASS
ISO 7176 Pt 16	Resistance to Ignition	PASS

Warranty Terms & Conditions

Standard INVACARE terms

This is to certify that your XTERRA GT power chair is warranted by INVACARE Ltd., for a period of 1 year.

1. Only INVACARE chairs purchased at full price are warranted against defective workmanship and materials.
2. If a defect or fault is discovered the INVACARE dealer from whom the appliance was obtained should be notified immediately.
3. The manufacturer will not accept responsibility for damage caused by misuse or non-observance of the instructions set out in the users manual.
4. During the period of the Warranty, any parts that have become defective due to faulty workmanship or materials, will be renewed or repaired without charge by the INVACARE dealer.
5. The Warranty will be forfeited should any unauthorised alteration be made to the equipment.
6. The Purchaser's statutory rights under the Consumer Protection Act are not affected.

Limitation of liability

This Warranty does not extend to the consequential costs resulting from fault clearance, in particular freight and travel costs, loss of earnings, expenses etc.

- natural wear and tear
- inappropriate or incorrect use
- defective assembly or setting-up by the purchaser or third parties
- defective or neglectful treatment
- use of unsuitable spares

Contacting Invacare

For questions or support, please contact your authorised INVACARE Dealer. He has the necessary know-how and equipment plus the special knowledge concerning your wheelchair which enables him to offer you all-round satisfactory service.

Should you wish to contact us directly, we are at your service under the following addresses and phone numbers.

United Kingdom

INVACARE Ltd.

South Road Bridgend Mid Glamorgan - CF31-3PY

Tel (Customer Service): 01656 - 647 327 Fax (Customer Service): 01656 - 649 016

France

INVACARE POIRIER S.A.

Les Roches F-37230 Fondettes

Tel (Service Après-Vente): 02 47 - 62 64 15 Fax (Service Après-Vente): 02 47 - 62 64 64

Deutschland

INVACARE Deutschland GmbH

Dehmer Str. 66 D-32549 Bad Oeynhausen

Tel (Kundendienst): 05731 - 754 210 Fax (Kundendienst): 05731 - 754 216

The Netherlands

INVACARE BV
Celsiusstraat 46
NL-6716 BZ Ede
Tel : +31 - (0) 318 - 550 056 Fax: +31 - (0) 318 - 555 054

Sverige

INVACARE AB
Fagerstagatan 9, S-163 91 Spånga.

Spain

INVACARE SA
c/Areny, s/n, Poligon Industrial de celrà, 17460 Celrà (girona) - España
Tel. 0972 - 49 32 00 Fax: 0972 - 49 32 20

Italy

Mecc San S.R.L.
Via Dei Pini, 35 I - 36016 Thiene (VI) - Italia
Tel: 0445 - 380059 Fax: 0445 - 380034

Portugal

INVACARE PORTUGAL Lda
Rua Senhora de Campanhã, 105 4369-001 Porto - Portugal
Tel. 02 - 510 57 39 Fax: 02 - 510 50 20

Contents

	ISO 7176-15: 1996 Requirements for Information Disclosure,	
	Documentation and Labelling	2
	Warranty Terms & Conditions	3
	Standard INVACARE terms	3
	Limitation of liability	4
	Contacting Invacare	5
1	Introduction	10
	1.1 Important symbols in this manual	12
	1.2 Type classification and area of use	13
2	Safety Notes	14
	2.1 Repair or service information	14
	2.2 General safety notes	14
	2.3 Safety information on electromagnetic interference	17
	2.4 Safety precautions/safe operation	18
3	Some Useful Tips	21
4	Safety Inspection Checklist	26
	4.1 Troubleshooting - mechanical	29
	4.2 Troubleshooting - electrical	30
	4.3 Checking battery charge level	32
	4.4 Care and maintenance	33

5	Footrest Maintenance	34
5.1	Installing/removing footrests	34
5.2	Footrest height adjustment	36
5.3	Adjusting/replacing telescopic front rigging support	38
5.4	Installing adjustable angle flip-up footplate hinge	39
5.5	Installing/adjusting adjustable angle flip-up footplates	40
5.6	Adjustable angle flip-up footplate angle adjustment	42
5.7	Adjustable angle flip-up footplate alignment and/or angle adjustment	43
5.8	Composite/articulating footplate heel loop replacement	44
5.9	Installing/removing elevating legrests	45
5.10	Raising/lowering elevating legrests and/or adjusting calfpads	47
5.11	Removing/installing/adjusting the cage footrest	48
6.	Arms	50
6.1	Installing/removing flip back armrests	50
6.2	Adjusting flip back armrests	52
7	Van Seat	54
7.1	Replacing seat positioning strap	54
8	Batteries	56
8.1	Removing/installing batteries	56
8.2	Connecting battery cables	63
8.3	Batteries and battery charging	71

10	Motor Locks/Forks	75
	10.1 Disengaging/engaging motor lock levers	75
	10.2 Adjusting forks	76
11	Controls and Operating your Power Chair	77
	11.1 Operation	77
12	Troubleshooting	80
	12.1 Power chair will not drive, ON/OFF light does not come on, when ON/OFF switch is pressed.	80
	12.2 Power chair pulls to one side.	80
	12.3 Power chair will not drive - ON/OFF light flashing.	81
13	Transportation	82
14	Technical Specifications	84
15	Label Locations	86

1 Introduction

Dear User

First of all we wish to thank you for your confidence in our products! We hope you will enjoy your new Powerchair.

This manual contains important hints and information on:

- **Safety**
- **Operation**
- **Care and maintenance**

Please familiarise yourself thoroughly before making your first trip.

The information contained in this document is subject to change without notice.

As a manufacturer of wheelchairs, Invacare endeavours to supply a wide variety of wheelchairs to meet many needs of the end user. However, final selection of the type of wheelchair to be used by an individual rests solely with the user and his/her healthcare professional capable of making such a selection.

Do not operate this equipment without first reading and understanding this manual. If you are unable to understand the warnings, cautions, and instructions, contact your dealer otherwise injury or damage may result.

NOTE:

Not all of the components within this manual will necessarily be available with your XTERRA GT power wheelchair. This manual is a multinational operator's manual and any references not applicable to your product should be ignored.

1.1 Important symbols in this manual



WARNING: THIS SYMBOL WARNS YOU OF DANGER!

- *Follow the instructions to avoid injury to the user or damage to the product!*
-



NOTE:

This symbol indicates hints and suggestions which should help make operating the product easier and point out special functions.



Requirements:

- This symbol indicates a list of the different tools and other requirements you will need to do certain maintenance work.
-

1.2 Type classification and area of use

The XTERRA GT is available with 2 maximum speed options.

- The 4mph model is a Class 2 vehicle. The ACS Remote has 4 preset drive programs.
- The 7.5mph model is a Class 3 vehicle and as such is equipped with lights and a rear view mirror fitted as standard. In addition to the same 4 preset drive programs as the 4mph model setting 5 gives the additional top speed.



WARNING:

- *Under no circumstances must the top speed of the Class 2 XTERRA GT be increased, to do so will infringe Road Traffic Act Regulations.*
-

The Class 3 XTERRA is of course fully compliant and may be used on roads with the exceptions of motorways, unrestricted dual carriageways, cycle lanes and bus lanes.

When used on footpath, pavements, bridleways and pedestrian areas speed must be restricted to 4mph (setting 5 **must not** be used in these areas).

Persons under the age of 14 years **must not** use a Class 3 vehicle.

2 Safety Notes

2.1 Repair or service information

Setup of the Electronic Control Unit is to be performed ONLY by individuals certified by Invacare. The final tuning adjustments of the controller may affect other activities of the wheelchair. Damage to the equipment could occur under these circumstances. If non-certified individuals perform any work on these units, the warranty is void.

2.2 General safety notes



GENERAL WARNINGS

- *Performance adjustments should only be made by professionals of the healthcare field or persons fully conversant with this process and the driver's capabilities. Incorrect settings could cause injury to the driver, bystanders, damage to the chair and to surrounding property.*
- *After the wheelchair has been setup, check to make sure that the wheelchair performs to the specifications entered during the setup procedure. If the wheelchair does NOT perform to specifications, turn the wheelchair OFF immediately and re-enter setup specifications. Repeat this procedure until the wheelchair performs to specifications.*
- *DO NOT climb, go up or down ramps or traverse slopes greater than 9°.*
- *DO NOT attempt to move up or down an incline with a water, ice or oil film.*
- *DO NOT attempt to drive over curbs or obstacles greater than 50mm (2in) in height. Doing so may cause your wheelchair to turn over and cause bodily harm or damage to the chair.*

- *Always stop before climbing an obstacle. Approach slowly until castors contact the obstacle. Apply power and the action of the Sure-Step™ feature will lift the castors over the obstacle. Weight is transferred to the drive wheels providing traction and motor strength to power the chair over the obstacle.*
- *DO NOT use parts, accessories, or adapters other than those authorised by Invacare.*
- *DO NOT stand on the frame of the wheelchair.*



TYRE PRESSURE

- *DO NOT use your wheelchair unless it has the proper tyre pressure (P.S.I.). DO NOT overinflate the tyres. Failure to follow these suggestions may cause the tyre to explode and cause bodily harm. The recommended tyre pressure is listed on the side wall of the tyre.*
-



BATTERIES

- *The warranty and performance specifications contained in this manual are based on the use of deep cycle gel cell batteries. Invacare strongly recommends their use as the power source for this unit.*
 - *Carefully read battery/battery charger information prior to installing, servicing or operating your wheelchair.*
-



ELECTRICAL

- *Extreme care should be exercised when using oxygen in close proximity to electrical circuits. Contact your oxygen supplier for instructions in the safe use of oxygen.*
-



RAIN TEST

- *INVACARE has tested its power wheelchairs in accordance with ISO 7176 Part 9 “Rain Test”. This provides the end user or his/her attendant sufficient time to remove his/her power wheelchair from a rain storm and retain wheelchair operation.*
 - *DO NOT leave power wheelchair in a rain storm of any kind.*
 - *DO NOT use power wheelchair in a shower or leave it in a damp bathroom while taking a shower.*
 - *DO NOT leave power wheelchair in a damp area for any length of time.*
 - *Direct exposure to rain or dampness will cause the chair to malfunction electrically and mechanically and may cause the chair to rust prematurely.*
 - *Check to ensure that the battery covers are secured in place.*
 - *DO NOT use the joystick if the boot is torn or cracked. If the joystick boot becomes torn or cracked, replace IMMEDIATELY.*
-



WEIGHT TRAINING

- *Invacare DOES NOT recommend the use of its wheelchairs as a weight training apparatus. Invacare wheelchairs have NOT been designed or tested as a seat for any kind of weight training. If occupant uses said wheelchair as a weight training apparatus, Invacare shall NOT be liable for bodily injury and the warranty is void.*
-



WEIGHT LIMITATION

- *The XTERRA GT has a maximum user weight limitation of 114kg (18stone).*
-

2.3 Safety information on electromagnetic interference

This electric vehicle was successfully tested in accordance with international standards as to its compliance with Electromagnetic Interference (EMI) regulations. However, electromagnetic fields, such as those generated by radio and television transmitters, and cellular phones, can influence the functions of electric vehicles. Also, the electronics used in our vehicles can generate a low level of electromagnetic interference, which however will remain within the tolerances permitted by law. For these reasons we ask you to please observe the following precautions:



WARNING: DANGER OF MALFUNCTION DUE TO ELECTROMAGNETIC INTERFERENCE!

- *Do not switch on or operate portable transceivers or communication devices (such as radio transceivers or cellular phones) when the vehicle is switched on!*
 - *Avoid getting near strong radio and television transmitters!*
 - *In case the vehicle should be set in motion unintentionally or the brakes are released, switch it off immediately!*
 - *Adding electrical accessories and other components or modifying the vehicle in any way can make it susceptible to electromagnetic interference. Keep in mind that there is no sure way to determine the effect such modifications will have on the overall immunity of the electronic system!*
 - *Report all occurrences of unintentional movement of the vehicle, or release of the electronic brakes to the manufacturer!*
-

2.4 Safety precautions/safe operation



IMPORTANT WARNING

- *The day-to-day activities and the more advanced power chair techniques depend, on your physical capabilities and your own specific circumstances. Our recommendations may occasionally differ from those of your Therapeutic Adviser or Physician, as they have a better understanding of your abilities. Where this is the case, you **MUST FOLLOW THEIR** advice, they are better placed to tell you what is suitable for you and what is not.*
 - ***DO NOT** use your power chair when your driving ability is impaired by medication or alcohol.*
-



CAUTION

- *Avoid using your power chair on rough ground or in adverse weather conditions (snow or ice), always steer clear of obstacles where possible, ensure your clothing and hands are kept clear of all moving parts, ask for assistance when descending or ascending steep gradients. Never attempt to negotiate stairs. Never use an escalator to move a power chair between floors. Due to both the weight of a power chair and its occupant it is not advisable to attempt to be assisted up and down stairs whilst the power chair is occupied.*
 - *If you are a user with limited mobility we advise that in the case of adverse weather conditions i.e. extreme cold, **DO NOT** attempt a journey without an accompanying attendant. In the event of a power failure you could become stranded in an isolated area, where there is the strong possibility you will be unable to get immediate assistance.*
 - *Braking of your power chair is dependent on electromagnetic motor brakes. When these are disengaged by declutching the motor gear box drive system, the chair is in freewheel mode, this mode is for emergency use only and motor gear boxes should remain engaged at all other times.*
 - ***To avoid the power chair freewheeling, special care must be taken to engage motor brakes.***
-



SAFETY INDOORS

- *When using your power chair indoors always consider the following potential hazards:*
 - *Beware of the fact that many of the premises where you are likely to use your power chair may not have been designed with this consideration in mind. You should therefore have an awareness for safety when encountering the likes of narrow doorways, steps, high surfaces, protruding wall fittings and every day household items such as children's toys, electrical appliances etc. Take extra care in kitchen environments.*
 - *Consider the fire evacuation procedures for buildings you may be entering. Never put yourself at risk and ensure that you can be easily evacuated in the event of an emergency.*
-



NOTE

power chairs drive very quietly, generally travel faster than the average walking pace and are low to the ground. Always consider these factors when using your powered Wheelchair in busy pedestrian areas.



COPING WITH EVERYDAY OBSTACLES

- *Coping with the irritation of everyday obstacles can be alleviated somewhat by learning how to manage your wheelchair. Keep in mind your centre of gravity to maintain stability and balance.*
 - *DO NOT attempt to lift the wheelchair by any removable (detachable) parts. Lifting by means of any removable (detachable) parts of a wheelchair may result in injury to the user or damage to the wheelchair.*
 - *Also, be aware of detachable parts such as armrests or legrests. These must NEVER be used for hand-hold or lifting supports, as they may be inadvertently released, resulting in possible injury to the user and/or assistant(s).*
 - *When learning a new assistance technique, have an experienced assistant help you before attempting it alone.*
-



SAFETY/HANDLING OF WHEELCHAIRS

- *Use this information only as a “basic” guide. The techniques that are discussed on the following pages have been used successfully by many.*
 - *Individual wheelchair users often develop skills to deal with daily living activities that may differ from those described in this manual. Invacare recognises and encourages each individual to try what works best for him/her in overcoming environmental obstacles that they may encounter, however ALL WARNINGS and CAUTIONS given in this manual MUST be followed. Techniques in this manual are a starting point for all new wheelchair user and assistant with “safety” as the most important consideration for all.*
-

3 Some Useful Tips

Before you venture off on your first journey, ensure that everything is adjusted to your specific needs, read this manual to familiarise yourself with the product and its functions. DO NOT attempt to drive without attendant on hand until you are fully proficient in using and manoeuvring your power chair.

Ensure power is switched off before entering or leaving your power chair. Before switching on, check that both motors are engaged, tyres are inflated to the correct pressure and are in good condition. When on the move DO NOT attempt turns at full speed, especially while travelling downhill. Before changing from forward to reverse, and vice versa, you must stop, failure to do so will cause severe damage to the electronics. DO NOT use your power chair beyond its limitations. Due to both the weight of a powered Wheelchair and its occupant it is not advisable to attempt to be assisted up and down stairs whilst seated.



When entering or leaving your power chair, DO NOT stand on the footplates.

If you have to brake in an emergency, release the joystick. DO NOT switch off power while the power chair is moving, it would cause an abrupt, sharp stop.



DO NOT use your power chair beyond the limitations set out in this manual concerning kerb height, gradients, etc.



Stability and Balance

To ensure stability and safe control of your power chair you must at all times maintain proper balance. The power chair is designed to remain stable and

upright during normal use, so long as you do not move your centre of gravity outside the normal seating position.



REACHING - BENDING FORWARD

- *Ensure power is OFF. DO NOT lean your body forward out of the power chair further than the length of the armrests.*
- *DO NOT attempt to pick up objects from the floor by bending forward and reaching between your knees.*
- *DO NOT attempt to reach objects by sliding forward to the edge of the power chair seat.*

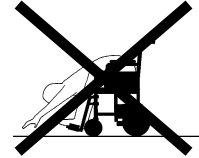

REACHING - BENDING BACKWARDS

- *Again ensure power is switched OFF.*
- *DO NOT reach back any further than your arm will extend without changing your sitting position.*
- *DO NOT lean over the top of the backrest as it will shift the centre of gravity, risking tipping over.*
- *DO NOT hang heavy loads or objects on the backrest. They may make the power chair unstable, especially on an incline.*





TRANSFERRING TO AND FROM OTHER SEATS

- *ALWAYS turn the wheelchair power OFF and engage the motor locks/clutches to prevent the wheels from moving BEFORE attempting to transfer in or out of the wheelchair. Also, make sure every precaution is taken to reduce the gap distance by turning both rear castors away from the object you are transferring onto.*
 - *When transferring, position yourself as far back as possible in the seat. This will prevent broken screws, damaged upholstery and the possibility of the wheelchair tipping forward.*
 - *Note: This activity may be performed independently provided you have adequate mobility and upper body strength.*
 - *Position the wheelchair as close as possible along side the seat to which you are transferring, with the rear castors pointing away from it.*
 - *Engage motor locks/clutches.*
 - *Shift body weight into seat with transfer.*
 - *During independent transfer, little or no seat platform will be beneath you. Use transfer board if at all possible.*
-

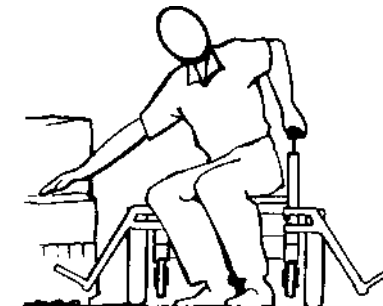



NEGOTIATING GRADIENTS/SLOPES

- *Never attempt to climb or descend an incline where the surface is rough, wet or slippery (gravel, loose chippings, grass, rain, black ice, snow etc.).*
- *If you are in a situation where by the power chair fails to climb a ramp and stalls midway through the manoeuvre, DO NOT attempt to turn the power chair to drive back down in a forward facing direction, always reverse slowly in a steady, flowing action and DO NOT brake harshly, as this will upset balance in this situation. If possible, always seek the assistance of an attendant.*

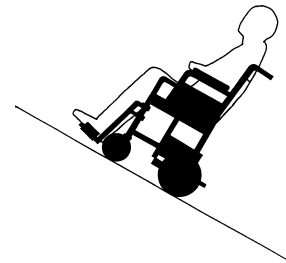

NEGOTIATING KERBS

- *When approaching kerbs wherever possible mount and dismount pavements via ramps. Always approach the kerb head on, not at an angle.*

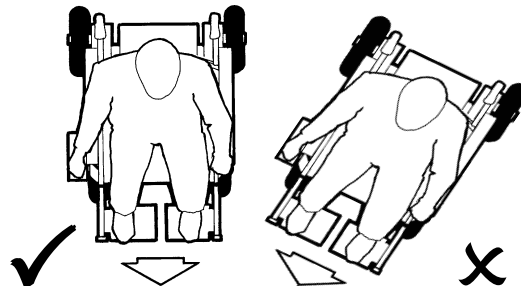

Direction of Travel



YOU, YOUR POWER CHAIR AND OTHERS

- *power chairs are strictly forbidden on motorways and their use is strongly discouraged on highways with fast moving traffic.*
 - *On the Pavement, in Pedestrian Zones or in Supermarkets it is obvious that you must show as much consideration and common sense to others as you expect from them.*
 - *When you cross the carriageway of a public road take extra care and allow time to cross, observe the Highway code. Although you are not required by law to hold a driving license, you are responsible and fully liable for proper operation. An important fact to bear in mind is that you must not present a traffic hazard even in the event of a breakdown. The most common cause may be discharged batteries. It is important to keep the batteries in a fully charged condition, we can only repeat this warning at this stage. If you do suffer a breakdown for whatever reason, you should immediately: seek the assistance of a passer-by. Explain where to find the motor disengagement/declutching lever, ask him/her to switch to freewheel, so that the power chair can be pushed by hand and moved. When in a safe place always ensure motor gear boxes are re-engaged.*
-



SAFEGUARDING OTHERS

- *If there are children in your family or household, keep the power chair away from them. It is not intended to be used as a toy. It isn't just about safeguarding the power chair, it is also about protecting others and yourself from injury.*
 - *Finally, we want you to get the most out of your INVACARE power chair, ensuring that the safety of yourself and others is never in jeopardy. If you are in any doubt about safe techniques, handling or care of the power chair, contact a recognised expert before putting yourself and others at risk.*
-

4 Safety Inspection Checklist

Initial adjustments should be made to suit personal body structure/user capability and preference. Thereafter follow these maintenance procedures:

	Initially	inspect/ adjust weekly	inspect/ adjust monthly	inspect/ adjust periodically
General Wheelchair rolls straight (no excessive drag or pull to one side).	X			X
Motor brushes & motor gearbox coupling				X
Clothing guards Ensure all fasteners are secure.	X			X
Arms Secure but easy to release; adjustment levers engage properly. Adjustable height arms operate and lock securely.	X X			X X
Armrests Inspect for rips in upholstery. Arm rest pad sits flush against arm tube.	X X			X X

	Initially	inspect/ adjust weekly	inspect/ adjust monthly	inspect/ adjust periodically
Seat and back upholstery Inspect for rips or sagging.	X			X
Drive wheels Axle nut and wheel mounting nuts are secure. No excessive side movement or binding when lifted and spun when disengaged (free-wheeling).	X X		X	X
Castors Inspect wheel/fork assembly for proper tension by spinning castor; castor should come to a gradual stop. Loosen/tighten locknut if wheel wobbles noticeably or binds to a stop. CAUTION: As with any vehicle, the wheels and tyres should be checked periodically for cracks and wear, and should be replaced.	X X	X X		
Castor/wheel/fork/head tube Ensure all fasteners are secure.	X	X		

	Initially	inspect/ adjust weekly	inspect/ adjust monthly	inspect/ adjust periodically
Tyres Inspect for flat spots and wear. If pneumatic tyres check for proper inflation. CAUTION: As with any vehicle, the wheels and tyres should be checked periodically for cracks and wear, and should be replaced.	X X	X X		
CLEANING Clean upholstery and armrests.	X			X



NOTE:

Every six (6) months take your wheelchair to a qualified dealer for a thorough inspection and servicing. Regular cleaning will reveal loose or worn parts and enhance the smooth operation of your wheelchair. To operate properly and safely, your wheelchair must be cared for just like any other vehicle. Routine maintenance will extend the life and efficiency of your wheelchair.

4.1 Troubleshooting - mechanical

Chair Veers Left/Right	Sluggish Turn/ Performance	Castors flutter	Squeaks and Rattles	Solutions
X	X	X		If pneumatic, check tyres for correct and equal pressure.
X	X X	X	X X	Check for loose stem nuts/bolts. Check that both castors contact ground at the same time.

Looseness In Chair	Chair 3 Wheels	Solutions
X	X	If pneumatic, check tyres for correct and equal pressure. Check for loose stem nuts/bolts.

4.2 Troubleshooting - electrical

Symptom	Probable Cause	Solutions
Batteries draw excessive current when charging.	Battery failure. Electrical malfunction.	Check batteries for shorted cell. Replace if necessary (PROCEDURE 8). Contact Dealer/Invacare for Service.
Battery indicator flashes the charge level is low - immediately after recharge.	Battery failure. Malfunctioning battery charger. Electrical malfunction.	Check batteries for shorted cell. Replace if necessary (PROCEDURE 8). Contact Dealer/Invacare for Service. Poor connections between charger and wheelchair. Contact Dealer/Invacare.
Battery indicator flashes the charge level is low, too soon after being recharged.	Batteries not charged. Weak batteries.	Have charger checked. Replace batteries if necessary. Contact Dealer/Invacare for Service.
Motor “chatters” or runs irregular.	Electrical malfunction.	Contact Dealer/Invacare for Service.

Symptom	Probable Cause	Solutions
Only one (1) drive wheel turns.	Electrical malfunction. One motor lock is disengaged.	Contact Dealer/Invacare for Service. Engage motor lock (PROCEDURE 9).
Joystick erratic or does not respond as desired.	Damaged motor coupling. Electrical malfunction. Controller Programmed improperly.	Contact Dealer/Invacare for Service. Contact Dealer/Invacare for Service. Contact Dealer/Invacare for Service.
Wheelchair does not respond to commands. power indicator OFF - even after recharging.	Poor battery terminal connection. Electrical malfunction. Blown Fuse	Clean terminals (PROCEDURE 8). Contact Dealer/Invacare for Service. Replace the fuse in Procedure 10.



NOTE:

For additional troubleshooting information and explanation of electrical symptoms, refer to additional sections in this procedure of the manual.

4.3 Checking battery charge level

The following “Do’s” and “Don’ts” are provided for your convenience and safety.

Don'ts	Do's
Don't perform any installation or maintenance without first reading this manual.	Read and understand this manual and any service information that accompanies a battery and charger before operating the wheelchair.
Don't make it a habit to discharge batteries to the lowest level.	Recharge as frequently as possible to maintain a high charge level and extend battery life.
Don't use randomly chosen batteries or chargers.	Follow recommendations in this manual when selecting a battery or charger.
Don't put new batteries into service before charging.	Fully charge a new battery before using.
Don't tap on clamps and terminals with tools.	Push battery clamps on the terminals. Spread clamps wider if necessary.
Don't mismatch your battery and chargers.	Use ONLY a GEL charger for a GEL or sealed battery.

4.4 Care and maintenance



NOTE:

Have your vehicle checked once a year by an authorised Invacare dealer in order to maintain its driving safety and roadworthiness.

Cleaning the vehicle

When cleaning the vehicle, pay attention to the following points:

- Only use a damp cloth and gentle detergent.
- Do not use any scrubbing agents.
- Do not subject the electronic components to any direct contact with water.
- Do not use high-pressure cleaning devices.

5 Footrest Maintenance



AFTER ANY ADJUSTMENTS, REPAIR OR SERVICE AND BEFORE USE:

- *Make sure that all screws, nuts and bolts are tightened securely - otherwise injury or damage may result.*
-

5.1 Installing/Removing footrests

70°/ 70° Taper Pin Style

1. Turn the footrest to the side (open footplate is perpendicular to wheelchair).
2. Install the hinge plates on the footrest onto the hinge pins on the wheelchair frame.
3. Push the footrest towards the inside of the wheelchair until it locks into place.

NOTE:

The footplate will be on the inside of the wheelchair when locked in place.

4. Repeat STEPS 1-3 for other footrest assembly.
5. To remove the footrest, push the footrest release lever inward, rotate footrest outward.
6. Refer to FOOTREST HEIGHT ADJUSTMENT in this procedure of the manual.

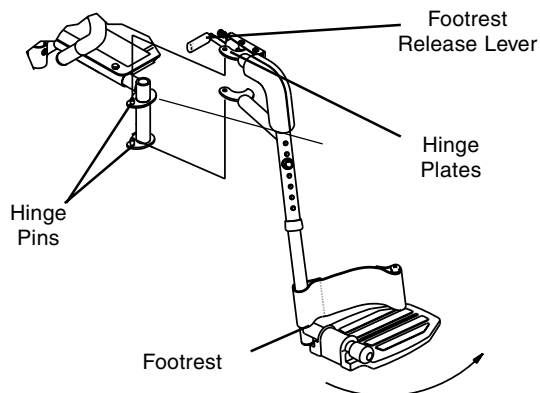

60°, 70°, 70° Taper

1. Turn the footrest to the side (open footplate is perpendicular to wheelchair itself).
2. Insert footrest mounting pin into mounting tube.
3. Push the footrest towards the inside of the wheelchair until it locks into place.

NOTE:

The footplate will be on the inside of the wheelchair when locked in place.

4. Repeat STEPS 1- 3 for the other footrest assembly.
5. To remove the footrest, push the footrest release lever inward, rotate footrest outward.
6. Refer to FOOTREST HEIGHT ADJUSTMENT in this procedure of the manual.

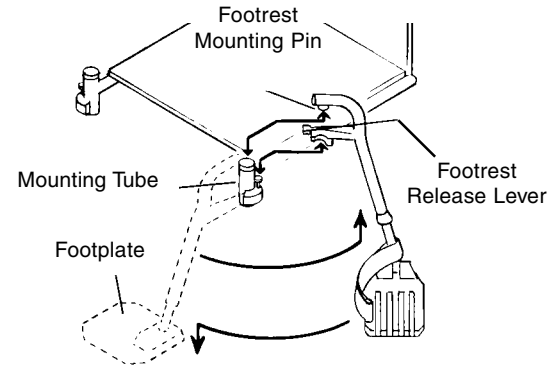

5.2 Footrest height adjustment

60°, 70°, PW93

1. Remove any accessory from the footrest(s).
2. Remove the footrest from the wheelchair. Refer to INSTALLING/REMOVING FOOTRESTS in this procedure of the manual.

NOTE:

Lay the footrest on a flat surface to simplify this procedure.

3. Remove the mounting screw, washers and locknut that secure the lower footrest to the footrest support.
4. Reposition the lower footrest to the desired height.
5. Reinstall the mounting, washers and locknut that secure the lower footrest to the footrest support and tighten securely.
6. Repeat STEPS 1-5 for the opposite side of the wheelchair footrest, if necessary.
7. Reinstall the footrest(s) onto the wheelchair. Refer to INSTALLING/REMOVING FOOTRESTS in this procedure of the manual.
8. Reinstall any accessory onto the footrest(s).

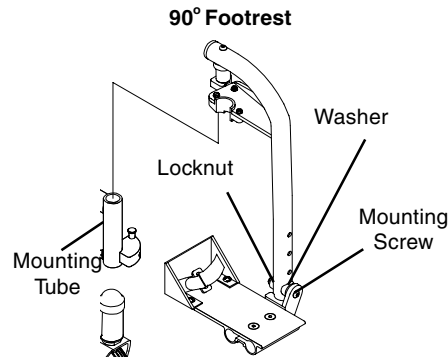
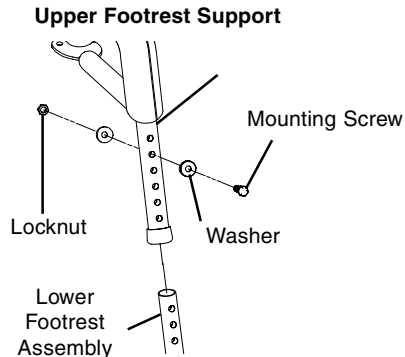

70° Taper

1. Remove any accessory from the footrest(s).
2. Remove the footrest from the wheelchair. Refer to INSTALLING/REMOVING FOOTRESTS in this procedure of the manual.



NOTE:

Lay the assembly on a flat surface to simplify this procedure.
Note the position of spacers before disassembly.

3. Remove the mounting screw and coved spacer that secures the lower footrest assembly.
4. Position the footrest assembly to the desired height.
5. Secure lower footrest assembly with existing mounting screw and coved spacer. Securely tighten.



NOTE:

Make sure spacers are positioned properly when reassembling so not to damage frame mounting tubes.

6. Reinstall the footrest(s) onto the wheelchair. Refer to INSTALLING/REMOVING FOOTRESTS in this procedure of the manual.
7. Reinstall any accessory onto the footrest(s).

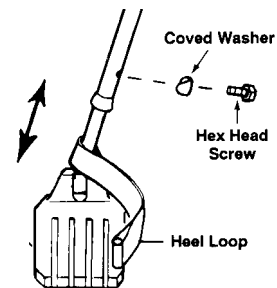

5.3 Adjusting/replacing telescopic front rigging support

1. Remove the two (2) mounting screws, spacers and locknuts that secure the telescopic front rigging support to the seat frame.
2. Perform one (1) of the following:
 - Slide existing telescopic front rigging support to one (1) of three (3) depth positions.
 - Remove existing telescopic front rigging support and install NEW telescopic front rigging support.
3. Secure telescopic front rigging at desired depth with existing two (2) mounting screws, spacers, and locknuts. Securely tighten.

NOTE:

The two (2) telescopic front rigging supports can be positioned at different depths depending on the need of the user.

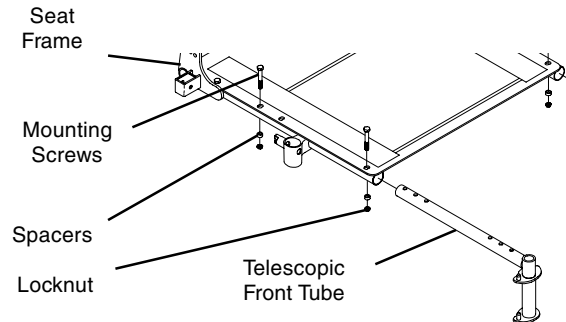

5.4 Installing adjustable angle flip-up footplate hinge

1. Position adjustable angle flip-up footplate (footplate) hinge on the footrest support tube at the desired height.
2. Position mounting screw, washers, spacer, and locknut on the footrest support as shown.
3. Flip the footplate hinge to the UP position.

NOTE:

The footplate hinge will fall to the DOWN position.

4. Tighten the mounting screw, washer, and locknut that secure the footplate hinge to the footrest support until the footplate hinge remains in the UP position.
5. Check the up and down motion of the footplate hinge to make sure the user of the wheelchair can operate the footplates easily.

NOTE:

If footplate's motion is too tight, loosen the mounting screw and locknut approximately 1/4-turn counter clockwise.

If the footplate's motion is too loose, tighten mounting screw and locknut approximately 1/4-turn clockwise.

6. Adjust footplate. Refer to INSTALLING/ADJUSTING ADJUSTABLE ANGLE FLIP-UP FOOTPLATES in this procedure of the manual.

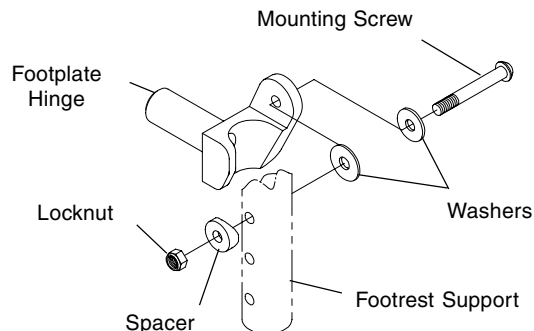

5.5 Installing/adjusting adjustable angle flip-up footplates

Installing

1. Slide the half clamp over the footplate hinge.
2. Loosely tighten the two (2) flat screws that secure the footplate to the half clamp.
3. Adjust the footplates to the necessary angle and depth for the user. Refer to ADJUSTING ADJUSTABLE FLIP-UP FOOTPLATES in this procedure of the manual.

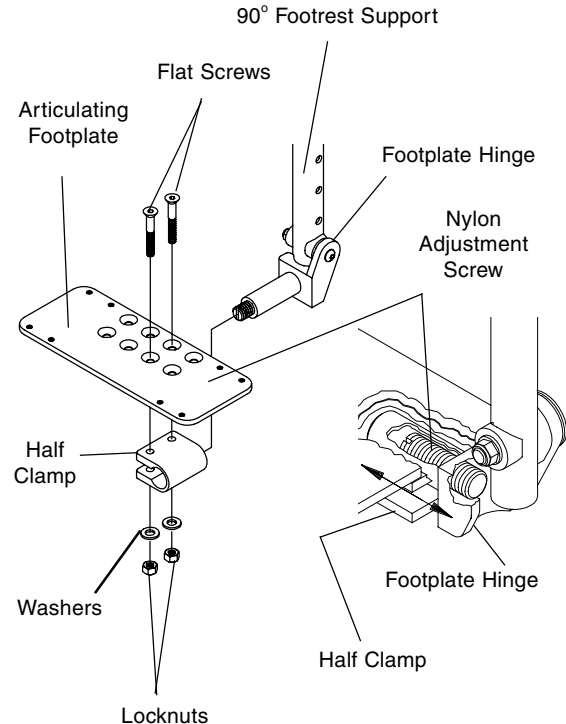

Adjusting

1. Remove the two (2) flat screws, washers and locknuts that secure articulating footplate to the half clamp.

NOTE:

Observe the angle of the articulating footplate for reinstallation.

2. Move articulating footplate to one (1) of four (4) mounting positions.

NOTE:

If desired depth is still not obtained, rotate the half clamp on the footplate hinge 180°.

3. Retighten the two (2) flat screws, washers and locknuts.

NOTE:

The settings for positioning the articulating footplates on the half-clamps may vary for each footplate.

4. Refer to Adjustable Angle Flip-up Footplate Angle Adjustment or Adjustable Angle Flip-up Footplate Alignment and/or Angle Adjustment in this procedure of the manual.

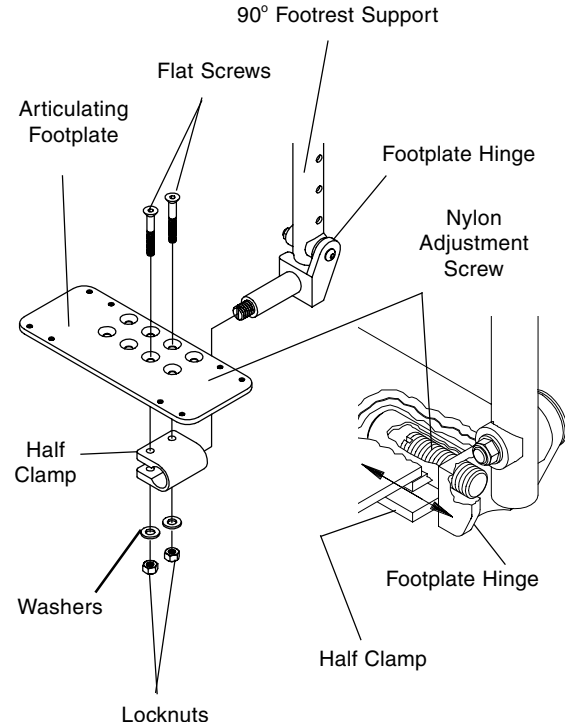

5.6 Adjustable angle flip-up footplate angle adjustment

1. Loosen, but do not remove the two (2) flat screws, washer and locknuts that secure the footplate to the footplate hinge.
2. Position the articulating footplate to the necessary angle to accommodate the user.
3. Retighten the two (2) flat screws, washers and locknuts.

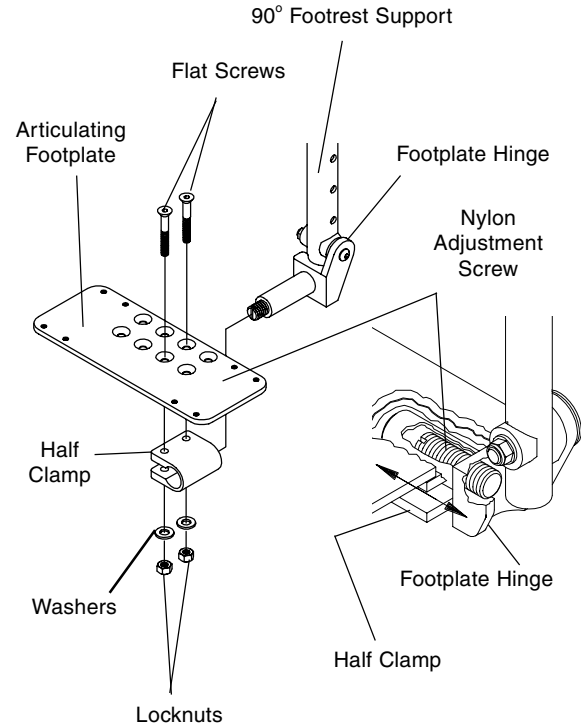
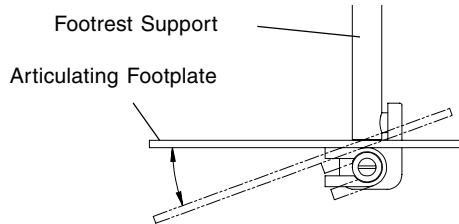

5.7 Adjustable angle flip-up footplate alignment and/or angle adjustment



NOTE:

It is not necessary to remove the footplate to perform this adjustment.

1. Insert a flathead screwdriver through the half clamp on the articulating footplate.
2. Slowly turn nylon adjustment screw in or out until articulating footplate is aligned to the footrest assembly or the desired angle is obtained.

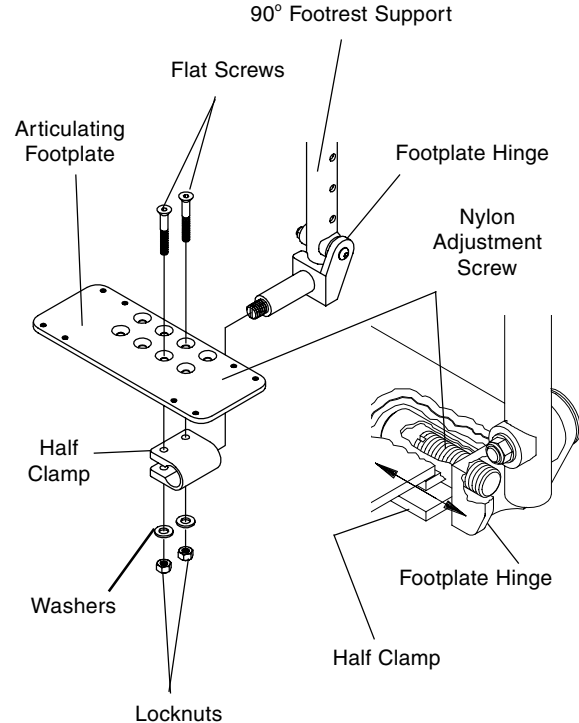
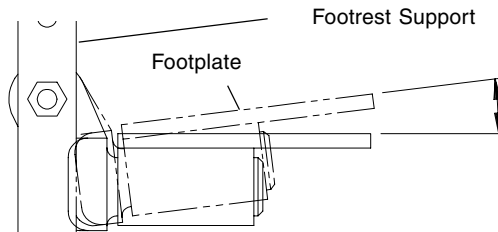

5.8 Composite/articulating footplate heel loop replacement

Disassembly

Composite

1. Remove the mounting screw and covered washer that secures the lower half of the footrest to the swingaway footrest assembly.
2. Remove the lower footrest assembly.
3. Remove the mounting screw and locknut that secure the heel loop to the footrest.
4. Slide heel strap over cane of footrest assembly.

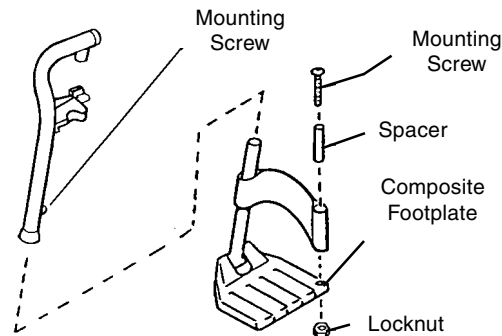

Articulating

1. Remove the two (2) mounting screws that secure the heel loop to the articulating footplate.

Reassembly

1. Replace heel strap/loop.
2. Reverse preceding steps to reassemble.

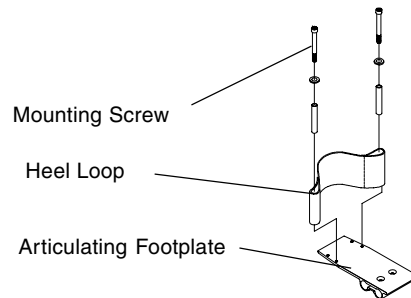

NOTE:

When securing heel loop to the footrest, tighten mounting screw until the spacer is secure.

5.9 Installing/removing elevating legrests

Installing

1. Turn legrest to side (open footplate is perpendicular to wheelchair) and position mounting holes in the legrest hinge plates with hinge pins on the wheelchair frame.
2. Install the legrest hinge plates onto the hinge pins on the wheelchair frame.
3. Rotate legrest toward the inside of the wheelchair until it locks in place.

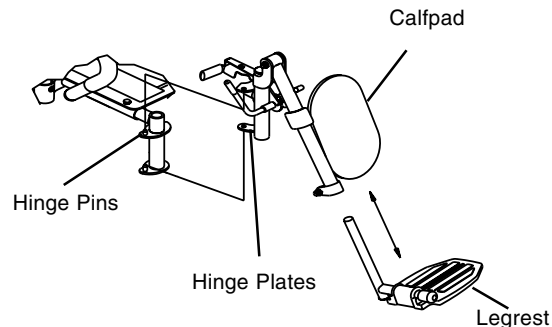

NOTE:

The footplate will be on the inside of the wheelchair when locked in place.

4. Repeat STEPS 1-3 for the opposite legrest.
5. After seated in wheelchair, adjust footplate to correct height by loosening nut and sliding the lower footrest assembly up or down until desired height is achieved.

Legrest Release Handle

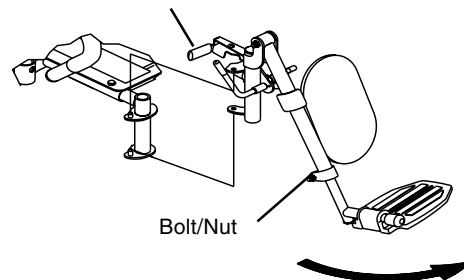

Removing

1. Push the legrest release handle toward the inside of the wheelchair (facing the front of the wheelchair) and swing the legrest to the outside of the wheelchair.
2. Lift up on the legrest and remove from the wheelchair.
3. Repeat STEPS 1-2 for opposite side of wheelchair.

5.10 Raising/lowering elevating legrests and/or adjusting calfpads

Raising/Lowering Elevating Legrests

1. Perform one (1) of the following:

- **RAISING** - Pull back on the release lever until the leg is at the desired height.
- **LOWERING** - Support leg with one (1) hand and push release lever downward with other hand.

Adjusting Calfpads

1. Turn the calfpad towards the outside of the wheelchair.
2. Slide the calfpad up or down until the desired position is obtained.

NOTE:

If one (1) of the top two (2) calfpad adjustment positions is being used, the legrest will need to be raised to avoid interference with the front stabilizers while going over obstacles or going up and down ramps. Refer to **RAISING/LOWERING ELEVATING LEGRESTS** in this procedure of the manual.

3. Turn the calfpad towards the inside of the wheelchair.

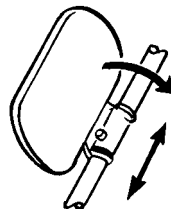
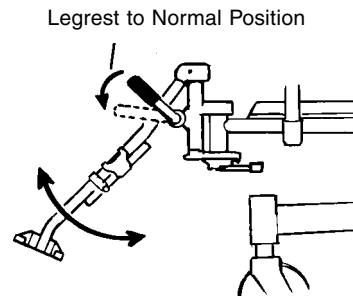

Adjust Calfpad

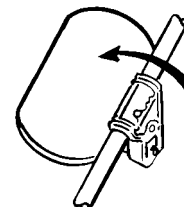

Secure Calfpad

5.11 Removing/installing/adjusting the cage footrest

Removing/installing/depth adjustment

1. Remove the cushion.
2. Remove the four (4) mounting screws, spacers, and locknuts that secure the cage footrest to the seat frame.
3. Perform one (1) of the following:
 - To remove cage footrest, pull footrest out of the seat assembly.
 - To adjust depth, adjust mounting tubes to desired depth and reinstall mounting screws. Securely tighten.
4. To install, slide footrest into seat assembly to desired depth and reinstall mounting screws. Securely tighten.
5. Reinstall cushion.

Height adjustment

1. Remove the two (2) mounting screws, tube clamps, and locknuts that secure the anti-rattle, slide tube and footrest to upright tubes.
2. Adjust the footrest to desired position.
3. Reinstall the two (2) mounting screws, tube clamps, and locknut that secure the anti-rattle, slide tube and footrest to upright tubes. Securely tighten.

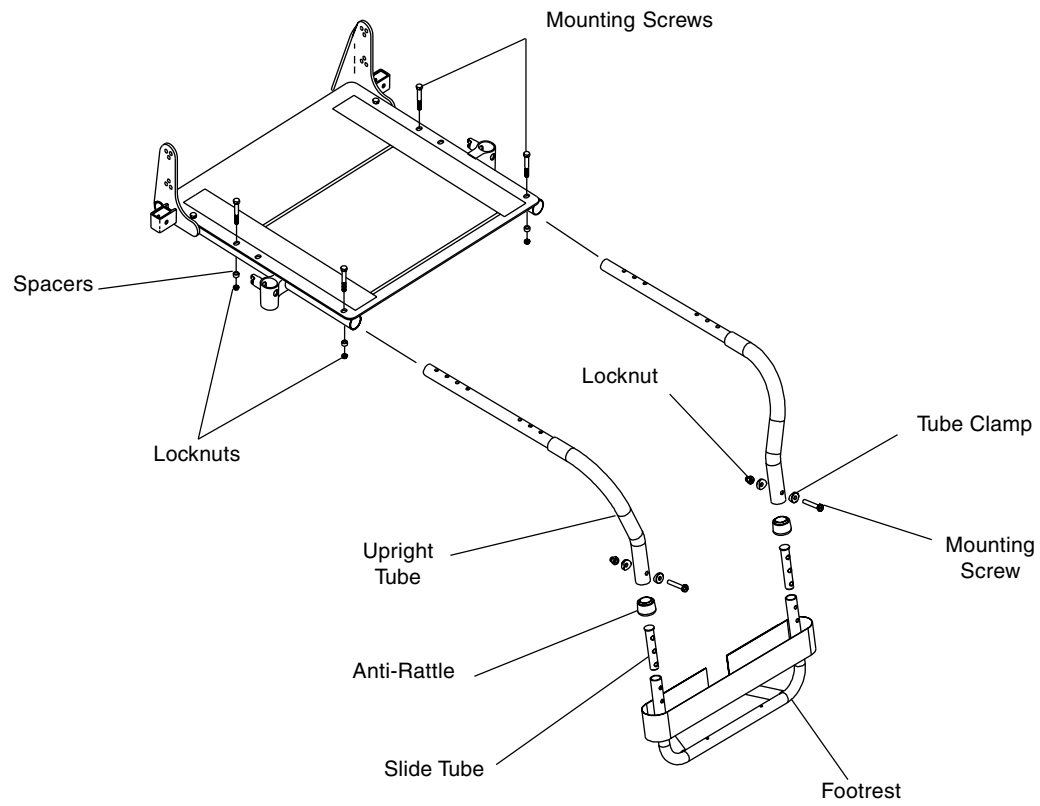

6. Arms



WARNING

- *After ANY adjustments, repair or service and BEFORE use, make sure that all attaching hardware is tightened securely - otherwise injury or damage may result.*

6.1 Installing/removing flip back armrests



WARNING

- *Make sure the flip back armrest release and height adjustment levers are in the locked position before using the wheelchair.*



NOTE:

Flip back armrest release lever must be in the unlocked (UP- HORIZONTAL) position when placing the armrest into the arm sockets.

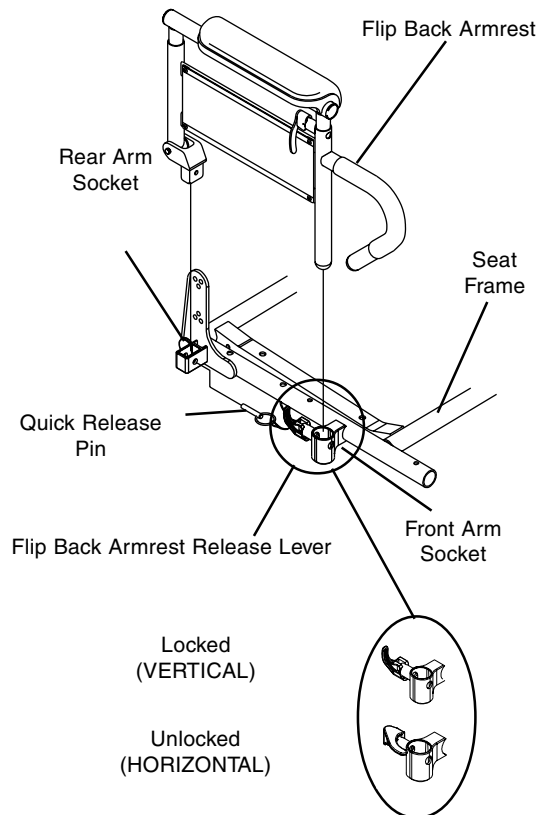

Installing

1. Visually inspect to ensure flip back armrest release lever is in the unlocked HORIZONTAL position.
2. Slide the flip back armrest into the arm sockets on the seat frame.
3. Install the quick release pin through the rear arm socket and flip back armrest.
4. Lock the flip back armrest by pressing the flip back armrest release lever into the VERTICAL position.
5. Repeat STEPS 1-4 for the opposite flip back armrest.

Removing

1. Unlock the flip back armrest by positioning the flip back armrest release lever into the HORIZONTAL position.
2. Remove the quick release pin that secures the flip back armrest to the rear arm socket.
3. Pull up on the flip back armrest and remove the armrest from the arm sockets.
4. Repeat STEPS 1-3 for the opposite flip back armrest, if necessary.

6.2 Adjusting flip back armrests



WARNING

- *Make sure the flip back armrest release and height adjustment levers are in the locked position before using the wheelchair.*

Positioning Flip Back Armrests for User Transfer

1. Unlock the flip back armrest by pulling the armrest release lever into the HORIZONTAL position.



WARNING

- *Armrest release lever must remain in the horizontal position during transfer, otherwise injury may result.*
2. Pull up on the flip back armrest and remove the armrest from the front arm socket.
 3. Continue to pull up on the flip back armrest until the armrest is out of the way.
 4. Repeat STEPS 1-3 for opposite flip back armrest, if necessary.

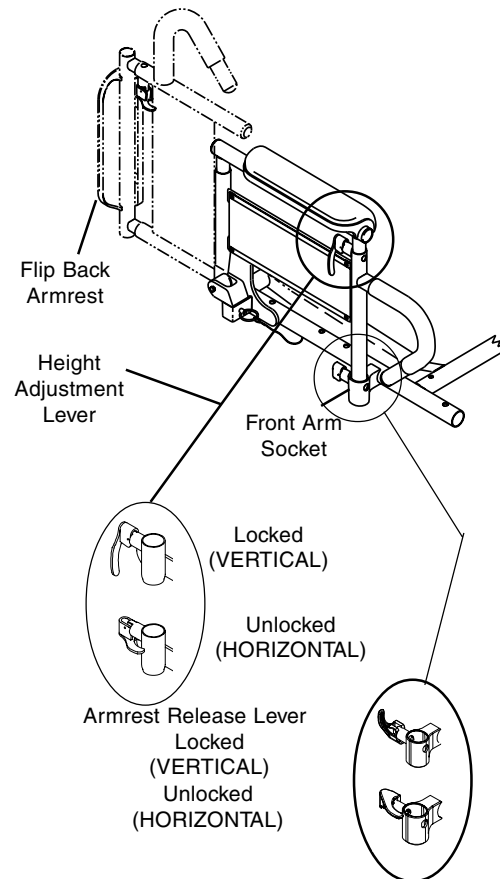

Positioning Flip Back Armrests for Use

1. Make sure the flip back armrest release lever is in the HORIZONTAL position.
2. Install the flip back armrest into the front arm socket.
3. Lock flip back armrest by pressing flip back armrest release lever into the VERTICAL position.
4. Lift up on flip back armrest to make sure the armrest is locked in place.
5. Repeat STEPS 1-4 for opposite flip back armrest, if necessary.

Adjusting

1. Unlock top of flip back armrest by pulling height adjustment lever into the HORIZONTAL position.
2. Adjust top of the flip back armrest to the desired height.
3. Lock top of flip back armrest by pushing height adjustment lever into the VERTICAL position.

7 Van Seat



WARNING

- *After ANY adjustments, repair or service and BEFORE use, make sure that all attaching hardware is tightened securely - otherwise injury or damage may result.*
-

7.1 Replacing seat positioning strap

Standard/Adjustable Seat frames

1. Remove the seat cushion from the seat pan.
2. Move the flip back armrests out of the way. Refer to USING/ADJUSTING FLIP BACK ARM-RESTS in PROCEDURE 5 of this manual.
3. Remove the two (2) mounting screws, quick release pin tabs, spacers, and locknuts that secure the seat pan and seat positioning straps to the seat frame.
4. Remove the two (2) halves of the seat positioning strap from the rear seat frame.



NOTE:

Quick release pin tabs are positioned underneath the seat positioning strap.

5. Reposition the two (2) new seat positioning strap halves underneath seat rails.
6. Reinstall the two (2) mounting screws, quick release pin tabs, spacers, and locknuts that secure the seat pan and seat positioning straps to the seat frame and torque to 75-inch pounds.
7. Reinstall the seat cushion onto the seat pan.

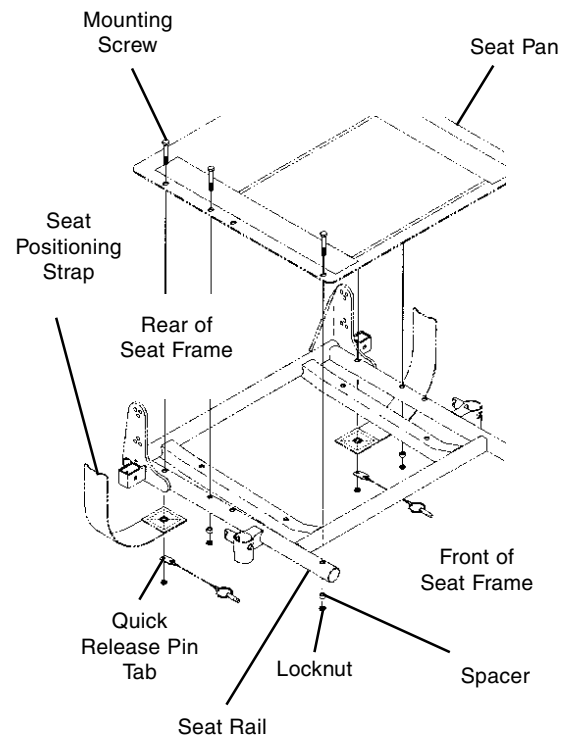

8 Batteries



WARNING

- *Make sure power to the wheelchair is OFF before performing this procedure.*
 - *The use of rubber gloves and chemical goggles is recommended when working with batteries.*
 - *Invacare strongly recommends that battery installation and battery replacement always be done by a qualified technician.*
 - *After ANY adjustments, repair or service and BEFORE use, make sure all attaching hardware is tightened securely - otherwise injury or damage may result.*
 - *This procedure MUST be performed while the wheelchair is unoccupied.*
-

8.1 Removing/installing batteries



WARNING

- *Each battery weighs 16kg. Use proper lifting techniques (lift with your legs) to avoid injury.*
 - *Failure to use the correct battery size and/or voltage may cause damage to your wheelchair and give you unsatisfactory performance.*
 - *Always use a battery lifting strap when lifting a battery. It also helps to prolong the life of the battery.*
-

Removing

1. Place the wheelchair in a well ventilated area where work can be performed without risking damage to carpeting or floor covering.
2. Ensure the Joystick is switched off.
3. Pull release lever located underneath the front of the seat to disengage.
4. Tilt seat backward and lock seat in upward position with seat prop.
5. Disconnect the battery wiring harness from the front battery.
6. Disconnect battery wiring harness from the rear battery.
7. Disconnect the battery retention strap.
8. Lift the front battery out of the base frame.
9. Slide rear battery forward and lift out of base frame.

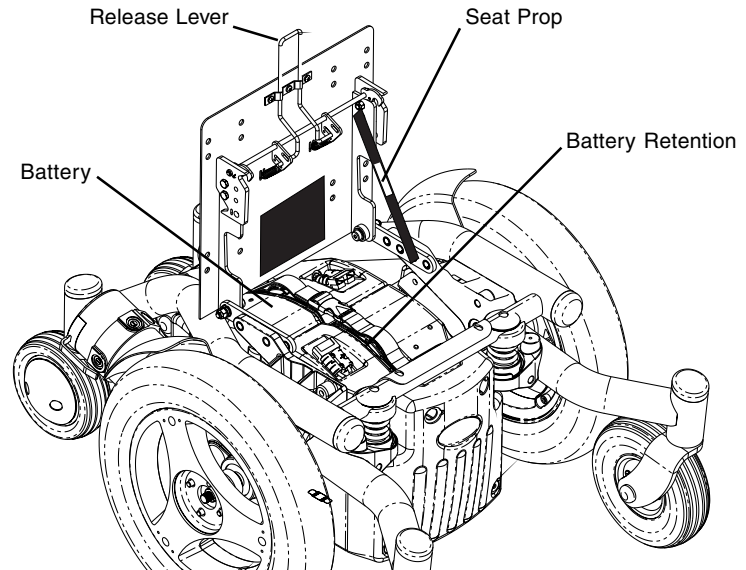

Installing

1. Install the rear battery into the base frame in the orientation shown before .
2. Slide the rear battery rearward.
3. Install the front battery into the base frame in the orientation shown .
4. Connect the battery retention strap.
5. Connect the battery wiring harness to the rear battery.
6. Connect the battery wiring harness to the front battery.



WARNING

- *When lowering the seat, ensure that hands and fingers are clear from underneath seat before lowering, otherwise, injury may result.*
 - *After lowering seat, ensure that seat is locked securely in place before operating chair, otherwise serious personal injury, damage to the wheelchair and/or damage to surrounding property may occur.*
-
7. To lower seat: Lift up on seat with one hand. While holding seat, pull prop toward the front of the seat. Lower seat.

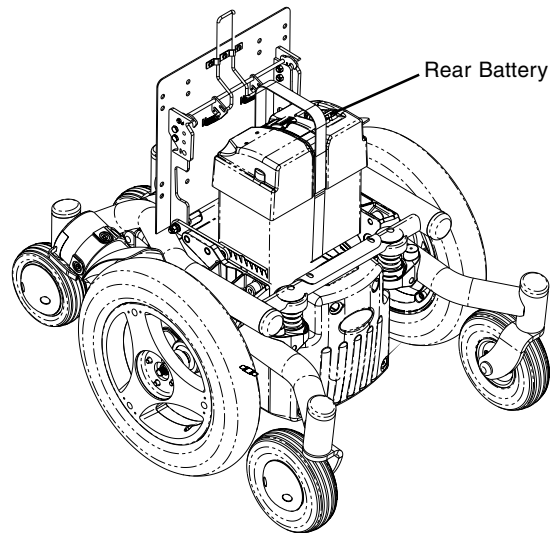
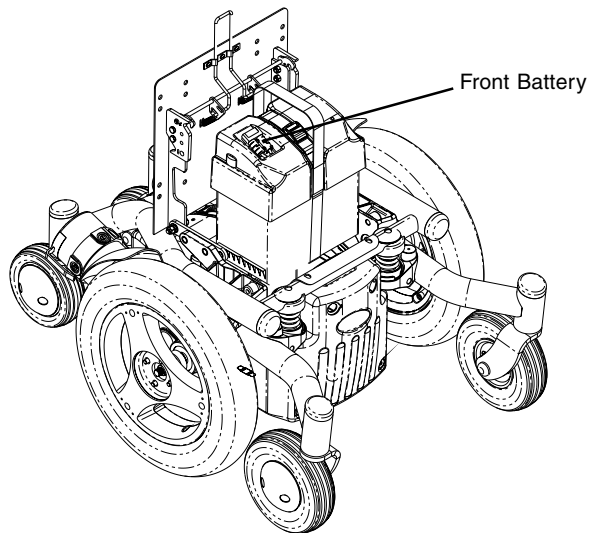

Disconnecting Battery Cables (figure 3)



WARNING

- *NEVER allow any of your tools and/or battery cable(s) to contact BOTH battery terminal(s)/ post(s) at the same time. An electrical short may occur and serious personal injury or damage may occur.*
- *The use of rubber gloves and chemical goggles is recommended when working with batteries.*



NOTE:

Perform this procedure on one (1) battery and battery box at a time. Repeat procedure for other battery box.

1. Disconnect the strap that secures the lid to the battery.
2. Lift up on battery box lid to expose underlying cables.
3. Cut the tie wraps that secure the battery covers to the terminals.
4. Perform one (1) of the following:
 - Direct Mount Method - Peel back battery covers to expose ring terminal on each battery cable as follows:

RED battery cover from red battery cable.

BLACK battery cover from Black battery cable.

Direct mount method

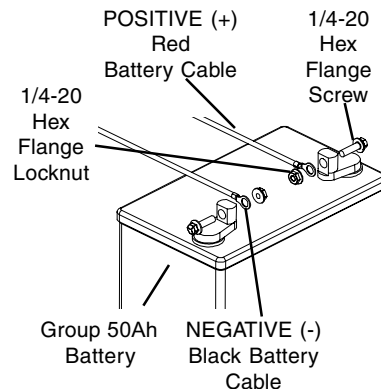
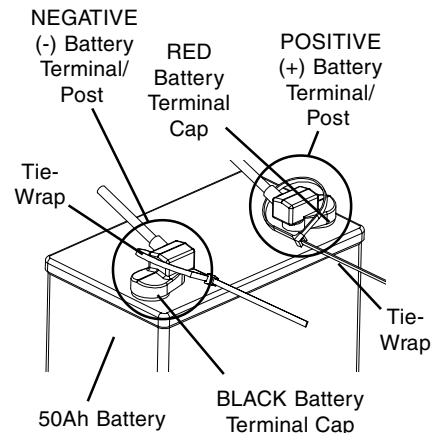

- Battery Clamp Method - Peel back battery covers to expose battery clamp on each battery cable as follows:

RED battery clamp cover from red battery cable.

BLACK battery clamp cover from Black battery cable.

3. Perform one (1) of the following:

- Direct Mount Method

Remove the hex screw and locknut that secures the NEGATIVE (-) black battery cable to the negative battery terminal/post.

Remove the hex screw and locknut that secures the POSITIVE (+) red battery cable to the positive battery terminal/post.

- Battery Clamp Method

Remove the hex screw that secures the NEGATIVE (-) black battery cable to the battery clamp of the positive battery terminal/post.

Remove the hex screw that secures the POSITIVE (+) red battery cable to the battery clamp of the positive battery terminal/post.

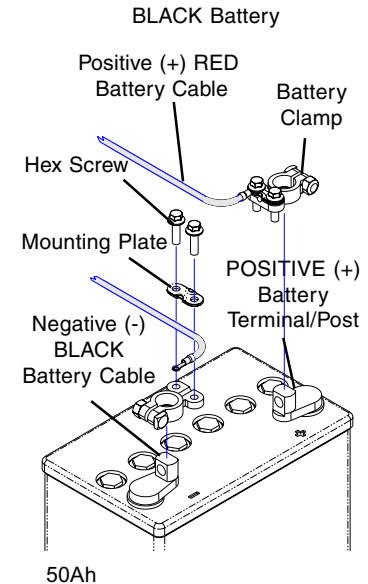
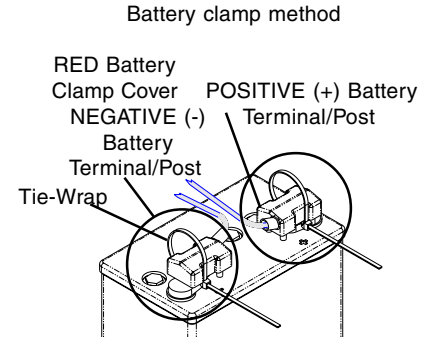



NOTE:

To transfer battery clamps to new battery, perform the following:

Remove the hex screw and locknut that secures the battery clamp to the negative battery terminal/post. Remove battery clamp.

Remove the hex screw and locknut that secures the battery clamp to the positive battery terminal/post. Remove battery clamp.

8.2 Connecting battery cables



WARNING

- *NEVER allow any of your tools and/or battery cable(s) to contact BOTH battery terminal(s)/post(s) at the same time. An electrical short may occur and serious personal injury or damage may occur.*
 - *The use of rubber gloves and chemical goggles is recommended when working with batteries.*
-

Perform one (1) of the following methods for connecting the battery cable(s):

- For group 22 NF Batteries that have mounting holes in the battery terminal(s)/post(s) - Use direct mount method.
- For group 22 NF Batteries that do not have mounting holes in the battery terminal(s)/post(s) - Use battery clamp method.

Direct Mount method (FIGURES 4 and 5)

1. Install battery terminal cap(s) onto battery cable(s) as follows:

- RED battery terminal cap onto red battery cable.
- BLACK battery terminal cap onto Black battery cable.



CAUTION

- *When connecting the battery cables to the battery(ies), the battery cable(s) MUST be connected to the battery terminal(s)/post(s) depending on battery type, otherwise damage to the battery cable may result when installing battery terminal caps.*
-

2. Connect battery cable(s) to battery(ies) terminal(s)/post(s) as follows (depending on battery type):
 - Negative (-) BLACK battery cable to NEGATIVE (-) battery terminal/post.
 - Positive (+) RED battery cable to POSITIVE (+) battery terminal/post.
3. Secure the battery cable(s)/ring terminal(s) to the battery terminal(s)/post(s), BLACK to NEGATIVE (-) and RED to POSITIVE (+), with the provided 1/4-20 x 7/8-inch hex flange screw and hex flange locknut. Securely tighten. (depending on battery type).
4. Verify all battery cable(s)/ring terminal(s) are correctly installed and securely tightened.
5. Slide terminal cap(s) down battery cable(s) and onto battery clamps.
6. Secure each terminal cap in place with a tie-wrap (Use tie-wraps 11-1/2-inches long).



NOTE:

It will be necessary to trim excess tie-wrap in order to install the battery box top(s).

7. Install the battery with lid into the wheelchair. Refer to INSTALLING/REMOVING BATTERIES in this procedure.



NOTE:

New Battery(ies) MUST be fully charged BEFORE using, otherwise the life of the battery(ies) will be reduced.

8. If necessary, charge the battery(ies). Refer to CHARGING BATTERIES in this procedure.

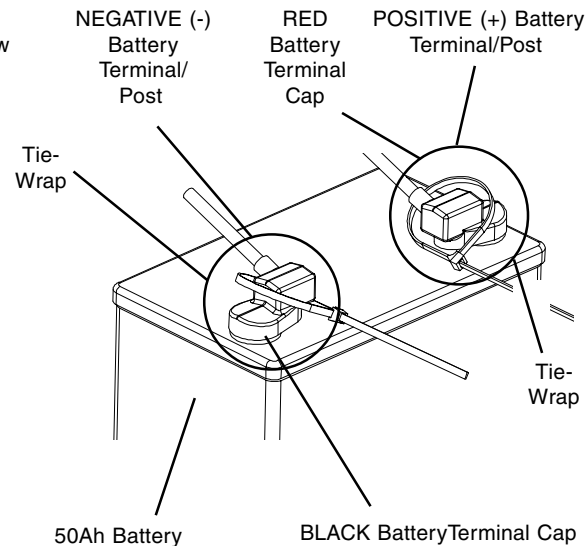
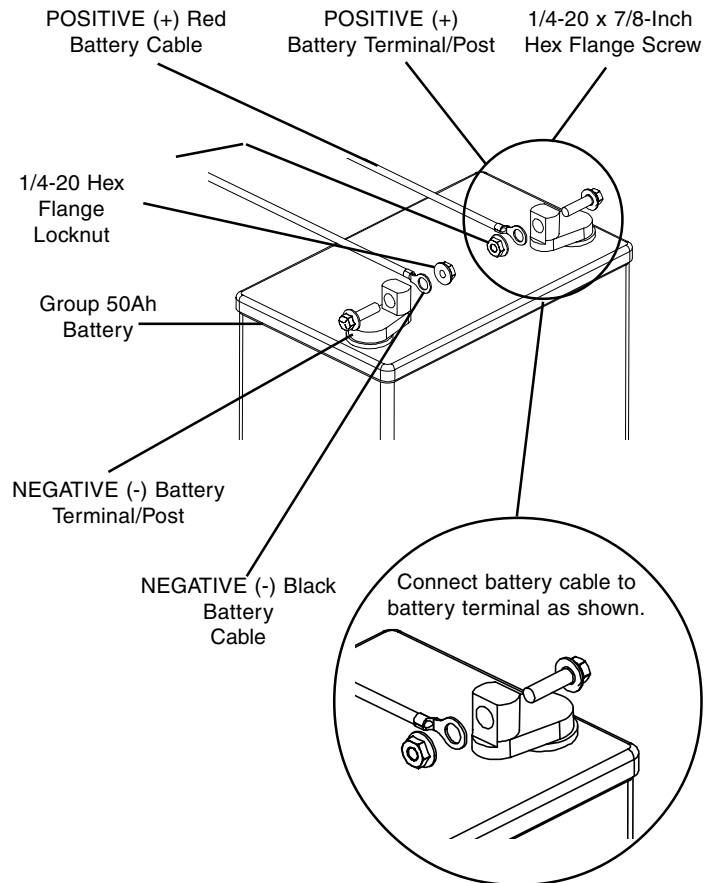

INSTALLING BATTERY TERMINAL Caps

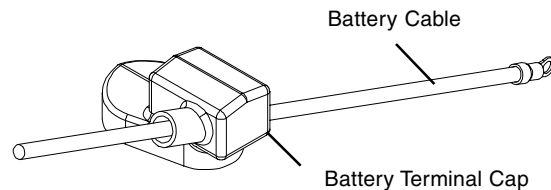

NOTE: Only one (1) battery cable and terminal cap shown for clarity. Both caps install in the same manner.

Battery Clamp Method



CAUTION

- *The battery clamps MUST be mounted in the positions shown, otherwise the battery box top cannot be installed properly.*
-

1. Perform one (1) of the following:

- If the battery clamp of the POSITIVE (+) battery terminal/post is NOT mounted in the orientation shown, perform the following:

Loosen the hex nut that secures the battery clamp to the POSITIVE (+) battery terminal/post.



CAUTION

- *When tightening the clamps, always use a box wrench. Pliers will “round off” the nuts. NEVER wiggle the battery terminal(s)/post(s) when tightening. The battery may become damaged.*
-

Remove the battery clamp from the POSITIVE (+) battery terminal/post.

Reposition the battery clamp on the POSITIVE (+) battery terminal/post as shown in.

Securely tighten the hex nut that secures the battery clamp to the positive (+) battery terminal/post.

- If the battery clamp on the POSITIVE (+) battery terminal/post is positioned as shown in FIGURE 6, proceed to STEP 2.

2. Install battery clamp covers onto battery cables as follows:

- RED battery clamp cover onto red battery cable.
- BLACK battery clamp cover onto Black battery cable.



NOTE:

Only one (1) battery cable and battery clamp covdr are shown for clarity. Both battery clamp covers install in the same manner.

POSITIVE (+) Battery Terminal/Post
(Note position of battery clamp)

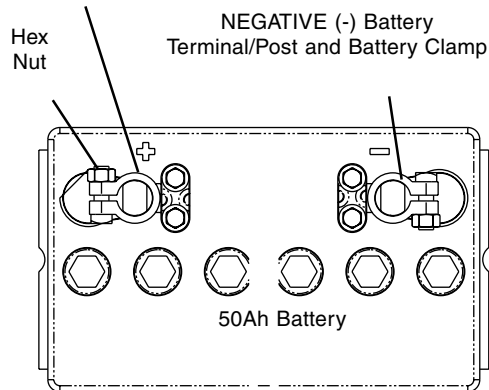

INSTALLING BATTERY TERMINAL Caps

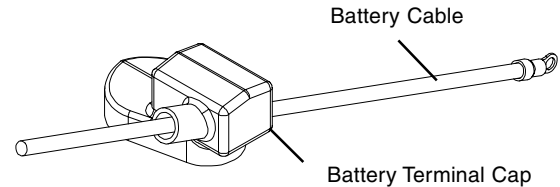

NOTE: Only one (1) battery cable and terminal cap shown for clarity. Both caps install in the same manner.



CAUTION:

- *When connecting the battery cable/ring terminal(s) to the battery(ies) clamp(s), the battery cable(s) must be connected in the position shown, otherwise damage may occur to the battery cable and/or battery clamp covers.*
-

3. Connect battery cable(s) to battery(ies) terminal(s)/post(s) as follows:

- Negative (-) BLACK battery cable/ring terminal between the mounting plate and battery clamp of NEGATIVE (-) battery terminal/post.
- Positive (+) RED battery cable/ring terminal between the mounting plate and battery clamp of POSITIVE (+) battery terminal/post.

4. Secure the battery cable(s)/ring terminal(s) to the battery clamp(s), BLACK to NEGATIVE (-) and RED to POSITIVE (+), with existing hex screws. Securely Tighten.

5. Verify battery cable ring terminal(s) are correctly installed and securely tightened.

6. Slide battery clamp covers down battery cables and onto battery terminals.

7. Secure each terminal cap in place with a tie-wrap (Use tie-wraps 11-1/2-inches long).



NOTE:

It will be necessary to trim excess tie-wrap in order to install the battery box top(s).

8. Install the battery with lid into the wheelchair. Refer to INSTALLING/REMOVING BATTERIES W/ LID INTO WHEELCHAIR in this procedure.

**NOTE:**

New Battery(ies) MUST be fully charged BEFORE using, otherwise the life of the battery(ies) will be reduced.

9. If necessary, charge the battery(ies). Refer to CHARGING BATTERIES in this procedure.

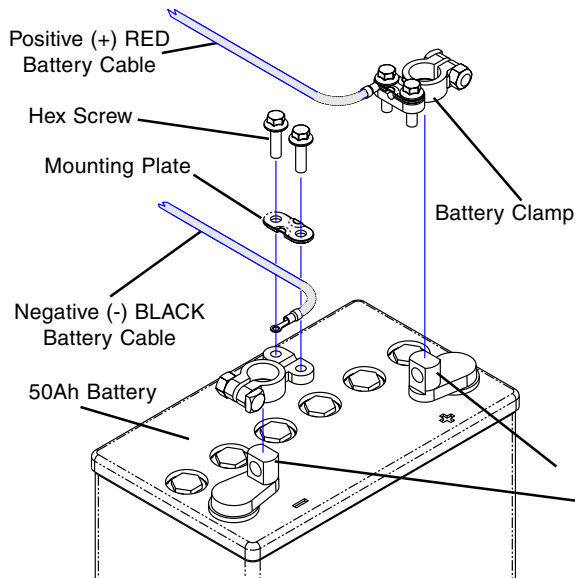

NOTE: Battery clamps exploded away for clarification purposes only.

EXPLODED VIEW

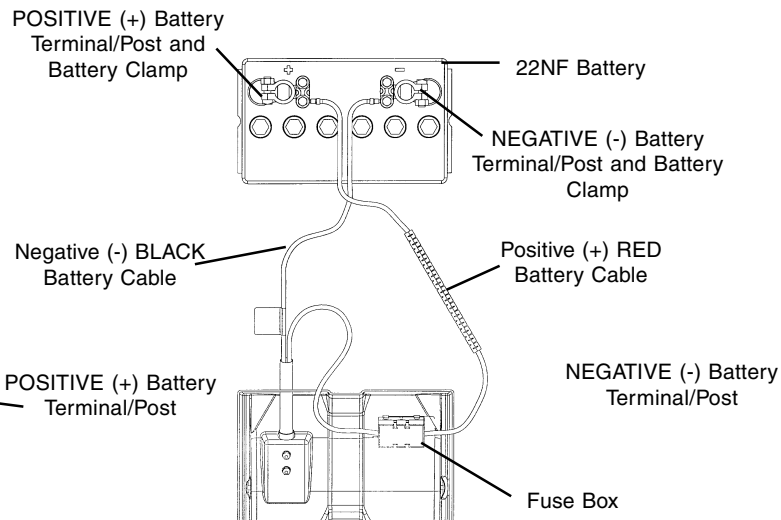

TOP VIEW

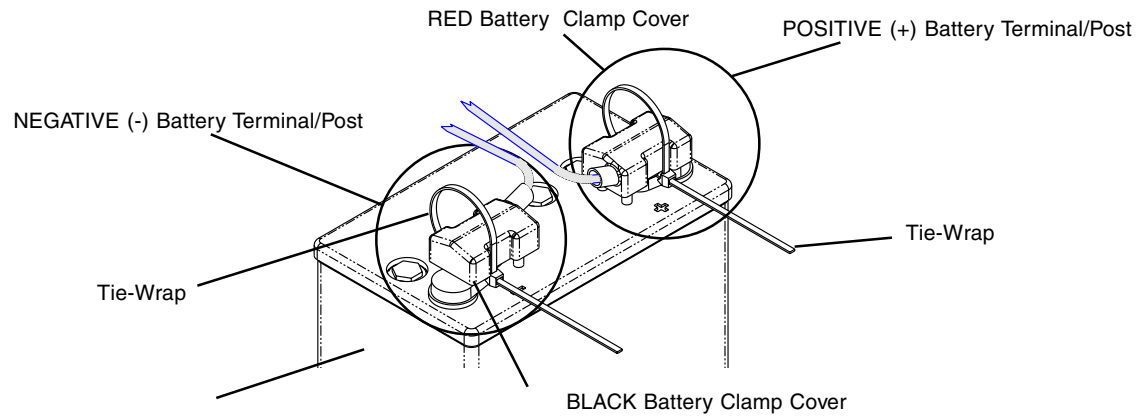

8.3 Batteries and battery charging



IMPORTANT WARNINGS

- *The battery charger supplied with your power chair is for indoor use only, it must be protected from moisture and external heat sources.*
 - *Handle the battery charger with care, if it has been dropped or damaged, do not use it.*
 - *Do not use an extension lead for connection from the mains to the charger unless absolutely necessary. If you do use one ensure it is in good condition.*
 - *Only use the charger supplied with your power chair.*
 - *Batteries are heavy, if you have to remove them, ensure you adopt the correct lifting posture to avoid injury. Ask for assistance if necessary.*
-

Batteries

Your power chair is equipped with GEL type batteries (Acid free) which require only regular charging.

To ensure trouble free operation of your power chair it is imperative to monitor the battery charge condition continuously and to recharge the batteries in good time.

Intervals at which the batteries may need charging will vary and depend upon the conditions in which the power chair is being used, the weight of the user and ambient operating temperature in which the power chair is being operated.

New batteries need charging before your first journey and will not perform to their peak until the first six to ten charging cycles have been completed.

To ensure long battery life DO NOT allow your batteries to become totally discharged. If your power chair is not used for any length of time the batteries must receive a full charge once a month and remain fully charged during storage.

For replacement batteries contact your local INVACARE supplier/dealer in order to ensure that the new batteries are of the correct type and specification and are correctly installed and connected.

WHEN TO CHARGE

Keep an eye on the battery charge indicator on the joystick box - at full charge all ten lights will be on (from right to left: green, amber, red). As the battery charge drops during power chair operation successive lights will extinguish until eventually only the two red lights will be on. It means that you must charge the Batteries without delay. We strongly advise you, however, not to wait until this critical point has been reached but to charge the batteries as early and as often as possible after you have used your power chair. If you ignore the warning (only two red lights on), and the battery charge drops further to a level where it is no longer sufficient to allow safe driving, the controller will automatically cut the power supply to the motors, so that the power chair comes to an abrupt halt, and you may find yourself stranded in an unpleasant situation.

Also, if you run down the Batteries to such a low charge, you will have greatly reduced their potential service life.

Except in emergencies, NEVER drive on discharged Batteries, this will add strain to them and reduce their life.

We recommend batteries should be charged every time the power chair is used, independent of the depth of discharge. Depending on this and their capacity, a full charge on completely discharged Batteries can take up to approximately eight hours.

CHARGING PROCEDURES



IMPORTANT

- *Before you attempt charging, ensure you read and understand the instruction manual supplied with the Battery Charger.*
-

To charge Batteries:

- Ensure power is switched off on the joystick control box.
- Check that the ventilation slots on the charger are clean and unobstructed.
- Plug the charger output lead into the socket on the joystick control box.
- Connect the charger power supply cable to the mains socket and switch the power on. The red "Mains ON" and the yellow "Charging" lights on the charger will come on.
- It is recommended the charger is left connected as described until the green full charge light illuminates to obtain optimum performance of the batteries.
- When the green "Charge Complete" light illuminates, the batteries are fully charged and ready for use.



NOTE

An "Overvoltage" condition may occur temporarily while you are descending a steep gradient with fully charged batteries, when the motors virtually have the effect of a dynamo, adding to the batteries.

When charging is complete switch off and disconnect from the mains.

If required, the charger can be left connected to the power chair and to the mains. This will keep the batteries 100% charged and compensate for self-discharging over a long period. (You cannot overcharge your batteries).

If you experience charging difficulties or require further advice, do not hesitate to contact your local INVACARE supplier/dealer.

10 Motor Locks/Forks



WARNING

- *After ANY adjustments, repair or service and BEFORE use, make sure that all attaching hardware is tightened securely - otherwise injury or damage may result.*



CAUTION

- *As with any vehicle, the wheels and tyres should be checked periodically for cracks and wear, and should be replaced.*

10.1 Disengaging/engaging motor lock levers



WARNING

- *DO NOT engage or disengage motor locks until the power switch is in the OFF position.*



NOTE:

Motor lock disengagement/engagement allows free wheeling or joystick controlled operation. Free wheeling allows an assistant to manoeuvre the wheelchair without power.

4 Pole Motors

1. Perform one (1) of the following:

- Disengage (PUSH) - push motor lock levers downward.
- Engage (DRIVE) - pull motor lock levers upward

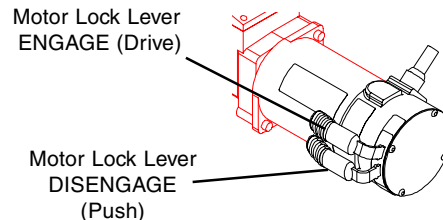

10.2 Adjusting forks

1. Remove the headtube cover from the castor headtube.
2. To properly tighten castor journal system and guard against flutter, perform the following check:
 - Tip back the wheelchair to floor.
 - Pivot both forks and castors to top of their arc simultaneously.
 - Let castors drop to bottom of arc (wheels should swing once to one-side, then immediately rest in a straight downward position).
 - Adjust locknuts according to freedom of castor swing.
3. Test wheelchair for manoeuvrability.
4. Readjust locknuts if necessary, and repeat STEPS 1-3 until correct.
5. Snap headtube cover into the castor headtube.

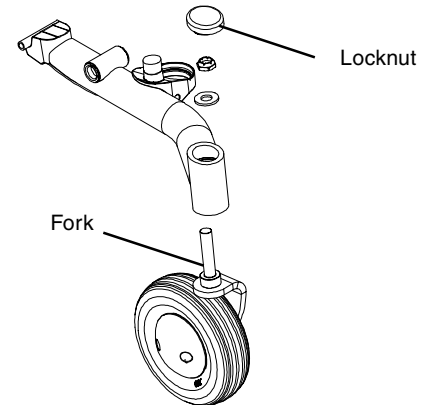

NOTE: Components exploded for clarity. There is no need to remove the fork from the base frame.

11 Controls and Operating your Power Chair

For detailed description of joystick operation, refer to the Operating Manual supplied with the joystick.



NOTE

Before you start using your power chair you must boost the battery charge by carrying out charging procedures as described in "Battery Charging" and always check the following:

1. Freewheel is engaged in drive Position.
2. Adjustments have been made to suit your individual needs and fasteners securely tightened.
3. Tyres are in good condition and correctly inflated. Or as specified on the Tyre Side Walls.
4. Check the operation of all controls (lights and indicators if fitted) and they function correctly.

11.1 Operation

When seated in your power chair, press the ON/OFF Switch. The light switch will come on and should be steady. All ten lights of the Battery Charge Indicator are also on, confirming that batteries are fully charged. In the Drive Mode Display Window a figure between 1 and 5 will appear. In Drive Mode 1 speed and acceleration are very slow. In Drive Mode 5 the power chair will reach maximum speed and acceleration. Each time you press the UP selector key you will see in the window the next higher number, and each time you press the DOWN selector key you will see the next lower figure. In this way you can select any intermediate drive mode between very low speed and acceleration and maximum speed and acceleration, whichever suits best the given conditions in which you drive and which you prefer at the time. As already indicated, the electronic controller

of your power chair is programmable. It means the way in which the power chair behaves in any of these five drive modes can be changed and adjusted according to your requirements and wishes. Contact your INVACARE supplier/dealer.

Freewheel Operation (see 10.1)

To push the power chair by hand in the event of a fault or battery failure, or simply to move it WITH NO OCCUPANT in it, the two motor/gearbox units can be declutched from the rear wheels. First ensure that power is switched OFF on the joystick box.



CAUTION

- *Freewheel operation is only intended for short-term use in SPECIAL CIRCUMSTANCES, NOT as a regular or permanent mode of power chair movement. In freewheel mode the power chair is NOT secured by the electromagnetic brakes, as both brake systems are out of action during this time.*
 - *Before you attempt to drive the chair, ensure that BOTH declutch levers are FULLY returned to normal operating position.*
-

Driving Practice

With the joystick you now control speed (within the selected Drive Mode) and direction of the power chair. The more you move it forward, the faster you travel. To reverse, pull the joystick backward. By moving the joystick left or right (while the power chair is moving forward or backward) you steer the power chair. Push the joystick full left or right, and the power chair will turn around within its smallest turning circle. To slow down, guide the joystick towards its centre (neutral) position. If you have to stop in an emergency, simply release the joystick. It will automatically snap back to neutral and the power chair will come to a smooth halt. As a last resort ONLY press the On/Off switch which

will serve as an emergency off switch. Once at a standstill, the power chair is instantly locked by the electromagnetic parking brakes, so that it is perfectly safe while it is stationary, even on an incline.

Shutdown - Parking

For security shutdown, parking indicator lighting and the adjustments of electrical options, refer to the Operating Manual supplied with the joystick.

12 Troubleshooting

The following check list is to assist you in locating and rectifying certain fault conditions. If the problem persists after you have made the checks, contact your local INVACARE supplier/dealer.

12.1 **Power chair will not drive, ON/OFF light does not come on, when ON/OFF switch is pressed.**

1. power cable from battery boxes not properly connected to power Module. Check and make proper connection.
2. Batteries completely flat. Charge batteries. If they do not accept charge, contact your local INVACARE dealer.
3. Defective power supply cable or connector, contact your local INVACARE dealer.

12.2 **Power chair pulls to one side.**

1. Check that both motor/gearbox units are fully engaged (clutch levers in normal operating position).
2. Check that BOTH front wheels (castors) turn and swivel freely.

12.3 Power chair will not drive - ON/OFF light flashing.

If the light in the ON/OFF switch on the joystick box flashes, it indicates a fault in the power chair electric/electronic system. This flashing occurs in "bursts" of flashes separated by a two second pause. The number of flashes in each of these "bursts" indicates the nature and location of the fault. Faults which affect the safety of the power chair will cause the power chair to stop, or prevent it from starting.

For further details refer to Joystick Box Operating Manual supplied with your Joystick.

13 Transportation

INVACARE always advises that a power chair secured in a vehicle will not provide the equivalent safety level and security as bespoke seating systems and recommends transfer to the vehicle seating, but also recognises that it is not always practical for the user to be transferred.

In cases where transfer is not possible then the power chair should only be secured as follows:



NOTE

Your safety during transportation, largely depends upon the diligence of the person securing the Tie-downs and passenger restraints, it is your responsibility to ensure that your power chair has been secured safely.

1. The XTERRA GT has been crash tested and has met all pass requirements of ISO7176 Part19 and is suitable for transportation with an occupant in a vehicle.
2. Seek confirmation from the Transporter that the vehicle is suitably designed, insured and equipped to transport a passenger seated in a power chair.
3. Any part of the power chair (accessories etc.) that can be easily detached should be removed and stored in the vehicle luggage hold during transportation.
4. The power chair should always be transported in a forward facing direction. Rearward facing is only acceptable if your head and back can be supported by a suitable bulkhead.
5. Invacare recommend the 4-Point Webbing Tie-Down System with Karabiner should be used to secure your chair within the vehicle, these restraints are available from Koller Engineering (based in the UK, Yeovil in Somerset).

6. When attaching the tie-downs to the power chair, it is imperative they are fixed onto the MAIN-FRAME only of the power chair and not onto any attachments or accessories (wheels, castors, footrests, armrests, anti-tipping levers etc.).
7. The Tie-Downs should be secured, as close as possible, at an angle of 45° to ensure maximum effectiveness of the restraint in all directions.
8. If your power chair has a headrest it should always be used during transportation, if not ask the transporter if a universal headrest is available that will fit onto your power chair.
9. During transportation it is essential that you are secured by three point lap and diagonal occupant restraint system, which is anchored to the vehicle wall and floor rails. power chair lap belts can be used in addition to the three point restraint system but must not be considered as an alternative to the occupant restraint system.

14 Technical Specifications

Seat Width Range:	355mm to 510mm (14 to 20in)
Seat Depth Range:	355mm to 510mm (14 to 20in)
Back Height Range:	355mm to 560mm (14 to 22in)
Back Angle Range:	80° to 115°
Seat-to-Floor (approx.):	455mm (18in) @ 3° 435mm (17in) @ 0°
Overall Width of Base:	635mm (w/o joystick) (25in)
Overall Height:	920mm (361/4in)
Overall Length:	36-1/2-inches (std) 40-inches (max.)
Weight 4-Pole Motor:	Without Batteries: 81kg (179 lbs) With Batteries: 117kg (257 lbs)
Drive Wheels/Tyres:	(Foam Filled or Pneumatic) 16 x 3in (Pneumatic - std) 16 x 3in (flat free - opt)
Battery Type:	22NF batteries
Castors w/Precision Sealed Bearings Semi-Pneumatic:	Front: 8 x 2 - inches Rear: 6 x 2 - inches

Footrests:	Telescopic Front Rigging Supports, Swing-Away (Std), Heavy Duty (Opt.), 2-in. and 4-in. longer Pivot Slide Tube (Opt), Cage
Armrests:	Flip Back, Fixed or Adjustable Height (Desk and Full Length)
A.S.B.A.* Seat Angle Adjustment:	Adjustable (0° and 3°)
A.S.B.A.* Back Angle Adjustment:	Adjustable (80° to 115° in 5° increments)
A.S.B.A.* Seat Cushion:	Cushion (Optional)
A.S.B.A.* Chair Upholstery Options:	Nylon and Vinyl.
VAN:	Cloth and Vinyl
Operating Temperature:	0 - 122 degrees F
Storage Temperature:	-10 - 152 degrees F
Kerb Climbing:	2-inches
Weight Limitations:	114kg.
Performance Rating: 114kg	Speed up to 7.5mph Range** up to 14 Miles

* A.S.B.A. Stands for Adjustable Seat and Back Angle.

**Range will vary with battery conditions, surface, terrain and operator's weight.

15 Label Locations

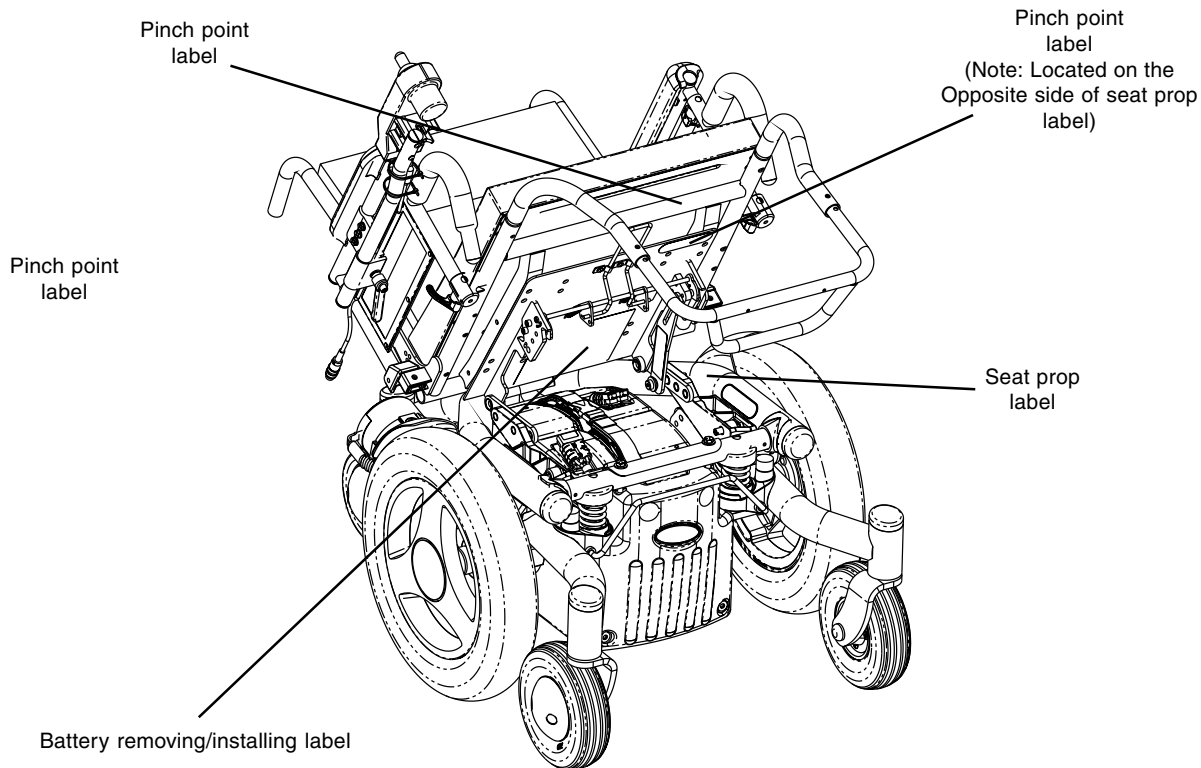

INVACARE INTERNATIONAL

Deutschland, Österreich, Switzerland: Dehmer Straße 66, D-32549 Bad Oeynhausen.

France: Les Roches, F-37230 Fondettes.

United Kingdom: South Road, Industrial Estate, Bridgend - UK - CF31 3PY.

España: c/ Areny, s/n, Polígon Industrial de Celrà, E-17460 Celrà (Girona).

Portugal: Rua Senhora de Campanhã, 105 P-4369-001 Porto.

Belgium: Autobaan 14, B-8210 Loppem, Brügge.

Denmark: Sdr. Ringvej 39, DK-2605 Brøndby.

Sweden: Fagerstagatan 9, S-163 91 Spånga.

Norge: Grensesvingen 9, Etterstad, N-0603 Oslo 6.

Nederland: Celsiusstraat 46, NL-6716 BZ Ede.

