

User Manual

Wi-Safe  **2**TM

**LOW FREQUENCY
SOUNDER**

W2-LFS-630

ABOVE ALL
FireAngel[®]

Please read me – as I could save your life.

Please retain this user manual for future reference



Wi-Safe // 2™

Keeping the hard of hearing and high risk safe from fire and carbon monoxide

For a full range of carbon monoxide alarms
visit www.fireangel.co.uk

CONTENTS

INTRODUCTION	2	PRODUCT INDICATORS (LEDS)	14
KEY FEATURES	2	WHAT TO DO IF YOUR LOW FREQUENCY SOUNDER GOES INTO ALARM.	15
INSTALLING THE LOW FREQUENCY SOUNDER	4	WHAT TO DO IN THE EVENT OF A SMOKE ALARM TRIGGERING THE LOW FREQUENCY SOUNDER	16
CONNECTING THE BATTERY/MAINS POWER	4	WHAT TO DO IN THE EVENT OF A CARBON MONOXIDE ALARM TRIGGERING THE LOW FREQUENCY SOUNDER	17
WIRELESSLY INTERLINKING THE LOW FREQUENCY SOUNDER TO YOUR WI-SAFE 2 SMOKE OR CO ALARM	6	REPAIR	18
TO REMOVE THE LOW FREQUENCY SOUNDER FROM THE WIRELESS NETWORK.	8	TROUBLESHOOTING.	19
TESTING THE LOW FREQUENCY SOUNDER WITH YOUR WI-SAFE 2 SMOKE/CO ALARMS.	8	DISPOSAL	20
POSITIONING	10	WARRANTY	20
INSTALLING THE LOW FREQUENCY SOUNDER	11	RETURNS.	21
LIMITATIONS	12	PRODUCT RANGE	21
OPERATION	12	NOTES	22
UNPLUGGING FROM THE MAINS/POWER CUT	13		

Note: This User Manual is also available in large text and other formats. Please call **0800 141 2561** for further information

INTRODUCTION

i IMPORTANT: If you are installing this product for use by others, you must leave this manual (or a copy of it) for the end user.

Wi-Safe 2 is the very latest in wireless technology from Sprue Safety Products. It provides a network of wireless radio frequency (RF) communication which can trigger Wi-Safe 2 Alert products to alarm simultaneously in the event of danger.

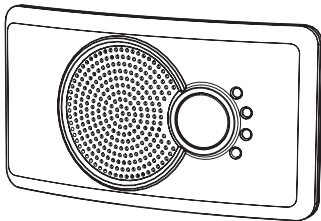

This Low Frequency Sounder, when interlinked with Wi-Safe 2 enabled Smoke alarms and/or Wi-safe 2 enabled Carbon Monoxide (CO) Alarms (purchased separately) will provide warning of danger from smoke and/or

carbon monoxide for people who may respond to a lower frequency audible sound.

The Low Frequency Sounder has been specifically designed to provide additional protection to standard smoke alarms in the event of a fire.

A low frequency signal is more likely to wake up high risk individuals such as children, those with mild to moderate hearing loss, older people and people under the influence of alcohol than a regular smoke alarm, according to research*

*Bruck, D. & Thomas, I (2007) Waking effectiveness of alarms (auditory, visual and tactile) for adults who are hard of hearing. Optimizing Fire Alarm Notification for High Risk Groups Research Project. pp.66.

KEY FEATURES

- Uses Wi-Safe 2 technology to provide warning of fire or Carbon Monoxide (CO). Wi-Safe 2 products can be interlinked to create a network, meaning if smoke or CO triggers any alarm in the network, all other networked alarms and ancillary devices activate.
- When used with Wi-Safe 2 enabled Smoke and/or CO alarms, the Low Frequency Sounder provides

additional protection when a standard high pitched sound alone may not be enough.

- Provides a simple two button press “learn in” process to wirelessly interlink with Wi-Safe 2 smoke alarms or CO alarms
- The Low Frequency Sounder provides a remote low level testing facility for testing interlinked smoke and CO alarms, avoiding the need to reach up to ceiling mounted alarms to test.
- Mains powered with rechargeable battery back-up (must be replaced after 5 years).
- The Low Frequency Sounder will detect and demonstrate a fault or low battery warning with any smoke alarm or CO alarm within the inter-linked network
- The Low Frequency Sounder is suitable for wall mounting with 2 screw fixings or free standing
- Designed for use with Smoke alarms and Carbon Monoxide alarms from the Wi-Safe 2 range (purchased separately)

Wi-Safe 2 Low Frequency Sounder Pack Contains:

1. Low Frequency Sounder
2. Plug in AC mains adaptor, 9V 2A rated output
3. Replaceable, rechargeable 5 year life battery
4. Wall fixing screws

NOTE: The Low Frequency Sounder is only compatible with Wi-Safe 2 alarms from Sprue Safety Products. It cannot be wirelessly interlinked with other models or brands of smoke alarms or carbon monoxide alarms. It is not compatible with products from FireAngel's original Wi-Safe range.

The Wi-Safe 2 product range is currently being expanded. Please visit www.fireangel.co.uk for details of the latest additions to the portfolio.

INSTALLING THE LOW FREQUENCY SOUNDER

PREPARATION: Please ensure you have read and understood this entire manual before installing your Low Frequency Sounder.

Your Low Frequency Sounder is designed to be used in conjunction with Smoke alarm(s) and CO alarm(s) from the Wi-Safe 2 range of products.

It is recommended that for optimum protection from smoke and/or carbon monoxide, one Wi-Safe 2 smoke alarm is fitted in each living room of your home, including bedrooms, and one Wi-Safe 2 CO alarm is fitted in every room containing a fossil fuel appliance, with your Low Frequency Sounder.

NOTE: Up to fifty Wi-Safe 2 enabled Smoke alarms, CO alarms and/or Wi-Safe 2 accessories can be interlinked (“learned in”) to a single network.

Ensure all smoke alarms and/or CO alarms to be used are installed, tested and working correctly as per the instructions in their respective user manuals.

CONNECTING THE BATTERY/MAINS POWER

NOTE: The Low Frequency Sounder requires both a continuously powered AC (mains) electrical supply and internal battery for its normal operation. The battery accompanying this product is rechargeable and charges when there is mains power to the Low Frequency Sounder.

1. Remove the battery cover on the back of the Low Frequency Sounder by pressing the tabs on either side of the battery cover as shown (fig 1).

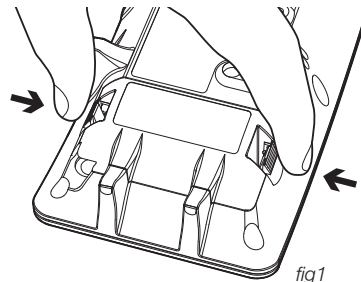

2. Connect the rechargeable battery, by aligning the terminals (red wire to red wire) and clipping the connectors together.

CAUTION: Connect the battery with mains power disconnected.

3. Place the battery into the recess. **NOTE:** The battery cable needs to be positioned underneath the battery. Place the cable into the bottom of the recess and place the battery over the top, with the battery text facing up as shown (fig 2). This will ensure that the battery is installed correctly.

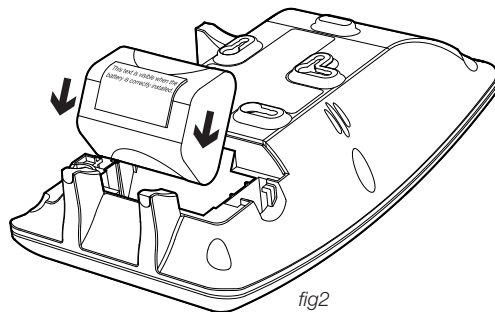

4. Assemble the power cable and adaptor by positioning the plug head as shown. Rotate onto the adaptor clockwise until it clicks into position.

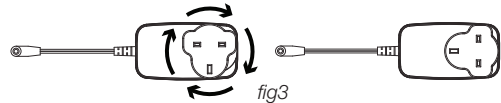

5. Plug the power cable in to the Low Frequency Sounder by fitting the cable into the connection point as shown (fig 4).

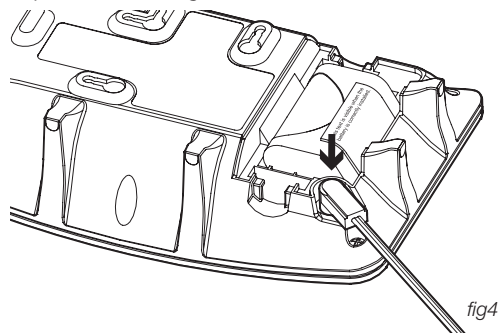

6. Replace battery cover.
7. Plug in the mains adaptor and turn the power on.
The green power LED should illuminate. Within a few seconds, the amber fault LED will be continuously illuminated; both alarm LEDs (smoke and CO) should be extinguished.

NOTE: When power is first provided to the Low Frequency Sounder, the amber fault LED and both red alarm LEDs will flash twice; the amber LED will then illuminate continuously to indicate that the unit has not been “learned in” to any network. This will typically happen when the battery is connected. If the has not retained any residual charge during shipping, it will happen when the mains power is connected. You will also see a low battery warning indication as the amber fault LED will flash once every five seconds.

WIRELESSLY INTERLINKING THE LOW FREQUENCY SOUNDER TO YOUR WI-SAFE 2 SMOKE OR CO ALARM

It is recommended that you read through these “learn in” instructions before starting.

Learning a Low Frequency Sounder into a new Wi-Safe 2 system:

1. Place one of your Smoke or CO alarms on to its baseplate. You will use this product to interlink with the Low Frequency Sounder to create a network.
2. Briefly push and release the learn button located in a circular hole in the back of the Low Frequency Sounder, using a pen, or similar as shown (fig 5).

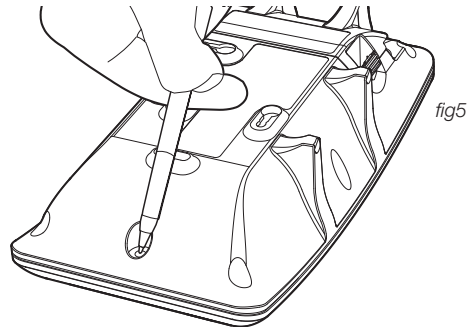

3. After pressing this button, the two Alarm (red) LEDs on the front of the unit will flash and then illuminate for 5 seconds.
4. During this period, while the red LEDs are illuminated, press the test/reset button on the Smoke or CO alarm to wirelessly interlink the two products. The Smoke alarm (or CO alarm) will emit an audible signal, and the red (Alarm) LED on the Smoke (or CO alarm) will also flash.
5. After learning in the Low Frequency Sounder into the alarms, test the units separately to ensure they are wirelessly interlinked (see below) and test again in final installed position.

Learning a Low Frequency Sounder into an existing Wi-Safe 2 system:

1. Locate a Smoke / CO alarm that is already part of the existing Wi-Safe 2 system. You will use this product when adding the Low Frequency Sounder into the network.
2. Follow steps from point 2 above.

To add any further alarms to the network, press the learn button on the new alarm then the test button on the Low Frequency Sounder, or on any alarm already learned in to the network.

NOTE: The battery is supplied in a discharged or partially discharged state and will require up to 72 hours of charging (continuous connection to the mains supply) to ensure that it is fully charged. During this period the amber fault LED may flash once every five seconds to indicate that the battery is low. The following tests however may be carried out before the charging is complete.

Further Wi-Safe 2 products (including additional Low Frequency Sounders) can be learned into the network in the same way. The learn button on the Low Frequency Sounder is located on the back of the product.

After learning in the Low Frequency Sounder into the alarms, test the units separately to ensure they are wirelessly interlinked (see below).

TO REMOVE THE LOW FREQUENCY SOUNDER FROM THE WIRELESS NETWORK

i **IMPORTANT:** If you need to remove (“unlearn”) the Low Frequency Sounder from the wireless network, eg for house alterations, or to dispose of the unit it is important to follow the instructions below to “unlearn” the unit from the wireless network. Failure to do so means that the network continues to try and communicate with the removed unit, and will result in a system fault.

1. Briefly push and release the learn button located in the circular hole in the back of the Low Frequency Sounder using a ball point pen or similar as shown (fig 5). The two red alarm LEDs on the front of the Low Frequency Sounder will illuminate as you push the button.
2. Push and hold the learn button a second time. The red alarm LEDs will illuminate. Hold the button until the red alarm LEDs extinguish.
3. The red alarm LEDs will then perform a sequence

of two long and three short flashes. The amber fault LED will illuminate to confirm that the Low Frequency Sounder is no longer interlinked to the wireless network.

4. Press the test button on the Low Frequency Sounder. It should not cause other Wi-Safe 2 alarms to sound. However, if the Low Frequency Sounder is still interlinked, repeat the above procedure.

TESTING THE LOW FREQUENCY SOUNDER WITH YOUR WI-SAFE 2 SMOKE/CO ALARMS

Testing the network from the Smoke Alarm or CO alarm

Briefly press the test button on the smoke alarm or CO alarm and release (fig 6) . The alarm will give an audible sound (consisting of 2 cycles of 3 loud beeps on the smoke alarms, 2 cycles of 4 rapid beeps on CO alarms), then stop automatically. The red alarm LED on the alarm will flash rapidly during the audible signal. Any other wirelessly interlinked alarms which are also part of the network will also give an audible alarm then stop automatically.

fig6

The Low Frequency Sounder will sound the same pattern as the alarm being tested and the corresponding alarm LED (smoke or CO) will flash during the test.

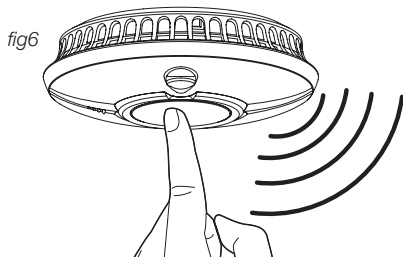

Repeat the procedure with all alarms in the wireless network.

Testing the network from the Low Frequency Sounder

Briefly press the test button on the Low Frequency Sounder and release. The Low Frequency Sounder will sound a pattern of 2 cycles of 3 loud beeps and both alarm LEDs (smoke and CO) will flash. At the same time any alarm that is wirelessly interlinked (learned in) to the network will also sound, the sound pattern on each

alarm corresponding to its type (smoke or CO – see previous section). The Low Frequency Sounder will be activated for the length of time that the alarms sound (2 cycles of 3 beeps).

This confirms that the units are wirelessly interlinked.

Weekly Testing

It is recommended that a self-test of all the units in your Wi-Safe 2 network is carried out weekly.

In addition the network should also be tested whenever:

- An additional alarm or ancillary product is added to the system
- There are changes to the structure of your property
- There are significant changes in the position of large items of furniture or electrical products in your home
- You replace the battery in any product within the Wi-Safe 2 network.

The Low Frequency Sounder is now ready to be placed into position.

If you are testing the Low Frequency Sounder for the first time during installation and it does not test, please repeat the “learn in” procedure.

If you are unable to resolve the problem please contact Technical Support on **0800 141 2561**.

The Low Frequency Sounder is independently tested as being compliant with the applicable British and European standards. However, as with any electronic product, it could fail and may not produce an indication of smoke or CO within sufficient time to alert you of the danger and provide adequate time for your escape. In order to maximise your level of safety, always test your Low Frequency Sounder and all alarms in the Wi-Safe 2 network system every week to ensure the whole system is in full working order and that the wireless interlink (RF) between the alarms and ancillary products has not been compromised.

NOTE: The Low Frequency Sounder, smoke and CO alarms should not be considered as a substitute for life or property insurance. The Low Frequency Sounder should be replaced immediately in the event of failure, and the rechargeable battery should be replaced every 5 years.

POSITIONING

Where should the Low Frequency Sounder be installed?

If you have one Low Frequency Sounder, it should be installed in the main room where you sleep. You may wirelessly interlink additional Low Frequency Sounders to the network and install them in any room where you may need to be alerted in the event of an alarm. It is important that if you install additional Low Frequency Sounders you test each of these upon installation to check they are “learned in” to the rest of the network.

Wireless Range: The wireless range of Wi-Safe 2 products is over 200 metres in clear air/clear line of sight. However it is recommended not to exceed 35m as the maximum distance between any interlinked Wi-Safe 2 smoke alarm or carbon monoxide alarm from the Low Frequency Sounder. This is because the range can be reduced by walls, and other obstructions in the building.

Position the Low Frequency Sounder:

- Close to a power socket where it can be easily plugged in and the cable does not create a tripping hazard.
- Where you can see the LEDs on the front of the unit.

NOTE: the Low Frequency Sounder can be fitted to a wall or placed on a shelf or table.

i CAUTION: Do not put the Low Frequency Sounder

- Outside the building
- In a cupboard
- In a damp or humid area
- In an area where the temperature could regularly drop below -5°C or rise above 40°C
- Anywhere where the unit can easily be knocked or damaged

INSTALLING THE LOW FREQUENCY SOUNDER

We recommend wall mounting the Low Frequency Sounder. To do this, drill two suitably sized holes 37mm apart, centre to centre, using the template (fig 7). Warning: Make sure that you check for electrical cabling and pipework hidden in the wall before carrying out any drilling). In the pack you will find two screws and two screw anchors. Push the screw anchors (if needed) into

the drill holes and secure the screw leaving the heads protruding so that the face of the head is 5mm away from the wall. Now hook the Low Frequency Sounder onto the screws (fig 8).

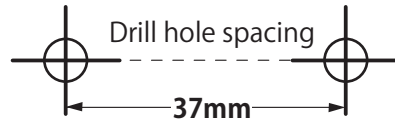

fig7

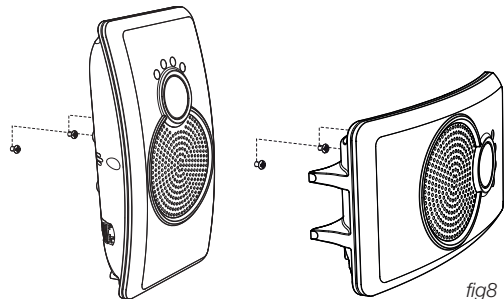

fig8

If placing the Low Frequency Sounder on a table or shelf instead of mounting on the wall, make sure it cannot easily be knocked or slide off. Once plugged in, the green “power” LED should illuminate continuously to show that the AC power supply is connected.

LIMITATIONS

NOTE: This Low Frequency Sounder is not compatible with products from the original Wi-Safe product range.

- The Low Frequency Sounder will not operate in isolation, with non Wi-Safe 2 Alarms, or any alarms made by other manufacturers.
- The Low Frequency Sounder may not respond to the signal from the Wi-Safe 2 alarm if the alarm and the Low Frequency Sounder are too far apart (see “Positioning”).
- The Low Frequency Sounder may not respond to the signal from the Wi-Safe 2 alarm if there are obstructions that significantly reduce the signal (eg: steel reinforcement in concrete). Always test the operation of the Low Frequency Sounder with all other alarms and units in the network after any changes to

the building structure or in the position of large items of furniture.

DANGER: Under no circumstances should this product be immersed in water, or used in an area where water may come into contact with the product.

OPERATION

1. Standby Mode, but not “learned in” to a network.

The amber (fault) LED will be illuminated.

2. Standby mode

The Low Frequency Sounder should be connected to the mains AC supply and placed in a suitable position. The Green “power” LED on the Low Frequency Sounder will be permanently illuminated.

3. Alarm mode

When a Wi-Safe smoke or CO alarm goes into “alarm” mode the RESPECTIVE red alarm LED will flash rapidly and the Low Frequency Sounder will sound as follows:

- Red ‘smoke’ LED & repeated cycles of 3 loud beeps – SMOKE
- Red ‘CO’ LED & repeated cycles of 4 rapid beeps – CO

- Both red LEDs flashing rapidly and repeated cycles of 3 loud beeps – SMOKE and CO

NOTE: The Low Frequency Sounder will silence and the red alarm LED will cease to flash when the alarm sending the signal has been reset or has stopped if the danger is no longer present.

Only reset an alarm if you are certain there is no imminent danger from Fire or Carbon Monoxide.

Locate Feature:

When the network is in alarm mode, pressing the test button on any unit in the network will silence all other alarms in the network, for a period of 2 minutes, **except the alarm that has sensed smoke or carbon monoxide.** This will enable the instigating alarm to be identified/located. If necessary, the instigating alarm can then be silenced.

UNPLUGGING FROM THE MAINS/POWER CUT

The Low Frequency Sounder is designed to be mains powered. The internal rechargeable battery will still provide power if the mains fails. A fully charged battery

will allow the Low Frequency Sounder to continue to operate for three days. NB Only use the battery supplied in the pack or a genuine FireAngel replacement. Other batteries may damage the equipment or create a safety hazard.

WARNING: When the mains power is disconnected, the green power LED will no longer illuminate. Plug the Low Frequency Sounder back into the mains as soon as possible to recharge the battery and maintain correct operation.

If the amber (fault) LED is flashing once every 5 seconds when the green power LED is off then URGENTLY restore power to the unit as the battery status is very low, and may fail to operate in an alarm situation.

NOTE: Once the Low Frequency Sounder is plugged back into the mains, the amber (fault) LED will continue to flash once every 5 seconds until the battery has fully recharged.

PRODUCT INDICATORS (LEDS)

STATUS	LOW FREQUENCY SOUNDER ACTIVITY	POWER GREEN	SMOKE RED	FAULT AMBER	CO RED	ACTION NEEDED
Standby mode		Illuminated				None required
Mains not connected or on battery power						Reconnect Low Frequency Sounder to mains power
Mains not connected and battery capacity low or battery missing				Flashing once every 5 secs		URGENTLY restore power to unit as battery status is very low.
Alarm mode Smoke	Low Frequency Sounder sounding	Illuminated	Flashing			Alarm – fire - evacuate property
Alarm mode CO	Low Frequency Sounder sounding	Illuminated			Flashing	Alarm – CO – Open windows and evacuate property

STATUS	LOW FREQUENCY SOUNDER ACTIVITY	POWER GREEN	SMOKE RED	FAULT AMBER	CO RED	ACTION NEEDED
Network Fault Eg low battery in remote alarm, missing alarm etc.				Double flash once per second		Ensure every alarm and WiSafe 2 device is fitted correctly and working
Not learned in				Illuminated		Follow learn in procedure
Powering up			Double flash (not repeated)	Double flash (not repeated)	Double flash (not repeated)	None required

WHAT TO DO IF YOUR LOW FREQUENCY SOUNDER GOES INTO ALARM

CAUTION: In all circumstances assume your Low Frequency Sounder is responding to a real alarm situation that has been triggered by either a smoke alarm or carbon monoxide alarm.

The type of incident triggering the Low Frequency Sounder to go into alarm is indicated on the unit itself:

Smoke Alert

The Smoke (red) LED will flash

Carbon Monoxide Alert

The CO (red) LED will flash

Smoke and CO Alert

The Smoke LED (red) will flash

WHAT TO DO IN THE EVENT OF A SMOKE ALARM TRIGGERING THE LOW FREQUENCY SOUNDER

What to do in Case of Fire in your Home

If you have made a family escape plan and practiced it with your family, you have increased their chances of escaping safely. Go over the following rules with your children each time you have a fire drill. This will help everyone remember them in case of a real emergency.

- Don't panic; stay calm. Your safe escape may depend on thinking clearly and remembering what you have practiced.
- Notify every member in the residence of the fire.
- Get out of the house as quickly as possible. Follow a planned escape route. Do not stop to collect anything or to get dressed.
- Feel the doors to see if they are hot. If they are hot, do not open them - use an alternative escape route.
- Stay close to the floor. Smoke and hot gases rise.
- Cover your nose and mouth with a cloth (wet if possible). Take short, shallow breaths.

- Keep doors and windows closed. Open them only if you have to in order to escape.
- Meet at your planned meeting place after leaving the house. Carry out a head count.
- Call the fire service on 999 as soon as possible from outside your house. If possible use a neighbour's phone or call box rather than a mobile phone (as the location can be traced from the number if the line is lost).
- Give the address and your name.
- Never go back inside the building until a member of the fire service has told you it is safe to do so. If after proceeding with extreme caution you have been able to confirm that your Low Frequency Sounder was triggered by a nuisance alarm (which may occur from time to time from cooking or other non-emergency situations) you should silence the smoke alarm that has been triggered. This will silence the Low Frequency Sounder. It is important to practice escape plans and show everyone in the house, including children, what to do in the event of an alarm.

Contact your local fire service. They will give you more ideas about how to make your home safer from fires and how to plan your family's escape.

WHAT TO DO IN THE EVENT OF A CARBON MONOXIDE ALARM TRIGGERING THE LOW FREQUENCY SOUNDER

ASSUME CARBON MONOXIDE HAS BEEN DETECTED IN YOUR HOME

WARNING: A loud alarm is a warning that unusually high and potentially lethal levels of carbon monoxide are present. Never ignore this alarm; further exposure could be fatal. Immediately check residents for symptoms of carbon monoxide poisoning, (see product manual) and contact the proper authorities to resolve all CO problems.

NEVER IGNORE ANY ALARM.

What to do during an alarm:

- Keep calm and open the doors and windows to ventilate the property
- Stop using all fuel burning appliances and ensure, if possible, that they are turned off
- Evacuate the property leaving the doors and windows open
- Ring your gas or other fuel supplier on their emergency number; keep the number in a prominent place
- Do not re-enter the property until the alarm has stopped. When exposed to fresh air it can take up to 10 minutes for the sensor to clear and the alarm to stop depending on the level of carbon monoxide detected
- Get medical help immediately for anyone suffering the effects of carbon monoxide poisoning (headache, nausea, drowsiness), and advise that carbon monoxide poisoning is suspected
- Do not use the appliances again until they have been checked by an expert. Contact a Gas Safe registered engineer in the case of a gas appliance.

REPAIR

WARNING: DO NOT attempt to repair your Low Frequency Sounder.

Your Wi-Safe 2 Low Frequency Sounder is a sealed AC electrical device, and no attempt should be made to open the casing on any part of the system. Attempting to open the any case will:

- Damage your system
- Possibly result in exposure to a potentially lethal electric shock
- Impair its operation
- Invalidate your warranty

If your Wi-Safe 2 Low Frequency Sounder is not working correctly and you are unable to resolve the problem after consulting the “Troubleshooting” section, please contact Technical Support.

The battery provided has been chosen specifically for this application, but will need to be replaced every 5 years under normal operating conditions. If during normal operation (ie connected to the mains supply for at least 72 hours) the amber fault LED flashes once every 5 seconds while the green power LED is illuminated, contact Technical Support for advice on 0800 141 2561.

 **IMPORTANT:** Do not replace with any other type of battery. Replacement batteries are available from Technical Support call 0800 141 2561.

TROUBLESHOOTING

<p>The Low Frequency Sounder is connected to the Power Supply but the Power (green) LED is not illuminated</p>	<p>Check the power supply is plugged in and switched on at a working power socket</p>
<p>The Fault (amber) LED flashes once every 5 seconds continuously</p>	<p>Urgently restore mains power to the Low Frequency Sounder unit. If the Low Frequency Sounder is plugged in to the mains supply and has been switched on for at least 72 hours, the battery may be faulty. Call Technical Support on 0800 141 2561</p>
<p>The power (green) LED is illuminated, and the Fault (amber) LED is also continuously lit</p>	<p>The Low Frequency Sounder is not interlinked ("learned in") to the rest of the network. If you have learned in the unit and this is happening regularly, call Technical Support, on 0800 141 2561</p>
<p>The Low Frequency Sounder does not respond to a smoke or CO alarm that is being tested.</p>	<p>Check that the alarm and the Low Frequency Sounder have been interlinked ("learned in") correctly. Check that all the units in the network are in range (see "Positioning" page 10). If the Low Frequency Sounder still fails to respond, call Technical Support on 0800 141 2561.</p>
<p>The Fault (amber) LED double flashes, rapidly once per second</p>	<p>One or more alarms in the network is missing, faulty or disabled (removed from its base).</p>

DISPOSAL



Waste electrical products should not be disposed of with regular household waste. Your Low Frequency Sounder should be disposed of in line with the waste electronic and electrical equipment (WEEE) regulations. Please recycle where facilities exist. Check with your local authority, retailer or contact our technical support team for recycling/disposal advice as regional variations apply. If the rest of the network remains in situ, you must “Unlearn” the Low Frequency Sounder from its wireless network (see page 8) and disconnect the battery within the Low Frequency Sounder before disposal. Failure to do so will result in a system fault.

WARNING: DO NOT ATTEMPT TO OPEN. DO NOT BURN.

WARRANTY

Sprue Safety Products Ltd warrants to the original purchaser that its enclosed Low Frequency Sounder (W2-LFS-630) be free from defects in materials and workmanship under normal residential use and service for a period of 5 (five) years from the date of purchase. Provided it is returned with postage prepaid

and proof of purchase date, Sprue Safety Products Ltd hereby warrants that during the 5 (five) year period commencing from the date of purchase Sprue Safety Products Ltd, at its discretion, agrees to replace the unit free of charge. The warranty on any replacement W2-LFS-630 will last for the remainder of the period of the original warranty in respect of the product originally purchased – that is from the date of original purchase and not from the date of receipt of the replacement product. Sprue Safety Products Ltd reserves the right to offer an alternative product similar to that being replaced if the original model is no longer available or in stock. This warranty applies to the original retail purchaser from the date of original retail purchase and is not transferable. Proof of purchase is required.

This warranty does not cover damage resulting from accident, misuse, disassembly, abuse or lack of reasonable care of the product, or applications not in accordance with the user manual. It does not cover events and conditions outside of Sprue Safety Products Ltd’s control, such as Acts of God (fire, severe weather etc.). It does not apply to retail stores, service centres or any distributors or agents. Sprue Safety Products Ltd will not recognise any changes to this warranty by third parties.

Sprue Safety Products Ltd shall not be liable for any incidental or consequential damages caused by the breach of any expressed or implied warranty. Except to the extent prohibited by applicable law, any implied warranty of merchantability or fitness for a particular purpose is limited in duration for 5 (five) years. This warranty does not affect your statutory rights. Except for death or personal injury, Sprue Safety Products Ltd shall not be liable for any loss of use, damage, cost or expense relating to this product or for any indirect or consequential loss, damages or costs incurred by you or any other user of this product.

RETURNS

We recommend that you contact the FireAngel Technical Support Line in the first instance on **0800 141 2561**, text phone users dial **18001 0800 141 2561** or callers from EIRE dial **1-800 523171**. We may be able to remedy the problem quickly over the phone (this is to prevent unnecessary returns that take a longer time to process). Alternatively e-mail: **technicalsupport@fireangel.co.uk**.

If there is a fault that we are unable to resolve then our technical support team member will provide you with a returns authority number so that your product can be returned for testing. To return your FireAngel Low Frequency Sounder under warranty, send it suitably packed with the battery disconnected with postage prepaid; a note indicating the returns authority number and describing the reason for return, with proof of purchase to:

Sprue Safety Products Ltd.
Vanguard Centre
Sir William Lyons Road
Coventry
CV4 7EZ
UK

PRODUCT RANGE

Sprue Safety Products Ltd. manufactures an extensive range of home safety products including smoke alarms, carbon monoxide alarms, fire extinguishers and remote sounding devices.

For more details visit **www.sprue.com**

NOTES

Technical Support Line

0800 141 2561

UK Textphone users dial **18001 0800 141 2561**

EIRE dial **1-800 523171**

Email

technicalsupport@fireangel.co.uk

Web

www.fireangel.co.uk



W2-LFS-630



A Sprue Safety Products Brand

Sprue Safety Products Ltd.

Vanguard Centre, Sir William Lyons Road, Coventry CV4 7EZ UK

GN2465/R2