

AUTOMATIC URINAL FLUSHER

USER

MANUAL

Characteristic

Sensor Urinal Flusher

1. 4AA alkaline batteries lasts for 2 years based on 300 cycles per day.
2. It can do the flush automatic each 24 hours.
3. Saving water 30 % than the old type.
4. The flushing water quantity can adjust by itself.
5. The inductive distance could adjust according to the environment.
6. Low battery power indication.

Model & Technical Data

Model	
Power	DC6V(4AA alkaline batteries)
Power	5W when flushing Lasts 2years(100cycles/day)
Flushing Time	Flushing 2S before and 6S after the urinal.
Water Pressure	Lowest water pressure is 0.05MPa Highest water pressure is 0.6MPa
Inductive Distance	The inductive distance could be adjusted according to the environment Factory set 65cm
Inductive time	3seconds
Ambient Temperature	0.1 ~ 45 °C
Inlet pipe dia.	G1/2"



Please do not use the sensor within 10 seconds after the installation. Or it will cause the inductive distance change and it takes about 5-6 minutes to recover by itself. The flusher could not effective at the first time because of the inductive distance change and it will be in goog position in 5 minutes

Parts Name

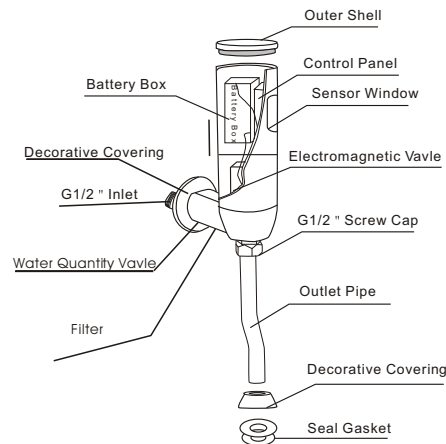

Installation Diagram

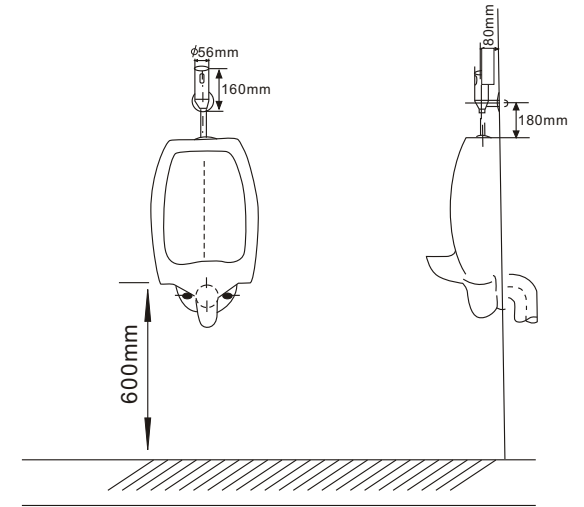

Installation Step

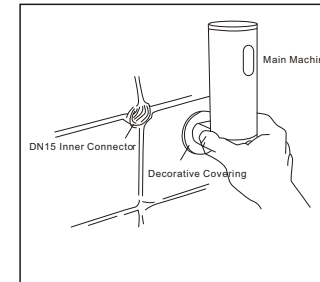

Install the main machine to inner connector

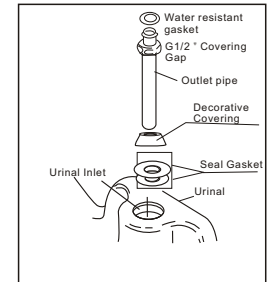

Please do the installation as the above diagram

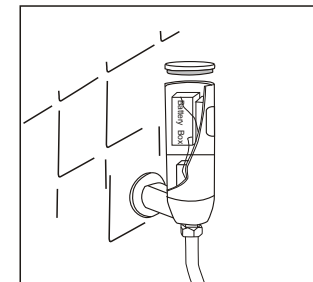

Please open the covering after the installation and take the battery box our then install the battery. Please take care the anode/cathode

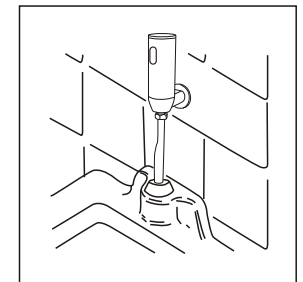

The correct installation diagram

User Manual

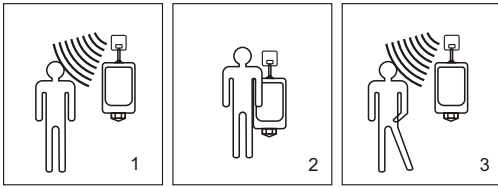

Flushing 2S before and 6S after the urinal.

Intelligent flush way :

1. Inductive time is 3S.
2. Normal position:
Flushing 2S before and 6S after the urinal.

- A. The second flushing time will be 2S if the urinal time within 10seconds.
B. The second flushing time will be 6s if the urinal time more than 10S.

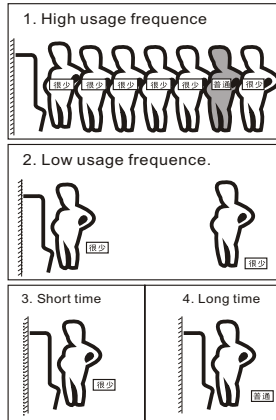

Maintenance

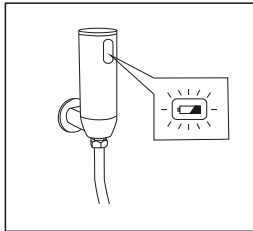

Inductive indication, low power indication
1.The light will flash in normal condition.
2.The sensor will out of service if the power is not enough and the light is on.

Change Battery: Open covering and take the battery box out then install new battery. Please do not use the battery with different brand.

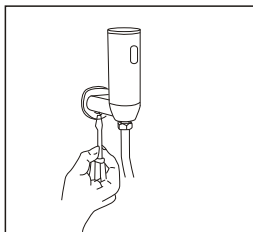

Maintenance

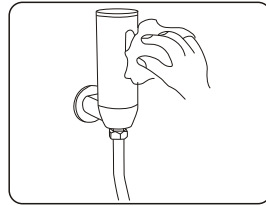

Please clean the inductive window with soft cloth after the installation.

Attention: The uncleaned inductive window will affect the inductive distance.

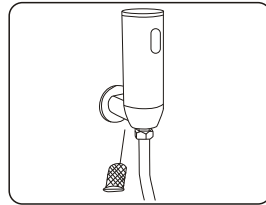

Clean the filter:
Please clean the filter if the outlet water is becoming small.

★ Attention: please close the valve before you take out the filter.

Attentions:

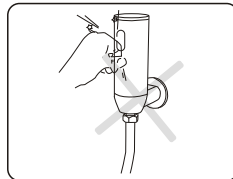

Please do not collapse to prevent the inductive problem.

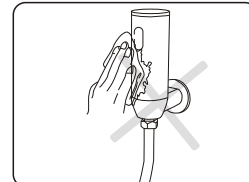

Please do not clean it by water

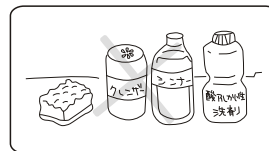

Please do not clean it by acid or alkali scour

Problem Elimination

Phenomenon	Trouble reason	Elimination
Not flush	Batteries Power-out(DC mode products)	Change new ones
	Power cut(AC mode products)	Await power supply
	Power supply trouble(AC mode products)	check power supply case
	No water	Await water
	Too dirty for strainer	clean strainer
	Dirt or other object on sensor display	clean dirt or move object
Not closed	water pressure not under range	re-designing as per specification
	batteries power-out(DC mode products)	change new batteries
	power cut (AC mode products)	Await power supply
	power supply trouble(AC mode products)	Check power supply case
	water pressure not under range	re-design as per specification
	Detection distance is self-adjusted from far to near	await 1 to 2 minutes
Little water after closed	lower water pressure	re-design as per specification
	Too dirty for strainer	clean strainer
Too small water flux	adjust too small flux	Adjust water control valve
	too dirty for strainer	clean strainer
	too lower water pressure	re-design as per specification
Too large water flux	adjust too large flux	adjust water control valve
Short for battery' s span life	Not use alkaline battery or use fake of battery (DC mode Products)	change specified battery