

# USER MANUAL



## Indoor/Outdoor IR Mini Vandal Dome

ELI-VDM ELI-VDM-IR



*[eLineTechnology.com](http://eLineTechnology.com)*

## Table of Contents

<b>PRODUCT DESCRIPTION .....</b>	<b>3</b>
<b>FEATURES.....</b>	<b>3</b>
<b>MODELS.....</b>	<b>3</b>
<b>SAFETY INFORMATION.....</b>	<b>3</b>
<b>FCC STATEMENT.....</b>	<b>4</b>
<b>PRODUCT COMPONENTS .....</b>	<b>4</b>
<b>BOX CONTENTS .....</b>	<b>4</b>
<b>ADDITIONAL MATERIALS NEEDED FOR INSTALLATION.....</b>	<b>5</b>
<b>PRODUCT DIAGRAMS.....</b>	<b>5</b>
<b>INSTALLATION .....</b>	<b>5</b>
<b>MOUNTING .....</b>	<b>5</b>
<b>ADJUSTING THE LENS .....</b>	<b>6</b>
<b>CONNECTIONS .....</b>	<b>7</b>
<b>SPECIFICATIONS.....</b>	<b>8</b>
<b>TROUBLESHOOTING.....</b>	<b>8</b>
<b>WARRANTY REPAIR/REPLACEMENTS .....</b>	<b>9</b>

© 2012 eLine. All rights reserved. eLine provides no warranty with regard to this manual and reserves the right to make any modification to this manual without notice.

## Product Description

### *Indoor/Outdoor IR Mini Vandal Dome*

Congratulations on your purchase of this product. This analog surveillance dome features advanced functions in a compact body and is suited for tight, indoor or outdoor environments. The camera utilizes advanced Sony image sensor technology producing high definition, realistic color.

### Features

- Indoor/outdoor vandal dome housing rated IP66
- Mini housing measures only 82.4mm diameter
- Digital Noise Reduction and Digital Wide Dynamic Range
- Use Gimbal Bracket or Flush Mount with Surface Base
- Infrared model features LEDs for night vision, 10M range
- 3-Axis bracket for versatile positioning of the lens
- 12V DC

### Models

Model Number	Resolution	Lens	Features
ELI-VDM-60-4	600 TVL	3.6mm Fixed	DNR, DWDR
ELI-VDM-60-4IR	600 TVL	3.6mm Fixed	10M IR Range, DNR, DWDR

## Safety Information

1. Read these instructions.
2. Heed all warnings.
3. Follow all instructions.
4. Clean only with dry cloth.
5. Do not block any ventilation openings.
6. Do not install near any heat sources such as radiators, heat registers, stoves, or other apparatus (including amplifiers) that produce heat.
7. Only use attachments/accessories specified by the manufacturer.
8. Pay attention to the power requirements.
9. Stop operation immediately when something is wrong with the product. If smoke or the smell of smoke comes from the product, continued use will result in fire, injury, or damage to the product.
10. Turn the power off immediately and contact qualified service personnel for service.
11. Be sure to turn off the power before wiring. Failure to observe this may cause electric shock. A short circuit or wrong wiring may cause fire.
12. This product has no power switch. Turn the power off when cleaning the product.
13. When continuously viewing a bright light source such as a spotlight, the color filter of the CCD may have deteriorated and it may cause discoloration. Even when changing the fixed viewing direction after continuously viewing a spotlight for a certain period, the discoloration may remain.
14. Keep the camera cable away from the lighting cable. Failure to observe this may cause noise.

15. When the camera is used near a TV/radio antenna, strong electric field, or magnetic field (near a motor or a transformer), images may be distorted and audible noise may be produced. In such a case, route the camera cable through specialized steel conduit tubes.

**CAUTION: TO REDUCE THE RISK OF ELECTRIC SHOCK, DO NOT REMOVE COVER (OR BACK). NO USER SERVICEABLE PARTS INSIDE. REFER SERVICING TO QUALIFIED SERVICE PERSONNEL.**

## FCC Statement

THIS DEVICE COMPLIES WITH PART 15 OF THE FCC RULES. OPERATION IS SUBJECT TO THE FOLLOWING TWO CONDITIONS:

1. THIS DEVICE MAY NOT CAUSE HARMFUL INTERFERENCE, AND
2. THIS DEVICE MUST ACCEPT ANY INTERFERENCE RECEIVED, INCLUDING INTERFERENCE THAT MAY CAUSE UNDESIRE OPERATION.

This equipment generates and uses radio frequency energy, and if not installed and used properly, that is, in strict accordance with the manufacturer's instructions, it may cause interference to radio and television reception. It has been type tested and found to comply with the limits for remote control devices in accordance with the specifications in Sub-Parts B and C of Part 15 of FCC Rules, which are designed to provide reasonable protection against such interference in a residential installation.

However, there is no guarantee that interference will not occur in a particular installation. If this equipment does cause interference to radio or television reception, which can be determined by unplugging the equipment, try to correct the interference by one or more of the following measures.

- Reorient the antenna of the radio/TV experiencing the interference.
- Relocate the equipment with respect to the radio/TV.
- Move the equipment away from the radio/TV.
- Plug the equipment into an outlet on a different electrical circuit from the radio/TV experiencing the interference.

If necessary, consult your local dealer for additional suggestions.

NOTE: Modifications to this product will void the user's authority to operate this equipment.

## Product Components

### Box Contents

- Dome Camera
- Mounting Base
- Quick Installation Guide
- Mounting Screws and Allen Wrench



## Additional Materials Needed for Installation

- Tape for protecting connections
- Power supply 12VDC 350mA

## Product Diagrams

### Surface Mount

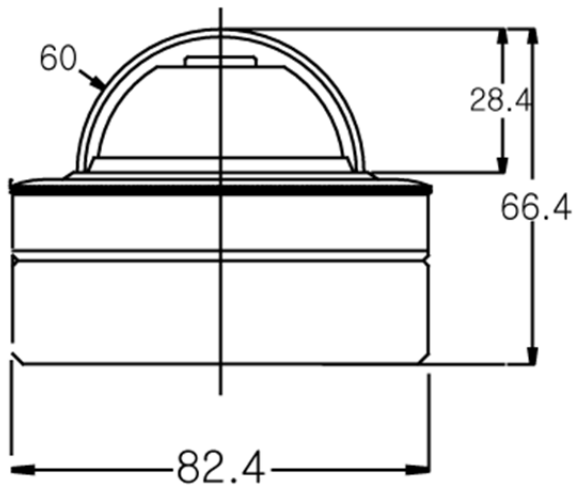

### Flush Mount

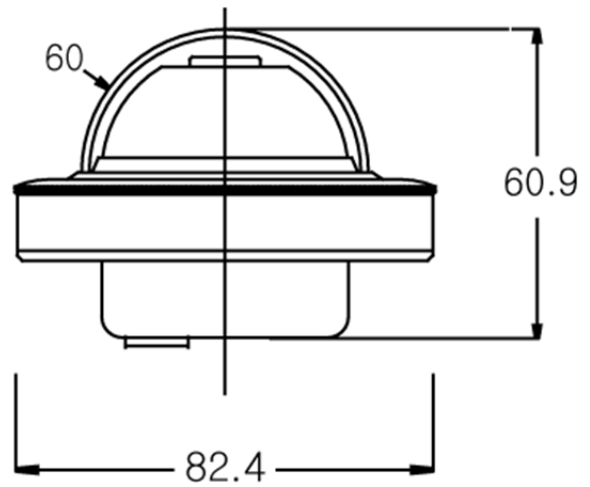

## Installation

### Mounting

1. Optional: Attach the surface mount bracket to the ceiling or wall with screws.

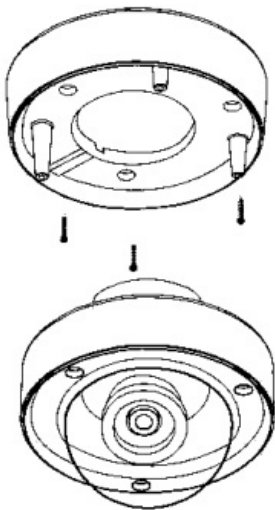

2. Make connections through the opening in the wall or ceiling. (See connection instructions below)

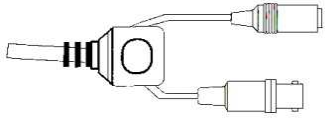

3. Attach the camera with screws to the optional surface mount bracket or directly to the wall or ceiling. Attach the threaded dome cover by rotating it clockwise until tight.

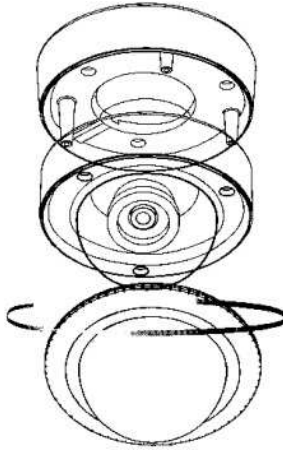

4. Secure the dome cover to the camera by tightening the lock screw with an Allen wrench.

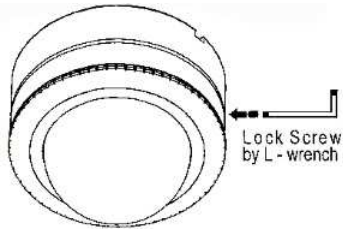

**Caution:** Once power is supplied, do not remove the camera from the mounting base due to risk of electrical shock.

### Adjusting the Lens

1. Loosen the lock screw with an Allen wrench.
2. Remove the dome cover by unscrewing it counter-clockwise.
3. Loosen the two Phillips-head screws on each side of the camera.



4. Adjust lens position. Tighten screws. Replace dome cover. Tighten lock screw.

## Connections

1. Use a BNC connector to connect the camera's VIDEO OUT to the monitor's (or DVRs) VIDEO IN.  
Use the following recommendations for cable types and distances:

Maximum Cable Length				
Type of Coaxial Cable	RG-59/U	RG-6/U	RG-11/U	RG-15/U
Recommended Max	250 M	500 M	600 M	800 M
Cable Length	825 ft	1650 ft	1980 ft	2640 ft

2. The power is DC 12V (+/- 10%) / 350mA. Use the following recommendations for cable types and distances:

12V DC Recommended Wire Size and Resistance (68°F)				
Copper Wire Size (AWG)	#24 (0.22 mm <sup>2</sup> )	#22 (0.33 mm <sup>2</sup> )	#20 (0.52 mm <sup>2</sup> )	#18 (0.83 mm <sup>2</sup> )
Resistance (Ω/m)	0.078	0.050	0.03	0.018
Resistance (Ω/ft)	0.024	0.015	0.009	0.005

Use the formula below to calculate the power cord and power supply. "L", "R", "VA", "I" shall satisfy the inequality below:  
 $10.8 \text{ V DC} \leq \text{VA} - 2 (R \times I \times L) \leq 16 \text{ V DC}$   
 L = Cord length (m or ft)  
 R = Resistance of copper wire (Ω/m or Ω/ft) VA = DC output voltage of power supply unit  
 I = DC current consumption (A).

3. Connect power supply to the camera's POWER IN terminal.

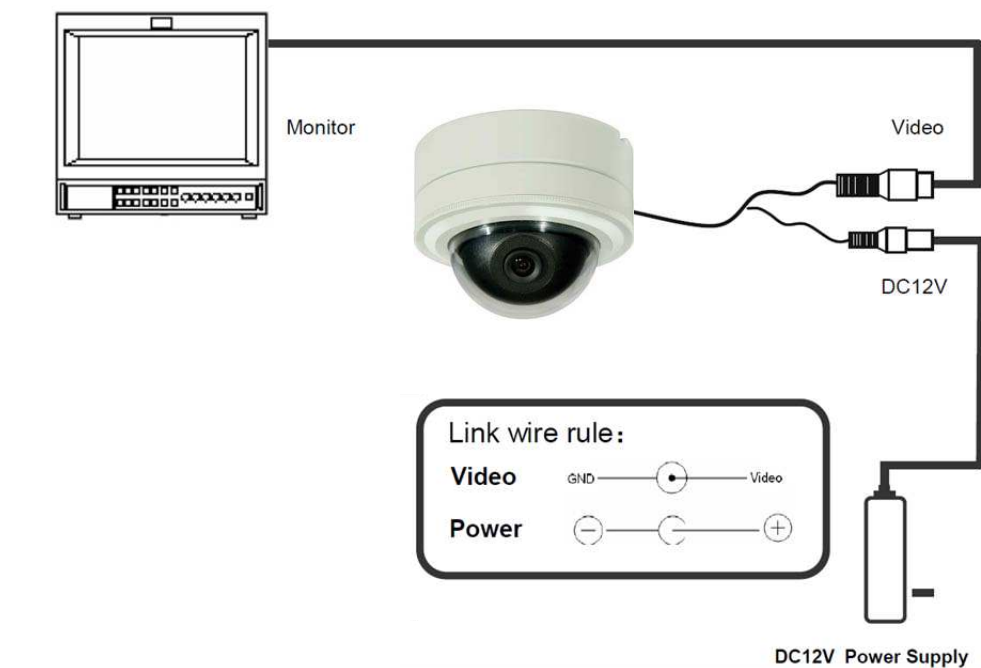

## Specifications

Feature	Specification
Sensor	1/3" Sony Super HAD II CCD
Horizontal Resolution	600 TV Lines
Effective Pixels	NTSC: 768 x 494; PAL: 752 x 582
S/N Ratio	More than 50 dB
Minimum Sensitivity	0.1 Lux at F:1.4
Gamma Correction	0.45 Approx.
Gain Control	Automatic
Video Output	Composite Video 1.0Vp-p 75 Ohm
Lens	Fixed 3.6mm Lens
Operating Temperature	-10 C ~ +50 C
Power Source	12VDC 300mA
Power Consumption	3.0W
Dimension	Flush Mount: 61 x 82.4mm Surface Mount: 66.4 x 82.4mm
Weight	400g

## Troubleshooting

### *No picture after providing power*

- Check the power connection to the power supply to the power outlet for connectivity.
- Check the power supply voltage.
- Check all connecting cable and monitors for loose connections.
- Check the monitor settings

### *The picture has interference or ripples*

- This may be caused by the power supply's arc, poor quality cable, too long cable, or improper ground connection.

### *The picture background color changes continuously*

- A fluorescent light's electromagnetic field may cause color roll. Reduce the number of fluorescent lights or increase the distance between the camera and the lights to reduce this effect. Use of a power supply with external sync may solve the problem.

### *Blurred Image*

- Check the dome cover for dirt or imperfections
- Check the focus to make sure adjusted correctly
- Check the lens of the camera to make sure it is clean. Only use a dry, clean lens cloth to clean the lens. Never touch with your fingers.



## Warranty Repair/Replacements

Subject to the terms of the limited warranty in effect at the time of purchase, e-Line will repair or replace a product that fails to meet the terms provided, within the product's warranty period. eLine reserves the right to replace any product under warranty with new, refurbished or remanufactured product. For product purchased directly from eLine by a dealer or an integrator, the warranty period starts from either a) the date of shipment from eLine's facility (point of origin) or b) the manufacturer's date code (if the shipment date is unknown). Except for software products (which shall be treated as if purchased directly e-Line for purposes of determining the start of the warranty period as set forth in the immediately preceding sentence), for product purchased from an authorized eLine distributor by a dealer or an integrator, the warranty period starts from the date the product is purchased by the dealer or integrator. Warranty periods vary based on product category and type of equipment, as shown in Table 1 entitled "Product Warranty Periods" below.

We will return equipment or ship replacement equipment via the same incoming ship method at no additional charge. If you request a different return ship method, we will charge for the full shipping cost.

### *Product Warranty Periods*

Table 1 lists warranty durations for most eLine equipment, sorted by category. Warranty periods start as set forth under the heading "Warranty Repair/Replacements" above. For items that do not appear in Table 1, contact Customer Service or your sales rep for the applicable policy.

Product Type	Product Warranty	Exceptions
<b>eLine Cloud Cameras</b>	2 years	PTZ Cameras – 1 year
<b>Other eLine</b>	2 years	----

For help or more information on setup, please visit <http://elinetechnology.com>

Or contact eLine support provided by 2D Electronics at 303.938.1133 [support@2delectronics.com](mailto:support@2delectronics.com)

eLine, 1070 W 124th Ave Suite B-100, Westminster, CO 80234