

ducasa

DT1 – Digital Timer

Compatible with the Sunburst PRC-10T, PRC-15T and PRC-20T Radiant Heaters

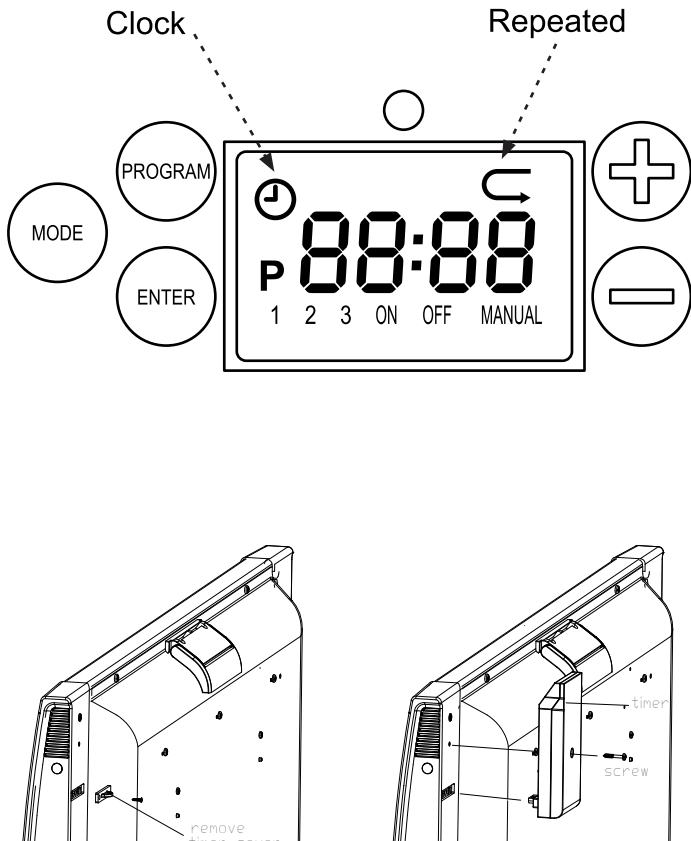

Switch off the appliance first and disconnect the plug from the socket.

Before fitting the timer, please remove the cover from the back of the right hand plastic end panel by using a screw driver.

- Push the timer into the connectors on the heater. Fix securely to heater with the screw.
- Then plug in heaters to power source.
- After fitting the timer, the heater can only be operated when the heater power switches are on.

That means if the power switches are off, the heater will not work even if the timer is in the operating mode.

There are five buttons to set the Timer, they are the MODE, PROGRAM, ENTER, + and – buttons.

Icons and 4 digits are shown on the display.

When you first plug in, only ---- will be shown on

the display as the time has not been set. Please set the current time first as described below:

- Clock setting - Hold the PROGRAM button until the hour digits are flashing, press “+” or “-“ to set the hour, press ENTER button to confirm. Then set the minutes, press the ENTER button to confirm. The clock icon is displayed when setting the clock or when current time is shown. Clock setting can only be done in the OFF or the manual mode status.

MODE SELECTION

- Press the mode button to set the desired status 1) manual on 2) timer standby and 3) off.
- The first press of the button will select the ‘manual on’ mode, the power LED light is on and the clock icon, current time and MANUAL are shown on the display. The appliance is now in manual mode.
- Press the mode button again to change to ‘timer standby’ mode. Power light is still on and the clock icon, current time, OFF and P are shown on display. There are three program timer setting. If there are any programs set. They will be displayed as – 1, 2 or 3 or a combination of the numbers. During this mode, the appliance will operate as set in the program chosen.
- Press the mode button again to turn off the appliance. The clock icon and the current time is shown on the screen.

PROGRAM SETTING

- Press the PROGRAM button twice to set - P, 1 and ON are displayed. The starting time of program 1 can now be set.
- The hour digits are flashing, press “+” and “-“ to set the hour, press ENTER to confirm. Then set the minutes, press the ENTER button to confirm. Then the P, 1 and OFF are displayed and the end time can now be set. Set the hour and minutes using the same procedure as the starting time. Press ENTER again to set P2 and P3 with ON and OFF times.

Press MODE button to go back.

When all programs are set, the current time and clock icon are display.

PROGRAM CHOSEN

- After setting programs they can be chosen individually or in combinations.
- Hold the MODE button first and then press PROGRAM. P, 1 is flashing. Press ENTER to choose and 1 will stop flashing and P1 is chosen. Then P, 2 is flashing and can be chosen. Press ENTER to confirm and repeat for P,3. If you do not wish to choose a Program, press “+” or “-“ and the program number will flash again. Press mode to cancel. After a few seconds, the program is confirmed and set. When the timer is set to standby mode, the heater will operate according to the program set and chosen.

SINGLE PROGRAM OPERATION

- During the program timer operation, the corresponding program no.1, 2 or 3 and ON will be displayed. And the power LED will be on.
- At the end of the program, the program no. will disappear and OFF is displayed. (only when single program chosen). The power LED is off.
- During program operation press ‘mode’ to stop the program or choose the ‘manual on’ mode.

COMBINATION PROGRAM OPERATION

- Press PROGRAM and ENTER buttons at same time to choose a combination of programs. Press PROGRAM and ENTER buttons again to revert to single program operation.
- When a combination of programs is chosen, the repeated icon is shown on display.
- If a combination of programs is chosen, at the end of the program, the corresponding program no. will remain displayed. The programs will be repeated each day.

SELF BUTTON LOCKING

- Press ENTER and “+” buttons at the same time and hold for 5 secs to lock the keypad. Press the same keys again for 5 secs to unlock.

ducasa

UK Distributor of Ducasa Products:
Heattend Products Ltd.

Web: www.heattend.co.uk

Email: enquiries@heattend.co.uk